

Brampton Encore - 7 - 1 - 38-5 Elev.A HANDEL

ELECTRICAL

Inv.455	1 - TELEPHONE AND CABLE ROUGH-IN LOCATION SKETCH
Line5837	Note:
26Apr16 / 24May16	

Inv.455	1 - KITCHEN: INSTALL 110V WALL RECEPTACLE ON DEDICATED CIRCUIT - FOR MICROWAVE - MICROWAVE NOT INCLUDED. SEE SKETCH. PURCHASER MUST BUY APPROPRIATE CABINETRY AT THE COLOUR APPOINTMENT
Line5838	Note:
26Apr16 / 24May16	

Inv.455	4 - EXTERIOR: INSTALL FOUR (X4) POT LIGHTS: 4 INCH LINE VOLTAGE POT LIGHT - (EXTERIOR) -EACH, AS SHOWN ON BROCHURE. SEE SKETCH
Line5840	Note:
26Apr16 / 24May16	

Inv.922	1 - KITCHEN: PURCHASER HAD BOUGHT A RECEPTICAL AT THE STRUCTURAL APPOINTMENT. THEY HAVE OPTED TO NOT PUT IN A MICROWAVE.
	NO CREDIT GIVEN FOR RECEPTICAL
Line13130	Note:
26Oct16 / 28Oct16	

EXTERIOR COLOURS

Inv.455	1 - EXTERIOR COLOUR PACKAGE 10
Line6153	Note:
26Apr16 / 24May16	

FRAMING

Inv.455	1 - MAN DOOR GARAGE TO HOUSE - OPTIONAL - IF GRADE PERMITS
Line6155	Note: As Per Bonus Pckg APS
26Apr16 / 24May16	

GRANITE MARBLE QUARTZ

Inv.922	
Line13119	
26Oct16 / 28Oct16	

Inv.922	1 - KITCHEN: INSTALL 4 CM PROFILE UPG 1 Kitchen with Island no BBar
Line13120	Note:
26Oct16 / 28Oct16	

Inv.922	1 - KITCHEN: INSTALL 4 CM PROFILE UPG 1 Optional Flush BBar
Line13121	Note:
26Oct16 / 28Oct16	

Inv.922	1 - MASTER ENSUITE: INSTALL 2 CM GRP 2 Ensuite
Line13122	Note:
26Oct16 / 28Oct16	

Inv.922	1 - ENSUITE 2: ISNTALL 2 CM GRP 1 Ensuite 2
Line13123	Note:
26Oct16 / 28Oct16	

Inv.922	1 - TWIN BATH: INSTALL 2 CM GRP 1 Twin Bath
Line13124	Note:
26Oct16 / 28Oct16	

Brampton Encore - 7 - 1 - 38-5 Elev.A HANDEL

HARDWOOD

Inv.922	1 - DINING ROOM: INSTALL PREVERCO, SOLID FLEX RED OAK IN SIERRA Upgrade 1 LEVEL S Dining
Line13114	Note:
26Oct16 / 28Oct16	
Inv.922	1 - FAMILY ROOM: INSTALL PREVERCO, SOLID FLEX RED OAK IN SIERRA Upgrade 1 LEVEL S Family
Line13115	Note:
26Oct16 / 28Oct16	
Inv.922	1 - MAIN HALL: INSTALL PREVERCO, SOLID FLEX RED OAK IN SIERRA Upgrade 1 LEVEL S Main Hall
Line13116	Note:
26Oct16 / 28Oct16	
Inv.922	1 - LANDING: INSTALL PREVERCO, SOLID FLEX RED OAK IN SIERRA Upgrade 1 LEVEL S Landing
Line13117	Note:
26Oct16 / 28Oct16	

KITCHEN AND BATH CABINetry

Inv.922	1 - KITCHEN: PURCHASER HAD BOUGHT A RECEPICAL AT THE STRUCTURAL APPOINTMENT. THEY HAVE OPTED TO NOT PUT IN A MICROWAVE.
	NO CREDIT GIVEN FOR RECEPICAL
Line13131	Note:
26Oct16 / 28Oct16	

MISC.

Inv.455	1 - BONUS PACKAGE: \$3344.80 (INCLUDING TAXES) WORTH OF UPGRADES FROM GOLD PARK HOMES DÉCOR CENTRE IS BEING APPLIED TOWARD THE STRUCTURAL APPOINTMENT. PURCHASER HAS A REMAINING AMOUNT OF \$6655.20 (INCLUDING TAXES) TO BE USED TOWARD THE COLOUR APPOINTMENT
Line5841	Note:
26Apr16 / 24May16	
Inv.455	1 - Purchaser has attended a Structural appointment at the Decor Centre & has DECLINED any additional upgrades and accepts and acknowledges that there will be no further structural changes/additions/deletions to be made upon signing on May 5, 2016
Line5842	Note:
26Apr16 / 24May16	
Inv.455	1 - Purchasers are aware & accepts that ANY changes made to upgrades after signing this Purchasers Extra Form are subject to a minimum administration fee of \$500. PLUS a 10% holdback fee
Line5843	Note:
26Apr16 / 24May16	
Inv.922	1 - Purchaser has attended a Colour appointment at the Decor Centre & has DECLINED any additional upgrades and accepts and acknowledges that there will be no further structural changes/additions/deletions to be made upon signing on October 26, 2016
Line13132	Note:
26Oct16 / 28Oct16	
Inv.922	1 - Purchasers are aware & accepts that ANY changes made to upgrades after signing this Purchasers Extra Form are subject to a minimum administration fee of \$500. PLUS a 10% holdback fee
Line13133	Note:
26Oct16 / 28Oct16	

Brampton Encore - 7 - 1 - 38-5 Elev.A HANDEL

Inv.922	1 - BONUS PACKAGE: \$6655.20 (INCLUDING TAXES) WORTH OF UPGRADES FROM GOLD PARK HOMES DÉCOR CENTRE IS BEING APPLIED TOWARD THE COLOUR APPOINTMENT.
Line13134	Note:
26Oct16 / 28Oct16	

Inv.922	1 - Due to the many variables that can affect the pattern, colour and/or design and "pitting" of natural products, granite installed will not be identical to the samples displayed. Every effort is made to provide granite counter tops as close as possible
Line13135	Note: the vendor is not responsible for results which differ from the sample displayed. All countertop surfaces may have seems & product pattern & shade can change in areas containing seems
26Oct16 / 28Oct16	

PAINTING

Inv.922	1 - STAIRCASE: Stain Staircase 2 Storey Model (Euroline Pickets Charged Separately)
Line13118	Note:
26Oct16 / 28Oct16	

PLUMBING

Inv.455	1 - BASEMENT: INSTALL ROUGH-IN - 3PC BASEMENT ROUGH-IN, AS PER PLAN
Line5474	Note:
26Apr16 / 24May16	

Inv.922	2 - MASTER ENSUITE: UNDERMOUNT SINKS- INSTALL TWO (X2) UNDERMOUNT SINKS IN MASTER ENSUITE
	CALVIN 19 1/4" OVAL UNDERMOUNT SINK #4220CFY
Line13125	Note:
26Oct16 / 28Oct16	

Inv.922	2 - TWIN BATH: UNDERMOUNT SINKS- INSTALL TWO (X2) UNDERMOUNT SINKS IN TWIN BATH
	CALVIN 19 1/4" OVAL UNDERMOUNT SINK #4220CFY
Line13126	Note:
26Oct16 / 28Oct16	

Inv.922	1 - ENSUITE 2: UNDERMOUNT SINKS- INSTALL TWO (X2) UNDERMOUNT SINKS IN ENSUITE 2
	CALVIN 19 1/4" OVAL UNDERMOUNT SINK #4220CFY
Line13127	Note:
26Oct16 / 28Oct16	

STAIRS AND RAILINGS

Inv.922	1 - STAIRCASE: INSTALL EUROLINE 1 Black
Line13128	Note:
26Oct16 / 28Oct16	

Inv.922	1 - STAIRCASE: V Groove Handrail
Line13129	Note:
26Oct16 / 28Oct16	

WINDOWS AND DOORS

Inv.455	1 - MAN DOOR GARAGE TO HOUSE - OPTIONAL - IF GRADE PERMITS
Line6154	Note: As Per Bonus Pkg APS
26Apr16 / 24May16	

Scheduled Closing Date: November-09-16

Purchasers: Yui Wong But & Anna Fung Heine Butt

Property: 7 of Plan -

Telephone Res. / Bus: (416) 400-9181

Project: Fieldwalk Investments Inc.

Decor Advisor: Terri Parisani

Model and Elevation: 38-5 Elev.A HANDEL

Layout Changes: Yes No Sketch Attached: Yes No Exterior Colour Scheme:

1. Cabinetry

	Style and Colour	Counter	Hardware
Kitchen / Breakfast	Carrara(pvc)ChocMaple	Grigio Sardo *Edge: T-30	cs1-6
Laundry Room	<input type="text"/>	<input type="text"/>	<input type="text"/>
Powder Room	<input type="text"/>	<input type="text"/>	<input type="text"/>
TWIN BATH	Carrara(pvc)Mystic	*Upg.1 Marble Bianco Carrara Edge: F30	cs1-18
Master Ensuite Bathroom	Carrara(pvc)CrystalWhit	*Upg.2 Marble Volakis Edge: F30	cs1-10
Second Ensuite Bathroom (If Applicable)	Carrara(pvc)VanillaStix	*Upg.1 Marble Giallo Ornamental Edge: F30	cs1-20
<input type="text"/>	<input type="text"/>	<input type="text"/>	<input type="text"/>
Dishwasher Cabinet	N/A		

Comment

2. Floor Tile

	Selection	Grout	Threshold
Entrance Vestibule	Serpentine Grey 13 x 13	N/A	N/A
Main Hall	<input type="text"/>	<input type="text"/>	<input type="text"/>
Kitchen / Breakfast	Serpentine Grey 13 x 13	N/A	N/A
Laundry Room	Serpentine Grey 13 x 13	N/A	N/A
Powder Room	Serpentine Grey 13 x 13	N/A	N/A
TWIN BATH	Serpentine Syrak 13 x 13	N/A	N/A
Master Ensuite Bathroom	Serpentine Syrak 13 x 13	N/A	N/A
Second Ensuite Bathroom (If Applicable)	Serpentine Syrak 13 x 13	N/A	N/A
Lower Landing (If Applicable)	<input type="text"/>	N/A	N/A
<input type="text"/>	<input type="text"/>	<input type="text"/>	<input type="text"/>

Comment

3. Wall Tile

	Selection	Listello/Inserts	Describe
TWIN BATH	Weave Tender Grey, 8 x 10	<input type="radio"/> Yes <input checked="" type="radio"/> No	<input type="text"/>
Master Ensuite Bathroom			
Tub Deck	Weave Tender Grey, 8 x 10	<input type="radio"/> Yes <input checked="" type="radio"/> No	<input type="text"/>
Shower Stall	Weave Tender Grey, 8 x 10	<input type="radio"/> Yes <input checked="" type="radio"/> No	<input type="text"/>
Bathroom Walls	Weave Tender Grey, 8 x 10	<input type="radio"/> Yes <input checked="" type="radio"/> No	<input type="text"/>
Second Ensuite Bathroom (If Applicable)	Weave Ivory, 8 x 10	<input type="radio"/> Yes <input checked="" type="radio"/> No	<input type="text"/>
<input type="text"/>	<input type="text"/>	<input type="radio"/> Yes <input type="radio"/> No	<input type="text"/>

Kitchen Backsplash

Yes No

Backsplash Behind Fridge

N/A

Comment

Scheduled Closing Date: November-09-16

Purchasers: Yui Wong But & Anna Fung Heine Butt

Property: 7 of Plan -

Telephone Res. / Bus: (416) 400-9181

Project: Fieldwalk Investments Inc.

Decor Advisor: Terri Parisani

Model and Elevation: 38-5 Elev.A HANDEL

4. Plumbing Fixtures

Master Ensuite Bathroom	<input type="checkbox"/>	Second Ensuite	<input type="checkbox"/>	Powder Room	<input type="checkbox"/>
	<input type="checkbox"/>	Other Room - Specify	<input type="checkbox"/>	Other Washroom	<input type="checkbox"/>
Comment	<input type="text"/>				

ALL FIXTURES TO REMAIN STANDARD THROUGHOUT

5. Hardwood Flooring

	Type and Stain		Type and Stain
Main Hall	<input type="text" value="*Upg.1,Preverco Sienna Red Oak"/>	Upper Landing	<input type="text" value="*Upg.1,Preverco Sienna Red Oak"/>
Kitchen / Breakfast	<input type="text" value="-"/>	Upper Hall	<input type="text" value="-"/>
Living Room	<input type="text" value="-"/>	Master Bedroom	<input type="text" value="-"/>
Dining Room	<input type="text" value="*Upg.1,Preverco Sienna Red Oak"/>	Bedroom #2	<input type="text" value="-"/>
Family Room	<input type="text" value="*Upg.1,Preverco Sienna Red Oak"/>	Bedroom #3	<input type="text" value="-"/>
Den/Library	<input type="text" value="-"/>	Bedroom #4	<input type="text" value="-"/>
Entrance Vestibule	<input type="text" value="-"/>	Bedroom #5	<input type="text" value="-"/>
Lower Landing (If Applicable)	<input type="text" value="-"/>	Other Room - Specify	<input type="text" value="-"/>

Comment

Preverco- is Solid Flex

6. Carpeting

	Upgrade	Description
Main Hall	<input type="checkbox"/>	<input type="text" value="-"/>
Living Room	<input type="checkbox"/>	<input type="text" value="-"/>
Dining Room	<input type="checkbox"/>	<input type="text" value="-"/>
Family Room	<input type="checkbox"/>	<input type="text" value="-"/>
Den/Library	<input type="checkbox"/>	<input type="text" value="-"/>
Upper Hall	<input type="checkbox"/>	<input type="text" value="T-03"/>
Master Bedroom	<input type="checkbox"/>	<input type="text" value="T-03"/>
Bedroom #2	<input type="checkbox"/>	<input type="text" value="T-03"/>
Bedroom #3	<input type="checkbox"/>	<input type="text" value="T-03"/>
Bedroom #4	<input type="checkbox"/>	<input type="text" value="T-03"/>
Bedroom #5	<input type="checkbox"/>	<input type="text" value="-"/>
<input type="text" value=""/>	<input type="checkbox"/>	<input type="text" value="-"/>
Upper Landing (If Applicable)	<input type="checkbox"/>	<input type="text" value="-"/>
Lower Landing (If Applicable)	<input type="checkbox"/>	<input type="text" value="-"/>

Upgrade Underpad	Type	Area
	<input type="text" value="STANDARD"/>	<input type="text" value=""/>
Carpet on Stairs	Capped	Runner - *Upgrade
	<input type="text" value="N/A"/>	<input type="text" value="N/A"/>

Comment

FF

Purchasers: Yui Wong But & Anna Fung Heine Butt

Property: 7 of Plan -

Telephone Res. / Bus: (416) 400-9181

Project: Fieldwalk Investments Inc.

Decor Advisor: Terri Parisani

Model and Elevation: 38-5 Elev.A HANDEL

7. Fireplace

	Living Room			Family Room			Other Room - Specify		
	Purchased	As Per Plan	N/A	Purchased	As Per Plan	N/A	Purchased	As Per Plan	N/A
Fireplace Type	<input type="radio"/>	<input type="radio"/>	<input checked="" type="radio"/>	<input type="radio"/>	<input checked="" type="radio"/>	<input type="radio"/>	<input type="radio"/>	<input type="radio"/>	<input checked="" type="radio"/>
Mantle Type				STANDARD					
Colour / Stain				NF-24					
Surround				WHITE PAINT-GRADE					
Hearth				NERO MARQUINA					
Comment				NONE					
<div style="border: 1px solid black; height: 30px; width: 100%;"></div>									

8. Trim Carpentry

Interior Doors Front Door Glass Inserts Door Handles

Interior Trim

Comment

9. Plaster Mouldings and Medallions

Entrance Vestibule	<input type="text" value="N/A"/>	<input type="text"/>	Kitchen/Breakfast	<input type="text" value="N/A"/>	<input type="text"/>
Main Hall	<input type="text" value="N/A"/>	<input type="text"/>	Den/Library	<input type="text" value="N/A"/>	<input type="text"/>
Living Room	<input type="text" value="N/A"/>	<input type="text"/>	Lower Landing	<input type="text" value="N/A"/>	<input type="text"/>
Dining Room	<input type="text" value="N/A"/>	<input type="text"/>	Other Room - Specify	<input type="text"/>	<input type="text"/>
Family Room	<input type="text" value="N/A"/>	<input type="text"/>			
Comment					
<div style="border: 1px solid black; height: 30px; width: 100%;"></div>					

10. Railings and Spindles

Railing Package

Railing Colour Spindle Colour

Stringer / Riser Treads

Comment

Oak Stairs Yes No

11. Wall Paint

Main & Upper Hall	<input type="text" value="WARM GREY"/>	Master Bedroom	<input type="text" value="WARM GREY"/>
Living Room	<input type="text" value="WARM GREY"/>	Bedroom #2	<input type="text" value="WARM GREY"/>
Dining Room	<input type="text" value="WARM GREY"/>	Bedroom #3	<input type="text" value="WARM GREY"/>
Kitchen / Breakfast	<input type="text" value="WARM GREY"/>	Bedroom #4	<input type="text" value="WARM GREY"/>
Family Room	<input type="text" value="WARM GREY"/>	Bedroom #5	<input type="text" value="WARM GREY"/>
Powder Room	<input type="text" value="WARM GREY"/>	Master Ensuite	<input type="text" value="WARM GREY"/>
Laundry Room	<input type="text" value="WARM GREY"/>		<input type="text"/>
Den/Library	<input type="text" value="WARM GREY"/>	Second Ensuite	<input type="text" value="WARM GREY"/>
Trim Paint	<input type="text" value="WHITE"/>		<input type="text"/>
Comment	Smooth Ceilings First Floor <input type="text"/>		

Scheduled Closing Date: November-09-16

Purchasers: Yui Wong But & Anna Fung Heine Butt

Property: 7 of Plan -

Telephone Res. / Bus: (416) 400-9181

Project: Fieldwalk Investments Inc.

Decor Advisor: Terri Parisani

Model and Elevation: 38-5 Elev.A HANDEL

12. Electrical

Plugs and Switches White Ivory

Above Kitchen Cabinet Light Yes No

Hood Fan White Ivory

Below Kitchen Cabinet Light Yes No

Appliances **Built in Cooktop**

Built in Oven

Gas Stove

Microwave

Yes No

Yes No

Yes No

Yes No

Comment

STANDAR HOOD FAN: STAINLESS STEEL

13. Heating and Air Conditioning

Air Conditioning

Gas Provisions Stove

Gas Provisions Dryer

Gas Provisions Barbecue

Comment

GAS BBQ IS STANDARD

14. Additional Comments

15. Disclaimers and Notes

- 1) Colours of all materials are as close as possible to builder's selection, but not necessarily identical due to variances in manufacturing.
- 2) Any extras listed above are null and void unless accompanied by a separate invoice/amendment. Said invoice must be paid in full.
- 3) The Purchaser acknowledges that after Interior Colour Selection form is signed and dated, no further changes will be permitted other than re-selection due to unavailability. _____ Purchaser's Initials
- 4) The Purchaser acknowledges reading and accepting the "Gold Park Homes Decor Centre Disclaimers" form. This document contains other miscellaneous disclaimers.

This Interior Colour Selection is final and approved by:

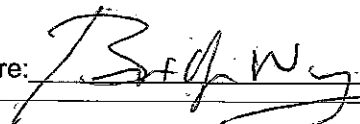
Signature: 

Date: Oct 20, 2016

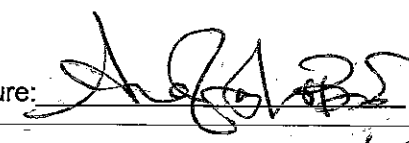
Signature: 

Date: Oct 20, 2016

Elevation A • 2,603 sq.ft. | Elevation B • 2,603 sq.ft.

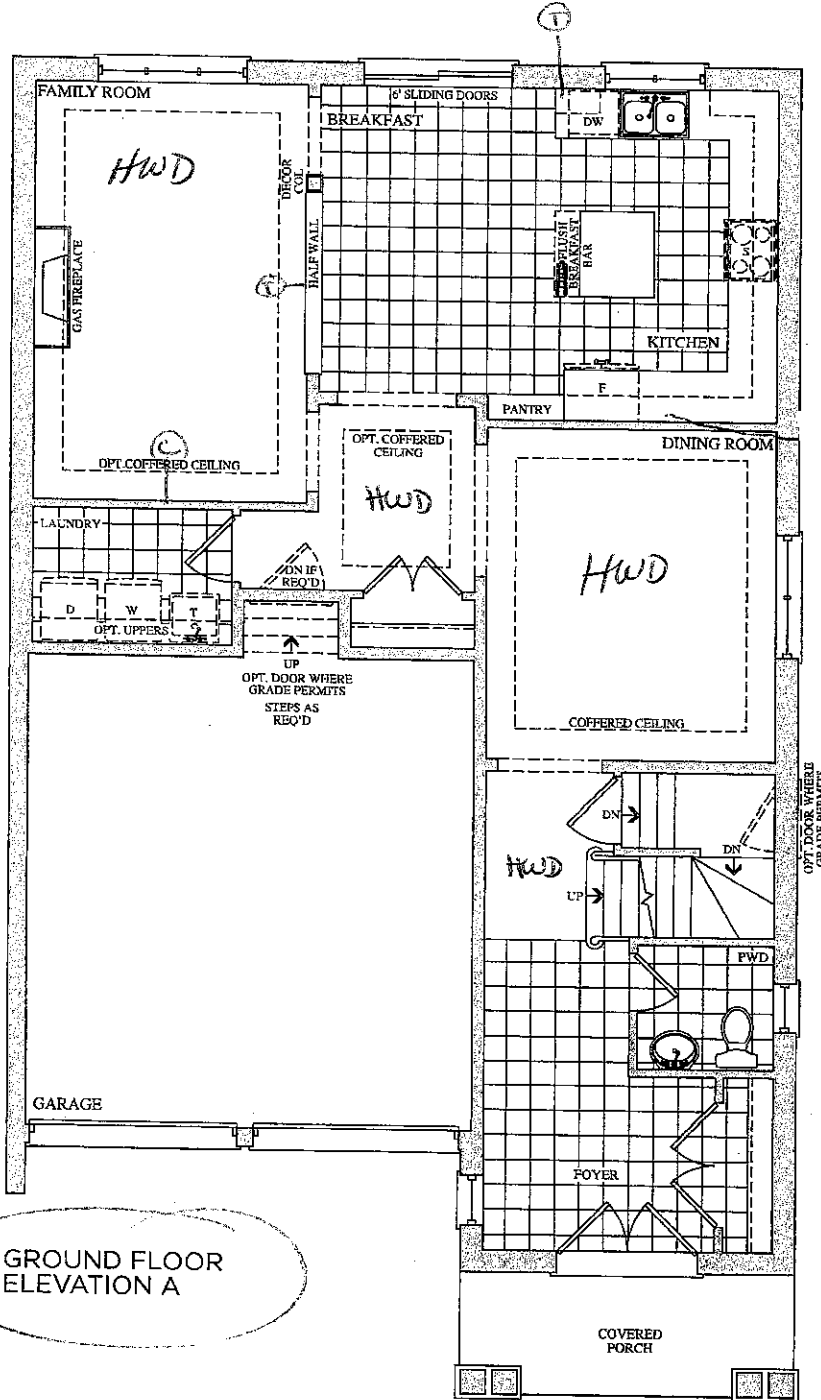

Lot 7
Oct. 26, 16
[Handwritten initials]

Lot 7
May 5, 16
[Handwritten initials]

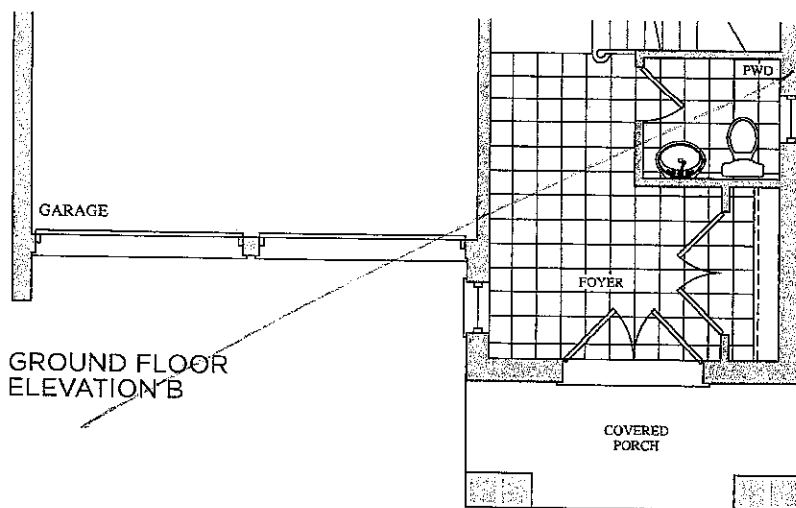

Elevation A • 2,603 sq.ft. | Elevation B • 2,603 sq.ft.

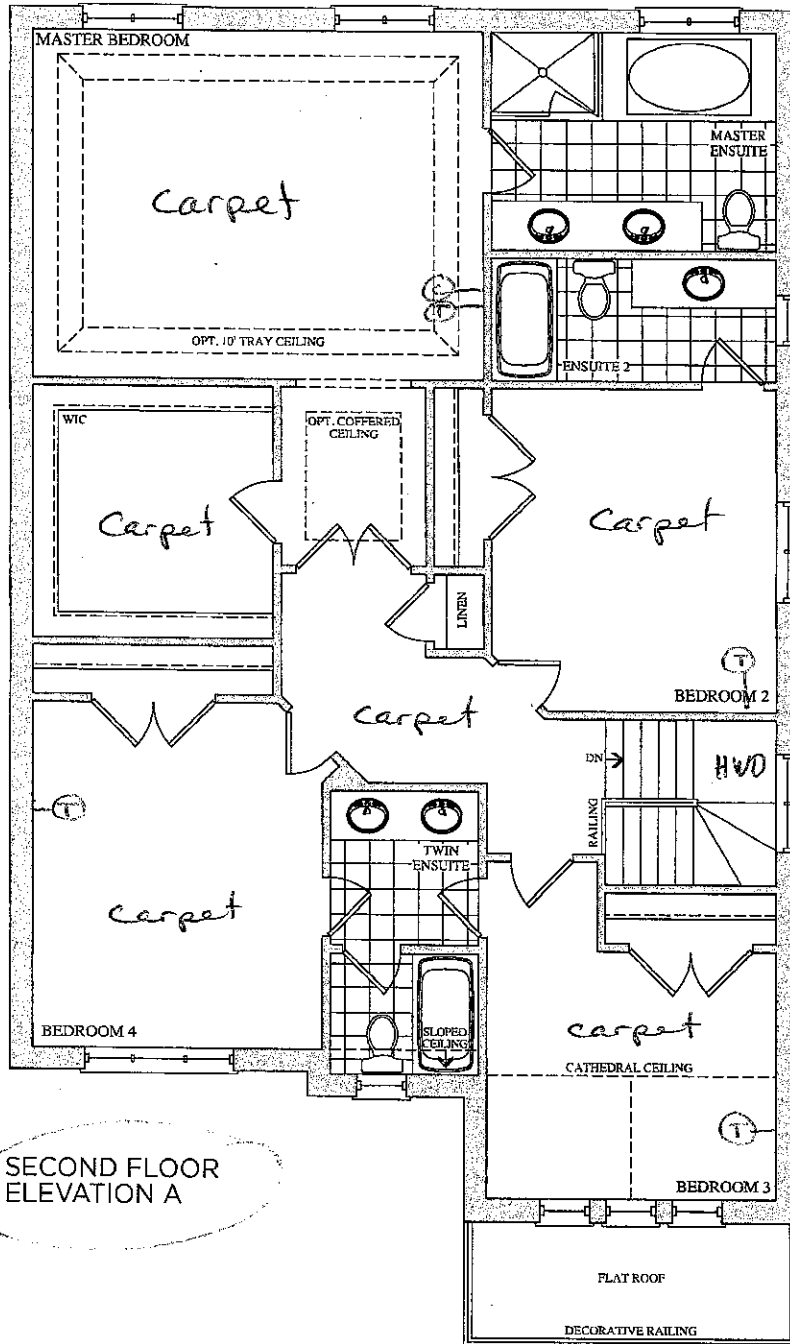

Lot 7
Oct. 26, 16
~~2~~ ~~3~~

Lot 7
May 5, 16
~~2~~ ~~3~~

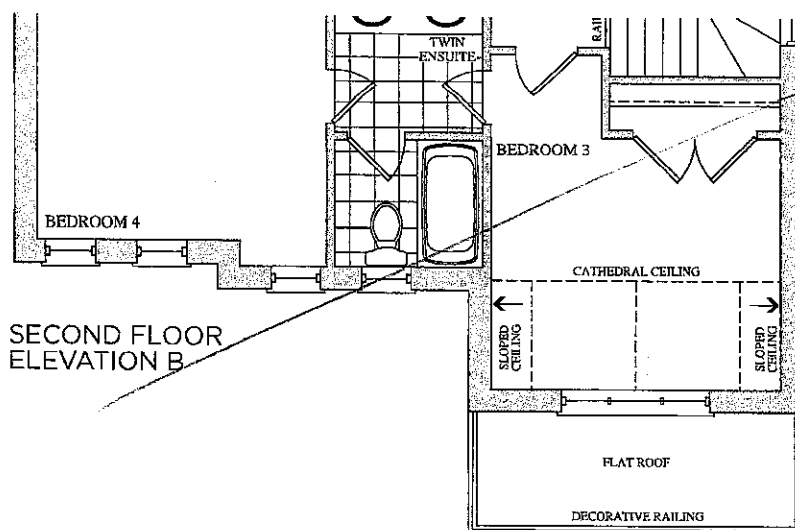

Lot 7
Oct. 26, 16

Q
P

Calvin

4220CFY 19 1/4" Oval Undermount Sink



FEATURES

Vitreous china
Front overflow hole
Template and mounting hardware supplied
Overall dimensions (W x D x H):
(OD): 19 1/4" x 16 1/2" x 7 5/8"
(ID): 17" x 13 3/4" x 5 3/4"

CERTIFICATIONS

IAPMO cUPC
ASME A112.19.2 / CSA B45.1-2008

COLOUR

Soft white

contrac
www.contrac.ca

The images shown are a representation of the finish and color, and may not reflect every characteristic possible.

Issued: Feb. 2016

X 2 in Master
X 2 in Main Bath
X 1 in Ens. 2



CSI-6

Kitchen

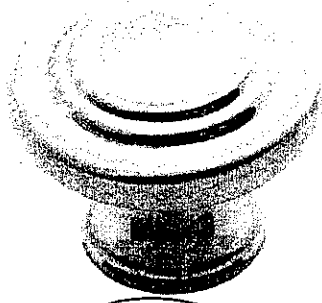

CSI-10

master

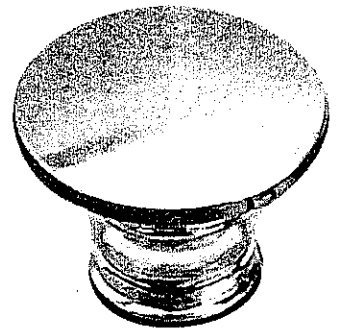

CSI-14

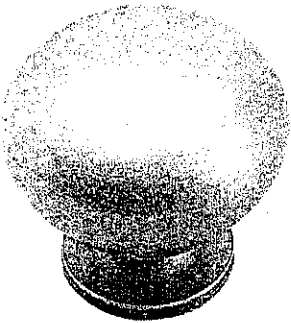

CSI-16

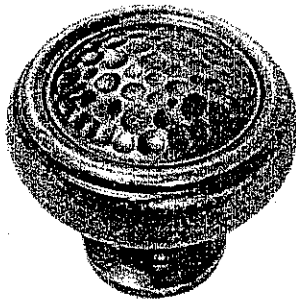

CSI-18

Twin

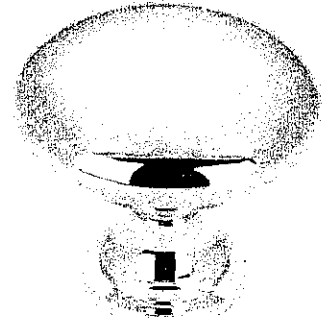

CSI-19

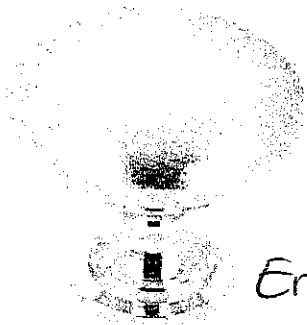

CSI-20

Ens. 2

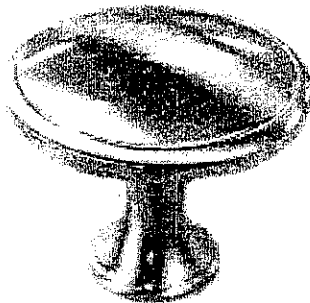

CSI-21

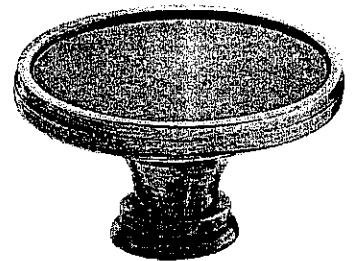

CSI-22

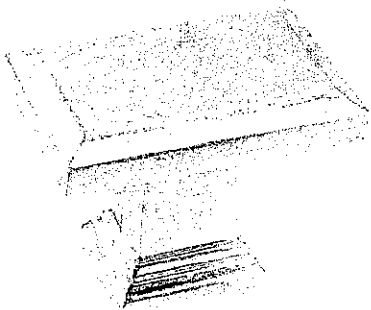

CSI-23

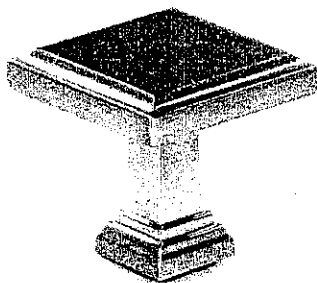

CSI-24

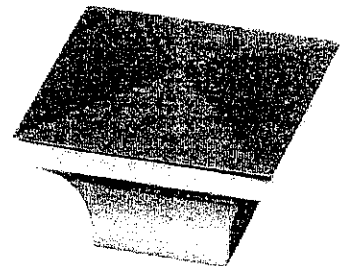

CSI-25

*NOTES:

- IMAGES ARE FOR QUICK REFERENCE PURPOSES ONLY
- ACTUAL SIZES AND FINISHES AS PER HARDWARE SAMPLE BOARD PROVIDED TO DECOR CENTRE

20mm (3/4") Profiles

Standard & Upgrade Profiles
Offered with a 2 cm Surface

*Twin Bath
Ens. &
Master Ensuite*

30mm (1 1/4") Profiles

Standard & Upgrade Profiles
Offered with a 3 cm Surface

40mm (1 1/2") Profiles

Upgrade 1
Upgrade 2
Offered with a 2 cm Surface

Kitchen

Note: All colours may not be available in 30mm at time ordered.
Vendor reserves the right to use 40mm edges (by lamination process).

*Lot 7
Oct. 26, 16
P. Q. V. I.*

CORTINA KITCHENS INC.

70 Regina Road Woodbridge ON L4L 8L6
905-264-6464

INFORMATION - PVC DOORS

Builder Gold Park Homes Project Encore Lot # 7

All cabinets with PVC (Thermofoil) Doors come with melamine gables, panels and kick. The doors, crown moulding and light valance are PVC wrapped. Open shelves incorporated in design will only be available with melamine interiors. There will be variations in colour shades between the PVC parts (doors, crown and Light valance) and the melamine parts (open shelves, Gables, Panels and Kick) due to the difference in material.

Furring Panel with crown moulding to the ceiling is not available on all PVC door styles due to subtle variations in colour shades between the PVC parts (moulding) and the melamine parts (furring panel) due to the difference in material. Grain directions in wood grain pattern melamine, vary between the furring panel, crown moulding (horizontal) and the PVC doors (vertical).

Thank you for your understanding.

I am well informed of this information, and agree to the purchase of the above.

Purchaser:

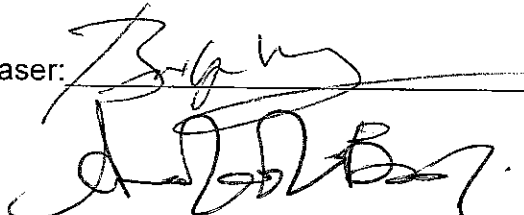

Date:

Oct 26, 2016

OCT 26, 2016.

Trade Name: Gold Park Homes	Site location: Brampton	Model: 38-5
Address:	Project: Encore	Phase:

This layout has been explained to the purchaser by Cortina Kitchens Inc. and is understood by the purchaser.

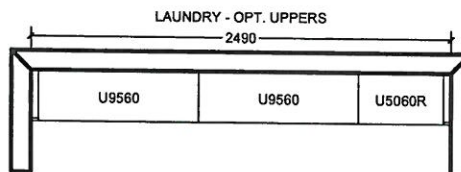
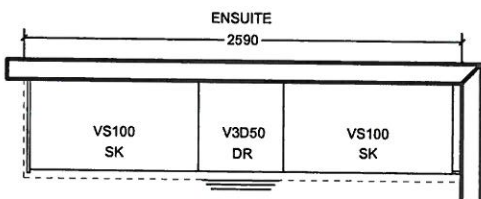
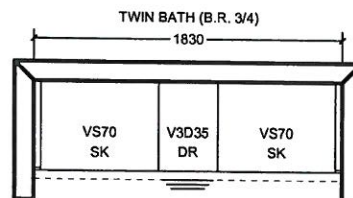
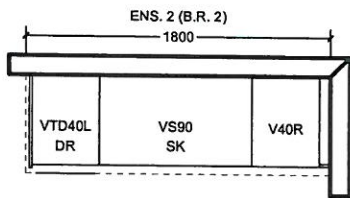
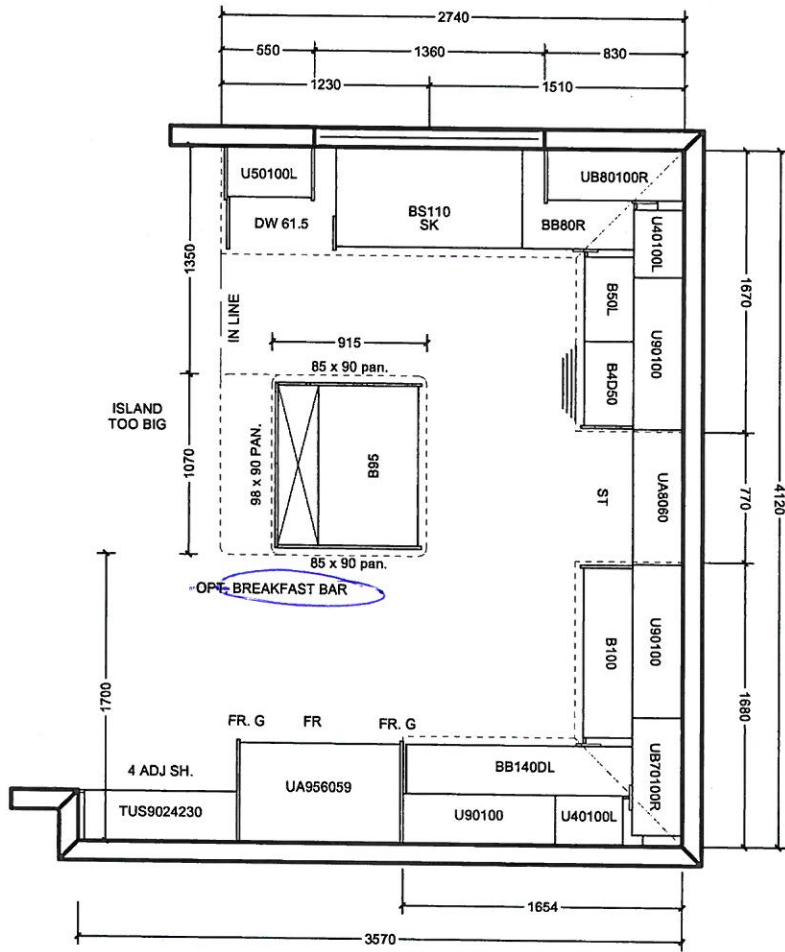

All prices subject to confirmation from head office. This quotation is subject to the terms & conditions set out in Cortina's Agreement of Purchase and Sale

All agreements are contingent upon strikes, accidents, and delay beyond our control. Please provide our Installer with template for sinkholes or \$150.00 will be charged for callback.

ACCEPTED DATE: _____

CUSTOMER SIGNATURE

SALESPERSON SIGNATURE

CORTINA HEAD OFFICE APPROVAL

ITEM A. Wood grain and colour are characteristics of the product, we cannot guarantee that such grain and colour will always match
ITEM B. Cortina Kitchens reserves the right to alter dimensions and make technical changes without notice.

*Lot 7
Nov. 1, 16*

** No Kitchen changes*