

Brampton Encore - 118 - 1 - 38-1 Elev.B BIZET

CERAMIC

Inv.1,051	1 - KITCHEN- BACKSPLASH: INSTALL 2ND UPGRADE BACKSPLASH. TO GO ABOVE COUNTER AND BEHIND STOVE
Line15318	Note:
12Dec16 / 19Dec16	

ELECTRICAL

Inv.487	1 - TELEPHONE AND CABLE ROUGH-IN LOCATION SKETCH
Line5846	Note:
9May16 / 20May16	

Inv.487	1 - EXTERIOR: INSTALL ADDITIONAL FESTIVE SOFFIT PLUG ON SAME SWITCH AS BUILDER'S STANDARD SOFFIT PLUG FOR EXTERIOR HOLIDAY LIGHTS - SEE SKETCH FOR LOCATION:
Line5849	Note:
9May16 / 20May16	

Inv.487	1 - EXTERIOR: INSTALL GFI DUPLEX OUTLET WITH COVER - TO GO ON THE EXTERIOR WALL OUTSIDE OF BED #3 WINDOW, WHERE THERE IS THE DECORATIVE RAILING. SEE SKETCH FOR LOCATION.
Line5850	Note:
9May16 / 20May16	

EXTERIOR COLOURS

Inv.509	1 - EXTERIOR COLOUR PACKAGE 1
Line6144	Note:
20May16 / 20May16	

FORMING

Inv.487	1 - EXTERIOR: INSTALL SIDE DOOR- HOME TO EXTERIOR- AS PER PLAN AND GRADE PERMITTING
Line5847	Note:
9May16 / 20May16	

FRAMING

Inv.487	1 - FAMILY ROOM: INSTALL OPTIONAL COFFERED CEILING - FAMILY ROOM (PER ROOM AS PER PLAN)
Line5848	Note:
9May16 / 20May16	

GRANITE MARBLE QUARTZ

Inv.1,051	1 - 2 CM GRP 1 Optional Flush BBar
Line15319	Note:
12Dec16 / 19Dec16	

HARDWOOD

Inv.1,051	1 - UPPER HALL: INSTALL PREVERCO PRO, IN NATURAL, IN LIEU OF STANDARD CARPET. Standard Upper Hall
Line15317	Note:
12Dec16 / 19Dec16	

KITCHEN AND BATH CABINETRY

Inv.1,051	1 - MAIN BATH (TWIN): INSTALL Handles Main Vanity
Line15315	Note:
12Dec16 / 19Dec16	

Brampton Encore - 118 - 1 - 38-1 Elev.B BIZET

Inv.1,051	1 - MASTER ENSUITE: INSTALL Handles Master Ensuite
Line15316	Note:
12Dec16 / 19Dec16	

MISC.

Inv.487	1 - Purchasers are aware & accepts that ANY changes made to upgrades after signing this Purchasers Extra Form are subject to a minimum administration fee of \$500. PLUS a 10% holdback fee
Line5853	Note:
9May16 / 20May16	

Inv.487	1 - BONUS PACKAGE: \$5130.20 (INCLUDING TAXES) WORTH OF UPGRADES FROM GOLD PARK HOMES DÉCOR CENTRE IS BEING APPLIED TOWARD THE STRUCTURAL APPOINTMENT. PURCHASER HAS A REMAINING AMOUNT OF \$4869.80 (INCLUDING TAXES) TO BE USED TOWARD THE COLOUR APPOINTMENT
Line5851	Note:
9May16 / 20May16	

Inv.487	1 - Purchaser has attended a Structural appointment at the Decor Centre & has DECLINED any additional upgrades and accepts and acknowledges that there will be no further structural changes/additions/deletions to be made upon signing on May 9, 2016
Line5852	Note:
9May16 / 20May16	

Inv.1,051	1 - BONUS PACKAGE: \$4869.80 (INCLUDING TAXES) WORTH OF UPGRADES FROM GOLD PARK HOMES DÉCOR CENTRE IS BEING APPLIED TOWARD THE COLOUR APPOINTMENT
Line15320	Note: NOTE: BALANCE OF DECOR BONUS HAS NO CASH VALUE
12Dec16 / 19Dec16	

Inv.1,051	1 - Purchaser has attended a Colour appointment at the Decor Centre & has DECLINED any additional upgrades and accepts and acknowledges that there will be no further structural changes/additions/deletions to be made upon signing on December 12, 2016
Line15321	Note:
12Dec16 / 19Dec16	

Inv.1,051	1 - Purchasers are aware & accepts that ANY changes made to upgrades after signing this Purchasers Extra Form are subject to a minimum administration fee of \$500. PLUS a 10% holdback fee
Line15322	Note:
12Dec16 / 19Dec16	

WINDOWS AND DOORS

Inv.487	1 - MAN DOOR GARAGE TO HOUSE - OPTIONAL - IF GRADE PERMITS
Line6138	Note: As per APS
9May16 / 20May16	

Purchaser: Suveetharan Shanmuganthan

Property: 118 of Plan -

Telephone Res. / Bus: (647) 262-9555

Project: Fieldwalk Investments Inc.

Decor Advisor: Terri Parisani

Model and Elevation: 38-1 Elev.B BIZET

Layout Changes: ☐ Yes ☒ No Sketch Attached: ☒ Yes ☐ No Exterior Colour Scheme:

1. Cabinetry

	Style and Colour	Counter	Hardware
Kitchen / Breakfast	Toscana (pvc) Mystic	Grigio Sardo Granite Edge: C20	cs1-6
Laundry Room	-		
Powder Room	-		
MAIN BATH	Toscana (pvc)VanillaStix	7735-58 Portico Marble Laminate	*CH-32
Master Ensuite Bathroom	Toscana (pvc) Mystic	6697-46 Argento Romano Laminate	*CH-52
Second Ensuite Bathroom (If Applicable)	-		
	-		
Dishwasher Cabinet	-		
Comment			

2. Floor Tile

	Selection	Grout	Threshold
Entrance Vestibule	Reflex White, 13 x 13	N/A	N/A
Main Hall	-	N/A	N/A
Kitchen / Breakfast	Reflex White, 13 x 13	N/A	N/A
Laundry Room	Reflex Espresso, 13 x 13	N/A	N/A
Powder Room	Reflex White, 13 x 13	N/A	N/A
MAIN BATH	New Reeds Silver, 13 x 13	N/A	N/A
Master Ensuite Bathroom	Serpentine Beyaz, 13 x 13	N/A	N/A
Second Ensuite Bathroom (If Applicable)	-		
Lower Landing (If Applicable)	-		
Comment			

3. Wall Tile

	Selection	Listello/Inserts	Describe
MAIN BATH	Reflection Olive 8 x 10	<input type="radio"/> Yes <input checked="" type="radio"/> No	
Master Ensuite Bathroom			
Tub Deck	Weave White 8 x 10	<input type="radio"/> Yes <input checked="" type="radio"/> No	
Shower Stall	Weave White 8 x 10	<input type="radio"/> Yes <input checked="" type="radio"/> No	
Bathroom Walls	Weave White 8 x 10	<input type="radio"/> Yes <input checked="" type="radio"/> No	
Second Ensuite Bathroom (If Applicable)		<input type="radio"/> Yes <input checked="" type="radio"/> No	
		<input type="radio"/> Yes <input checked="" type="radio"/> No	
Kitchen Backsplash	<input checked="" type="radio"/> Yes <input type="radio"/> No	Backsplash Behind Fridge	none
Comment	*SEE BELOW FOR DETAILS		
BACKSPLASH: UPG. 2, CRISTALLO GLASS MOSAIC, BRICK LAYERED- GLOSSY/MATTE BLENDS IN SUPER WHITE 0.6" X 1.9"			

Scheduled Closing Date: October-25-16

Purchaser: Suveetharan Shanmuganthan

Property: 118 of Plan -

Telephone Res. / Bus: (647) 262-9555

Project: Fieldwalk Investments Inc.

Decor Advisor: Terri Parisani

Model and Elevation: 38-1 Elev.B BIZET

4. Plumbing Fixtures

Master Ensuite Bathroom Second Ensuite Powder Room
Other Room - Specify Other Washroom

Comment

ALL FIXTURES TO REMAIN STANDARD THROUGHOUT

5. Hardwood Flooring

	Type and Stain		Type and Stain
Main Hall	STD. PREVERCO, NATURAL	Upper Landing	STD. PREVERCO, NATURAL
Kitchen / Breakfast	<input type="text"/>	Upper Hall	**PREVERCO PRO, NATURAL
Living Room	<input type="text"/>	Master Bedroom	<input type="text"/>
Dining Room	STD. PREVERCO, NATURAL	Bedroom #2	<input type="text"/>
Family Room	STD. PREVERCO, NATURAL	Bedroom #3	<input type="text"/>
Den/Library	<input type="text"/>	Bedroom #4	<input type="text"/>
Entrance Vestibule	<input type="text"/>	Bedroom #5	<input type="text"/>
Lower Landing (If Applicable)	<input type="text"/>	Other Room - Specify	<input type="text"/>

Comment

6. Carpeting

	Upgrade	Description
Main Hall	<input type="checkbox"/>	<input type="text"/>
Living Room	<input type="checkbox"/>	<input type="text"/>
Dining Room	<input type="checkbox"/>	<input type="text"/>
Family Room	<input type="checkbox"/>	<input type="text"/>
Den/Library	<input type="checkbox"/>	<input type="text"/>
Upper Hall	<input type="checkbox"/>	<input type="text"/>
Master Bedroom	<input type="checkbox"/>	T-07
Bedroom #2	<input type="checkbox"/>	T-07
Bedroom #3	<input type="checkbox"/>	T-07
Bedroom #4	<input type="checkbox"/>	T-07
Bedroom #5	<input type="checkbox"/>	<input type="text"/>
<input type="text"/>	<input type="checkbox"/>	<input type="text"/>
Upper Landing (If Applicable)	<input type="checkbox"/>	<input type="text"/>
Lower Landing (If Applicable)	<input type="checkbox"/>	<input type="text"/>

Upgrade Underpad Type STANDARD Area
Carpet on Stairs Capped Runner - *Upgrade

Comment

Purchaser: Suveetharan Shanmuganthan

Property: 118 of Plan -

Telephone Res. / Bus: (647) 262-9555

Project: Fieldwalk Investments Inc.

Decor Advisor: Terri Parisani

Model and Elevation: 38-1 Elev.B BIZET

7. Fireplace

Living Room			Family Room			Other Room - Specify		
Purchased	As Per Plan	N/A	Purchased	As Per Plan	N/A	Purchased	As Per Plan	N/A
<input type="radio"/>	<input type="radio"/>	<input checked="" type="radio"/>	<input type="radio"/>	<input checked="" type="radio"/>	<input type="radio"/>	<input type="radio"/>	<input type="radio"/>	<input checked="" type="radio"/>

Fireplace Type		STANDARD	
Mantle Type		NF-24	
Colour / Stain		WHITE PAINT-GRADE	
Surround		CREMA MARFIL	
Hearth		NONE	

Comment

8. Trim Carpentry

Interior Doors	STANDARD	Front Door Glass Inserts	STANDARD	Door Handles	STANDARD
Interior Trim	STANDARD				

Comment

9. Plaster Mouldings and Medallions

Entrance Vestibule	N/A		Kitchen/Breakfast	N/A	
Main Hall	N/A		Den/Library	N/A	
Living Room	N/A		Lower Landing	N/A	
Dining Room	N/A		Other Room - Specify		
Family Room	N/A				

Comment

10. Railings and Spindles

Railing Package	STANDARD		
Railing Colour	STANDARD-NATURAL	Spindle Colour	STANDARD-NATURAL
Stringer / Riser	STANDARD-NATURAL	Treads	STANDARD-NATURAL

Comment

Oak Stairs ☒ Yes ☐ No

11. Wall Paint

Main & Upper Hall	BIRCH WHITE	Master Bedroom	BIRCH WHITE
Living Room	-	Bedroom #2	BIRCH WHITE
Dining Room	BIRCH WHITE	Bedroom #3	BIRCH WHITE
Kitchen / Breakfast	BIRCH WHITE	Bedroom #4	BIRCH WHITE
Family Room	BIRCH WHITE	Bedroom #5	-
Powder Room	BIRCH WHITE	Master Ensuite	BIRCH WHITE
Laundry Room	BIRCH WHITE	MAIN BATH	BIRCH WHITE
Den/Library	-	Second Ensuite	-
Trim Paint	WHITE		

Comment Smooth Ceilings First Floor

Scheduled Closing Date: October-25-16

Purchaser: Suveetharan Shanmuganthan

Property: 118 of Plan -

Telephone Res. / Bus: (647) 262-9555

Project: Fieldwalk Investments Inc.

Decor Advisor: Terri Parisani

Model and Elevation: 38-1 Elev.B BIZET

12. Electrical

Plugs and Switches

☒ White ☐ Ivory

Hood Fan

☐ White ☐ Ivory

Appliances

Built in Cooktop

☐ Yes ☒ No

Built in Oven

☐ Yes ☒ No

Gas Stove

☐ Yes ☒ No

Microwave

☐ Yes ☒ No

Above Kitchen Cabinet Light

☐ Yes ☒ No

Below Kitchen Cabinet Light

☐ Yes ☒ No

Comment

HOOD FAN: STAINLESS STEEL

13. Heating and Air Conditioning

Air Conditioning

Gas Provisions Dryer

Gas Provisions Stove

Gas Provisions Barbecue

Comment

GAS BBQ IS STANDARD

14. Additional Comments

15. Disclaimers and Notes

- 1) Colours of all materials are as close as possible to builder's selection, but not necessarily identical due to variances in manufacturing.
- 2) Any extras listed above are null and void unless accompanied by a separate invoice/amendment. Said invoice must be paid in full.
- 3) The Purchaser acknowledges that after Interior Colour Selection form is signed and dated, no further changes will be permitted other than re-selection due to unavailability. Purchaser's Initials
- 4) The Purchaser acknowledges reading and accepting the "Gold Park Homes Decor Centre Disclaimers" form. This document contains other miscellaneous disclaimers.

This Interior Colour Selection is final and approved by:

Signature: 

Date: Dec 12, 2016

Cable ————— (c)

The Bizet

38' SERIES

Elevation A • 2,234 sq.ft. | Elevation B • 2,222 sq.ft.

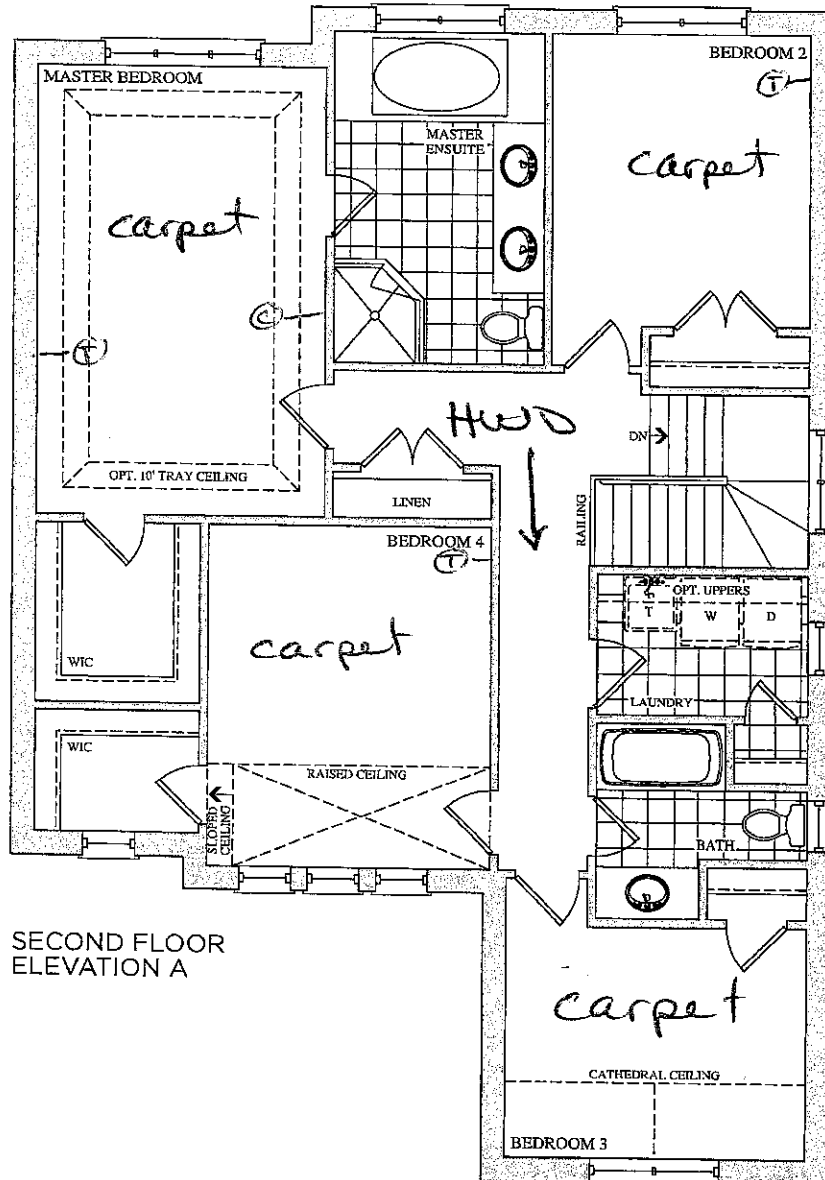

Lot 118
Dec. 12, 16

55

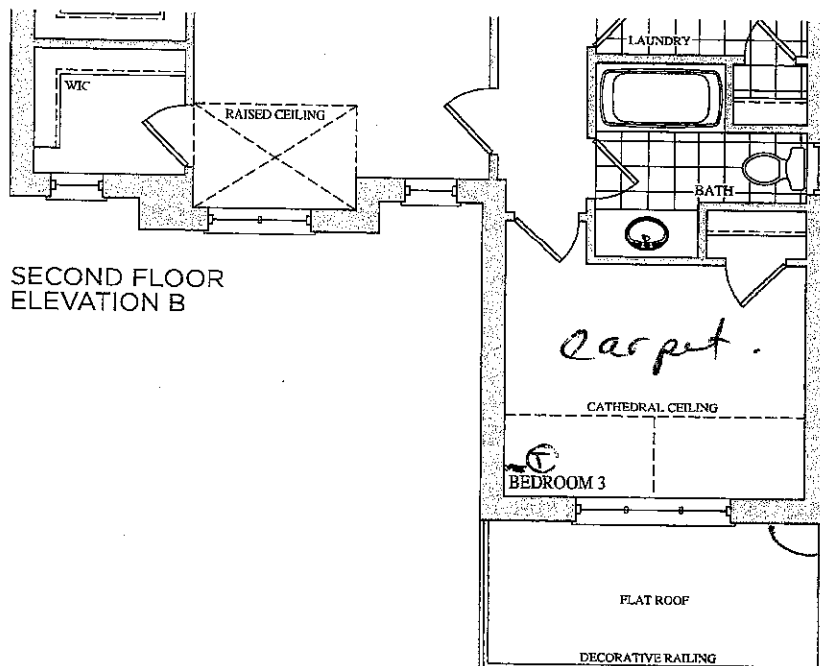

Lot 118
May 9, 2016

55

CORTINA

KITCHENS INC.

70 Regina Road Woodbridge ON L4L 8L6
905-264-6464

INFORMATION - PVC DOORS

Builder Gold Park Homes Project Encore Lot # 118

All cabinets with PVC (Thermofoil) Doors come with melamine gables, panels and kick. The doors, crown moulding and light valance are PVC wrapped. Open shelves incorporated in design will only be available with melamine interiors. There will be variations in colour shades between the PVC parts (doors, crown and Light valance) and the melamine parts (open shelves, Gables, Panels and Kick) due to the difference in material.

Furring Panel with crown moulding to the ceiling is not available on all PVC door styles due to subtle variations in colour shades between the PVC parts (moulding) and the melamine parts (furring panel) due to the difference in material. Grain directions in wood grain pattern melamine, vary between the furring panel, crown moulding (horizontal) and the PVC doors (vertical).

Thank you for your understanding.

I am well informed of this information, and agree to the purchase of the above.

Purchaser: 

Date: Dec 12, 2016

Trade Name: Gold Park Homes

Site location: Brampton

Model: 38-6

Address:

Project: Encore

Phase:

This layout has been explained to the purchaser by Cortina Kitchens Inc. and is understood by the purchaser.

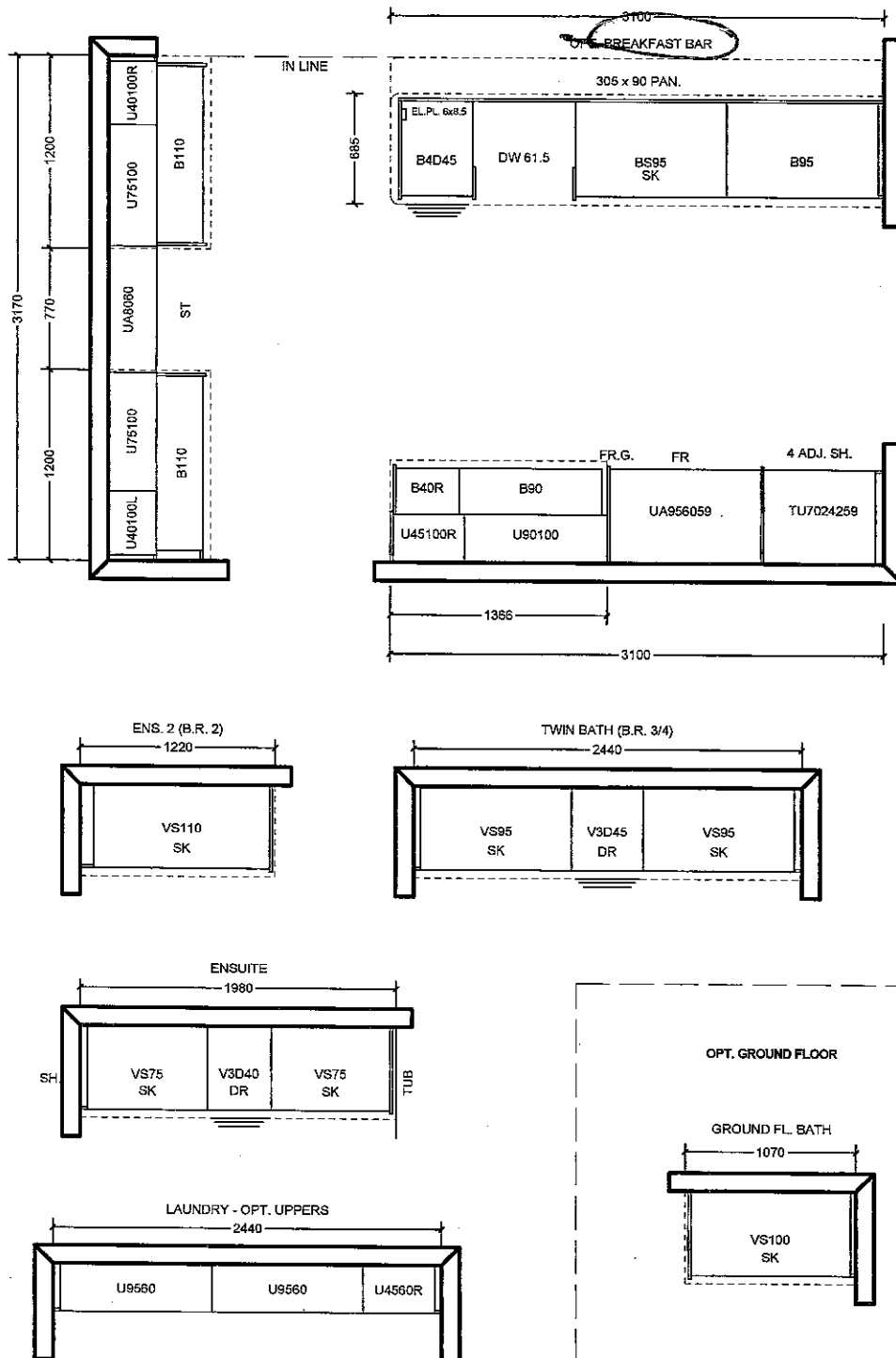

All prices subject to confirmation from head office.

This quotation is subject to the terms & conditions set out in Cortina's Agreement of Purchase and Sale.

All agreements are contingent upon strikes, accidents, and delay beyond our control. Please provide our installer with template for sinkholes or \$150.00 will be charged for callback.

ACCEPTED DATE: _____

CUSTOMER SIGNATURE

SALESPERSON SIGNATURE

CORTINA HEAD OFFICE APPROVAL

ITEM A. Wood grain and colour are characteristics of the product, we cannot guarantee that such grain and colour will always match.
ITEM B. Cortina Kitchens reserves the right to alter dimensions and make technical changes without notice.

Lot 118
Dec. 12, 16



UPGRADE HARDWARE

Dec. 12, 16

55

UPGRADE HARDWARE



CH-32



CH-38

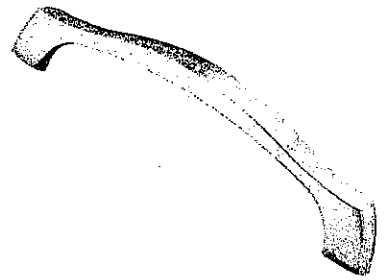

CH-44

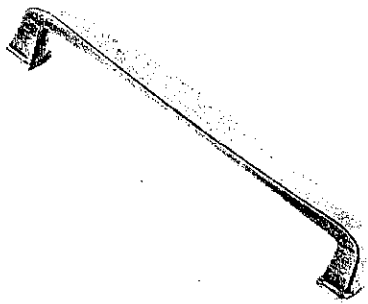
~~Hand~~
Main Bath

CH-45

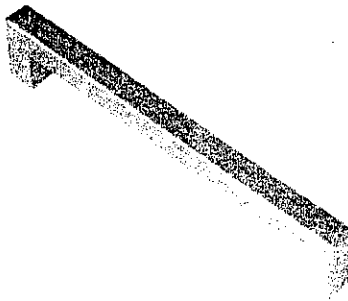

CH-46

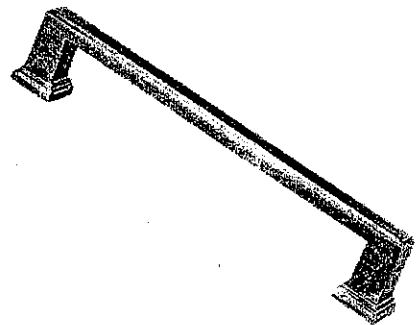

CH-47

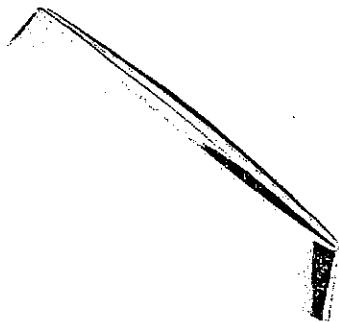

CH-48

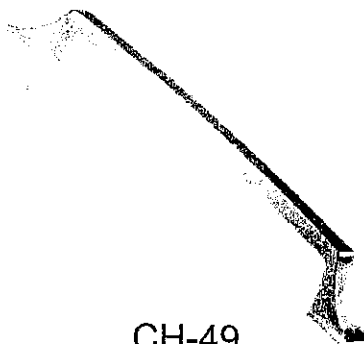

CH-49



CH-50

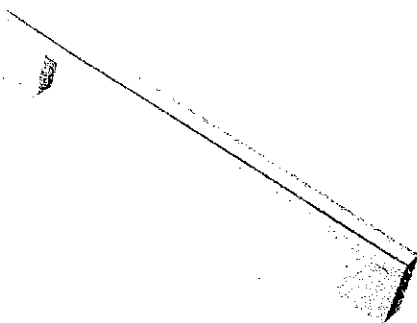

CH-51

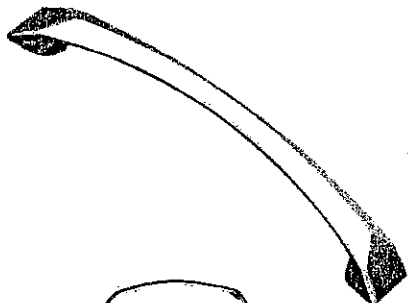

CH-52 Master

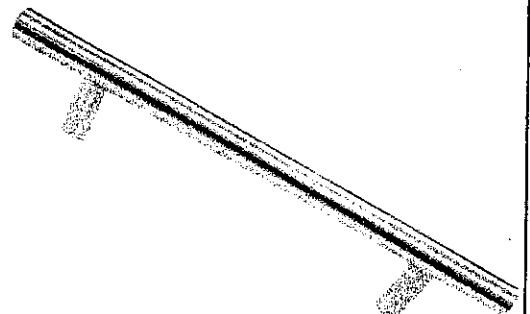

CH-53

*NOTES:

- IMAGES ARE FOR QUICK REFERENCE PURPOSES ONLY
- ACTUAL SIZES AND FINISHES AS PER HARDWARE SAMPLE BOARD PROVIDED TO DECOR CENTRE



CSI-6

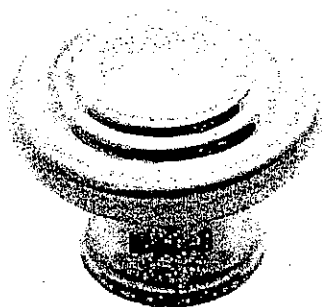

CSI-10



CSI-14

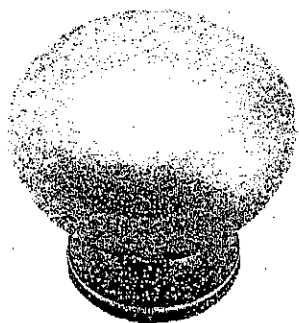

CSI-16

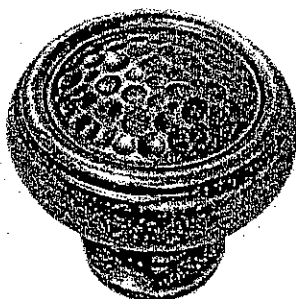

CSI-18

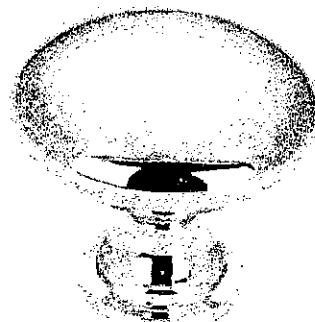

CSI-19

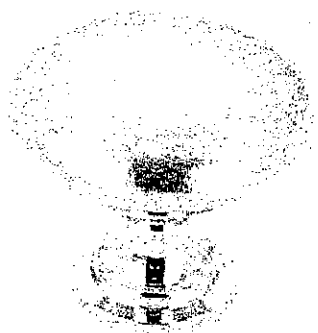

CSI-20

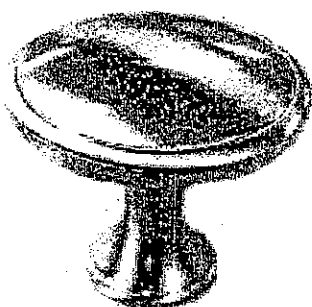

CSI-21



CSI-22

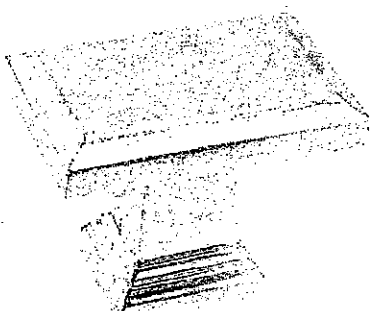

CSI-23

Kitchen

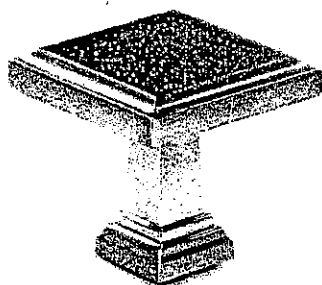

CSI-24

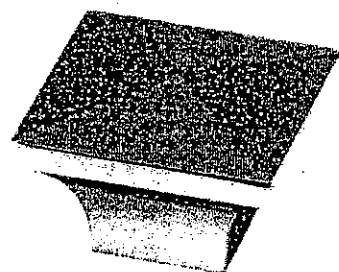

CSI-25

***NOTES:**

- IMAGES ARE FOR QUICK REFERENCE PURPOSES ONLY
- ACTUAL SIZES AND FINISHES AS PER HARDWARE
- SAMPLE BOARD PROVIDED TO DECOR CENTRE

Lot 118
Dec. 12, 16

20mm (3/4") Profiles

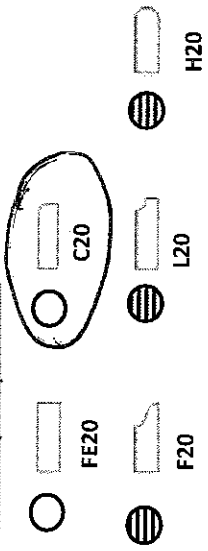

Standard & Upgrade Profiles
Offered with a 2 cm Surface

Kitchen

30mm (1 1/4") Profiles

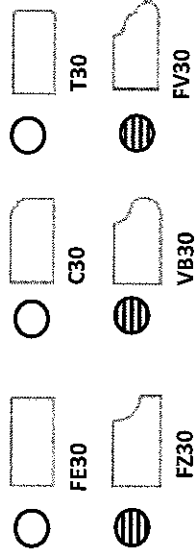

Standard & Upgrade Profiles
Offered with a 3 cm Surface

40mm (1 1/2") Profiles

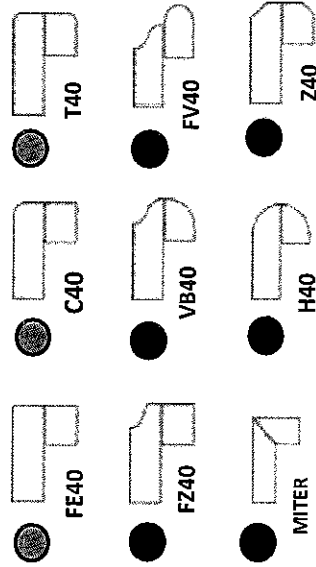

4 mm Upgrade 1 & 2 Profiles
Offered with a 2 cm Surface

Note: All colours may not be available in 30mm at time ordered.
Vendor reserves the right to use 40mm edges (by lamination process).