

CONSTRUCTION SUMMARY

116 - 1 - 38-5 Elev.A HANDEL

CENTRAL VAC AND WIRING

Inv.593	1 - TELEPHONE AND CABLE ROUGH-IN LOCATIONS
Line7249	Note:
21Jun16 / 26Sep16	
Inv.593	1 - FAMILY ROOM: INSTALL CONDUIT PIPE- FOR TELEVISION- MUST SPECIFY LOCATION AND TERMINATION POINT, ABOVE FIREPLACE
Line7250	Note:
21Jun16 / 26Sep16	
Inv.593	1 - KITCHEN: INSTALL VAC PAN UNDER KITCHEN SINK
Line7252	Note:
21Jun16 / 26Sep16	

ELECTRICAL

Inv.593	1 - FAMILY ROOM; INSTALL 110V WALL RECEPTACLE ON DEDICATED CIRCUIT - ABOVE FIREPLACE, SEE SKETCH
Line7251	Note:
21Jun16 / 26Sep16	
Inv.593	1 - KITCHEN: INSTALL 110V WALL RECEPTACLE ON DEDICATED CIRCUIT - FOR MICROWAVE - MICROWAVE NOT INCLUDED. PURCHASER IS AWARE THAT THEY MUST BUY THE APPROPRIATE CABINETRY AT THE TIME OF COLOURS
Line7253	Note:
21Jun16 / 26Sep16	
Inv.593	1 - BASEMENT: INSTALL 200 AMP ELECTRICAL SERVICE
Line7254	Note:
21Jun16 / 26Sep16	

EXTERIOR COLOURS

Inv.593	1 - EXTERIOR COLOUR PACKAGE 6
Line11998	Note:
21Jun16 / 26Sep16	

FORMING

Inv.593	1 - EXTERIOR: INSTALL SIDE DOOR- HOME TO EXTERIOR- AS PER PLAN AND GRADE PERMITTING
Line7256	Note: GRADING PERMITS PER SITING DATED AUGUST 2, 2016
21Jun16 / 26Sep16	

FRAMING

Inv.593	1 - GARAGE: INSTALL MANDOOR - GARAGE TO HOUSE- AS PER PLAN AND GRADE PERMITTING
Line7255	Note: GIVEN IN THE AGREEMENT OF PURCHASE AND SALE GRADING PERMITS PER SITING DATED AUGUST 2, 2016
21Jun16 / 26Sep16	

KITCHEN AND BATH CABINETRY

Inv.593	1 - KITCHEN: INSTALL VAC PAN UNDER KITCHEN SINK
Line11996	Note:
21Jun16 / 26Sep16	

MISC.

CONSTRUCTION SUMMARY

116 - 1 - 38-5 Elev.A HANDEL

Inv.593	1 - BONUS PACKAGE: \$5621.75 (INCLUDING TAXES) WORTH OF UPGRADES FROM GOLD PARK HOMES DÉCOR CENTRE IS BEING APPLIED TOWARD THE STRUCTURAL APPOINTMENT. PURCHASER HAS A REMAINING AMOUNT OF \$4378.25 (INCLUDING TAXES) TO BE USED TOWARD THE COLOUR APPOINTMENT.
Line7264	Note:
21Jun16 / 26Sep16	
Inv.593	1 - Purchaser has attended a Structural appointment at the Decor Centre & has DECLINED any additional upgrades and accepts and acknowledges that there will be no further structural changes/additions/deletions to be made upon signing on June 21, 2016
Line7265	Note:
21Jun16 / 26Sep16	
Inv.593	1 - Purchasers are aware & accepts that ANY changes made to upgrades after signing this Purchasers Extra Form are subject to a minimum administration fee of \$500. PLUS a 10% holdback fee
Line7266	Note:
21Jun16 / 26Sep16	

WINDOWS - BASEMENT

Inv.593	1 - BASEMENT: INSTALL ONE (X1) BASEMENT WINDOWS - EXTRA BASEMENT WINDOW 30 INCH X 12 INCH. SEE SKETCH
Line7257	Note:
21Jun16 / 26Sep16	
Inv.593	1 - BASEMENT: INSTALL ONE (X1) BASEMENT WINDOWS - EXTRA BASEMENT WINDOW 30 INCH X 16 INCH. SEE SKETCH
Line7258	Note:
21Jun16 / 26Sep16	
Inv.593	1 - BASEMENT: INSTALL ONE (X1) BASEMENT WINDOWS - UPGRADE EXISTING BASEMENT WINDOW TO 30 INCH X 16 INCH. SEE SKETCH
Line7259	Note:
21Jun16 / 26Sep16	



The  
**Handel**  
38' SERIES

Elevation A • 2,603 sq.ft. | Elevation B • 2,603 sq.ft.

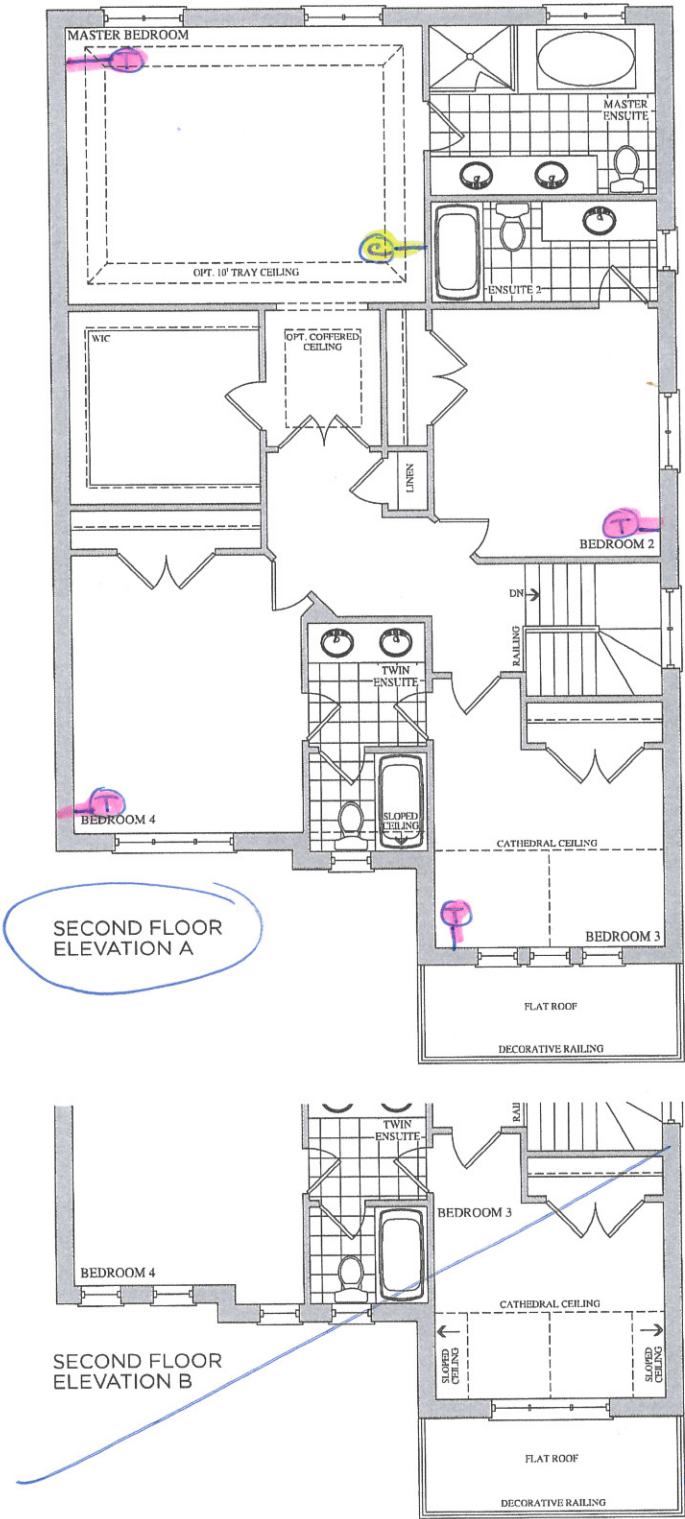

Prices, figures, illustrations, sizes, features and finishes are subject to change without notice. E.&O.E. Areas and dimensions are approximate and actual usable floor space may vary from the stated area. Layout may be reverse of the unit purchased. E. & O.E.

Elevation A • 2,603 sq.ft. | Elevation B • 2,603 sq.ft.

Basement Windows

1 x 30" x 16"

Additional :

1 x 30" x 16"

1 x 30" x 12"

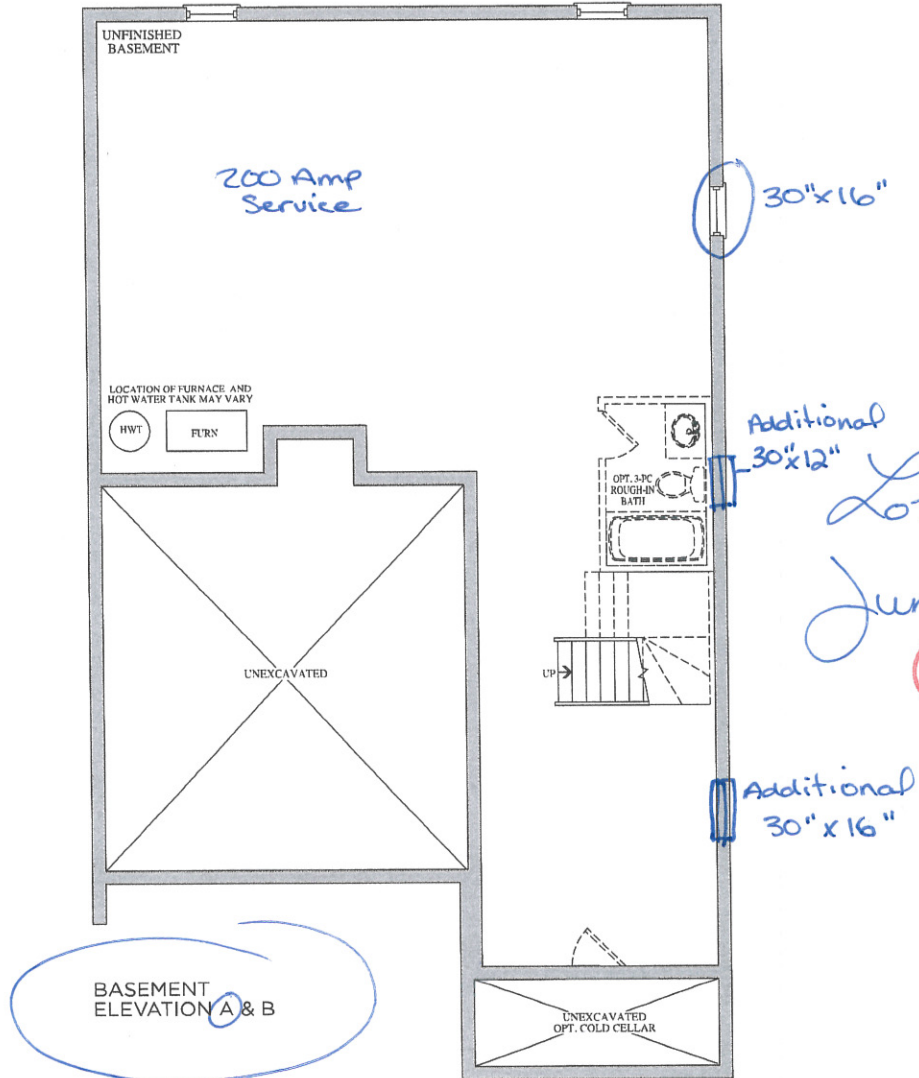

Prices, figures, illustrations, sizes, features and finishes are subject to change without notice. E.&O.E. Areas and dimensions are approximate and actual usable floor space may vary from the stated area. Layout may be reverse of the unit purchased. E. & O.E.



Stacey Carlete  
Project Coordinator



Claude Azzopardi  
Contracts Manager



Nancy Mc  
Corporate C

116  
Lot #



38.1 The Bizet			
Elevation	Circle One	A	2189.6 Square Feet
		B	2186.7 Square Feet
Optional Layouts	Circle All that Apply		

38.2 The Ravel			
Elevation	Circle One	A	2271.5 Square Feet
		B	2273.7 Square Feet
Optional Layouts	Circle All that Apply		

38.3 The Haydn			
Elevation	Circle One	A	2394.5 Square Feet
		B	2388.3 Square Feet
Optional Layouts	Circle All that Apply		

38.4 The Vivaldi			
Elevation	Circle One	A	2459.1 Square Feet
		B	2459.1 Square Feet
Optional Layouts	Circle All that Apply		

38.5 The Handel			
Elevation	Circle One	A	2549.2 Square Feet 2603.7
		B	2554.7 Square Feet
Optional Layouts	Circle All that Apply		

38.9 The Puccini			
Elevation	Circle One	A	3628.0 Square Feet
		B	3634.7 Square Feet
Optional Layouts	Circle All that Apply	GFA1	GROUND FLOOR Optional Alternative Layout

38.6 The Scarlatti			
Elevation	Circle One	A	3521.1 Square Feet
		B	3508.1 Square Feet
Optional Layouts	Circle All that Apply	GFA1	GROUND FLOOR Optional Alternative Layout

38.7 The Schubert			
Elevation	Circle One	A	3593.8 Square Feet
		B	3610.5 Square Feet
Optional Layouts	Circle All that Apply	GFA1	GROUND FLOOR Optional Alternative Layout
		SFA4	SECOND FLOOR Additional Bedroom

38.8 The Corelli			
Elevation	Circle One	A	3801.5 Square Feet
		B	3801.5 Square Feet
Optional Layouts	Circle All that Apply	GFA1	GROUND FLOOR Optional Alternative Layout
		SFA4	SECOND FLOOR Additional Bedroom w/ Ensuite

41.1 The Strauss			
Elevation	Circle One	A	2554.2 Square Feet
		B	2571.2 Square Feet
Optional Layouts	Circle All that Apply	SFA1	SECOND FLOOR Shower in Lieu of Tub B2

41.2 The Mozart			
Elevation	Circle One	A	2725.9 Square Feet
		B	2711.1 Square Feet
Optional Layouts	Circle All that Apply	SFA1	SECOND FLOOR Shower in Lieu of Tub B2

41.3 The Chopin			
Elevation	Circle One	A	2800.0 Square Feet
		B	2810.5 Square Feet
Optional Layouts	Circle All that Apply		

41.4 The Bach			
Elevation	Circle One	A	2894.4 Square Feet
		B	2894.5 Square Feet
Optional Layouts	Circle All that Apply		

41.5 The Brahms			
Elevation	Circle One	A	3948.1 Square Feet
		B	3949.1 Square Feet
Optional Layouts	Circle All that Apply	GFA1	GROUND FLOOR Optional Alternative Layout
		SFA2	SECOND FLOOR Shower in Lieu of Tub B4
		SFA3	SECOND FLOOR Optional Laundry Layout

41.6 The Verdi			
Elevation	Circle One	A	3862.5 Square Feet
		B	3866.4 Square Feet
Optional Layouts	Circle All that Apply	GFA1	GROUND FLOOR Optional Alternative Layout
		SFA3	SECOND FLOOR Optional Laundry Layout

June 21, 16

HB

JB