

Brampton Encore - 113 - 1 - 38-6 Elev.A SCARLATTI OPT- GFA1

CARPET

Inv.915	1 - BED # 2: INSTALL City View Berber Bed 2
Line13078	Note:
19Oct16 / 31Oct16	
Inv.915	1 - BED # 3: INSTALL City View Berber Bed 3
Line13079	Note:
19Oct16 / 31Oct16	
Inv.915	1 - BED # 4: INSTALL City View Berber Bed 4
Line13080	Note:
19Oct16 / 31Oct16	
Inv.915	1 - BED # 5: INSTALL City View Berber Bed 5
Line13081	Note:
19Oct16 / 31Oct16	
Inv.915	1 - MASTER BEDROOM: INSTALL City View Berber Master Bed
Line13082	Note:
19Oct16 / 31Oct16	
Inv.915	1 - REC ROOM: INSTALL City View Berber Rec Room at GF
Line13083	Note:
19Oct16 / 31Oct16	
Inv.915	1 - GROUND FLOOR STAIRS AND LANDING : INSTALL City View Berber Rec Room at GF
Line13084	Note:
19Oct16 / 31Oct16	

CENTRAL VAC AND WIRING

Inv.496	1 - FAMILY ROOM: INSTALL CONDUIT PIPE- FOR TELEVISION- MUST SPECIFY LOCATION AND TERMINATION POINT
Line6016	Note:
12May16 / 20May16	
Inv.496	1 - ATTIC: INSTALL CONDUIT PIPE- FROM ATTIC TO ELECTRICAL PANEL- MUST SPECIFY LOCATION AND TERMINATION POINT
Line6018	Note:
12May16 / 20May16	

ELECTRICAL

Inv.496	1 - TELEPHONE AND CABLE ROUGH-IN LOCATION SKETCH
Line6015	Note:
12May16 / 20May16	
Inv.496	1 - FAMILY ROOM: INSTALL 110V WALL RECEPTACLE ON DEDICATED CIRCUIT ABOVE FIREPLACE SEE SKETCH
Line6017	Note:
12May16 / 20May16	
Inv.496	1 - KITCHEN: INSTALL 220V WALL RECEPTICAL ON DEDICATED CIRCUIT- FOR 4 WIRE BUILT-IN WALL OVEN - SEE SKETCH. FOR FUTURE WALL OVEN/MICROWAVE UNIT. PURCHASER IS AWARE THAT THEY WILL NEED TO PURCHASE APPROPRIATE CABINETRY AT THE TIME OF COLOURS.
Line6019	Note:
12May16 / 20May16	

Brampton Encore - 113 - 1 - 38-6 Elev.A SCARLATTI OPT- GFA1

Inv.496	1 - KITCHEN: INSTALL 110V WALL RECEPTACLE ON DEDICATED CIRCUIT - FOR MICROWAVE - MICROWAVE NOT INCLUDED. SEE SKETCH. FOR FUTURE WALL OVEN/MICROWAVE UNIT. PURCHASER IS AWARE THAT THEY WILL NEED TO PURCHASE APPROPRIATE CABINETRY AT THE TIME OF COLOURS
Line6020	Note:
12May16 / 20May16	
Inv.496	1 - KITCHEN: INSTALL KITCHEN CABINET STRIP VALANCE LIGHTS (UNDER CABINETS) - ROUGH - IN - DOES NOT INCLUDE (AND REQUIRES) KITCHEN UPGRADE PRICING
Line6021	Note:
12May16 / 20May16	
Inv.496	1 - LIVING ROOM: INSTALL ADDITIONAL STANDARD FIXTURE WITH SWITCH - IN LIVING ROOM. SEE SKETCH
Line6022	Note:
12May16 / 20May16	

EXTERIOR COLOURS

Inv.508	1 - EXTERIOR COLOUR PACKAGE 9
Line6143	Note:
20May16 / 20May16	

FRAMING

Inv.496	1 - GROUND FLOOR ENSUITE: INSTALL SHOWER IN LIEU OF TUB- INCLUDES FRAMED GLASS SHOWER ENCLOSURE-
Line6023	Note:
12May16 / 20May16	
Inv.496	1 - OPTIONAL GROUND FLOOR LAYOUT
Line6141	Note: As Per APS
12May16 / 20May16	

GLASS AND MIRROR

Inv.496	1 - GROUND FLOOR ENSUITE: INSTALL SHOWER IN LIEU OF TUB- INCLUDES FRAMED GLASS SHOWER ENCLOSURE
Line6140	Note:
12May16 / 20May16	

GRANITE MARBLE QUARTZ

Inv.915	1 - KITCHEN: INSTALL 2 CM GRP 1 Optional Flush BBar
Line13085	Note:
19Oct16 / 31Oct16	
Inv.915	1 - KITCHEN: INSTALL CONTINUOUS COUNTER TOP FOR 30" COOKTOP
Line13086	Note:
19Oct16 / 31Oct16	

HARDWOOD

Inv.915	1 - DINING ROOM: INSTALL PREVERCO, RED OAK, SOLID FLEX IN CAPPUCCINO Upgrade 2 LEVEL I Dining
Line13072	Note:
19Oct16 / 31Oct16	
Inv.915	1 - FAMILY ROOM: INSTALL PREVERCO, RED OAK, SOLID FLEX IN CAPPUCCINO Upgrade 2 LEVEL I Family
Line13073	Note:
19Oct16 / 31Oct16	

Brampton Encore - 113 - 1 - 38-6 Elev.A SCARLATTI OPT- GFA1

Inv.915	1 - LIVING ROOM: INSTALL PREVERCO, RED OAK, SOLID FLEX IN CAPPUCCINO Upgrade 2 LEVEL I Living
Line13074	Note:
19Oct16 / 31Oct16	
Inv.915	1 - LANDINGS: INSTALL PREVERCO, RED OAK, SOLID FLEX IN CAPPUCCINO Upgrade 2 LEVEL I Landings
Line13075	Note:
19Oct16 / 31Oct16	
Inv.915	1 - BREAKFAST AREA: INSTALL PREVERCO, RED OAK, SOLID FLEX IN CAPPUCCINO Upgrade 2 LEVEL I breakfast area
Line13076	Note:
19Oct16 / 31Oct16	

KITCHEN AND BATH CABINETRY

Inv.915	1 - KITCHEN: INSTALL Spray Stain Kitchen
Line13087	Note:
19Oct16 / 31Oct16	
Inv.915	1 - KITCHEN: INSTALL UPG 1 GRP III Opt Light Valance
Line13088	Note: **PRICE INCLUDES SPRAY STAIN
19Oct16 / 31Oct16	
Inv.915	1 - KITCHEN: INSTALL Oak PVC 112 Built in wall oven and microwave and cooktop with countertop by others 242cm SEE SKETCH
Line13089	Note:
19Oct16 / 31Oct16	
Inv.915	1 - KITCHEN: INSTALL Oak PVC 158 Overlay Gable Pantry 61x220 61x242 FOR PANTRY
Line13090	Note:
19Oct16 / 31Oct16	
Inv.915	1 - KITCHEN: INSTALL Oak PVC 87 Pot and Pan Drawers 2 deep drawers and one shallow top drawer 60 70 80 90 cm wide TO GO UNDER COOKTOP
Line13091	Note:
19Oct16 / 31Oct16	

MISC.

Inv.496	1 - BONUS PACKAGE: \$8441.10 (INCLUDING TAXES) WORTH OF UPGRADES FROM GOLD PARK HOMES DÉCOR CENTRE IS BEING APPLIED TOWARD THE STRUCTURAL APPOINTMENT. PURCHASER HAS A REMAINING AMOUNT OF \$1558.90 (INCLUDING TAXES) TO BE USED TOWARD THE COLOUR APPOINTMENT
Line6027	Note:
12May16 / 20May16	
Inv.496	1 - Purchaser has attended a Structural appointment at the Decor Centre & has DECLINED any additional upgrades and accepts and acknowledges that there will be no further structural changes/additions/deletions to be made upon signing on May 12, 2016
Line6028	Note:
12May16 / 20May16	
Inv.496	1 - Purchasers are aware & accepts that ANY changes made to upgrades after signing this Purchasers Extra Form are subject to a minimum administration fee of \$500. PLUS a 10% holdback fee
Line6029	Note:
12May16 / 20May16	

Brampton Encore - 113 - 1 - 38-6 Elev.A SCARLATTI OPT- GFA1

Inv.915	1 - Purchaser has attended a Colour appointment at the Decor Centre & has DECLINED any additional upgrades and accepts and acknowledges that there will be no further structural changes/additions/deletions to be made upon signing on October 24, 2016
Line13092	Note:
19Oct16 / 31Oct16	
Inv.915	1 - Purchasers are aware & accepts that ANY changes made to upgrades after signing this Purchasers Extra Form are subject to a minimum administration fee of \$500. PLUS a 10% holdback fee
Line13093	Note:
19Oct16 / 31Oct16	
Inv.915	1 - BONUS PACKAGE: \$1558.90 (INCLUDING TAXES) WORTH OF UPGRADES FROM GOLD PARK HOMES DÉCOR CENTRE IS BEING APPLIED TOWARD THE COLOUR APPOINTMENT
Line13094	Note:
19Oct16 / 31Oct16	

PAINTING

Inv.915	1 - Choice of Stain 2 Staircases 3 Storey Model (Euroline Pickets Charged Separately)
Line13077	Note:
19Oct16 / 31Oct16	

PLUMBING

Inv.496	1 - KITCHEN: INSTALL ROUGH-IN - WATERLINE FOR FRIDGE
Line6025	Note:
12May16 / 20May16	
Inv.496	1 - BASEMENT: INSTALL ROUGH-IN - 3PC BASEMENT ROUGH-IN, AS PER PLAN
Line6026	Note:
12May16 / 20May16	
Inv.496	1 - GROUND FLOOR ENSUITE: INSTALL SHOWER IN LIEU OF TUB- INCLUDES FRAMED GLASS SHOWER ENCLOSURE
Line6139	Note:
12May16 / 20May16	

WINDOWS - BASEMENT

Inv.496	2 - BASEMENT: INSTALL TWO (X2) BASEMENT WINDOWS - UPGRADE EXISTING BASEMENT WINDOW TO 30 INCH X 16 INCH
Line6024	Note:
12May16 / 20May16	

WINDOWS AND DOORS

Inv.496	1 - MAN DOOR GARAGE TO HOUSE - OPTIONAL - IF GRADE PERMITS
Line6142	Note: As Per APS Bonus Package
12May16 / 20May16	

Purchasers:
Helen Kolawole & Foluke Kolawole

Property:
113 of Plan -

Telephone Res. / Bus:
(905) 840-7716

Project:
Fieldwalk Investments Inc.

Decor Advisor:
Terri Parisani

Model and Elevation:
38-6 Elev.A SCARLATTI OPT- GFA1

Layout Changes:
☒ Yes
☐ No

Sketch Attached:
☒ Yes
☐ No

Exterior Colour Scheme:

1. Cabinetry

	Style and Colour	Counter	Hardware
Kitchen / Breakfast	*Siena (oak) Raspberry	Grigio Sardo Edge: F-30	cs1-10
Laundry Room	-		
Powder Room	-		
TWIN BATH	Varese(pvc)WhiteCrystal	P-344LM Inukshuk Grey Laminate	cs1-25
Master Ensuite Bathroom	M500(mel)VanillaStix	6696-46 Carrara Bianco Laminate	cs1-23
Second Ensuite Bathroom (If Applicable)	Siena (oak) Ginger	1877K-56 Autumn Carnival Laminate	cs1-22
GROUND FLOOR ENSUITE	Siena (oak) Coco	1877K-56 Autumn Carnival Laminate	cs1-16
Dishwasher Cabinet	N/A		

Comment

2. Floor Tile

	Selection	Grout	Threshold
Entrance Vestibule	Serpentine Beyaz, 13 x 13	N/A	N/A
Main Hall	-	N/A	N/A
Kitchen / Breakfast	Serpentine Beyaz, 13 x 13	N/A	N/A
Laundry Room	Serpentine Beyaz, 13 x 13	N/A	N/A
Powder Room	Serpentine Beyaz, 13 x 13	N/A	N/A
TWIN BATH	New Reeds Brown, 13 x 13	N/A	N/A
Master Ensuite Bathroom	Serpentine Syrak, 13 x 13	N/A	N/A
Second Ensuite Bathroom (If Applicable)	Serpentine Krem, 13 x 13	N/A	N/A
Lower Landing (If Applicable)	-	N/A	N/A
GROUND FLOOR ENSUITE	New Reeds Taupe, 13 x 13	N/A	N/A

Comment

GROUND FLOOR HALL

3. Wall Tile

	Selection	Listello/Inserts	Describe
TWIN BATH	New Reeds Brown 8 x 10	<input type="radio"/> Yes <input checked="" type="radio"/> No	
Master Ensuite Bathroom			
Tub Deck	Serpentine Syrak, 8 x 10	<input type="radio"/> Yes <input checked="" type="radio"/> No	
Shower Stall	Serpentine Syrak, 8 x 10	<input type="radio"/> Yes <input checked="" type="radio"/> No	
Bathroom Walls	Serpentine Syrak, 8 x 10	<input type="radio"/> Yes <input checked="" type="radio"/> No	
Second Ensuite Bathroom (If Applicable)	Serpentine Krem, 8 x 10	<input type="radio"/> Yes <input checked="" type="radio"/> No	
GROUND FLOOR ENSUITE	New Reeds Taupe 8 x 10	<input type="radio"/> Yes <input checked="" type="radio"/> No	

Kitchen Backsplash
☐ Yes ☒ No

Backsplash Behind Fridge
N/A

Comment

Scheduled Closing Date: October-20-16

Purchasers: Helen Kolawole & Foluke Kolawole

Property: 113 of Plan -

Telephone Res. / Bus: (905) 840-7716

Project: Fieldwalk Investments Inc.

Decor Advisor: Terri Parisani

Model and Elevation: 38-6 Elev.A SCARLATTI OPT- GFA1

4. Plumbing Fixtures

<input type="text"/>	Second Ensuite	<input type="text"/>	Powder Room	<input type="text"/>	
Master Ensuite Bathroom	<input type="text"/>	Other Room - Specify	<input type="text"/>	Other Washroom	<input type="text"/>

Comment

ALL FIXTURES TO REMAIN STANDARD THROUGHOUT THE HOUSE

5. Hardwood Flooring

	Type and Stain		Type and Stain
Main Hall	*Upg.1 Preverco RedOak Cappucc	Upper Landing	*Upg.1 Preverco RedOak Cappucc
Kitchen / Breakfast	<input type="text"/>	Upper Hall	<input type="text"/>
Living Room	*Upg.1 Preverco RedOak Cappucc	Master Bedroom	<input type="text"/>
Dining Room	*Upg.1 Preverco RedOak Cappucc	Bedroom #2	<input type="text"/>
Family Room	*Upg.1 Preverco RedOak Cappucc	Bedroom #3	<input type="text"/>
Den/Library	<input type="text"/>	Bedroom #4	<input type="text"/>
Entrance Vestibule	<input type="text"/>	Bedroom #5	<input type="text"/>
Lower Landing (If Applicable)	<input type="text"/>	Other Room - Specify	<input type="text"/>

Comment

6. Carpeting

	Upgrade	Description
Main Hall	<input type="checkbox"/>	<input type="text"/>
Living Room	<input type="checkbox"/>	<input type="text"/>
Dining Room	<input type="checkbox"/>	<input type="text"/>
Family Room	<input type="checkbox"/>	<input type="text"/>
Den/Library	<input type="checkbox"/>	<input type="text"/>
Upper Hall	<input type="checkbox"/>	*Upg. 1 Cityview, #756 Country Twill
Master Bedroom	<input type="checkbox"/>	*Upg. 1 Cityview, #756 Country Twill
Bedroom #2	<input type="checkbox"/>	*Upg. 1 Cityview, #756 Country Twill
Bedroom #3	<input type="checkbox"/>	*Upg. 1 Cityview, #756 Country Twill
Bedroom #4	<input type="checkbox"/>	*Upg. 1 Cityview, #756 Country Twill
Bedroom #5	<input type="checkbox"/>	*Upg. 1 Cityview, #756 Country Twill
REC ROOM	<input type="checkbox"/>	*Upg. 1 Cityview, #756 Country Twill
Upper Landing (If Applicable)	<input type="checkbox"/>	<input type="text"/>
Lower Landing (If Applicable)	<input type="checkbox"/>	*Upg. 1 Cityview, #756 Country Twill

Upgrade Underpad	Type STANDARD	Area N/A
Carpet on Stairs	Capped *Upg. 1 Cityview, #756 Country Twill	Runner - *Upgrade NONE

Comment

Scheduled Closing Date: October-20-16

Purchasers: Helen Kolawole & Foluke Kolawole

Property: 113 of Plan -

Telephone Res. / Bus: (905) 840-7716

Project: Fieldwalk Investments Inc.

Decor Advisor: Terri Parisani

Model and Elevation: 38-6 Elev.A SCARLATTI OPT- GFA1

7. Fireplace

	Living Room			Family Room			Other Room - Specify		
	Purchased	As Per Plan	N/A	Purchased	As Per Plan	N/A	Purchased	As Per Plan	N/A
Fireplace Type	<input type="radio"/>	<input type="radio"/>	<input checked="" type="radio"/>	<input type="radio"/>	<input checked="" type="radio"/>	<input type="radio"/>	<input type="radio"/>	<input type="radio"/>	<input checked="" type="radio"/>
Mantle Type				STANDARD					
Colour / Stain				NF-20					
Surround				WHITE PAINT-GRADE					
Hearth				NERO MARQUINA					

Comment

8. Trim Carpentry

Interior Doors	STANDARD	Front Door Glass Inserts	STANDARD	Door Handles	STANDARD
Interior Trim	STANDARD				

Comment

9. Plaster Mouldings and Medallions

Entrance Vestibule	N/A		Kitchen/Breakfast	N/A	
Main Hall	N/A		Den/Library	N/A	
Living Room	N/A		Lower Landing	N/A	
Dining Room	N/A		Other Room - Specify		
Family Room	N/A				

Comment

10. Railings and Spindles

Railing Package	STANDARD		
Railing Colour	*CAPPUCCINO RED OAK	Spindle Colour	*CAPPUCCINO RED OAK
Stringer / Riser	*CAPPUCCINO RED OAK	Treads	*CAPPUCCINO RED OAK

Comment

GROUND FLOOR STAIRS CARPETED

11. Wall Paint

Main & Upper Hall	WARM GREY	Master Bedroom	WARM GREY
Living Room	WARM GREY	Bedroom #2	WARM GREY
Dining Room	WARM GREY	Bedroom #3	WARM GREY
Kitchen / Breakfast	WARM GREY	Bedroom #4	WARM GREY
Family Room	WARM GREY	Bedroom #5	WARM GREY
Powder Room	WARM GREY	Master Ensuite	WARM GREY
Laundry Room	WARM GREY	TWIN BATH	WARM GREY
Den/Library	WARM GREY	Second Ensuite	WARM GREY
Trim Paint	WHITE	GROUND FLOOR	WARM GREY

Comment

Smooth Ceilings First Floor

Scheduled Closing Date: October-20-16

Purchasers: Helen Kolawole & Foluke Kolawole

Property: 113 of Plan -

Telephone Res. / Bus: (905) 840-7716

Project: Fieldwalk Investments Inc.

Decor Advisor: Terri Parisani

Model and Elevation: 38-6 Elev.A SCARLATTI OPT- GFA1

12. Electrical

Plugs and Switches ☒ White ☐ Ivory

Hood Fan ☐ White ☐ Ivory

Appliances Built in Cooktop

☒ Yes ☐ No

Built in Oven

☒ Yes ☐ No

Above Kitchen Cabinet Light ☐ Yes ☒ No

Below Kitchen Cabinet Light ☒ Yes ☐ No

Gas Stove

☐ Yes ☒ No

Microwave

☒ Yes ☐ No

Comment

13. Heating and Air Conditioning

Air Conditioning

Gas Provisions Dryer

Gas Provisions Stove

Gas Provisions Barbecue

Comment

GAS LINE FOR BBQ IS STANDARD

14. Additional Comments

15. Disclaimers and Notes

- 1) Colours of all materials are as close as possible to builder's selection, but not necessarily identical due to variances in manufacturing.
- 2) Any extras listed above are null and void unless accompanied by a separate invoice/amendment. Said invoice must be paid in full.
- 3) The Purchaser acknowledges that after Interior Colour Selection form is signed and dated, no further changes will be permitted other than re-selection due to unavailability. _____ Purchaser's Initials
- 4) The Purchaser acknowledges reading and accepting the "Gold Park Homes Decor Centre Disclaimers" form. This document contains other miscellaneous disclaimers.

This Interior Colour Selection is final and approved by:

Signature: _____

Date: 10/24/16

Signature: _____

Date: _____

Telephone 416-291-1111
Website 416-291-1111
Email info@encorehomes.com

The
Scarlatti
38' SERIES

Elevation A • 3,591 sq.ft. | Elevation B • 3,578 sq.ft.

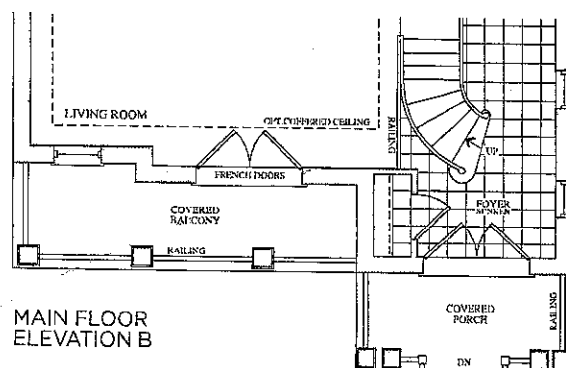
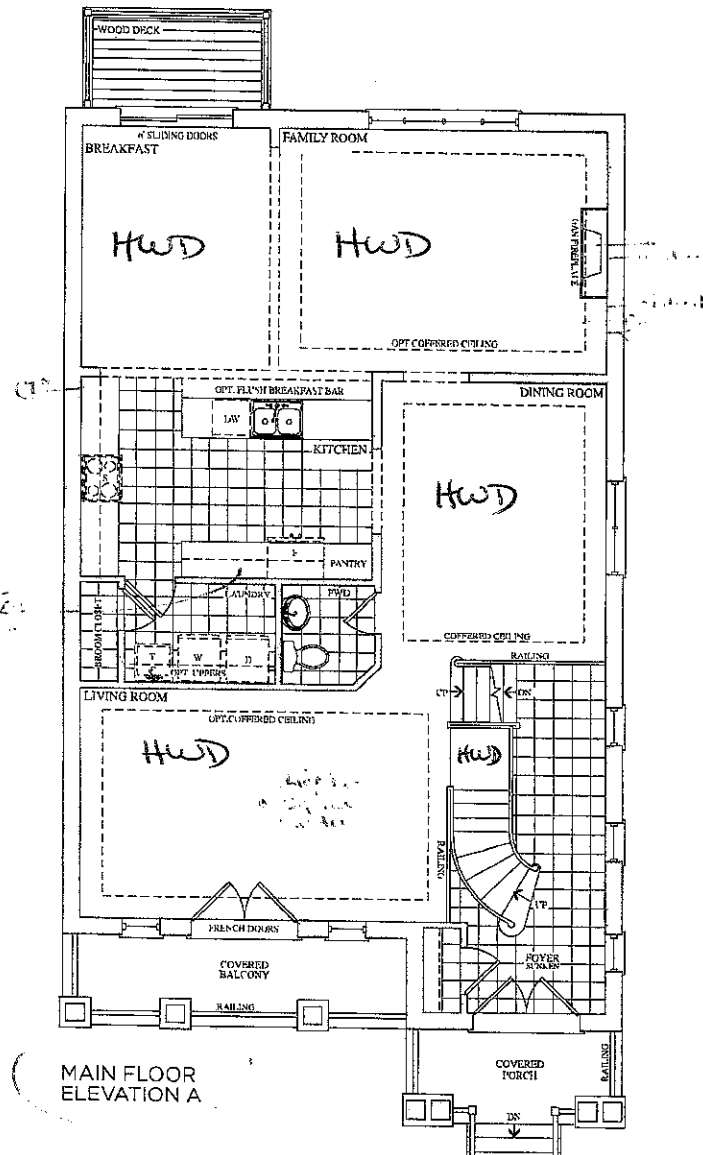

Prices, figures, illustrations, sizes, features and finishes are subject to change without notice. L.S.O.L. Areas and dimensions are approximate and actual usable floor space may vary from the stated area. Layout may be reverse of the unit pictured. E & O.E.

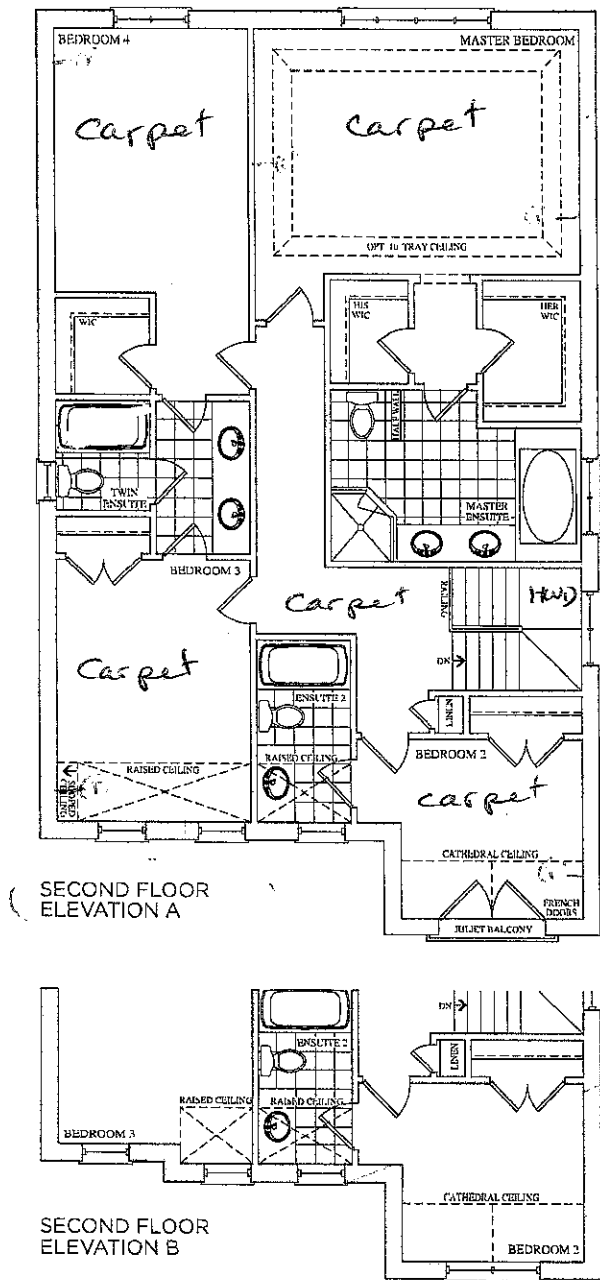

Lot 113
Oct. 24, 16
[Signature]

Lot 113
2/24/16
[Signature]

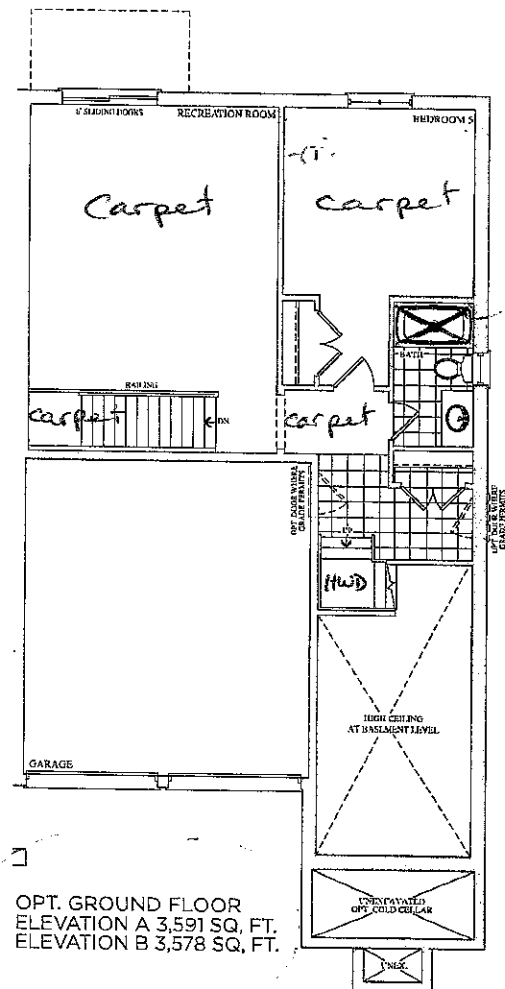
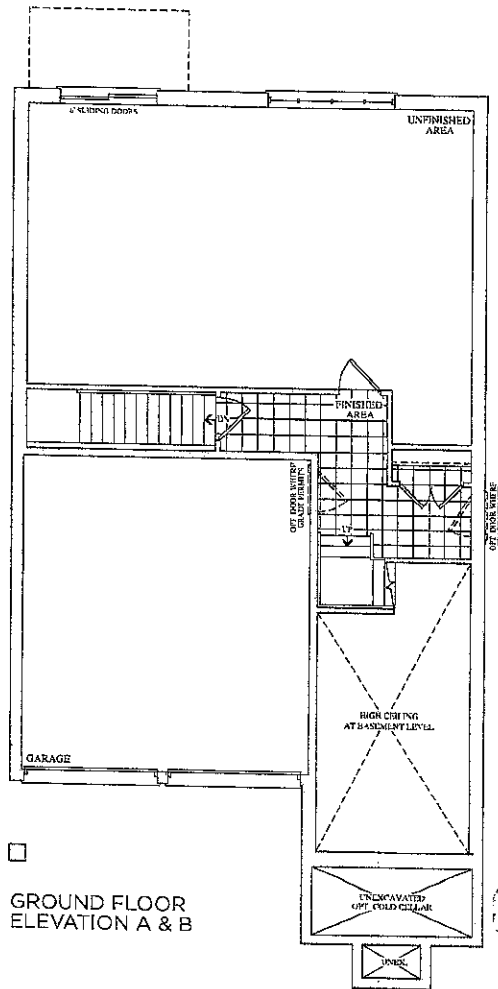

Lot 113
Oct. 24, 16
C

Lot 113
Oct. 24, 16
C

13.000000000000000

2A 30" x 11.1"

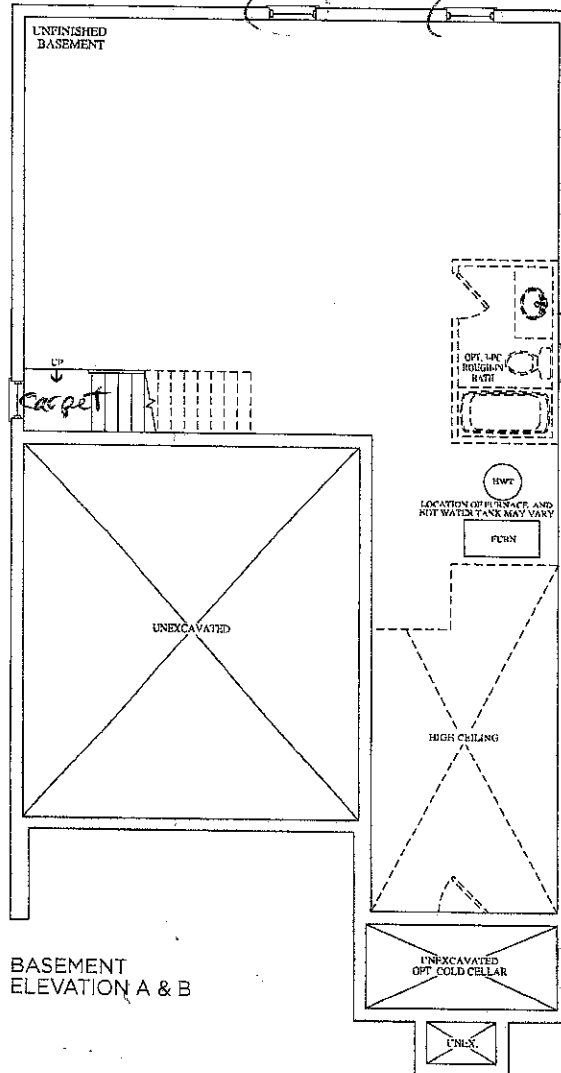

BASEMENT
ELEVATION A & B

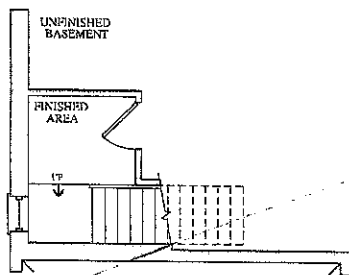

OPT. BASEMENT
ELEVATION A & B

Lot 113
10/24/16
30' 0"

Lot 113
Oct. 24, 16



This layout has been explained to the purchaser by Cortina Kitchens Inc. and is understood by the purchaser.

ITEM A. Wood grain and colour are characteristics of the product, we cannot guarantee that such grain and colour will always match
ITEM B. Cortina Kitchens reserves the right to alter dimensions and make technical changes without notice.

- Light Balance

Lot 113
Oct. 24, 16



STANDARD HARDWARE

Lot 113 Oct. 24, 16

STANDARD HARDWARE

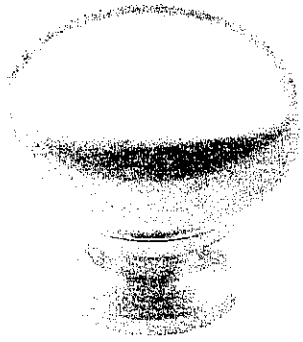

CSI-6

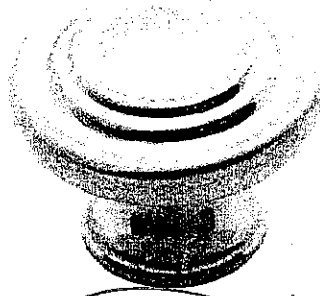

CSI-10

Kitchen



CSI-14



CSI-16

Ground Floor Bath

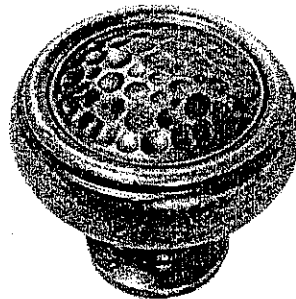

CSI-18

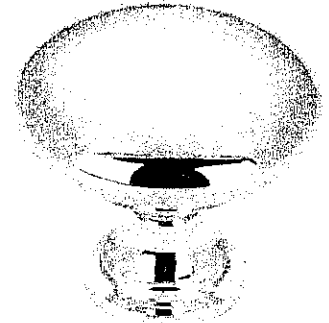

CSI-19

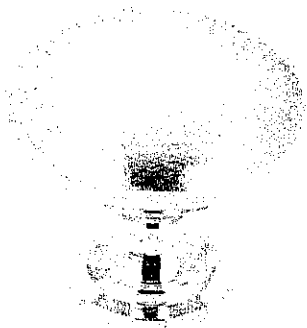

CSI-20

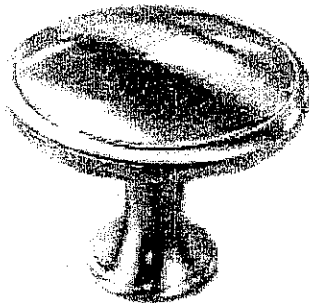

CSI-21

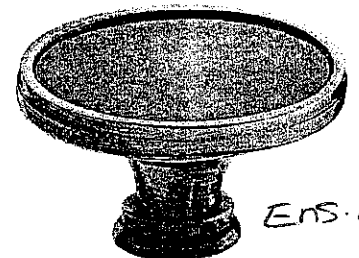

CSI-22

Ens. 2



CSI-23

Master

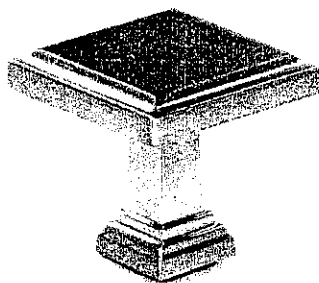

CSI-24

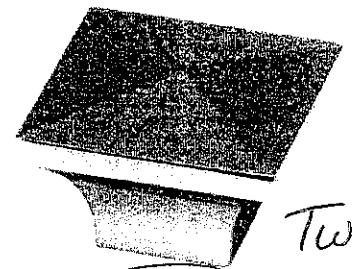

CSI-25

Twin

*NOTES:

- IMAGES ARE FOR QUICK REFERENCE PURPOSES ONLY
- ACTUAL SIZES AND FINISHES AS PER HARDWARE SAMPLE BOARD PROVIDED TO DECOR CENTRE

CORTINA

KITCHENS INC.

20 Regina Road Woodbridge ON L4L 8L6
905-264-6464

DARK STAIN INFORMATION

Builder Gold Park Homes... Project Encore..... Lot # 113.....

Cortina Kitchens offers a wide variety of finishes, applied to oak and maple products. The subject finishes include the spray stains **Cocoa**, **Espresso**, **Graphite** as well as wiping stain **Ebony**.

Due to the very dark stains applied on natural maple and oak doors and joints, several characteristics are important to be noted when purchasing these products.

1. Shadow lines may be visible at the interior profile edges of a door or drawer front. If movement occurs shadow lines may increase or decrease, depending on the style and/or size of a door or drawer front.
2. Variation and unevenness may be visible in the finish.
3. Hairline cracks at the joints are created over time due to the nature of natural wood, caused by usage, humidity, or dryness. They tend to be more visible to darker stains, than lighter wood stains.

Please be advised that Cortina Kitchens will not replace doors nor parts that exhibit the above characteristics associated with this finish. These characteristics are not avoidable and are a result of the natural characteristics of wood and wood veneer, and the characteristics of darker stains on wood.

Thank you for your understanding.

I am well informed of this information, and agree to the purchase of any of the subject finishes listed above.

Purchaser: _____

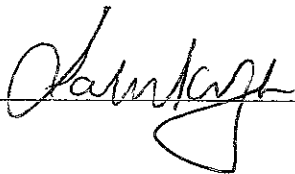

Date: _____

Oct 24th / 16

Lot 113
Oct. 24, 16

20mm (3/4") Profiles

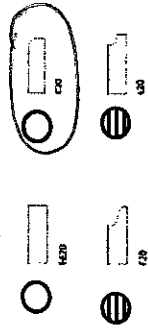

Standard & Upgrade Profiles
Offered with a 2 cm Surface

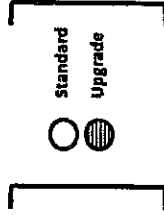

30mm (1 1/4") Profiles

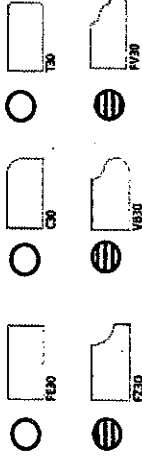

Standard
Upgrade

Standard & Upgrade Profiles
Offered with a 3 cm Surface

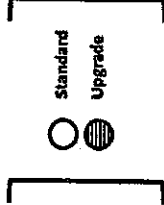

40mm (1 1/2") Profiles

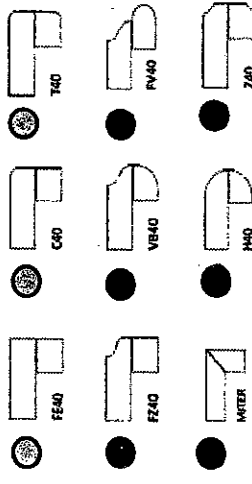

Upgrade 1
Upgrade 2

4 mm Upgrade 1 & 2 Profiles
Offered with a 2 cm Surface

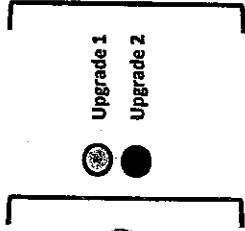

Note: All colours may not be available in 30mm at time ordered.
Vendor reserves the right to use 40mm edges (by lamination process).

Lot 113



27" (68.6 cm) and 30" (76.2 cm) ELECTRIC BUILT-IN MICROWAVE/OVEN COMBINATION

* Proud Installation

PRODUCT MODEL SERIES

WOC54EC0A WOC54EC7A WOC95EC0A

ELECTRICAL CONNECTION

If codes permit and a separate ground wire is used, it is recommended that a qualified electrical installer determine that the ground path and the wire gauge are in accordance with local codes.

Check with a qualified electrical installer if you are not sure the oven is properly grounded.

This oven must be connected to a grounded metal, permanent wiring system.

Be sure that the electrical connection and wire size are adequate and in conformance with the National Electrical Code, ANSI/NFPA 70-latest edition or CSA Standards C22.1-94, Canadian Electrical Code, Part 1 and C22.2 No. 0-M91-latest edition, and all local codes and ordinances.

To properly install your oven, you must determine the type of electrical connection you will be using and follow the instructions provided for it here.

- Oven must be connected to the proper electrical voltage and frequency as specified on the model/serial number rating plate. The model/serial number rating plate is located near center vent of the lower oven. See the following illustration.

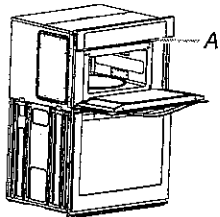

A. Model/serial number plate

- Models rated from 7.3 to 9.6 kW at 240 volts (5.4 to 7.4 kW at 208 volts) require a separate 40-amp circuit. Models rated at 4.8 kW and below at 240 volts (3.6 kW and below at 208 volts) require a separate 20-amp circuit.
- A circuit breaker is recommended.
- Connect directly to the fused disconnect (or circuit breaker box) through flexible, armored or nonmetallic sheathed, copper cable (with grounding wire). See "Make Electrical Connection" section.
- Flexible conduit from the oven should be connected directly to the junction box.
- Do not cut the conduit. The length of conduit provided is for serviceability of the oven.
- A UL listed or CSA approved conduit connector must be provided.
- If the house has aluminum wiring, follow the procedure below:
 1. Connect a section of solid copper wire to the pigtail leads.
 2. Connect the aluminum wiring to the added section of copper wire using special connectors and/or tools designed and UL listed for joining copper to aluminum.

Follow the electrical connector manufacturer's recommended procedure. Aluminum/copper connection must conform with local codes and industry accepted wiring practices.

For power requirements for models WOC54EC7A, WOC54EC0A, WOC95EC0A and MMW9730A, refer to the following table.

Voltage	Microwave Oven and Microwave Oven with Single Thermal Oven	Microwave Oven and Microwave Oven with Single Convection Oven
240 VAC	5490 W	5520 W
208 VAC	4590 W	4620 W
240 VAC	30.4 A	30.5 A
208 VAC	28.4 A	28.6 A

PRODUCT DIMENSIONS

Product Dimensions

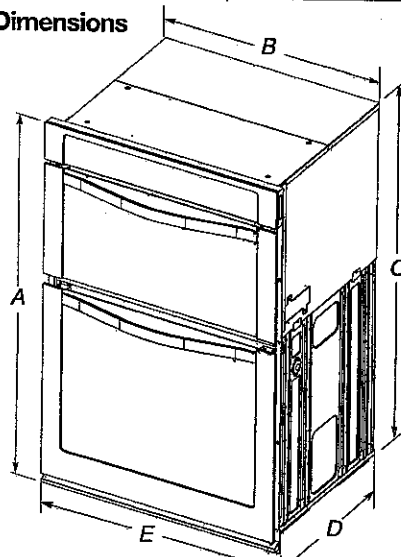

27" (68.6 cm) models

- A. 42 $\frac{3}{4}$ " (108.0 cm) overall height
- B. 25 $\frac{7}{8}$ " (64.6 cm) recessed width
- C. 41" (104.1 cm) recessed height
- D. 23 $\frac{1}{4}$ " (59.1 cm) max. recessed depth
- E. 27" (68.6 cm) overall width

30" (76.2 cm) models

- A. 42 $\frac{3}{4}$ " (108.0 cm) overall height
- B. 28 $\frac{1}{2}$ " (72.3 cm) recessed width
- C. 41" (104.1 cm) recessed height
- D. 23 $\frac{1}{4}$ " (59.1 cm) max. recessed depth
- E. 30" (76.2 cm) overall width

Cabinet Dimensions

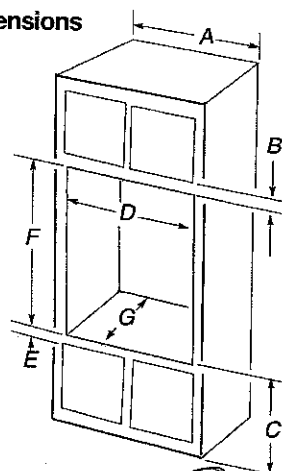

27" (68.6 cm) models

- A. 27" (68.6 cm) min. cabinet width
- B. 1" (2.5 cm) top of cutout to bottom of upper cabinet door
- C. 19 $\frac{1}{4}$ " (48.9 cm) bottom of cutout to floor is recommended. 4"-19 $\frac{1}{4}$ " (10.2-48.9 cm) bottom of cutout to floor is acceptable.
- D. 25 $\frac{1}{2}$ " (64.8 cm) cutout width
- E. 1 $\frac{1}{2}$ " (3.8 cm) min. bottom of cutout to top of cabinet door
- F. 41 $\frac{3}{8}$ " (105 cm)* recommended cutout height
- G. 24" (60.7 cm) cutout depth

30" (76.2 cm) models

- A. 30" (76.2 cm) min. cabinet width
- B. 1" (2.5 cm) top of cutout to bottom of upper cabinet door
- C. 19 $\frac{1}{4}$ " (48.9 cm) bottom of cutout to floor is recommended. 4"-19 $\frac{1}{4}$ " (10.2-48.9 cm) bottom of cutout to floor is acceptable.
- D. 28 $\frac{1}{2}$ " (72.4 cm) cutout width
- E. 1 $\frac{1}{2}$ " (3.8 cm) min. bottom of cutout to top of cabinet door
- F. 41 $\frac{3}{8}$ " (105 cm)* recommended cutout height
- G. 24" (60.7 cm) cutout depth

*NOTE: The cabinet height can be between 41" (104.1 cm) and 41 $\frac{1}{2}$ " (105.6 cm) for microwave/oven combination.

Because Whirlpool Corporation policy includes a continuous commitment to improve our products, we reserve the right to change materials and specifications without notice.

Dimensions are for planning purposes only. For complete details, see Installation instructions packed with product. Specifications subject to change without notice.

Ref. W10351241
6/26/12

COOKING

LCE3010
LCE3610

30" & 36" Radiant Cooktops

HIGHLIGHTS

Style and Design
SmoothTouch™ Controls
Steady Heat Technology

COOKING PERFORMANCE

- LCE3010 – 30" Cooktop
LCE3610 – 36" Cooktop
- Steady Heat Elements
- Triple 12"/9"/6", Double 9"/6",
Double 8"/5" (LCE3610)
- Double RF – 9"/6" (LCE3010)

STYLE AND DESIGN

- Smooth Cooktop Surface

CONVENIENCE

- SmoothTouch™ Controls



30"

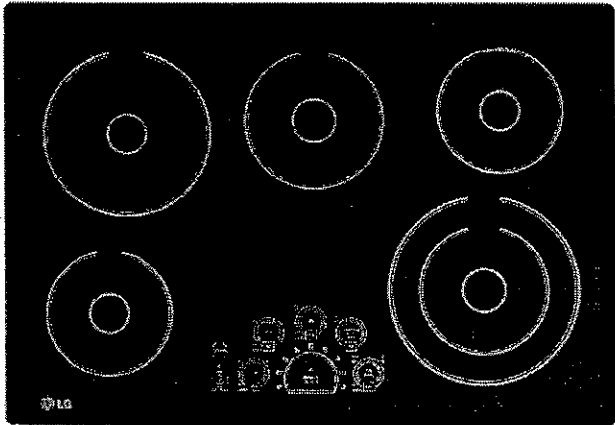

36"

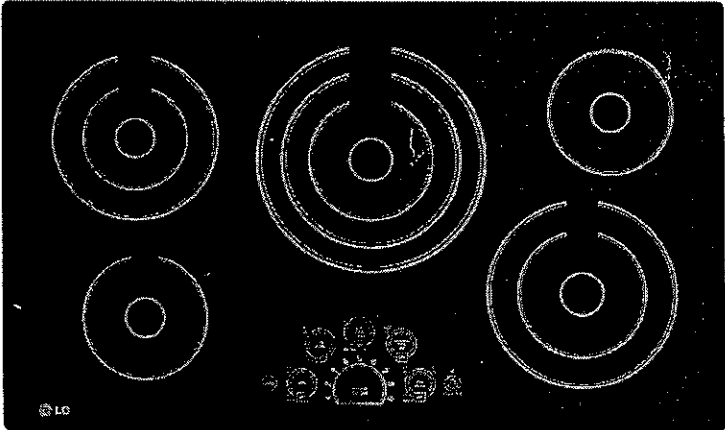

SIMPLY RADIANT

Cooking performance meets modern design in this LG radiant cooktop. Steady Heat cooking elements deliver constant heat at any temperature for more precise heat control, and provide a quick response to every temperature adjustment. SmoothTouch™ controls allow you to adjust the settings with the touch of a finger.

Style and Design
LG's premium 30" & 36" radiant cooktops offers the perfect harmony between style and convenience.

SmoothTouch™ Controls
Easy to use with just a touch. At a quick glance of the centralized electronic controls users can see which heating element is activated and the smooth surface easily wipes clean.

Steady Heat Technology
Steady Heat cooking elements deliver constant heat at any temperature for more precise control and responds quickly to power setting adjustments.

COOKING

LCE3010
LCE3610



TYPE	
Type	Electric
Cooking Surface	Radiant Glass Surface
Size (LCE3010)	30"
Size (LCE3610)	36"
Number of Elements	5
CONFIGURATION – LCE3010	
Element Configuration	9", 6" / 3.0, 1.4kW (Dual) 6" / 0.1kW (Warm)
	8" / 1.9kW 6" / 1.2kW 7" / 1.5kW
CONFIGURATION – LCE3610	
Element Configuration	12", 9", 6" / 3.0, 2.2, 1.1kW (Triple) 9", 6" / 3.0, 1.4kW (Dual) 8", 5" / 1.9, 1.0kW 6" / 1.2kW 6" / 0.1kW (Warm)
CONTROLS	
Type	Electronic Touch
Location	Front Center
Safety/In-Use Indication	5 Hot Surface Indicator Lights
FEATURES	
Hot Surface Indicator	•
Warm Function	•
Auto Shut-Off	•
Bridge Elements (LCE3610 only)	•
Under Bench Oven	•
Control Panel	SmoothTouch™
Power Control Elements	Steady Heat Ceramic Glass

POWER SOURCE – LCE3010	
Electric Supply	240V/208V, 60Hz AC
Max. Amp Load	240V 40 Amp 208V 30 Amp
Power Cable Location	Right Rear
Total Connected Load	7.7kW @ 240V 5.8kW @ 208V
Power Source	Electric
POWER SOURCE – LCE3610	
Electric Supply	240V/208V, 60Hz AC
Max. Amp Load	240V 50 Amp 208V 40 Amp
Power Cable Location	Right Rear
Total Connected Load	10.5kW @ 240V 7.9kW @ 208V
Power Source	Electric
SAFETY FEATURES	
Child Lock	•
DIMENSIONS – LCE3010	
Width	30 27/32"
Height	4"
Depth	21 1/2"
DIMENSIONS – LCE3610	
Width	36 11/16"
Height	4"
Depth	22"
WARRANTY	
	1 Year Parts & Labor
UPC CODE	
LCE3010	30" Radiant Cooktop 048231 317115
LCE3610	36" Radiant Cooktop 048231 317122

www.LG.com

LG Electronics U.S.A., Inc.
1000 Sylvan Avenue Englewood Cliffs, NJ 07632
Customer Service and Technical Support: (800) 243-0000

Dimensions and weights are approximate. Design, features and specifications subject to change without notice.

© 2010 LG Electronics USA, Inc. All rights reserved. "LG Life's Good" is a registered trademark of LG Corp. All other product and brand names are trademarks or registered trademarks of their respective companies.

HACC-LCE3010/3610-SS 1/21/10

LDS5774ST

LEAVE NO DISH UNWASHED.

Now you can handle anything your dishes serve up. Our EasyRack™ Plus with Height Adjustable 3rd Rack features convenient innovations like adjustable tines, flip-up stemware racks and a unique utensil basket. Plus, it's equipped with our LoDecibel operation for a quiet clean. Your dirty dishes can run, but they sure can't hide.

SPECIFICATIONS

- 15 Place Settings
- 7 Cycles
- Stainless Steel Tub
- 3-Stage Filtration System
- BPA-Free Nylon Coated Tines
- ENERGY STAR Qualified

STYLISH DESIGN

- Semi-Integrated Controls with Time Remaining LED Display

INNOVATIONS

- EasyRack™ Plus with Fully Adjustable Color-coded Tines
- Height Adjustable 3rd Rack
- One-touch Height Adjustable Upper Rack
- 44 dB LoDecibel™ Quiet Operation
- Slim DirectDrive Motor
- Safety Water Overflow Detector
- 19-Hour Delay Start
- LoDecibel™ Quiet Operation
- SenseClean™ Wash System
- Variable Spray Intensities
- Dual Control Cycle
- NSF-Certified Sanitary Rinse
- Hybrid Condensing Drying System

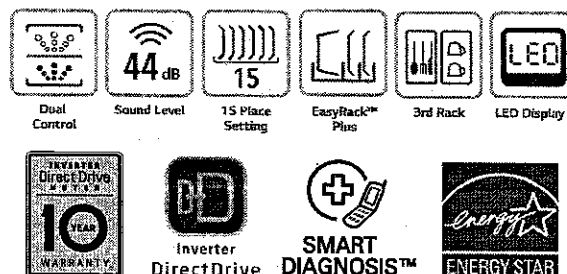
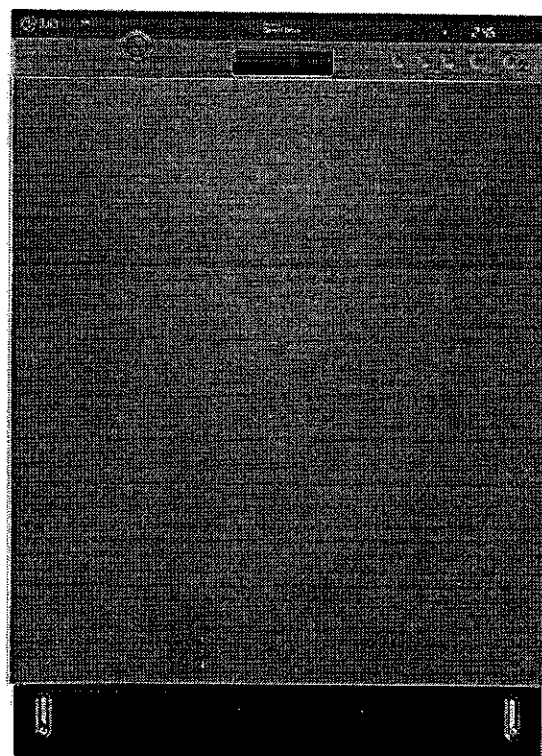

EasyRack™ Plus w/ Height Adjustable 3rd Rack

The newly-enhanced EasyRack™ Plus system provides outstanding flexibility and convenience, adjusting to just about any load of dishes to ensure optimal cleaning performance. Easy to adjust on-the-fly, this racking system can shift to handle any challenge your dishes can serve up.

The Height Adjustable 3rd Rack gives you more space to fit everything from long flatware to small espresso cups.

10-Year Limited Warranty on Inverter Direct Drive Motor

When you buy a dishwasher, you want something reliable that you can count on. Because the Direct Drive Motor uses fewer moving parts and operates more efficiently, LG confidently backs the motor with a 10-year limited warranty.

LoDecibel™ Operation

LG's technological advances, like the Inverter Direct Drive motor and the advanced 3-stage filtration system, were designed with quiet in mind. At 44dB, this dishwasher is among the quietest dishwashers in its class.

LDS5774ST



CAPACITY

Total Place Settings	15
Upper Rack Dish Height Limit	12"
Lower Rack Dish Height Limit	14"

RACKS AND BASKETS

Cutlery Baskets	3-in-1 Detachable Baskets
Sterware Holders	
Racks and Tines	Nylon Coated with Rounded Tips
Height Adjustable 3rd Rack	
EasyRack™ Plus System	
Upper Rack Color-Coded Foldable Tines	
Lower Rack Color-Coded Foldable Tines	
Height Adjustable Upper Rack	

STYLE AND DESIGN

Electronic Controls	Semi-Integrated Controls with LED Display
Time Remaining Indicator	
Rinse-Aid Indicator	
Tub Material	Stainless Steel
Available Colors	Stainless Steel (ST)

FEATURES

LoDecibel™ Quiet Operation	
Slim Direct Drive Motor	
Overflow Detector	
120°F Inlet Water Capability	
3-Stage Filtration System	
Delay Start	Up To 19 Hours
Child Lock	

PERFORMANCE

Number of Wash Cycles	7
Wash Cycles	Auto, Heavy, Delicate, Dual Control, Normal, Quick & Dry, Rinse Only
SenseClean™ Wash System	
Dual Spray Intensity Feature	
Variable Spray Intensities	Strong/Medium/Soft
Sanitary Rinse Option	
Extra Rinse Option	
Multi-Level Water Direction	5
Hybrid Condensing Drying System	
Noise Level	44 dB

POWER SOURCE/RATING

Ratings/Requirements/Type	UL Listed/120 V, 12 Amps/60 Hz
Circuit Breaker Size	15 Amps
Energy Star	

DIMENSIONS

Unit Dimensions (WxHxD)	23 3/4" x 33 1/2" x 24 5/8"
Required Clearances (WxHxD)	24" x 33 1/2" x 24"
Carton Dimensions (WxHxD)	27 1/5" x 35 1/10" x 29 3/5"
Weight (Unit/Carton)	94.9 lbs / 105.6 lbs

LIMITED WARRANTY

	1 Year Labor, 2 Year Parts,
	5 Years on Control Board and Rack Parts, 10 Years Direct Drive Motor,
	Lifetime on the Stainless Steel Tub and Door Liner

UPC CODES

LDS5774ST (Stainless Steel)	048231 014410
-----------------------------	---------------

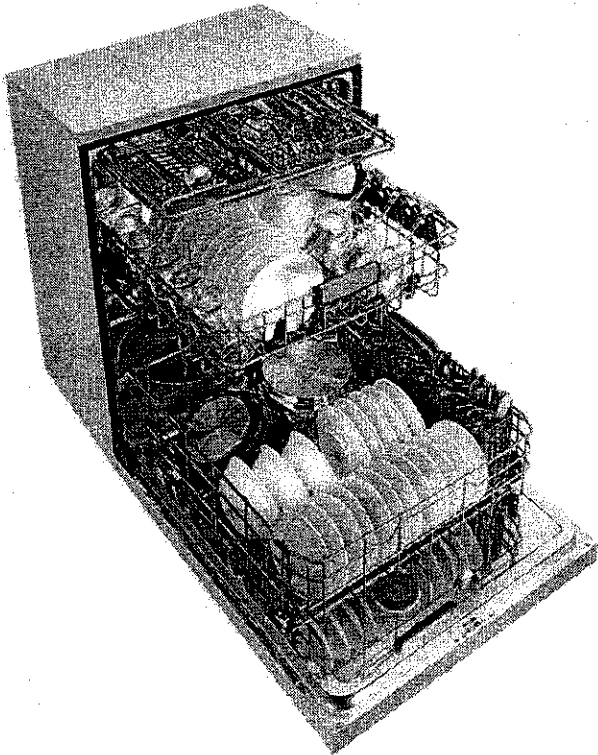
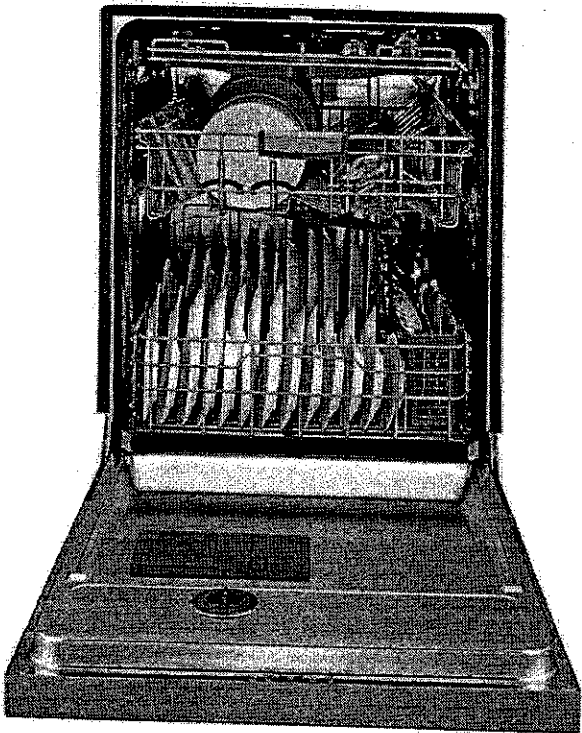

LG Electronics U.S.A., Inc.
1000 Sylvan Avenue Englewood Cliffs, NJ 07632
Customer Service and Technical Support: (800) 243-0000
LG.com

Design, features and specifications are subject to change without notice. Non-metric weights and measurements are approximate.
© 2014 LG Electronics USA, Inc. All rights reserved. "LG Life's Good" is a registered trademark of LG Corp. All other product and brand names are trademarks or registered trademarks of their respective companies. 5/14/14

LFXS27566S

Ultra-Capacity 3 Door French Door Refrigerator w/ Door-in-Door™

Lot 113

GREAT ELEGANCE, SIZE, AND CONVENIENCE.

If you've ever wished you had more space to get more organized, your wish has been granted. With 27 cubic feet, you get that extra space. From post-workout protein shakes to after-school snacks, LG's Door-in-Door™ design keeps all your favorites at your fingertips while reducing cold air loss to help keep foods fresher longer and conserve on precious energy—all with the push of a button. You also get extras like Smart Cooling technology, designed to help keep all that extra food fresher, longer. Plus, our own Slim SpacePlus® Ice System, which frees up even more room in the door. And with French-doors it's real easy getting food in or out of this refrigerator.

STYLE AND DESIGN

- 27 cu.ft.
- **Door-in-Door™**
- ColdSaver™ Panel
- Slim SpacePlus® Ice System
- Premium Finish in Stainless Steel
- Contoured Doors with Matching Commercial Handles
- SmartPull™ Freezer Handle
- Hidden Hinges
- Premium LED Interior Light

ORGANIZATION

- 3 SpillProtector™ Tempered Glass Shelves/1 Folding Shelf
- Full Width, Temperature-Controlled Glide N' Serve™ Drawer
- 2 Humidity Crispers
- 9 Door Bins (Including Door-in-Door™)
- DuraBase™ Solid Drawer Base

PERFORMANCE

- Smart Cooling System
- Linear Compressor
- 10 Year Limited Manufacturer's Warranty on Linear Compressor
- Multi-Air Flow
- Fresh Air Filter
- Electronic Temperature Controls
- Tall Ice & Water Dispenser
- Premium Water Filtration System
- IcePlus™ Accelerated Freezing Function
- ENERGY STAR® Qualified
- Door Alarm
- LoDecibel™ Quiet Operation

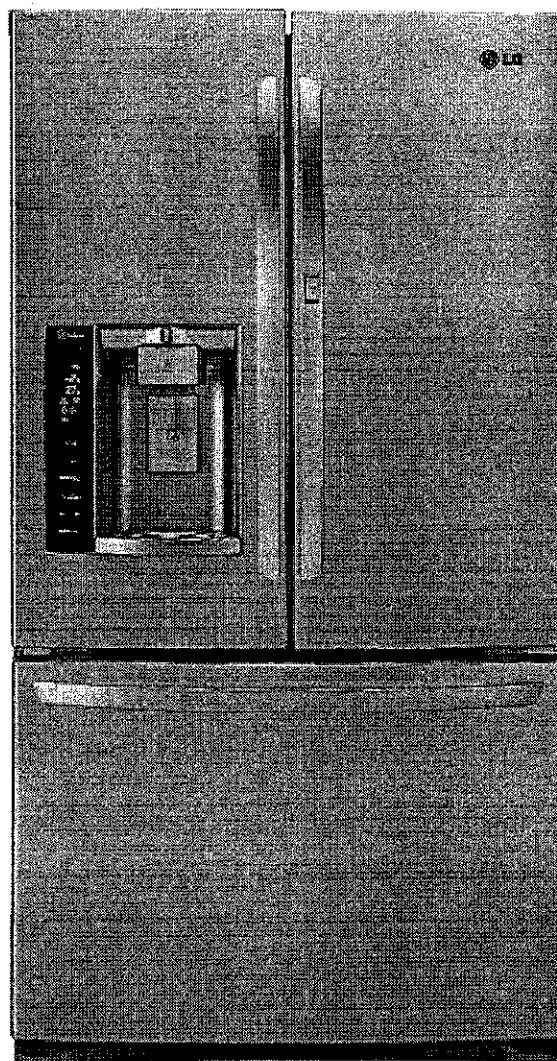

 **Door-in-Door**



KEY FEATURES

Door-in-Door™

For those fly-by visits to the refrigerator, the Door-in-Door™ feature allows you quickly get in and out for easy access to beverages and snacks. Because food can be accessed without opening the entire refrigerator, it reduces cold air loss by up to 47%* to help keep food fresher longer, while conserving precious energy.

Ultra Capacity

Stock-up and store everything you need. With a cavernous 27 cubic feet of space, this LG French Door refrigerator gives you ample space for all of your family's favorite foods and keeps them conveniently organized and within reach.

Slim SpacePlus® Ice System

Ice makers are great, but not if it means you can't fit all of your food in the fridge. The Slim SpacePlus® Ice System provides maximum shelf space** and allows even more space for door bins.

*Percent reduction in exchange rate of air between opening the Door-in-Door™ compared to one French Door for 10 seconds.

**Standard width french door refrigerator, excludes other LG manufactured products.

LFXS27566S

Ultra-Capacity 3 Door French Door Refrigerator w/ Door-in-Door™

CAPACITY

Refrigerator	17.7 cu. ft.
Freezer	8.9 cu. ft.
Total	26.6 cu. ft.

FEATURES

Door-in-Door™ with ColdSaver™ Panel	
ENERGY STAR® Qualified	
Ice & Water Dispenser	
Dispenser Type	Integrated Tall Dispenser
Ice System	Slim SpacePlus®
Daily Ice Production	3.5 lbs/3.8 IcePlus
Ice Storage Capacity	2.8 lbs
Water Filtration System	Compact Filter LT700P
Smart Cooling System	
Dispenser Light	
Multi Air Flow Cooling	
Fresh Air Filter	
Temperature Sensors	6
Linear Compressor	
Display Type	Membrane / White LED
Temperature Controls	Electronic/Digital
Door Alarm	
Child Lock	
LoDecibel™ Quiet Operation	
Auto Closing Door Hinge	
ADA Compliant	

REFRIGERATOR

No. of Shelves	4 Split (3 Fixed / 1 Folding)
Folding Shelf	1
Cantilevered Shelves	
Shelf Construction	SpillProtector™ Tempered Glass
Crisper Bins	2 Humidity Crispers
Glide N' Serve™ Drawer	
Refrigerator Light	Premium LED

REFRIGERATOR DOOR

No. of Shelves/Bin	9 (Including Door-in-Door™)
Door Bin Construction	Clear Bins with Deco
Dairy Corner	

FREEZER

Door Type	Pull Drawer
Drawers	2
DuraBase™ Solid Drawer Base	
Drawer Divider	
Ice Bin	
Freezer Light	Premium LED
Handle	SmartPull™ Handle

MATERIALS AND FINISHES

Contour Door	
Hidden Hinges	
Toe Grille	
Surface	Coated Metal, Stainless Steel
Back	Flush & Metal cover over mechanical parts
Available Colors	Stainless Steel (S)
Handles	Matching Commercial Handles

DIMENSIONS/CLEARANCES/WEIGHT

Depth with Handles	35 3/8"
Depth without Handles	32 7/8"
Depth without Door	29"
Depth (Total with Door Open)	47 5/8"
Height to Top of Case	68 3/8"
Height to Top of Door Hinge	69 3/4"
Width	35 3/4"
Width (Door Open 90° with Handle)	44 1/4"
Width (Door Open 90° without Handle)	39 1/4"
Door Edge Clearance with Handle	4 1/2"
Door Edge Clearance without Handle	1 3/4"
Installation Clearance	Sides 1/8", Top 1", Back 1"
Weight (Unit/Carion)	357 lbs./382 lbs.
Carton Dimensions (WxHxD)	38" x 73" x 38"

WARRANTY

	1 Year Parts and Labor, 7 Years on the Sealed System, 10 Years on Linear Compressor
--	---

UPC CODES

LFXS27566S Stainless Steel	048231 786485
----------------------------	---------------

LG Electronics U.S.A., Inc.

1000 Sylvan Avenue Englewood Cliffs, NJ 07632

Customer Service and Technical Support: (800) 243-0000

LG.com

Design, features and specifications are subject to change without notice. Non-metric weights and measurements are approximate.

© 2015 LG Electronics USA, Inc. All rights reserved. "LG Life's Good" is a registered trademark of LG Corp. All other product and brand names are trademarks or registered trademarks of their respective companies. 6/23/15