

Brampton Encore - 102 - 1 - 38-6 Elev.B SCARLATTI
CENTRAL VAC AND WIRING

Inv.518	1 - TELEPHONE AND CABLE ROUGH-IN LOCATION SKETCH.
Line6232	Note: *NOTE: ALL TELEPHONE AND CABLE ROUGH-IN LOCATIONS TO BE AT THE STANDARD HEIGHT
26May16 / 1Jun16	
Inv.518	1 - BEDROOM #2: INSTALL RG 6 ROUGH-IN IN BED #2. SEE SKETCH
Line6235	Note:
26May16 / 1Jun16	

CERAMIC

Inv.913	1 - LAUNDRY ROOM: INSTALL Floor Upgrade 4 Laundry Room Floor
Line13163	Note:
19Oct16 / 16Nov16	
Inv.913	1 - FOYER: INSTALL Floor Upgrade 4 Foyer Vestibule Main Hall Floor
Line13165	Note:
19Oct16 / 16Nov16	
Inv.913	1 - KITCHEN: INSTALL Floor Upgrade 4 Kitchen Floor No Breakfast
Line13162	Note:
19Oct16 / 16Nov16	
Inv.913	1 - POWDER ROOM: INSTALL Floor Upgrade 4 Powder Room Floor
Line13164	Note:
19Oct16 / 16Nov16	
Inv.913	1 - MASTER ENSUITE: INSTALL Floor Upgrade 4 Ensuite Bath Floor-ONLY
Line13166	Note:
19Oct16 / 16Nov16	

ELECTRICAL

Inv.518	1 - FAMILY ROOM: INSTALL 110V WALL RECEPTACLE ON DEDICATED CIRCUIT - TO GO ON FAMILY ROOM WALL, 3 FEET FROM FINISHED CEILING HEIGHT. SEE SKETCH.
Line6236	Note: LOCATION MAY VARY SLIGHTLY DUE TO JOIST LOCATIONS.
26May16 / 1Jun16	
Inv.518	1 - LIVING ROOM: INSTALL ADDITIONAL STANDARD FIXTURE WITH SWITCH - IN LIVING ROOM. SEE SKETCH. IN ADDITION TO BUILDER'S STANDARD SWITCH CONTROLLED RECEPTACLE
Line6237	Note:
26May16 / 1Jun16	
Inv.913	1 - KITCHEN: DELETE UPPER CABINETS ABOVE STOVE. PURCHASER TO SUPPLY THEIR OWN FAN AFTER CLOSING
Line13516	Note:
19Oct16 / 16Nov16	

EXTERIOR COLOURS

Inv.435	1 - EXTERIOR COLOUR PACKAGE 9
Line5224	Note:
18Apr16 / 21Apr16	

FIREPLACE AND MANTLE

Brampton Encore - 102 - 1 - 38-6 Elev.B SCARLATTI

Inv.518	1 - FAMILY ROOM: DELETE FIREPLACE FROM FAMILY ROOM AND RELOCATE IT TO THE LIVING ROOM. SEE SKETCH
Line6432	Note:
26May16 / 1Jun16	

FORMING

Inv.435	1 - SIDE DOOR- HOME TO EXTERIOR- AS PER PLAN AND GRADE PERMITTING
Line5227	Note:
18Apr16 / 21Apr16	

FRAMING

Inv.518	1 - FAMILY ROOM: DELETE FIREPLACE FROM FAMILY ROOM AND RELOCATE IT TO THE LIVING ROOM. SEE SKETCH
Line6233	Note:
26May16 / 1Jun16	
Inv.518	1 - LAUNDRY/BROOM CLOSET: DELETE BROOM CLOSET ON MAIN FLOOR AND KEEP AREA OPEN FOR FUTURE SERVERY
	CHANGE LAYOUT OF LAUNDRY ROOM TO ACCOMODATE A PASS THROUGH TO THE LIVING ROOM. SEE SKETCH
Line6234	Note: LAUNDRY TUB IS MOVED TO BASEMENT. SEE SKETCH FOR LOCATION
26May16 / 1Jun16	
Inv.518	1 - MASTER ENSUITE: DELETE TOILET WALL AND TURN TOILET TO BACK ON THE SHOWER WALL. SEE SKETCH
Line6238	Note:
26May16 / 1Jun16	
Inv.518	1 - MASTER ENSUITE: ENLARGE FRAMED GLASS SHOWER TO APPROX. 3' X 5'. SEE SKETCH.
Line6239	Note:
26May16 / 1Jun16	
Inv.518	1 - MANDOOR - GARAGE TO HOUSE- AS PER PLAN AND GRADE PERMITING
Line6434	Note: AS PER APS -BONUS PACKAGE
26May16 / 1Jun16	

GRANITE MARBLE QUARTZ

Inv.913	1 - KITCHEN: INSTALL 2 CM GRP 1 Optional Flush BBar
Line13167	Note:
19Oct16 / 16Nov16	
Inv.913	1 - KITCHEN: INSTALL CUT-OUT FOR SLIDE-IN STOVE (30")
Line13169	Note:
19Oct16 / 16Nov16	
Inv.913	1 - KITCHEN: INSTALL SOAP DISPENSER BESIDE KITCHEN SINK. ON RIGHT SIDE OF FAUCET
	#RP 1022 CHROME
Line13517	Note:
19Oct16 / 16Nov16	

INTERIOR TRIM AND DOORS

Brampton Encore - 102 - 1 - 38-6 Elev.B SCARLATTI

Inv.518	3 - MAIN FLOOR: INSTALL THREE (X3) STANDARD DOORS EXTENDED HEIGHT 96" (PRICE PER DOOR) MAIN FLOOR 3 STOREY MODELS - FOR POWDER ROOM, CLOSET AND LAUNDRY. SEE SKETCH
Line6240	Note:
26May16 / 1Jun16	

KITCHEN AND BATH CABINETRY

Inv.913	1 - KITCHEN: INSTALL Oak PVC 104 Slide in stove enclosure with countertop by others
Line13170	Note:
19Oct16 / 16Nov16	
Inv.913	1 - KITCHEN: DELETE UPPER CABINETS ABOVE STOVE. PURCHASER TO SUPPLY THEIR OWN FAN AFTER CLOSING
Line13275	Note:
19Oct16 / 16Nov16	

MISC.

Inv.435	1 - BONUS DECOR DOLLARS ON APS: \$15 000.00 DOLLARS SPENT ON INVOICE: (-\$5 672.60) REMAINING DECOR DOLLAR BALANCE: \$9 327.40
Line5371	Note:
18Apr16 / 21Apr16	
Inv.435	1 - Purchasers acknowledge that purchases are final and subject to head office approval. Approval will be based on construction status
Line5370	Note:
18Apr16 / 21Apr16	
Inv.518	1 - BONUS PACKAGE: \$3435.20 (INCLUDING TAXES) WORTH OF UPGRADES FROM GOLD PARK HOMES DÉCOR CENTRE IS BEING APPLIED TOWARD THE STRUCTURAL APPOINTMENT. PURCHASER HAS A REMAINING AMOUNT OF \$5892.20 (INCLUDING TAXES) TO BE USED TOWARD THE COLOUR APPOINTMENT
Line6242	Note:
26May16 / 1Jun16	
Inv.518	1 - Purchaser has attended a Structural appointment at the Decor Centre & has DECLINED any additional upgrades and accepts and acknowledges that there will be no further structural changes/additions/deletions to be made upon signing on May 26, 2016
Line6243	Note:
26May16 / 1Jun16	
Inv.518	1 - Purchasers are aware & accepts that ANY changes made to upgrades after signing this Purchasers Extra Form are subject to a minimum administration fee of \$500. PLUS a 10% holdback fee
Line6244	Note:
26May16 / 1Jun16	
Inv.529	1 - Purchasers are aware & accepts that ANY changes made to upgrades after signing this Purchasers Extra Form are subject to a minimum administration fee of \$500. PLUS a 10% holdback fee
Line6391	Note:
31May16 / 1Jun16	
Inv.529	1 - BONUS PACKAGE: \$5650.00 (INCLUDING TAXES) WORTH OF UPGRADES FROM GOLD PARK HOMES DÉCOR CENTRE IS BEING APPLIED TOWARD THE STRUCTURAL APPOINTMENT. PURCHASER HAS A REMAINING AMOUNT OF \$242.20 (INCLUDING TAXES) TO BE USED TOWARD THE COLOUR APPOINTMENT
Line6392	Note:
31May16 / 1Jun16	
Inv.913	1 - BONUS PACKAGE: \$5892.20 (INCLUDING TAXES) WORTH OF UPGRADES FROM GOLD PARK HOMES DÉCOR CENTRE IS BEING APPLIED TOWARD THE COLOUR APPOINTMENT
Line13212	Note:
19Oct16 / 16Nov16	

Brampton Encore - 102 - 1 - 38-6 Elev.B SCARLATTI

Inv.913	1 - Purchasers are aware & accepts that ANY changes made to upgrades after signing this Purchasers Extra Form are subject to a minimum administration fee of \$500. PLUS a 10% holdback fee
Line13214	Note:
19Oct16 / 16Nov16	
Inv.913	1 - Purchaser has attended a Colour appointment at the Decor Centre & has DECLINED any additional upgrades and accepts and acknowledges that there will be no further structural changes/additions/deletions to be made upon signing on November 1, 2016
Line13213	Note:
19Oct16 / 16Nov16	

PLUMBING

Inv.435	1 - ROUGH-IN - 3PC BASEMENT ROUGH-IN
Line5220	Note:
18Apr16 / 21Apr16	
Inv.435	1 - DELETE LAUNDRY TUB ON MAIN FLOOR AND MOVE LAUNDRY TUB TO BASEMENT (LOCATION AS NOTED ON FLOORPLAN)
Line5369	Note:
18Apr16 / 21Apr16	
Inv.529	1 - GROUND FLOOR: INSTALL COMPLETE - 3PC WASHROOM ON GROUND FLOOR. SEE SKETCH FOR LOCATION
Line6390	Note:
31May16 / 1Jun16	
Inv.913	1 - KITCHEN: INSTALL SOAP DISPENSER BESIDE KITCHEN SINK. ON RIGHT SIDE OF FAUCET
	#RP 1022 CHROME
Line13171	Note:
19Oct16 / 16Nov16	

WINDOWS - BASEMENT

Inv.435	1 - BASEMENT WINDOWS - UPGRADE EXISTING BASEMENT WINDOW TO 30 INCH X 16 INCH
Line5221	Note:
18Apr16 / 21Apr16	
Inv.435	3 - BASEMENT WINDOWS - UPGRADE EXISTING BASEMENT WINDOW TO 30 INCH X 24 INCH - MAY REQUIRE INSTALLATION OF WINDOW WELL
Line5222	Note:
18Apr16 / 21Apr16	

WINDOWS AND DOORS

Inv.518	1 - MAN DOOR GARAGE TO HOUSE - OPTIONAL - IF GRADE PERMITS
Line6433	Note: AS PER BONUS PACKAGE
26May16 / 1Jun16	

1. Cabinetry

	Style and Colour	Counter	Hardware
Kitchen / Breakfast	Toscana(pvc)AntqWhite	Crema Caramel Edge: FE-20	cs1-23
Laundry Room	-		
Powder Room	-		
TWIN BATH	Venice(pvc)ItalianWalnu	6697-46 Argento Romano Laminate	cs1-23
Master Ensuite Bathroom	Toscana(pvc)ChocMapl	1874K-52 Autumn Carnival	
Second Ensuite Bathroom (If Applicable)	Toscana(pvc)AntqWhite	1874K-52 Winter Carnival	cs1-24
GROUND FL BATH	Toscana(pvc)ChocMapl	P-277LM St. Lawrence Bedrock Laminate	cs1-23
Dishwasher Cabinet	N/A		

Comment

2. Floor Tile

	Sélection	Grout	Threshold
Entrance Vestibule	*Upg.4 Must Polished Taupe, 18 x 18	N/A	N/A
Main Hall	-	N/A	N/A
Kitchen / Breakfast	*Upg.4 Must Polished Taupe, 18 x 18	N/A	N/A
Laundry Room	*Upg.4 Must Polished Taupe, 18 x 18	N/A	N/A
Powder Room	*Upg.4 Must Polished Taupe, 18 x 18	N/A	N/A
TWIN BATH	Serpentine Beyaz 13 x 13	N/A	N/A
Master Ensuite Bathroom	*Upg.4 Must Polished Taupe, 18 x 18	N/A	N/A
Second Ensuite Bathroom (If Applicable)	Serpentine Taupe 13 x 13	N/A	N/A
Lower Landing (If Applicable)	N/A	N/A	N/A
GROUND FL BATH	Serpentine Krem 13 x 13	N/A	N/A

Comment

GROUND FLOOR HALL: Serpentine Krem 13 x 13

3. Wall Tile

	Selection	Listello/Inserts	Describe
TWIN BATH	Serpentine Beyaz 8 x 10	<input type="radio"/> Yes <input checked="" type="radio"/> No	
Master Ensuite Bathroom			
Tub Deck	Venus Brown 8 x 10	<input type="radio"/> Yes <input checked="" type="radio"/> No	
Shower Stall	Venus Brown 8 x 10	<input type="radio"/> Yes <input checked="" type="radio"/> No	
Bathroom Walls	Venus Brown 8 x 10	<input type="radio"/> Yes <input checked="" type="radio"/> No	
Second Ensuite Bathroom (If Applicable)	Serpentine Taupe 8 x 10	<input type="radio"/> Yes <input checked="" type="radio"/> No	
GROUND FL BATH	Serpentine Krem 8 x 10	<input type="radio"/> Yes <input checked="" type="radio"/> No	

Kitchen Backsplash ☐ Yes ☒ No Backsplash Behind Fridge none

Comment

Scheduled Closing Date: October-11-16

Purchaser: Kirandeep Kaur Lall

Property: 102 of Plan -

Telephone Res. / Bus: (647) 896-2646

Project: Fieldwalk Investments Inc.

Decor Advisor: Terri Parisani

Model and Elevation: 38-6 Elev.B SCARLATTI

4. Plumbing Fixtures

<input type="checkbox"/>	Second Ensuite	<input type="checkbox"/>	Powder Room	<input type="checkbox"/>	
Master Ensuite Bathroom	<input type="checkbox"/>	Other Room - Specify	<input type="checkbox"/>	Other Washroom	<input type="checkbox"/>
<input type="text"/>					

Comment

ALL PLUMBING FIXTURES TO REMAIN STANDARD

5. Hardwood Flooring

	Type and Stain		Type and Stain
Main Hall	Preverco,4 1/4" NATURAL FINISH	Upper Landing	Preverco,4 1/4" NATURAL FINISH
Kitchen / Breakfast	-	Upper Hall	-
Living Room	Preverco,4 1/4" NATURAL FINISH	Master Bedroom	-
Dining Room	Preverco,4 1/4" NATURAL FINISH	Bedroom #2	-
Family Room	Preverco,4 1/4" NATURAL FINISH	Bedroom #3	-
Den/Library	-	Bedroom #4	-
Entrance Vestibule	-	Bedroom #5	-
Lower Landing (If Applicable)	-	Other Room - Specify	-

Comment

6. Carpeting

	Upgrade	Description
Main Hall	<input type="checkbox"/>	-
Living Room	<input type="checkbox"/>	-
Dining Room	<input type="checkbox"/>	-
Family Room	<input type="checkbox"/>	-
Den/Library	<input type="checkbox"/>	-
Upper Hall	<input type="checkbox"/>	T-15
Master Bedroom	<input type="checkbox"/>	T-15
Bedroom #2	<input type="checkbox"/>	T-15
Bedroom #3	<input type="checkbox"/>	T-15
Bedroom #4	<input type="checkbox"/>	T-15
Bedroom #5	<input type="checkbox"/>	-
GROUND FLOOR	<input type="checkbox"/>	T-15
Upper Landing (If Applicable)	<input type="checkbox"/>	-
Lower Landing (If Applicable)	<input type="checkbox"/>	-

Upgrade Underpad	Type STANDARD	Area -
Carpet on Stairs	Capped N/A	Runner - *Upgrade N/A

Comment

Scheduled Closing Date: October-11-16

Purchaser: Kirandeep Kaur Lall
Telephone Res. / Bus: (647) 896-2646
Decor Advisor: Terri Parisani

Property: 102 of Plan -
Project: Fieldwalk Investments Inc.
Model and Elevation: 38-6 Elev.B SCARLATTI

7. Fireplace

	Living Room			Family Room			Other Room - Specify		
	Purchased	As Per Plan	N/A	Purchased	As Per Plan	N/A	Purchased	As Per Plan	N/A
	<input type="radio"/>	<input checked="" type="radio"/>	<input type="radio"/>	<input type="radio"/>	<input type="radio"/>	<input checked="" type="radio"/>	<input type="radio"/>	<input type="radio"/>	<input checked="" type="radio"/>
Fireplace Type	STANDARD								
Mantle Type	NF-20								
Colour / Stain	WHITE PAINT-GRADE								
Surround	NERO MARQUINA								
Hearth	NONE								

Comment

*NOTE: FIREPLACE WAS MOVED TO LIVING ROOM AT STRUCTURAL APPOINTMENT

8. Trim Carpentry

Interior Doors Front Door Glass Inserts Door Handles
Interior Trim

Comment

9. Plaster Mouldings and Medallions

Entrance Vestibule	<input type="text" value="N/A"/>	<input type="text"/>	Kitchen/Breakfast	<input type="text" value="N/A"/>	<input type="text"/>
Main Hall	<input type="text" value="N/A"/>	<input type="text"/>	Den/Library	<input type="text" value="N/A"/>	<input type="text"/>
Living Room	<input type="text" value="N/A"/>	<input type="text"/>	Lower Landing	<input type="text" value="N/A"/>	<input type="text"/>
Dining Room	<input type="text" value="N/A"/>	<input type="text"/>	Other Room - Specify	<input type="text" value="N/A"/>	<input type="text"/>
Family Room	<input type="text" value="N/A"/>	<input type="text"/>			

Comment

10. Railings and Spindles

Railing Package
Railing Colour Spindle Colour
Stringer / Riser Treads
Oak Stairs ☒ Yes ☐ No

Comment

11. Wall Paint

Main & Upper Hall	<input type="text" value="OYSTER"/>	Master Bedroom	<input type="text" value="OYSTER"/>
Living Room	<input type="text" value="OYSTER"/>	Bedroom #2	<input type="text" value="OYSTER"/>
Dining Room	<input type="text" value="OYSTER"/>	Bedroom #3	<input type="text" value="OYSTER"/>
Kitchen / Breakfast	<input type="text" value="OYSTER"/>	Bedroom #4	<input type="text" value="OYSTER"/>
Family Room	<input type="text" value="OYSTER"/>	Bedroom #5	<input type="text"/>
Powder Room	<input type="text" value="OYSTER"/>	Master Ensuite	<input type="text" value="OYSTER"/>
Laundry Room	<input type="text" value="OYSTER"/>	TWIN BATH	<input type="text" value="OYSTER"/>
Den/Library	<input type="text" value="OYSTER"/>	Second Ensuite	<input type="text" value="OYSTER"/>
Trim Paint	<input type="text" value="WHITE"/>	GROUND FLOOR	<input type="text" value="OYSTER"/>
Comment	Smooth Ceilings First Floor <input type="text"/>		

Scheduled Closing Date: October-11-16

Purchaser: Kirandeep Kaur Lall

Property: 102 of Plan -

Telephone Res. / Bus: (647) 896-2646

Project: Fieldwalk Investments Inc.

Decor Advisor: Terri Parisani

Model and Elevation: 38-6 Elev.B SCARLATTI

12. Electrical

Plugs and Switches	<input checked="" type="radio"/> White <input type="radio"/> Ivory		Above Kitchen Cabinet Light	<input type="radio"/> Yes <input checked="" type="radio"/> No
Hood Fan	<input type="radio"/> White <input type="radio"/> Ivory		Below Kitchen Cabinet Light	<input type="radio"/> Yes <input checked="" type="radio"/> No
Appliances	Built in Cooktop	Built in Oven	Gas Stove	Microwave
	<input checked="" type="radio"/> Yes <input type="radio"/> No	<input type="radio"/> Yes <input checked="" type="radio"/> No	<input type="radio"/> Yes <input checked="" type="radio"/> No	<input type="radio"/> Yes <input checked="" type="radio"/> No
Comment				

STANDARD HOOD FAN: STAINLESS STEEL

13. Heating and Air Conditioning

Air Conditioning		Gas Provisions Stove	
Gas Provisions Dryer		Gas Provisions Barbecue	
Comment			

GAS BBQ IS STANDARD

14. Additional Comments

15. Disclaimers and Notes

- 1) Colours of all materials are as close as possible to builder's selection, but not necessarily identical due to variances in manufacturing.
- 2) Any extras listed above are null and void unless accompanied by a separate invoice/amendment. Said invoice must be paid in full.
- 3) The Purchaser acknowledges that after Interior Colour Selection form is signed and dated, no further changes will be permitted other than re-selection due to unavailability. _____ Purchaser's Initials
- 4) The Purchaser acknowledges reading and accepting the "Gold Park Homes Decor Centre Disclaimers" form. This document contains other miscellaneous disclaimers.

This Interior Colour Selection is final and approved by:

Signature: _____ Date: _____

encore
BRAMPTON

Telephone — (T)
Cable — (C)
Electrical — (E)

The Scarlatti 38' SERIES

Elevation A • 3,591 sq.ft. | Elevation B • 3,578 sq.ft.

Lot 102
Nov. 1, 16



Extended height door
Delete Broom Closet, make pass through to living room.
Change Laundry w/d location

move Fireplace to Living Rm

Place plug 3' below finished ceiling height
* Telephone and Cable to be left at standard height.

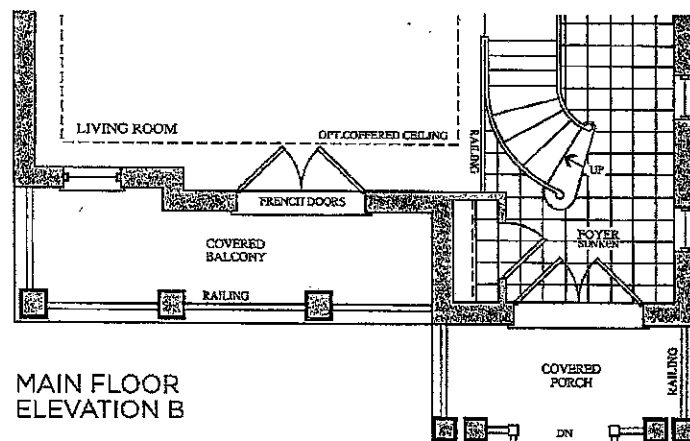
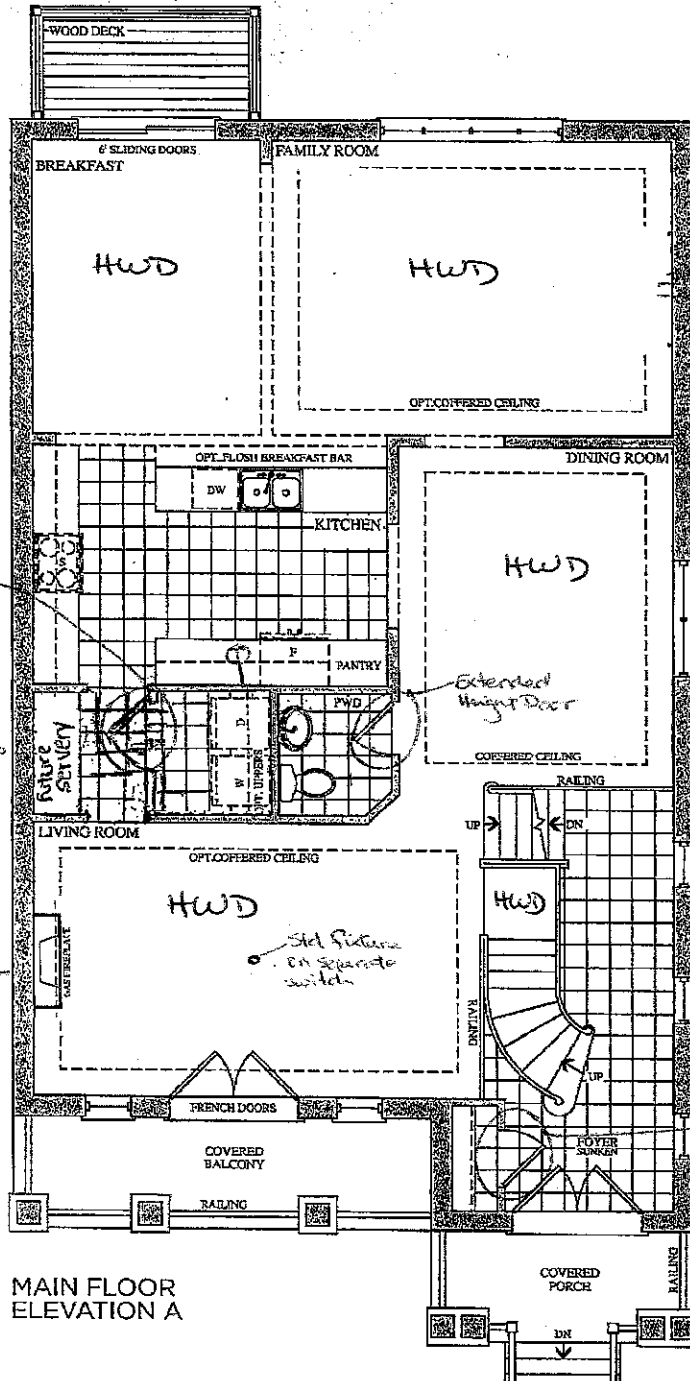

Lot 102
May 26, 16



Prices, figures, illustrations, sizes, features and finishes are subject to change without notice. E.&O.E. Areas and dimensions are approximate and actual usable floor space may vary from the stated area. Layout may be reverse of the unit purchased. E. & O.E.

GOLDPARK
HOMES

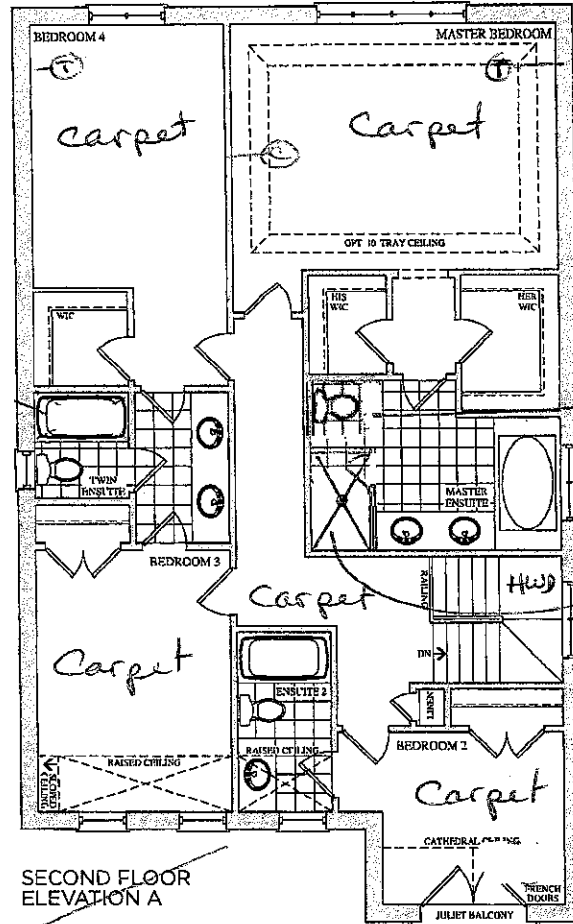

SECOND FLOOR
ELEVATION A

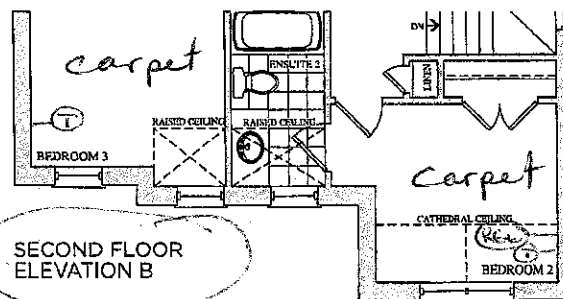

SECOND FLOOR
ELEVATION B

Lot 102
Nov. 1, 16
○○

Lot 102
May 26, 16
1/4 ○○

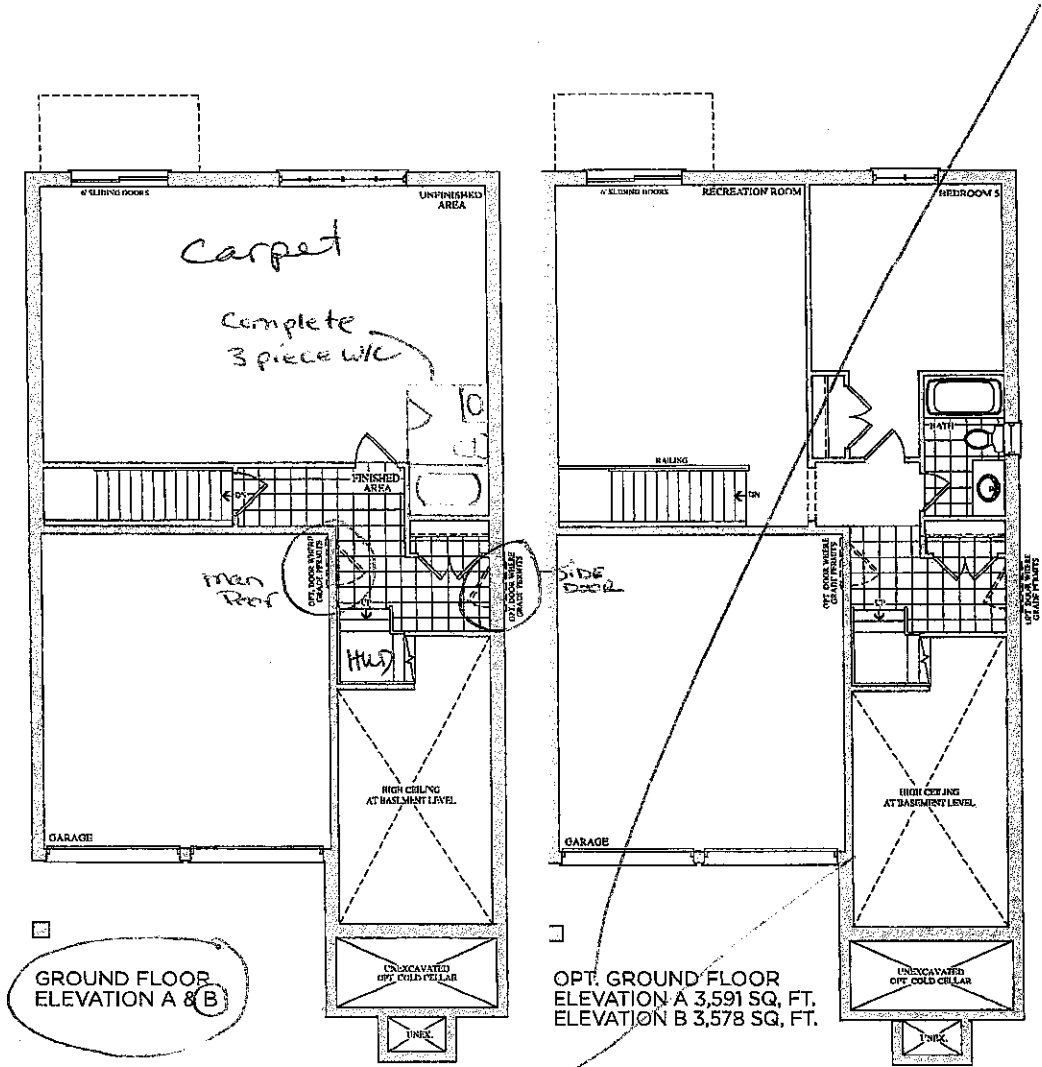

Lot 102
May 26, 16

KL

Lot 102
Nov. 1, 16

OO

Lot 102
Nov. 1, 16

20mm (3/4") Profiles

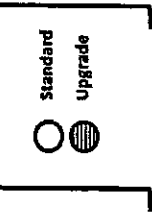
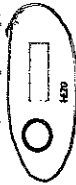

Standard & Upgrade Profiles
Offered with a 2 cm Surface

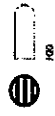

30mm (1 1/8") Profiles

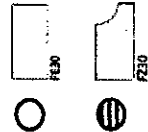
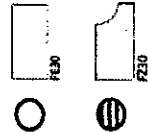
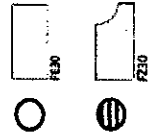
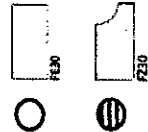
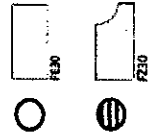
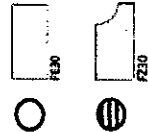
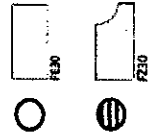
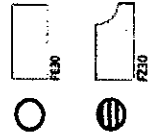
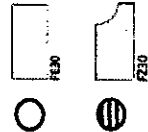
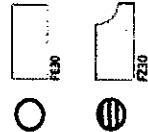
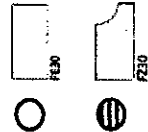
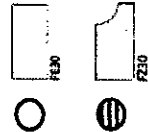
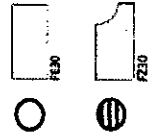
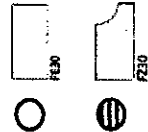
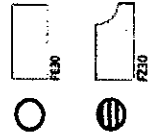
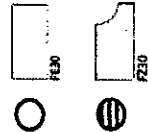
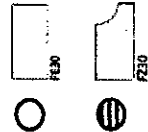
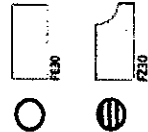
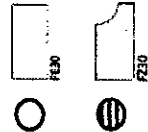
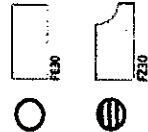
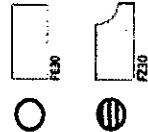
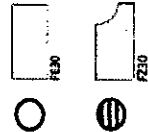
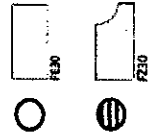
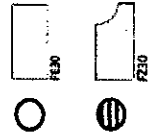
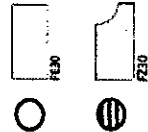
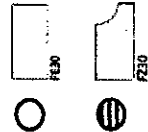
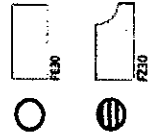
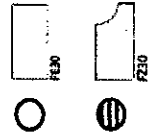
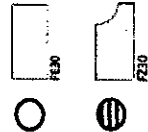
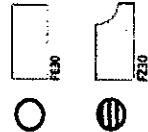
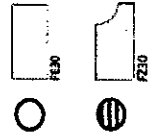
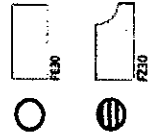
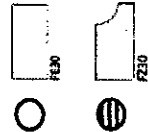
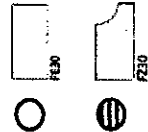
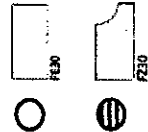
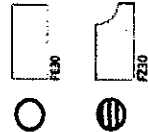
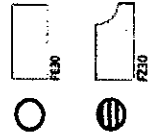
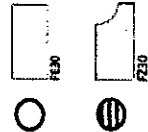
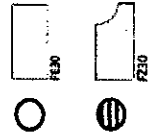
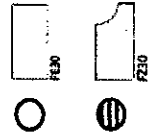
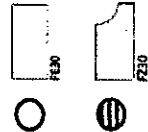
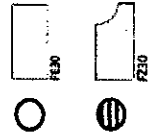
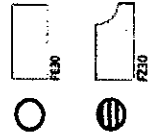
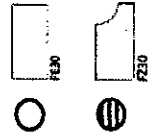
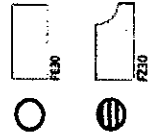
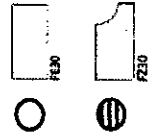
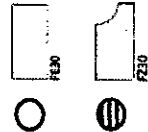
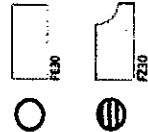
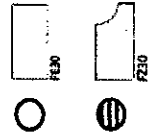
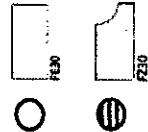
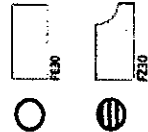
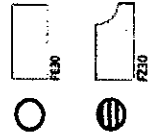
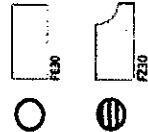
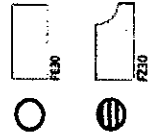
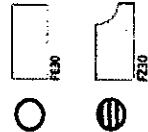
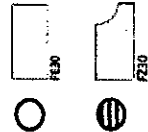
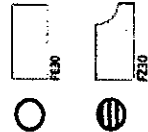
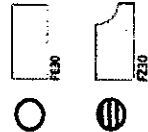
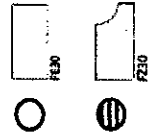
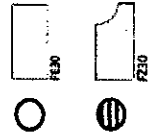
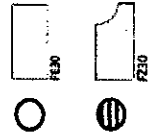
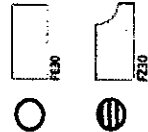
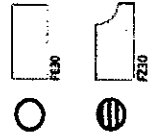
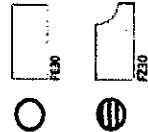
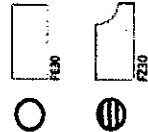
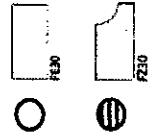
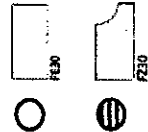
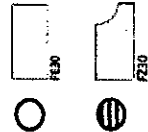
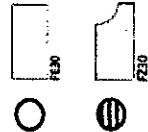
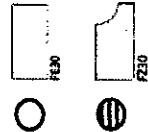
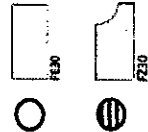
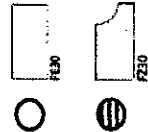
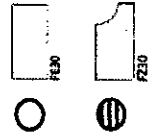
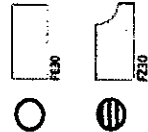
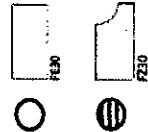
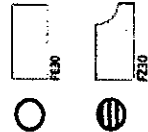
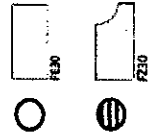
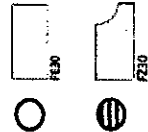
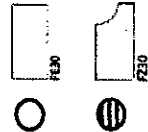
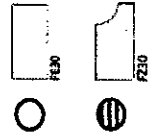
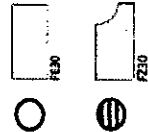
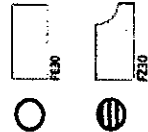
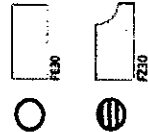
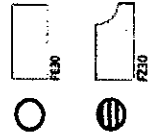
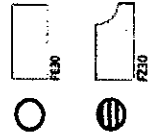
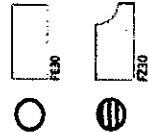
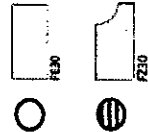
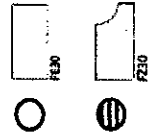
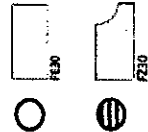
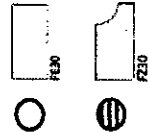
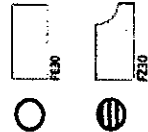
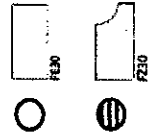
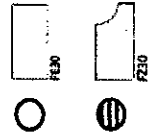
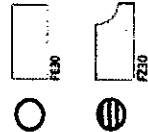
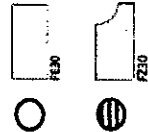
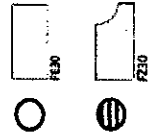
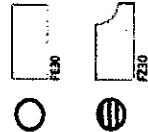
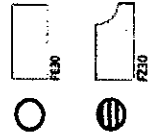
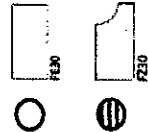
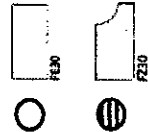
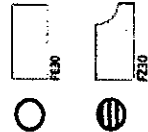
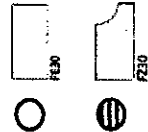
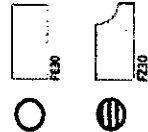
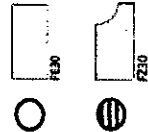
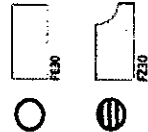
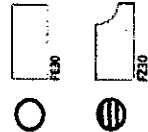
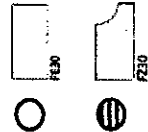
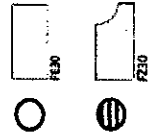
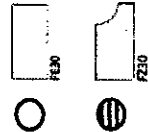
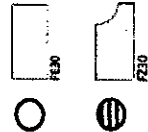
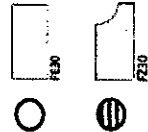
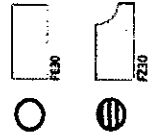
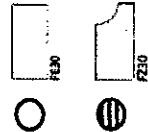
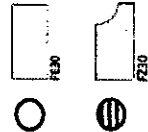
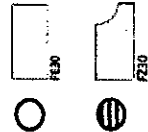
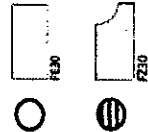
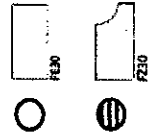
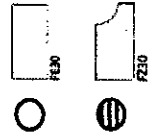
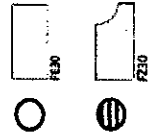
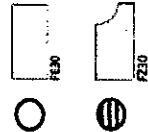
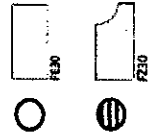
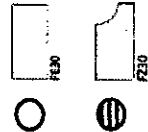
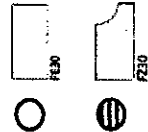
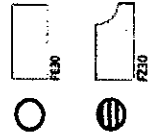
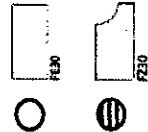
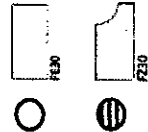
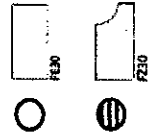
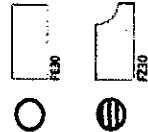
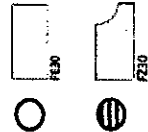
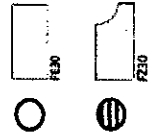
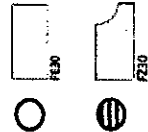
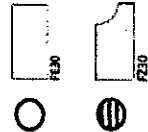
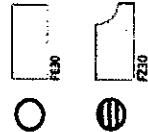
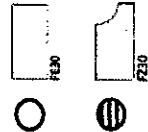
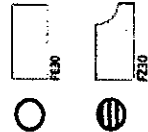
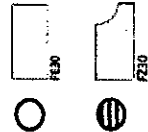
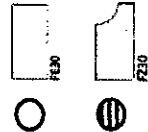
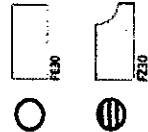
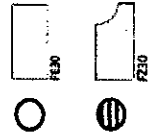
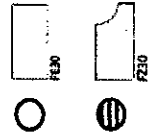
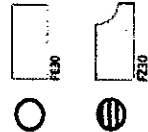
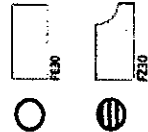
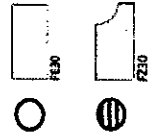
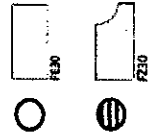
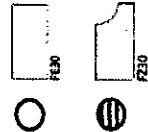
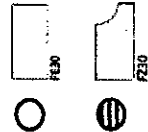
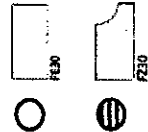
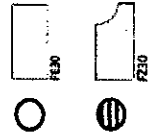
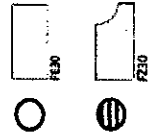
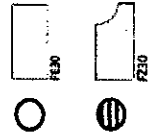
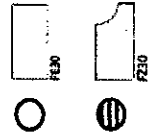
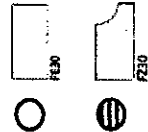
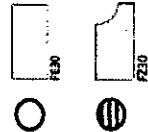
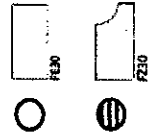
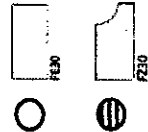
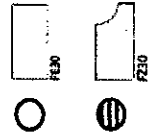
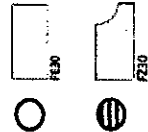
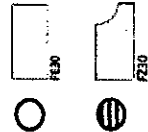
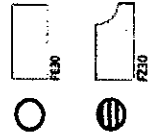
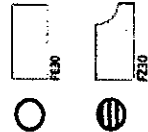
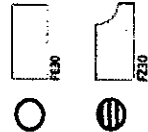
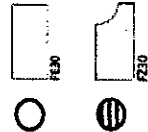
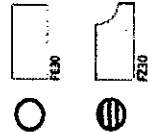
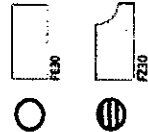
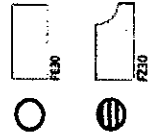
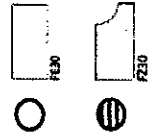
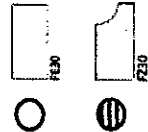
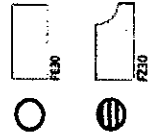
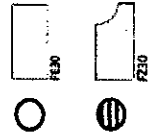
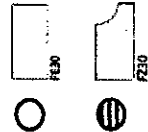
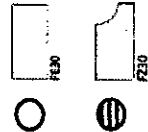
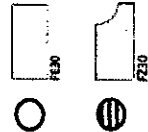
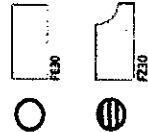
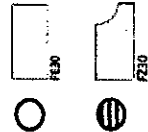
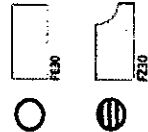
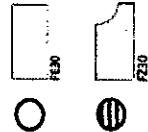
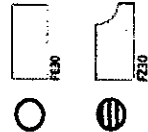
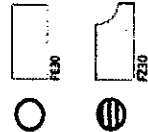
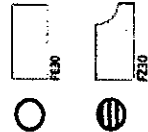
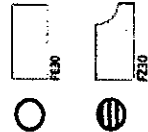
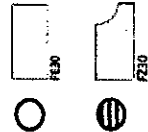
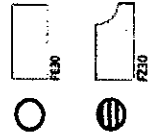
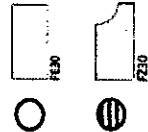
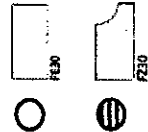
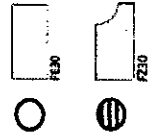
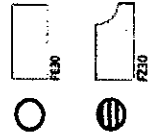
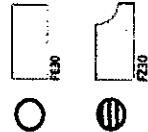
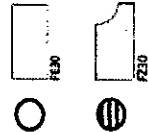
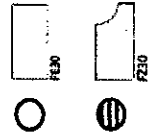
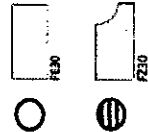
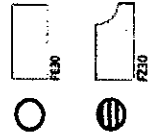
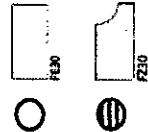
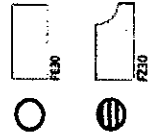
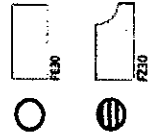
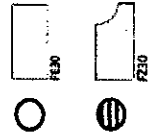
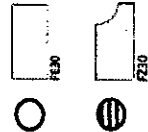
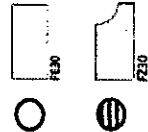
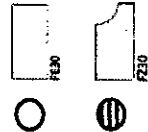
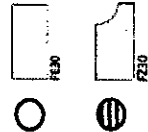
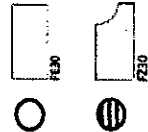
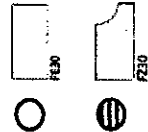
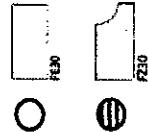
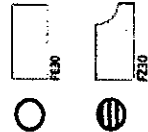
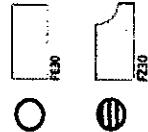
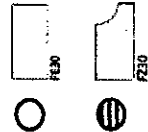
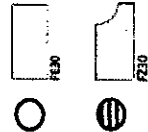
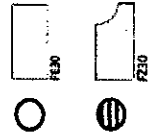
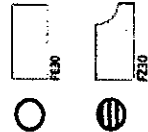
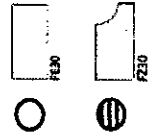
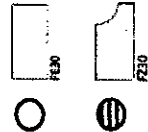
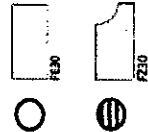
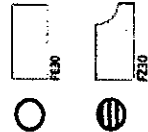
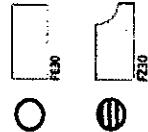
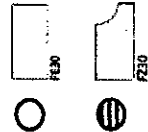
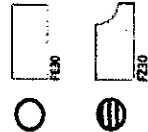
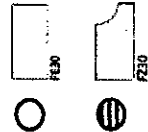
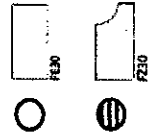
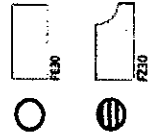
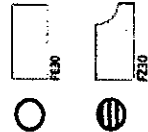
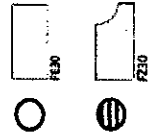
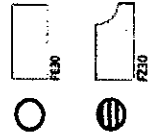

CORTINA

KITCHENS INC.

70 Regina Road Woodbridge ON L4L 8L6
905-264-6464

INFORMATION - PVC DOORS

Builder Gold Park Homes Project Encore Lot # 102

All cabinets with PVC (Thermofoil) Doors come with melamine gables, panels and kick. The doors, crown moulding and light valance are PVC wrapped. Open shelves incorporated in design will only be available with melamine interiors. There will be variations in colour shades between the PVC parts (doors, crown and Light valance) and the melamine parts (open shelves, Gables, Panels and Kick) due to the difference in material.

Furring Panel with crown moulding to the ceiling is not available on all PVC door styles due to subtle variations in colour shades between the PVC parts (moulding) and the melamine parts (furring panel) due to the difference in material. Grain directions in wood grain pattern melamine, vary between the furring panel, crown moulding (horizontal) and the PVC doors (vertical).

Thank you for your understanding.

I am well informed of this information, and agree to the purchase of the above.

Purchaser: _____

Date: _____

STANDARD HARDWARE

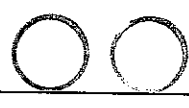

STANDARD HARDWARE



CSI-6

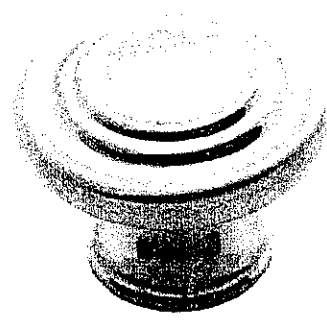

CSI-10



CSI-14

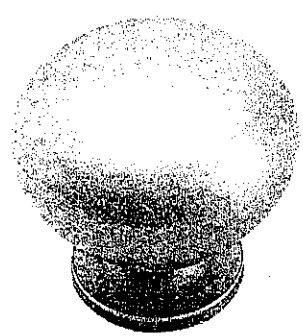

CSI-16



CSI-18

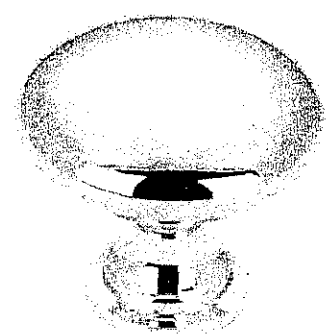

CSI-19

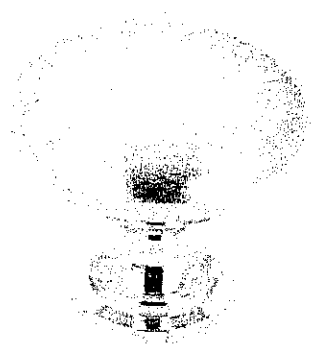

CSI-20

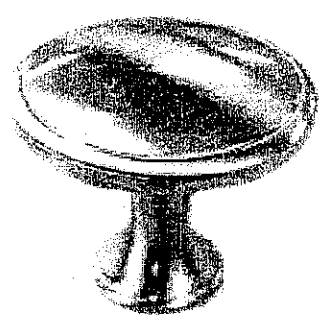

CSI-21



CSI-22



CSI-23

• Kitchen
• Twin Bath
• Ground Floor
EHS.

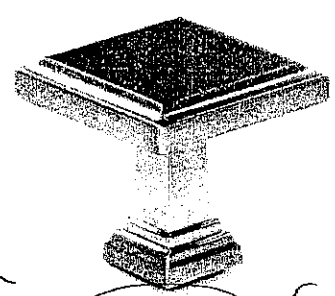

CSI-24

Ens. 2

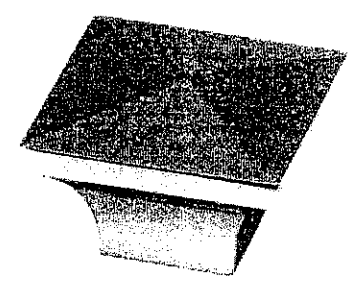

CSI-25

***NOTES:**
- IMAGES ARE FOR QUICK REFERENCE PURPOSES ONLY
- ACTUAL SIZES AND FINISHES AS PER HARDWARE
SAMPLE BOARD PROVIDED TO DECOR CENTRE

Recommended locations for gas piping and electrical outlets

(For models NX58H9950W*, NX58H9500W*, NX58K9500W*)

Doc 102
Nov 1, 16

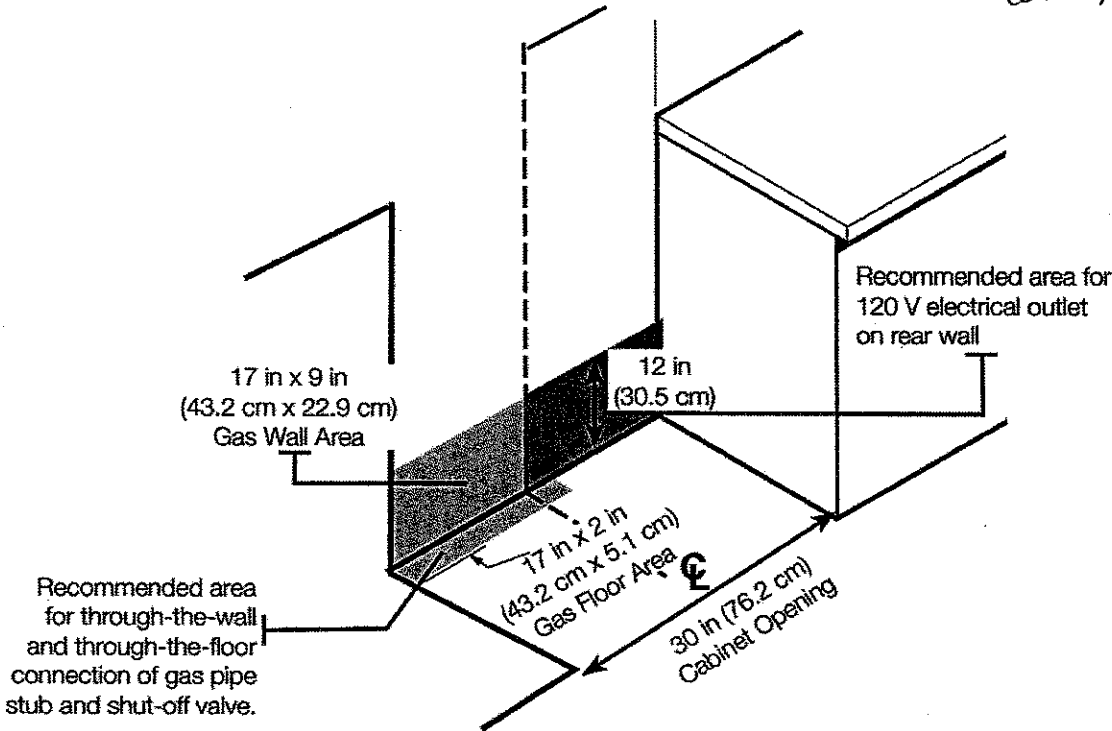

CAUTION

You must use the rear filler kit to install the range in a freestanding cutout cabinet. For more information, see "Optional rear filler kit" as shown below.

Optional rear filler kit



Used to fill gap between the range back and wall. Adds a filler strip to the rear of the range. This kit can only be used when the opening in the countertop is 25" deep.



If the countertop depth is greater than 25", there will be a gap between the filler kit and the back wall.

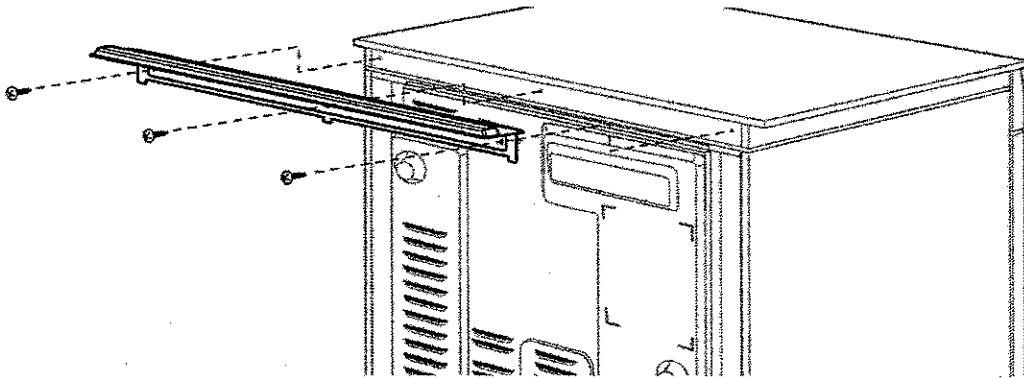

LOCATION REQUIREMENTS

Clearances and dimensions

 For OTR over Gas Stove, please follow local GAS CODE.

BEFORE YOU BEGIN to install this appliance, refer to the following information, dimensions, and clearances. **Do not locate the range where it may be subject to strong drafts.** Provide adequate clearances between the range and adjacent combustible surfaces. These dimensions must be met for safe use of the range. The location of the electrical outlet and gas piping may be adjusted to meet the following dimensions and clearances.

For installation in Canada, a free-standing range is not to be installed closer than 4.7 in (12 cm) from any adjacent surface.

 **CAUTION** This range has been designed to comply with the maximum allowable wood cabinet temperature of 194 °F (90 °C). Make sure the wall covering, countertops, and cabinets around the range can withstand the heat (up to 194 °F [90 °C]) generated by the range. If not, discoloration, delamination, or melting may occur.

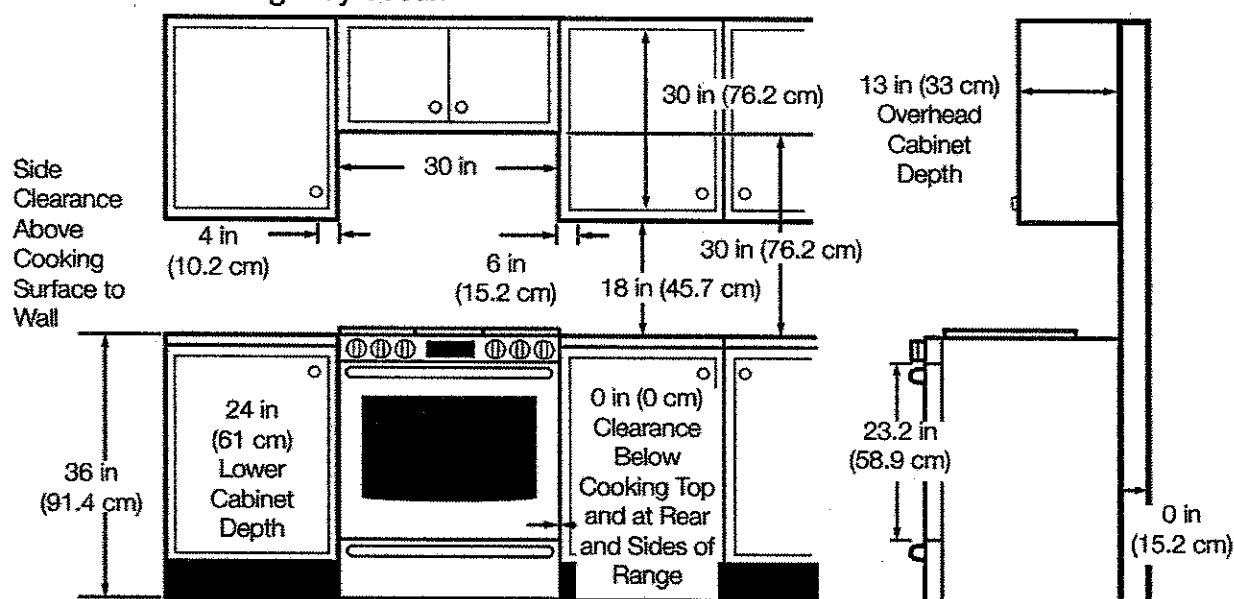

IMPORTANT: MAKE SURE the unit is supported by the leveling legs and **NOT** by the cooktop itself.

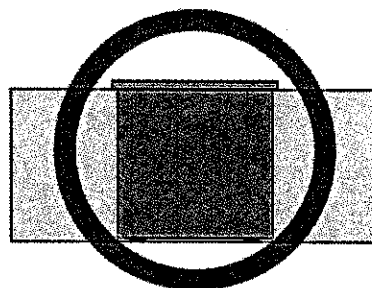
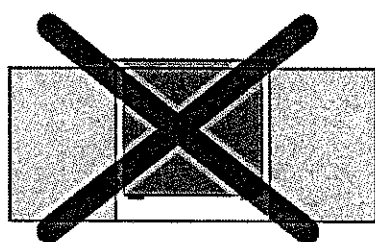

Minimum dimensions



If overhead cabinets are provided, a range hood should also be provided that projects horizontally a minimum of 5 in (12.7 cm) beyond the front of the cabinets. This will dissipate any heat buildup in the overhead cabinets to prevent death, personal injury, and/or fire hazard. The ventilating hood must be constructed of sheet metal not less than 0.0122" thick. Install above the cooktop with a clearance of not less than 1/4" between the hood and the underside of the combustible material or metal cabinet. The hood must be at least as wide as the appliance and centered over the appliance. Clearance between the cooking surface and the ventilation hood surface must never be less than 24 inches.

Exception 1 : Installation of a listed microwave oven or cooking appliance over the cooktop shall conform to the installations packed with that appliance.

- 30-in (101.6-cm) minimum clearance between the top of the cooking surface and the bottom of an unprotected wood or metal cabinet; or If no 30-in(101.6-cm) minimum clearance, 24-in (61-cm) minimum when the bottom of the wood or metal cabinet is protected by not less than 0.25-in (0.64-cm) flame-retardant millboard covered with not less than no. 28 MSG sheet steel, 0.015-in (0.038-cm) stainless steel, 0.024-in (0.061-cm) aluminum, or 0.020-in (0.051-cm) copper.
- 18-in (45.7-cm) minimum between the countertop and the adjacent cabinet bottom.

Exception 2 : For island installation, maintain 2-1/2" minimum from cutout to back edge of countertop and 4" minimum from cutout to side edges of countertop.

Installation guide

SLIDE-IN CUTOUT

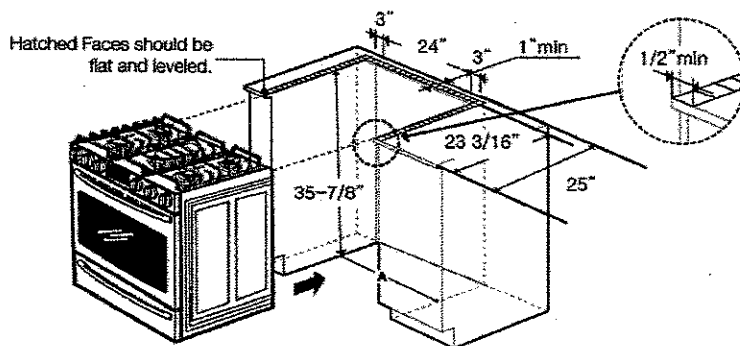

FREESTANDING CUTOUT

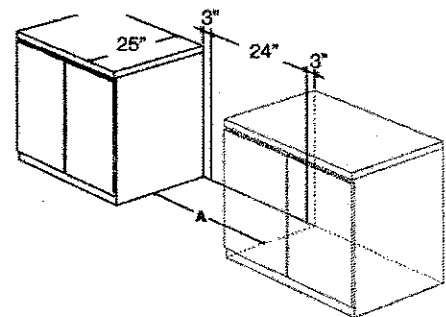

A: Cabinet opening 30" (76.2 cm)

IMPORTANT: If your cabinet have height over 36-4/5", this range cannot be installed without supporting unit like hard block.

Kitchen – Soap Dispensers



Soap Dispenser

Chrome Finish
RP1001

Arctic™ Stainless Finish
RP1001AR

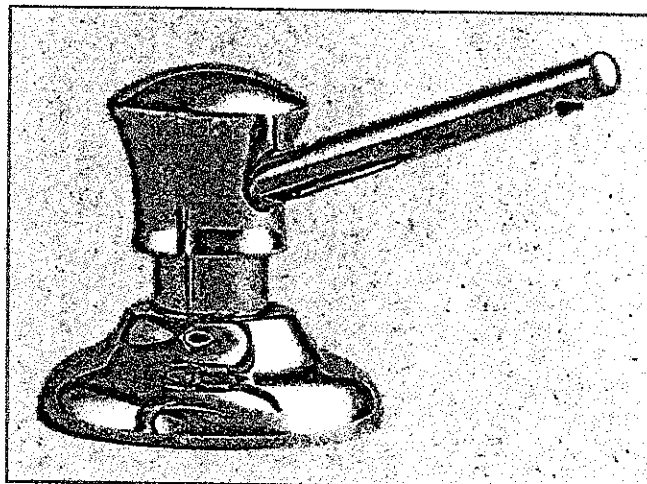

Soap Dispenser

Chrome Finish
RP1002

Arctic™ Stainless Finish
RP1002AR

Champagne Bronze™ Finish
RP1002CZ

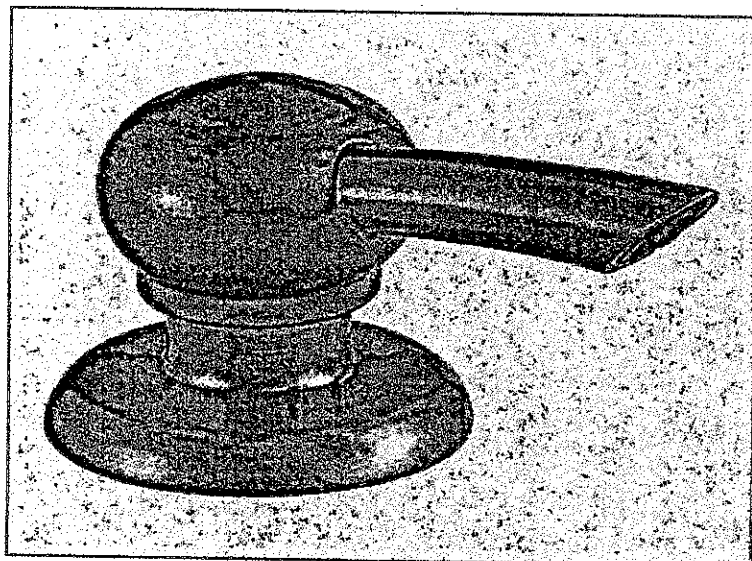

Soap Dispenser

Chrome Finish
RP50813

Arctic™ Stainless Finish
RP50813AR

Champagne Bronze™ Finish
RP50813CZ



Lot 102
Nov. 1, 16



Date: 06/23/16

Trade Name: Gold Park Homes	Site location: Brampton	Model: 38-6
Address:	Project: Encore	Phase:

This layout has been explained to the purchaser by Cortina Kitchens Inc. and is understood by the purchaser.

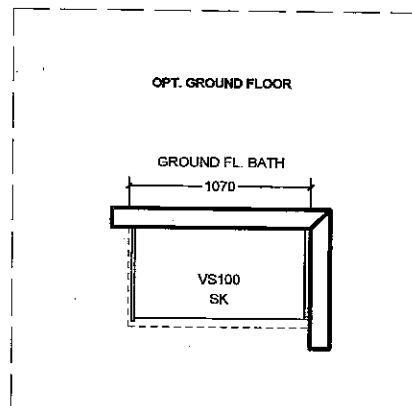
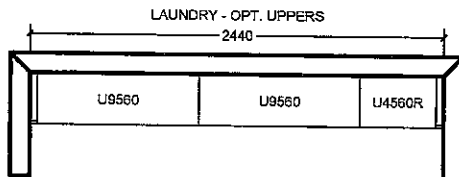
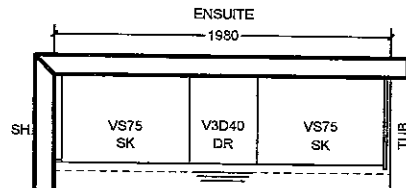
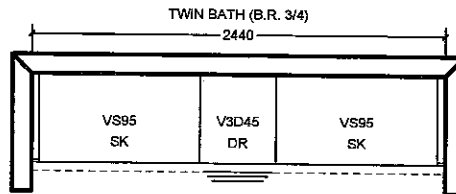
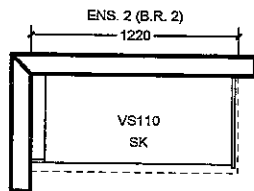
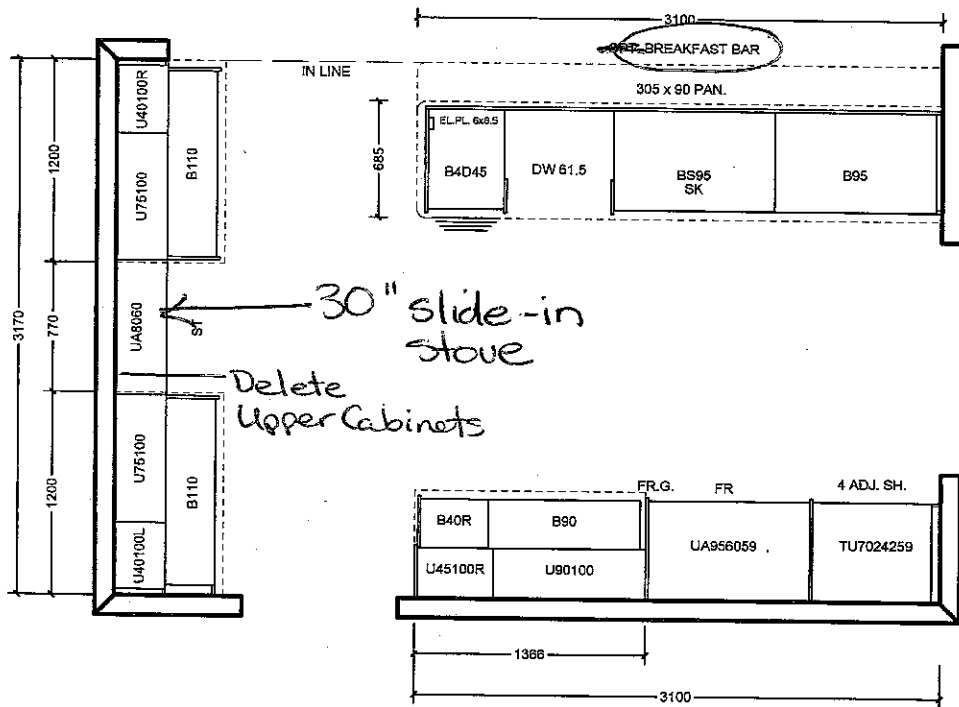

All prices subject to confirmation from head office.

This quotation is subject to the terms & conditions set out in Cortina's Agreement of Purchase and Sale.

All agreements are contingent upon strikes, accidents, and delay beyond our control. Please provide our installer with template for sinkholes or \$150.00 will be charged for callback.

ACCEPTED DATE: _____

CUSTOMER SIGNATURE _____

SALESPERSON SIGNATURE _____

CORTINA HEAD OFFICE APPROVAL _____

ITEM A. Wood grain and colour are characteristics of the product, we cannot guarantee that such grain and colour will always match.
ITEM B. Cortina Kitchens reserves the right to alter dimensions and make technical changes without notice.

Lot 102
Nov. 1, 16

