

Kleinburg Glen - 23L - 1 - 25-1 Elev.B RIVERSTONE
CERAMIC

Inv.829	1 - ENTRANCE VESTIBULE: UPG 4
Line12127	Note:
20Sep16 / 2Dec16	
Inv.829	1 - LAUNDRY: UPG 4
Line12131	Note:
20Sep16 / 2Dec16	
Inv.829	1 - POWDER ROOM: UPG 4
Line12132	Note:
20Sep16 / 2Dec16	
Inv.829	1 - MASTER ENSUITE FLOOR TILE: UPG 2
Line12133	Note: Price included Floor, Tub Deck, Tub Skirt & Tub Splash
20Sep16 / 2Dec16	
Inv.829	1 - MAIN BATH FLOOR TILE: UPG 2
Line12134	Note:
20Sep16 / 2Dec16	
Inv.829	1 - BATHROOM ACCESSORIES: DELETE STANDARD CERAMIC ACCESSORIES THROUGHOUT ALL BATHROOMS
Line12289	Note:
20Sep16 / 2Dec16	
Inv.829	1 - MASTER ENSUITE: Shower Wall Tile UPG 1
Line14221	Note:
20Sep16 / 2Dec16	

DRYWALL

Inv.683	1 - SMOOTH CEILINGS - (2 - Story Design) SECOND FLOOR
Line8973	Note:
20Jul16 / 17Aug16	

ELECTRICAL

Inv.683	1 - FAMILY ROOM: 110V WALL RECEPTACLE ON NORMAL CIRCUIT - ABOVE FIREPLACE APPROX 66" AFF. PLEASE SEE FLOORPLAN FOR LOCATION
Line8972	Note:
20Jul16 / 17Aug16	

EXTERIOR COLOURS

Inv.683	1 - EXTERIOR COLOUR PACKAGE 9
Line10261	Note:
20Jul16 / 17Aug16	

GRANITE MARBLE QUARTZ

Inv.829	1 - COUNTERTOP: ACCOMMODATE FOR SLIDE IN RANGE
Line12287	Note:
20Sep16 / 2Dec16	
Inv.829	1 - MASTER ENSUITE COUNTERTOP: UPG 2 Caesarstone
Line14293	Note: STD Edge FE20
20Sep16 / 2Dec16	

Kleinburg Glen - 23L - 1 - 25-1 Elev.B RIVERSTONE

Inv.829	2 - MASTER ENSUITE: Polish cut out for undermount sinks
Line14296	Note:
20Sep16 / 2Dec16	

HARDWOOD

Inv.829	1 - MAIN HALL: UPG 1 PROVECO RED OAK INOX PRO
Line12128	Note:
20Sep16 / 2Dec16	

Inv.829	1 - KITCHEN/BREAKFAST: UPG 1 PROVECO RED OAK INOX PRO
Line12129	Note:
20Sep16 / 2Dec16	

Inv.829	1 - FAMILY ROOM: UPG 1 PROVERCO RED OAK INOX PRO
Line12130	Note:
20Sep16 / 2Dec16	

Inv.829	1 - UPPER HALL: UPG 1 PROVERCO RED OAK INOX PRO
Line12135	Note:
20Sep16 / 2Dec16	

Inv.829	1 - MASTER BEDROOM: UPG 1 PROVECO INOX PRO
Line12282	Note:
20Sep16 / 2Dec16	

Inv.829	1 - BEDROOM 2: UPG 1 PROVECO INOX PRO
Line12283	Note:
20Sep16 / 2Dec16	

Inv.829	1 - BEDROOM 3: UPG 1 PROVECO INOX PRO
Line12284	Note:
20Sep16 / 2Dec16	

INTERIOR TRIM AND DOORS

Inv.683	2 - EXTENDED HEIGHT ARCHWAY (PRICE PER DOORWAY)
Line8974	Note:
20Jul16 / 17Aug16	

Inv.683	5 - STANDARD DOOR EXTENDED HEIGHT 96 INCH (PRICE PER DOOR) - GROUND FLOOR 2 STOREY MODELS
Line8975	Note:
20Jul16 / 17Aug16	

KITCHEN AND BATH CABINETRY

Inv.829	1 - KITCHEN: UPG Island Colour and Door Style
Line12122	Note: ***CHANGE ISLAND DOOR AND COLOUR TO: UPG 1: VARESE OAK GREYSTONE****
20Sep16 / 2Dec16	

Inv.829	1 - MASTER ENSUITE VANITY CAB: UPG 1 VARESE OAK GREYSTONE
Line12124	Note: With STD Hardware CS1-23
20Sep16 / 2Dec16	

Inv.829	1 - KITCHEN HARDWARE: UPG CH51
Line12278	Note:
20Sep16 / 2Dec16	

Kleinburg Glen - 23L - 1 - 25-1 Elev.B RIVERSTONE

Inv.829	1 - KITCHEN: ACCOMMODATE FOR SLIDE IN RANGE-- Client requested 30" standard opening and is aware that opening will be 30" as they have not provided stove specs
Line12286	Note:
20Sep16 / 2Dec16	
Inv.829	1 - KITCHEN: RAISE KITCHEN BASE CABINETS 3/4" FROM ROUGH FLOOR FOR FINISHED HARDWOOD
Line12288	Note:
20Sep16 / 2Dec16	
Inv.829	1 - KITCHEN: UPG ADD LIGHT VALANCE
Line12317	Note:
20Sep16 / 2Dec16	
Inv.829	1 - KITCHEN: Extend Island 6" on either side
Line14212	Note:
20Sep16 / 2Dec16	
Inv.829	1 - LAUNDRY: Add Laundry Uppers
Line14225	Note:
20Sep16 / 2Dec16	

MISC.

Inv.683	1 - BALANCE OF \$949.45 PAID BY MASTERCARD
Line8995	Note:
20Jul16 / 17Aug16	
Inv.683	1 - Purchaser has attended a Structural appointment at the Decor Centre & has DECLINED any additional upgrades and accepts and acknowledges that there will be no further structural changes/additions/deletions to be made upon signing on July 20, 2016.
Line8992	Note:
20Jul16 / 17Aug16	
Inv.683	1 - Purchasers are aware & accepts that ANY changes made to upgrades after signing this Purchasers Extra Form are subject to a minimum administration fee of \$500. PLUS a 10% holdback fee.
Line8993	Note:
20Jul16 / 17Aug16	
Inv.683	1 - BONUS PACKAGE: \$5,000.00 (INCLUDING TAXES) WORTH OF UPGRADES FROM GOLD PARK HOMES DÉCOR CENTRE IS BEING APPLIED TOWARD THE STRUCTURAL APPOINTMENT. PURCHASER HAS A REMAINING AMOUNT OF \$00 (INCLUDING TAXES) TO BE USED TOWARD THE COLOUR APPOINTMENT.
Line8994	Note:
20Jul16 / 17Aug16	
Inv.829	1 - Purchaser Accepts Standard Appliance Openings: Fridge - 37-1/2"W x 73-1/2" High Approx. Range - 30-1/2"D x 31-1/2"W Approx. Dishwasher - 24" W Approx
Line14229	Note:
20Sep16 / 2Dec16	
Inv.829	1 - TOTAL: \$34,557.66 50% Deposit: \$17,278.83 50% on Mortgage: \$17,278.83
Line14231	Note:
20Sep16 / 2Dec16	

Kleinburg Glen - 23L - 1 - 25-1 Elev.B RIVERSTONE

Inv.829	1 - Purchaser has attended a Structural appointment at the Decor Centre & has DECLINED any additional upgrades and accepts and acknowledges that there will be no further structural changes/additions/deletions to be made upon signing
Line14228	Note:
20Sep16 / 2Dec16	
Inv.829	1 - Due to the many variables that can affect the pattern, colour and/or design and "pitting" of natural products, granite installed will not be identical to the samples displayed.
Line14230	Note: Every effort is made to provide granite counter tops as close as possible but the vendor is not responsible for results which differ from the sample displayed. All countertop surfaces may have seems & product pattern & shade can change in areas containing seems.
20Sep16 / 2Dec16	

PLUMBING

Inv.829	1 - KITCHEN: UPG Add Soap Dispenser RP-1002
Line14220	Note: Please see spec sheet attached
20Sep16 / 2Dec16	
Inv.829	2 - MASTER ENSUITE: UPG Vanity Faucet Delta Addison 592-DST
Line14219	Note: See Spec Sheet attached
20Sep16 / 2Dec16	
Inv.829	2 - MASTER ENSUITE VANITY SINKS: UPG - Contrac Camden 16"
Line14294	Note:
20Sep16 / 2Dec16	

STAIRS AND RAILINGS

Inv.829	1 - UPG HANDRAIL: V-GROOVE
Line12136	Note:
20Sep16 / 2Dec16	
Inv.829	1 - IRON PICKETS: UPG: EUROLINE 1
Line12137	Note:
20Sep16 / 2Dec16	
Inv.829	1 - STAIR STAIN: PROVERCO INOX. The purchaser was advised and therefore accepts and acknowledges that the stain of the staircase and flooring chosen do not match. This difference might result in an undesirable colour variance.
Line12294	Note:
20Sep16 / 2Dec16	

TRIM AND DOORS

Inv.829	1 - SECOND FLOOR: UPG 2
Line14227	Note:
20Sep16 / 2Dec16	
Inv.829	1 - MAIN FLOOR TRIM & BASEBOARDS: UPG 2
Line14226	Note:
20Sep16 / 2Dec16	

Scheduled Closing Date: October-13-16

Purchaser: Giovanni Sisti

Property: 23L

Telephone Res. / Bus:

Project: Burkshire Holdings Inc.

Decor Advisor: Laura Lofaro

Model and Elevation: 25-1 Elev.B RIVERSTONE

Layout Changes: ☐ Yes ☐ No

Sketch Attached: ☐ Yes ☐ No

Exterior Colour Scheme:

1. Cabinetry

	Style and Colour	Counter	Hardware
Kitchen / Breakfast	*Varese PVC WhtCry	Granite Grigio Sardo STD Edge HE20	CH-51
Laundry Room	*Varese PVC WhtCry		CS1-24
Powder Room	N/A		
Master Ensuite Bathroom	*Varese Oak Greystone	*Caesarstone 9141 Ice Snow Edge HE20	CS1-24
Second Ensuite Bathroom (If Applicable)	N/A		
Main Bath	Varese PVC WhtCry	Arborite P-345 LM Inukshuk Taupe	CS1-24
Dishwasher Cabinet	N/A		

Comment

****UPG - KITCHEN ISLAND DIFFERENT COLOUR: VARESE OAK GREYSTONE**** SEE KITCHEN DRAWING, Island Extended 6" on either side for a total 12" extension

2. Floor Tile

	Selection	Grout	Threshold
Entrance Vestibule	*12x24 Sahara Series Grey Polished		
Main Hall	**Please see Hardwood		
Kitchen / Breakfast	**Please see Hardwood		
Laundry Room	*12x24 Sahara Series Grey Polished		
Powder Room	*12x24 Sahara Series Grey Polished		
Master Ensuite Bathroom	*Jupiter Series Perla (Light Grey) 12x24		
Second Ensuite Bathroom (If Applicable)	N/A		
Lower Landing (If Applicable)			
Main Bath	*Jupiter Series Perla (Light Grey) 12x24		

Comment

Tub Deck / Skirt / Splash: *Jupiter Series Perla (Light Grey)

3. Wall Tile

	Selection	Listello/Inserts	Describe
		<input type="radio"/> Yes <input checked="" type="radio"/> No	
Master Ensuite Bathroom			
Tub Deck	*Jupiter Series Perla (Light Grey)	<input type="radio"/> Yes <input checked="" type="radio"/> No	
Shower Stall	*Chess Bevelled Tender Grey 4x12	<input type="radio"/> Yes <input checked="" type="radio"/> No	
Bathroom Walls	N/A	<input type="radio"/> Yes <input checked="" type="radio"/> No	
Second Ensuite Bathroom (If Applicable)		<input type="radio"/> Yes <input checked="" type="radio"/> No	
Main Bath	*Chess Bevelled Tender Grey 4x12	<input type="radio"/> Yes <input checked="" type="radio"/> No	

Kitchen Backsplash

☐ Yes ☒ No

Backsplash Behind Fridge

Comment

Purchaser: Giovanni Sisti
Telephone Res. / Bus:
Decor Advisor: Laura Lofaro

Property: 23L
Project: Burkshire Holdings Inc.
Model and Elevation: 25-1 Elev.B RIVERSTONE

4. Plumbing Fixtures

<input type="text"/>	Second Ensuite	<input type="text"/>	Powder Room	<input type="text"/>
Master Ensuite Bathroom	<input type="text"/>	Other Room - Specify	<input type="text"/>	Other Washroom
<input type="text"/>		<input type="text"/>		

Comment

UPG** Master Ensuite Sinks Camden Undermount Sink x2 / Faucet x 2
UPG** Kitchen Soap Dispenser

5. Hardwood Flooring

	Type and Stain		Type and Stain
Main Hall	<input type="text"/> *Proveco Red Oak Inox Pro	Upper Landing	<input type="text"/> *Proveco Red Oak Inox Pro
Kitchen / Breakfast	<input type="text"/> *Proveco Red Oak Inox Pro	Upper Hall	<input type="text"/> *Proveco Red Oak Inox Pro
Living Room	<input type="text"/> *Proveco Red Oak Inox Pro	Master Bedroom	<input type="text"/> *Proveco Red Oak Inox Pro
Dining Room	<input type="text"/> N/A	Bedroom #2	<input type="text"/> *Proveco Red Oak Inox Pro
Family Room	<input type="text"/> *Proveco Red Oak Inox Pro	Bedroom #3	<input type="text"/> *Proveco Red Oak Inox Pro
Den/Library	<input type="text"/> N/A	Bedroom #4	<input type="text"/>
Entrance Vestibule	<input type="text"/> N/A	Bedroom #5	<input type="text"/>
Lower Landing (If Applicable)	<input type="text"/>	Other Room - Specify	<input type="text"/>

Comment

6. Carpeting

	Upgrade	Description
Main Hall	<input type="checkbox"/>	<input type="text"/> N/A
Living Room	<input type="checkbox"/>	<input type="text"/> N/A
Dining Room	<input type="checkbox"/>	<input type="text"/> N/A
Family Room	<input type="checkbox"/>	<input type="text"/> N/A
Den/Library	<input type="checkbox"/>	<input type="text"/> N/A
Upper Hall	<input type="checkbox"/>	<input type="text"/> N/A
Master Bedroom	<input type="checkbox"/>	<input type="text"/> N/A
Bedroom #2	<input type="checkbox"/>	<input type="text"/> N/A
Bedroom #3	<input type="checkbox"/>	<input type="text"/> N/A
Bedroom #4	<input type="checkbox"/>	<input type="text"/> N/A
Bedroom #5	<input type="checkbox"/>	<input type="text"/> N/A
<input type="text"/>	<input type="checkbox"/>	<input type="text"/>
Upper Landing (If Applicable)	<input type="checkbox"/>	<input type="text"/> N/A
Lower Landing (If Applicable)	<input type="checkbox"/>	<input type="text"/> N/A

Upgrade Underpad	Type <input type="text"/> N/A	Area <input type="text"/> N/A
Carpet on Stairs	Capped <input type="text"/> N/A	Runner - *Upgrade <input type="text"/> N/A

Comment

Scheduled Closing Date: October-13-16

Purchaser: Giovanni Sisti

Property: 23L

Telephone Res. / Bus:

Project: Burkshire Holdings Inc.

Decor Advisor: Laura Lofaro

Model and Elevation: 25-1 Elev.B RIVERSTONE

7. Fireplace

	Living Room			Family Room			Other Room - Specify		
	Purchased	As Per Plan	N/A	Purchased	As Per Plan	N/A	Purchased	As Per Plan	N/A
	<input type="radio"/>	<input type="radio"/>	<input type="radio"/>	<input type="radio"/>	<input checked="" type="radio"/>	<input type="radio"/>	<input type="radio"/>	<input type="radio"/>	<input type="radio"/>
Fireplace Type				STD					
Mantle Type				STD Cast Stone					
Colour / Stain									
Surround									
Hearth				Declined					
Comment	Standard Cast Fireplace Mantle without Hearth								

8. Trim Carpentry

Interior Doors	***STD	Front Door Glass Inserts	STD	Door Handles	STD
Interior Trim	UPG 2				
Comment	***Extended Archways and Doors ordered at Structural Appointment***				

9. Plaster Mouldings and Medallions

Entrance Vestibule	N/A	N/A	Kitchen/Breakfast	N/A	N/A
Main Hall	N/A	N/A	Den/Library	N/A	N/A
Living Room	N/A	N/A	Lower Landing	N/A	N/A
Dining Room	N/A	N/A	Other Room - Specify	N/A	
Family Room	N/A	N/A			
Comment					

10. Railings and Spindles

Railing Package	*V-Groove		
Railing Colour	*INOX	Spindle Colour	Iron Black
Stringer / Riser	*INOX	Treads	*INOX
Comment	Oak Stairs <input checked="" type="radio"/> Yes <input type="radio"/> No		
Railing and Stair Stain to Match Hardwood as close as possible. Preverco Red Oak INOX Pro			

11. Wall Paint

Main & Upper Hall		Master Bedroom	
Living Room		Bedroom #2	
Dining Room		Bedroom #3	
Kitchen / Breakfast		Bedroom #4	
Family Room		Bedroom #5	
Powder Room		Master Ensuite	
Laundry Room			
Den/Library		Second Ensuite	
Trim Paint			
Comment	Smooth Ceilings First Floor		
Cool White Throughout			

Scheduled Closing Date: October-13-16

Purchaser: Giovanni Sisti

Property: 23L

Telephone Res. / Bus:

Project: Burkshire Holdings Inc.

Decor Advisor: Laura Lofaro

Model and Elevation: 25-1 Elev.B RIVERSTONE

12. Electrical

Plugs and Switches ☒ White ☐ Ivory

Hood Fan ☐ White ☐ Ivory

Appliances

Built in Cooktop

Built in Oven

Gas Stove

Microwave

Comment

Above Kitchen Cabinet Light ☐ Yes ☐ No

Below Kitchen Cabinet Light ☐ Yes ☐ No

☐ Yes ☐ No

☐ Yes ☐ No

☐ Yes ☐ No

☐ Yes ☐ No

13. Heating and Air Conditioning

Air Conditioning

Gas Provisions Dryer

Comment

Gas Provisions Stove

Gas Provisions Barbecue

14. Additional Comments

15. Disclaimers and Notes

- Colours of all materials are as close as possible to builder's selection, but not necessarily identical due to variances in manufacturing.
- Any extras listed above are null and void unless accompanied by a separate invoice/amendment. Said invoice must be paid in full.
- The Purchaser acknowledges that after Interior Colour Selection form is signed and dated, no further changes will be permitted other than re-selection due to unavailability. MS Purchaser's Initials
- The Purchaser acknowledges reading and accepting the "Gold Park Homes Decor Centre Disclaimers" form. This document contains other miscellaneous disclaimers.

This Interior Colour Selection is final and approved by:

Signature: Giovanni Sisti Date: NOV. 17 2016

CORTINA

KITCHENS INC.
70 Regina Road, Woodbridge, Ontario L4L 8L6
Tel: 905-284-6484 Fax: 905-284-0884
www.CortinaKitchens.com

QUOTATION

Date: 28/06/16

Trade Name: Gold Park Homes

Site location:

Model: 25-1

Address: LOT 23L

Project: Kleinburg Glen

Phase:

This layout has been explained to the purchaser by Cortina Kitchens Inc. and is understood by the purchaser.

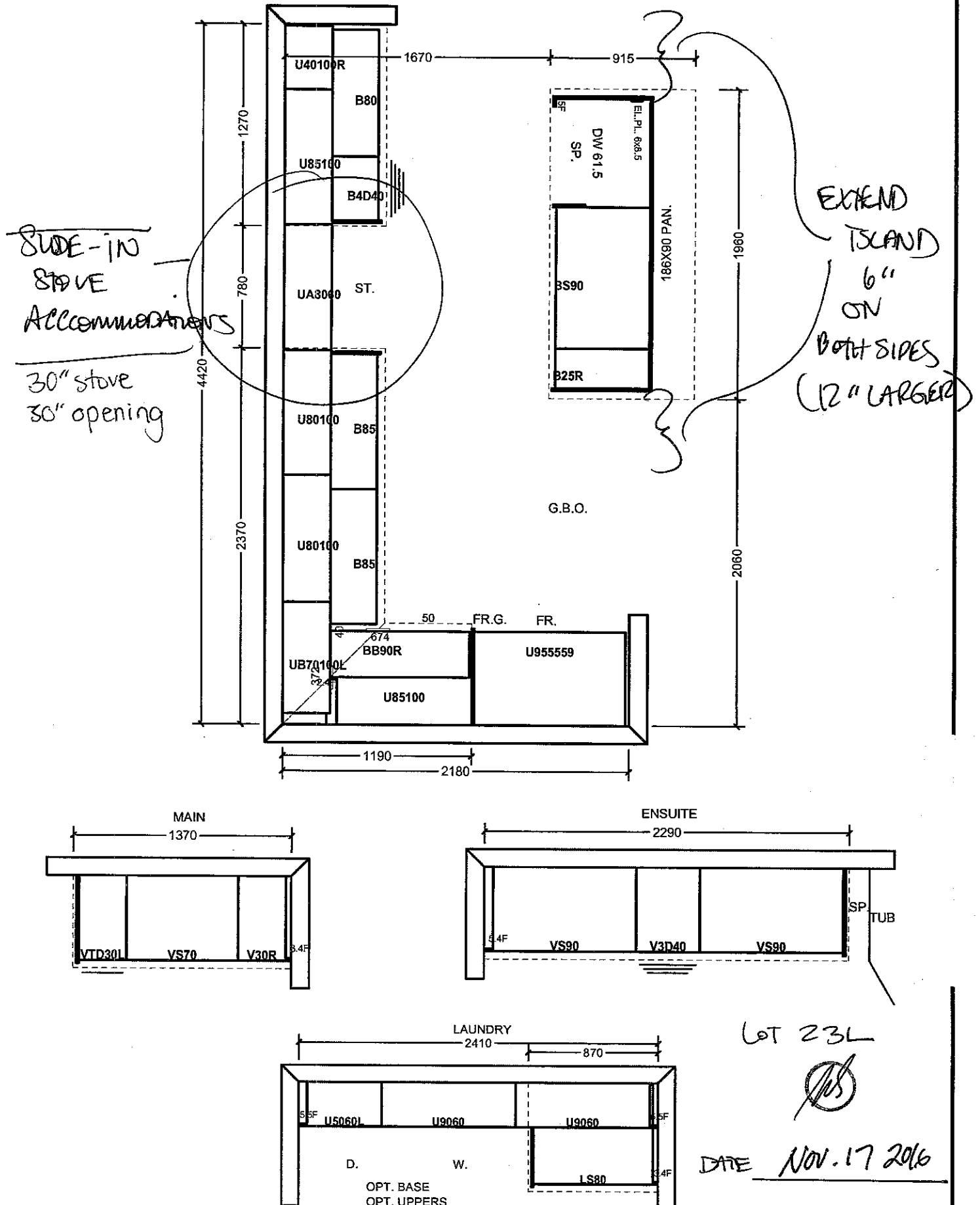

All prices subject to confirmation from head office.
This quotation is subject to the terms & conditions set out

All agreements are contingent upon strikes, accidents, and delays beyond our control.
Please provide our installer with template for sinkholes or \$150.00 will be charged for callback.

ACCEPTED DATE: _____

LOT 23L
[Signature]
DATE Nov. 17 2016

Item A. Wood grain and colour are characteristics of the product. We cannot guarantee that such grain and colour will always match.
Item B. Cortina Kitchens Inc. reserves the right to alter dimensions and make technical changes without notice.

CORTINA

KITCHENS INC.

70 Regina Road Woodbridge ON L4L 8L6
905-264-6464

INFORMATION - PVC DOORS

Builder GOLD PARK Project KLEINBURG Lot # 23L

All cabinets with PVC (Thermofoil) Doors come with melamine gables, panels and kick. The doors, crown moulding and light valance are PVC wrapped. Open shelves incorporated in design will only be available with melamine interiors. There will be variations in colour shades between the PVC parts (doors, crown and Light valance) and the melamine parts (open shelves, Gables, Panels and Kick) due to the difference in material.

Furring Panel with crown moulding to the ceiling is not available on all PVC door styles due to subtle variations in colour shades between the PVC parts (moulding) and the melamine parts (furring panel) due to the difference in material. Grain directions in wood grain pattern melamine, vary between the furring panel, crown moulding (horizontal) and the PVC doors (vertical).

Thank you for your understanding.

I am well informed of this information, and agree to the purchase of the above.

Purchaser: 

Date: Nov. 17 2016

UPGRADE HARDWARE



CH-32



CH-38

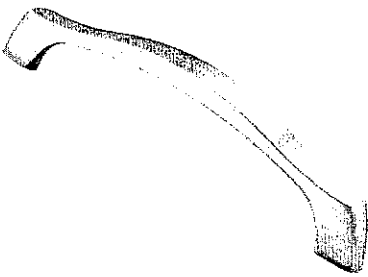

CH-44

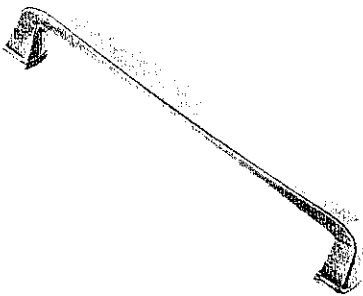

CH-45

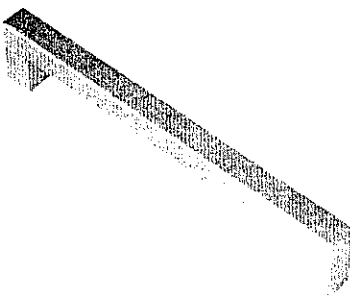

CH-46

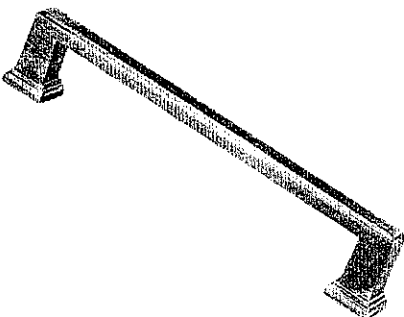

CH-47

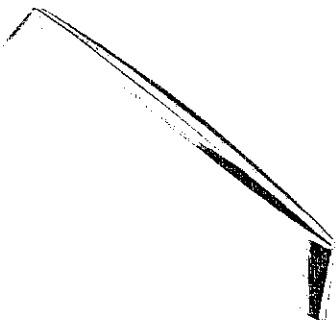

CH-48

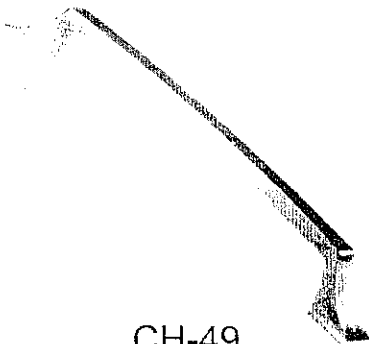

CH-49



CH-50

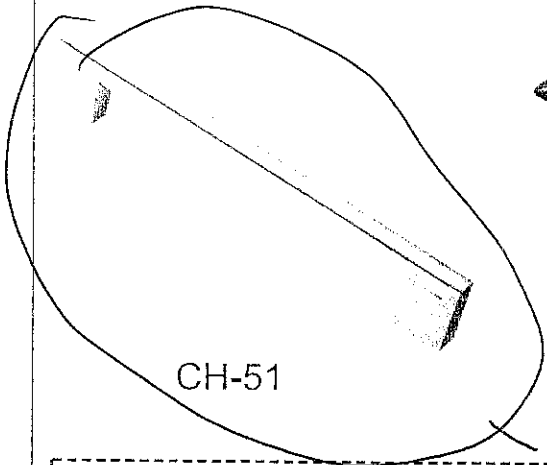

CH-51

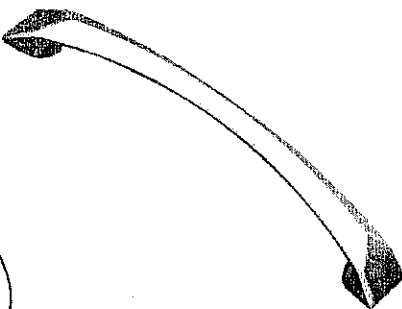

CH-52

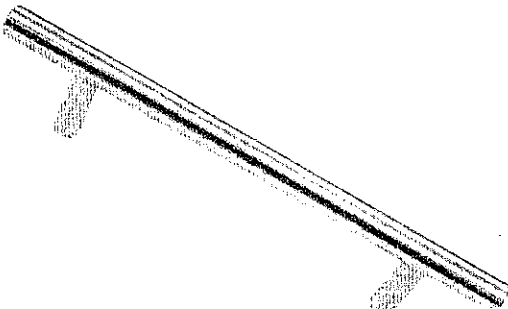

CH-53

*NOTES:

- IMAGES ARE FOR QUICK REFERENCE PURPOSES ONLY
- ACTUAL SIZES AND FINISHES AS PER HARDWARE
- SAMPLE BOARD PROVIDED TO DECOR CENTRE

KITCHEN

KLEINBURG GLEN

LOT 23 L

NOV. 16. 2016

STANDARD HARDWARE



CSI-6



CSI-10



CSI-14



CSI-16

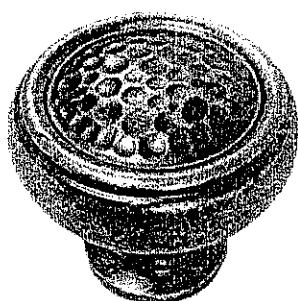

CSI-18

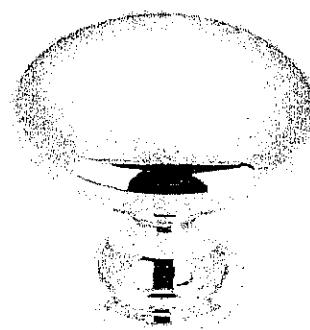

CSI-19

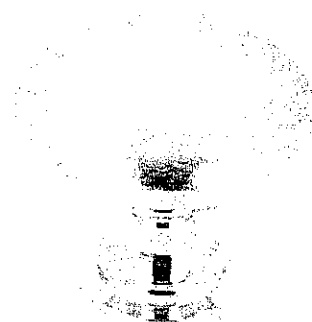

CSI-20

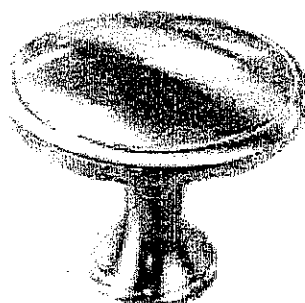

CSI-21



CSI-22

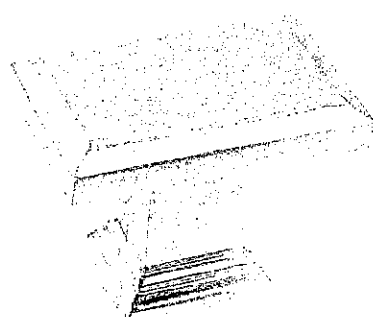

CSI-23

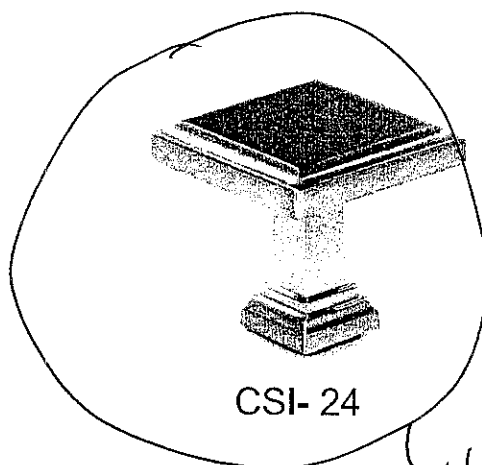

CSI-24

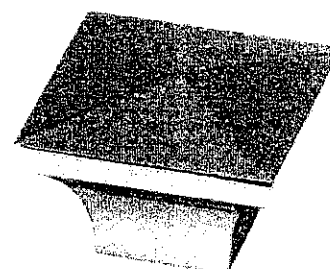

CSI-25

***NOTES:**

- IMAGES ARE FOR QUICK REFERENCE PURPOSES ONLY
- ACTUAL SIZES AND FINISHES AS PER HARDWARE
- SAMPLE BOARD PROVIDED TO DECOR CENTRE

LAUNDRY
- MASTER ENSUITE
- MAIN BATH

KWENBURG & LEM
LOT 23 L
NOV. 16. 2016

Elevation A • 1,849 sq.ft.

Elevation B • 1,849 sq.ft.

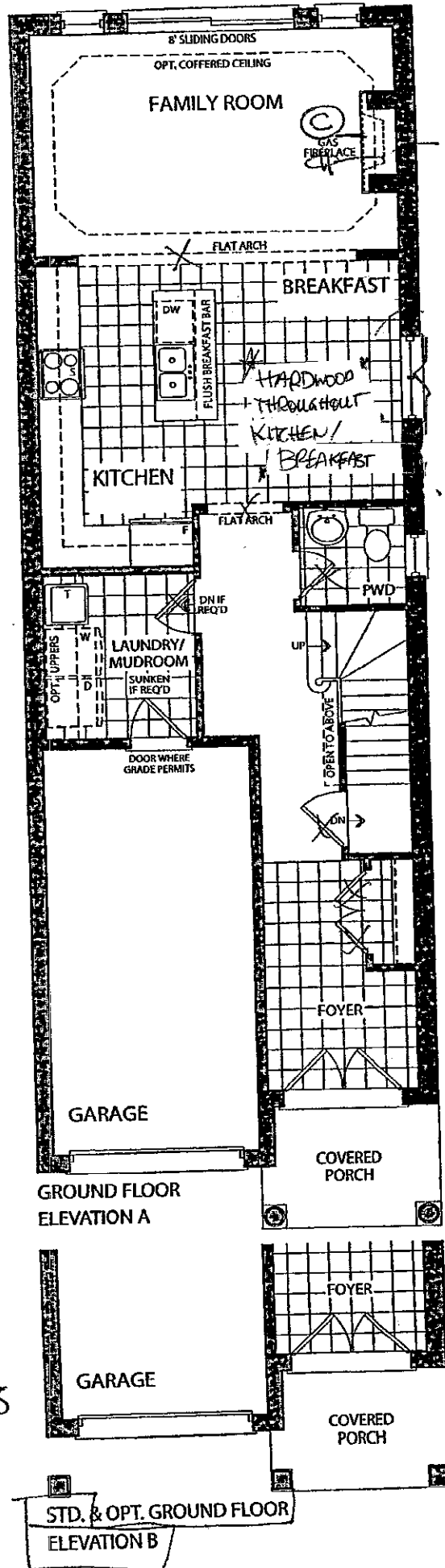

LOT 23L

DATE: Nov. 17 2016

LOT 23L

July 29 2016

*
- EXTEND ARCHWAYS
- EXTEND DOOR HEIGHTS
*

CAB.

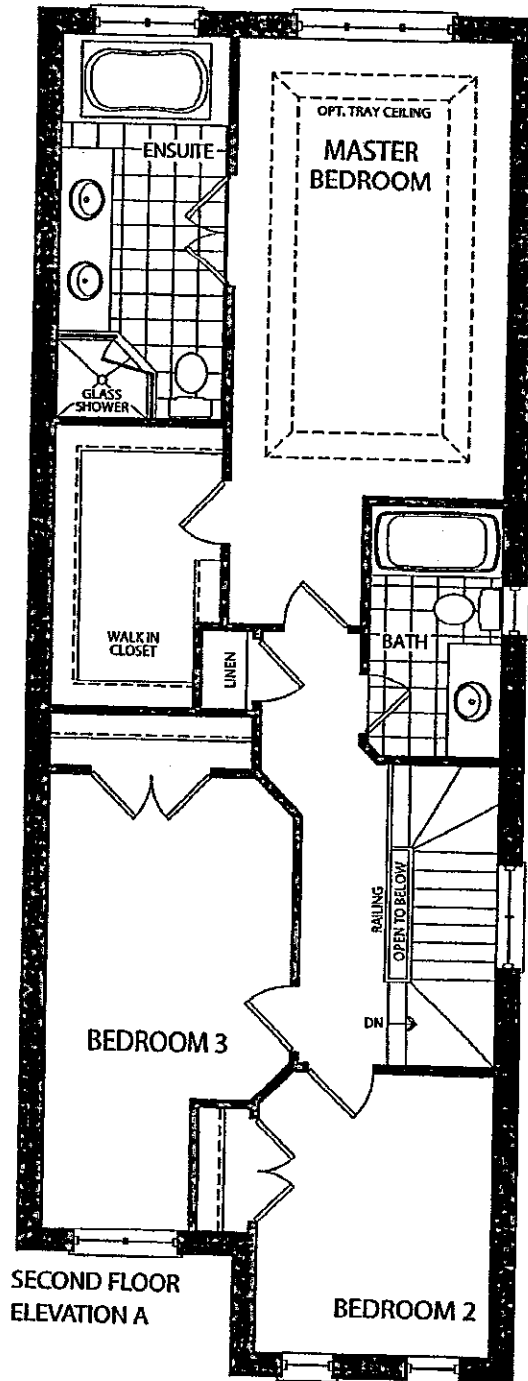

★ *SMOOTH
CEILING* ★

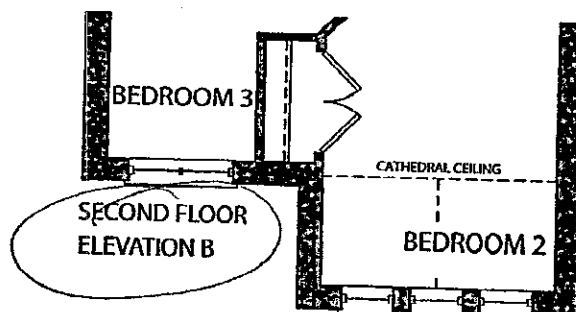

LOT 23L

DATE:

MS
Nov. 17 2016

LOT 23L

MS
July 20, 2016

Elevation A • 1,849 sq.ft.

Elevation B • 1,849 sq.ft.

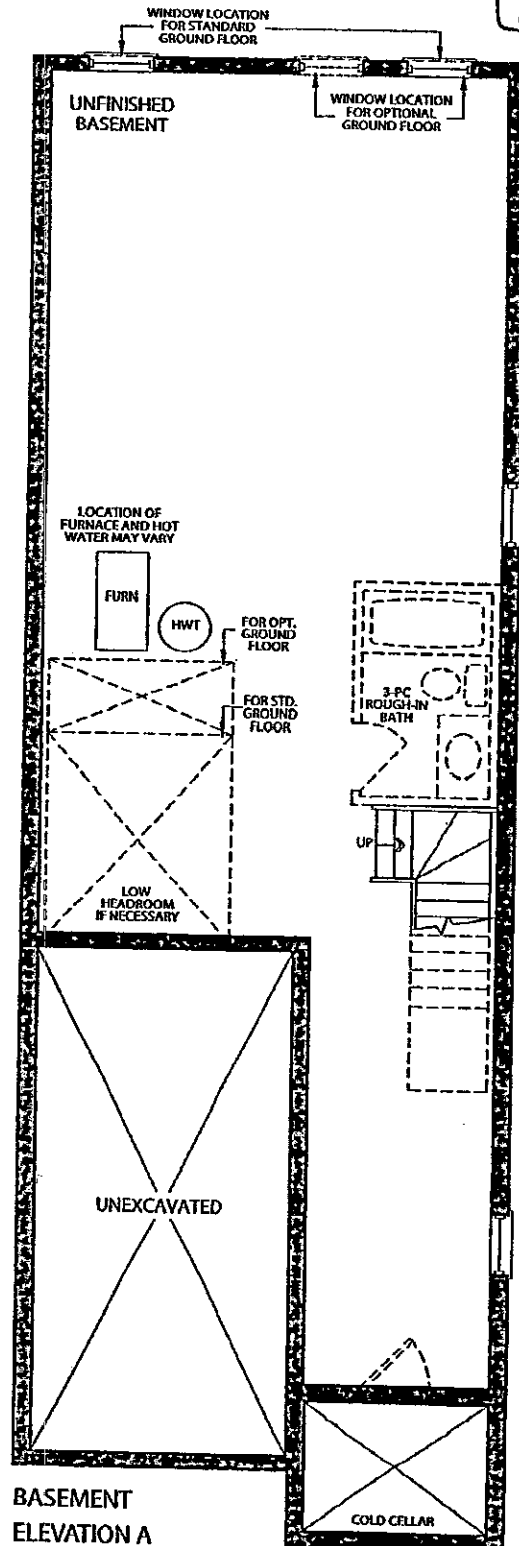

BASEMENT
ELEVATION A

LOT 23L

[Signature]

DATE: NOV. 17 2016

LOT 23L

[Signature]

July 20, 2016

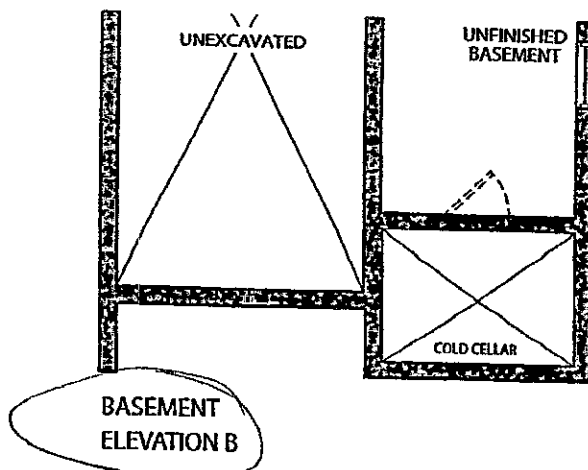

BASEMENT
ELEVATION B

Addison™ Collection

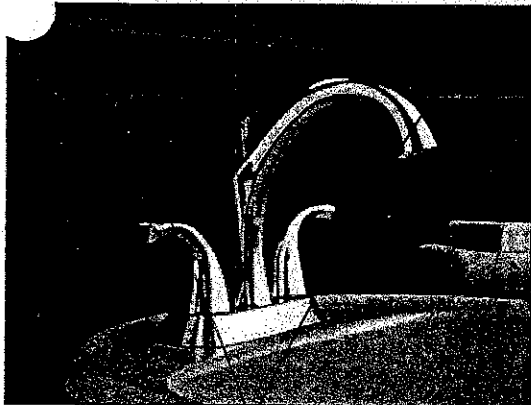

Lavatory 4" Centreset

Chrome Finish
2592-MFU-DST

Brilliance® Stainless Finish
2592-SSMPU-DST

Champagne Bronze™ Finish
2592-CZMPU-DST

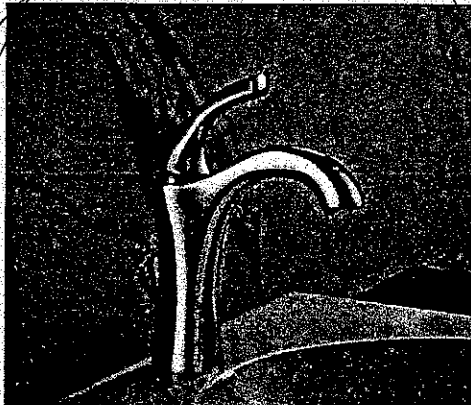

Lavatory
Single or three holes with plate

Chrome Finish ~~# 592-DST~~ **# 354**

Brilliance® Stainless Finish
592-SS-DST

Champagne Bronze™ Finish
592-CZ-DST



Vessel Lavatory



Chrome Finish
792-DST

Brilliance® Stainless Finish
792-SS-DST

Champagne Bronze™ Finish
792-CZ-DST

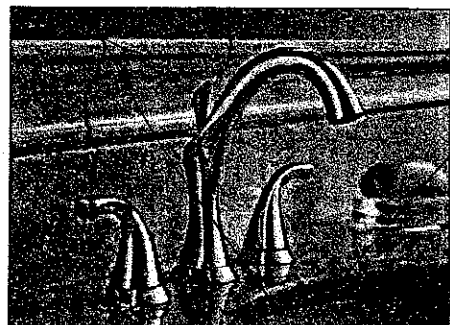
Applies to faucets shown above



Lavatory Widespread with pop up  
3592LF

Brilliance® Stainless Finish
3592LF-SS

Champagne Bronze™ Finish
3592LF-CZ

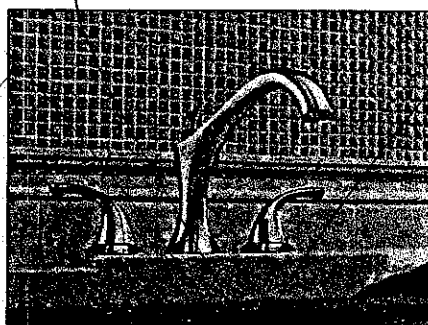

Roman Tub - 3 Piece
T2792 / R2709

Brilliance® Stainless Finish
T2792-SS / R2709

Champagne Bronze™ Finish
T2792-CZ / # R2709

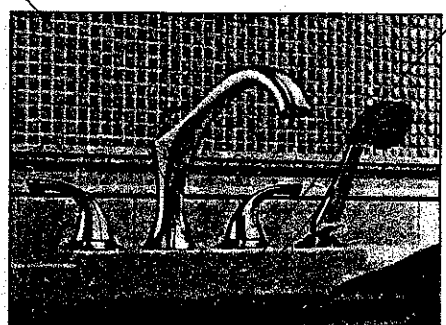

Roman Tub - 4 Piece
T4792 / R4716

Brilliance® Stainless Finish
T4792-SS / R4716

Champagne Bronze™ Finish
T4792-CZ / R4716

Shown in Chrome

 DELTA

MASTER ENSURE
X2

KLEINBURG GLEN
LOT 23L

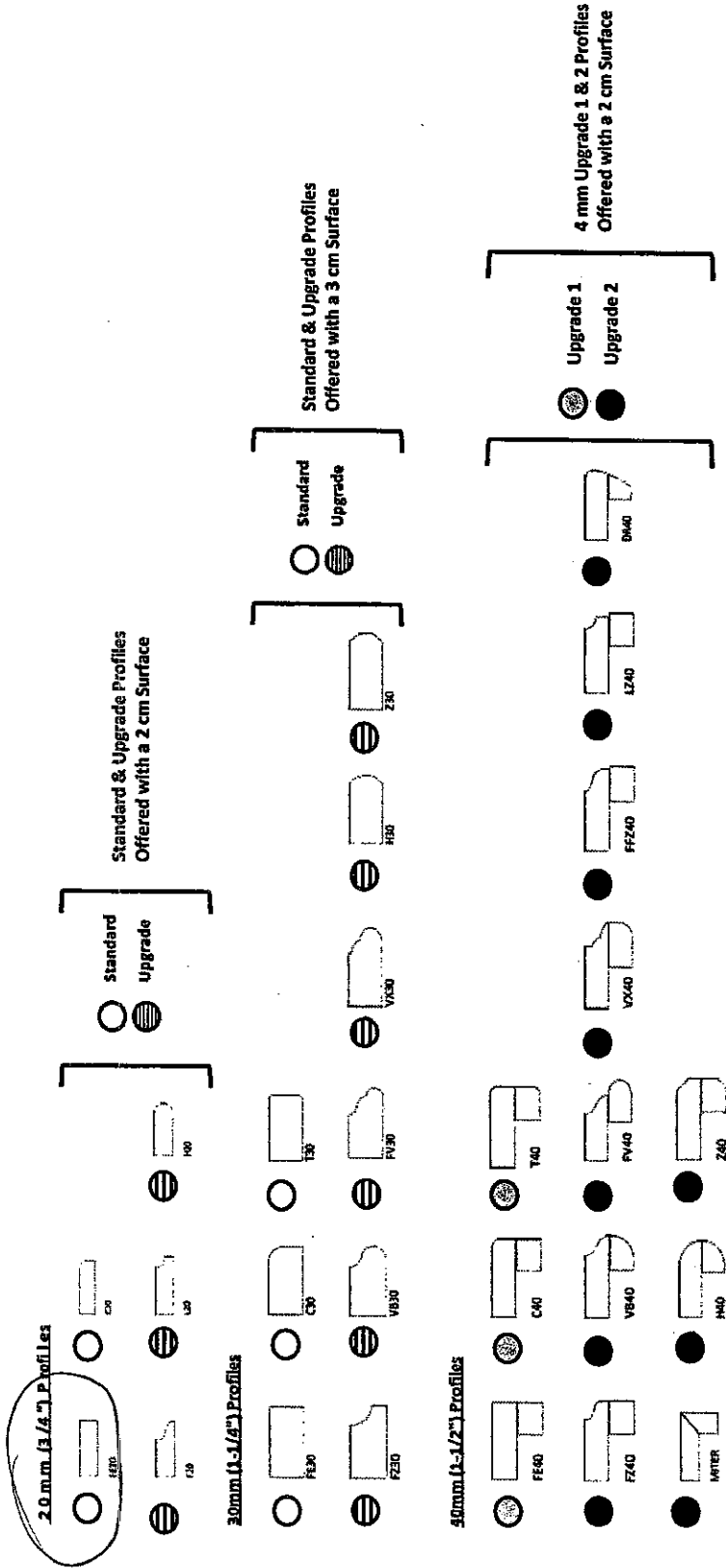
NOV-17, 2016



KLEINBURG GLEN
LOT 23L

NOV. 17.2016

Camden

4210CHY 16" Square Undermount Sink

2016 décor center catalogue

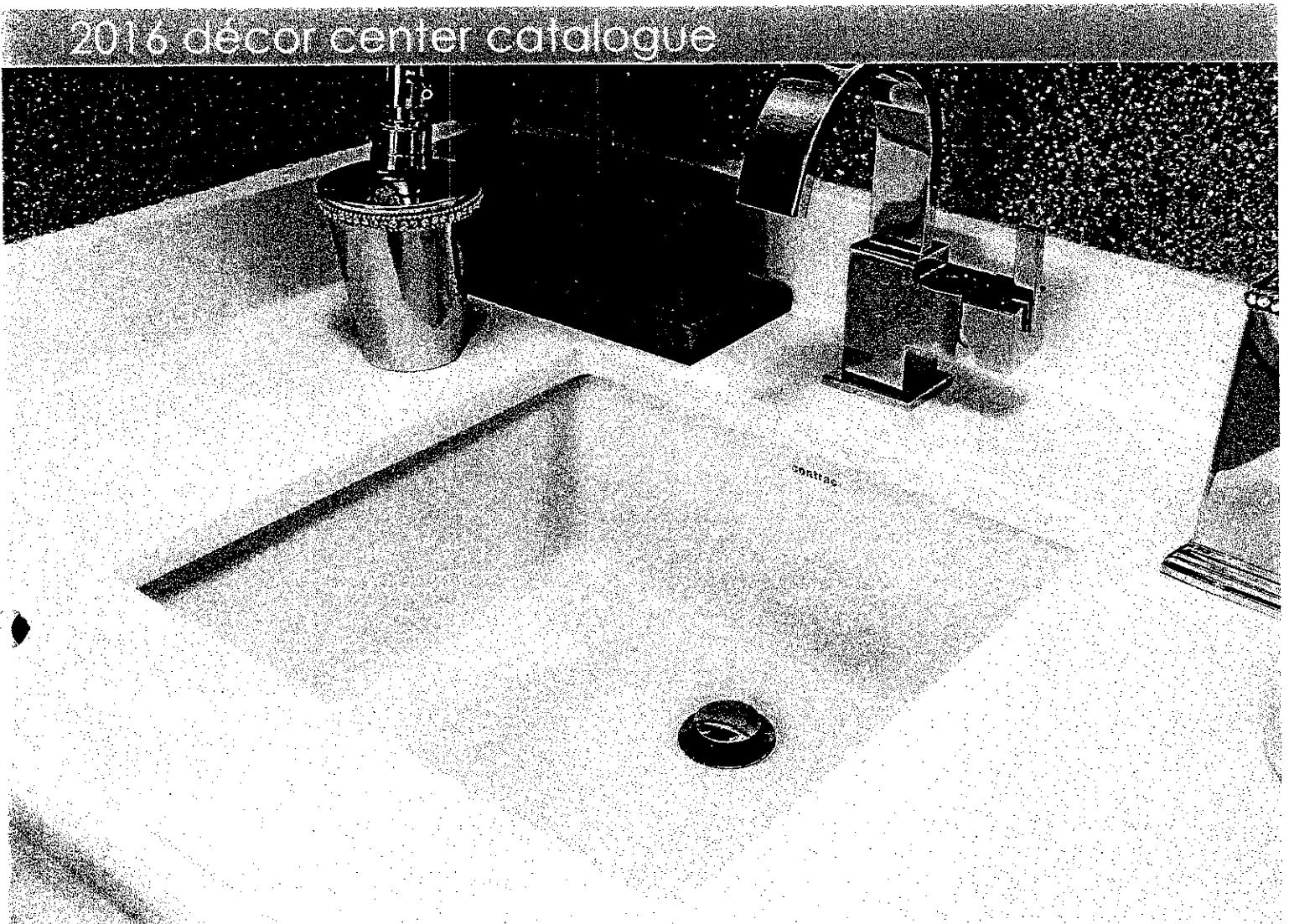

FEATURES

Vitreous china
Front overflow hole
Template and mounting hardware supplied
Overall dimensions (W x D x H):
(OD) 16" x 16" x 7½"
(ID) 13¾" x 13¾" x 5½"

CERTIFICATIONS

IAPMO cUPC
ASME A112.19.2 / CSA B45.1-2008

COLOUR

Soft white

\$478-
(incl polish)



contrac
www.contrac.ca

The images shown are a representation of the finish and color, and may not reflect every characteristic possible.

Issued: Feb. 2016

Kitchen – Soap Dispensers

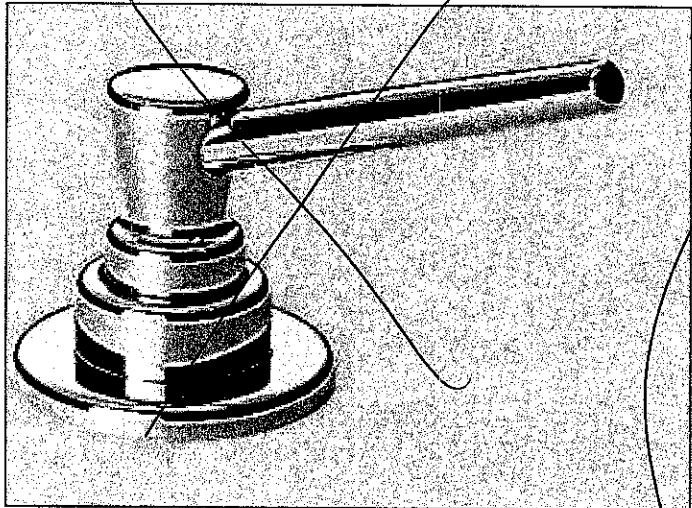

Soap Dispenser

Chrome Finish
RP1001

Arctic™ Stainless Finish
RP1001AR

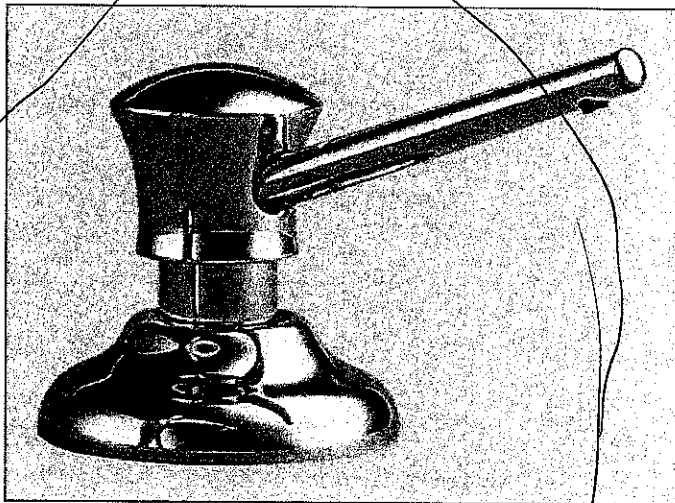

Soap Dispenser

Chrome Finish
RP1002

Arctic™ Stainless Finish
RP1002AR

Champagne Bronze™ Finish
RP1002CZ

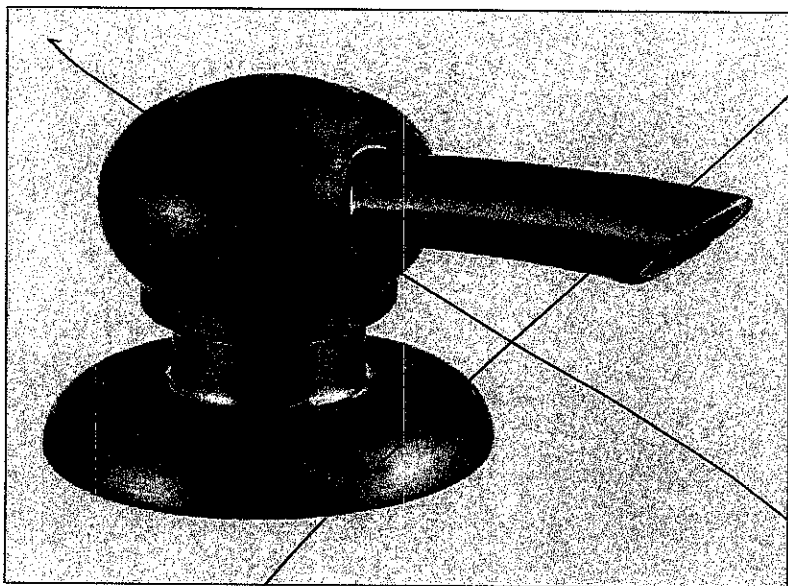

Soap Dispenser

Chrome Finish
RP50813

Arctic™ Stainless Finish
RP50813AR

Champagne Bronze™ Finish
RP50813CZ

KLEINBURG, GLEN

LOT 23 L



Nov. 16. 2016