

Kleinburg Glen - 15 - 1 - 42-4 Elev.B NATIONAL OPT- SFA5

CENTRAL VAC AND WIRING

Inv.511	1 - LAUNDRY ROOM Install and additional ROUGH - IN FOR EXTRA SECURITY KEY PAD (see sketch)
Line6513	Note:
20May16 / 3Nov16	
Inv.511	1 - GREAT ROOM - Install a CONDUIT PIPE - FOR TELEVISION - MUST SPECIFY LOCATION AND TERMINATION POINT from Great Room to basement for future TV above fireplace, approx. 60" A.F.F., see plan for location
Line6514	Note:
20May16 / 3Nov16	
Inv.511	1 - DEN - Install an additional cable rough-in in Den, see sketch
Line6529	Note:
20May16 / 3Nov16	

CERAMIC

Inv.1,014	1 - KITCHEN FLOOR TILE: Upgrade 5 floor tile 24x24" laid straight, stacked pattern.
Line14536	Note:
24Nov16 / 13Dec16	
Inv.1,014	1 - FOYER FLOOR TILE: Upgrade 5 floor tile 24x24" laid straight, stacked pattern.
Line14538	Note:
24Nov16 / 13Dec16	
Inv.1,014	1 - POWDER ROOM FLOOR TILE: Upgrade 5 floor tile 24x24"" laid straight, stacked pattern.
Line14539	Note:
24Nov16 / 13Dec16	
Inv.1,014	1 - MASTER ENSUITE: Upgrade 1 wall tile 4x16" laid in VERTICAL-STACKED pattern in shower.
Line14545	Note:
24Nov16 / 13Dec16	

DRYWALL

Inv.511	1 - SMOOTH CEILINGS - (2 - Story Design) SECOND FLOOR
Line6516	Note:
20May16 / 3Nov16	

ELECTRICAL

Inv.511	1 - 1 - GREAT ROOM - Install a 110V WALL RECEPTACLE ON NORMAL CIRCUIT - MUST SPECIFY LOCATION above fireplace for future TV, approx. 60" A.F.F., see plan for location
Line6523	Note:
20May16 / 3Nov16	
Inv.1,014	1 - KITCHEN: Add 110V WALL RECEPTACLE ON DEDICATED CIRCUIT - FOR MICROWAVE - MICROWAVE NOT INCLUDED - for built-in microwave. See plan for location.
Line14546	Note:
24Nov16 / 13Dec16	
Inv.1,014	1 - KITCHEN ELECTRICAL: Add a 240V WALL RECEPTICAL ON DEDICATED CIRCUIT - FOR 4 WIRE BUILT - IN WALL OVEN. See plan for location.
Line14547	Note:
24Nov16 / 13Dec16	

EXTERIOR COLOURS

Kleinburg Glen - 15 - 1 - 42-4 Elev.B NATIONAL OPT- SFA5

Inv.941	1 - EXTERIOR COLOUR PACKAGE 4
Line13380	Note:
3Nov16 / 3Nov16	

FRAMING

Inv.511	1 - OPTIONAL SECOND FLOOR 5TH BEDROOM
Line13375	Note:
20May16 / 3Nov16	

GARAGE DOORS

Inv.511	1 - GARAGE DOOR OPENER - WITH 1 REMOTE - PRICE IS PER DOOR
Line6538	Note:
20May16 / 3Nov16	

Inv.511	1 - EXTRA REMOTE CONTROL FOR GARAGE DOOR
Line6539	Note:
20May16 / 3Nov16	

GLASS AND MIRROR

Inv.511	1 - MASTER ENSUITE - CONVERT FRAMED SHOWER TO 10MM FRAMLESS SHOWER ENCLOSURE WITH DOOR AND 10MM SIDE PANEL
Line6517	Note:
20May16 / 3Nov16	

GRANITE MARBLE QUARTZ

Inv.1,014	1 - KITCHEN STONE COUNTER TOP: Add granite for cooktop (appliance spec's required)
Line14537	Note:
24Nov16 / 13Dec16	

Inv.1,014	1 - KITCHEN STONE COUNTER TOP: Upgrade 5 Caesar stone
Line14638	Note:
24Nov16 / 13Dec16	

Inv.1,014	1 - KITCHEN STONE COUNTER TOP: Upgrade edge FE-40
Line14641	Note:
24Nov16 / 13Dec16	

HARDWOOD

Inv.1,014	1 - LIVING / DINING / MAIN HALL / DEN / GREAT ROOM / UPPER LANDING / LOWER LANDING: Upgrade 4 hardwood floor - 3/4 x 5" Preverco White Oak 'Brushed Finish"
Line14541	Note:
24Nov16 / 13Dec16	

Inv.1,014	1 - UPPER HALL / MASTER BEDROOM / BEDROOM 2 / BEDROOM 3 / BEDROOM 4 / BEDROOM 5: Upgrade 4 hardwood floor - 3/4 x 5" Preverco White Oak 'Brushed Finish"
Line14542	Note:
24Nov16 / 13Dec16	

HVAC

Inv.511	1 - HUMIDIFIER: WB3 - 17 (UP TO 3,000 SQ.FT.)
Line6518	Note:
20May16 / 3Nov16	

INTERIOR TRIM AND DOORS

Kleinburg Glen - 15 - 1 - 42-4 Elev.B NATIONAL OPT- SFA5

Inv.1,014	1 - MAIN FLOOR *only* TRIM: Upgrade package 2 **standard trim on 2nd floor**
Line14553	Note:
24Nov16 / 13Dec16	

KITCHEN AND BATH CABINETRY

Inv.1,014	1 - KITCHEN CABINETRY: DELETE upper cabinets above stove for future chimney-style hood fan. Leave approx. 36" opening for 30" hood fan.
Line14530	Note:
24Nov16 / 13Dec16	
Inv.1,014	1 - KITCHEN CABINETRY: CABINETRY CROWN MOULDING + FURRING PANEL
Line14531	Note:
24Nov16 / 13Dec16	
Inv.1,014	1 - KITCHEN CABINETRY: ADD UPPER AND BASE CABINETRY TO STANDARD KITCHEN TO CREATE BUILT-IN WALL OVEN AND MICROWAVE TOWER (or double oven), AND COOKTOP (with countertop by others) 242cm
Line14532	Note:
24Nov16 / 13Dec16	
Inv.1,014	1 - KITCHEN CABINETRY: Add pots and pans drawers below cook top cabinet. (1 false top drawer + 2 deep pots and pans drawers)
Line14533	Note:
24Nov16 / 13Dec16	
Inv.1,014	1 - KITCHEN CABINETRY: Magic corner (pull-out hardware) for base blind corner cabinet
Line14534	Note:
24Nov16 / 13Dec16	
Inv.1,014	7 - KITCHEN CABINETRY *ISLAND*: Add dummy doors to island back and side gables
Line14535	Note:
24Nov16 / 13Dec16	
Inv.1,014	1 - KITCHEN CABINETRY: Upgrade hardware CH-51
Line14643	Note:
24Nov16 / 13Dec16	

MISC.

Inv.511	1 - Purchasers are aware & accepts that ANY changes made to upgrades after signing this Purchasers Extra Form are subject to a minimum administration fee of \$500. PLUS a 10% holdback fee.
Line6543	Note:
20May16 / 3Nov16	
Inv.511	1 - STRUCTURAL DISCLAIMER: Purchaser has attended a Structural appointment at the Decor Centre & has DECLINED any additional upgrades and accepts and acknowledges that there will be no further structural changes/additions/deletions to be made upon
Line6542	Note:
20May16 / 3Nov16	
Inv.511	1 - BONUS PACKAGE: \$10,000.00 (INCLUDING TAXES) WORTH OF UPGRADES FROM GOLD PARK HOMES DÉCOR CENTRE IS BEING APPLIED TOWARD THE STRUCTURAL APPOINTMENT. PURCHASER HAS A REMAINING AMOUNT OF \$00 (INCLUDING TAXES) TO BE USED TOWARD THE COLOUR APPOINTMENT.
Line6544	Note:
20May16 / 3Nov16	

**Kleinburg Glen - 15 - 1 - 42-4 Elev.B NATIONAL OPT- SFA5**

Inv.1,014	1 - Purchaser has attended a Colour appointment at the Decor Centre & has DECLINED any additional upgrades and accepts and acknowledges that there will be no further changes/additions/deletions to be made upon signing on November 24, 2016.
Line14548	Note:
24Nov16 / 13Dec16	
Inv.1,014	1 - Purchasers are aware & accepts that ANY changes made to upgrades after signing this Purchasers Extra Form are subject to a minimum administration fee of \$500. PLUS a 10% holdback fee.
Line14549	Note:
24Nov16 / 13Dec16	
Inv.1,014	1 - STAIRCASE - The purchaser was advised and therefore accepts and acknowledges that the wood species of the staircase and flooring chosen do not match in colour, texture or species. This difference may result in a stain colour variance.
Line14550	Note: The purchaser agrees that the vendor is to be exempt from any and all claims by the purchaser regarding this colour variance.
24Nov16 / 13Dec16	
Inv.1,014	1 - KITCHEN - Purchasers request to NOT INSTALL builder's standard hood fan and standard cabinets above stove. DELETE. Do not supply, install, and/or credit. Purchasers are installing their own hood fan after closing.
Line14551	Note:
24Nov16 / 13Dec16	
Inv.1,014	1 - KITCHEN - Purchaser accepts & acknowledges that in order to either complete or install built-in appliances and accommodate for cook-top, all appliance specifications must be provided to the Décor Center within one (1) week of completion of colour chart.
Line14552	Note:
24Nov16 / 13Dec16	

**PAINTING**

Inv.1,014	1 - MAIN STAIRS: Stain stairs and handrail "Preverco 'Komodo'. Note: Home owner acknowledges that stairs will not match hardwood floors in colour, texture, finish or species.
Line14544	Note:
24Nov16 / 13Dec16	

**PLUMBING**

Inv.511	1 - KITCHEN - Install a ROUGH - IN - WATERLINE FOR FRIDGE
Line6525	Note:
20May16 / 3Nov16	
Inv.1,014	1 - KITCHEN: Upgrade sink to Blanco Quatrus U2 #401247 stainless steel
Line14540	Note:
24Nov16 / 13Dec16	

**STAIRS AND RAILINGS**

Inv.1,014	1 - MAIN STAIRS: Euroline 1 + V Groove
Line14543	Note:
24Nov16 / 13Dec16	

**WINDOWS - BASEMENT**

Inv.511	5 - BASEMENT WINDOWS - UPGRADE EXISTING BASEMENT WINDOW TO 30 INCH X 24 INCH - MAY REQUIRE INSTALLATION OF WINDOW WELL
Line6520	Note:
20May16 / 3Nov16	

Scheduled Closing Date: Monday, September 12, 2016

Purchaser: Sana Breka Yousif

Property: 15

Telephone Res. / Bus: (416) 455-6586

Project: Burkshire Holdings Inc.

Decor Advisor: Yolande Somerville

Model and Elevation: 42-4 Elev.B NATIONAL OPT- SFA5

Layout Changes: ☐ Yes ☒ NoSketch Attached: ☒ Yes ☐ No

Exterior Colour Scheme:

## 1. Cabinetry

	Style and Colour	Counter	Hardware
Kitchen / Breakfast	Varese pvc 'white crystal'	*Quartz#5133 Symphony Grey *Edge: FE-40	*CH-51
Laundry Room	n/a	n/a	n/a
Powder Room	n/a	n/a	n/a
Twin 2/3	Varese pvc 'mystic'	P-lam #P-344-LM 'Inukshuk Grey'	cs1-24
Master Ensuite Bathroom	Varese pvc 'mystic'	P-lam #P-344-LM 'Inukshuk Grey'	cs1-24
Second Ensuite Bathroom (If Applicable)	n/a	n/a	n/a
Twin 4/5	Varese pvc 'mystic'	P-lam #P-344-LM 'Inukshuk Grey'	cs1-24
Dishwasher Cabinet	n/a		

Comment

## 2. Floor Tile

	Selection	Grout	Threshold
Entrance Vestibule	*24x24" Timeless 'Light Grey Polished'	n/a	n/a
Main Hall	n/a	n/a	n/a
Kitchen / Breakfast	*24x24" Timeless 'Light Grey Polished'	n/a	n/a
Laundry Room	13x13" New Reeds 'Brown'	n/a	n/a
Powder Room	*24x24" Timeless 'Light Grey Polished'	n/a	n/a
Twin 2/3	13x13" New Byzantium 'Azzuro Blue'	n/a	n/a
Master Ensuite Bathroom	13x13" New Byzantium 'Azzuro Blue'	n/a	n/a
Second Ensuite Bathroom (If Applicable)	n/a	n/a	n/a
Lower Landing (If Applicable)	n/a	n/a	n/a
Twin 4/5	13x13" New Byzantium 'Azzuro Blue'	n/a	n/a

Comment

## 3. Wall Tile

	Selection	Listello/Inserts	Describe
Twin 2/3	8x10" Reflection 'White'	<input type="radio"/> Yes <input checked="" type="radio"/> No	
Master Ensuite Bathroom			
Tub Deck	n/a	<input type="radio"/> Yes <input checked="" type="radio"/> No	
Shower Stall	*4x16" CDC 'Taupe Bright'	<input type="radio"/> Yes <input checked="" type="radio"/> No	
Bathroom Walls	n/a	<input type="radio"/> Yes <input checked="" type="radio"/> No	
Second Ensuite Bathroom (If Applicable)	n/a	<input type="radio"/> Yes <input checked="" type="radio"/> No	
Twin 4/5	8x10" Reflection 'White'	<input type="radio"/> Yes <input checked="" type="radio"/> No	

Kitchen Backsplash ☐ Yes ☒ No

Backsplash Behind Fridge

Comment

B

Purchaser: Sana Breka Yousif  
Telephone Res. / Bus: (416) 455-6586  
Decor Advisor: Yolande Somerville

Property: 15  
Project: Burkshire Holdings Inc.  
Model and Elevation: 42-4 Elev.B NATIONAL OPT- SFA5

4. Plumbing Fixtures

<input type="checkbox"/>	Second Ensuite	<input type="checkbox"/>	Powder Room	<input type="checkbox"/>
Master Ensuite Bathroom	<input type="checkbox"/>	Other Room - Specify	<input type="checkbox"/>	Other Washroom
<input type="text"/>				

Comment

Standard thru out, EXCEPT kitchen sink

5. Hardwood Flooring

	Type and Stain		Type and Stain
Main Hall	*3/4x5" Wht oak brshd 'Greenwich'	Upper Landing	*3/4x5" Wht oak brshd 'Greenwich'
Kitchen / Breakfast	n/a	Upper Hall	*3/4x5" Wht oak brshd 'Greenwich'
Living Room	n/a	Master Bedroom	*3/4x5" Wht oak brshd 'Greenwich'
Dining Room	*3/4x5" Wht oak brshd 'Greenwich'	Bedroom #2	*3/4x5" Wht oak brshd 'Greenwich'
Family Room	*3/4x5" Wht oak brshd 'Greenwich'	Bedroom #3	*3/4x5" Wht oak brshd 'Greenwich'
Den/Library	*3/4x5" Wht oak brshd 'Greenwich'	Bedroom #4	*3/4x5" Wht oak brshd 'Greenwich'
Entrance Vestibule	n/a	Bedroom #5	*3/4x5" Wht oak brshd 'Greenwich'
Lower Landing (If Applicable)	*3/4x5" Wht oak brshd 'Greenwich'	Other Room - Specify	n/a
		<input type="text"/>	

Comment

Hardwood thru out non-tiled areas: Preverco White Oak 3/4 x 5" brushed finish 'Greenwich'

6. Carpeting

	Upgrade	Description
Main Hall	<input type="checkbox"/>	n/a
Living Room	<input type="checkbox"/>	n/a
Dining Room	<input type="checkbox"/>	n/a
Family Room	<input type="checkbox"/>	n/a
Den/Library	<input type="checkbox"/>	n/a
Upper Hall	<input type="checkbox"/>	n/a
Master Bedroom	<input type="checkbox"/>	n/a
Bedroom #2	<input type="checkbox"/>	n/a
Bedroom #3	<input type="checkbox"/>	n/a
Bedroom #4	<input type="checkbox"/>	n/a
Bedroom #5	<input type="checkbox"/>	n/a
<input type="text"/>	<input type="checkbox"/>	<input type="text"/>
Upper Landing (If Applicable)	<input type="checkbox"/>	n/a
Lower Landing (If Applicable)	<input type="checkbox"/>	n/a

Upgrade Underpad	Type	Area
	n/a	n/a
Carpet on Stairs	Capped	Runner - *Upgrade
	n/a	n/a

Comment

no carpet thru out.

Scheduled Closing Date: Monday, September 12, 2016

Purchaser: Sana Breka Yousif

Property: 15

Telephone Res. / Bus: (416) 455-6586

Project: Burkshire Holdings Inc.

Decor Advisor: Yolande Somerville

Model and Elevation: 42-4 Elev.B NATIONAL OPT- SFA5

## 7. Fireplace

	Living Room			Family Room			Other Room - Specify <b>Great Room</b>		
	Purchased	As Per Plan	N/A	Purchased	As Per Plan	N/A	Purchased	As Per Plan	N/A
Fireplace Type	<input type="radio"/>	<input type="radio"/>	<input checked="" type="radio"/>	<input type="radio"/>	<input type="radio"/>	<input checked="" type="radio"/>	<input type="radio"/>	<input checked="" type="radio"/>	<input type="radio"/>
Mantle Type							standard gas		
Colour / Stain							standard mediterranean		
Surround							standard		
Hearth							none		
Comment									

## 8. Trim Carpentry

Interior Doors  Front Door Glass Inserts  Door Handles   
Interior Trim

Comment

## 9. Plaster Mouldings and Medallions

Entrance Vestibule	<input type="text"/>	<input type="text"/>	Kitchen/Breakfast	<input type="text"/>	<input type="text"/>
Main Hall	<input type="text"/>	<input type="text"/>	Den/Library	<input type="text"/>	<input type="text"/>
Living Room	<input type="text"/>	<input type="text"/>	Lower Landing	<input type="text"/>	<input type="text"/>
Dining Room	<input type="text"/>	<input type="text"/>	Other Room - Specify	<input type="text" value="none"/>	<input type="text"/>
Family Room	<input type="text"/>	<input type="text"/>	Thru out	<input type="text"/>	<input type="text"/>

Comment

## 10. Railings and Spindles

Railing Package   
Railing Colour  Spindle Colour   
Stringer / Riser  Treads

Comment

Note: stairs and hardwood floors don't match!!

## 11. Wall Paint

Main & Upper Hall	<input type="text"/>	Master Bedroom	<input type="text"/>
Living Room	<input type="text"/>	Bedroom #2	<input type="text"/>
Dining Room	<input type="text"/>	Bedroom #3	<input type="text"/>
Kitchen / Breakfast	<input type="text"/>	Bedroom #4	<input type="text"/>
Family Room	<input type="text"/>	Bedroom #5	<input type="text"/>
Powder Room	<input type="text"/>	Master Ensuite	<input type="text"/>
Laundry Room	<input type="text"/>		<input type="text"/>
Den/Library	<input type="text"/>	Second Ensuite	<input type="text"/>
Trim Paint	<input type="text" value="White"/>	Thru out	<input type="text" value="Warm Grey"/>
Comment	Smooth Ceilings First Floor <input type="text"/>		



Scheduled Closing Date: Monday, September 12, 2016

Purchaser: Sana Breka Yousif

Property: 15

Telephone Res. / Bus: (416) 455-6586

Project: Burkshire Holdings Inc.

Decor Advisor: Yolande Somerville

Model and Elevation: 42-4 Elev.B NATIONAL OPT- SFA5

## 12. Electrical

Plugs and Switches ☒ White ☐ Ivory

Hood Fan ☐ White ☐ Ivory

Appliances Built in Cooktop

☒ Yes ☐ No

Built in Oven

☒ Yes ☐ No

Gas Stove

☐ Yes ☒ No

Microwave

☒ Yes ☐ No

Comment

\*future chimney-style hood fan

## 13. Heating and Air Conditioning

Air Conditioning

Gas Provisions Dryer

Comment

Standard gas BBQ line

Gas Provisions Stove

Gas Provisions Barbecue

## 14. Additional Comments

## 15. Disclaimers and Notes

- 1) Colours of all materials are as close as possible to builder's selection, but not necessarily identical due to variances in manufacturing.
- 2) Any extras listed above are null and void unless accompanied by a separate invoice/amendment. Said invoice must be paid in full.
- 3) The Purchaser acknowledges that after Interior Colour Selection form is signed and dated, no further changes will be permitted other than re-selection due to unavailability. \_\_\_\_\_ Purchaser's Initials
- 4) The Purchaser acknowledges reading and accepting the "Gold Park Homes Decor Centre Disclaimers" form. This document contains other miscellaneous disclaimers.

This Interior Colour Selection is final and approved by:

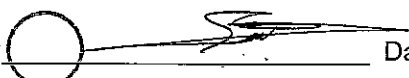
Signature:  Date: \_\_\_\_\_



MICRO  
+  
WALL OVEN

2" conduit +  
ELECT.  
60" AFF (approx)

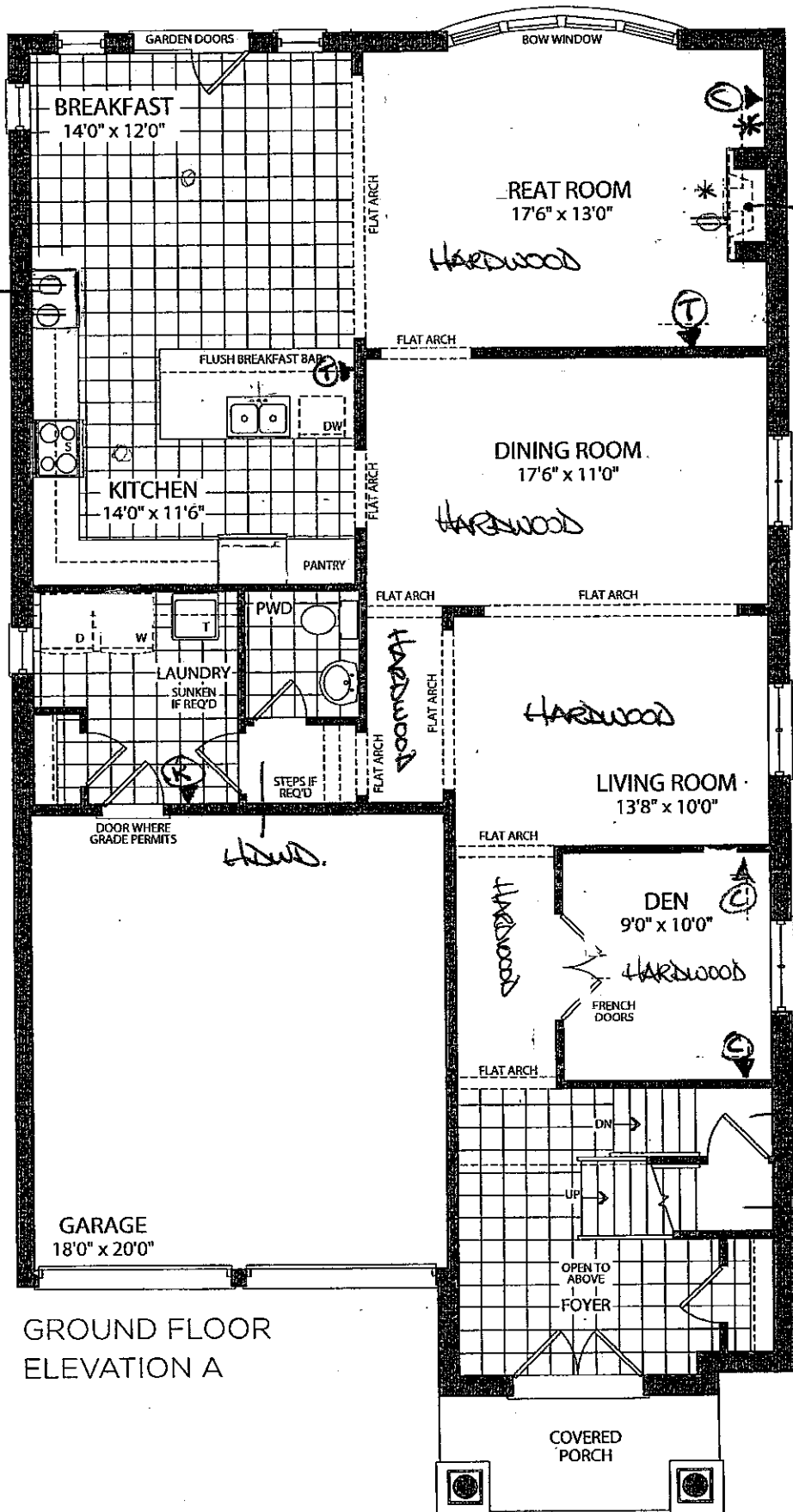

GROUND FLOOR  
ELEVATION A

KG-15  
X60.24  
2016

LOT 15

JUNE 6 2016

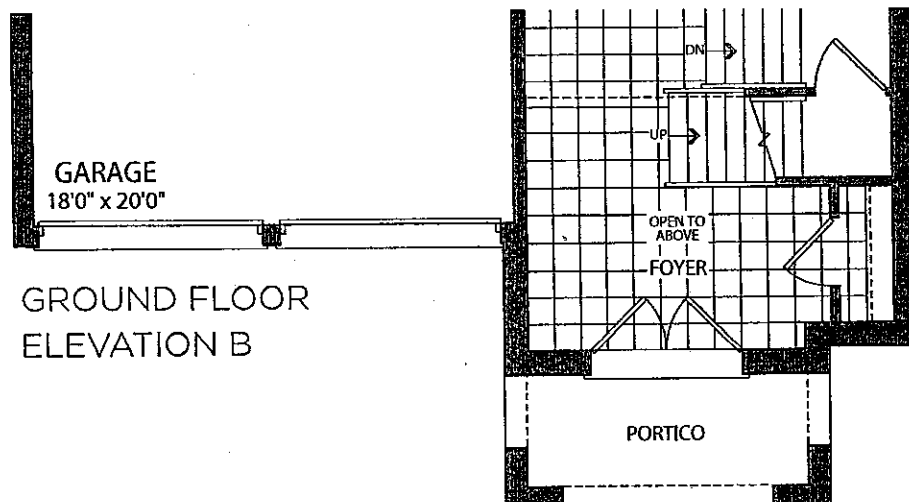

GROUND FLOOR  
ELEVATION B

Lot 15

KG-15 (B)  
Nov 24 2016

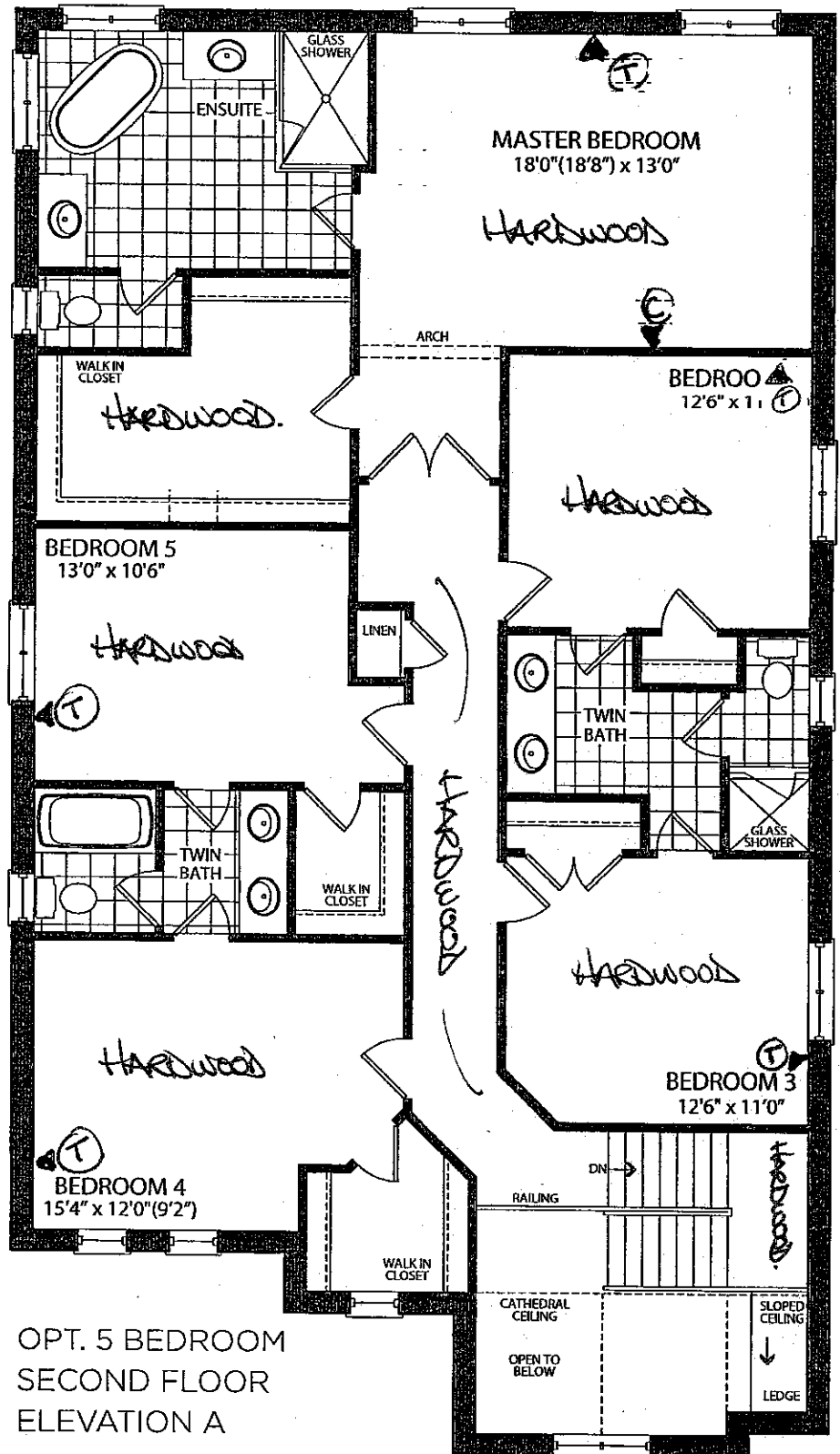

OPT. 5 BEDROOM  
SECOND FLOOR  
ELEVATION A

LOT 15  
(B)  
JUNE 6 2016.

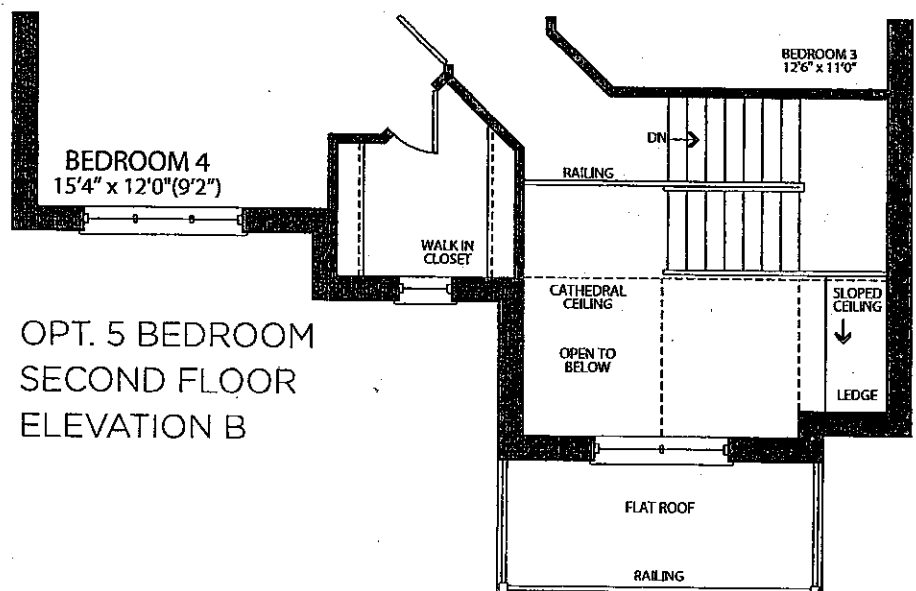

OPT. 5 BEDROOM  
SECOND FLOOR  
ELEVATION B

Lot 15

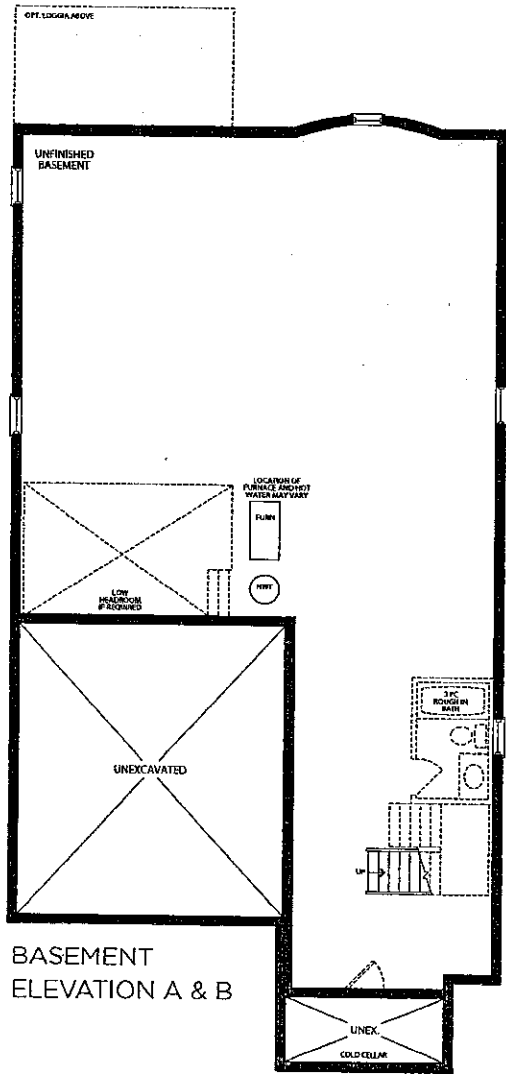
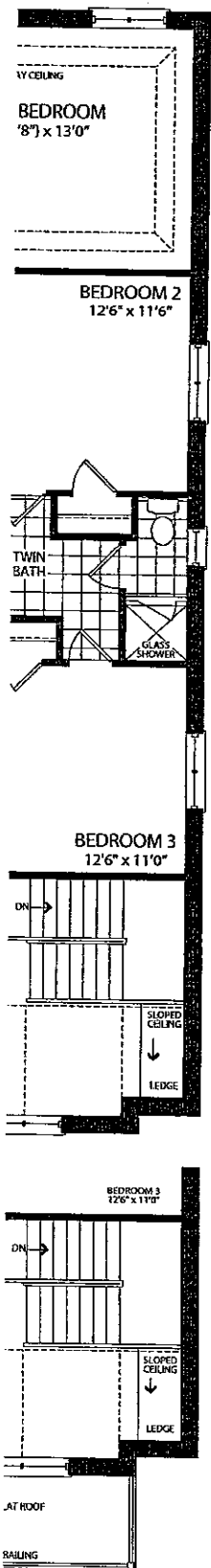

BASEMENT  
ELEVATION A & B

LOT 15  
(B) JUNE 6 2016.

KG-15 (B)  
NOVEMBER 24  
2016.

Lot 15



# the National



Elevation A • 3,439 sq.ft.



Elevation B • 3,439 sq.ft.

GOLDPARK  
HOMES

Prices, figures, illustrations, sizes, features and finishes are subject to change without notice. E.&O.E. Areas and dimensions are approximate and actual usable floor space may vary from the stated area. Layout may be reverse of the unit purchased. E. & O.E.

# CORTINA

KITCHENS INC.

70 Regina Road Woodbridge ON L4L 8L6  
905-264-6464

## INFORMATION - PVC DOORS

Builder GOLD PARK Project Kleinburg Lot # 15

All cabinets with PVC (Thermofoil) Doors come with melamine gables, panels and kick. The doors, crown moulding and light valance are PVC wrapped. Open shelves incorporated in design will only be available with melamine interiors. There will be variations in colour shades between the PVC parts (doors, crown and Light valance) and the melamine parts (open shelves, Gables, Panels and Kick) due to the difference in material.

Furring Panel with crown moulding to the ceiling is not available on all PVC door styles due to subtle variations in colour shades between the PVC parts (moulding) and the melamine parts (furring panel) due to the difference in material. Grain directions in wood grain pattern melamine, vary between the furring panel, crown moulding (horizontal) and the PVC doors (vertical).

Thank you for your understanding.

---

I am well informed of this information, and agree to the purchase of the above.

Purchaser: 

Date: Nov 24 2016

KG-15 (B)  
NOVEMBER 24 2016

**CORTINA**  
KITCHENS INC.  
70 Regatta Road, Woodbridge, Ontario L4L 8L9  
Tel: 905-294-6684 Fax: 905-294-6684  
www.CortinaKitchens.com

## QUOTATION

Date: 14/10/16

Trade Name: Gold Park Homes	Site location: Kleinburg	Model: 42-4
Address:	Project: Kleinburg Glen	Phase:

This layout has been explained to the purchaser by Cortina Kitchens Inc. and is understood by the purchaser.

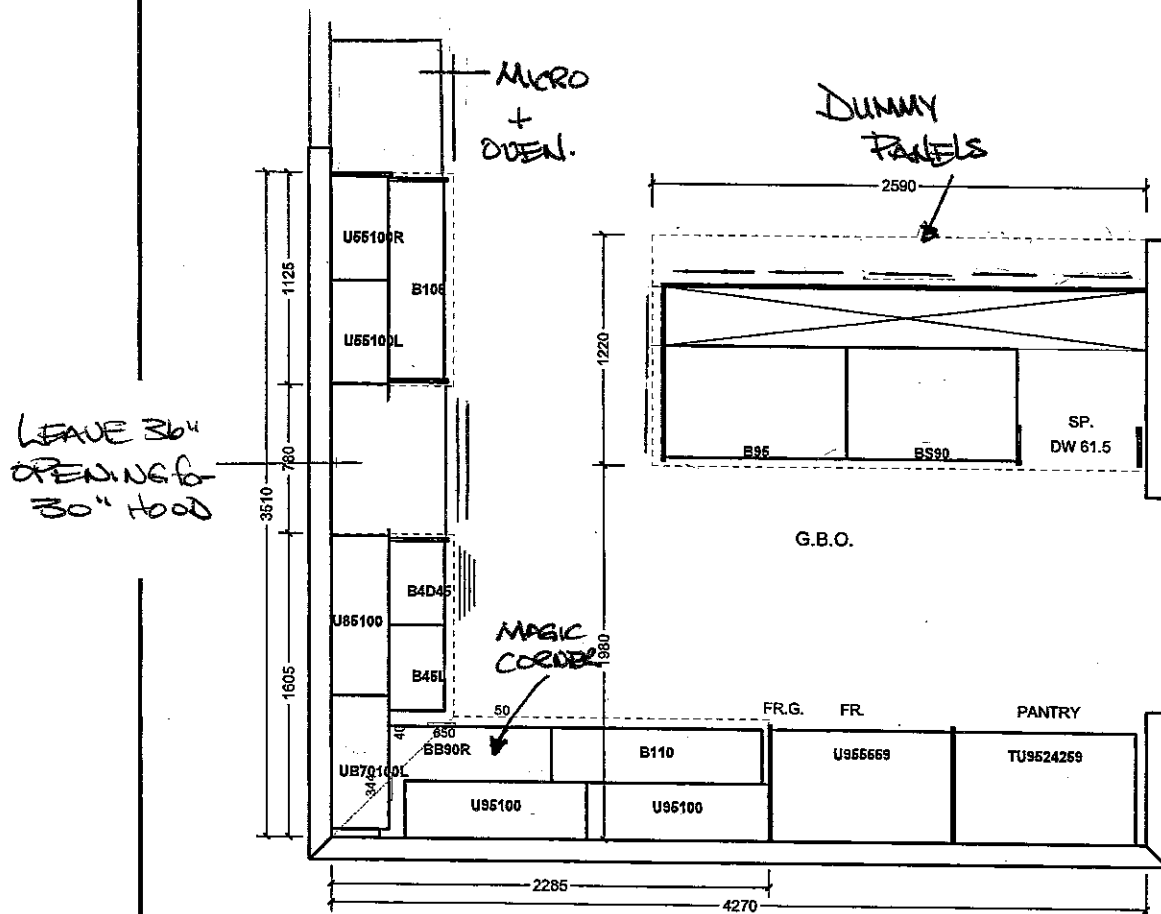

- \*CROWN MOULDING + FURRING PANEL
- \* 30" COOK TOP + DRAWERS BELOW
- \* FUTURE CHIMNEY-HOOD
- \* UPGRADE HARDWARE

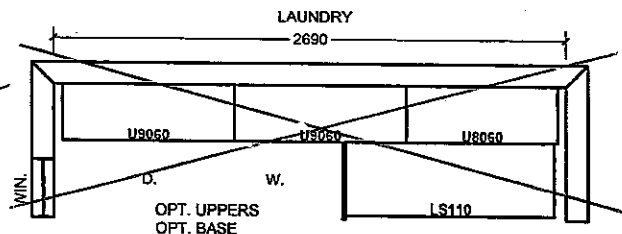

All prices subject to confirmation from head office.  
This quotation is subject to the terms & conditions set out

ACCEPTED DATE: \_\_\_\_\_

All agreements are contingent upon strikes, accidents, and delays beyond our control.  
Please provide our installer with template for sinkholes or \$150.00 will be charged for callback.

Item A. Wood grain and colour are characteristics of the product. We cannot guarantee that such grain and colour will always match.  
Item B. Cortina Kitchens Inc. reserves the right to alter dimensions and make technical changes without notice.

KG-15 (B)  
Nov 24 2016

CORTINA KITCHENS INC. 70 Ruggie Road, Woodbridge, Ontario L4L 5L6 Tel: 905-294-6694 Fax: 905-294-0954 www.CortinaKitchens.com		QUOTATION
Trade Name: Gold Park Homes		Site location: Kleinburg
Address:		Model: 42-4
Project: Kleinburg Glen		Phase:
This layout has been explained to the purchaser by Cortina Kitchens Inc. and is understood by the purchaser.		
OPT. 2ND FLOOR		
All prices subject to confirmation from head office. This quotation is subject to the terms & conditions set out		
All agreements are contingent upon strikes, accidents, and delays beyond our control. Please provide our installer with template for sinkholes or \$150.00 will be charged for callback.		
ACCEPTED DATE: _____		
Item A. Wood grain and colour are characteristics of the product. We cannot guarantee that such grain and colour will always match. Item B. Cortina Kitchens Inc. reserves the right to alter dimensions and make technical changes without notice.		

KG-15 (B)  
 KITCHEN SINK  
 Nov 24 2016

## BLANCO QUATRUS™ Undermount

### BLANCO QUATRUS™ U 1 1/4

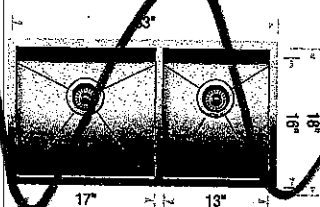

#### Sink Specifications

**Undermount**  
**Minimum Cabinet Size\***  
 36" (915 mm)  
**Bowl Depth**  
 9" (230 mm)  
**Cubed Weight**  
 56 lb. (25.4 kg)

#### Model N°

401244

#### List Price

#### Optional Accessories

#### List Price

406451 Grid (L)  
 406450 Grid (SB)  
 406345 Ash Cutting Board  
 406344 Workstation  
 517666 CapFlow™  
 230694 Magnetic Caddy

### BLANCO QUATRUS™ U 2

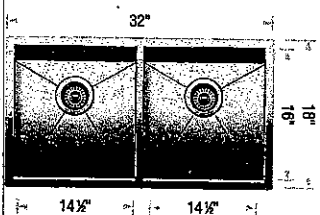

#### Sink Specifications

**Undermount**  
**Minimum Cabinet Size\***  
 36" (915 mm)  
**Bowl Depth**  
 9" (230 mm)  
**Cubed Weight**  
 55 lb. (25 kg)

#### Model N°

401247

#### List Price

#### Optional Accessories

#### List Price

406454 Grid  
 406345 Ash Cutting Board  
 406344 Workstation  
 517666 CapFlow™  
 230694 Magnetic Caddy

### BLANCO QUATRUS™ U SUPER SINGLE

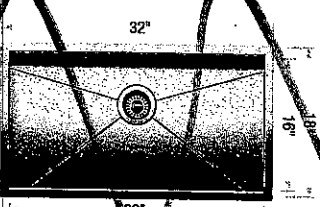

#### Sink Specifications

**Undermount**  
**Minimum Cabinet Size\***  
 36" (915 mm)  
**Bowl Depth**  
 9" (230 mm)  
**Cubed Weight**  
 55 lb. (25 kg)

#### Model N°

401248

#### List Price

#### Optional Accessories

#### List Price

406347 Super Single Grid \$1  
 406446 Elevated Grid \$1  
 406345 Ash Cutting Board \$2  
 406344 Workstation \$1  
 517666 CapFlow™ \$  
 230694 Magnetic Caddy \$

### BLANCO QUATRUS™ U 1 MEDIUM

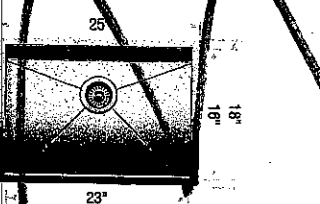

#### Sink Specifications

**Undermount**  
**Minimum Cabinet Size\***  
 27" (685 mm)  
**Bowl Depth**  
 9" (230 mm)  
**Cubed Weight**  
 43 lb. (19.5 kg)

#### Model N°

401246

#### List Price

#### Optional Accessories

406452 Grid  
 406345 Ash Cutting Board  
 406344 Workstation  
 517666 CapFlow™  
 230694 Magnetic Caddy

## Granite, Marble, Quartz (Edge Profiles)

KG-15 27  
Nov. 2066

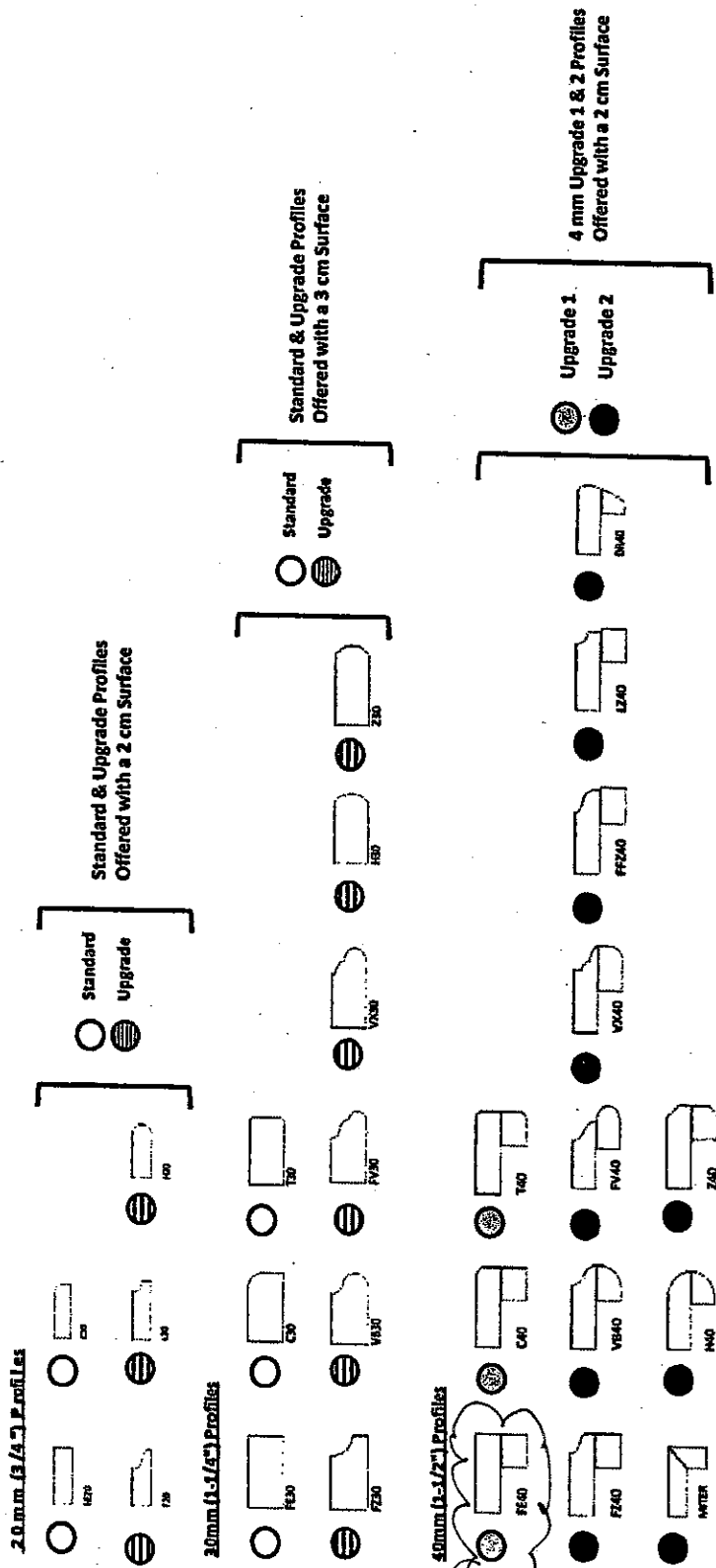

**Note:** All colours may not be available in 30mm at time ordered. Vendor reserves the right to use 40mm edges (by lamination process).

- \* UPGRADES KITCHEN SINK
- \* STANDARD KITCHEN FAUCET



UPGRADE HARDWARE

KG-15  
Nov. 27 2016 (B)

UPGRADE HARDWARE



CH-32

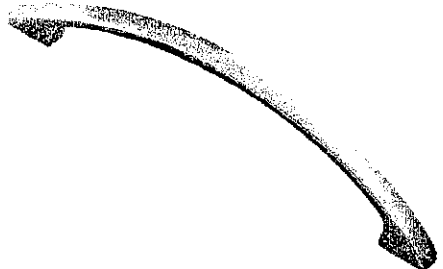

CH-38

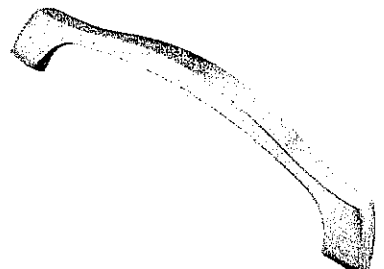

CH-44

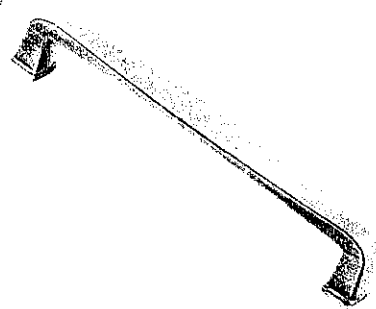

CH-45

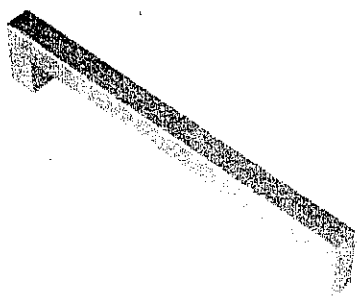

CH-46

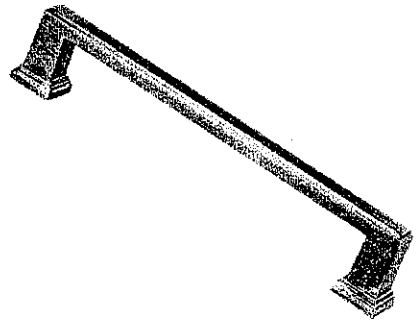

CH-47

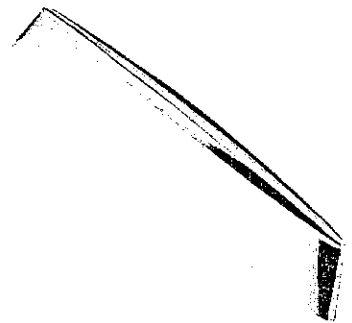

CH-48

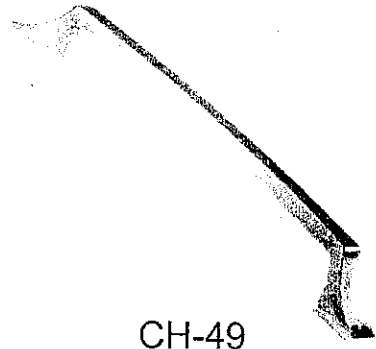

CH-49

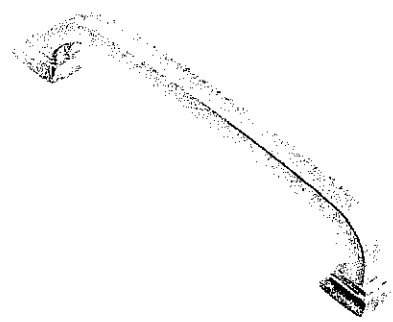

CH-50

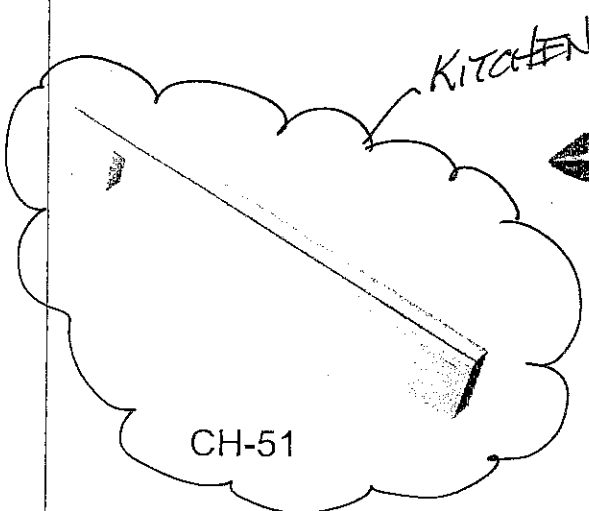

CH-51

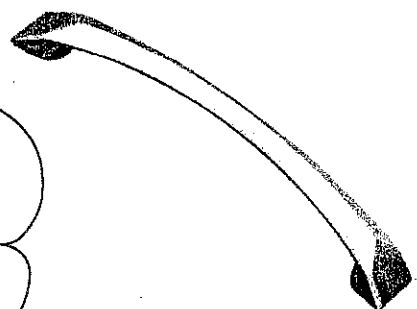

CH-52

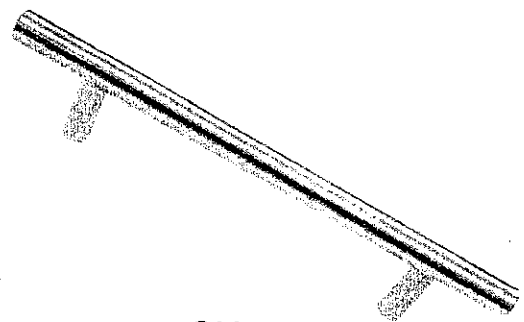

CH-53

**\*NOTES:**  
- IMAGES ARE FOR QUICK REFERENCE PURPOSES ONLY  
- ACTUAL SIZES AND FINISHES AS PER HARDWARE  
SAMPLE BOARD PROVIDED TO DECOR CENTRE

KG-15  
Nov. 24 2016



CSI-6

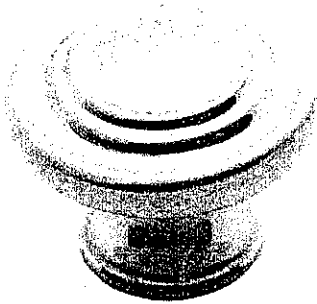

CSI-10



CSI-14

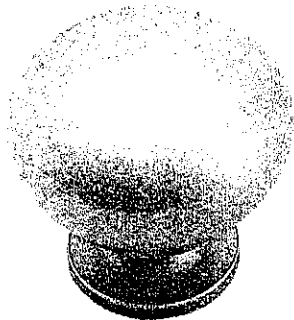

CSI-16



CSI-18

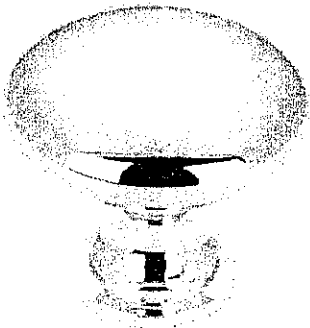

CSI-19

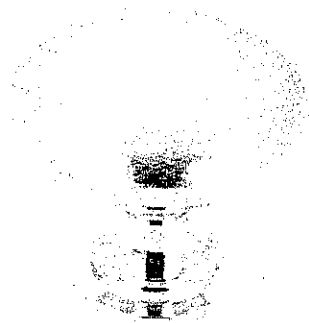

CSI-20

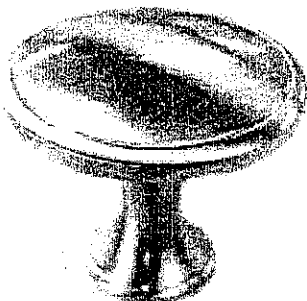

CSI-21

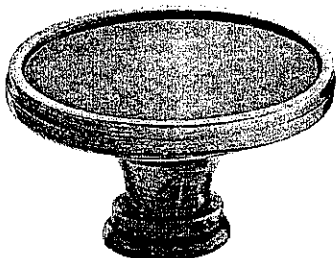

CSI-22

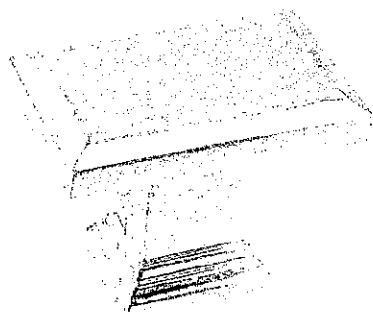

CSI-23

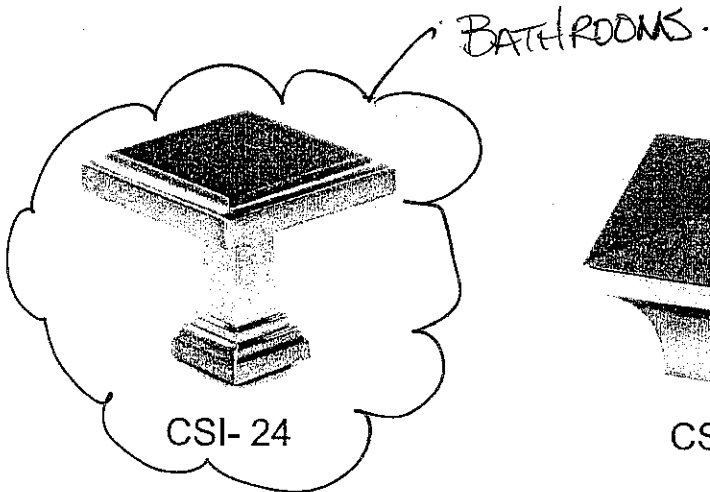

CSI-24

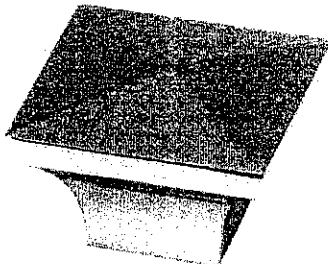

CSI-25

**\*NOTES:**  
- IMAGES ARE FOR QUICK REFERENCE PURPOSES ONLY  
- ACTUAL SIZES AND FINISHES AS PER HARDWARE  
SAMPLE BOARD PROVIDED TO DECOR CENTRE

K6-15

# KitchenAid® 27" (68.6 cm) and 30" (76.2 cm) Electric Built-In Microwave/Oven Combination

## PRODUCT MODEL NUMBERS

KEMS309E KOCE500E KOCE507E

## ELECTRICAL CONNECTION

If codes permit and a separate ground wire is used, it is recommended that a qualified electrical installer determine that the ground path and the wire gauge are in accordance with local codes.

Check with a qualified electrical installer if you are not sure the oven is properly grounded.

This oven must be connected to a grounded metal, permanent wiring system.

Be sure that the electrical connection and wire size are adequate and in conformance with the National Electrical Code, ANSI/NFPA 70-latest edition or CSA Standards C22.1-94, Canadian Electrical Code, Part 1 and C22.2 No. O-M91-latest edition, and all local codes and ordinances.

To properly install your oven, you must determine the type of electrical connection you will be using and follow the instructions provided for it here.

- Oven must be connected to the proper electrical voltage and frequency as specified on the model/serial/rating plate. See the following illustration.

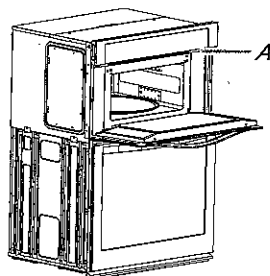

A. Model/serial/rating plate

- Models rated from 7.3 to 9.6 kW at 240 volts (5.4 to 7.4 kW at 208 volts) require a separate 40-amp circuit. Models rated at 4.8 kW and below at 240 volts (3.6 kW and below at 208 volts) require a separate 30-amp circuit.
- A circuit breaker is recommended.
- Connect directly to the fused disconnect (or circuit breaker box) through flexible, armored or nonmetallic sheathed, copper cable (with grounding wire). See "Make Electrical Connection" section.
- Flexible conduit from the oven should be connected directly to the junction box.
- Do not cut the conduit. The length of conduit provided is for serviceability of the oven.
- A UL listed or CSA approved conduit connector must be provided.
- If the house has aluminum wiring, follow the procedure below:
  - Connect a section of solid copper wire to the pigtail leads.
  - Connect the aluminum wiring to the added section of copper wire using special connectors and/or tools designed and UL listed for joining copper to aluminum.

Follow the electrical connector manufacturer's recommended procedure. Aluminum/copper connection must conform with local codes and industry accepted wiring practices.

For power requirements, refer to the following table.

Model	Voltage	Amperage (L1)*	Amperage (L2)*	Rating (W)
KOCE507E/KOCE500E	120/240	32	30	8000
KOCE507E/KOCE500E	120/208	30	28	6600

\*Amperage values noted above are for information purposes only; the units are rated in watts.

## PRODUCT DIMENSIONS

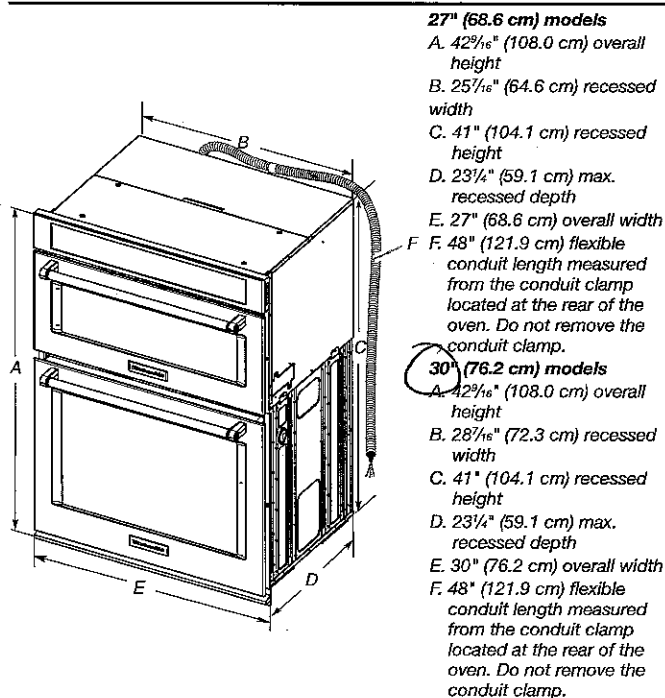

## Cabinet Dimensions

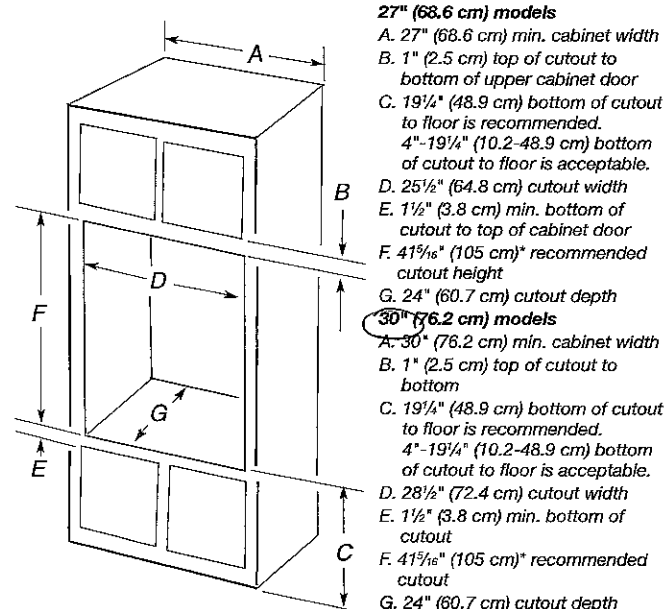

\* NOTE: The cabinet height can be between 41" (104.1 cm) and 41<sup>1</sup>/<sub>2</sub>" (105.6 cm) for microwave/oven combination.

## Electrical Connection

To properly install your oven, you must determine the type of electrical connection you will be using and follow the instructions provided for it here.

- Oven must be connected to the proper electrical voltage, amperage, and frequency as specified on the model/serial/rating plate. See the following illustration.

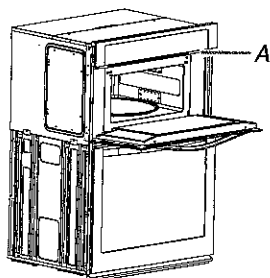

A. Model/serial/rating plate

- Models rated from 7.3 to 9.6 kW at 240 volts (5.4 to 7.4 kW at 208 volts) require a separate 40-amp circuit. Models rated at 4.8 kW and below at 240 volts (3.6 kW and below at 208 volts) require a separate 30-amp circuit.
- A circuit breaker is recommended.
- Connect directly to the fused disconnect (or circuit breaker box) through flexible, armored or nonmetallic sheathed, copper cable (with grounding wire). See "Make Electrical Connection" section.

- Flexible conduit from the oven should be connected directly to the junction box.
- Do not cut the conduit. The length of conduit provided is for serviceability of the oven.
- A UL listed or CSA approved conduit connector must be provided.
- If the house has aluminum wiring, follow the procedure below:

1. Connect a section of solid copper wire to the ends of the flexible conduit leads.
2. Connect the aluminum wiring to the added section of copper wire using special connectors and/or tools designed and UL listed for joining copper to aluminum.

Follow the electrical connector manufacturer's recommended procedure. Aluminum/copper connection must conform with local codes and industry accepted wiring practices.

For power requirements, refer to the following table.

Model	Voltage	Amperage (L1)*	Amperage (L2)*	Rating (W)
KOCE507E/ KOCE500E	120/240	32	30	8000
KOCE507E/ KOCE500E	120/208	30	28	6600

\*Amperage values noted above are for information purposes only: The units are rated in watts.

# INSTALLATION INSTRUCTIONS

## Prepare Built-In Microwave/Oven Combination

1. Decide on the final location for the oven. Locate existing wiring to avoid drilling into or severing wiring during installation.

### **⚠ WARNING**

#### **Excessive Weight Hazard**

**Use two or more people to move and install oven.**

**Failure to do so can result in back or other injury.**

2. To avoid floor damage, set the oven onto cardboard prior to installation. Do not use handle or any portion of the front frame for lifting.
3. Remember to remove bottom vent from the foam packing on top of oven.
4. Remove the shipping materials and tape from the oven.
5. Remove the hardware package from inside the bag containing literature.
6. Remove and set aside racks and other parts from inside the oven.
7. Move oven and cardboard close to the oven's final location.

## Remove Oven Door(s)

**IMPORTANT:** Use two hands to remove oven door.

1. Prior to removing the oven door, prepare a surface where you will place it. This surface should be flat and covered with a soft blanket, or use the corner posts from your packaging material.
2. Open the oven door.
3. Locate the oven door hinge locks in both corners of the oven door, and then rotate the hinge locks toward the oven door to the unlocked position. If the door hinge lock is not rotated fully (see illustration B), the door will not remove properly.

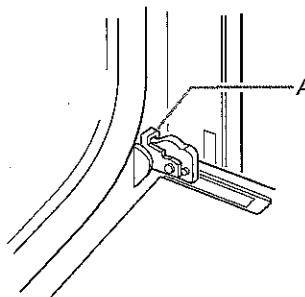

A. Oven door hinge lock in locked position

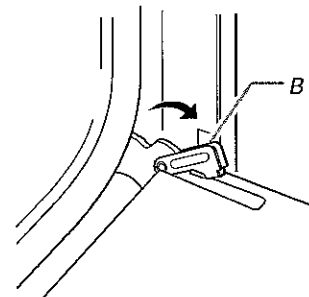

B. Oven door hinge lock in unlocked position

# BUILT-IN MICROWAVE/OVEN COMBINATION SAFETY

## Your safety and the safety of others are very important.

We have provided many important safety messages in this manual and on your appliance. Always read and obey all safety messages.



This is the safety alert symbol.

This symbol alerts you to potential hazards that can kill or hurt you and others.

All safety messages will follow the safety alert symbol and either the word "DANGER" or "WARNING."

These words mean:

**⚠ DANGER**

**You can be killed or seriously injured if you don't immediately follow instructions.**

**⚠ WARNING**

**You can be killed or seriously injured if you don't follow instructions.**

All safety messages will tell you what the potential hazard is, tell you how to reduce the chance of injury, and tell you what can happen if the instructions are not followed.

## INSTALLATION REQUIREMENTS

### Tools and Parts

Gather the required tools and parts before starting installation. Read and follow the instructions provided with any tools listed here.

#### Tools Needed

- Phillips screwdriver
- Measuring tape
- Drill (for wall cabinet installations)
- 1" (2.5 cm) drill bit (for wall cabinet installations)
- Level
- Flat-blade screwdriver

#### Parts Needed

- UL listed or CSA approved conduit connector
- UL listed wire connectors
- Warming Drawer Deflector Kit (for ovens installed above a warming drawer)

Order Part Number W10489566B for white 27" (68.6 cm) kit  
 Order Part Number W10489564B for black 27" (68.6 cm) kit  
 Order Part Number W10489568A for stainless steel 27" (68.6 cm) kit

Order Part Number W10489567B for white 30" (76.2 cm) kit  
 Order Part Number W10489565B for black 30" (76.2 cm) kit  
 Order Part Number W10489569A for stainless steel 30" (76.2 cm) kit  
 Order Part Number W10727416A for stainless steel/black 30" (76.2 cm) kit

To order, see the "Assistance or Service" section of the Use and Care Guide.

- Flush Installation Kit (for Combo installed at flush installation)

Order Part Number W10752694A for white 27" (68.6 cm) kit  
 Order Part Number W10752695A for black 27" (68.6 cm) kit  
 Order Part Number W10752696A for stainless steel 27" (68.6 cm) kit  
 Order Part Number W10752687A for white 30" (76.2 cm) kit  
 Order Part Number W10752688A for black 30" (76.2 cm) kit  
 Order Part Number W10752693A for stainless steel 30" (76.2 cm) kit  
 Order Part Number W10752691A for black/stainless steel 30" (76.2 cm) kit

To order, see the "Assistance or Service" section of the Use and Care Guide.

#### Parts Supplied

- #8-14 x 1" screws (4)
- Bottom vent
- #8-18 x 3/8" screws - bottom vent (2)

Check local codes. Check existing electrical supply. See "Electrical Requirements."

It is recommended that all electrical connections be made by a licensed, qualified electrical installer.

### Built-In Microwave/Oven Combination Location Requirements

**IMPORTANT:** Observe all governing codes and ordinances.

- Cabinet opening dimensions that are shown must be used. Given dimensions provide minimum clearance with oven.
- Recessed installation area must provide complete enclosure around the recessed portion of the oven.
- Grounded electrical supply is required. See "Electrical Requirements" section.

- Electrical supply junction box should be located 3" (7.6 cm) maximum below the support surface when the oven is installed in a wall cabinet. A 1" (2.5 cm) minimum diameter hole should have been drilled in the left rear corner of the support surface to pass the appliance cable through to the junction box.
- Oven support surface must be solid, level and flush with bottom of cabinet cutout. Floor must be able to support a total weight (microwave and built-in oven) of 208 lbs (95 kg) for 27" (68.6 cm) models or 249 lbs (113 kg) for 30" (76.2 cm) models.

**IMPORTANT:** To avoid damage to your cabinets, check with your builder or cabinet supplier to make sure that the materials used will not discolor, delaminate or sustain other damage. This oven has been designed in accordance with the requirements of UL and CSA International and complies with the maximum allowable wood cabinet temperatures of 194°F (90°C).

## Product Dimensions

### 27" and 30" (68.6 cm and 76.2 cm) Ovens

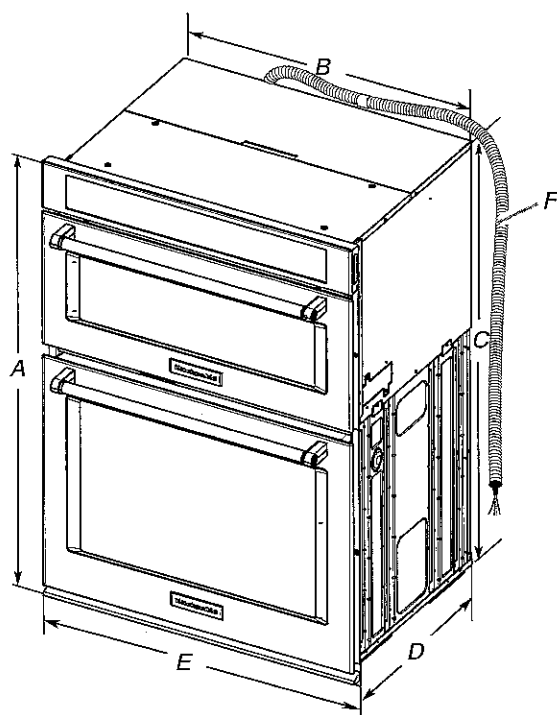

#### 27" (68.6 cm) models

- A. 42 5/8" (108.0 cm) overall height
- B. 25 1/8" (64.6 cm) recessed width
- C. 41" (104.1 cm) recessed height
- D. 23 1/4" (59.1 cm) max. recessed depth
- E. 27" (68.6 cm) overall width
- F. 48" (121.9 cm) flexible conduit length measured from the conduit clamp located at the rear of the oven. Do not remove the conduit clamp.

#### 30" (76.2 cm) models

- A. 42 5/8" (108.0 cm) overall height
- B. 28 7/8" (72.2 cm) recessed width
- C. 41" (104.1 cm) recessed height
- D. 23 1/4" (59.1 cm) max. recessed depth
- E. 30" (76.2 cm) overall width
- F. 48" (121.9 cm) flexible conduit length measured from the conduit clamp located at the rear of the oven. Do not remove the conduit clamp.

## Cabinet Dimensions

### 27" and 30" (68.6 cm and 76.2 cm) Ovens

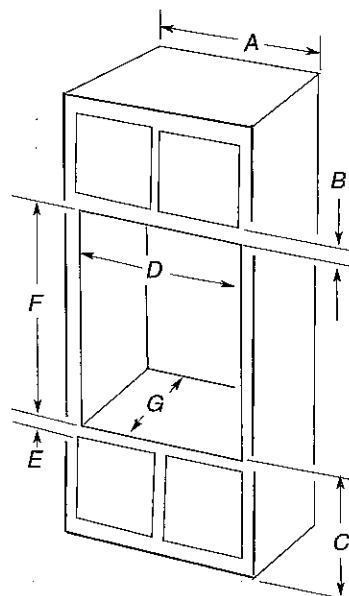

#### 27" (68.6 cm) models

- A. 27" (68.6 cm) min. cabinet width
- B. 1" (2.5 cm) top of cutout to bottom of upper cabinet door
- C. 19 1/4" (48.9 cm) bottom of cutout to floor is recommended. 4"-19 1/4" (10.2-48.9 cm) bottom of cutout to floor is acceptable.
- D. 25 1/2" (64.8 cm) cutout width
- E. 1 1/2" (3.8 cm) min. bottom of cutout to top of cabinet door
- F. 41 5/8" (105 cm)\* recommended cutout height
- G. 24" (60.7 cm) cutout depth

#### 30" (76.2 cm) models

- A. 30" (76.2 cm) min. cabinet width
- B. 1" (2.5 cm) top of cutout to bottom of upper cabinet door
- C. 19 1/4" (48.9 cm) bottom of cutout to floor is recommended. 4"-19 1/4" (10.2-48.9 cm) bottom of cutout to floor is acceptable.
- D. 28 1/2" (72.4 cm) cutout width
- E. 1 1/2" (3.8 cm) min. bottom of cutout to top of cabinet door
- F. 41 5/8" (105 cm)\* recommended cutout height
- G. 24" (60.7 cm) cutout depth

**\*NOTE:** The cutout height can be between 41" and 41 1/2" (104.1 cm and 105.6 cm) for microwave/oven combination.

## Electrical Requirements

If codes permit and a separate ground wire is used, it is recommended that a qualified electrical installer determine that the ground path and wire gauge are in accordance with local codes.

Check with a qualified electrical installer if you are not sure the oven is properly grounded.

This oven must be connected to a grounded metal, permanent wiring system.

Be sure that the electrical connection and wire size are adequate and in conformance with the National Electrical Code, ANSI/NFPA 70-latest edition or CSA Standards C22.1-94, Canadian Electrical Code, Part 1 and C22.2 No. 0-M91-latest edition, and all local codes and ordinances.

A copy of the above code standards can be obtained from:

National Fire Protection Association  
1 Batterymarch Park  
Quincy, MA 02169-7471

CSA International  
8501 East Pleasant Valley Road  
Cleveland, OH 44131-5575

# INSTALLATION REQUIREMENTS

## Tools and Parts

Gather the required tools and parts before starting installation. Read and follow the instructions provided with any tools listed here.

### Tools needed

- Tape measure
- Marker or pencil
- ¼" (6.35 mm) nut driver
- Pliers
- Flat-blade screwdriver

### Parts supplied

- Foam strip roll
- 2½" (6.4 cm) clamping screws (2)
- Clamping brackets (2)

### Parts needed

- A UL listed or CSA approved connector for ½" (1.3 cm) diameter conduit
- UL listed wire connectors

Check local codes. Check existing electrical supply. See the "Electrical Requirements" section.

It is recommended that all electrical connections be made by a licensed, qualified electrical installer.

## Location Requirements

**IMPORTANT:** Observe all governing codes and ordinances. When installing cooktop, use minimum dimensions given.

- To eliminate the risk of burns or fire by reaching over the heated surface units, cabinet storage space located above the surface units should be avoided. If cabinet storage is to be provided, the risk can be reduced by installing a range hood that projects horizontally a minimum of 5" (12.7 cm) beyond the bottom of the cabinets.
- The cooktop must be a specified cooktop that is approved to be installed either alone or over an undercounter built-in oven. Check the cooktop base for an approved installation label. If you do not find this label, contact your dealer to confirm that your cooktop is approved.
- The cooktop must be installed in a level countertop.
- Ovens approved for this type of installation will have an approval label located on the top of the oven. If you do not find this label, contact your dealer to confirm that your oven is approved. Refer to oven manufacturer's Installation Instructions for approval for built-in undercounter use and proper cutout dimensions.
- The cooktop should be installed away from strong draft areas, such as windows, doors, fans or strong heating vents. The cooktop should be located for convenient use in the kitchen.
- Use the countertop opening dimensions that are given with these Installation Instructions. Given dimensions are minimum clearances and provide 0" (0 cm) clearance.
- Grounded electrical supply is required. See "Electrical Requirements" section.

**IMPORTANT:** To avoid damage, check with your builder or cabinet supplier to make sure that the materials used will not discolor, delaminate or sustain other damage.

## Product Dimensions

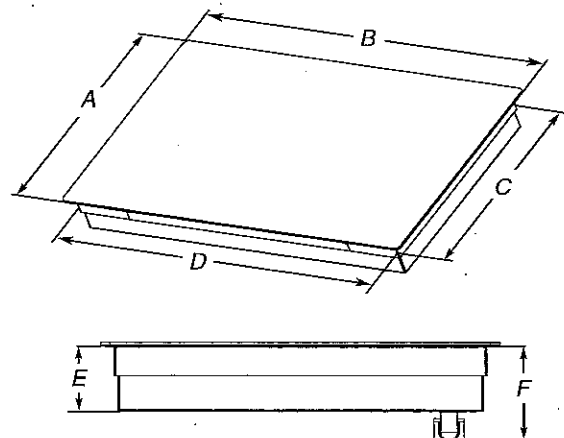

- A. Glass depth - black and white models - 21 3/4" (55.2 cm)  
Glass depth - stainless steel models - 22 1/4" (56.4 cm)
- B. Glass width - 30" (76.2 cm) models - 30 7/8" (78.4 cm)  
Glass width - 36" (91.4 cm) models - 36 5/8" (92.3 cm)
- C. Frame depth - 20 1/4" (51.5 cm)
- D. Frame width - 30" (76.2 cm) models - 28 1/8" (73.5 cm)  
Frame width - 36" (91.4 cm) models - 34 7/8" (87.5 cm)
- E. Cooktop height - 3 3/4" (9.6 cm)
- F. Cooktop height including conduit (located at rear of cooktop, right side) - 5 1/4" (13.5 cm)

## Cabinet Dimensions

**IMPORTANT:** If installing a range hood or microwave hood combination above the cooktop, follow the range hood or microwave hood combination installation instructions for dimensional clearances above the cooktop surface.

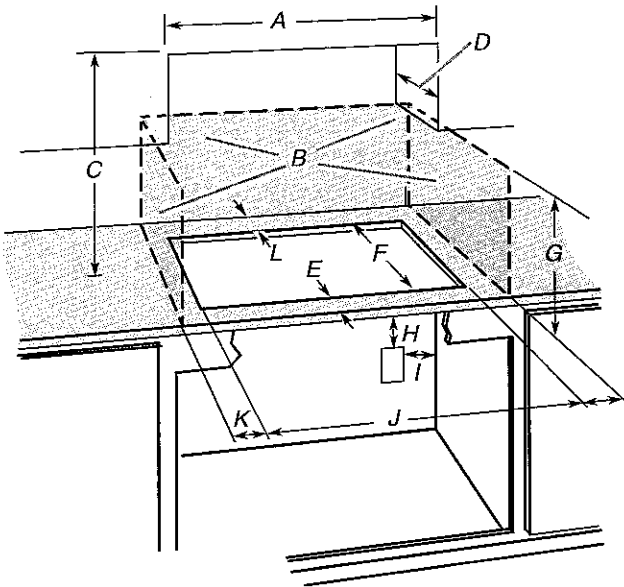

- A. 30" (76.2 cm) on 30" models; 36" (91.4 cm) on 36" models
- B. Combustible area above countertop (shown by dashed box above)
- C. 30" (76.2 cm) minimum clearance between top of cooktop platform and bottom of uncovered wood or metal cabinet (24" [61 cm] minimum clearance if bottom of wood or metal cabinet is covered by not less than 1/4" [0.6 cm] flame retardant millboard covered with not less than No. 28 MSG sheet steel, 0.015" [0.04 cm] stainless steel, or 0.024" [0.06 cm] aluminum or 0.020" [0.05 cm] copper)
- D. 13" (33 cm) recommended upper cabinet depth
- E. 2" (5.1 cm) on most models; 2 5/8" (6.7 cm) on model JEC4430B
- F. 20 1/2" (52.0 cm) recommended cutout.  
Will fit in cutout from 20 3/8" - 20 5/8" (51.8 - 52.2 cm).
- G. 18" (45.7 cm) minimum clearance from upper cabinet to countertop within minimum horizontal clearances to cooktop
- H. Junction box or outlet: 7" (17.8 cm) minimum from top of countertop
- I. Junction box or outlet: 9" (23.0 cm) maximum from right side of cabinet
- J. 29 1/2" (74.9 cm) recommended cutout on 30" (76.2 cm) models.  
Will fit in cutout from 29 1/8" - 29 5/8" (73.8 - 75.1 cm) on 30" (76.2 cm) models.  
35 1/2" (90.2 cm) recommended cutout on 36" (91.4 cm) models.  
Will fit in cutout from 34 3/8" - 35 3/8" (87.8 - 90.3 cm) on 36" (91.4 cm) models.
- K. 1" (2.5 cm) minimum distance to nearest left and right side combustible surface above cooktop
- L. 1" (2.5 cm) minimum clearance between back wall and countertop

**NOTES:** After making the countertop cutout, some installations may require notching down the base cabinet side walls to clear the cooktop base. To avoid this modification, use a base cabinet with sidewalls wider than the cutout.

If cabinet has a drawer, a 5 1/2" (14.0 cm) depth clearance from the top of the countertop to the top of the drawer (or other obstruction) in base cabinet is required.

## Electrical Requirements

### ⚠ WARNING



#### Electrical Shock Hazard

**Disconnect power before servicing.**

**Use 8 gauge copper wire.**

**Electrically ground cooktop.**

**Failure to follow these instructions can result in death, fire, or electrical shock.**

If codes permit and a separate ground wire is used, it is recommended that a qualified electrical installer determine that the ground path and wire gauge are in accordance with local codes.

Check with a qualified electrical installer if you are not sure the cooktop is properly grounded.

Make sure that the electrical connection and wire size are adequate and in conformance with the National Electrical Code, ANSI/NFPA 70-latest edition or CSA Standards C22.1-94, Canadian Electrical Code, Part 1 and C22.2 No. 0-M91-latest edition, and all local codes and ordinances.

A copy of the above code standards can be obtained from:

National Fire Protection Association  
1 Batterymarch Park  
Quincy, MA 02169-7471

CSA International  
8501 East Pleasant Valley Road  
Cleveland, OH 44131-5575

#### Before You Make the Electrical Connection:

To properly install your cooktop, you must determine the type of electrical connection you will be using and follow the instructions provided for it here.

- A 3-wire or 4-wire, single phase, 120/240 volt, 60-Hz., AC only electrical supply is required on a separate, 40-amp circuit fused on both sides of the line. The model/serial number rating plate is located on the metal cabinet underneath the cooktop. See the following illustration.

**NOTE:** A separate 30-amp circuit fused on both sides of the line can be used for models W5CE3024 and G9CE3065.

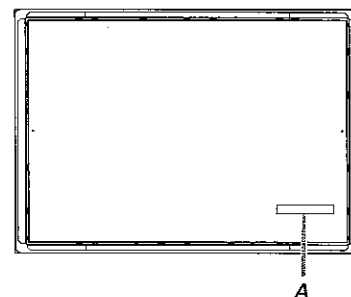

A. Model/serial number plate



- The cooktop is rated 120/240 volt. Some models have a neutral (white) wire.
- The cooktop should be connected directly to the junction box through flexible, armored or nonmetallic sheathed, copper cable. The flexible, armored cable extending from the fuse box or circuit breaker box should be connected directly to the junction box.
- Locate the junction box to allow as much slack as possible between the junction box and the cooktop so that the cooktop can be moved if servicing becomes necessary in the future.
- Do not cut the conduit. Use the length of conduit provided.
- A UL listed or CSA approved conduit connector must be provided at each end of the power supply cable (at the cooktop and at the junction box). A listed conduit connector is already provided at the cooktop.
- If the house has aluminum wiring, follow the procedure below:
  1. Connect a section of solid copper wire to the pigtail leads.
  2. Connect the aluminum wiring to the added section of copper wire using special connectors and/or tools designed and UL listed for joining copper to aluminum.

Follow the electrical connector manufacturer's recommended procedure. Aluminum/copper connection must conform with local codes and industry accepted wiring practices.

## INSTALLATION INSTRUCTIONS

### Prepare Cooktop for Installation

#### **⚠ WARNING**

##### **Excessive Weight Hazard**

**Use two or more people to move and install cooktop.**  
**Failure to do so can result in back or other injury.**

Decide on the final location for the cooktop. Avoid drilling into or severing existing wiring during installation.

1. Using 2 or more people, place the cooktop upside down on a covered surface using the foam end posts from the packaging. Make sure that the knobs are not resting on the foam.
2. Remove foam strip roll from the package containing literature. The roll contains four ¼" (0.64 cm) strips of foam. Remove one strip at a time and apply foam strip adhesive-side down around bottom of the cooktop glass.

**NOTE:** The foam strip helps avoid damage to the underside of the cooktop glass from debris and helps the cooktop sit flat on uneven counters.

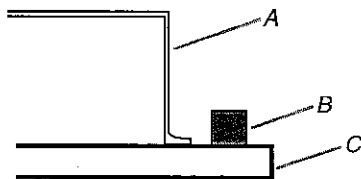

A. Cooktop base  
 B. ¼" (0.64 cm) Foam strip  
 C. Cooktop

### Install Cooktop

#### **Style 1: Cooktop over undercounter built-in oven**

**IMPORTANT:** Clamping brackets should not be used.

1. Using 2 or more people, place cooktop right side up into the cutout.

**NOTE:** Make sure that the front edge of the cooktop is parallel to the front edge of the countertop. If repositioning is needed, lift entire cooktop up from cutout to avoid scratching the countertop.

#### **Style 2: Cooktop over cabinets**

1. Determine whether your cabinet construction provides clearance for installing clamping brackets at cooktop base ends.

**30" (76.2 cm) and 36" (91.4 cm) traditional knob models**

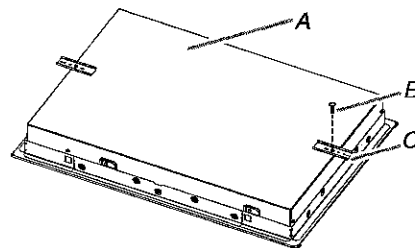

A. Cooktop base bottom  
 B. Attachment screw  
 C. Clamping bracket

2. The clamping brackets can be installed before or after the cooktop is placed into the cutout. Complete the following steps for the option you choose.