

Kleinburg Glen - 19L - 1 - 25-1 Elev.B RIVERSTONE OPT- GFA1

CENTRAL VAC AND WIRING

Inv.831	1 - MASTER ENSUITE FLOOR TILE: UPGRADE 2 floor tile - 12x24" New Byzantine 'Pentellic Grey' (laid straight stacked, see plan for tile direction)
Line11584	Note:
20Sep16 / 1Nov16	

CERAMIC

Inv.831	1 - FOYER TILE: Upgrade 2 floor tile - 18x18" Champions 'White'
Line11568	Note:
20Sep16 / 1Nov16	
Inv.831	1 - KITCHEN AND BREAKFAST FLOOR TILE: UPGRADE 2 - 18X18" Champions 'white'
Line11569	Note:
20Sep16 / 1Nov16	
Inv.831	1 - POWDER ROOM FLOOR TILE: UPGRADE 2 - 18x18" Champions 'White'
Line11570	Note:
20Sep16 / 1Nov16	
Inv.831	1 - MUDROOM FLOOR TILE: UPGRADE 2 - 18X18" Champions 'white'
Line11571	Note:
20Sep16 / 1Nov16	
Inv.831	1 - THRU OUT: DO *not* INTALL Accessories (tissue holder, towel bar, etc)
Line11583	Note:
20Sep16 / 1Nov16	
Inv.831	1 - MAIN BATH FLOOR TILE: Upgrade 2 floor tile - 12x24" New Byzantine 'Pentellic Grey'
Line11585	Note:
20Sep16 / 1Nov16	

EXTERIOR COLOURS

Inv.548	1 - EXTERIOR COLOUR PACKAGE 9
Line10238	Note:
7Jun16 / 17Aug16	

FRAMING

Inv.934	1 - OPTIONAL GROUND FLOOR
Line13285	Note:
1Nov16 / 1Nov16	

HARDWOOD

Inv.831	1 - MAIN HALL: UPGRADE 3 HARDWOOD 3/4" x 4-1/4" BRUSHED FINISH - ash "Komodo"
Line11572	Note:
20Sep16 / 1Nov16	
Inv.831	1 - FAMILY ROOM UPGRADE 3 HARDWOOD: 3/4" x 4-1/4" BRUSHED FINISH - ash "Komodo"
Line11573	Note:
20Sep16 / 1Nov16	
Inv.831	1 - UPPER HALL: UPGRADE 3 HARDWOOD 3/4" x 4-1/4" BRUSHED FINISH - ash "Komodo"
Line11574	Note:
20Sep16 / 1Nov16	

KITCHEN AND BATH CABINETRY

Kleinburg Glen - 19L - 1 - 25-1 Elev.B RIVERSTONE OPT- GFA1

Inv.831	1 - KITCHEN CABINETRY: Base corner folding door
Line11564	Note:
20Sep16 / 1Nov16	
Inv.831	4 - KITCHEN CABINETRY: Kitchen top drawer on *island only* *2 LONG TOP DRAWERS* above 4 cabinet doors
Line11566	Note:
20Sep16 / 1Nov16	
Inv.831	2 - KITCHEN CABINETRY: Base Overlay Gable *island ends only*
Line11567	Note:
20Sep16 / 1Nov16	
Inv.831	1 - MASTER ENSUITE CABINETRY: Install vanity bank of 3 drawers
Line11577	Note:
20Sep16 / 1Nov16	

MISC.

Inv.548	1 - Purchasers are aware & accepts that ANY changes made to upgrades after signing this Purchasers Extra Form are subject to a minimum administration fee of \$500. PLUS a 10% holdback fee.
Line6793	Note:
7Jun16 / 17Aug16	
Inv.548	1 - Purchaser has attended a Structural appointment at the Decor Centre & has DECLINED any additional upgrades and accepts and acknowledges that there will be no further structural changes/additions/deletions to be made upon signing on June 9, 2016.
Line6792	Note:
7Jun16 / 17Aug16	
Inv.548	1 - BONUS PACKAGE: \$5,000.00 (INCLUDING TAXES) WORTH OF UPGRADES FROM GOLD PARK HOMES DÉCOR CENTRE IS BEING APPLIED TOWARD THE STRUCTURAL APPOINTMENT. PURCHASER HAS A REMAINING AMOUNT OF \$4700.55 (INCLUDING TAXES) TO BE USED TOWARD THE COLOUR APPOINTMENT.
Line6794	Note:
7Jun16 / 17Aug16	
Inv.831	1 - Purchasers are aware & accepts that ANY changes made to upgrades after signing this Purchasers Extra Form are subject to a minimum administration fee of \$500. PLUS a 10% holdback fee.
Line11579	Note:
20Sep16 / 1Nov16	
Inv.831	1 - STRUCTURAL & C/CHART DISCLAIMER: Purchaser has attended a Colour appointment at the Decor Centre & has DECLINED any additional upgrades and accepts and acknowledges that there will be no further structural changes/additions/deletions to be made.
Line11578	Note:
20Sep16 / 1Nov16	

PAINTING

Inv.831	1 - MAIN STAIRS: STAIN STAIRS TO MATCH HARDWOOD (as close as possible) (treads, pickets, handrail) - Note: Stairs are oak and hardwood is ash - colour may not match exactly
Line11575	Note:
20Sep16 / 1Nov16	
Inv.831	1 - MAIN STAIRS: paint risers and stringers white
Line11576	Note:
20Sep16 / 1Nov16	

WINDOWS - BASEMENT



CONSTRUCTION SUMMARY

Kleinburg Glen - 19L - 1 - 25-1 Elev.B RIVERSTONE OPT- GFA1

Inv.548	1 - COLD CELLAR - BASEMENT WINDOWS - Install EXTRA BASEMENT WINDOW 30 INCH X 12 INCH, see plan for location
Line6654	Note:
7Jun16 / 17Aug16	

Purchasers: Joseph Spadaro & Emily Gallo

Property: 19L

Telephone Res. / Bus: (647) 402-2915

Project: Burkshire Holdings Inc.

Decor Advisor: Yolande Somerville

Model and Elevation: 25-1 Elev.B RIVERSTONE OPT- GFA1

Layout Changes: ☐ Yes ☒ No      Sketch Attached: ☒ Yes ☐ No      Exterior Colour Scheme:

1. Cabinetry

	Style and Colour	Counter	Hardware
Kitchen / Breakfast	Varese pvc 'crystal whit	Grigio Sardo Edge FE-20	CS1-6
Laundry Room	n/a	n/a	n/a
Powder Room	n/a	n/a	n/a
Master Ensuite Bathroom	Varese pvc 'crystal whit	P-344LM 'Inukshuk Grey'	cs1-24
Second Ensuite Bathroom (If Applicable)			
Main Bath	Siena Oak 'greystone'	P-948CA 'Hiverna'	cs1-24
Dishwasher Cabinet	n/a		
Comment			

2. Floor Tile

	Selection	Grout	Threshold
Entrance Vestibule	*18x18" Champions 'white'	n/a	n/a
Main Hall	n/a	n/a	n/a
Kitchen / Breakfast	*18x18" Champions 'white'	n/a	n/a
Laundry Room	*18x18" Champions 'white'	n/a	n/a
Powder Room	*18x18" Champions 'white'	n/a	n/a
Master Ensuite Bathroom	*12x24" New Byzantine 'Pentellic Grey'	n/a	n/a
Second Ensuite Bathroom (If Applicable)			
Lower Landing (If Applicable)			
Main Bath	*12x24" New Byzantine 'Pentellic Grey'	n/a	n/a
Comment			

3. Wall Tile

	Selection	Listello/Inserts	Describe
Main Bath	8x10" Reflection 'White'	<input type="radio"/> Yes <input checked="" type="radio"/> No	
Master Ensuite Bathroom			
Tub Deck	8x10" Reflection 'White'	<input type="radio"/> Yes <input checked="" type="radio"/> No	
Shower Stall	8x10" Reflection 'White'	<input type="radio"/> Yes <input checked="" type="radio"/> No	
Bathroom Walls	n/a	<input type="radio"/> Yes <input checked="" type="radio"/> No	
Second Ensuite Bathroom (If Applicable)		<input type="radio"/> Yes <input checked="" type="radio"/> No	
		<input type="radio"/> Yes <input type="radio"/> No	
Kitchen Backsplash	<input type="radio"/> Yes <input checked="" type="radio"/> No	Backsplash Behind Fridge	n/a
Comment			



Purchasers: Joseph Spadaro & Emily Gallo

Property: 19L

Telephone Res. / Bus: (647) 402-2915

Project: Burkshire Holdings Inc.

Decor Advisor: Yolande Somerville

Model and Elevation: 25-1 Elev.B RIVERSTONE OPT- GFA1

#### 4. Plumbing Fixtures

<input type="text"/>	<b>Second Ensuite</b>	<input type="text"/>	<b>Powder Room</b>	<input type="text"/>
<b>Master Ensuite Bathroom</b>	<input type="text"/>	<b>Other Room - Specify</b>	<input type="text"/>	<b>Other Washroom</b>
<input type="text"/>				

##### Comment

All plumbing fixtures to be standard.

#### 5. Hardwood Flooring

	Type and Stain		Type and Stain
<b>Main Hall</b>	*3/4x4-1/4" Ash Brushed 'Komodo'	<b>Upper Landing</b>	n/a
<b>Kitchen / Breakfast</b>	n/a	<b>Upper Hall</b>	*3/4x4-1/4" Ash Brushed 'Komodo'
<b>Living Room</b>	n/a	<b>Master Bedroom</b>	n/a
<b>Dining Room</b>	n/a	<b>Bedroom #2</b>	n/a
<b>Family Room</b>	*3/4x4-1/4" Ash Brushed 'Komodo'	<b>Bedroom #3</b>	n/a
<b>Den/Library</b>	n/a	<b>Bedroom #4</b>	n/a
<b>Entrance Vestibule</b>	n/a	<b>Bedroom #5</b>	n/a
<b>Lower Landing (If Applicable)</b>	n/a	<b>Other Room - Specify</b>	<input type="text"/>

##### Comment

#### 6. Carpeting

	Upgrade	Description
<b>Main Hall</b>	<input type="checkbox"/>	n/a
<b>Living Room</b>	<input type="checkbox"/>	n/a
<b>Dining Room</b>	<input type="checkbox"/>	n/a
<b>Family Room</b>	<input type="checkbox"/>	n/a
<b>Den/Library</b>	<input type="checkbox"/>	n/a
<b>Upper Hall</b>	<input type="checkbox"/>	n/a
<b>Master Bedroom</b>	<input type="checkbox"/>	T-15
<b>Bedroom #2</b>	<input type="checkbox"/>	T-15
<b>Bedroom #3</b>	<input type="checkbox"/>	T-15
<b>Bedroom #4</b>	<input type="checkbox"/>	n/a
<b>Bedroom #5</b>	<input type="checkbox"/>	n/a
<input type="text"/>	<input type="checkbox"/>	<input type="text"/>
<b>Upper Landing (If Applicable)</b>	<input type="checkbox"/>	n/a
<b>Lower Landing (If Applicable)</b>	<input type="checkbox"/>	n/a

<b>Upgrade Underpad</b>	Type n/a	Area n/a
<b>Carpet on Stairs</b>	Capped n/a	Runner - *Upgrade n/a

##### Comment

Scheduled Closing Date: Wednesday, September 28, 2016

Purchasers: Joseph Spadaro &amp; Emily Gallo

Property: 19L

Telephone Res. / Bus: (647) 402-2915

Project: Burkshire Holdings Inc.

Decor Advisor: Yolande Somerville

Model and Elevation: 25-1 Elev.B RIVERSTONE OPT- GFA1

## 7. Fireplace

	Living Room			Family Room			Other Room - Specify		
	Purchased	As Per Plan	N/A	Purchased	As Per Plan	N/A	Purchased	As Per Plan	N/A
Fireplace Type	<input type="radio"/>	<input type="radio"/>	<input checked="" type="radio"/>	<input type="radio"/>	<input checked="" type="radio"/>	<input type="radio"/>	<input type="radio"/>	<input type="radio"/>	<input checked="" type="radio"/>
Mantle Type				standard					
Colour / Stain				standard					
Surround				n/a					
Hearth				n/a					

Comment

## 8. Trim Carpentry

Interior Doors	standard	Front Door Glass Inserts	n/a	Door Handles	standard
Interior Trim	standard				

Comment

## 9. Plaster Mouldings and Medallions

Entrance Vestibule	n/a		Kitchen/Breakfast	n/a	
Main Hall	n/a		Den/Library	n/a	
Living Room	n/a		Lower Landing	n/a	
Dining Room	n/a		Other Room - Specify		
Family Room	n/a				

Comment

## 10. Railings and Spindles

Railing Package	standard		
Railing Colour	*match hdwd (as close as possible)		
Stringer / Riser	*white		
Spindle Colour	*match hdwd (as close as poss		
Treads	*match hdwd (as close as poss		
Oak Stairs	<input checked="" type="radio"/> Yes <input type="radio"/> No		

Comment

## 11. Wall Paint

Main & Upper Hall	warm grey	Master Bedroom	warm grey
Living Room	n/a	Bedroom #2	warm grey
Dining Room	n/a	Bedroom #3	warm grey
Kitchen / Breakfast	warm grey	Bedroom #4	n/a
Family Room	warm grey	Bedroom #5	n/a
Powder Room	warm grey	Master Ensuite	warm grey
Laundry Room	warm grey	Main Bath	warm grey
Den/Library	n/a	Second Ensuite	
Trim Paint	white		
Comment	Smooth Ceilings First Floor		

96

JH

Purchasers: Joseph Spadaro & Emily Gallo

Property: 19L

Telephone Res. / Bus: (647) 402-2915

Project: Burkshire Holdings Inc.

Decor Advisor: Yolande Somerville

Model and Elevation: 25-1 Elev.B RIVERSTONE OPT- GFA1

12. Electrical

Plugs and Switches ☒ White ☐ Ivory

Hood Fan ☐ White ☐ Ivory

Appliances ☐ Yes ☒ No

Comment

Built in Cooktop ☐ Yes ☒ No

Built in Oven ☐ Yes ☒ No

Gas Stove ☐ Yes ☒ No

Microwave ☐ Yes ☒ No

Above Kitchen Cabinet Light ☐ Yes ☒ No

Below Kitchen Cabinet Light ☐ Yes ☒ No

Standard stainless hood fan

13. Heating and Air Conditioning

Air Conditioning

Gas Provisions Dryer

Comment

Gas Provisions Stove

Gas Provisions Barbecue

standard gas bbq line

14. Additional Comments

15. Disclaimers and Notes

- Colours of all materials are as close as possible to builder's selection, but not necessarily identical due to variances in manufacturing.
- Any extras listed above are null and void unless accompanied by a separate invoice/amendment. Said invoice must be paid in full.
- The Purchaser acknowledges that after Interior Colour Selection form is signed and dated, no further changes will be permitted other than re-selection due to unavailability. Purchaser's Initials
- The Purchaser acknowledges reading and accepting the "Gold Park Homes Decor Centre Disclaimers" form. This document contains other miscellaneous disclaimers.

This Interior Colour Selection is final and approved by:

Signature: 

Date:

Signature: 

Date:

Trade Name: Gold Park Homes	Site location:	Model: 25-1
Address:	Project: Kleinburg Glen	Phase:

This layout has been explained to the purchaser by Cortina Kitchens Inc. and is understood by the purchaser.

KG-19L.

OPT. GROUND FLOOR KITCHEN

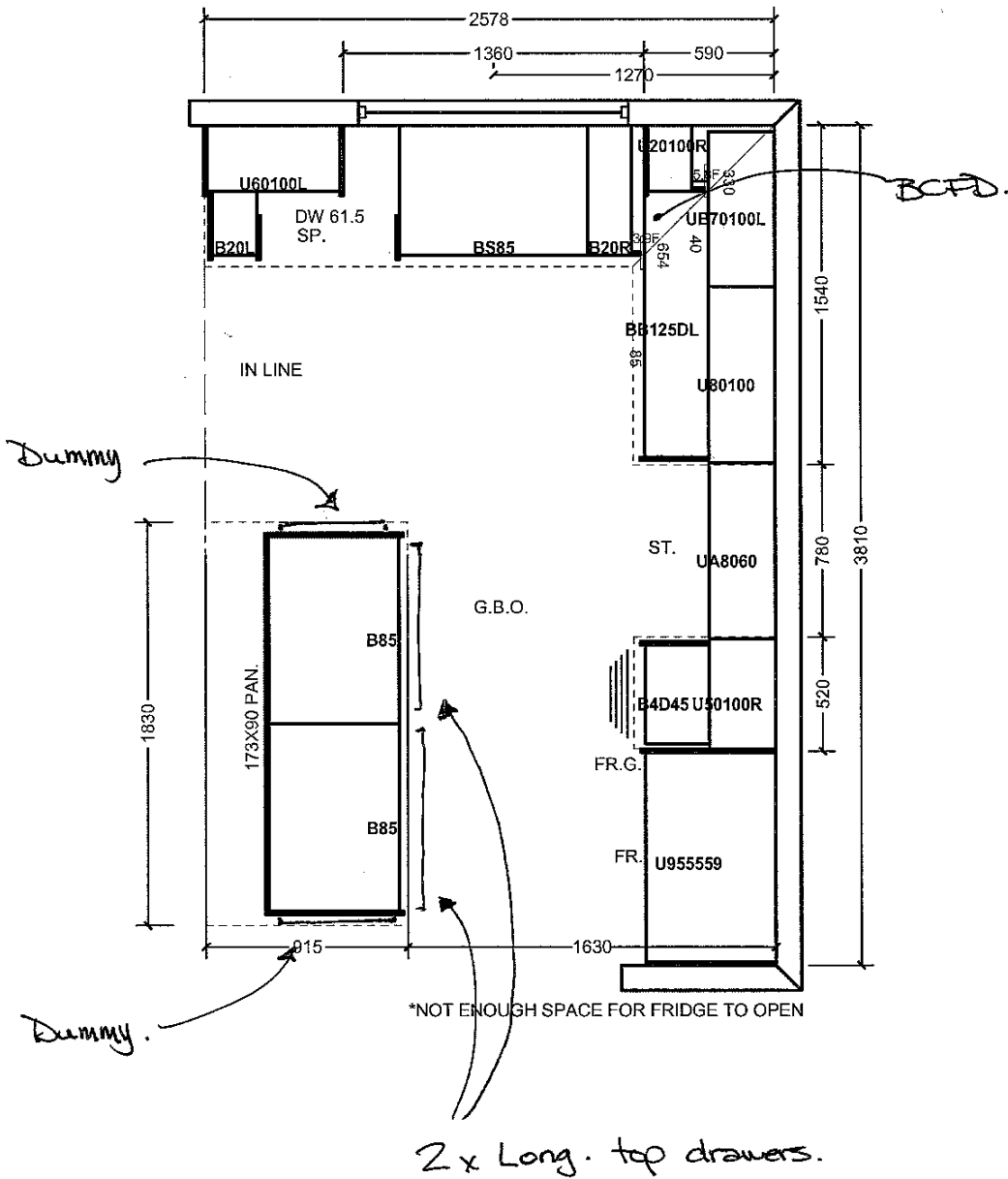

All prices subject to confirmation from head office.  
This quotation is subject to the terms & conditions set out

ACCEPTED DATE: SEPT 20 2016

*[Signature]*

All agreements are contingent upon strikes, accidents, and delays beyond our control.  
Please provide our installer with template for sinkholes or \$150.00 will be charged for callback.

*[Signature]*

Item A. Wood grain and colour are characteristics of the product. We cannot guarantee that such grain and colour will always match.  
Item B. Cortina Kitchens Inc. reserves the right to alter dimensions and make technical changes without notice.



# CORTINA

70 Regina Road, Woodbridge, Ontario L4L 8L6  
Tel: 905-284-8484 Fax: 905-284-0884  
www.CortinaKitchens.com

## QUOTATION

Date: 28/06/16

19-L.

Trade Name: Gold Park Homes

Site location:

Model: 25-1

Address:

Project: Kleinburg Glen

Phase:

This layout has been explained to the purchaser by Cortina Kitchens Inc. and is understood by the purchaser.

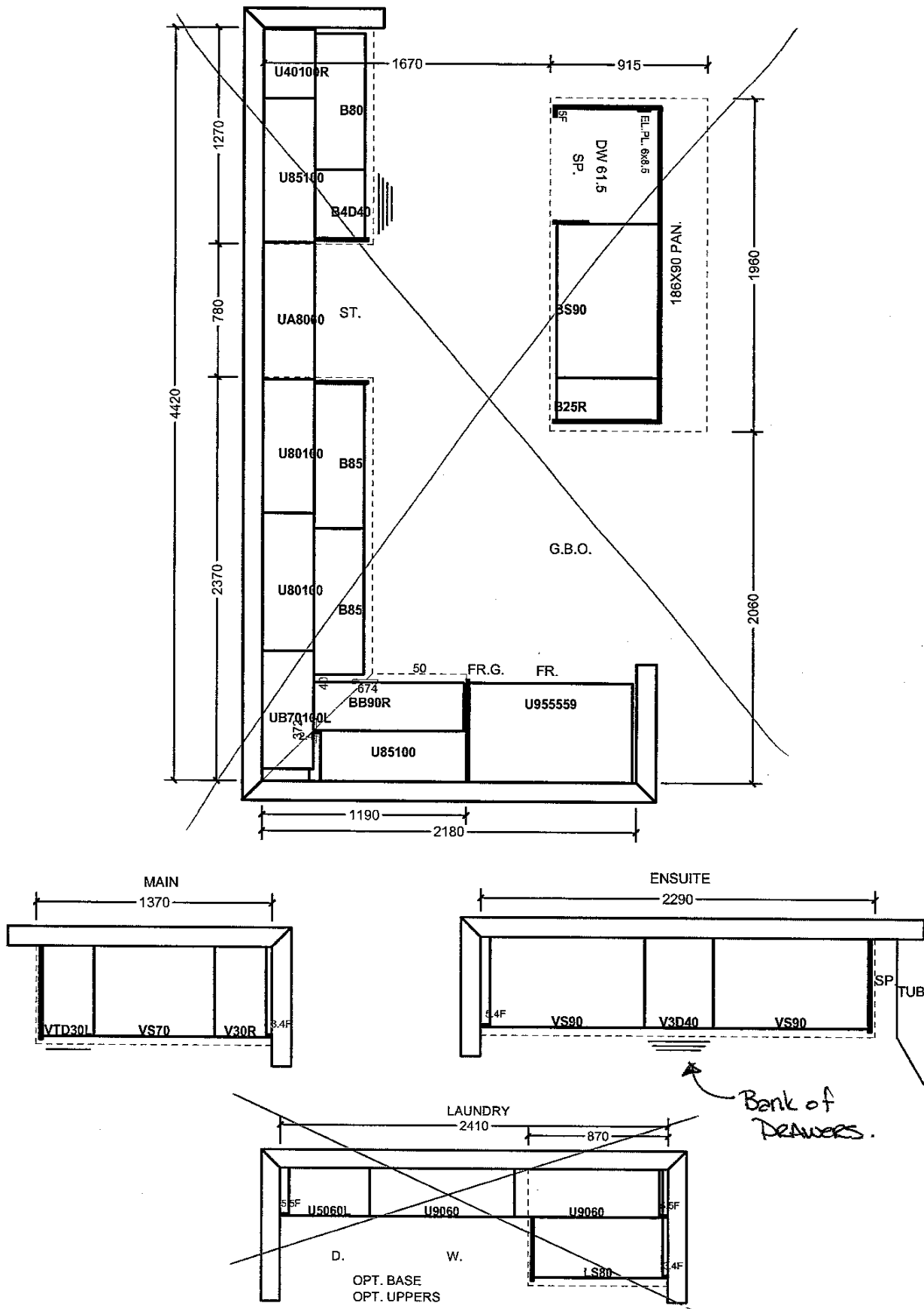

All prices subject to confirmation from head office.  
This quotation is subject to the terms & conditions set out

All agreements are contingent upon strikes, accidents, and delays beyond our control.  
Please provide our installer with template for sinkholes or \$150.00 will be charged for callback.

ACCEPTED DATE: Sept 20 2016

Item A. Wood grain and colour are characteristics of the product. We cannot guarantee that such grain and colour will always match.  
Item B. Cortina Kitchens Inc. reserves the right to alter dimensions and make technical changes without notice.

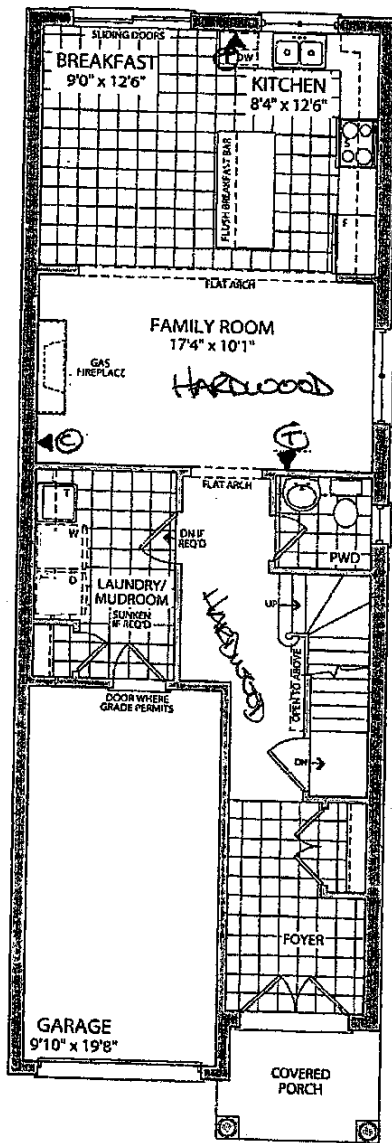

OPT. GROUND FLOOR  
ELEVATION A

LEGEND

▲(T) - PHONE

▲(C) - CABLE

19-L (eb) (dl)  
SEPT 20 2016

(eb) (dl) 19-L  
JUNE 9 2016

TILE DIRECTION



Bank of drawers.

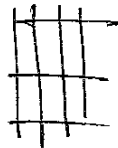
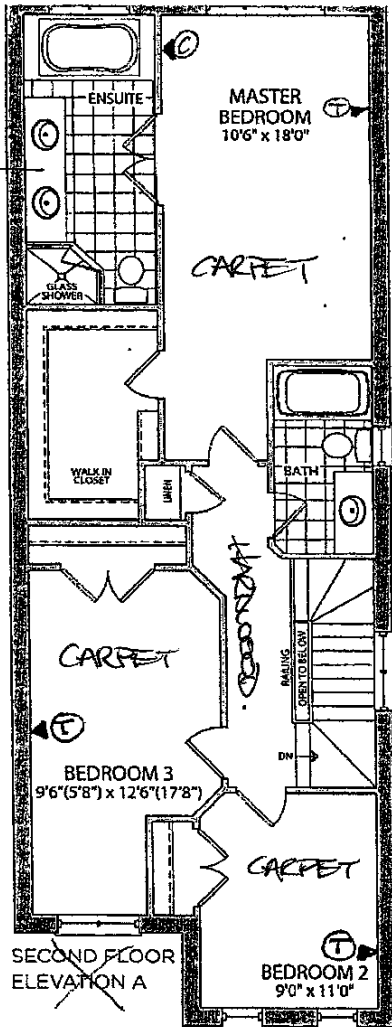

TILE DIRECTION

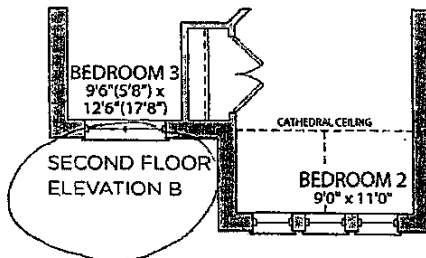

86 19-L  
JUNE 9 2016

96 19-L  
Sept 20 2016

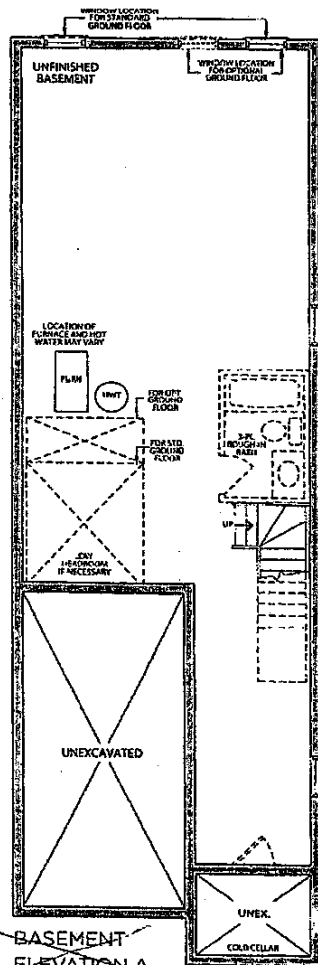

~~BASEMENT ELEVATION A~~

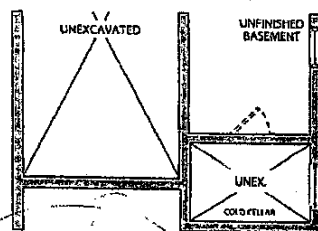

BASEMENT ELEVATION B

19-L  
JUNE 9 2016  
96 11

19-L  
SEPT 20 2016  
96 11

\* ADD (1) 12x30" WINDOW IN COLD CELLAR

STANDARD HARDWARE

STANDARD HARDWARE

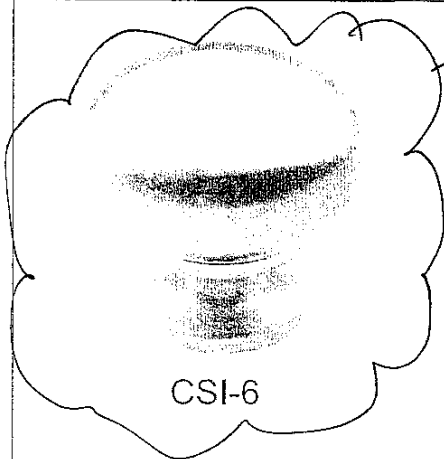

CSI-6

KITCHEN

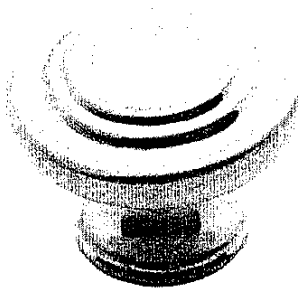

CSI-10

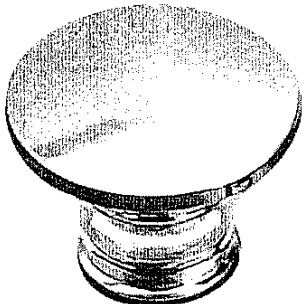

CSI-14

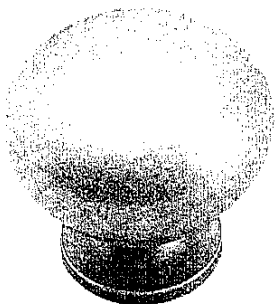

CSI-16

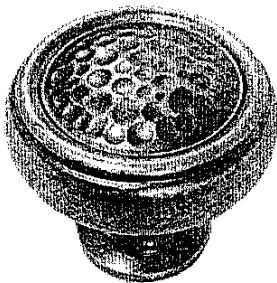

CSI-18

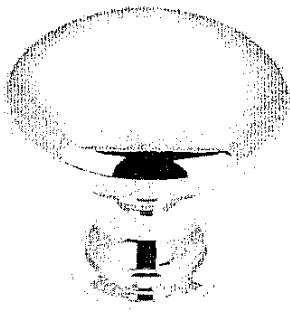

CSI-19

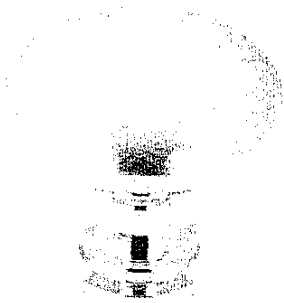

CSI-20

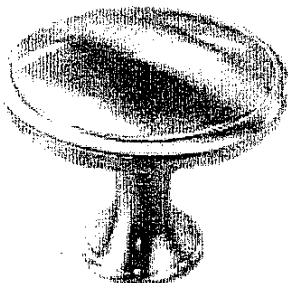

CSI-21

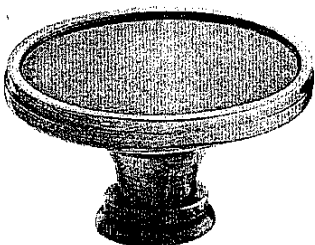

CSI-22

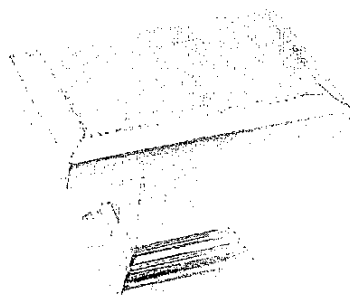

CSI-23

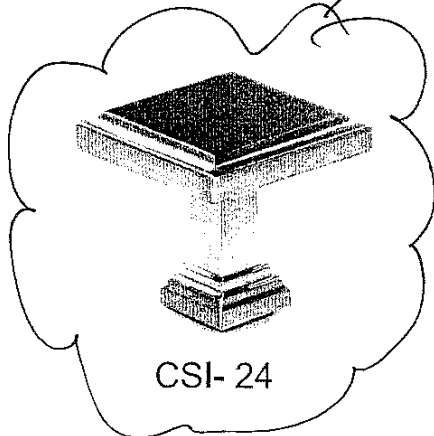

CSI-24

BATHROOMS

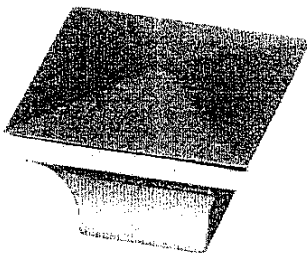

CSI-25

\*NOTES:

- IMAGES ARE FOR QUICK REFERENCE PURPOSES ONLY
- ACTUAL SIZES AND FINISHES AS PER HARDWARE SAMPLE BOARD PROVIDED TO DECOR CENTRE

KG-19-L

96 2/1

Sept 20 2016

KITCHEN

20mm (3/4") Profiles