



CONSTRUCTION SUMMARY

Kleinburg Glen - 26L - 1 - 25-3 Elev.A OAKMOUNT OPT- GFA1 AND SFA5
CENTRAL VAC AND WIRING

Inv.662	1 - GREAT ROOM: CONDUIT PIPE - FOR TELEVISION - LOCATED ABOVE FIREPLACE APPROX 66" AFF. TERMINATING LEFT OF FIREPLACE. PLEASE SEE FLOORPLAN FOR DETAIL
Line8517	Note:
14Jul16 / 17Aug16	

CERAMIC

Inv.859	1 - MAIN BATH: UPG 1 Wall tile CDC 4x16 Arctic White
Line12846	Note:
26Sep16 / 4Nov16	
Inv.859	1 - UPG: ***DELETE STANDARD BATHROOM ACCESSORIES THROUGHOUT ALL BATHROOMS***
Line11916	Note:
26Sep16 / 4Nov16	
Inv.859	1 - MASTER ENSUITE: UPG 1 Wall Tile - 4x16" CDC Taupe Bright
Line12845	Note:
26Sep16 / 4Nov16	
Inv.859	1 - MAIN FLOOR- FOYER / POWDER ROOM /MUD ROOM / KITCHEN: UPG 2 Sacramento Grey 8x24
Line12843	Note:
26Sep16 / 4Nov16	

ELECTRICAL

Inv.662	1 - GREAT ROOM: 110V WALL RECEPTACLE ON NORMAL CIRCUIT - LOCATED ABOVE FIREPLACE APPROX 66" AFF. NEXT TO CONDUIT PIPE & CABLE. PLEASE SEE FLOORPLAN FOR DETAIL
Line8518	Note:
14Jul16 / 17Aug16	
Inv.662	4 - KITCHEN: POT LIGHT: 4 INCH HALOGEN POT LIGHT - 440 WH - X 4. PLEASE SEE FLOORPLAN FOR LOCATIONS
Line8519	Note:
14Jul16 / 17Aug16	
Inv.662	1 - KITCHEN POTLIGHTS: ON A SEPARATE SWITCH
Line8520	Note:
14Jul16 / 17Aug16	
Inv.662	1 - KITCHEN: RELOCATE STANDARD KITCHEN CEILING LIGHT TO OVER ISLAND. LEFT SIDE. PLEASE SEE FLOORPLAN FOR LOCATION
Line8521	Note:
14Jul16 / 17Aug16	
Inv.662	1 - KITCHEN: ROUGH - IN CEILING OUTLET (WITH COVER PLATE) - DOES NOT INCLUDE FIXTURE - RIGHT SIDE OVER ISLAND. BOTH CEILING ISLAND LIGHTS TO BE ON THE SAME STANDARD SWITCH. PLEASE SEE FLOORPLAN FOR LOCATION.
Line8522	Note:
14Jul16 / 17Aug16	
Inv.662	1 - KITCHEN CABINET STRIP VALANCE LIGHTS (UNDER CABINETS) - ROUGH - IN - DOES NOT INCLUDE (AND REQUIRES) KITCHEN UPGRADE PRICING. ABOVE DISHWASHER, LEFT & RIGHT OF OVEN.
Line8523	Note: PLEASE RELOCATE UNDERCABINET LIGHT SWITCH ABOVE DISHWASHER, LEFT OF SINK. SEE FLOORPLAN FOR LOCATION
14Jul16 / 17Aug16	



CONSTRUCTION SUMMARY

Kleinburg Glen - 26L - 1 - 25-3 Elev.A OAKMOUNT OPT- GFA1 AND SFA5

Inv.662	8 - GREAT ROOM: POT LIGHT: 4 INCH HALOGEN POT LIGHT - 440 WH - x8. 4 x IN ZONE 1, 4 x IN ZONE 2. BOTH ON SEPARATE SWITCHES. PLEASE SEE FLOORPLAN FOR LOCATIONS.
Line8526	Note:
14Jul16 / 17Aug16	
Inv.662	2 - GREAT ROOM: ZONE 1 & ZONE 2 POTLIGHTS ON TWO SEPARATE SWITCHES
Line8527	Note:
14Jul16 / 17Aug16	

EXTERIOR COLOURS

Inv.662	1 - EXTERIOR COLOUR PACKAGE 3
Line10267	Note:
14Jul16 / 17Aug16	

FRAMING

Inv.662	1 - MASTER ENSUITE: DELETE TUB TO ACCOMMODATE RELOCATED TOILET AND ADD FULL WIDTH FRAMELESS SHOWER. PLEASE SEE FLOORPLAN FOR LOCATIONS.
Line10266	Note:
14Jul16 / 17Aug16	
Inv.859	1 - OPTIONAL GROUND FLOOR
Line13301	Note:
26Sep16 / 4Nov16	
Inv.859	1 - OPTIONAL 4TH BEDROOM PLAN
Line13302	Note:
26Sep16 / 4Nov16	

GRANITE MARBLE QUARTZ

Inv.859	1 - KITCHEN: DO NOT INSTALL BREAKFAST BAR OVERHANG - COUNTERTOP EDGE: UPG TO 1-1/2" FE40
Line11903	Note:
26Sep16 / 4Nov16	
Inv.859	1 - MASTER ENSUITE: COUNTERTOP - UPG 3: 4030 STONE GREY CAESARSTONE
Line11909	Note: STANDARD STRAIGHT 3/4" EDGE H20
26Sep16 / 4Nov16	
Inv.859	1 - KITCHEN / COUNTERTOP: Range code states SLIDE-In, Purchaser requesting NOT TO accommodate for a slide in Range as it has a 1-1/4" lip at the back and will protrude into kitchen space. Please LEAVE as a standard opening.
Line13303	Note:
26Sep16 / 4Nov16	
Inv.859	1 - MASTER ENSUITE: UPG VANITY SINK - CONTRAC CAMDEN 16' SQUARE UNDERMOUNT SINK 4210CHY
POLISHED EDGE FOR UNDERMOUNT SINK	
Line13333	Note:
26Sep16 / 4Nov16	

HARDWOOD

Inv.859	1 - MAIN FLOOR: MAIN HALLWAY AND GREAT ROOM - UPG 2 PREVERCO Hard Maple Komodo PRO 3-1/4"
Line11905	Note:
26Sep16 / 4Nov16	

Kleinburg Glen - 26L - 1 - 25-3 Elev.A OAKMOUNT OPT- GFA1 AND SFA5

Inv.859	1 - 2ND FLOOR HALLWAY - UPG 2 PREVERCO Hard Maple Komodo PRO 3-1/4"
Line11906	Note:
26Sep16 / 4Nov16	

HVAC

Inv.662	1 - KITCHEN: PLEASE LOCATED STANDARD HOOD VENT PIPE CENTERED OVER OVEN OPENING TO ACCOMMODATE CHIMNEY STYLE HOOD.
Line8530	Note:
14Jul16 / 17Aug16	
Inv.859	1 - KITCHEN: Purchaser to Supply & Install Gas line for Range at own expense and warranty after closing
Line12838	Note:
26Sep16 / 4Nov16	

INTERIOR TRIM AND DOORS

Inv.662	2 - MAIN FLOOR: EXTENDED HEIGHT ARCHWAY (PRICE PER DOORWAY)
Line9245	Note:
14Jul16 / 17Aug16	
Inv.662	5 - STANDARD DOOR EXTENDED HEIGHT 96 INCH (PRICE PER DOOR) - GROUND FLOOR 2 STOREY MODELS
Line9246	Note:
14Jul16 / 17Aug16	

KITCHEN AND BATH CABINETRY

Inv.859	1 - KITCHEN: UPG: ADD LIGHT VALANCE AT LOWER PERIMETER OF CABINETRY
Line11901	Note:
26Sep16 / 4Nov16	
Inv.859	2 - KITCHEN: DELETE UPPER CABINETS OVER SLIDE-IN-RANGE AND ADD SIDE OVERLAY GABLES TO UPPER CABINETS To Accommodate Chimney Style Hood Fan
Line12323	Note: Please see Kitchen Drawing for location
26Sep16 / 4Nov16	
Inv.859	1 - KITCHEN / COUNTERTOP: Range code states SLIDE-In, Purchaser requesting NOT TO accommodate for a slide in Range as it has a 1-1/4" lip at the back and will protrude into kitchen space. Please LEAVE as a standard opening.
Line12324	Note:
26Sep16 / 4Nov16	
Inv.859	1 - KITCHEN: UPG BASE CORNER FOLDING DOOR
Line12837	Note: Please see kitchen drawing for location
26Sep16 / 4Nov16	
Inv.859	1 - KITCHEN: DO NOT INSTALL BREAKFAST BAR OVERHANG - COUNTERTOP EDGE: UPG TO 1-1/2" FE40
Line13300	Note:
26Sep16 / 4Nov16	

MISC.

Inv.662	1 - Purchaser has attended a Structural appointment at the Decor Centre & has DECLINED any additional upgrades and accepts and acknowledges that there will be no further structural changes/additions/deletions to be made upon signing on July 14, 2016.
Line8612	Note:
14Jul16 / 17Aug16	

Kleinburg Glen - 26L - 1 - 25-3 Elev.A OAKMOUNT OPT- GFA1 AND SFA5

Inv.662	1 - Purchasers are aware & accepts that ANY changes made to upgrades after signing this Purchasers Extra Form are subject to a minimum administration fee of \$500. PLUS a 10% holdback fee.
Line8613	Note:
14Jul16 / 17Aug16	
Inv.662	1 - BONUS PACKAGE: \$5,000.00 (INCLUDING TAXES) WORTH OF UPGRADES FROM GOLD PARK HOMES DÉCOR CENTRE IS BEING APPLIED TOWARD THE STRUCTURAL APPOINTMENT. PURCHASER HAS A REMAINING AMOUNT OF \$00 (INCLUDING TAXES) TO BE USED TOWARD THE COLOUR APPOINTMENT.
Line8614	Note:
14Jul16 / 17Aug16	
Inv.662	1 - Balance paid by VISA \$7,266.15
Line8616	Note:
14Jul16 / 17Aug16	
Inv.859	1 - Due to the many variables that can affect the pattern, colour and/or design and "pitting" of natural products, granite installed will not be identical to the samples displayed.
Line12842	Note: Every effort is made to provide granite counter tops as close as possible but the vendor is not responsible for results which differ from the sample displayed. All countertop surfaces may have seems & product pattern & shade can change in areas containing seems.
26Sep16 / 4Nov16	
Inv.859	1 - Purchaser has attended a Structural appointment at the Decor Centre & has DECLINED any additional upgrades and accepts and acknowledges that there will be no further structural changes/additions/deletions to be made upon signing
Line12326	Note:
26Sep16 / 4Nov16	
Inv.859	1 - Purchasers are aware & accepts that ANY changes made to upgrades after signing this Purchasers Extra Form are subject to a minimum administration fee of \$500. PLUS a 10% holdback fee.
Line12327	Note:
26Sep16 / 4Nov16	
Inv.859	1 - STAIRCASE - The purchaser was advised and therefore accepts and acknowledges that the wood species of the staircase and flooring chosen do not match. This difference may result in a stain colour variance.
Line12839	Note: The purchaser agrees that the vendor is to be exempt from any and all claims by the purchaser regarding this colour variance.
26Sep16 / 4Nov16	
Inv.859	1 - STAIRCASE - The purchaser was advised and therefore accepts and acknowledges that the stain of the staircase and flooring chosen do not match. This difference might result in an undesirable colour variance.
Line12840	Note: The purchaser agrees that the vendor is to be exempt from any and all claims by the purchaser regarding this colour variance.
26Sep16 / 4Nov16	
Inv.859	1 - KITCHEN - Purchasers request to NOT INSTALL builder's standard hood fan and standard cabinets above stove. DELETE. Do not supply, install, and/or credit. Purchasers are installing their own hood fan after closing.
Line12841	Note: Purchasers accept and acknowledge that the exhaust fan duct hole may be off-centered with stove in kitchen due to purchasers installing their own hood fan after closing. The vendor is exempt.
26Sep16 / 4Nov16	

PAINT

Inv.859	1 - STAIRS & RAILING STAIN: UPG: STAIN COLOUR Generation Cobalt
Line11912	Note:
26Sep16 / 4Nov16	

PLUMBING

Inv.662	1 - MASTER ENSUITE: DELETE TUB TO ACCOMMODATE RELOCATED TOILET AND ADD FULL WIDTH FRAMELESS SHOWER. PLEASE SEE FLOORPLAN FOR LOCATIONS.
Line9237	Note:
14Jul16 / 17Aug16	



CONSTRUCTION SUMMARY

Kleinburg Glen - 26L - 1 - 25-3 Elev.A OAKMOUNT OPT- GFA1 AND SFA5

Inv.662	1 - MASTER ENSUITE: RELOCATE TOILET. PLEASE SEE FLOORPLAN FOR LOCATION
Line9236	Note:
14Jul16 / 17Aug16	

PLUMBING FIXTURES

Inv.859	1 - MASTER ENSUITE: UPG VANITY SINK - CONTRAC CAMDEN 16' SQUARE UNDERMOUNT SINK 4210CHY
Line11910	Note: Polished Cut out Included
26Sep16 / 4Nov16	

STAIRS AND RAILINGS

Inv.859	1 - UPG: EUROLINE 1 MATTE SPINDALS
Line11913	Note:
26Sep16 / 4Nov16	
Inv.859	1 - UPG: RAILING TO V-GROOVE HANDRAIL
Line11915	Note:
26Sep16 / 4Nov16	

Scheduled Closing Date: October-25-16

Purchasers: David Assis & Cindy L Nichol

Property: 26L

Telephone Res. / Bus: (416) 846-2292

Project: Burkshire Holdings Inc.

Decor Advisor: Laura Lofaro

Model and Elevation: 25-3 Elev.A OAKMOUNT OPT- GFA1 ANE

Layout Changes: ☒ Yes ☐ NoSketch Attached: ☒ Yes ☐ NoExterior Colour Scheme:

1. Cabinetry

	Style and Colour	Counter	Hardware
Kitchen / Breakfast	Varese PVC Wht, Cryst	*Granite Grigio Sardo - WITHOUT Overhang	CS1-14
Laundry Room	N/A		
Powder Room	N/A		
Master Ensuite Bathroom	Varese PVC Choc. Mapl	*Caesarstone 4030 Stone Grey	CS1-14
Second Ensuite Bathroom (If Applicable)	N/A		
Main Bath	Varese PVC Choc. Mapl	Formica 8830-58 Elemental Concrete	CS1-14
Dishwasher Cabinet			

Comment

Kitchen Counter Edge: 1-1/2" FE40
Master Ensuite Counter Edge: STD H20

2. Floor Tile

	Selection	Grout	Threshold
Entrance Vestibule	*Sacramento Grey 8x24	N/A	
Main Hall	N/A	N/A	
Kitchen / Breakfast	*Sacramento Grey 8x24	N/A	
Laundry Room	Sacramento WHITE 13x13	N/A	
Powder Room	*Sacramento Grey 8x24	N/A	
	MUD ROOM: *Sacramento Grey 8x24		
Master Ensuite Bathroom	Sacramento White 13x13	N/A	
Second Ensuite Bathroom (If Applicable)	N/A	N/A	
Lower Landing (If Applicable)	N/A	N/A	
Main Bath	Sacramento White 13x13	N/A	

Comment

3. Wall Tile

	Selection	Listello/Inserts	Describe
		<input type="radio"/> Yes <input checked="" type="radio"/> No	
Master Ensuite Bathroom			
Tub Deck	N/A	<input type="radio"/> Yes <input checked="" type="radio"/> No	
Shower Stall	*CDC 4x16 Taupe Bright	<input type="radio"/> Yes <input checked="" type="radio"/> No	
Bathroom Walls	N/A	<input type="radio"/> Yes <input checked="" type="radio"/> No	
Second Ensuite Bathroom (If Applicable)	N/A	<input type="radio"/> Yes <input checked="" type="radio"/> No	
Main Bath	*CDC 4x16 Arctic White Bright	<input type="radio"/> Yes <input checked="" type="radio"/> No	
Kitchen Backsplash	<input type="radio"/> Yes <input checked="" type="radio"/> No	Backsplash Behind Fridge	N/A

Comment

Tub Deleted at Structural appmt

Purchasers: David Assis & Cindy L Nichol

Property: 26L

Telephone Res. / Bus: (416) 846-2292

Project: Burkshire Holdings Inc.

Decor Advisor: Laura Lofaro

Model and Elevation: 25-3 Elev.A OAKMOUNT OPT- GFA1 ANC

4. Plumbing Fixtures

Master Ensuite Bathroom Second Ensuite Powder Room STD
Other Room - Specify STD Other Washroom STD
Kitchen

Comment

Master Ensuite UPG VANITY SINK - Camden 16" Square with Polished cut-out
All other plumbing Fixtures Standard throughout

5. Hardwood Flooring

	Type and Stain		Type and Stain
Main Hall	*Preverco Hd.Maple KomodoPRO	Upper Landing	N/A
Kitchen / Breakfast	N/A	Upper Hall	*Preverco Hd.Maple KomodoPRO
Living Room	N/A	Master Bedroom	N/A
Dining Room	N/A	Bedroom #2	N/A
Family Room	N/A	Bedroom #3	N/A
Den/Library	N/A	Bedroom #4	N/A
Entrance Vestibule	N/A	Bedroom #5	N/A
Lower Landing (If Applicable)	N/A	Other Room - Specify	*Preverco Hd.Maple KomodoPRO
		GREAT ROOM	

Comment

*Preverco Hard Maple Komodo PRO 3-1/4"

6. Carpeting

	Upgrade	Description
Main Hall	<input type="checkbox"/>	N/A
Living Room	<input type="checkbox"/>	N/A
Dining Room	<input type="checkbox"/>	N/A
Family Room	<input type="checkbox"/>	N/A
Den/Library	<input type="checkbox"/>	N/A
Upper Hall	<input type="checkbox"/>	N/A
Master Bedroom	<input type="checkbox"/>	T15
Bedroom #2	<input type="checkbox"/>	T15
Bedroom #3	<input type="checkbox"/>	T15
Bedroom #4	<input type="checkbox"/>	T15
Bedroom #5	<input type="checkbox"/>	N/A
<input type="text"/>	<input type="checkbox"/>	<input type="text"/>
Upper Landing (If Applicable)	<input type="checkbox"/>	N/A
Lower Landing (If Applicable)	<input type="checkbox"/>	N/A

Upgrade Underpad Type Area
Capped Runner - *Upgrade
Carpet on Stairs

Comment

Purchasers: David Assis & Cindy L Nichol

Property: 26L

Telephone Res. / Bus: (416) 846-2292

Project: Berkshire Holdings Inc.

Decor Advisor: Laura Lofaro

Model and Elevation: 25-3 Elev.A OAKMOUNT OPT- GFA1 ANC

7. Fireplace

Living Room

Purchased ☐ As Per Plan ☐ N/A ☐

Family Room

Purchased ☐ As Per Plan ☐ N/A ☐

Other Room - Specify GREAT RM

Purchased ☐ As Per Plan ☒ N/A ☐

Fireplace Type

Gas

Mantle Type

STD Cast Stone

Colour / Stain

Surround

Hearth

Comment

Standard Cast Stone Fireplace without HEARTH

8. Trim Carpentry

Interior Doors

*STD

Front Door Glass Inserts

STD

Door Handles

STD

Interior Trim

STD

Comment

* ARCHWAYS AND DOORWAYS EXTENDED AT STRUCTURAL APPOINTMENT

9. Plaster Mouldings and Medallions

Entrance Vestibule

N/A

Kitchen/Breakfast

N/A

Main Hall

N/A

Den/Library

N/A

Living Room

N/A

Lower Landing

N/A

Dining Room

N/A

Other Room - Specify

Family Room

N/A

Comment

10. Railings and Spindles

Railing Package

EUROLINE 1 WITH V-GROOVE HANDRAIL

Railing Colour

Stain Generation Cobalt

Spindle Colour

N/A

Stringer / Riser

Stain Generation Cobalt

Treads

Stain Generation Cobalt

Comment

Matte Black Iron Pickets

Oak Stairs

☒ Yes ☐ No

11. Wall Paint

Main & Upper Hall

Warm Grey

Master Bedroom

Warm Grey

Living Room

N/A

Bedroom #2

Warm Grey

Dining Room

N/A

Bedroom #3

Warm Grey

Kitchen / Breakfast

Warm Grey

Bedroom #4

Warm Grey

Family Room

N/A

Bedroom #5

N/A

Powder Room

Warm Grey

Master Ensuite

N/A

Laundry Room

Warm Grey

Den/Library

N/A

Second Ensuite

Warm Grey

Trim Paint

White

GREAT ROOM

Warm Grey

Comment

Smooth Ceilings First Floor

Warm Grey Throughout

Scheduled Closing Date: October-25-16

Purchasers: David Assis & Cindy L Nichol

Property: 26L

Telephone Res. / Bus: (416) 846-2292

Project: Burkshire Holdings Inc.

Decor Advisor: Laura Lofaro

Model and Elevation: 25-3 Elev.A OAKMOUNT OPT- GFA1 ANC

12. Electrical

Plugs and Switches ☒ White ☐ Ivory

Above Kitchen Cabinet Light ☐ Yes ☒ No

Hood Fan ☐ White ☐ Ivory

Below Kitchen Cabinet Light ☒ Yes ☐ No

Appliances

Built in Cooktop

Built in Oven

Gas Stove

Microwave

☐ Yes ☒ No

☐ Yes ☒ No

☒ Yes ☐ No

☐ Yes ☒ No

Comment

***Purchaser to Supply and Install own Gas line at own expense and warranty after closing**
Rough-In for Under Cabinet Lighting
Chimney Style Hood Fan

13. Heating and Air Conditioning

Air Conditioning

Gas Provisions Stove

Gas Provisions Dryer

Gas Provisions Barbecue

Comment

14. Additional Comments

15. Disclaimers and Notes

- 1) Colours of all materials are as close as possible to builder's selection, but not necessarily identical due to variances in manufacturing.
- 2) Any extras listed above are null and void unless accompanied by a separate invoice/amendment. Said invoice must be paid in full.
- 3) The Purchaser acknowledges that after Interior Colour Selection form is signed and dated, no further changes will be permitted other than re-selection due to unavailability. D.A. CW Purchaser's Initials
- 4) The Purchaser acknowledges reading and accepting the "Gold Park Homes Decor Centre Disclaimers" form. This document contains other miscellaneous disclaimers.

This Interior Colour Selection is final and approved by:

Signature: 

Date: Oct 18, 2016

Signature: 

Date: Oct 18, 2016

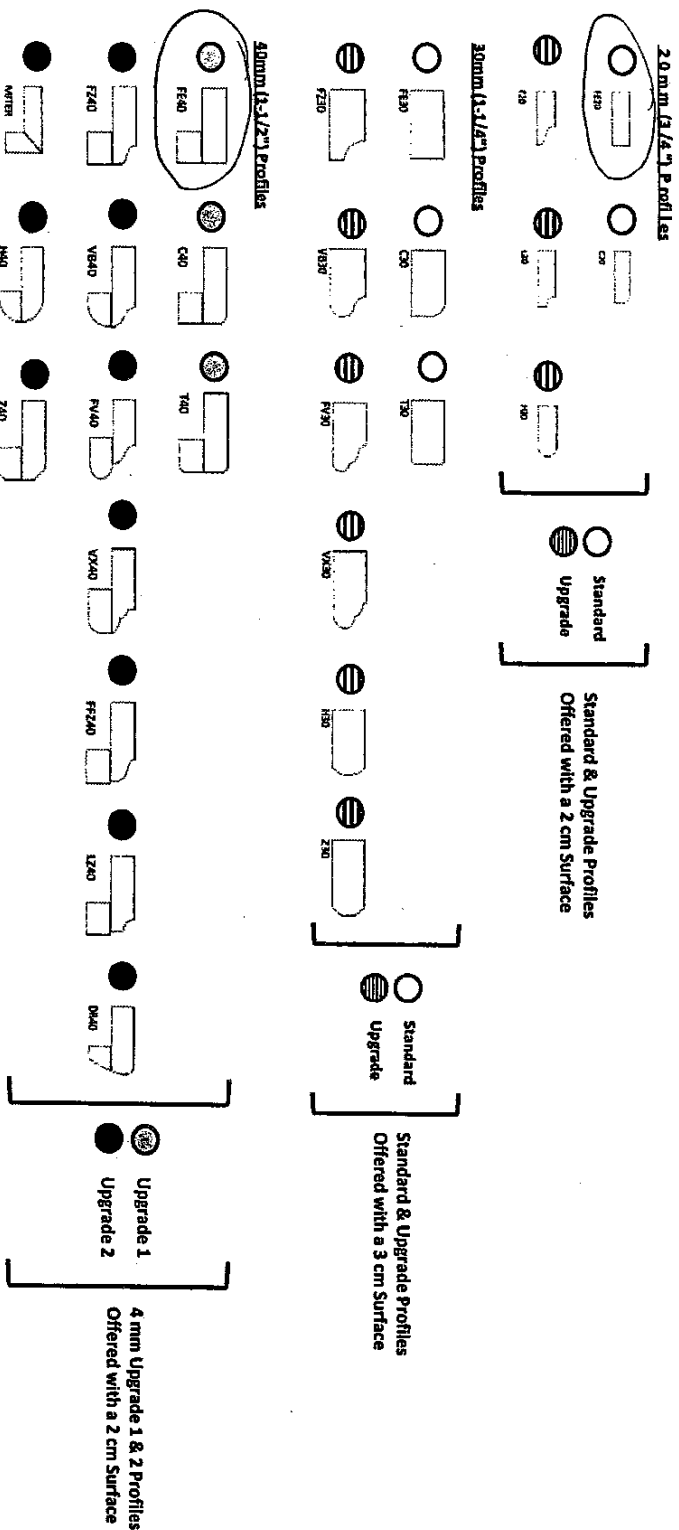

LOT 26L

0.8

2

DATE: October 18, 2016

#E40 : KITCHEN

H20 : MASTER ENSUITE

CORTINA

MODIFIED: 19/05/16 fd

STANDARD HARDWARE

STANDARD HARDWARE



CSI-6

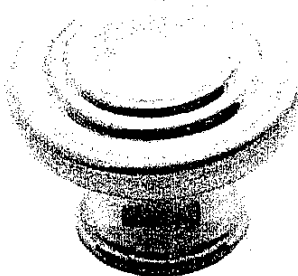

CSI-10

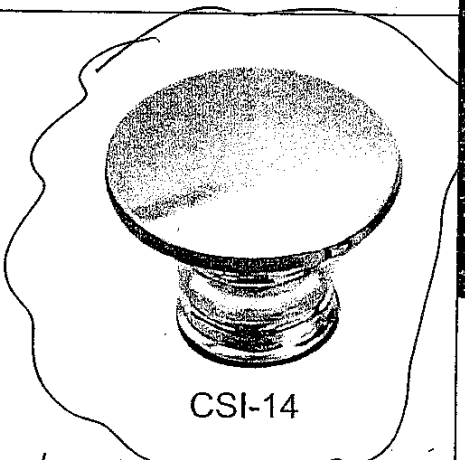

CSI-14

KITCHEN, MASTER ENSUITE
MAIN BATHROOM



CSI-16



CSI-18

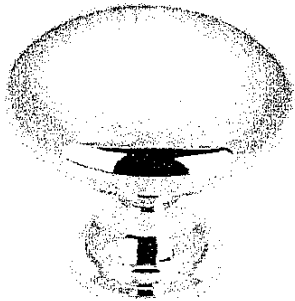

CSI-19



CSI-20

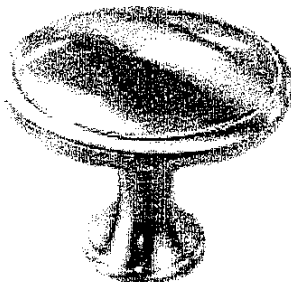

CSI-21

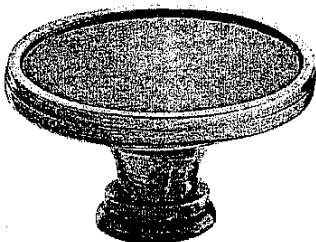

CSI-22

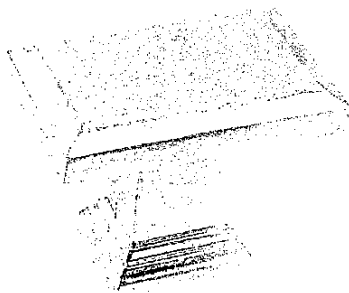

CSI-23

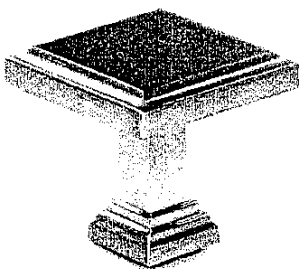

CSI-24

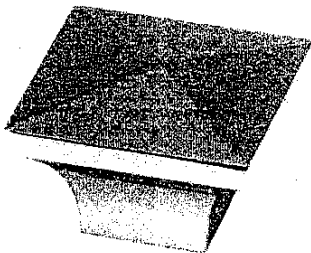

CSI-25

*NOTES:

- IMAGES ARE FOR QUICK REFERENCE PURPOSES ONLY
- ACTUAL SIZES AND FINISHES AS PER HARDWARE
- SAMPLE BOARD PROVIDED TO DECOR CENTRE

LOT 26L



DATE: October 18, 2016

LOCATIONS: _____

CORTINA

KITCHENS INC.

70 Regina Road Woodbridge ON L4L 8L6
905-264-6464

INFORMATION - PVC DOORS

Builder... GOLD PARK Project... KLEINBURG GLEN Lot #... 26L

All cabinets with PVC (Thermofoil) Doors come with melamine gables, panels and kick. The doors, crown moulding and light valance are PVC wrapped. Open shelves incorporated in design will only be available with melamine interiors. There will be variations in colour shades between the PVC parts (doors, crown and Light valance) and the melamine parts (open shelves, Gables , Panels and Kick) due to the difference in material.

Furring Panel with crown moulding to the ceiling is not available on all PVC door styles due to subtle variations in colour shades between the PVC parts (moulding) and the melamine parts (furring panel) due to the difference in material. Grain directions in wood grain pattern melamine , vary between the furring panel, crown moulding (horizontal) and the PVC doors (vertical).

Thank you for your understanding.

I am well informed of this information, and agree to the purchase of the above.

Purchaser: 313

Date: October 18, 2016

Purchaser: [Signature]

DATE: October 18, 2016

LOT 26L
MASTER ENSUITE

(D.P.) (CW)

October 18, 2016

DATE:

Camden

16" Square
4210CHY Undermount Sink



FEATURES

Vitreous china
Front overflow hole
Template and mounting hardware supplied
Overall dimensions (W x D x H):
(OD) 16" x 16" x 7½"
(ID) 13¾" x 13¾" x 5½"

477-

CERTIFICATIONS

IAPMO cUPC
ASME A112.19.2 / CSA B45.1-2008

COLOUR

Soft white

contrac
www.contrac.ca

The images shown are a representation of the finish and color, and may not reflect every characteristic possible.

Issued: Feb. 2016

CORTINA

70 Regina Road, Woodbridge, Ontario L4L 8L8
Tel: 905-264-8484 Fax: 905-264-0884
www.CortinaKitchens.com

QUOTATION

Date: 28/06/16

Trade Name: Gold Park Homes

Site location:

Model: 25-3

Address:

Project: Kleinburg Glen

Phase:

This layout has been explained to the purchaser by Cortina Kitchens Inc. and is understood by the purchaser.

OPT. GROUND FLOOR KITCHEN

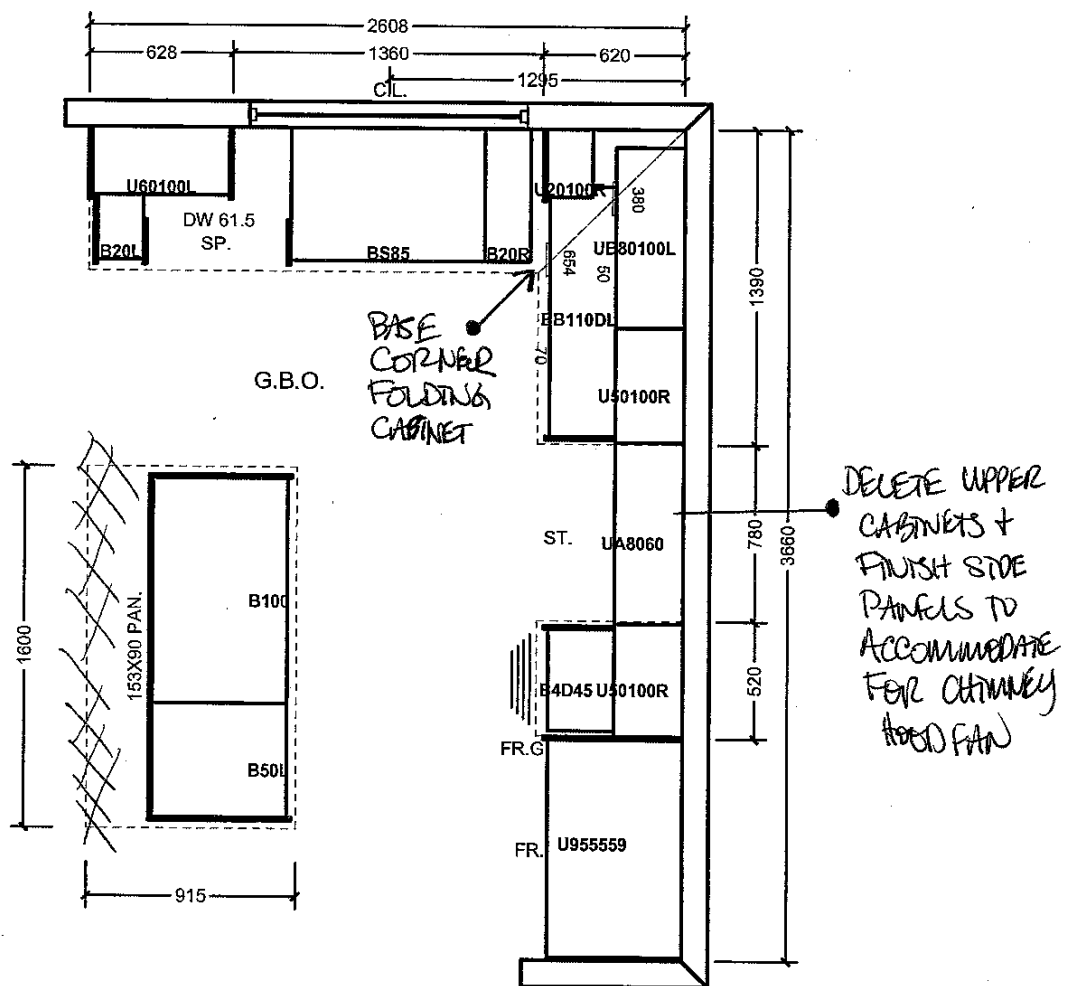

* UPS LIGHT VALANCE *

LOT 26 L



DATE: October 18, 2016

All prices subject to confirmation from head office.
This quotation is subject to the terms & conditions set out

All agreements are contingent upon strikes, accidents, and delays beyond our control.
Please provide our installer with template for sinkholes or \$150.00 will be charged for callback.

ACCEPTED DATE: _____

Item A. Wood grain and colour are characteristics of the product. We cannot guarantee that such grain and colour will always match.
Item B. Cortina Kitchens Inc. reserves the right to alter dimensions and make technical changes without notice.

CORTINA

70 Regina Road, Woodbridge, Ontario L4L 8L8
Tel: 905-284-8404 Fax: 905-284-0084
www.CortinaKitchens.com

QUOTATION

Date: 28/06/16

Trade Name: Gold Park Homes

Site location:

Model: 25-3

Address:

Project: Kleinburg Glen

Phase:

This layout has been explained to the purchaser by Cortina Kitchens Inc. and is understood by the purchaser.

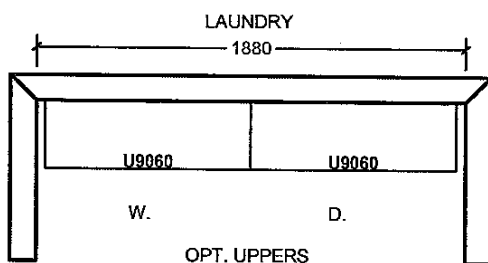
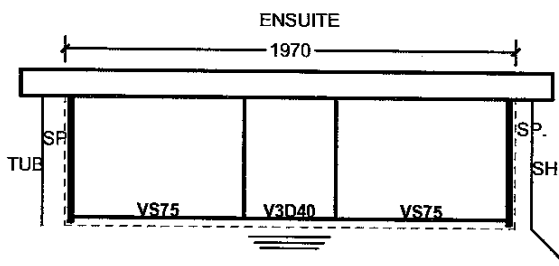
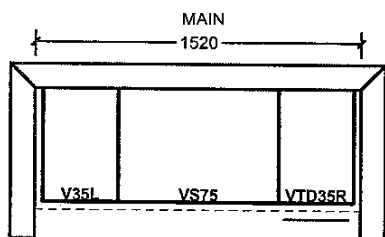

OPT. SECOND FLOOR

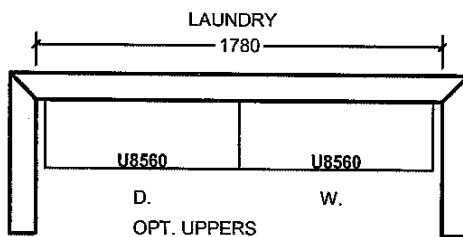
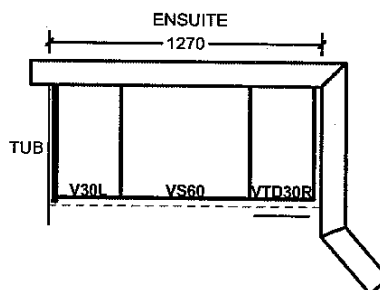
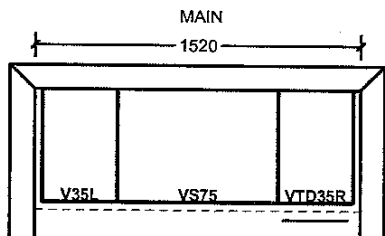

Lot 26L

D.A.

EW

DATE: October 18, 2016

All prices subject to confirmation from head office.
This quotation is subject to the terms & conditions set out

All agreements are contingent upon strikes, accidents, and delays beyond our control.
Please provide our installer with template for sinkholes or \$150.00 will be charged for callback.

ACCEPTED DATE: _____

Item A. Wood grain and colour are characteristics of the product. We cannot guarantee that such grain and colour will always match.
Item B. Cortina Kitchens Inc. reserves the right to alter dimensions and make technical changes without notice.

the Oakmount

Elevation A • 2,053 sq.ft.

Elevation B • 2,053 sq.ft.

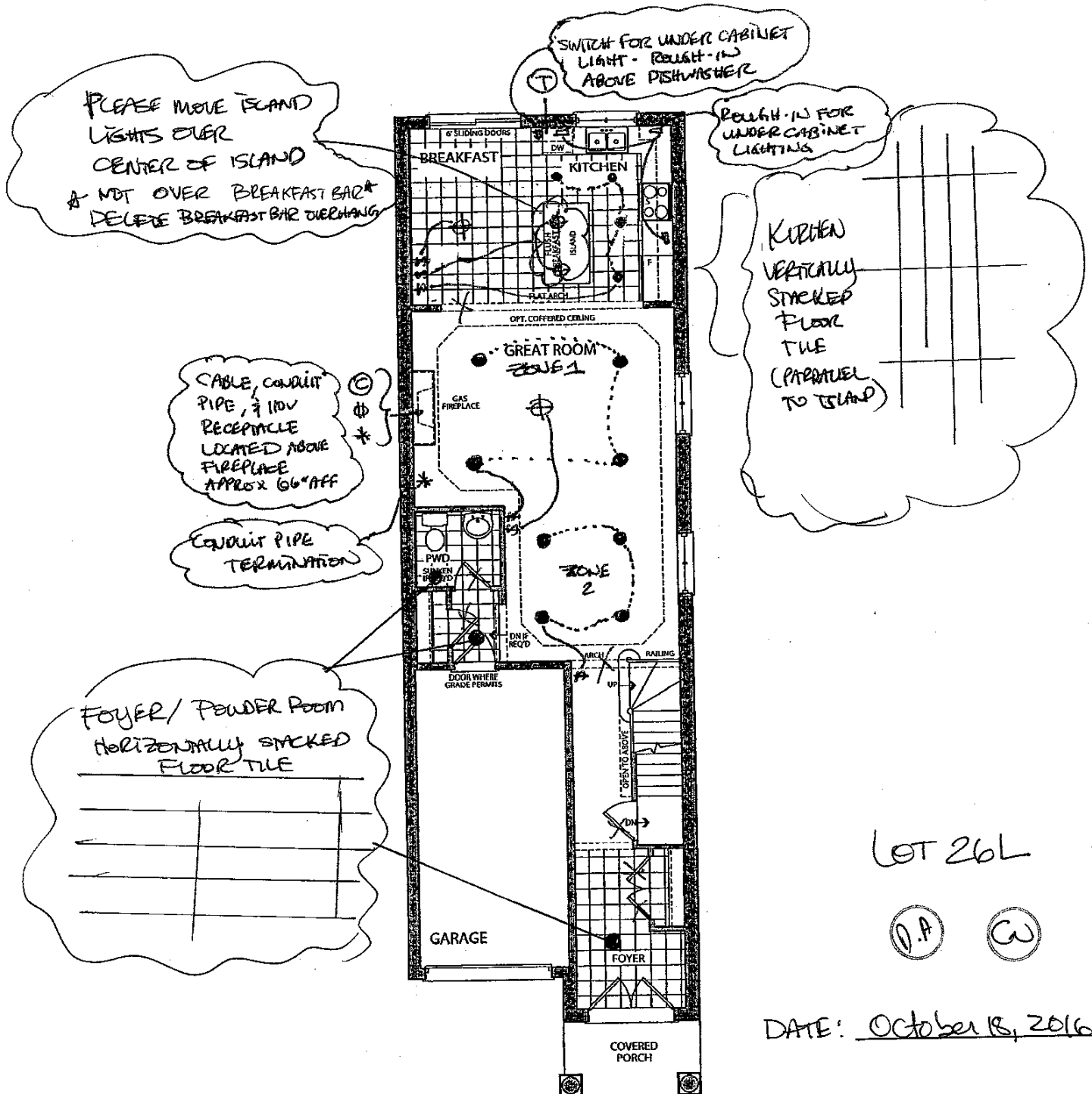

LOT 26L

(D.A) (C.W)

DATE: OCTOBER 18, 2016

LEGEND

- (T) - TELEPHONE
- (C) - CABLE
- Φ - 110V RECEPTACLE
- - POTLIGHT
- - UNDERCABINET LIGHTING ROUGH IN.
- X - EXTENDED DOOR + ARCHWAY HEIGHTS

Prices, figures, illustrations, sizes, features and finishes are subject to change without notice. E.&O.E. Areas and dimensions are approximate and actual usable floor space may vary from the stated area. Layout may be reverse of the unit purchased. E. & O.E.

LOT 26L

July 26, 2016

(C.W) (D.A)

GOLDPARK
HOMES



the Oakmount

Elevation A • 2,053 sq.ft.

Elevation B • 2,053 sq.ft.

Lot 26L

DATE: July 26, 2016

CN O.A

DATE: October 18, 2016

O.A CO

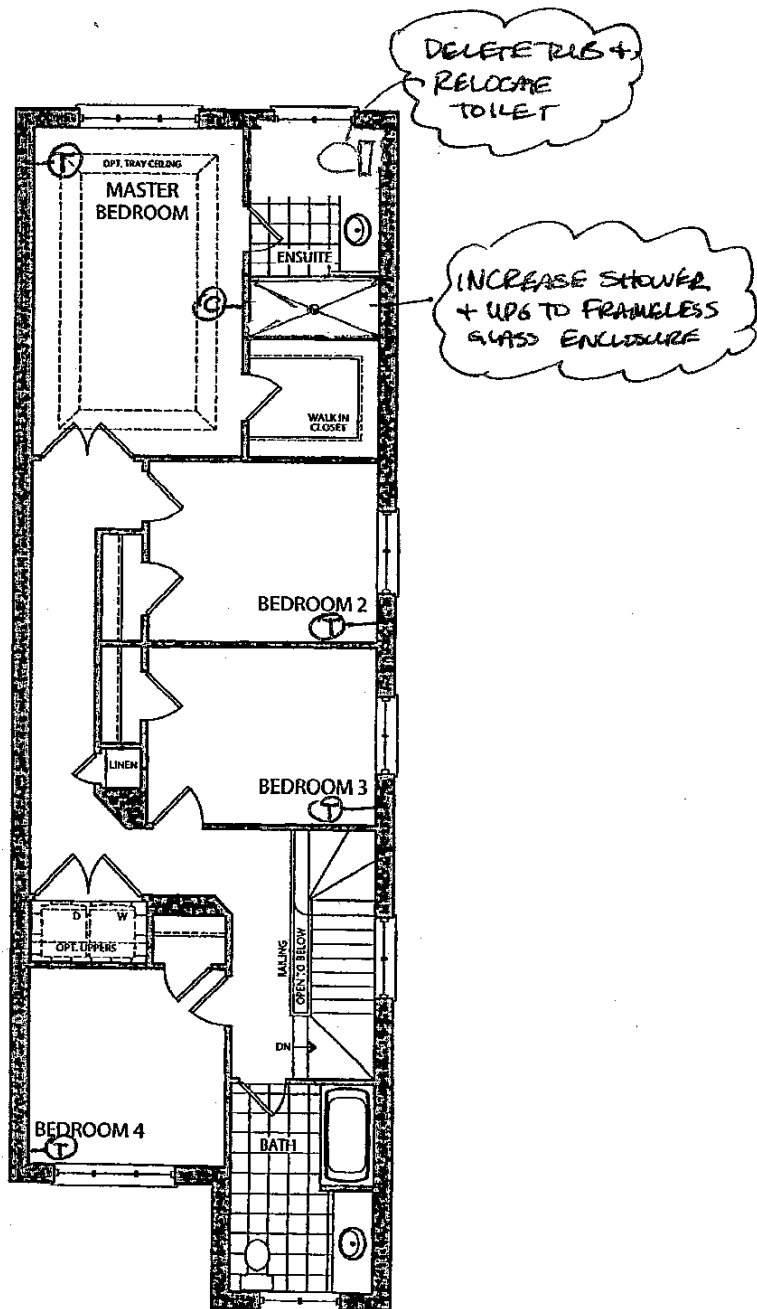

OPT. SECOND FLOOR
ELEVATION A

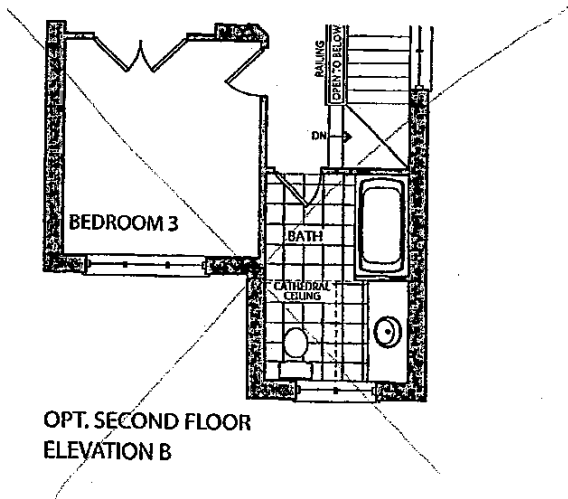

Prices, figures, illustrations, sizes, features and finishes are subject to change without notice. E.&O.E. Areas and dimensions are approximate and actual usable floor space may vary from the stated area. Layout may be reverse of the unit purchased. E. & O.E.



the Oakmount

✓ Elevation A • 2,053 sq.ft.

Elevation B • 2,053 sq.ft.

LOT 26L

DATE July 26, 2016

(CN) (O.A)

DATE : October 18, 2016

(O.A) (CN)

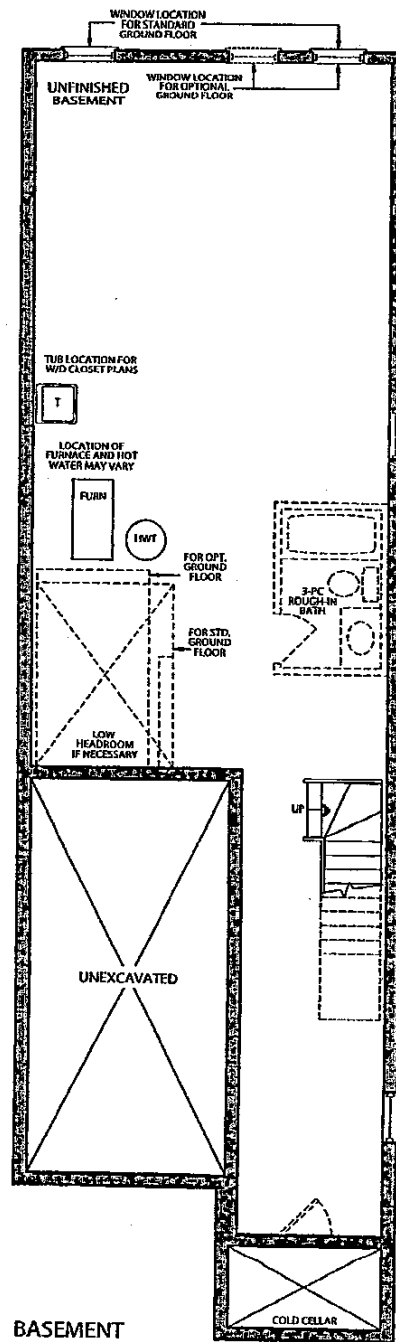

BASEMENT
ELEVATION A & B

Prices, figures, illustrations, sizes, features and finishes are subject to change without notice. E.&O.E. Areas and dimensions are approximate and actual usable floor space may vary from the stated area. Layout may be reverse of the unit purchased. E. & O.E.

GOLDPARK
HOMES

6/16/2016

Vulcano - Falmec hoods - Modern Hoods - cooker hoods - extractors

Select Country

HOME COMPANY PRODUCTS TECHNOLOGY DISTRIBUTORS SUPPORT COMMUNICATION NEWS CONTACT US

Home > Products > COLLECTIONS > Potenza > Vulcano

COLLECTIONS

Silence - NRS

Design+

Mirabilia

Fastest

Design

Insert

Potenza

Mercurio

Afrodite

Artemide

Saturno

Vulcano

Eros

Professional

Professional Pyramid

TYPES OF
INSTALLATION

ALPHABETIC

SEE ALL

PRODUCT SEARCH

GALLERY

CATALOGUES

ACCESSORIES

VULCANO Potenza

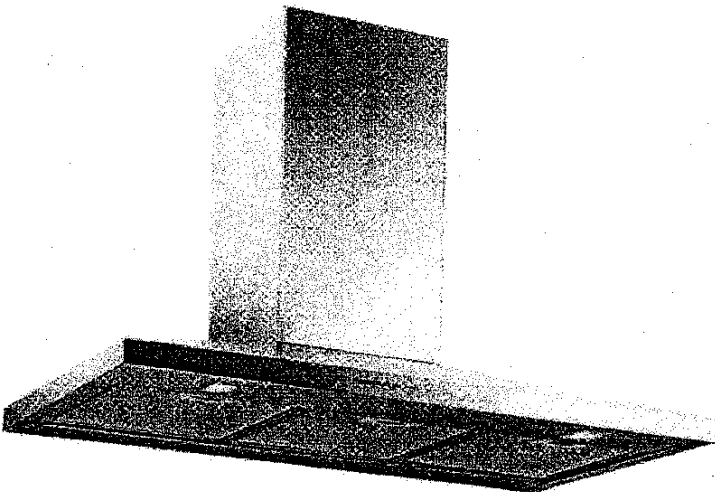

INSTRUCTION
BOOKLET

DESCRIPTION

The Vulcano is a twist on the conventional pyramid shape with softer angles, resulting in a classic elegant finish.

AVAILABLE VERSIONS

- ~~Vulcano Wall 24" 200 CFM~~
- ~~Vulcano Wall 30" 280 CFM~~
- ~~Vulcano Wall 36" 360 CFM~~
- ~~Vulcano XL Wall 30" 600 CFM~~
- ~~Vulcano XL Wall 36" 600 CFM~~

Kienburg

LOT 26L

(D.A.)

(CW)

Oct. 18. 2016

6/16/2016

Vulcano - Falmec hoods - Modern Hoods - cooker hoods - extractors

WALL 24" - 60 CM

~~FPVUL24W3SS~~
~~Motor and control~~
~~280 CFM, 3 speed Mechanical controls~~
~~Filters~~
~~"Metallic"~~
~~Lighting~~
~~Halogen 2x20~~
~~Duct specification~~
~~4 3/4" - 12 cm~~
~~(custom order only, check with your local distributor for availability)~~

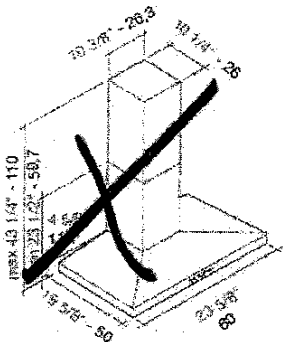

WALL 30" - 76 CM / 36" - 90 CM

~~FPVUL30W3SS / FPVUL36W3SS~~
~~Motor and control~~
~~280 CFM, 3 speed Electronic controls~~
~~Filters~~
~~"Metallic"~~
~~Lighting~~
~~Halogen 2x20 W~~
~~Duct specification~~
~~4 3/4" - 12 cm~~

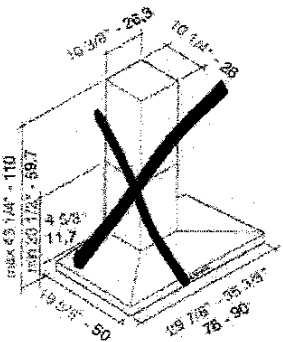

WALL 30" - 76 CM / ~~36" - 90 CM~~

VULCANO XL

FPVUX30W6SS / FPVUX36W6SS
Motor and control
600 CFM, 4 speed Electronic controls
Filters
"Baffle"
Lighting
Halogen 2x20 W
Duct specification
6" - 15 cm

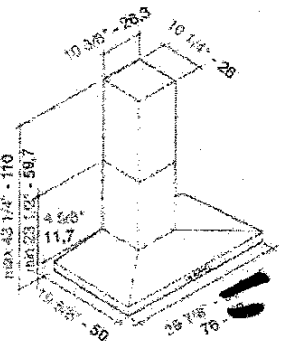

Falmec S.p.A. - Via dell'Artigianato, 42 - 31029 Vittorio Veneto TV - ITALIA - Fax 0438 501531 - P.Iva 02344900267 - Reg. Imprese e Cod. Fiscale TV02344900267 - Cap. Soc. € 416.000,00 - Copyright © 2013 Falmec Spa. Tutti i diritti riservati. All rights reserved

KLEINBURG
LOT 26L

Q.A. CW
OCT. 18. 2016