

It is the builder's complete responsibility to ensure that all plans submitted for approval fully comply with the Architectural Guidelines and all applicable regulations and requirements including zoning provisions and any provisions in the subdivision agreement. The Control Architect is not responsible in any way for examining or approving site (lotting) plans or working drawings with respect to any zoning or building code or permit matter or that any house can be properly built or located on its lot.

This is to certify that these plans comply with the applicable Architectural Design Guidelines approved by the City of BRAMPTON.

ARCHITECTURAL REVIEW & APPROVAL

FEB 23 2016

John G. Williams Limited, Architect

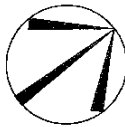

NOTE: BUILDER TO VERIFY LOCATION OF ALL HYDRANTS, STREET LIGHTS, TRANSFORMERS AND OTHER SERVICES. IF MIN. DIMENSIONS ARE NOT MAINTAINED BUILDER IS TO RELOCATE AT HIS OWN EXPENSE.

CLIENT

GOLD PARK HOMES

PROJECT/LOCATION

MCLAUGHLIN AND MAYFIELD
BRAMPTON, ON

DRAWING

SITE PLAN

BUILDING STATISTICS

REG. PLAN No.	43M-2005
ZONE	R1F-9.0-38FT
LOT NUMBER	41
LOT AREA(m) ²	313.20
BLDG AREA(m) ²	N/A
LOT COVERAGE(%)	N/A
No. OF STOREYS	2
MEAN HEIGHT(m)	8.6
INT. GARAGE DIMS(m)	N/A
GARAGE DOOR WIDTH(m)	N/A

LEGEND

FFE	FINISHED FLOOR ELEVATION
TFW	TOP OF FOUNDATION WALL
TBS	TOP OF BASEMENT SLAB
USF	UNDER SIDE FOOTING
USFR	UNDER SIDE FOOTING @ REAR
USFG	UNDER SIDE FOOTING @ GARAGE
TEF	TOP OF ENGINEERED FILL
R	NUMBER OF RISERS TO GRADE
WOD	WALKOUT DECK
LOB	LOOKOUT BASEMENT
WOB	WALK OUT BASEMENT
REV	REVERSE PLAN
STD	STANDARD PLAN
△	DOOR
○	WINDOW
⊗	BELL PEDISTAL
⊠	CABLE PEDISTAL
□	CATCH BASIN
⊞	DBL. CATCH BASIN
*	ENGINEERED FILL
⊕	HYDRO CONNECTION
⊙	FIRE HYDRANT
⊛	STREET LIGHT
⊞	MAIL BOX
⊞	TRANSFORMER
⊞	WATER VALVE
⊞	WATER CONNECTION
▽	SEWER CONNECTIONS 2 LOTS
▽	SEWER CONNECTIONS 1 LOT
⊞	AIR CONDITIONING
⊞	DOWN SPOUT TO SPLASH PAD
→	SWALE DIRECTION
---	CHAINLINK FENCE
---	PRIVACY FENCE
---	SOUND BARRIER
---	FOOTING TO BE EXTENDED TO 1.25 (MIN) BELOW GRADE

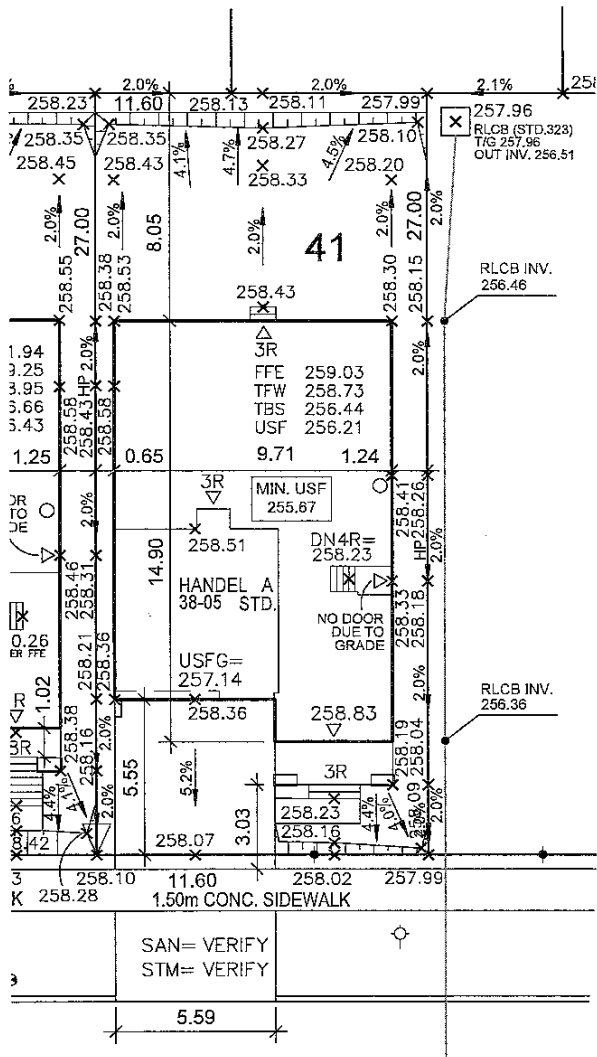

ROULETTE CRESCENT

URBANTECH NOTES:

- 1) No final utility location information at this time. Urbantech will not be responsible for future changes to design. Builder should notify purchaser's that street hardware and above ground utility furniture may be added or removed from their frontages.
- 2) Builder to lower underside of footings where adjacent to RLCB leads. Exact depth to be determined on site during footing excavation.
- 3) Builder to stake out driveway curb depressions at time of curb installation.
- 4) Builder to verify location of all hydrants, street lights, transformers and all other services. If min. dimensions are not maintained as per City standards, builder is to relocate at his own expense.
- 5) Builder to confirm service connection elevations and review for absence of conflict prior to footing excavation.
- 6) Final fence design have not been provided at this time. Purchaser to be advised that actual fencing details may not be as shown on this plan.

URBANTECH CONSULTING

We certify that the proposed grades at the lot corners are correct, and that the lot grading of the subject lot is in conformity to the approved subdivision grading plans and City standards.

REVIEWED BY: D.S. DATE: FEB 26/16

ISSUED OR REVISION COMMENTS

NO.	DESCRIPTION	DATE	DWN	CHK
1	ISSUED FOR REVIEW	FEB.02/16	SDU	JP
2	ISSUED FOR FINAL	FEB.17/16	SDU	JP

I, JULIO PINZON, DECLARE THAT I HAVE REVIEWED AND TAKE DESIGN RESPONSIBILITY FOR THE DESIGN WORK ON BEHALF OF RN DESIGN LIMITED, UNDER DIVISION C, PART 3, SUBSECTION 3.2.4. OF THE BUILDING CODE. I AM QUALIFIED, AND THE FIRM IS REGISTERED, IN THE APPROPRIATE CLASSES/CATEGORIES.
QUALIFIED DESIGNER BCIN 38688
FIRM BCIN 26995
FEB.17/16
DATE SIGNATURE

DRAWN BY

SDU

SCALE

1:250

PROJECT No.

13098

LOT NUMBER

41



RN design

Imagine • Inspire • Create

TEL. (905) 738-3177
FAX. (905) 738-5449
DWG@RNDESIGN.COM

