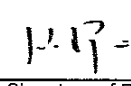

## Schedule 1: Designer Information

Use one form for each individual who reviews and takes responsibility for design activities with respect to the project.

<b>A. Project Information</b>															
Building number, street name		Unit no. <b>38-06 'A'</b>	Lot/con. <b>24</b>												
Municipality <b>BRAMPTON</b>	Postal code	Plan number/ other description <b>43M-2005</b>													
<b>B. Individual who reviews and takes responsibility for design activities</b>															
Name <b>Julio Pinzon</b>		Firm <b>RN Design Limited</b>													
Street address <b>8395 Jane Street</b>		Unit no. <b>203</b>	Lot/con.												
Municipality <b>Vaughan</b>	Postal code <b>L4K 5Y2</b>	Province <b>Ontario</b>	E-mail <b>juliop@rndesign.com</b>												
Telephone number <b>(905) 738-3177</b>	Fax number <b>(905) 738-5449</b>	Cell number													
<b>C. Design activities undertaken by individual identified in Section B. [Building Code Division C, Part 3 Table 3.5.2.1]</b>															
<table style="width: 100%; border: none;"> <tr> <td><input checked="" type="checkbox"/> House</td> <td><input type="checkbox"/> HVAC – House</td> <td><input type="checkbox"/> Building Structural</td> </tr> <tr> <td><input type="checkbox"/> Small Buildings</td> <td><input type="checkbox"/> Building Services</td> <td><input type="checkbox"/> Plumbing – House</td> </tr> <tr> <td><input type="checkbox"/> Large Buildings</td> <td><input type="checkbox"/> Detection, Lighting and Power</td> <td><input type="checkbox"/> Plumbing – All Buildings</td> </tr> <tr> <td><input type="checkbox"/> Complex Buildings</td> <td><input type="checkbox"/> Fire Protection</td> <td><input type="checkbox"/> On-site Sewage Systems</td> </tr> </table>				<input checked="" type="checkbox"/> House	<input type="checkbox"/> HVAC – House	<input type="checkbox"/> Building Structural	<input type="checkbox"/> Small Buildings	<input type="checkbox"/> Building Services	<input type="checkbox"/> Plumbing – House	<input type="checkbox"/> Large Buildings	<input type="checkbox"/> Detection, Lighting and Power	<input type="checkbox"/> Plumbing – All Buildings	<input type="checkbox"/> Complex Buildings	<input type="checkbox"/> Fire Protection	<input type="checkbox"/> On-site Sewage Systems
<input checked="" type="checkbox"/> House	<input type="checkbox"/> HVAC – House	<input type="checkbox"/> Building Structural													
<input type="checkbox"/> Small Buildings	<input type="checkbox"/> Building Services	<input type="checkbox"/> Plumbing – House													
<input type="checkbox"/> Large Buildings	<input type="checkbox"/> Detection, Lighting and Power	<input type="checkbox"/> Plumbing – All Buildings													
<input type="checkbox"/> Complex Buildings	<input type="checkbox"/> Fire Protection	<input type="checkbox"/> On-site Sewage Systems													
Description of designer's work <b>Review of the site plan design and working drawings for Lot 24 model SCARLATTI 38-06 'A' REV corner upgrade door to garage. Design responsibility excludes any structural design and specifications outside of the scope of Part 9 of the OBC.</b>															
<b>D. Declaration of Designer</b>															
I, <u>Julio Pinzon</u> declare that (choose one as appropriate): (print name) <input checked="" type="checkbox"/> I review and take responsibility for the design work on behalf of a firm registered under Division C, Part 3, subsection 3.2.4. of the Building Code. I am qualified, and the firm is registered, in the appropriate classes/categories: Individual BCIN: <u>38688</u> Firm BCIN: <u>26995</u> <input type="checkbox"/> I review and take responsibility for the design work and am qualified in the appropriate category as an "other designer" under Division C, Part 3, subsection 3.2.5 of the Building Code. Individual BCIN: _____ Basis for exemption from registration: _____ <input type="checkbox"/> The design work is exempt from the registration and qualification requirements of the Building Code. Basis for exemption from registration and qualification: _____															
I certify that: 1. The information contained in this schedule is true to the best of my knowledge. 2. I have authority to bind the corporation or partnership (if applicable).															
October 19, 2016 Date		 Signature of Designer													

\*For the purposes of this form, "individual" means the "person" referred to in Division C, Part 3, Clause 3.2.4.7. (1)(d), Division C, Part 3, Article 3.2.5.1. and all other persons who are exempt from qualification under Division C, Part 3, Subsections 3.2.4. and 3.2.5.

**NOTE:**

1. Firm and Individual BCIN numbers are not required for building permit applications submitted prior to January 1, 2006
2. Schedule 1 does not need to be completed by architects, or holders of a Certificate of Practice or a Temporary License under the *Architects Act*

It is the builder's complete responsibility to ensure that all plans submitted for approval fully comply with the Architectural Guidelines and all applicable regulations and requirements including zoning provisions and any provisions in the subdivision agreement. The Control Architect is not responsible in any way for examining or approving site (lotting) plans or working drawings with respect to any zoning or building code or permit matter or that any house can be properly built or located on its lot.

This is to certify that these plans comply with the applicable Architectural Design Guidelines approved by the City of BRAMPTON.

ARCHITECTURAL REVIEW & APPROVAL

OCT 14 2016

John G. Williams, Limited, Architect



NOTE: BUILDER TO VERIFY LOCATION OF ALL HYDRANTS, STREET LIGHTS, TRANSFORMERS AND OTHER SERVICES. IF MIN. DIMENSIONS ARE NOT MAINTAINED BUILDER IS TO RELOCATE AT HIS OWN EXPENSE.

CLIENT  
**GOLD PARK HOMES**

PROJECT/LOCATION  
**MCLAUGHLIN AND MAYFIELD  
BRAMPTON, ON**

DRAWING  
**SITE PLAN**

**BUILDING STATISTICS**

REG. PLAN No	43M-2005
ZONE	R1F-9 0-38FT
LOT NUMBER	24
LOT AREA(m) <sup>2</sup>	416.31
BLDG AREA(m) <sup>2</sup>	N/A
LOT COVERAGE(%)	N/A
No OF STOREYS	3
MEAN HEIGHT(m)	10.67
INT. GARAGE DIMS(m)	5.49 X 6.10
GARAGE DOOR WIDTH(m)	2 X 2.44

**LEGEND**

FFE	FINISHED FLOOR ELEVATION
TFW	TOP OF FOUNDATION WALL
TBS	TOP OF BASEMENT SLAB
USF	UNDER SIDE FOOTING
USFR	UNDER SIDE FOOTING @ REAR
USFG	UNDER SIDE FOOTING @ GARAGE
TEF	TOP OF ENGINEERED FILL
R	NUMBER OF RISERS TO GRADE
WOD	WALKOUT DECK
LOB	LOOKOUT BASEMENT
WOB	WALK OUT BASEMENT
REV	REVERSE PLAN
STD	STANDARD PLAN
DOOR	DOOR
WINDOW	WINDOW
BELL PEDISTAL	BELL PEDISTAL
CABLE PEDISTAL	CABLE PEDISTAL
CATCH BASIN	CATCH BASIN
DBL. CATCH BASIN	DBL. CATCH BASIN
ENGINEERED FILL	ENGINEERED FILL
HYDRO CONNECTION	HYDRO CONNECTION
FIRE HYDRANT	FIRE HYDRANT
STREET LIGHT	STREET LIGHT
MAIL BOX	MAIL BOX
TRANSFORMER	TRANSFORMER
WATER VALVE	WATER VALVE
WATER CONNECTION	WATER CONNECTION
SEWER CONNECTIONS 210/15	SEWER CONNECTIONS 210/15
SEWER CONNECTIONS 150/10	SEWER CONNECTIONS 150/10
AIR CONDITIONING	AIR CONDITIONING
DOWN SPOUT TO SPLASH PAD	DOWN SPOUT TO SPLASH PAD
SWALE DIRECTION	SWALE DIRECTION
CHAINLINK FENCE	CHAINLINK FENCE
PRIVACY FENCE	PRIVACY FENCE
SOUND BARRIER	SOUND BARRIER
FOOTING TO BE EXTENDED TO 1.25 (MIN) BELOW GRADE	FOOTING TO BE EXTENDED TO 1.25 (MIN) BELOW GRADE

ISSUED OR REVISION COMMENTS				
NO	DESCRIPTION	DATE	DWN	CHK
1	ISSUED FOR REVIEW	JULY 28/16	BWS	ES
2	ISSUED FOR FINAL	SEP 02/16	BWS	ES
3	ISSUED FOR FINAL	SEP 26/16	BWS	ES
4	ISSUED FOR FINAL	SEP 27/16	BWS	ES

I, JULIO PINZON, DECLARE THAT I HAVE REVIEWED AND TAKE DESIGN RESPONSIBILITY FOR THE DESIGN WORK ON BEHALF OF RN DESIGN LIMITED, UNDER DIVISION C, PART 3, SUBSECTION 3.2.4 OF THE BUILDING CODE. I AM QUALIFIED, AND THE FIRM IS REGISTERED, IN THE APPROPRIATE CLASSES/CATEGORIES QUALIFIED DESIGNER BCIN **38688**

FIRM BCIN **26995**

SEPT. 27/16  
DATE  
SIGNATURE

DRAWN BY  
**BWS**

SCALE  
**1:250**

PROJECT NO.  
**13098**

LOT NUMBER  
**24**

**RN design**  
Imagine - Inspire - Create  
TEL: (905) 738-3177  
FAX: (905) 738-5449  
DWG@RNDESIGN.COM

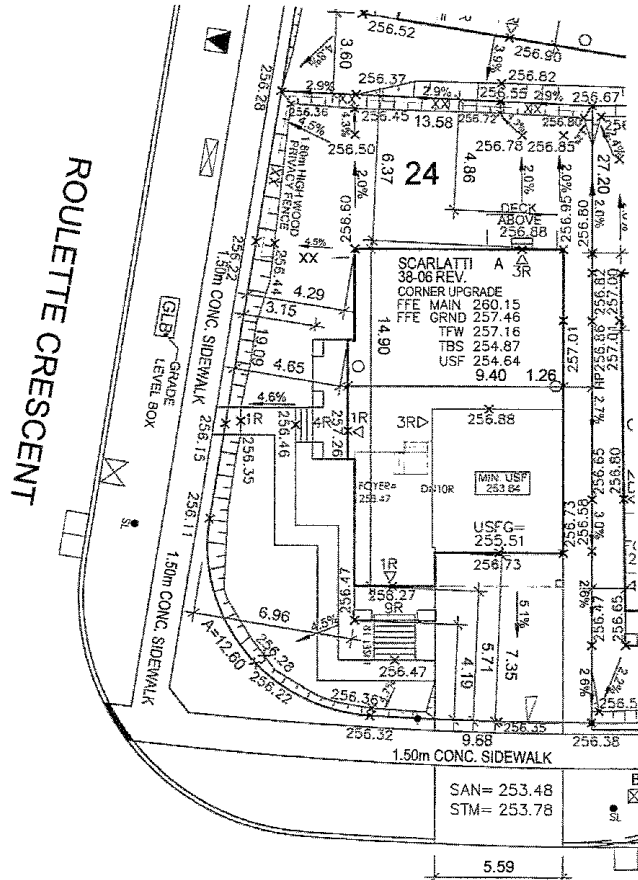

THORNBUSH BOULEVARD

**URBANTECH NOTES:**

- 1) No final utility location information at this time. Urbantech will not be responsible for future changes to design. Builder should notify purchaser's that street hardware and above ground utility furniture may be added or removed from their frontages.
- 2) Builder to lower underside of footings where adjacent to RLCB leads. Exact depth to be determined on site during footing excavation.
- 3) Builder to stake out driveway curb depressions at time of curb installation.
- 4) Builder to verify location of all hydrants, street lights, transformers and all other services. If min. dimensions are not maintained as per City standards, builder is to relocate at his own expense.
- 5) Builder to confirm service connection elevations and review for absence of conflict prior to footing excavation.
- 6) Final fence design have not been provided at this time. Purchaser to be advised that actual fencing details may not be as shown on this plan.

**URBANTECH CONSULTING**

We certify that the proposed grades at the lot corners are correct, and that the lot grading of the subject lot is in conformity to the approved subdivision grading plans and City standards.

REVIEWED BY **J.E.** DATE **9/28/2016**

