

**Brampton Encore - 58 - 1 - 41-4 Elev.A BACH
 CARPET**

Inv.832	1 - MASTER BEDROOM CARPET: Upgrade 1-City View Berber Master Bed
Line11622	Note:
20Sep16 / 23Sep16	
Inv.832	1 - BEDROOM 2 CARPET: Upgrade 1 City View Berber Bed 2
Line11623	Note:
20Sep16 / 23Sep16	
Inv.832	1 - BEDROOM 3 CARPET: Upgrade 1 - City View Berber Bed 3
Line11624	Note:
20Sep16 / 23Sep16	
Inv.832	1 - BEDROOM 4 CARPET: Upgrade 1 - City View Berber Bed 4
Line11625	Note:
20Sep16 / 23Sep16	
Inv.832	1 - MASTER BEDROOM CARPET: Upgraded underpad to 12mm Superpad Master Bed
Line11626	Note:
20Sep16 / 23Sep16	
Inv.832	1 - BEDROOM 2 CARPET - Upgraded underpad to 12mm Superpad Bed 2
Line11627	Note:
20Sep16 / 23Sep16	
Inv.832	1 - BEDROOM 3 CARPET: Upgraded underpad to 12mm Superpad Bed 3
Line11628	Note:
20Sep16 / 23Sep16	
Inv.832	1 - BEDROOM 4 CARPET: Upgraded underpad to 12mm Superpad Bed 4
Line11629	Note:
20Sep16 / 23Sep16	

CENTRAL VAC AND WIRING

Inv.447	1 - FAMILY ROOM: INSTALL CONDUIT PIPE- FOR TELEVISION- MUST SPECIFY LOCATION AND TERMINATION POINT. SEE SKETCH
Line5404	Note:
25Apr16 / 29Jul16	

CERAMIC

Inv.832	1 - TWIN ENSUITE SHOWER WALL: Wall Upgrade 2 Ensuite Bath 2 Rows - Install 1 band of 2 rows of mosaic tile approx. 66" A.F.F. in shower *only*. See sketch for location.
Line11634	Note:
20Sep16 / 23Sep16	
Inv.832	1 - KITCHEN & BREAKFAST FLOOR TILE: Floor Upgrade 2 Kitchen and Breakfast Floor - Laid in straight stacked pattern, see plan for tile direction.
Line11609	Note:
20Sep16 / 23Sep16	
Inv.832	1 - FOYER FLOOR TILE: Floor Upgrade 2 Foyer Vestibule Floor - lay in straight stacked pattern. See plan for tile direction.
Line11610	Note:
20Sep16 / 23Sep16	
Inv.832	1 - MASTER ENSUITE SHOWER WALL: Wall Upgrade 2 Ensuite Bath 2 Rows - Install 1 band of 2 rows of mosaic tile approx. 66" A.F.F. in shower *only*. See sketch for location.
Line11633	Note:
20Sep16 / 23Sep16	

Brampton Encore - 58 - 1 - 41-4 Elev.A BACH

Inv.832	1 - ENSUITE 4 SHOWER WALL: Wall Upgrade 2 Ensuite Bath 2 Rows - Install 1 band of 2 rows of mosaic tile approx. 66" A.F.F. in shower *only*. See sketch for location. Wall Upgrade 2 Ensuite Bath 2 Rows
Line11635	Note:
20Sep16 / 23Sep16	

ELECTRICAL

Inv.447	1 - TELEPHONE AND CABLE ROUGH-IN LOCATIONS
Line5403	Note:
25Apr16 / 29Jul16	
Inv.447	1 - FAMILY ROOM: INSTALL 110V WALL RECEPTACLE ON DEDICATED CIRCUIT - ABOVE FIREPLACE. SEE SKETCH
Line5405	Note:
25Apr16 / 29Jul16	
Inv.447	1 - BASEMENT: INSTALL 200 AMP ELECTRICAL SERVICE, IN LIEU OF STANDARD 100 AMPS
Line5406	Note:
25Apr16 / 29Jul16	
Inv.447	1 - KITCHEN: INSTALL 220V WALL RECEPTICAL ON DEDICATED CIRCUIT- FOR 4 WIRE BUILT-IN WALL OVEN - SEE SKETCH. FOR A FUTURE WALL OVEN/MICROWAVE UNIT. PURCHASER IS AWARE THAT THEY MUST BUY THE APPROPRIATE CABINETRY AT THE TIME OF COLOURS.
Line6918	Note:
25Apr16 / 29Jul16	
Inv.447	1 - KITCHEN: INSTALL 110V WALL RECEPTACLE ON DEDICATED CIRCUIT - FOR MICROWAVE - MICROWAVE NOT INCLUDED. SEE SKETCH. FOR A FUTURE WALL OVEN/MICROWAVE UNIT. PURCHASER IS AWARE THAT THEY MUST BUY THE APPROPRIATE CABINETRY AT THE TIME OF COLOURS
Line6919	Note:
25Apr16 / 29Jul16	
Inv.447	1 - KITCHEN: MOVE PANTRY OVER 3' TO ACCOMODATE FOR A WALL OVEN UNIT. APPROPRIATE CABINETRY WILL BE PURCHASED AT THE TIME OF COLOURS. SEE SKETCH
Line6921	Note:
25Apr16 / 29Jul16	

EXTERIOR COLOURS

Inv.711	1 - EXTERIOR COLOUR PACKAGE 9
Line9591	Note:
29Jul16 / 29Jul16	

FORMING

Inv.447	1 - EXTERIOR: INSTALL SIDE DOOR- HOME TO EXTERIOR- AS PER PLAN AND GRADE PERMITTING
Line5407	Note:
25Apr16 / 29Jul16	

FRAMING

Inv.447	1 - MAIN FLOOR: DELETE CLOSET IN FRONT OF POWDER ROOM.
Line6519	Note:
25Apr16 / 29Jul16	
Inv.447	1 - DEN: INSTALL DOUBLE DOORS INTO DEN. ADDITIONAL DOOR TO BE STANDARD STYLE
Line6522	Note:
25Apr16 / 29Jul16	

Brampton Encore - 58 - 1 - 41-4 Elev.A BACH

Inv.447	1 - MASTER ENSUITE ENTRY: MOVE DOUBLE DOORS FURTHER INTO THE MASTER BEDROOM, MAKING A LARGER HALL IN FRONT OF MASTER BEDROOM DOOR. SEE SKETCH
Line6547	Note:
25Apr16 / 29Jul16	
Inv.447	1 - MASTER BEDROOM-WALK-IN CLOSET: MOVE DOOR LOCATION OF WALK IN CLOSET FROM THE HALLWAY INTO MASTER BEDROOM. SEE SKETCH
Line6548	Note:
25Apr16 / 29Jul16	
Inv.447	1 - BEDROOM #2: MOVE LOCATION OF BEDROOM #2 DOOR TO CLOSET WALL. SEE SKETCH.
Line6549	Note:
25Apr16 / 29Jul16	
Inv.447	1 - UPPER HALL: DELETE LINEN CLOSET IN UPPER HALL
Line6550	Note:
25Apr16 / 29Jul16	
Inv.447	1 - BEDROOM #4: INSTALL DOUBLE DOOR ENTRY INTO BEDROOM #4. SEE SKETCH
Line6551	Note:
25Apr16 / 29Jul16	

GRANITE MARBLE QUARTZ

Inv.832	1 - KITCHEN COUNTER TOP: 2 CM GRP 1 Kitchen with Island no BBar (included in APS)
Line11601	Note:
20Sep16 / 23Sep16	
Inv.832	1 - KITCHEN ISLAND COUNTER TOP: 2 CM GRP 1 Optional Flush BBar
Line11602	Note:
20Sep16 / 23Sep16	
Inv.832	1 - KITCHEN GRANITE COUNTER TOP: Install granite at cooktop
Line11608	Note:
20Sep16 / 23Sep16	
Inv.832	1 - KITCHEN COUNTER TOP: 4 CM PROFILE UPG 2 Kitchen with Island no BBar
Line11606	Note:
20Sep16 / 23Sep16	
Inv.832	1 - KITCHEN ISLAND COUNTER TOP: 4 CM PROFILE UPG 2 Optional Flush BBar
Line11607	Note:
20Sep16 / 23Sep16	
Inv.832	1 - MASTER ENSUITE COUNTER TOP: 2 CM GRP 1 Master Ensuite
Line11616	Note:
20Sep16 / 23Sep16	
Inv.832	1 - TWIN BATH COUNTER TOP: 2 CM GRP 1 Twin Bath
Line11617	Note:
20Sep16 / 23Sep16	
Inv.832	1 - ENSUITE 4 COUNTER TOP: 2 CM GRP 1 Ensuite 4
Line11618	Note:
20Sep16 / 23Sep16	

HARDWOOD

Brampton Encore - 58 - 1 - 41-4 Elev.A BACH

Inv.832	1 - FAMILY ROOM HARDWOOD: Upgrade 2 LEVEL I Family
Line11611	Note:
20Sep16 / 23Sep16	
Inv.832	1 - DINING ROOM HARDWOOD: Upgrade 2 LEVEL I Dining
Line11612	Note:
20Sep16 / 23Sep16	
Inv.832	1 - DEN HARDWOOD: Upgrade 2 LEVEL I Den
Line11613	Note:
20Sep16 / 23Sep16	
Inv.832	1 - UPPER HALL HARDWOOD: Upgrade 2 LEVEL I Upper Hall
Line11614	Note:
20Sep16 / 23Sep16	
Inv.832	1 - LANDING HARDWOOD: Upgrade 2 LEVEL I Landing
Line11615	Note:
20Sep16 / 23Sep16	

INTERIOR TRIM AND DOORS

Inv.447	6 - MAIN FLOOR: UPGRADE STANDARD SIX (6) DOORS EXTENDED HEIGHT 96" (PRICE PER DOOR)- GROUND FLOOR 2 STOREY MODELS. ON CLOSET (X2), BASEMENT, DEN (X2) AND POWDER ROOM. SEE SKETCH
Line5412	Note:
25Apr16 / 29Jul16	

KITCHEN AND BATH CABINETRY

Inv.832	1 - KITCHEN: Upgrade kitchen and island cabinetry hardware - Handles Kitchen
Line11586	Note:
20Sep16 / 23Sep16	
Inv.832	1 - KITCHEN: Oak PVC 112 Built in wall oven and microwave and cooktop with countertop by others 242cm - Locate between fridge and pantry, see plan for location
Line11587	Note:
20Sep16 / 23Sep16	
Inv.832	2 - KITCHEN CABINETRY: Oak PVC 85 Base Corner Folding Door with lazy susan hardware
Line11588	Note:
20Sep16 / 23Sep16	
Inv.832	1 - KITCHEN CABINETRY: ISLAND -UPG 1 Opt Breakfast Bar (Cabinetry)
Line11589	Note:
20Sep16 / 23Sep16	
Inv.832	1 - KITCHEN CABINETRY: Oak PVC 87 Pot and Pan Drawers 2 deep drawers and one shallow top dummy drawer 60 70 80 90 cm wide (below cooktop)
Line11591	Note:
20Sep16 / 23Sep16	
Inv.832	2 - KITCHEN CABINETRY: Oak PVC 59 Upper Corner Diagonal 100cm H
Line11593	Note:
20Sep16 / 23Sep16	
Inv.832	2 - KITCHEN CABINETRY: Oak PVC 50 Matching Interior Single Door cabinet - 100cm h (matching interior cabinets for upper diagonal cabinets, used with glass doors)
Line11594	Note:
20Sep16 / 23Sep16	

Brampton Encore - 58 - 1 - 41-4 Elev.A BACH

Inv.832	1 - KITCHEN CABINETRY: OAK pvc 02 Plain Clear Glass 100cm h - glass doors for upper diagonal cabinets.
Line11596	Note:
20Sep16 / 23Sep16	
Inv.832	1 - KITCHEN CABINETRY: *delete* uppers for future chimney-style hood fan.
Line11600	Note:
20Sep16 / 23Sep16	
Inv.832	1 - MASTER ENSUITE CABINETRY: Oak PVC 151 Vanity bank of drawers 30 40 50cm
Line11603	Note:
20Sep16 / 23Sep16	
Inv.832	1 - TWIN BATH CABINETRY: Oak PVC 152 Vanity top drawer
Line11604	Note:
20Sep16 / 23Sep16	

MISC.

Inv.447	1 - BONUS PACKAGE: \$12,610.80 (INCLUDING TAXES) WORTH OF UPGRADES FROM GOLD PARK HOMES DÉCOR CENTRE IS BEING APPLIED TOWARD THE STRUCTURAL APPOINTMENT. PURCHASER HAS A REMAINING AMOUNT OF \$2688.65 (INCLUDING TAXES) TO BE USED TOWARD THE COLOUR APPOINTMENT
Line6552	Note:
25Apr16 / 29Jul16	
Inv.447	1 - Purchaser has attended a Structural appointment at the Decor Centre & has DECLINED any additional upgrades and accepts and acknowledges that there will be no further structural changes/additions/deletions to be made upon signing on June 6, 2016
Line6553	Note:
25Apr16 / 29Jul16	
Inv.447	1 - Purchasers are aware & accepts that ANY changes made to upgrades after signing this Purchasers Extra Form are subject to a minimum administration fee of \$500. PLUS a 10% holdback fee
Line6554	Note:
25Apr16 / 29Jul16	
Inv.832	1 - Purchaser has attended a Colour appointment at the Decor Centre & has DECLINED any additional upgrades and accepts and acknowledges that there will be no further structural changes/additions/deletions to be made upon signing on September 20, 2016
Line11639	Note:
20Sep16 / 23Sep16	
Inv.832	1 - Purchasers are aware & accepts that ANY changes made to upgrades after signing this Purchasers Extra Form are subject to a minimum administration fee of \$500. PLUS a 10% holdback fee.
Line11640	Note:
20Sep16 / 23Sep16	

PAINTING

Inv.832	1 - Choice of Stain 1 Staircase 2 Storey Model
Line11632	Note:
20Sep16 / 23Sep16	

PLUMBING

Inv.447	1 - BASEMENT: SHIFT ROUGH-IN - 3PC BASEMENT, AS PER NEW LOCATION MARKED ON FLOORPLAN DUE TO LARGER BASEMENT WINDOW
Line5411	Note:
25Apr16 / 29Jul16	

Brampton Encore - 58 - 1 - 41-4 Elev.A BACH

Inv.832	2 - MASTER ENSUITE: Contrac "Calvin" oval undermount sink (price includes stone polishing)
Line11619	Note:
20Sep16 / 23Sep16	
Inv.832	2 - TWIN ENSUITE: Contrac "Calvin" oval undermount sink (price includes stone polishing)
Line11620	Note:
20Sep16 / 23Sep16	
Inv.832	1 - ENSUITE 4: Contrac "Calvin" oval undermount sink (price includes stone polishing)
Line11621	Note:
20Sep16 / 23Sep16	

STAIRS AND RAILINGS

Inv.832	1 - MAIN STAIRS: Upgrade railing to EUROLINE 2 Black- single collar alt./ double collar
Line11630	Note:
20Sep16 / 23Sep16	
Inv.832	1 - MAIN STAIRS: Upgrade handrail to V Groove Handrail
Line11631	Note:
20Sep16 / 23Sep16	

WINDOWS - BASEMENT

Inv.447	2 - BASEMENT: UPGRADE TWO (2) BASEMENT WINDOWS - UPGRADE EXISTING BASEMENT WINDOW TO 46 INCH X 32 INCH EGRESS - MAY REQUIRE INSTALLATION OF WINDOW WELL. TO BE APPROVED BY CONSTRUCTION
Line5409	Note:
25Apr16 / 29Jul16	
Inv.447	1 - BASEMENT: UPGRADE ONE (1) BASEMENT WINDOW - EXTRA BASEMENT WINDOW 53 INCH X 16 INCH EGRESS - MAY REQUIRE INSTALLATION OF WINDOW WELL. TO BE APPROVED BY CONSTRUCTION. SEE SKETCH
Line5410	Note:
25Apr16 / 29Jul16	

WINDOWS AND DOORS

Inv.711	1 - MAN DOOR GARAGE TO HOUSE - OPTIONAL - IF GRADE PERMITS
Line9590	Note: AS PER BONUS PACKAGE APS
29Jul16 / 29Jul16	

Purchasers: Ravinder Kuman Sharma & Alka Sharma

Property: 58 of Plan -

Telephone Res. / Bus: (905) 970-1735

Project: Fieldwalk Investments Inc.

Decor Advisor: Yolande Somerville

Model and Elevation: 41-4 Elev.A BACH

Layout Changes: ☐ Yes ☒ No

Sketch Attached: ☒ Yes ☐ No

Exterior Colour Scheme:
1. Cabinetry

	Style and Colour	Counter	Hardware
Kitchen / Breakfast	Siena oak 'graystone'	*Granite -Steel Grey	*ch-47
Laundry Room	n/a	n/a	n/a
Powder Room	n/a	n/a	n/a
Master Ensuite Bathroom	Siena oak 'ant brown'	*Granite - Giallo Ornamental	cs1-23
Second Ensuite Bathroom (If Applicable)	Siena oak 'ant brown'	*Granite - New Caledonia	cs1-24
Twin Bath	Siena oak 'grey stone'	*Granite - Grigio Sardo	cs1-18
Dishwasher Cabinet	n/a		

Comment
2. Floor Tile

	Selection	Grout	Threshold
Entrance Vestibule	*12x24" New Byzantine 'Pentellic Grey'	n/a	n/a
Main Hall	n/a	n/a	n/a
Kitchen / Breakfast	*12x24" New Byzantine 'Pentellic Grey'	n/a	n/a
Laundry Room	13x13" Serpentine 'Beyaz White'	n/a	n/a
Powder Room	13x13" Serpentine 'Beyaz White'	n/a	n/a
Mud Room	13x13" Serpentine 'Beyaz White'	n/a	n/a
Master Ensuite Bathroom	13x13" New Reeds 'Silver'	n/a	n/a
Second Ensuite Bathroom (If Applicable)	13x13" New Reeds 'Brown'	n/a	n/a
Lower Landing (If Applicable)	n/a	n/a	n/a
Twin Bath	13x13" New Reeds 'Taupe'	n/a	n/a

Comment
3. Wall Tile

	Selection	Listello/Inserts	Describe
Master Ensuite Bathroom		<input type="radio"/> Yes <input type="radio"/> No	
Tub Deck	8x10" Reflection 'Bone'	<input type="radio"/> Yes <input checked="" type="radio"/> No	
Shower Stall	8x10" Reflection 'Bone'	<input checked="" type="radio"/> Yes <input type="radio"/> No	Listello #KV.CR.SYG.0.6,1.9BL
Bathroom Walls	n/a	<input type="radio"/> Yes <input type="radio"/> No	
Second Ensuite Bathroom (If Applicable)	8x10" Weave 'Grey'	<input checked="" type="radio"/> Yes <input type="radio"/> No	Listello #GM.TUANA.0,6X1.9
Twin Bath	8x10" Weave 'White'	<input checked="" type="radio"/> Yes <input type="radio"/> No	Listello #KV.CR.GRY.0,6X1,9BLK

Kitchen Backsplash
☐ Yes ☒ No

Backsplash Behind Fridge

n/a

Comment

Purchasers: Ravinder Kuman Sharma & Alka Sharma

Property: 58 of Plan -

Telephone Res. / Bus: (905) 970-1735

Project: Fieldwalk Investments Inc.

Decor Advisor: Yolande Somerville

Model and Elevation: 41-4 Elev.A BACH

4. Plumbing Fixtures

<input type="text"/>	Second Ensuite	<input type="text"/>	Powder Room	<input type="text"/>
Master Ensuite Bathroom	<input type="text"/>	Other Room - Specify	<input type="text"/>	Other Washroom
	<input type="text"/>			

Comment

Standard thru out, except bathroom sinks!

5. Hardwood Flooring

	Type and Stain		Type and Stain
Main Hall	n/a	Upper Landing	*3/4x5" red oak distinct 'espresso'
Kitchen / Breakfast	n/a	Upper Hall	*3/4x5" red oak distinct 'espresso'
Living Room	n/a	Master Bedroom	n/a
Dining Room	*3/4x5" red oak distinct 'espresso'	Bedroom #2	n/a
Family Room	*3/4x5" red oak distinct 'espresso'	Bedroom #3	n/a
Den/Library	*3/4x5" red oak distinct 'espresso'	Bedroom #4	n/a
Entrance Vestibule	n/a	Bedroom #5	n/a
Lower Landing (If Applicable)	n/a	Other Room - Specify	<input type="text"/>

Comment
6. Carpeting

	Upgrade	Description
Main Hall	<input type="checkbox"/>	n/a
Living Room	<input type="checkbox"/>	n/a
Dining Room	<input type="checkbox"/>	n/a
Family Room	<input type="checkbox"/>	n/a
Den/Library	<input type="checkbox"/>	n/a
Upper Hall	<input type="checkbox"/>	n/a
Master Bedroom	<input checked="" type="checkbox"/>	*Cityview Berber 'Ball Gown' #937
Bedroom #2	<input checked="" type="checkbox"/>	*Cityview Berber 'Ball Gown' #937
Bedroom #3	<input checked="" type="checkbox"/>	*Cityview Berber 'Ball Gown' #937
Bedroom #4	<input checked="" type="checkbox"/>	*Cityview Berber 'Ball Gown' #937
Bedroom #5	<input type="checkbox"/>	n/a
<input type="text"/>	<input type="checkbox"/>	<input type="text"/>
Upper Landing (If Applicable)	<input type="checkbox"/>	n/a
Lower Landing (If Applicable)	<input type="checkbox"/>	n/a

	Type	Area
Upgrade Underpad	*Superpad 12mm	below all carpet
	Capped	Runner - *Upgrade
Carpet on Stairs	n/a	n/a

Comment

Purchasers: Ravinder Kuman Sharma & Alka Sharma

Property: 58 of Plan -

Telephone Res. / Bus: (905) 970-1735

Project: Fieldwalk Investments Inc.

Decor Advisor: Yolande Somerville

Model and Elevation: 41-4 Elev.A BACH

7. Fireplace

	Living Room			Family Room			Other Room - Specify		
	Purchased	As Per Plan	N/A	Purchased	As Per Plan	N/A	Purchased	As Per Plan	N/A
Fireplace Type	<input type="radio"/>	<input type="radio"/>	<input checked="" type="radio"/>	<input type="radio"/>	<input checked="" type="radio"/>	<input type="radio"/>	<input type="radio"/>	<input type="radio"/>	<input checked="" type="radio"/>
Mantle Type				standard gas					
Colour / Stain				ND-20					
Surround				white (paint grade)					
Hearth				Nero Marquina					
Comment	n/a								

8. Trim Carpentry

Interior Doors	standard	Front Door Glass Inserts	n/a	Door Handles	standard
Interior Trim	standard				
Comment					

9. Plaster Mouldings and Medallions

Entrance Vestibule	n/a	Kitchen/Breakfast	n/a
Main Hall	n/a	Den/Library	n/a
Living Room	n/a	Lower Landing	n/a
Dining Room	n/a	Other Room - Specify	
Family Room	n/a		
Comment			

10. Railings and Spindles

Railing Package	*Euroline 2 + V Groove (single collar alt/ double collar)		
Railing Colour	*to match hardwood 'espresso'	Spindle Colour	black
Stringer / Riser	*to match hardwood 'espresso'	Treads	*to match hardwood 'espresso'
Comment	Oak Stairs	<input checked="" type="radio"/> Yes <input type="radio"/> No	

11. Wall Paint

Main & Upper Hall	warm grey	Master Bedroom	warm grey
Living Room	n/a	Bedroom #2	warm grey
Dining Room	warm grey	Bedroom #3	warm grey
Kitchen / Breakfast	warm grey	Bedroom #4	warm grey
Family Room	warm grey	Bedroom #5	n/a
Powder Room	warm grey	Master Ensuite	warm grey
Laundry Room	warm grey	Twin Bath	warm grey
Den/Library	warm grey	Second Ensuite	warm grey
Trim Paint	white		
Comment	Smooth Ceilings First Floor		

Scheduled Closing Date: Tuesday, September 20, 2016

Purchasers: Ravinder Kuman Sharma & Alka Sharma

Property: 58 of Plan -

Telephone Res. / Bus: (905) 970-1735

Project: Fieldwalk Investments Inc.

Decor Advisor: Yolande Somerville

Model and Elevation: 41-4 Elev.A BACH

12. Electrical

Plugs and Switches ☒ White ☐ Ivory

Hood Fan ☐ White ☐ Ivory

Appliances

Built in Cooktop

Built in Oven

Gas Stove

Microwave

☒ Yes ☐ No

☒ Yes ☐ No

☐ Yes ☐ No

☒ Yes ☐ No

Comment

13. Heating and Air Conditioning

Air Conditioning

Gas Provisions Stove

Gas Provisions Dryer

Gas Provisions Barbecue

Comment

14. Additional Comments

15. Disclaimers and Notes

- Colours of all materials are as close as possible to builder's selection, but not necessarily identical due to variances in manufacturing.
- Any extras listed above are null and void unless accompanied by a separate invoice/amendment. Said invoice must be paid in full.
- The Purchaser acknowledges that after Interior Colour Selection form is signed and dated, no further changes will be permitted other than re-selection due to unavailability. _____ Purchaser's Initials
- The Purchaser acknowledges reading and accepting the "Gold Park Homes Decor Centre Disclaimers" form. This document contains other miscellaneous disclaimers.

This Interior Colour Selection is final and approved by:

Signature: 

Date: _____

Signature: 

Date: _____

375-
Calvin

19 1/4" Oval
4220CFY Undermount Sink

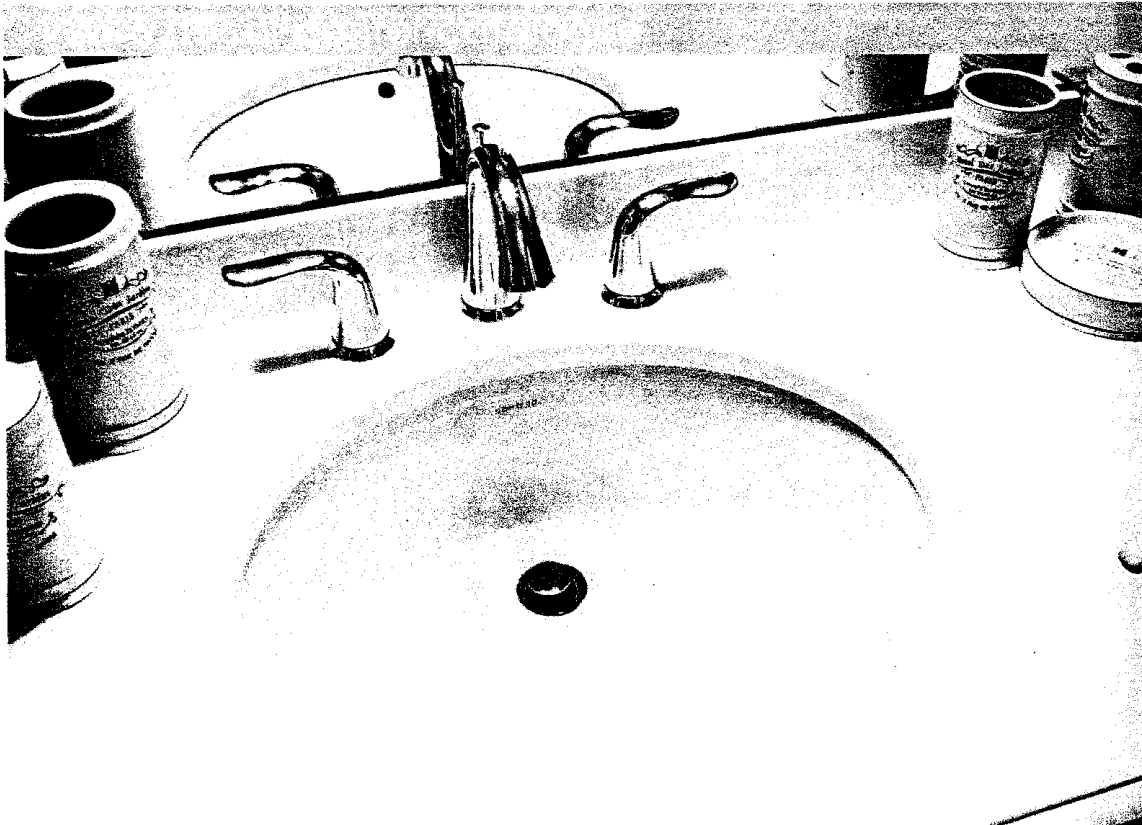

FEATURES

Vitreous china
Front overflow hole
Template and mounting hardware supplied
Overall dimensions (W x D x H):
(OD): 19 1/4" x 16 1/8" x 7 7/8"
(ID): 17" x 13 3/4" x 5 3/4"

CERTIFICATIONS

IAPMO cUPC
ASME A112.19.2 / CSA B45.1-2008

COLOUR

Soft white

contrac.
www.contrac.ca

The images shown are a representation of the finish and color and may not reflect every characteristic possible.

Issued: Feb. 2016

BE-58
ALL VANITIES THRU OUT

* ALL VANITIES
THRU OUT.

OO
SEPT 20 2016

Trade Name: Gold Park Homes	Site location: Brompton	Model: 41-4
Address:	Project: Encore	Phase:

This layout has been explained to the purchaser by Cortina Kitchens Inc. and is understood by the purchaser.

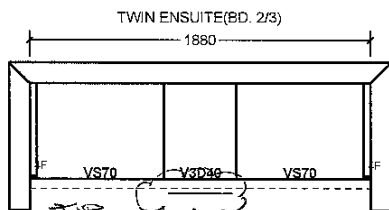
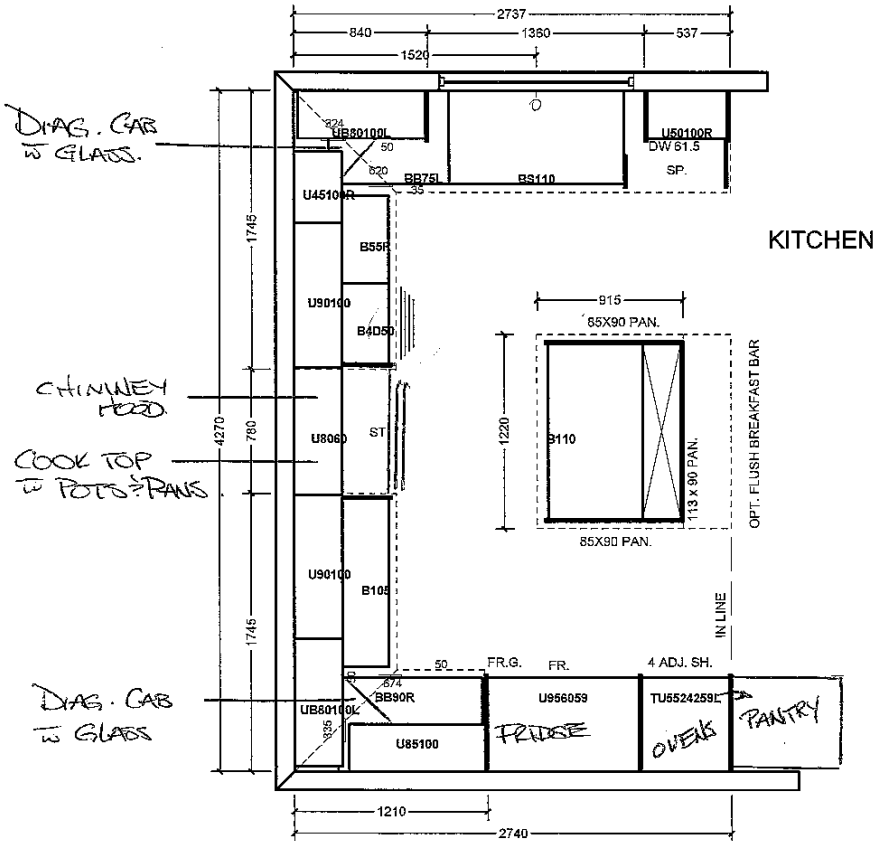

TWIN ENSUITE(BD. 2/3)

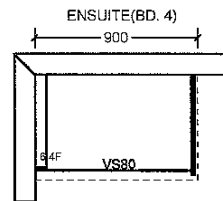

ENSUITE(BD. 4)

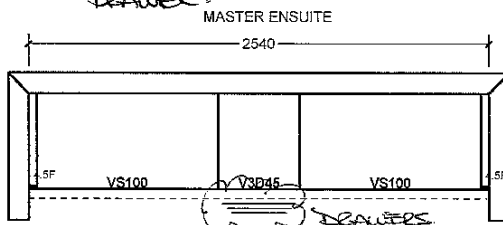

MASTER ENSUITE

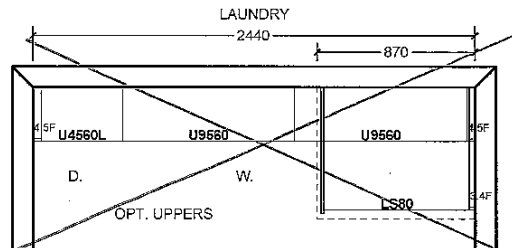

LAUNDRY

All prices subject to confirmation from head office.
This quotation is subject to the terms & conditions set out

All agreements are contingent upon strikes, accidents, and delays beyond our control. Please provide our installer with template for sinkholes or \$150.00 will be charged for callback.

ACCEPTED DATE:



Item A. Wood grain and colour are characteristics of the product. We cannot guarantee that such grain and colour will always match.
Item B. Cortina Kitchens Inc. reserves the right to alter dimensions and make technical changes without notice.

MASTER
ENQUIRE
+
Tusin
+
ENS. 4.

20mm (3/4") Profiles

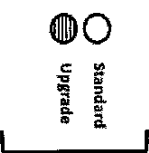
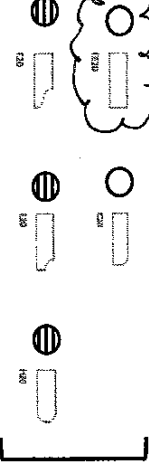

Standard & Upgrade Profiles
Offered with a 2 cm Surface

30mm (1 1/4") Profiles

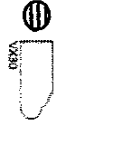
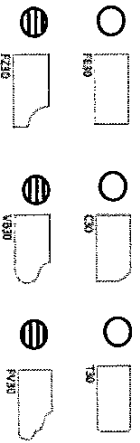

Standard & Upgrade Profiles
Offered with a 3 cm Surface

40mm (1 1/2") Profiles

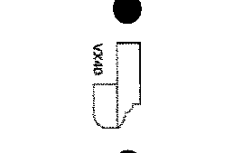
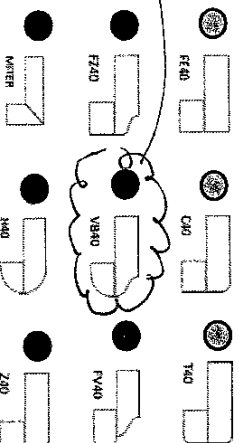

4 mm Upgrade 1 & 2 Profiles
Offered with a 2 cm Surface

Note: All colours may not be available in 30mm at time ordered.
Vendor reserves the right to use 40mm edges (by lamination process).

BE-58
SEPT. 26 2016.

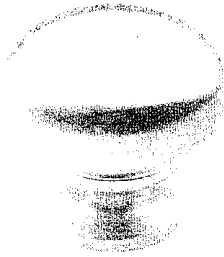
BE-58
SEPT. 20 2016

CSI-6

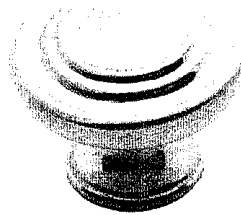

CSI-10

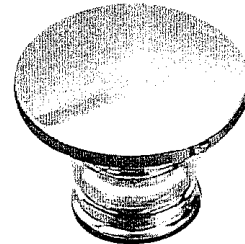

CSI-14

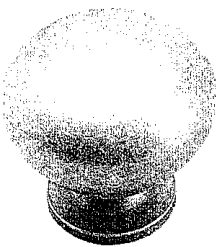

CSI-16

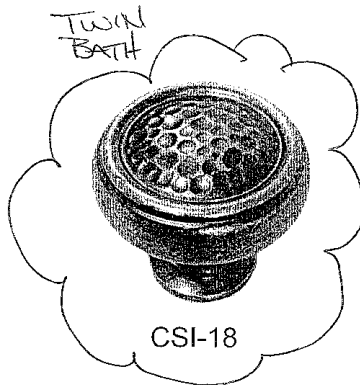

CSI-18

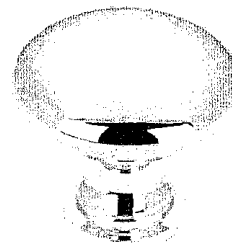

CSI-19

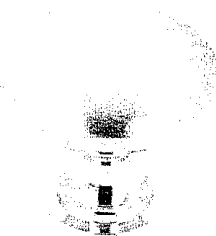

CSI-20

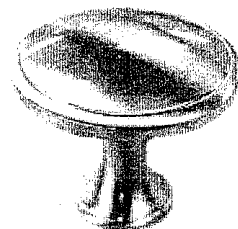

CSI-21

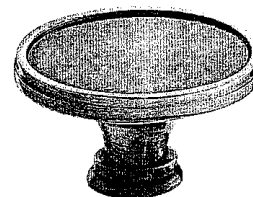

CSI-22

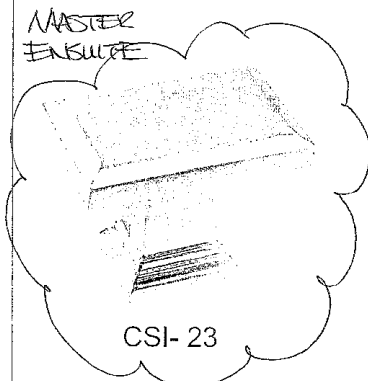

CSI-23

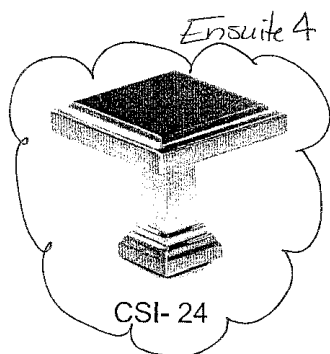

CSI-24

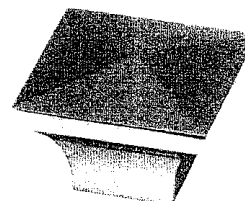

CSI-25

*NOTES:

- IMAGES ARE FOR QUICK REFERENCE PURPOSES ONLY
- ACTUAL SIZES AND FINISHES AS PER HARDWARE
- SAMPLE BOARD PROVIDED TO DECOR CENTRE

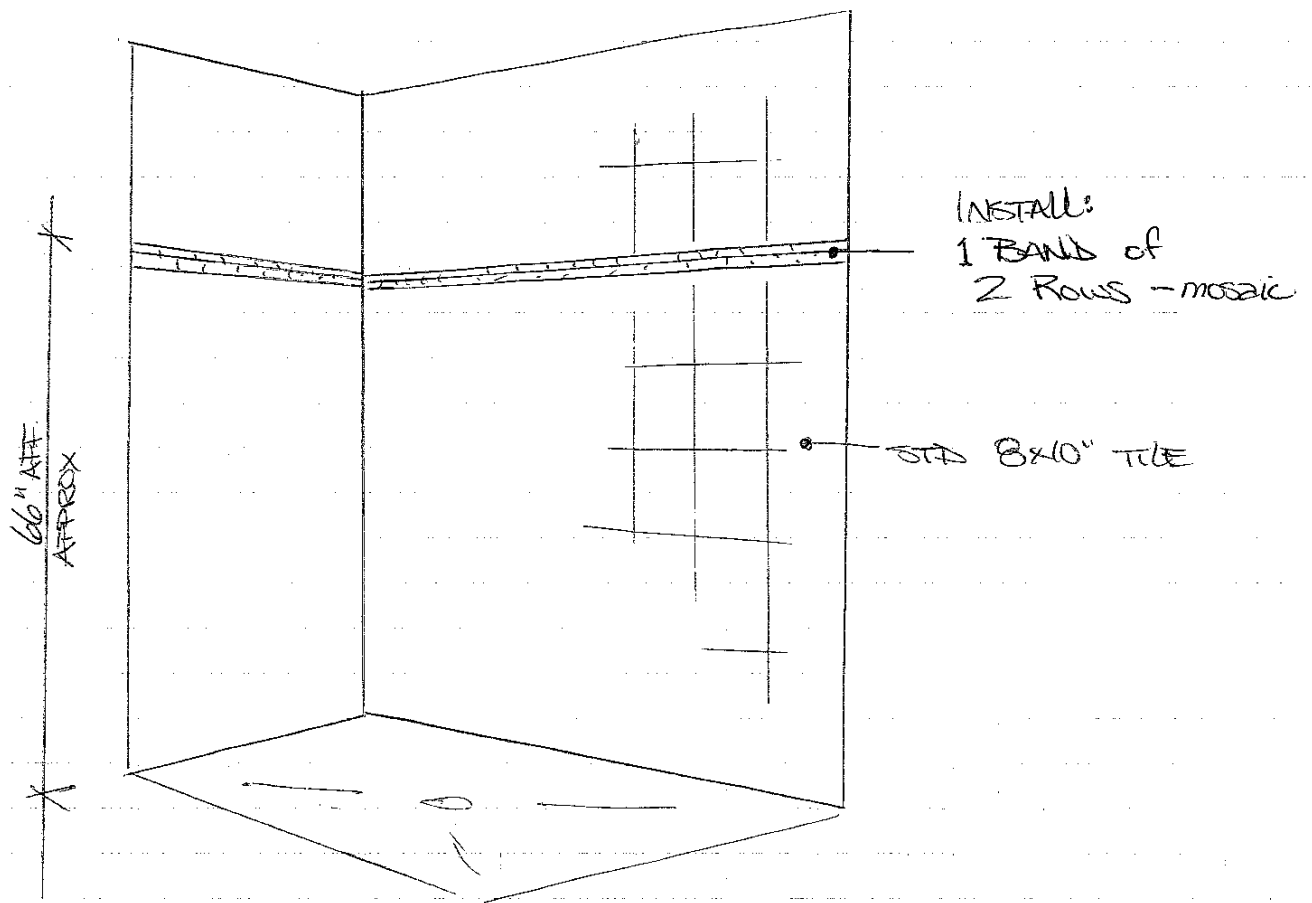

TYPICAL ABOVE.

BE-58

MOSAIC TILE INSERTS.

00

SEPT 20 2016

41-4

Elevation A • 3,046 sq.ft. | Elevation B • 3,046 sq.ft.

move Pantry over 3' to accommodate future wall oven unit.

TILE DIRECTION

3 Extended Height Doors

LOT 58
SEPT 20 2016



Delete Closet
Add Double Door Entry into Den

2 Extended Height Doors

Extended Height Door

Side Door

TILE DIRECTION

GROUND FLOOR ELEVATION A

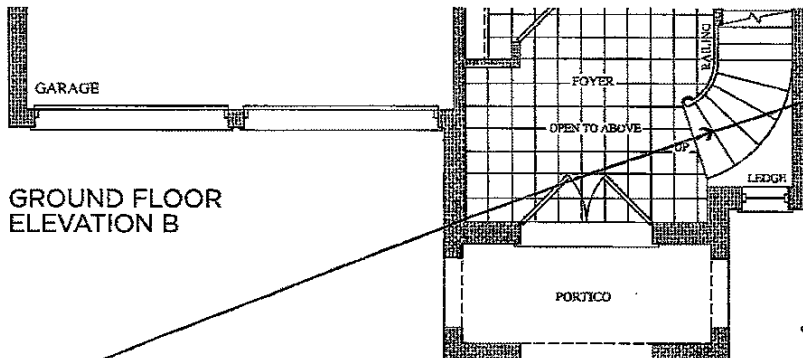

Lot 58
April 25, 2016



LOT 58
SEPT 20, 2016
OO

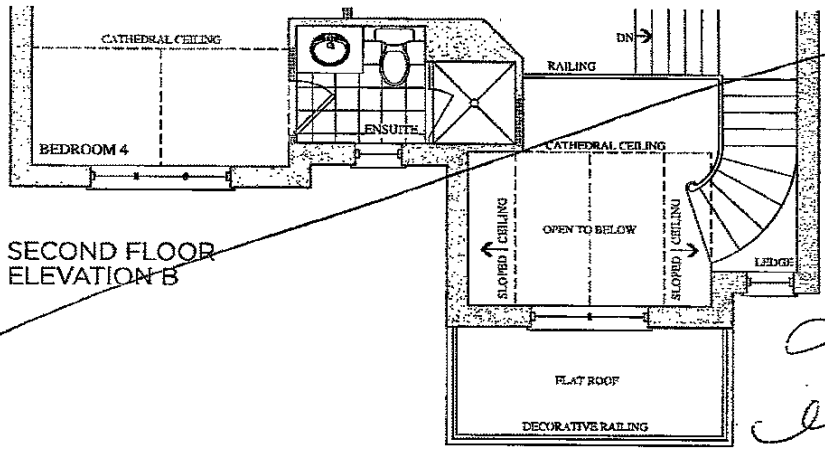
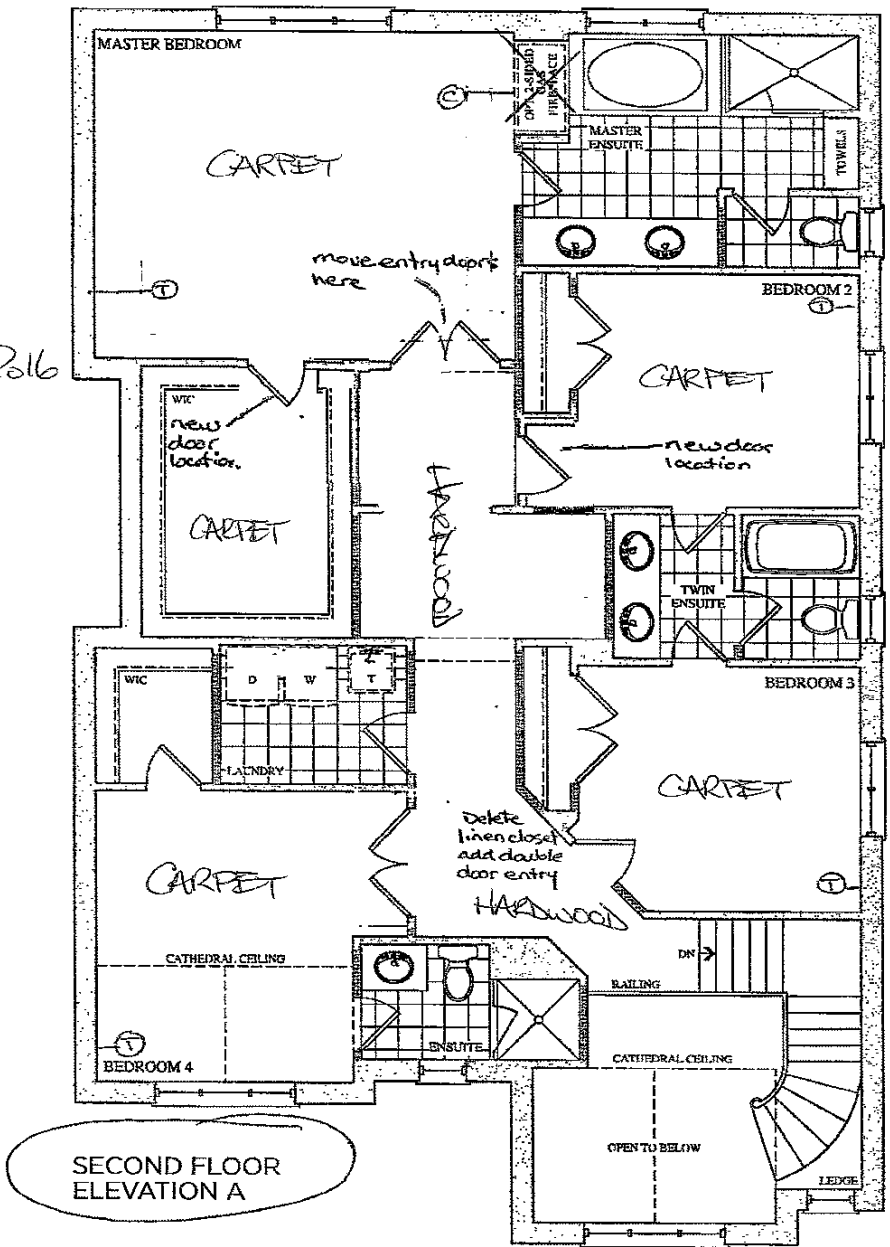

Lot 58
April 25, 2016
OO

41' SERIES

Elevation A • 3,046 sq.ft. | Elevation B • 3,046 sq.ft.

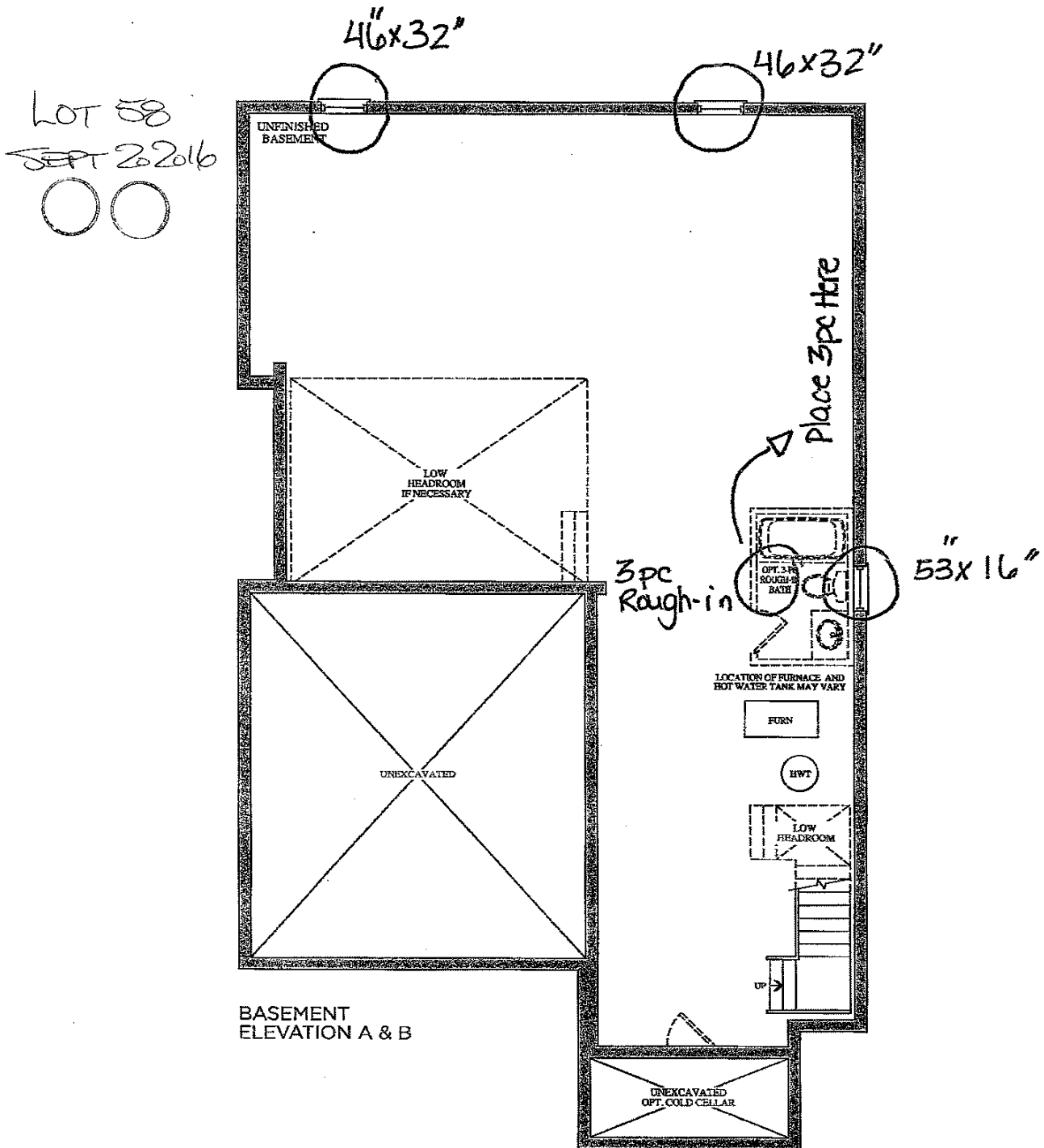

BE-58

KitchenAid®

Rec'd Sept. 20 2016

30" (76.2 CM) AND 36" (91.4 CM) WALL-MOUNT CANOPY RANGE HOOD

Installation Instructions and Use & Care Guide

For questions about features, operation/performance, parts, accessories or service, call: 1-800-422-1230
or visit our website at www.kitchenaid.com

In Canada, for assistance, installation and service, call: 1-800-807-6777
or visit our website at www.kitchenaid.ca

HOTTE D'EXTRACTION À MONTAGE MURAL DE 30" (76,2 CM) ET 36" (91,4 CM)

Instructions d'installation et Guide d'utilisation et d'entretien

Au Canada, pour assistance, installation ou service, composez le 1-800-807-6777
ou visitez notre site web à www.kitchenaid.ca

Table of Contents/Table des matières.....2

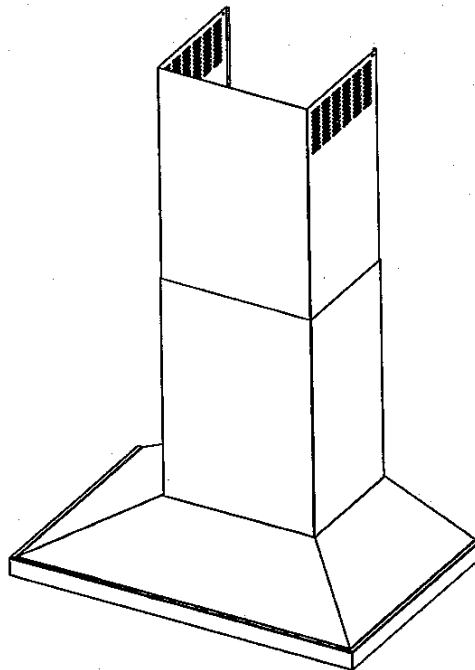

IMPORTANT: READ AND SAVE THESE INSTRUCTIONS.

FOR RESIDENTIAL USE ONLY.

IMPORTANT : LIRE ET CONSERVER CES INSTRUCTIONS.

POUR UTILISATION RÉSIDENNELLE UNIQUEMENT.

LI315E/W10674118G

TABLE OF CONTENTS

RANGE HOOD SAFETY	3
INSTALLATION REQUIREMENTS	5
Tools and Parts	5
Location Requirements	5
Venting Requirements	6
Electrical Requirements	7
INSTALLATION INSTRUCTIONS	8
Prepare Location	8
Install Range Hood	9
Connect Vent System	9
Make Electrical Connection	10
Install Vent Covers	11
Complete Installation	11
RANGE HOOD USE	11
Controls and Features	11
RANGE HOOD CARE	12
Cleaning	12
WIRING DIAGRAM	14
ASSISTANCE OR SERVICE	15
In the U.S.A.	15
In Canada	15
Accessories	15
WARRANTY	16

TABLE DES MATIÈRES

SÉCURITÉ DE LA HOTTE DE CUISINIÈRE	17
EXIGENCES D'INSTALLATION	19
Outils et pièces	19
Exigences d'emplacement	19
Exigences concernant l'évacuation	20
Spécifications électriques	21
INSTRUCTIONS D'INSTALLATION	22
Préparation de l'emplacement	22
Installation de la hotte	23
Raccordement du circuit d'évacuation	23
Raccordement électrique	24
Installation des cache-conduits	25
Achever l'installation	25
UTILISATION DE LA HOTTE	26
Commandes et caractéristiques	26
ENTRETIEN DE LA HOTTE	27
Nettoyage	27
SCHÉMA DE CÂBLAGE	29
ASSISTANCE OU SERVICE	30
Au Canada	30
Accessoires	30
GARANTIE	31

RANGE HOOD SAFETY

Your safety and the safety of others are very important.

We have provided many important safety messages in this manual and on your appliance. Always read and obey all safety messages.



This is the safety alert symbol.

This symbol alerts you to potential hazards that can kill or hurt you and others.

All safety messages will follow the safety alert symbol and either the word "DANGER" or "WARNING."

These words mean:

⚠ DANGER

You can be killed or seriously injured if you don't immediately follow instructions.

⚠ WARNING

You can be killed or seriously injured if you don't follow instructions.

All safety messages will tell you what the potential hazard is, tell you how to reduce the chance of injury, and tell you what can happen if the instructions are not followed.

State of California Proposition 65 Warnings:

WARNING: This product contains one or more chemicals known to the State of California to cause cancer.

WARNING: This product contains one or more chemicals known to the State of California to cause birth defects or other reproductive harm.

IMPORTANT SAFETY INSTRUCTIONS

WARNING: TO REDUCE THE RISK OF FIRE, ELECTRIC SHOCK, OR INJURY TO PERSONS, OBSERVE THE FOLLOWING:

- Use this unit only in the manner intended by the manufacturer. If you have questions, contact the manufacturer.
- Before servicing or cleaning the unit, switch power off at service panel and lock the service disconnecting means to prevent power from being switched on accidentally. When the service disconnecting means cannot be locked, securely fasten a prominent warning device, such as a tag, to the service panel.
- Installation work and electrical wiring must be done by qualified person(s) in accordance with all applicable codes and standards, including fire-rated construction.
- Do not operate any fan with a damaged cord or plug. Discard fan or return to an authorized service facility for examination and/or repair.
- Sufficient air is needed for proper combustion and exhausting of gases through the flue (chimney) of fuel burning equipment to prevent backdrafting. Follow the heating equipment manufacturer's guideline and safety standards such as those published by the National Fire Protection Association (NFPA), the American Society for Heating, Refrigeration and Air Conditioning Engineers (ASHRAE), and the local code authorities.
- When cutting or drilling into wall or ceiling, do not damage electrical wiring and other hidden utilities.
- Ducted fans must always be vented outdoors.

CAUTION: For general ventilating use only. Do not use to exhaust hazardous or explosive materials and vapors.

CAUTION: To reduce risk of fire and to properly exhaust air, be sure to duct air outside - do not vent exhaust air into spaces within walls or ceilings, attics or into crawl spaces, or garages.

WARNING: TO REDUCE THE RISK OF FIRE, USE ONLY METAL DUCTWORK.

WARNING: TO REDUCE THE RISK OF A RANGE TOP GREASE FIRE:

- Never leave surface units unattended at high settings. Boilovers cause smoking and greasy spillovers that may ignite. Heat oils slowly on low or medium settings.
- Always turn hood ON when cooking at high heat or when flambeing food (i.e. Crepes Suzette, Cherries Jubilee, Peppercorn Beef Flambe).
- Clean ventilating fans frequently. Grease should not be allowed to accumulate on fan or filter.
- Use proper pan size. Always use cookware appropriate for the size of the surface element.

WARNING: TO REDUCE THE RISK OF INJURY TO PERSONS IN THE EVENT OF A RANGE TOP GREASE FIRE, OBSERVE THE FOLLOWING:^a

- **SMOTHER FLAMES** with a close fitting lid, cookie sheet, or metal tray, then turn off the burner. **BE CAREFUL TO PREVENT BURNS.** If the flames do not go out immediately, **EVACUATE AND CALL THE FIRE DEPARTMENT.**
- **NEVER PICK UP A FLAMING PAN** - you may be burned.
- **DO NOT USE WATER**, including wet dishcloths or towels - a violent steam explosion will result.
- Use an extinguisher **ONLY** if:
 - You know you have a class ABC extinguisher, and you already know how to operate it.
 - The fire is small and contained in the area where it started.
 - The fire department is being called.
 - You can fight the fire with your back to an exit.

^aBased on "Kitchen Fire Safety Tips" published by NFPA.

- **WARNING:** To reduce the risk of fire or electrical shock, do not use this fan with any solid-state speed control device.

READ AND SAVE THESE INSTRUCTIONS

INSTALLATION REQUIREMENTS

Tools and Parts

Gather the required tools and parts before starting installation. Read and follow the instructions provided with any tools listed here.

Tools Needed

- Level
- Drill with 1¼" (3.0 cm), ⅜" (9.5 mm), and ⅝" (7.9 mm) drill bits
- Pencil
- Wire stripper or utility knife
- Tape measure or ruler
- Pliers
- Caulking gun and weatherproof caulking compound
- Vent clamps
- Jigsaw or keyhole saw
- Flat-blade screwdriver
- Metal snips
- Phillips screwdriver

Parts Needed

- Home power supply cable
- ½" (12.7 mm) UL listed or CSA approved strain relief
- UL listed wire connectors (3)

For Vented Installations, You Will Also Need:

- 1 wall or roof cap
- Metal vent system

For Non-Vented (Recirculating) Installations, You Will Also Need:

- Recirculation Kit Part Number W10692908 for non-vented (recirculating) installations only. See "Assistance or Service" section to order.
- 6" (15.2 cm) diameter round metal vent duct - length required is determined by ceiling height.

Parts Supplied

Remove parts from packages. Check that all parts are included.

- Hood canopy assembly with ventilator and LED and halogen lights installed
- Vent transition with back draft dampers installed
- Metal grease filter(s)—depending on model and size
- Vent cover support bracket
- Mounting template
- 2-piece vent cover
- 4.2 x 8 screws (4)
- 5 x 45 mm mounting screws (6)
- D6.4 x 18 mm washers (2)
- 8 x 40 mm wall anchors (2)
- 10 x 60 mm wall anchors (4)
- 5.4 x 75 mm screws (for 10 x 60 mm wall anchors) (4)
- 3.5 x 9.5 mm sheet metal screws (2)
- T10 TORX® adapter

†TORX is a registered trademark of Acument Intellectual Properties, LLC.

Location Requirements

IMPORTANT: Observe all governing codes and ordinances.

Have a qualified technician install the range hood. It is the installer's responsibility to comply with installation clearances specified on the model/serial/rating plate. The model/serial/rating plate is located behind the left filter on the rear wall of the vent hood.

Canopy hood location should be away from strong draft areas, such as windows, doors and strong heating vents.

Cabinet opening dimensions that are shown must be used. Given dimensions provide minimum clearance.

This range hood is recommended for use with cooktops with a maximum total rating of 65,000 BTUs or less.

Grounded electrical outlet is required. See "Electrical Requirements" section.

The canopy hood is factory-set for venting through the roof or wall. For non-vented (recirculating) installation see "For non-vented (recirculating) installation only" in the "Connect Vent System" section. Recirculation Kit Part Number W10692908 is available from your dealer or an authorized parts distributor.

All openings in ceiling and wall where canopy hood will be installed must be sealed.

For Mobile Home Installations

The installation of this range hood must conform to the Manufactured Home Construction Safety Standards, Title 24 CFR, Part 328 (formerly the Federal Standard for Mobile Home Construction and Safety, Title 24, HUD, Part 280) or when such standard is not applicable, the standard for Manufactured Home Installation 1982 (Manufactured Home Sites, Communities and Setups) ANSI A225.1/NFPA 501A, or latest edition, or with local codes.

Product Dimensions

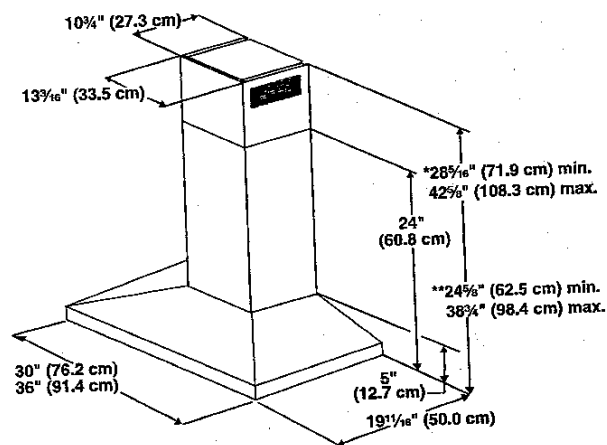

*For non-vented (recirculating) installations

**For vented installations

Cabinet Dimensions

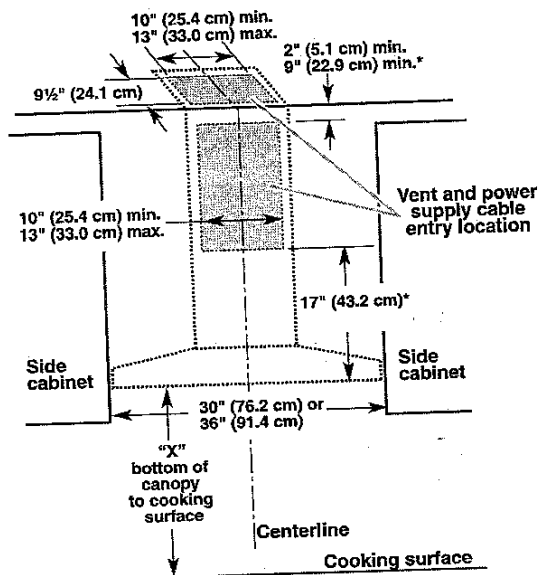

*For non-vented (recirculating) installations

IMPORTANT:

Minimum distance "X": 24" (61.0 cm) from electric cooking surface.

Minimum distance "X": 27" (68.6 cm) from gas cooking surfaces.

Suggested maximum distance "X": 36" (91.4 cm)

The chimneys can be adjusted for different ceiling heights. See the following chart.

Vented Installations

	Min. ceiling height	Max. ceiling height
Electric cooking surface	7' 1" (2.16 m)	9' 2" (2.79 m)
Gas cooking surface	7' 4" (2.23 m)	9' 2" (2.79 m)

Non-vented (recirculating) Installations

	Min. ceiling height	Max. ceiling height
Electric cooking surface	7' 1" (2.16 m)	9' 6" (2.9 m)
Gas cooking surface	7' 4" (2.23 m)	9' 6" (2.9 m)

NOTE: The range hood chimneys are adjustable and designed to meet varying ceiling or soffit heights depending on the distance "X" between the bottom of the range hood and the cooking surface. For higher ceilings, a Chimney Extension Kit is available from your dealer or an authorized parts distributor. The chimney extension replaces the chimney shipped with the range hood. To order, see the "Assistance or Service" section.

Venting Requirements (Vented Models Only)

- Vent system must terminate to the outdoors except for non-vented (recirculating) installations.
- Do not terminate the vent system in an attic or other enclosed area.
- Do not use 4" (10.2 cm) laundry-type wall caps.
- Use metal vent only. Rigid metal vent is recommended. Plastic or metal foil vent is not recommended.
- The length of vent system and number of elbows should be kept to a minimum to provide efficient performance.

For the Most Efficient and Quiet Operation:

- Use no more than three 90° elbows.
- Make sure there is a minimum of 24" (61.0 cm) of straight vent between the elbows if more than 1 elbow is used.
- Do not install 2 elbows together.
- Use clamps to seal all joints in the vent system.
- The vent system must have a damper. If the roof or wall cap has a damper, do not use the damper supplied with the range hood.
- Use caulking to seal exterior wall or roof opening around the cap.
- The size of the vent should be uniform.

Cold Weather Installations

An additional back draft damper should be installed to minimize backward cold air flow and a thermal break should be installed to minimize conduction of outside temperatures as part of the vent system. The damper should be on the cold air side of the thermal break.

The break should be as close as possible to where the vent system enters the heated portion of the house.

Makeup Air

Local building codes may require the use of makeup air systems when using ventilation systems greater than specified CFM of air movement. The specified CFM varies from locale to locale. Consult your HVAC professional for specific requirements in your area.

Venting Methods

This canopy range hood is factory set for venting through the roof or through the wall.

A 6" (15.2 cm) round vent system is needed for installation (not included). The hood exhaust opening is 6" (15.2 cm) round.

NOTE: Flexible vent is not recommended. Flexible vent creates back pressure and air turbulence that greatly reduce performance.

Vent system can terminate either through the roof or wall. To vent through a wall, a 90° elbow is needed.

Rear Discharge

A 90° elbow may be installed immediately above the hood.

For Non-Vented (Recirculating) Installations

If it is not possible to vent cooking fumes and vapors to the outside, the hood can be used in the non-vented (recirculating) version, using a Recirculation Kit (which includes charcoal filters and a deflector). To order, see the "Assistance or Service" section.

Roof Venting

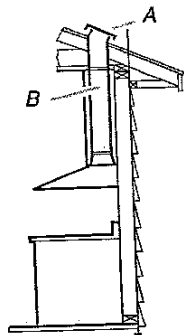

A. Roof cap
B. 6" (15.2 cm)
round vent

Wall Venting

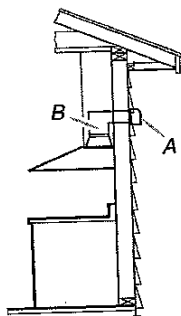

A. Wall cap
B. 6" (15.2 cm)
round vent

Non-Vented
(Recirculating)

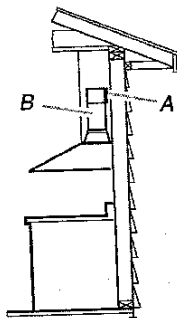

A. Diverter
B. 6" (15.2 cm)
round vent

Calculating Vent System Length

To calculate the length of the system you need, add the equivalent feet (meters) for each vent piece used in the system.

Vent Piece 6" (15.2 cm) Round

45° elbow

2.5 ft
(0.8 m)



90° elbow

5.0 ft
(1.5 m)



Maximum equivalent vent length is 35 ft (10.7 m).

Example Vent System

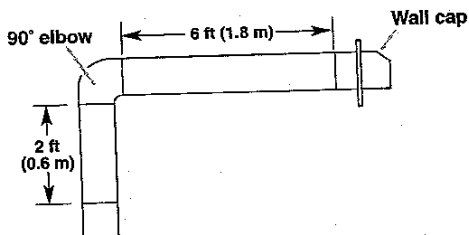

The following example falls within the maximum recommended vent length of 35 ft (10.7 m).

1 - 90° elbow	= 5.0 ft (1.5 m)
1 - wall cap	= 0.0 ft (0.0 m)
8 ft (2.4 m) straight	= 8.0 ft (2.4 m)
Length of system	= 13.0 ft (3.9 m)

Electrical Requirements

Observe all governing codes and ordinances.

Ensure that the electrical installation is adequate and in conformance with National Electrical Code, ANSI/NFPA 70 (latest edition), or CSA Standards C22.1-94, Canadian Electrical Code, Part 1 and C22.2 No. 0-M91 (latest edition) and all local codes and ordinances.

If codes permit and a separate ground wire is used, it is recommended that a qualified electrician determine that the ground path is adequate.

A copy of the above code standards can be obtained from:

National Fire Protection Association

1 Batterymarch Park
Quincy, MA 02169-7471

CSA International

8501 East Pleasant Valley Road
Cleveland, OH 44131-5575

- A 120 volt, 60 Hz., AC only, 15-amp, fused electrical circuit is required.

- If the house has aluminum wiring, follow the procedure below:

1. Connect a section of solid copper wire to the pigtail leads.
2. Connect the aluminum wiring to the added section of copper wire using special connectors and/or tools designed and UL listed for joining copper to aluminum.

Follow the electrical connector manufacturer's recommended procedure. Aluminum/copper connection must conform with local codes and industry accepted wiring practices.

- Wire sizes and connections must conform with the rating of the appliance as specified on the model/serial/rating plate. The model/serial/rating plate is located behind the left filter on the rear wall of the range hood.

- Wire sizes must conform to the requirements of the National Electrical Code, ANSI/NFPA 70 (latest edition), or CSA Standards C22.1-94, Canadian Electrical Code, Part 1 and C22.2 No. 0-M91 (latest edition) and all local codes and ordinances.

INSTALLATION INSTRUCTIONS

Prepare Location

- It is recommended that the vent system be installed before hood is installed.
 - Before making cutouts, make sure there is proper clearance within the ceiling or wall for exhaust vent.
 - Check your ceiling height and the hood height maximum before you select your hood.
1. Disconnect power.
 2. Determine which venting method to use: roof, wall, or non-vented.
 3. Select a flat surface for assembling the range hood. Place covering over that surface.

WARNING

Excessive Weight Hazard

Use two or more people to move and install range hood.

Failure to do so can result in back or other injury.

4. Using 2 or more people, lift range hood onto covered surface.

Range Hood Mounting Screws Installation

1. Determine and mark the centerline on the wall where the canopy hood will be installed.
2. Select a mounting height between a minimum of 24" (61.0 cm) for an electric cooking surface, a minimum of 27" (68.6 cm) for a gas cooking surface, and a suggested maximum of 36" (91.4 cm) above the range to the bottom of the hood. Mark a reference line on the wall.
3. Tape template in place, aligning the template centerline and bottom of template with hood bottom line and with the centerline marked on the wall.

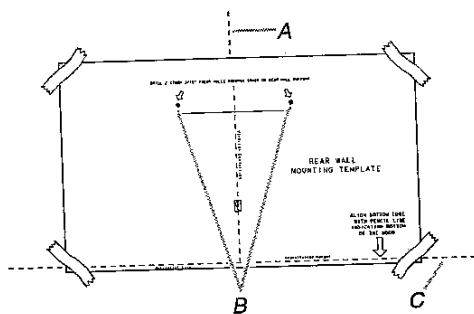

A. Centerline
B. Fastener locations
C. Mounting height reference (hood bottom line)

4. Mark centers of the fastener locations through the template to the wall.

IMPORTANT: All canopy mounting screws must be installed into wood where possible. If there is no wood to screw into, additional wall framing supports may be required, or use the (4) 10 x 60 mm wall anchors and 5.4 x 75 mm screws.

Remove the template.

5. For wood, drill $\frac{3}{16}$ " (4.8 mm) pilot holes at all locations where screws are being installed into wood.
For wall anchors, drill $\frac{7}{16}$ " (10 mm) holes at all locations where wall anchors are being used.
6. For wood, install (2) 5 x 45 mm mounting screws. Leave a $\frac{1}{4}$ " (6.4 mm) gap between the wall and the back of the screw head to slide range hood into place.
For wall anchors, install the 10 x 60 mm wall anchors and install the 5.4 x 75 mm screws into the wall anchors. Tighten until the wall anchors are secure. Back the screws out $\frac{1}{4}$ " (6.4 mm).

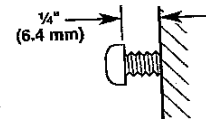

Vent Cover Bracket Installation

7. Attach vent cover bracket to wall flush to the ceiling using (2) 5 x 45 mm screws. Use the optional wall anchors if needed.

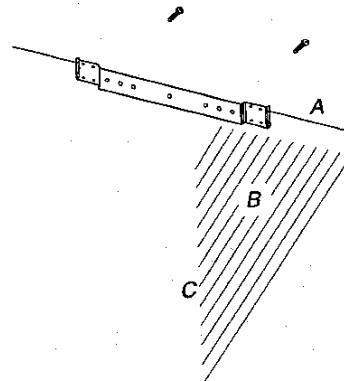

A. Ceiling
B. Wall
C. Centerline

Complete Preparation

1. Determine and make all necessary cuts in the wall for the vent system. Install the vent system before installing the hood. See "Venting Requirements" section.
2. Determine the required height for the home power supply cable and drill a $1\frac{1}{4}$ " (3.2 cm) hole at this location.
3. Run the home power supply cable according to the National Electrical Code or CSA Standards and local codes and ordinances. There must be enough $\frac{1}{2}$ " conduit and wires from the fused disconnect (or circuit breaker) box to make the connection in the hood's electrical terminal box.
NOTE: Do not reconnect power until installation is complete.
4. Use caulk to seal all openings.

Install In-Line Smart Kit - Optional

NOTE: Your range hood can work with either an internal or an in-line (external) blower motor system. An optional In-Line Smart Kit (purchased separately) allows the blower motor that comes with this range hood to be installed in a location other than inside the range hood cavity.

CAUTION: To reduce the risk of fire and electric shock, install this range hood only with the In-Line Smart Kit manufactured by Whirlpool, part number W10692945.

For installation see the In-Line Smart Kit installation instructions. See the "Assistance or Service" section to order.

Install Range Hood

1. Using 2 or more people, hang range hood on 2 mounting screws through the mounting slots on back of hood.

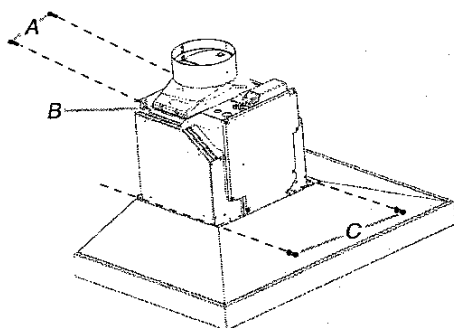

A. Mounting screws
B. Mounting slots
C. Lower mounting screws and washers

2. Remove the grease filter. See "Range Hood Care" section.
3. Level the range hood and tighten upper mounting screws.
4. Install (2) 5 x 45 mm lower mounting screws and (2) D6.4 x 18 mm washers and tighten. Use the optional wall anchors if needed.

Connect Vent System

1. Install transition on top of hood (if removed for shipping) with (2) 3.5 x 9.5 mm sheet metal screws.

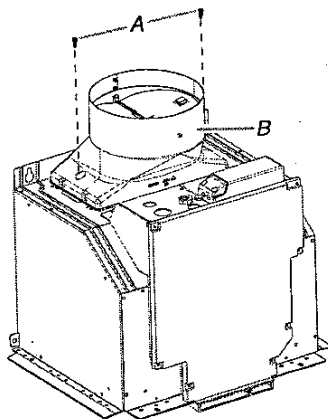

A. Vent transition
B. 3.5 x 9.5 mm screw

For Vented Installations Only:

1. Fit vent system over the exhaust outlet.
2. Seal connection with clamps.
3. Check that back draft dampers work properly.

For Non-Vented (Recirculating) Installation Only:

1. Assemble the air deflector with the duct cover bracket using (4) 4.2 x 8 mm screws.

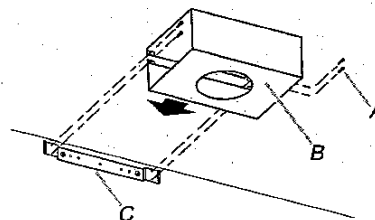

A. Assembly screws
B. Air deflector
C. Duct cover bracket

2. Measure from the bottom of the air deflector to the bottom of the hood outlet.

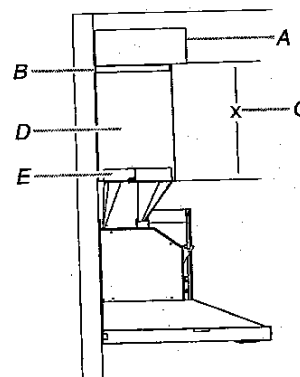

A. Air deflector
B. Vent clamp
C. X = length to cut vent duct
D. Vent duct
E. Exhaust outlet

3. Cut the duct to the measured size "X."
4. Remove the air deflector.
5. Slide the duct onto the bottom of the air deflector.
6. Place the assembled air deflector and duct over the exhaust outlet from the hood.
7. Reassemble the air deflector to the duct cover bracket with the 4 assembly screws.
8. Seal connections with vent clamps.

BE-58

INSTALLATION INSTRUCTIONS 27" (68.6 CM) AND 30" (76.2 CM) ELECTRIC SINGLE AND DOUBLE BUILT-IN OVEN

INSTRUCTIONS D'INSTALLATION FOUR ÉLECTRIQUE ENCASTRÉ 27" (68,6 CM) ET 30" (76,2 CM) - SIMPLE ET DOUBLE

Table of Contents/Table des matières

BUILT-IN OVEN SAFETY	2	SÉCURITÉ DU FOUR ENCASTRÉ	17
INSTALLATION REQUIREMENTS	2	EXIGENCES D'INSTALLATION	17
Tools and Parts	2	Outils et pièces	17
Location Requirements	3	Exigences d'emplacement.....	18
Electrical Requirements	6	Spécifications électriques	21
INSTALLATION INSTRUCTIONS	7	INSTRUCTIONS D'INSTALLATION	22
Prepare Built-In Oven.....	7	Préparation du four encastré	22
Remove Oven Door(s).....	7	Dépose de la/des porte(s) du four	22
Replace Oven Door(s).....	7	Réinstallation de la/des porte(s) du four	23
Positioning Oven Feet for Multiple Cabinet Cutout Heights	8	Positionnement des pieds du four pour des ouvertures d'encastrement de hauteur différente.....	24
Make Electrical Connection	13	Raccordement électrique.....	28
Install Oven.....	14	Installation du four	29
Install Warming Drawer Deflector Kit (Only for Ovens Installed Above Warming Drawers)	15	Installation de l'ensemble de déflecteur du tiroir-réchaud (uniquement pour les fours installés au-dessus d'un tiroir- réchaud).....	31
Complete Installation	16	Achever l'installation	32

IMPORTANT:

Save for local electrical inspector's use.

IMPORTANT :

À conserver pour consultation par l'inspecteur local des installations électriques.

BUILT-IN OVEN SAFETY

Your safety and the safety of others are very important.

We have provided many important safety messages in this manual and on your appliance. Always read and obey all safety messages.



This is the safety alert symbol.

This symbol alerts you to potential hazards that can kill or hurt you and others.

All safety messages will follow the safety alert symbol and either the word "DANGER" or "WARNING."

These words mean:

⚠ DANGER

You can be killed or seriously injured if you don't immediately follow instructions.

⚠ WARNING

You can be killed or seriously injured if you don't follow instructions.

All safety messages will tell you what the potential hazard is, tell you how to reduce the chance of injury, and tell you what can happen if the instructions are not followed.

INSTALLATION REQUIREMENTS

Tools and Parts

Gather the required tools and parts before starting installation. Read and follow the instructions provided with any tools listed here.

Tools Needed

- Phillips screwdriver
- Measuring tape
- Hand or electric drill (for wall cabinet installations)
- 1" (2.5 cm) drill bit (for wall cabinet installations)
- Level
- Flat-blade screwdriver

Parts Needed

- UL listed or CSA approved conduit connector
- UL listed wire connectors
- Warning Drawer Deflector Kit (for ovens installed above a warming drawer)
 - Order Part Number W10510613 for white 27" (68.6 cm) kit
 - Order Part Number W10531009 for black 27" (68.6 cm) kit
 - Order Part Number W10536338 for stainless steel 27" (68.6 cm) kit
 - Order Part Number W10510614 for white 30" (76.2 cm) kit
 - Order Part Number W10531010 for black 30" (76.2 cm) kit
 - Order Part Number W10536339 for stainless steel 30" (76.2 cm) kit
 - Order Part Number W10727416A for stainless steel/black 30" (76.2 cm) kit

To order, see the "Assistance or Service" section of the Use and Care Guide.

- Flush Installation Kit (for Single and Double installed at flush installation)

Order Part Number W10752684A for white 27" (68.6 cm) kit
Order Part Number W10752685A for black 27" (68.6 cm) kit
Order Part Number W10752686A for stainless steel 27" (68.6 cm) kit

Order Part Number W10752680A for white 30" (76.2 cm) kit
Order Part Number W10752681A for black 30" (76.2 cm) kit
Order Part Number W10752683A for stainless steel 30" (76.2 cm) kit

Order Part Number W10752682A for black/stainless steel 30" (76.2 cm) kit

To order, see the "Assistance or Service" section of the Use and Care Guide.

Parts Supplied

- #8-14 x 1" screws - single ovens (2), double ovens (4)
- #8-18 x 3/8" screws - bottom vent (2)
- #8-18 x 1/4" screws - bottom vent trim (4)
- #8-18 x 3/8" screws - double oven feet (4)
- Bottom vent
- Bottom vent trim
- Rear feet - double oven (2)
- Front feet - double oven (2)
- Foam strip - single oven*

Check local codes. Check existing electrical supply. See "Electrical Requirements."

It is recommended that all electrical connections be made by a licensed, qualified electrical installer.

*Foam strip not included with double oven.

Location Requirements

IMPORTANT: Observe all governing codes and ordinances.

- Cabinet opening dimensions that are shown must be used. Given dimensions provide minimum clearance with oven.
- Recessed installation area must provide complete enclosure around the recessed portion of the oven.
- Grounded electrical supply is required. See "Electrical Requirements" section.
- Electrical supply junction box should be located 3" (7.6 cm) maximum below the support surface when the oven is installed in a wall cabinet. A 1" (2.5 cm) minimum diameter hole should have been drilled in the right rear or left rear corner of the support surface to pass the appliance cable through to the junction box.

NOTE: For undercounter installation, it is recommended that the junction box be located in the adjacent right or left cabinet. If you are installing the junction box on rear wall behind oven, it is recommended that the junction box be recessed and located in the upper center of the cabinet.

- Oven support surface must be solid, level and flush with bottom of cabinet cutout.
- Floor must be able to support a single oven weight of 129 lbs (59 kg) for 27" (68.6 cm) models or 154 lbs (70 kg) for 30" (76.2 cm) models.
- Floor must be able to support a double oven weight of 251 lbs (114 kg) for 27" (68.6 cm) models or 288 lbs (131 kg) for 30" (76.2 cm) models.

IMPORTANT: To avoid damage to your cabinets, check with your builder or cabinet supplier to make sure that the materials used will not discolor, delaminate or sustain other damage. This oven has been designed in accordance with the requirements of UL and CSA International and complies with the maximum allowable wood cabinet temperatures of 194°F (90°C).

Undercounter Installation (With Cooktop Installed Above):

Ovens approved for this type of installation have an approval label located on the top of the oven. Refer to Cutout Dimensions For Ovens Installed Under Cooktop (separate sheet).

Product Dimensions - Single Ovens

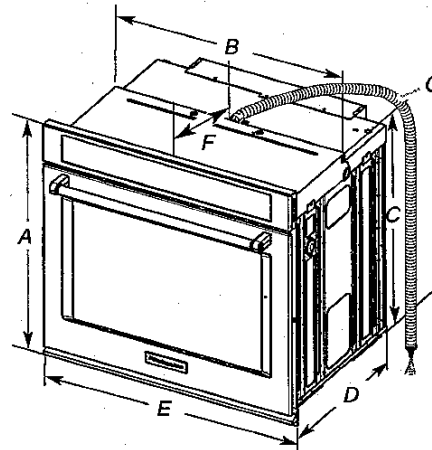

27" (68.6 cm) models

- A. 28 $\frac{3}{4}$ " (72.8 cm) max. overall height
- B. 25 $\frac{7}{8}$ " (64.6 cm) max. recessed width
- C. 26 $\frac{3}{4}$ " (67.9 cm) recessed height
- D. 23 $\frac{1}{4}$ " (59.1 cm) max. recessed depth
- E. 27" (68.6 cm) overall width
- F. 12" (30.5 cm) from back of control panel to start of strain relief
- G. 48" (121.9 cm) flexible conduit length

30" (76.2 cm) models

- A. 28 $\frac{3}{4}$ " (72.8 cm) max. overall height
- B. 28 $\frac{7}{8}$ " (72.2 cm) max. recessed width
- C. 26 $\frac{3}{4}$ " (67.9 cm) recessed height
- D. 23 $\frac{1}{4}$ " (59.1 cm) max. recessed depth
- E. 30" (76.2 cm) overall width
- F. 12" (30.5 cm) from back of control panel to start of strain relief
- G. 48" (121.9 cm) flexible conduit length

Cabinet Dimensions - Single Ovens

Single Oven Undercounter (Without Cooktop Installed Above)

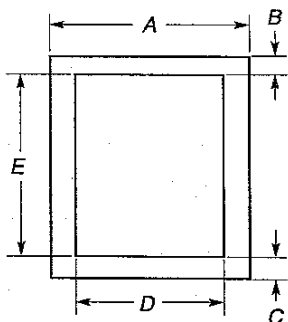

27" (68.6 cm) models

A. 27" (68.6 cm) min. cabinet width

B. 1 1/2" (3.8 cm) min. top of cutout to underside of countertop

C. 5 1/4" (13.3 cm) bottom of cutout to floor

D. 25 1/2" (64.8 cm) cutout width

E. 28" (71.2 cm) min. cutout height

30" (76.2 cm) models

A. 30" (76.2 cm) min. cabinet width

B. 1 1/2" (3.8 cm) min. top of cutout to underside of countertop

C. 5 1/4" (13.3 cm) bottom of cutout to floor

D. 28 1/2" (72.4 cm) cutout width

E. 28" (71.2 cm) min. cutout height

Single Ovens Installed in Cabinet

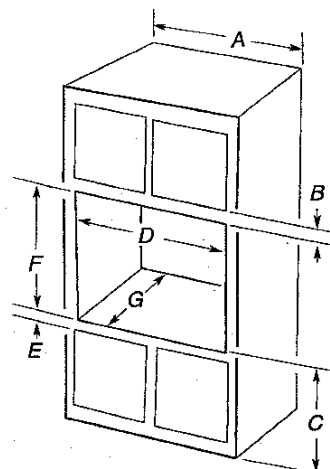

27" (68.6 cm) models

A. 27" (68.6 cm) min. cabinet width

B. 1" (2.5 cm) top of cutout to bottom of upper cabinet door

C. 32" (81.3 cm) bottom of cutout to floor

D. 25 1/2" (64.8 cm) cutout width

E. 1 1/2" (3.8 cm) min. bottom of cutout to top of cabinet door

F. 28" (71.2 cm)* recommended cutout height

G. 24" (60.7 cm) cutout depth

30" (76.2 cm) models

A. 30" (76.2 cm) min. cabinet width

B. 1" (2.5 cm) top of cutout to bottom of upper cabinet door

C. 32" (81.3 cm) bottom of cutout to floor

D. 28 1/2" (72.4 cm) cutout width

E. 1 1/2" (3.8 cm) min. bottom of cutout to top of cabinet door

F. 28" (71.2 cm)* recommended cutout height

G. 24" (60.7 cm) cutout depth

***NOTE:** The cutout height can be between 26 15/16" and 29 7/16" (68.4 cm and 74.8 cm) for single ovens.

Product Dimensions - Double Ovens

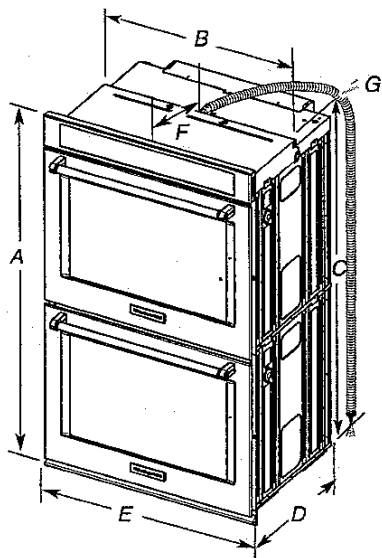

27" (68.6 cm) models

- A. 51 ³/₁₆" (130.0 cm) max. overall height
- B. 25 ⁷/₁₆" (64.6 cm) max. recessed width
- C. 48 ¹³/₁₆" (124.0 cm) recessed height
- D. 23 ¹/₄" (59.1 cm) max. recessed depth
- E. 27" (68.6 cm) overall width
- F. 12" (30.5 cm) from back of control panel to start of strain relief
- G. 66" (167.6 cm) flexible conduit length

30" (76.2 cm) models

- A. 51 ³/₁₆" (130.0 cm) max. overall height
- B. 28 ⁷/₁₆" (72.2 cm) max. recessed width
- C. 48 ¹³/₁₆" (124.0 cm) recessed height
- D. 23 ¹/₄" (59.1 cm) max. recessed depth
- E. 30" (76.2 cm) overall width
- F. 12" (30.5 cm) from back of control panel to start of strain relief
- G. 66" (167.6 cm) flexible conduit length

Cabinet Dimensions - Double Ovens

Double Ovens Installed in Cabinet

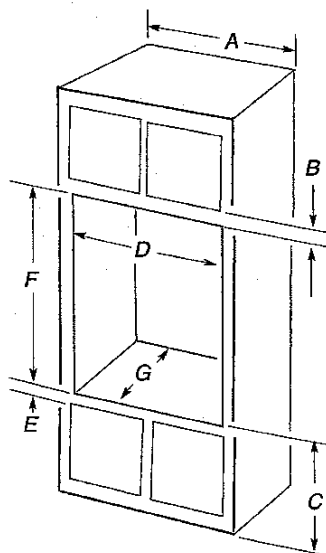

27" (68.6 cm) models

- A. 27" (68.6 cm) min. cabinet width
- B. 1" (2.5 cm) top of cutout to bottom of upper cabinet door
- C. 14 ³/₄" (37.5 cm) bottom of cutout to floor is recommended. 4"-14 ³/₄" (10.2-37.5 cm) bottom of cutout to floor is acceptable.
- D. 25 ¹/₂" (64.8 cm) cutout width
- E. 1 ¹/₂" (3.8 cm) min. bottom of cutout to top of cabinet door
- F. 50 ¹/₄" (127.6 cm)* recommended cutout height
- G. 24" (60.7 cm) cutout depth

30" (76.2 cm) models

- A. 30" (76.2 cm) min. cabinet width
- B. 1" (2.5 cm) top of cutout to bottom of upper cabinet door
- C. 14 ³/₄" (37.5 cm) bottom of cutout to floor is recommended. 4"-14 ³/₄" (10.2-37.5 cm) bottom of cutout to floor is acceptable.
- D. 28 ¹/₂" (72.4 cm) cutout width
- E. 1 ¹/₂" (3.8 cm) min. bottom of cutout to top of cabinet door
- F. 50 ¹/₄" (127.6 cm)* recommended cutout height
- G. 24" (60.7 cm) cutout depth

***NOTE:** The cutout height can be between 48 ⁷/₁₆" and 52 ³/₁₆" (124.1 cm and 132.6 cm) for double ovens.

BE 58

MICROWAVE OVEN BUILT-IN TRIM KIT INSTALLATION INSTRUCTIONS

Built-In Trim Kit Models MK2167, MK2160

UL listed for use over any electric or gas built-in oven, up to 30" (76.2 cm) wide

INSTRUCTIONS D'INSTALLATION GARNITURE ENCASTRÉE POUR FOUR À MICRO-ONDES

Garniture encastrée pour modèles MK2167, MK2160

Homologation UL pour utilisation au-dessus de tous les fours encastrés électriques ou gaz, jusqu'à 30" (76,2 cm) de largeur

Table of Contents / Table des matières

MICROWAVE OVEN SAFETY	1	SÉCURITÉ DU FOUR À MICRO-ONDES	7
INSTALLATION INSTRUCTIONS.....	2	INSTRUCTIONS D'INSTALLATION.....	7
Tools and Parts	2	Outils et pièces.....	7
Location Requirements.....	2	Exigences d'emplacement.....	7
Required Cutout Dimensions.....	2	Dimensions nécessaires de l'ouverture d'encastrement.....	8
Trim Kit Frame Dimensions.....	3	Dimensions du cadre de la trousse de garniture.....	8
Electrical Requirements	3	Spécifications électriques	9
Prepare Microwave Oven.....	3	Préparation du four à micro-ondes.....	9
Prepare Cutout/Cabinet Opening.....	4	Préparation de l'ouverture d'encastrement	10
Install the Microwave Oven.....	5	Installation du four à micro-ondes	11
Install Trim Kit Frame	6	Installation du cadre de la trousse de garniture	12

MICROWAVE OVEN SAFETY

Your safety and the safety of others are very important.

We have provided many important safety messages in this manual and on your appliance. Always read and obey all safety messages.



This is the safety alert symbol.

This symbol alerts you to potential hazards that can kill or hurt you and others.

All safety messages will follow the safety alert symbol and either the word "DANGER" or "WARNING."

These words mean:

⚠ DANGER

You can be killed or seriously injured if you don't immediately follow instructions.

⚠ WARNING

You can be killed or seriously injured if you don't follow instructions.

All safety messages will tell you what the potential hazard is, tell you how to reduce the chance of injury, and tell you what can happen if the instructions are not followed.

INSTALLATION INSTRUCTIONS

Tools and Parts

Tools Needed

Gather the required tools and parts before starting installation. Read and follow the instructions provided with any tools listed here.

- Measuring tape
- Drill
- Pencil
- 7/64" drill bit
- Phillips screwdriver

Parts Supplied (not shown to scale)

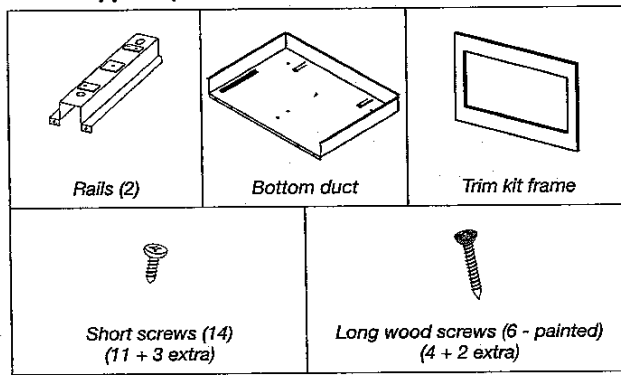

Location Requirements

The microwave oven may be installed over a built-in oven. If installing over a built-in oven, make sure there is a minimum of 3" (7.6 cm) between the top of the lower oven cutout and the microwave oven cutout floor.

The microwave oven may also be installed in a cabinet by itself (without a built-in oven below). For best usability, we recommend a minimum distance of 36" (91.4 cm) from the floor to the cutout floor.

Make sure the surrounding cabinetry has clearance to open and close freely. Allow a clearance of at least 1 1/16" (4.0 cm) below the cutout floor (3" [7.6 cm] for installation above a built-in oven), and a clearance of at least 2" (5.1 cm) above the cutout opening.

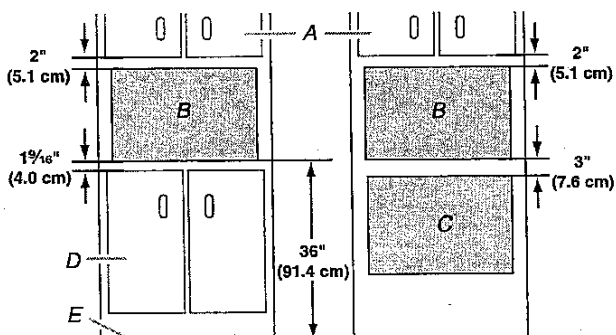

- A. Upper cabinet
- B. Microwave oven cutout
- C. Lower oven cutout
- D. Lower cabinets
- E. Floor

Required Cutout Dimensions

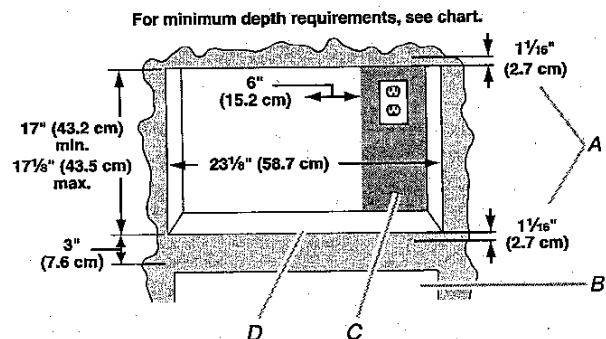

- A. Trim kit frame overhang
- B. Cutout for lower oven
- C. Recommended region for receptacle location (no less than 6" [15.2 cm] to the right of cutout centerline)
- D. Cutout centerline

Receptacle Location	Minimum Depth
Within recommended region	18" (45.7 cm) with flush receptacle; 21" (53.2 cm) with non-flush receptacle
Outside recommended region	19 1/2" (49.5 cm) with flush receptacle; 22 1/2" (57.2 cm) with non-flush receptacle

NOTES:

- Depth requirements depend upon receptacle and its location within or outside of recommended region. See illustration and chart above.
- Height dimension is critical: 17" (43.2 cm) minimum, 17 1/8" (43.5 cm) maximum.
- Width measurement has ±1/16" (2 mm) tolerance.
- 3" (7.6 cm) minimum dimension is from lower oven cutout ceiling to microwave oven cutout floor.
- Trim kit frame extends 1 1/16" (2.7 cm) above and below the cutout opening.

Trim Kit Frame Dimensions

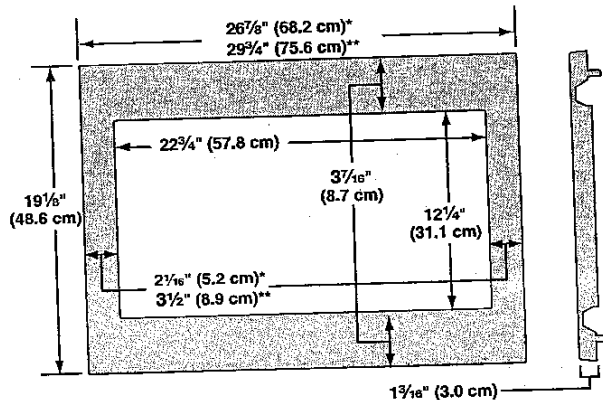

*27" (68.6 cm) trim kit

**30" (76.2 cm) trim kit

Electrical Requirements

⚠ WARNING



Electrical Shock Hazard

Plug into a grounded 3 prong outlet.

Do not remove ground prong.

Do not use an adapter.

Do not use an extension cord.

Failure to follow these instructions can result in death, fire, or electrical shock.

Observe all governing codes and ordinances.

Required:

- A 120 volt, 60 Hz, AC only, 15- or 20-amp electrical supply with a fuse or circuit breaker.

Recommended:

- A time-delay fuse or time-delay circuit breaker.
- A separate circuit serving only this microwave oven.

GROUNDING INSTRUCTIONS

■ For all cord connected appliances:

The microwave oven must be grounded. In the event of an electrical short circuit, grounding reduces the risk of electric shock by providing an escape wire for the electric current. The microwave oven is equipped with a cord having a grounding wire with a grounding plug. The plug must be plugged into an outlet that is properly installed and grounded.

WARNING: Improper use of the grounding plug can result in a risk of electric shock. Consult a qualified electrician or serviceman if the grounding instructions are not completely understood, or if doubt exists as to whether the microwave oven is properly grounded.

Do not use an extension cord. If the power supply cord is too short, have a qualified electrician or serviceman install an outlet near the microwave oven.

SAVE THESE INSTRUCTIONS

Prepare Microwave Oven

1. Unplug microwave oven before proceeding with installation.
2. Remove any loose items inside microwave oven.
3. Gently turn microwave oven onto its top, with the door facing forward (toward installer).
4. Align the two rails on the microwave oven bottom, as shown, making sure the flanges are forward and pointing up.

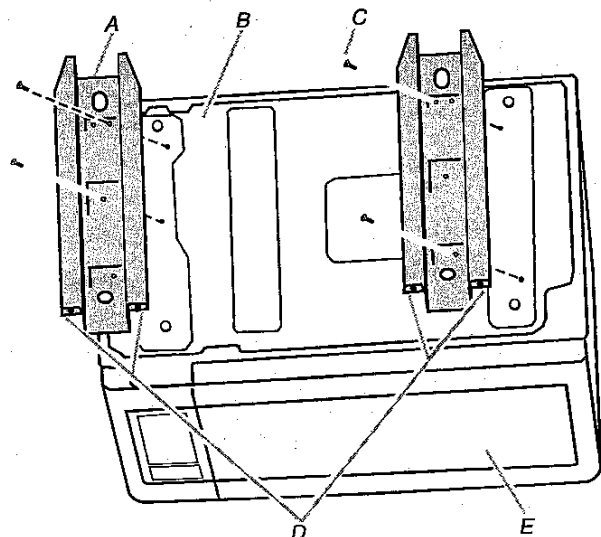

A. Rails (2)
B. Microwave oven bottom
C. Short screws (4)

D. Flanges
E. Door

5. Secure the rails to the microwave oven bottom using four short screws.

Prepare Cutout/Cabinet Opening

1. On the cutout floor, find and mark the centerline.
2. Place the bottom duct in the opening, with the flange resting against the bottom front facing of the opening.

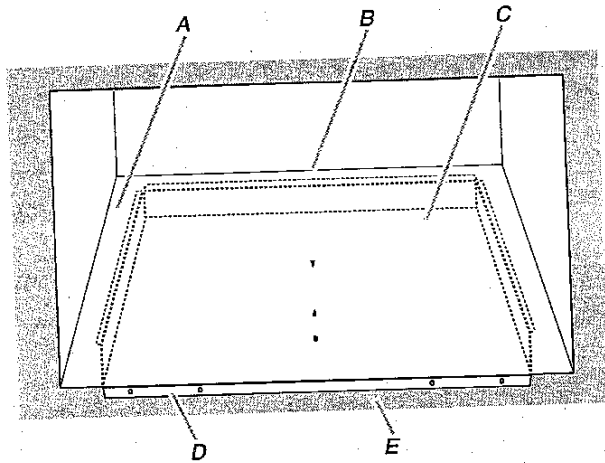

A. Cutout floor
B. Centerline
C. Bottom duct
D. Bottom duct flange
E. Front facing

3. Align the center arrows on the bottom duct with the centerline drawn in Step 1 above.

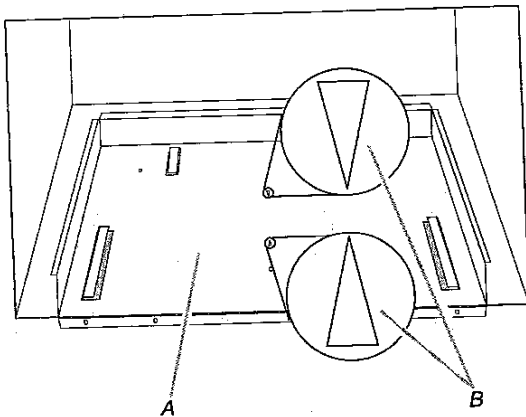

A. Bottom duct
B. Center arrows, aligned with centerline

4. Mark the three mounting holes through the bottom duct onto the cutout floor.

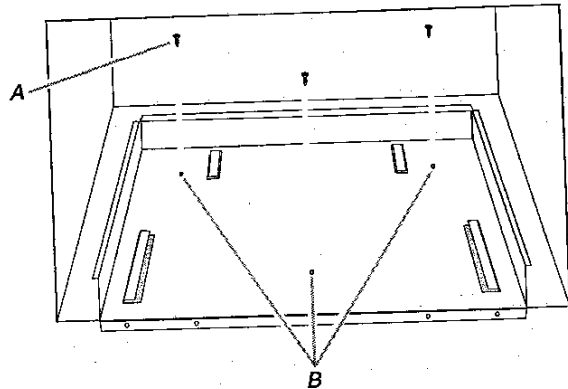

A. Short screws (3)
B. Bottom duct mounting holes

5. Using 7/64" drill, drill pilot holes into the three holes marked in Step 4.
6. Realign and install the bottom duct with three short screws.
7. Using 7/64" drill, drill pilot holes through the four mounting holes of the bottom duct flange into the bottom front facing of the cutout/cabinet opening.

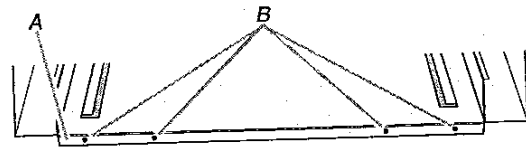

A. Bottom duct flange
B. Mounting holes

Install the Microwave Oven

1. Gently return microwave oven to its upright position.
2. Position microwave oven near cutout opening.

⚠ WARNING



Electrical Shock Hazard

Plug into a grounded 3 prong outlet.

Do not remove ground prong.

Do not use an adapter.

Do not use an extension cord.

Failure to follow these instructions can result in death, fire, or electrical shock.

3. Plug in microwave oven.
4. Align the rails with the rail guides on the bottom duct.

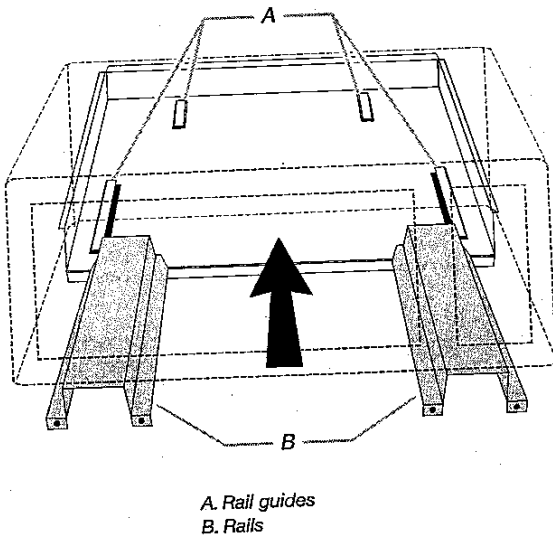

5. Slide the microwave oven back and into place. The mounting holes of the rail flanges and bottom duct flange will align against the bottom front facing of the cutout/cabinet opening.

6. Secure the microwave oven to the cutout/cabinet by installing four short screws into the mounting holes.

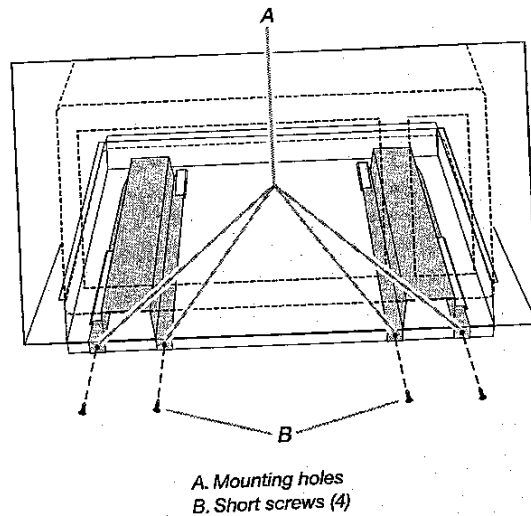

Install Trim Kit Frame

1. Position trim kit frame over the opening so that the lower tabs rest on the cutout floor, as shown.

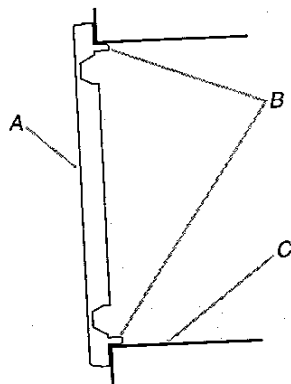

A. Front of trim kit frame
B. Tabs (upper and lower)
C. Cutout/cabinet floor

2. Holding the trim kit frame in place, use 7/64" drill to drill four pilot holes into the front facing of the cutout/cabinet through the mounting hole guides in the upper and lower corners of the trim kit frame.

NOTES:

- The holes will be drilled downward from the top, and upward from the bottom at an angle of about 45°.
- To avoid damage to the trim kit frame, do not overtighten screws.

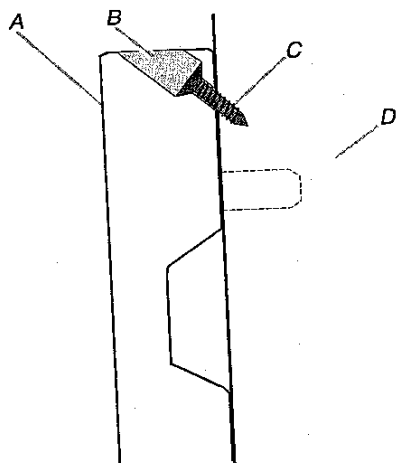

A. Trim kit frame
B. Mounting hole guide

C. Long wood screw (4 - painted)
D. Cutout ceiling

3. Secure trim kit frame to cutout/cabinet by installing four long wood screws (painted) into the pilot holes drilled in Step 2 above.

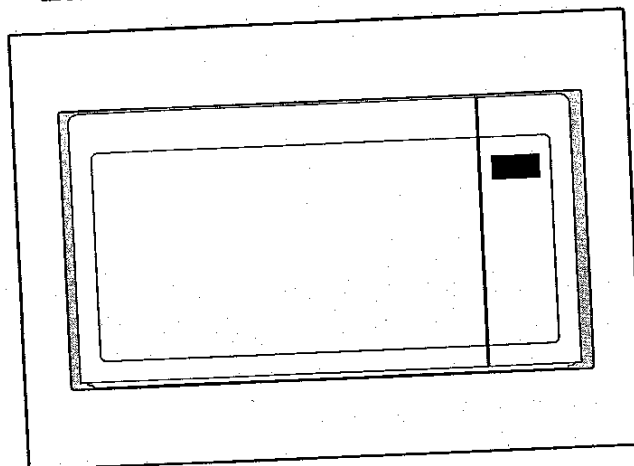





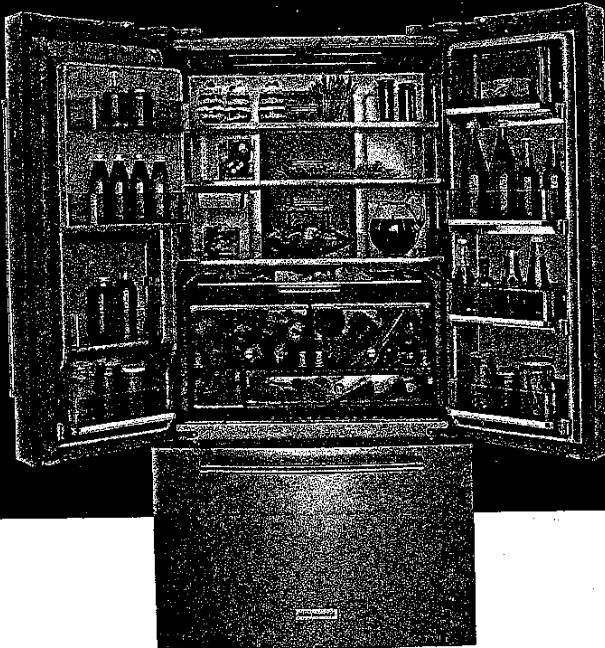

Installation is now complete. Replace any loose items that have been removed from microwave oven cavity.
Save these Installation Instructions for future reference.

KitchenAid®

REFRIGERATION



OPEN THE DOORS TO INSPIRE YOUR CULINARY ADVENTURES

KitchenAid®			
			
		KRFC604F	KRFC704F
THE KITCHENAID ADVANTAGE		Iconic Design	
TOP FEATURES		Luxury Soft Close External Doors Soft Close Pull-Out Basket Panoramic LED Lighting	Platinum Interior Design Luxury Soft Close External Doors Wood-Inspired Soft Close Pull-Out Basket
DESIGN SPECIFICATIONS	CAPACITY (CU. FT.)	23.8	23.8
	DIMENSIONS (W" X H" X D")	35.6 x 72 x 24.1	35.6 x 72 x 24.1
	COLOUR AVAILABILITY		  
	COUNTER DEPTH	.	.
	ELECTRONIC CONTROLS	.	.
	PULL OUT BASKET - FULL WIDTH	.	.
	PULL OUT WOOD BASKET - FULL WIDTH	.	.
PERFORMANCE FEATURES	PLATINUM INTERIOR	.	.
	LED LIGHTING	.	.
	EXTERNAL ICE & WATER DISPENSE	.	.
	FACTORY ICE MAKER	.	.
	ADJUSTABLE GLASS SHELVING WITH L TUCK	.	.
	ADJUSTABLE GLASS SHELVING WITH WOOD L TUCK	.	.
	SOFT CLOSE CRISPERS	.	.
	SOFT CLOSE PANTRY	.	.
	GALLON DOOR STORAGE	.	.
	SOFT CLOSE EXTERNAL FREEZER DRAWER	.	.
	SOFT CLOSE EXTERNAL REFRIGERATOR DOORS	.	.
	UNDERSHELF STORAGE	.	.
	HERB STORAGE	.	.
	LINEAR COMPRESSOR	.	.
QUALITY	WATER FILTER	EDR2RXD1	EDR2RXD1
	1 YEAR WARRANTY	.	.

COLOUR LEGEND: BS:BLACK STAINLESS SS:STAINLESS STEEL PS:PRINTSHIELD™ STAINLESS STEEL

BE 68

INSTALLATION INSTRUCTIONS 30" (76.2 CM) AND 36" (91.4 CM) GAS BUILT-IN COOKTOP

INSTRUCTIONS D'INSTALLATION DE LA TABLE DE CUISSON À GAZ ENCASTRÉE DE 30" (76,2 CM) ET 36" (91,4 CM)

Table of Contents/Table des matières

COOKTOP SAFETY	2	SÉCURITÉ DE LA TABLE DE CUISSON	13
INSTALLATION REQUIREMENTS	3	EXIGENCES D'INSTALLATION	14
Tools and Parts	3	Outillage et pièces	14
Location Requirements	3	Exigences d'emplacement	14
Electrical Requirements	7	Spécifications électriques	18
Gas Supply Requirements	7	Spécifications de l'alimentation en gaz	18
INSTALLATION INSTRUCTIONS	9	INSTRUCTIONS D'INSTALLATION	20
Install Cooktop	9	Installation de la table de cuisson	20
Make Gas Connection	9	Raccordement au gaz	20
Complete Installation	11	Achever l'installation	22

IMPORTANT:

Installer: Leave installation instructions with the homeowner.

Homeowner: Keep installation instructions for future reference.

IMPORTANT :

Installateur : Remettre les instructions d'installation au propriétaire.

Propriétaire : Conserver les instructions d'installation pour référence ultérieure.

COOKTOP SAFETY

Your safety and the safety of others are very important.

We have provided many important safety messages in this manual and on your appliance. Always read and obey all safety messages.



This is the safety alert symbol.

This symbol alerts you to potential hazards that can kill or hurt you and others.

All safety messages will follow the safety alert symbol and either the word "DANGER" or "WARNING."

These words mean:

⚠ DANGER

You can be killed or seriously injured if you don't immediately follow instructions.

⚠ WARNING

You can be killed or seriously injured if you don't follow instructions.

All safety messages will tell you what the potential hazard is, tell you how to reduce the chance of injury, and tell you what can happen if the instructions are not followed.

WARNING: If the information in this manual is not followed exactly, a fire or explosion may result causing property damage, personal injury or death.

- Do not store or use gasoline or other flammable vapors and liquids in the vicinity of this or any other appliance.
- WHAT TO DO IF YOU SMELL GAS:
 - Do not try to light any appliance.
 - Do not touch any electrical switch.
 - Do not use any phone in your building.
 - Immediately call your gas supplier from a neighbor's phone. Follow the gas supplier's instructions.
 - If you cannot reach your gas supplier, call the fire department.
- Installation and service must be performed by a qualified installer, service agency or the gas supplier.

WARNING: Gas leaks cannot always be detected by smell.

Gas suppliers recommend that you use a gas detector approved by UL or CSA.

For more information, contact your gas supplier.

If a gas leak is detected, follow the "What to do if you smell gas" instructions.

IMPORTANT: Do not install a ventilation system that blows air downward toward this gas cooking appliance. This type of ventilation system may cause ignition and combustion problems with this gas cooking appliance resulting in personal injury or unintended operation.

In the State of Massachusetts, the following installation instructions apply:

- Installations and repairs must be performed by a qualified or licensed contractor, plumber, or gasfitter qualified or licensed by the State of Massachusetts.
- If using a ball valve, it shall be a T-handle type.
- A flexible gas connector, when used, must not exceed 3 feet.

INSTALLATION REQUIREMENTS

Tools and Parts

Gather the required tools and parts before starting installation.

Tools needed

- | | |
|-----------------------------|-------------------------------------------|
| ■ Tape measure | ■ Wrench or pliers |
| ■ Flat-blade screwdriver | ■ Marker or pencil |
| ■ Phillips screwdriver | ■ Pipe-joint compound resistant to LP gas |
| ■ 15/16" combination wrench | ■ Noncorrosive leak-detection solution |
| ■ Pipe wrench | |

Parts supplied

- | | |
|--------------------------|---------------------------------|
| ■ Gas pressure regulator | ■ Clamping brackets (2) |
| ■ Burner grates | ■ Bracket attachment screws (2) |
| ■ Burner caps | |
| ■ Burner base | |

Parts needed

Check local codes and consult gas supplier. Check existing gas supply and electrical supply. See "Electrical Requirements" and "Gas Supply Requirements" sections.

Location Requirements

IMPORTANT: Observe all governing codes and ordinances. Do not obstruct flow of combustion and ventilation air.

- It is the installer's responsibility to comply with installation clearances specified on the model/serial rating plate. The model/serial rating plate is located on the underside of the cooktop base.

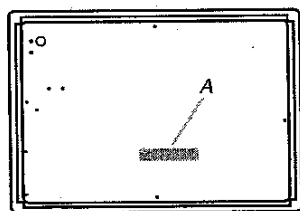

A. Model/serial rating plate

- To eliminate the risk of burns or fire by reaching over heated surface units, cabinet storage space located above the surface units should be avoided. If cabinet storage is to be provided, the risk can be reduced by installing a range hood that projects horizontally a minimum of 5" (12.7 cm) beyond the bottom of the cabinets.

- The cooktop must be a specified cooktop that is approved to be installed either alone or over an undercounter built-in oven. Check the cooktop base approved installation label for your cooktop model number and approved combinations of cooktops and ovens that can be installed. If you do not find this label, your cooktop may not be approved for use over an undercounter built-in oven. Contact your dealer to confirm that your cooktop is approved.
- Ovens approved for this type of installation will have an approval label located on the top of the oven. If you do not find this label, contact your dealer to confirm that your oven is approved. Refer to oven manufacturer's Installation Instructions for approval for built-in undercounter use and proper cutout dimensions.
- The cooktop should be installed in a location away from strong draft areas, such as windows, doors and strong heating vents or fans.
- All openings in the wall or floor where cooktop is to be installed must be sealed.
- Cabinet opening dimensions that are shown must be used. Given dimensions are minimum clearances.
- Grounded electrical supply is required. See "Electrical Requirements" section. Proper gas supply connection must be available. See "Gas Supply Requirements" section.
- The cooktop is designed to hang from the countertop by its side or rear flanges.
- The gas and electric supply should be located as shown in "Cabinet Dimensions" section so that they are accessible without requiring removal of the cooktop.
- Provide cutout in right rear corner of cutout enclosure as shown to provide clearance for gas inlet, power supply cord, and to allow the rating label to be visible.

IMPORTANT: To avoid damage, check with your builder or cabinet supplier to make sure that the materials used will not discolor, delaminate or sustain other damage.

Mobile Home - Additional Installation Requirements

The installation of this cooktop must conform to the Manufactured Home Construction and Safety Standard, Title 24 CFR, Part 3280 (formerly the Federal Standard for Mobile Home Construction and Safety, Title 24, HUD Part 280). When such standard is not applicable, use the Standard for Manufactured Home Installations, ANSI A225.1/NFPA 501A or with local codes.

In Canada, the installation of this cooktop must conform with the current standards CAN/CSA-A240-latest edition, or with local codes.

Product Dimensions

KCGS550ESS and KCGS950ESS Models

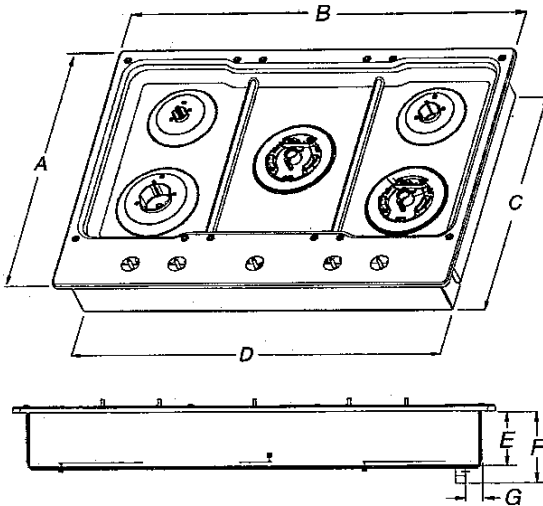

- | | |
|----------------------|---------------------|
| A. 21" (53.3 cm) | E. 3 3/8" (9.2 cm) |
| B. 30" (76.2 cm) | F. 4 1/8" (11.6 cm) |
| C. 19 3/8" (49.2 cm) | G. 1 1/8" (3.4 cm) |
| D. 28 3/8" (72.1 cm) | |

All Other 30" (76.2 cm) Models

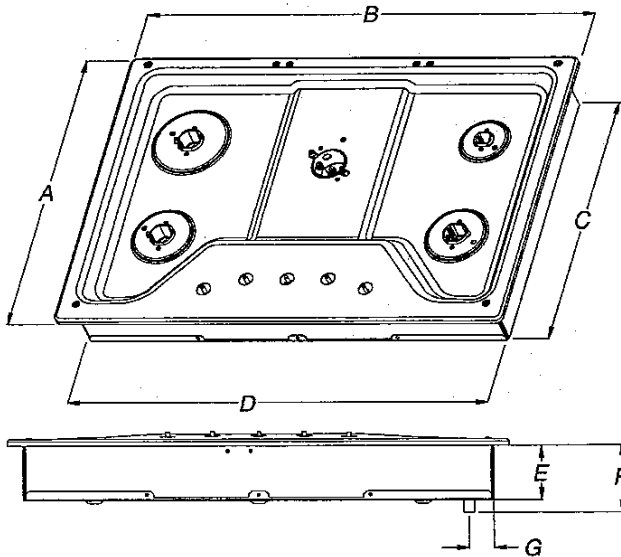

- | | |
|----------------------|---------------------|
| A. 21" (53.3 cm) | E. 3 3/8" (8.6 cm) |
| B. 30" (76.2 cm) | F. 4 1/8" (10.5 cm) |
| C. 18 7/8" (48.0 cm) | G. 1 1/2" (3.8 cm) |
| D. 28 3/8" (72.1 cm) | |

KCGS556ESS and KCGS956ESS Models

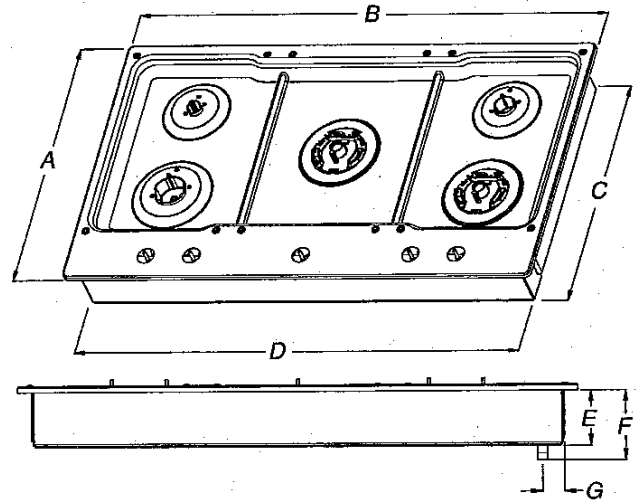

- | | |
|----------------------|---------------------|
| A. 21" (53.3 cm) | E. 3 3/8" (9.2 cm) |
| B. 36 1/4" (92.0 cm) | F. 4 1/8" (11.6 cm) |
| C. 19 3/8" (49.2 cm) | G. 1 7/8" (3.6 cm) |
| D. 34 3/8" (88.1 cm) | |

All Other 36" (91.4 cm) Models

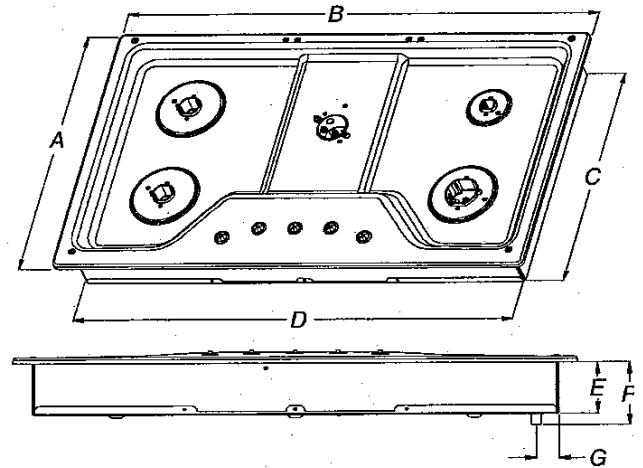

- | | |
|----------------------|---------------------|
| A. 21" (53.3 cm) | E. 3 3/8" (8.6 cm) |
| B. 36" (91.4 cm) | F. 4 1/8" (10.5 cm) |
| C. 18 7/8" (48.0 cm) | G. 1 1/2" (3.8 cm) |
| D. 33 3/4" (85.7 cm) | |

Cabinet Clearances

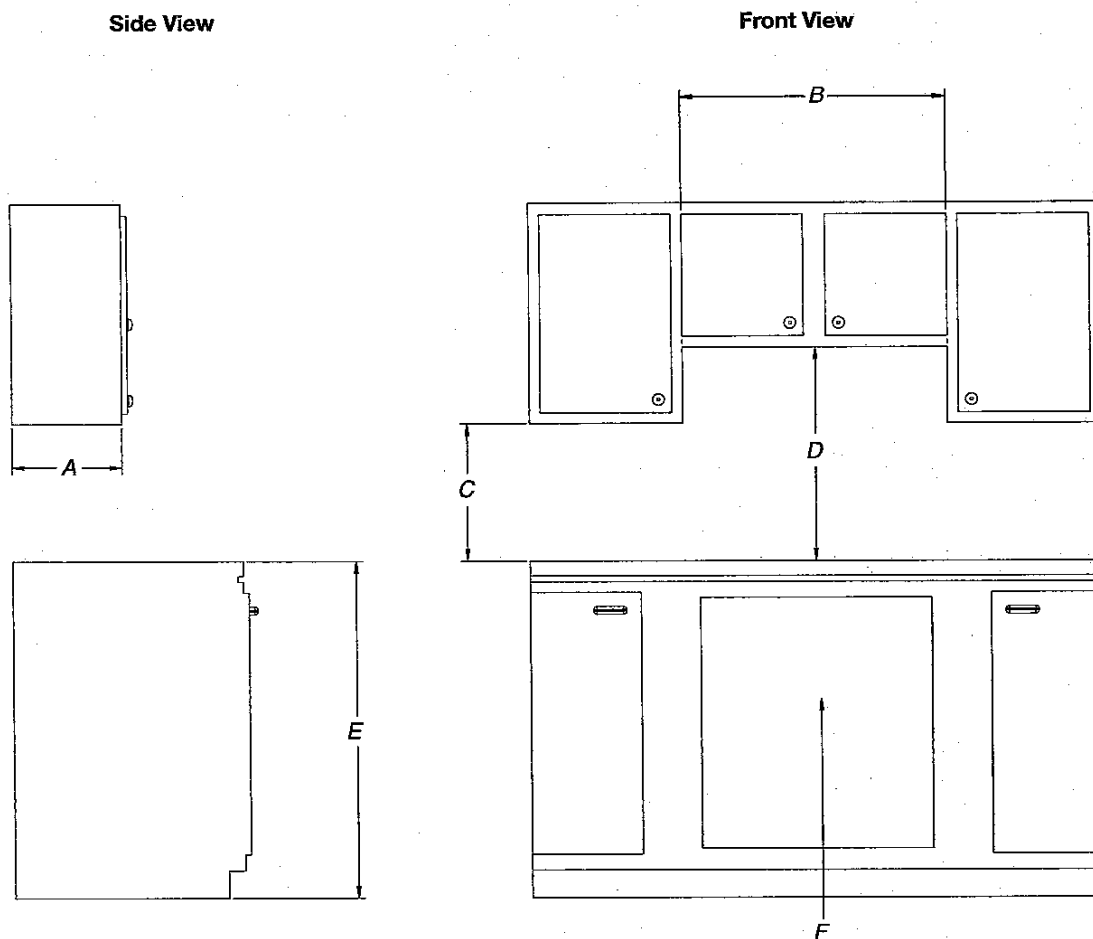

- A. 13" (33.0 cm) recommended upper cabinet depth.
- B. 30" (76.2 cm) for 30" models; 36" (91.4 cm) for 36" models.
- C. 18" (45.7 cm) minimum clearance from upper cabinet to countertop within minimum horizontal clearances to cooktop.
- D. 30" (76.2 cm) minimum clearance between top of cooktop platform and bottom of uncovered wood or metal cabinet.
24" [61 cm] minimum clearance if bottom of wood or metal cabinet is covered by not less than 1/4" [0.6 cm] flame retardant millboard covered with not less than No. 28 MSG sheet steel, 0.015" [0.04 cm] stainless steel, or 0.024" [0.06 cm] aluminum or 0.020" [0.05 cm] copper.
- E. 36" (91.4 cm) top of countertop to floor.
- F. Gas line opening - Wall: anywhere 5" (12.7 cm) below underside of countertop. Cabinet floor: anywhere within 6" (15.2 cm) of rear wall is recommended.

Cutout Dimensions - Top View

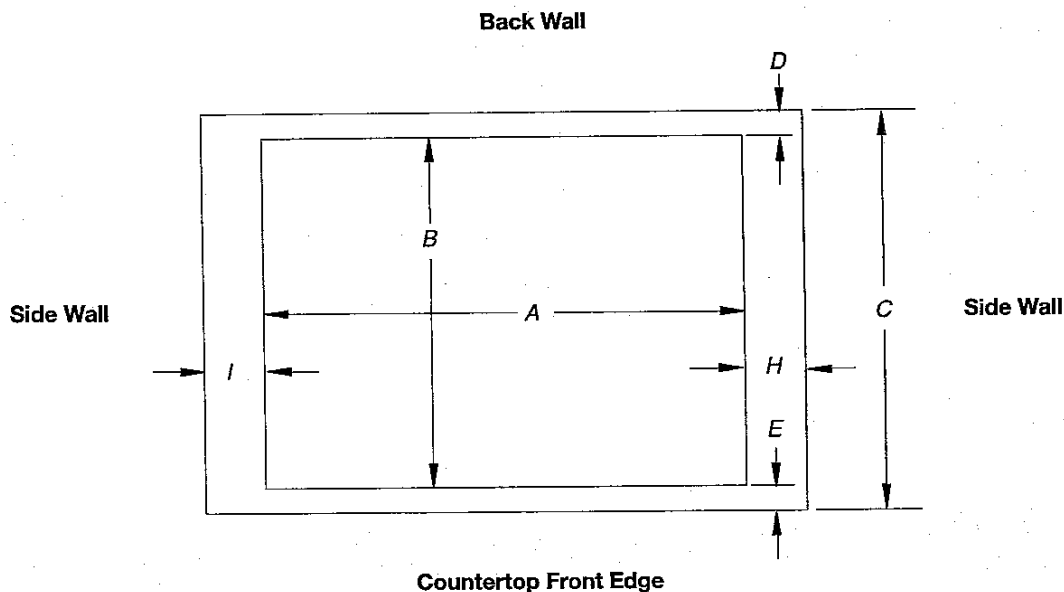

Cutout (Product Opening) Dimensions						
30" (76.2 cm) Models						
Models	A			B		
	Min	Recommended	Max	Min	Recommended	Max
KCGS550 and KCGS950	28 1/2" (72.4 cm)	28 7/8" (73.4 cm)	29 5/8" (74.3 cm)	19 1/2" (49.5 cm)	19 13/16" (50.2 cm)	20" (50.8 cm)
All Other 30" (76.2 cm) Models	28 1/2" (72.4 cm)	28 7/8" (73.4 cm)	29 5/8" (74.3 cm)	19" (48.3 cm)	19 1/2" (49.5 cm)	20" (50.8 cm)
36" (91.4 cm) Models						
KCGS556 and KCGS956	34 7/8" (88.4 cm)	35 3/8" (89.4 cm)	35 5/8" (90.3 cm)	19 1/2" (49.5 cm)	19 13/16" (50.2 cm)	20" (50.8 cm)
All Other 36" (91.4 cm) Models	33 7/8" (86.0 cm)	34 3/8" (87.0 cm)	35 1/4" (89.5 cm)	19" (48.3 cm)	19 1/2" (49.5 cm)	20" (50.8 cm)

Side Walls (Combustible Surfaces)	
Models	H and I
KCGS5 and KCGS9	H and I added together must be at least 48" (122.0 cm), with each side individually being at least 8" (20.3 cm).
KCGS350, KCGS356, MGC9536, WCG97US0, WCG97US6	H and I added together must be at least 48" (122.0 cm), with each side individually being at least 12" (30.5 cm).
All Other Models	Both have to be 8" (20.3 cm) or more.

Back Wall and Countertop Front Dimensions			
Models	C	D	E
KCGS550 and KCGS950	25" (63.5 cm)	2 7/8" (7.3 cm)	2 3/4" (6.9 cm)
All Other Models			3 1/8" (7.9 cm)

NOTES: After making the countertop cutout, some installations may require notching down the base cabinet side walls to clear the cooktop base. To avoid this modification, use a base cabinet with sidewalls wider than the cutout.

If cabinet has a drawer, a 4" (10.2 cm) depth clearance from the countertop to the top of the drawer (or other obstruction) in base cabinet is required. The drawer depth may need to be shortened to avoid interfering with the regulator.

IMPORTANT: If a built-in wall oven is to be installed below this cooktop, the grounded outlet and gas supply piping must be located in an adjacent cabinet.

This cooktop and its gas and electrical supply sources must be installed before the undercounter built-in wall oven is installed.

Electrical Requirements

⚠ WARNING



Electrical Shock Hazard

Plug into a grounded 3 prong outlet.

Do not remove ground prong.

Do not use an adapter.

Do not use an extension cord.

Failure to follow these instructions can result in death, fire, or electrical shock.

IMPORTANT: The cooktop must be electrically grounded in accordance with local codes and ordinances, or in the absence of local codes, with the National Electrical Code, ANSI/NFPA 70 or Canadian Electrical Code, CSA C22.1.

If codes permit and a separate ground wire is used, it is recommended that a qualified electrical installer determine that the ground path is adequate.

A copy of the above code standards can be obtained from:

National Fire Protection Association
One Batterymarch Park
Quincy, MA 02269

CSA International
8501 East Pleasant Valley Road
Cleveland, Ohio 44131-5575

- A 120 volt, 60 Hz, AC only, 15-amp, fused electrical circuit is required. A time-delay fuse or circuit breaker is also recommended. It is recommended that a separate circuit serving only this cooktop be provided.
- Electronic ignition systems operate within wide voltage limits, but proper grounding and polarity are necessary. Check that the outlet provides 120-volt power and is correctly grounded.
- The wiring diagrams are provided with this cooktop. See "Wiring Diagrams" on a separate sheet. The wiring diagrams are located on the left underside of the cooktop base.

Gas Supply Requirements

⚠ WARNING



Explosion Hazard

Use a new CSA International approved gas supply line.

Install a shut-off valve.

Securely tighten all gas connections.

If connected to LP, have a qualified person make sure gas pressure does not exceed 14" (36 cm) water column.

Examples of a qualified person include:

licensed heating personnel,
authorized gas company personnel, and
authorized service personnel.

Failure to do so can result in death, explosion, or fire.

Observe all governing codes and ordinances.

IMPORTANT: This installation must conform with all local codes and ordinances. In the absence of local codes, installation must conform with American National Standard, National Fuel Gas Code ANSI Z223.1 - latest edition or CAN/CGA B149 - latest edition.

IMPORTANT: Leak testing of the cooktop must be conducted according to the manufacturer's instructions.

Type of Gas

Natural Gas:

- This cooktop is factory set for use with Natural gas. If converting to LP gas, see the "LP Gas Conversion" instructions provided in the package containing literature. The model/serial rating plate located on the underside of the cooktop base has information on the types of gas that can be used. If the types of gas listed do not include the type of gas available, check with the local gas supplier.

LP Gas Conversion:

Conversion must be done by a qualified service technician.

No attempt shall be made to convert the cooktop from the gas specified on the model/serial rating plate for use with a different gas without consulting the serving gas supplier. See the Gas Conversion instructions provided in the package containing literature.