

CARPET

Inv.728	1 - SECOND FLOOR: INSTALL UPGRADED UNDERPAD (12mm SUPERPAD)THROUGHOUT SECOND FLOOR. IN ALL BEDROOMS AND UPPER HALL.
Line9848	Note:
8Aug16 / 31Aug16	

CENTRAL VAC AND WIRING

Inv.443	1 - BREAKFAST AREA: INSTALL ROUGH-IN FOR EXTRA SECURITY KEY PAD BY SLIDING DOORS IN BREAKFAST AREA
Line6438	Note:
20Apr16 / 2Jun16	

ELECTRICAL

Inv.443	1 - BASEMENT: INSTALL 200 AMP ELECTRICAL SERVICE
Line6440	Note:
20Apr16 / 2Jun16	
Inv.443	1 - TELEPHONE AND CABLE ROUGH-IN LOCATIONS
Line6437	Note:
20Apr16 / 2Jun16	
Inv.443	1 - KITCHEN: INSTALL 110V WALL RECEPTACLE ON DEDICATED CIRCUIT - FOR MICROWAVE - MICROWAVE NOT INCLUDED, ABOVE STOVE
Line6439	Note:
20Apr16 / 2Jun16	

EXTERIOR COLOURS

Inv.423	1 - EXTERIOR COLOUR PACKAGE 1
Line5196	Note:
13Apr16 / 20Apr16	

FRAMING

Inv.443	1 - GARAGE: INSTALL MANDOR - GARAGE TO HOUSE- AS PER PLAN AND GRADE PERMITING
Line6441	Note:
20Apr16 / 2Jun16	

GARAGE DOORS

Inv.443	1 - GARAGE: INSTALL DIGITAL ENTRY KEYPAD
Line6450	Note:
20Apr16 / 2Jun16	
Inv.443	2 - GARAGE DOOR OPENER - WITH 1 REMOTE- PRICE IS PER DOOR
Line6449	Note:
20Apr16 / 2Jun16	

HARDWOOD

Inv.728	1 - MAIN FLOOR: INSTALL 1ST UPGRADE HARDWOOD, PREVERCO, RED OAK SOLID FLEX IN CAPPUCCINO.
	TO GO IN FAMILY ROOM, DINING ROOM, MAIN HALL AND UPPER LANDING
Line9847	Note:
8Aug16 / 31Aug16	

KITCHEN AND BATH CABINETRY

Brampton Encore - 44 - 1 - 38-1 Elev.A BIZET

Inv.728	1 - KITCHEN: INSTALL UPPER CORNER DIAGONAL (100cm). SEE SKETCH
Line9852	Note:
8Aug16 / 31Aug16	
Inv.728	1 - KITCHEN: INSTALL BASE CORNER FOLDING DOOR. (NO LAZY SUSAN) SEE SKETCH
Line9853	Note:
8Aug16 / 31Aug16	
Inv.728	1 - KITCHEN: INSTALL OPTIONAL FLUSH BREAKFAST BAR ON ISLAND (STD. GRANITE)
Line9854	Note:
8Aug16 / 31Aug16	

MISC.

Inv.423	1 - Purchaser acknowledges that purchases are final and subject to head office approval. Approval will be based on construction status of the home.
Line5178	Note:
13Apr16 / 20Apr16	
Inv.423	1 - BONUS DECOR DOLLARS- \$10 000.00 DECOR INVOICE TOTAL - (-\$3 463.45) REMAINING DECOR DOLLARS- \$ 6 536.55
Line5179	Note:
13Apr16 / 20Apr16	
Inv.443	1 - Purchaser has attended a Structural appointment at the Decor Centre & has DECLINED any additional upgrades and accepts and acknowledges that there will be no further structural changes/additions/deletions to be made upon signing on June 2, 2016
Line6446	Note:
20Apr16 / 2Jun16	
Inv.443	1 - BONUS PACKAGE: \$5085.00 (INCLUDING TAXES) WORTH OF UPGRADES FROM GOLD PARK HOMES DÉCOR CENTRE IS BEING APPLIED TOWARD THE STRUCTURAL APPOINTMENT. PURCHASER HAS A REMAINING AMOUNT OF \$1451.55 (INCLUDING TAXES) TO BE USED TOWARD THE COLOUR APPOINTMENT
Line6445	Note:
20Apr16 / 2Jun16	
Inv.443	1 - Purchasers are aware & accepts that ANY changes made to upgrades after signing this Purchasers Extra Form are subject to a minimum administration fee of \$500. PLUS a 10% holdback fee
Line6447	Note:
20Apr16 / 2Jun16	
Inv.728	1 - BONUS PACKAGE: \$1451.55 (INCLUDING TAXES) WORTH OF UPGRADES FROM GOLD PARK HOMES DÉCOR CENTRE IS BEING APPLIED TOWARD THE COLOUR APPOINTMENT.
Line9850	Note:
8Aug16 / 31Aug16	
Inv.728	1 - Purchaser has attended a COLOUR appointment at the Decor Centre & has DECLINED any additional upgrades and accepts and acknowledges that there will be no further structural changes/additions/deletions to be made upon signing on August 8, 2016
Line9851	Note:
8Aug16 / 31Aug16	

PAINTING

Inv.728	1 - STAIRS: STAIN STAIRS TO CAPPUCCINO
Line9849	Note: STAIRS TO BASEMENT ARE PAINT-GRADE
8Aug16 / 31Aug16	

PLUMBING

Brampton Encore - 44 - 1 - 38-1 Elev.A BIZET

Inv.423	1 - ROUGH-IN - 3PC BASEMENT ROUGH-IN
Line5177	Note:
13Apr16 / 20Apr16	
Inv.443	1 - KITCHEN: INSTALL ROUGH-IN - WATERLINE FOR FRIDGE
Line6448	Note:
20Apr16 / 2Jun16	

WINDOWS - BASEMENT

Inv.423	2 - BASEMENT WINDOWS - UPGRADE EXISTING BASEMENT WINDOW TO 30 INCH X 24 INCH - MAY REQUIRE INSTALLATION OF WINDOW WELL
Line5175	Note:
13Apr16 / 20Apr16	
Inv.423	1 - BASEMENT WINDOWS - UPGRADE EXISTING BASEMENT WINDOW TO 53 INCH X 16 INCH EGRESS
Line5176	Note:
13Apr16 / 20Apr16	

Scheduled Closing Date: Friday, October 09, 2015

Purchasers: Jocelyn Erro Tite & Noble Nevin Tite

Property: 44 of Plan -

Telephone Res. / Bus: (416) 268-9770

Project: Fieldwalk Investments Inc.

Decor Advisor: Terri Parisani

Model and Elevation: 38-1 Elev.A BIZET

Layout Changes: ☐ Yes ☒ No Sketch Attached: ☒ Yes ☐ No Exterior Colour Scheme:

1. Cabinetry

	Style and Colour	Counter	Hardware
Kitchen / Breakfast	Siena(oak)Antiq.brown	Std. Crema Caramel, std. edge C-20	CSI-6
Laundry Room	None	None	None
Powder Room	None	None	None
Master Ensuite Bathroom	Carrara(PVC),Van.Stix	6697-46 Argento Romano	CSI-22
Second Ensuite Bathroom (If Applicable)	Toscana(PVC),Antiq.W	1877K-52, Autumn Carnival	CSI-20
Dishwasher Cabinet	N/A		

Comment

2. Floor Tile

	Selection	Grout	Threshold
Entrance Vestibule	Serpentine Krem, 13 x 13	N/A	N/A
Main Hall	Serpentine Krem, 13 x 13	N/A	N/A
Kitchen / Breakfast	Serpentine Krem, 13 x 13	N/A	N/A
Laundry Room	Serpentine Beyaz, 13 x 13	N/A	N/A
Powder Room	Serpentine Krem, 13 x 13	N/A	N/A
Mud Room	Serpentine Krem, 13 x 13	N/A	N/A
Master Ensuite Bathroom	Reflex, 13 x 13, Olive	N/A	N/A
Second Ensuite Bathroom (If Applicable)	New Reeds, 13 x 13, Silver	N/A	N/A
Lower Landing (If Applicable)		N/A	N/A

Comment

3. Wall Tile

	Selection	Listello/Inserts	Describe
		<input type="radio"/> Yes <input type="radio"/> No	
Master Ensuite Bathroom			
Tub Deck	Reflection 8 x 10, Olive	<input type="radio"/> Yes <input checked="" type="radio"/> No	N/A
Shower Stall	Reflection 8 x 10, Olive	<input type="radio"/> Yes <input checked="" type="radio"/> No	N/A
Bathroom Walls	Reflection 8 x 10, Olive	<input type="radio"/> Yes <input checked="" type="radio"/> No	N/A
Second Ensuite Bathroom (If Applicable)	New Reeds, 8 x 10, Silver	<input type="radio"/> Yes <input checked="" type="radio"/> No	N/A
		<input type="radio"/> Yes <input type="radio"/> No	

Kitchen Backsplash

☐ Yes ☒ No

Backsplash Behind Fridge

None

Comment

Scheduled Closing Date: Friday, October 09, 2015

Purchasers: Jocelyn Erro Tite & Noble Nevin Tite

Property: 44 of Plan -

Telephone Res. / Bus: (416) 268-9770

Project: Fieldwalk Investments Inc.

Decor Advisor: Terri Parisani

Model and Elevation: 38-1 Elev.A BIZET

4. Plumbing Fixtures

<input type="text"/>	Second Ensuite	<input type="text" value="Std"/>	Powder Room	<input type="text" value="Std"/>
Master Ensuite Bathroom	<input type="text" value="Std"/>	Other Room - Specify	<input type="text"/>	Other Washroom
Comment	<input type="text"/>			

5. Hardwood Flooring

	Type and Stain		Type and Stain
Main Hall	<input type="text" value="1st Red oak,Solid Flex,Cappuccin"/>	Upper Landing	<input type="text" value="1st Red oak,Solid Flex,Cappuccin"/>
Kitchen / Breakfast	<input type="text" value="N/A"/>	Upper Hall	<input type="text" value="N/A"/>
Living Room	<input type="text" value="N/A"/>	Master Bedroom	<input type="text" value="N/A"/>
Dining Room	<input type="text" value="1st Red oak,Solid Flex,Cappuccin"/>	Bedroom #2	<input type="text" value="N/A"/>
Family Room	<input type="text" value="1st Red oak,Solid Flex,Cappuccin"/>	Bedroom #3	<input type="text" value="N/A"/>
Den/Library	<input type="text" value="N/A"/>	Bedroom #4	<input type="text" value="N/A"/>
Entrance Vestibule	<input type="text" value="N/A"/>	Bedroom #5	<input type="text" value="N/A"/>
Lower Landing (If Applicable)	<input type="text" value="N/A"/>	Other Room - Specify	<input type="text"/>

Comment

6. Carpeting

	Upgrade	Description
Main Hall	<input type="checkbox"/>	<input type="text" value="N/A"/>
Living Room	<input type="checkbox"/>	<input type="text" value="N/A"/>
Dining Room	<input type="checkbox"/>	<input type="text" value="N/A"/>
Family Room	<input type="checkbox"/>	<input type="text" value="N/A"/>
Den/Library	<input type="checkbox"/>	<input type="text" value="N/A"/>
Upper Hall	<input type="checkbox"/>	<input type="text" value="TXP 140, Colour: T-18"/>
Master Bedroom	<input type="checkbox"/>	<input type="text" value="TXP 140, Colour: T-18"/>
Bedroom #2	<input type="checkbox"/>	<input type="text" value="TXP 140, Colour: T-18"/>
Bedroom #3	<input type="checkbox"/>	<input type="text" value="TXP 140, Colour: T-18"/>
Bedroom #4	<input type="checkbox"/>	<input type="text" value="TXP 140, Colour: T-18"/>
Bedroom #5	<input type="checkbox"/>	<input type="text" value="N/A"/>
<input type="text"/>	<input type="checkbox"/>	<input type="text"/>
Upper Landing (If Applicable)	<input type="checkbox"/>	<input type="text" value="N/A"/>
Lower Landing (If Applicable)	<input type="checkbox"/>	<input type="text"/>

Upgrade Underpad	Type	Area
	<input type="text" value="*12mm Superpad"/>	<input type="text" value="Upper Hall, Bed 2,3,4"/>
Carpet on Stairs	Capped	Runner - *Upgrade
	<input type="text" value="N/A"/>	<input type="text" value="N/A"/>

Comment

Purchasers: Jocelyn Erro Tite & Noble Nevin Tite

Property: 44 of Plan -

Telephone Res. / Bus: (416) 268-9770

Project: Fieldwalk Investments Inc.

Decor Advisor: Terri Parisani

Model and Elevation: 38-1 Elev.A BIZET

7. Fireplace

	Living Room			Family Room			Other Room - Specify		
	Purchased	As Per Plan	N/A	Purchased	As Per Plan	N/A	Purchased	As Per Plan	N/A
Fireplace Type	<input type="radio"/>	<input type="radio"/>	<input checked="" type="radio"/>	<input type="radio"/>	<input checked="" type="radio"/>	<input type="radio"/>	<input type="radio"/>	<input type="radio"/>	<input checked="" type="radio"/>
Mantle Type				NF-20					
Colour / Stain				Standard					
Surround				White Paint-Grade					
Hearth				Travertino Classico					
Comment				N/A					

8. Trim Carpentry

Interior Doors	Classique	Front Door Glass Inserts	N/A	Door Handles	Standard
Interior Trim	Standard				
Comment					

9. Plaster Mouldings and Medallions

Entrance Vestibule	N/A	N/A	Kitchen/Breakfast	N/A	N/A
Main Hall	N/A	N/A	Den/Library	N/A	N/A
Living Room	N/A	N/A	Lower Landing	N/A	N/A
Dining Room	N/A	N/A	Other Room - Specify		
Family Room	N/A	N/A			
Comment					

10. Railings and Spindles

Railing Package	Standard		Spindle Colour	*Cappuccino
Railing Colour	*Cappuccino		Treads	*Cappuccino
Stringer / Riser	*Cappuccino		Oak Stairs	<input checked="" type="radio"/> Yes <input type="radio"/> No
Comment				

11. Wall Paint

Main & Upper Hall	Warm Grey	Master Bedroom	Warm Grey
Living Room		Bedroom #2	Warm Grey
Dining Room	Warm Grey	Bedroom #3	Warm Grey
Kitchen / Breakfast	Warm Grey	Bedroom #4	Warm Grey
Family Room	Warm Grey	Bedroom #5	
Powder Room	Warm Grey	Master Ensuite	Warm Grey
Laundry Room	Warm Grey		
Den/Library		Second Ensuite	Warm Grey
Trim Paint	White		
Comment	Smooth Ceilings First Floor		

Scheduled Closing Date: Friday, October 09, 2015

Purchasers: Jocelyn Erro Tite & Noble Nevin Tite

Property: 44 of Plan -

Telephone Res. / Bus: (416) 268-9770

Project: Fieldwalk Investments Inc.

Decor Advisor: Terri Parisani

Model and Elevation: 38-1 Elev.A BIZET

12. Electrical

Plugs and Switches ☒ White ☐ Ivory
Hood Fan ☒ White ☐ Ivory N/A
Appliances **Built in Cooktop** ☐ Yes ☒ No **Built in Oven** ☐ Yes ☒ No **Gas Stove** ☐ Yes ☒ No **Microwave** ☒ Yes ☐ No
Above Kitchen Cabinet Light ☐ Yes ☒ No
Below Kitchen Cabinet Light ☐ Yes ☒ No

Comment

Hood Fan: Stainless

13. Heating and Air Conditioning

Air Conditioning NO **Gas Provisions Stove** NO
Gas Provisions Dryer NO **Gas Provisions Barbecue** STD

Comment

Gas Barbecue is given standard.

14. Additional Comments

15. Disclaimers and Notes

- 1) Colours of all materials are as close as possible to builder's selection, but not necessarily identical due to variances in manufacturing.
- 2) Any extras listed above are null and void unless accompanied by a separate invoice/amendment. Said invoice must be paid in full.
- 3) The Purchaser acknowledges that after Interior Colour Selection form is signed and dated, no further changes will be permitted other than re-selection due to unavailability. _____ Purchaser's Initials
- 4) The Purchaser acknowledges reading and accepting the "Gold Park Homes Decor Centre Disclaimers" form. This document contains other miscellaneous disclaimers.

This Interior Colour Selection is final and approved by:

Signature:  Date: 08/08/16 Signature:  Date: 08/08/2016

encore
BRAMPTON

The Bizet 38' SERIES

Elevation A • 2,234 sq.ft. | Elevation B • 2,222 sq.ft.

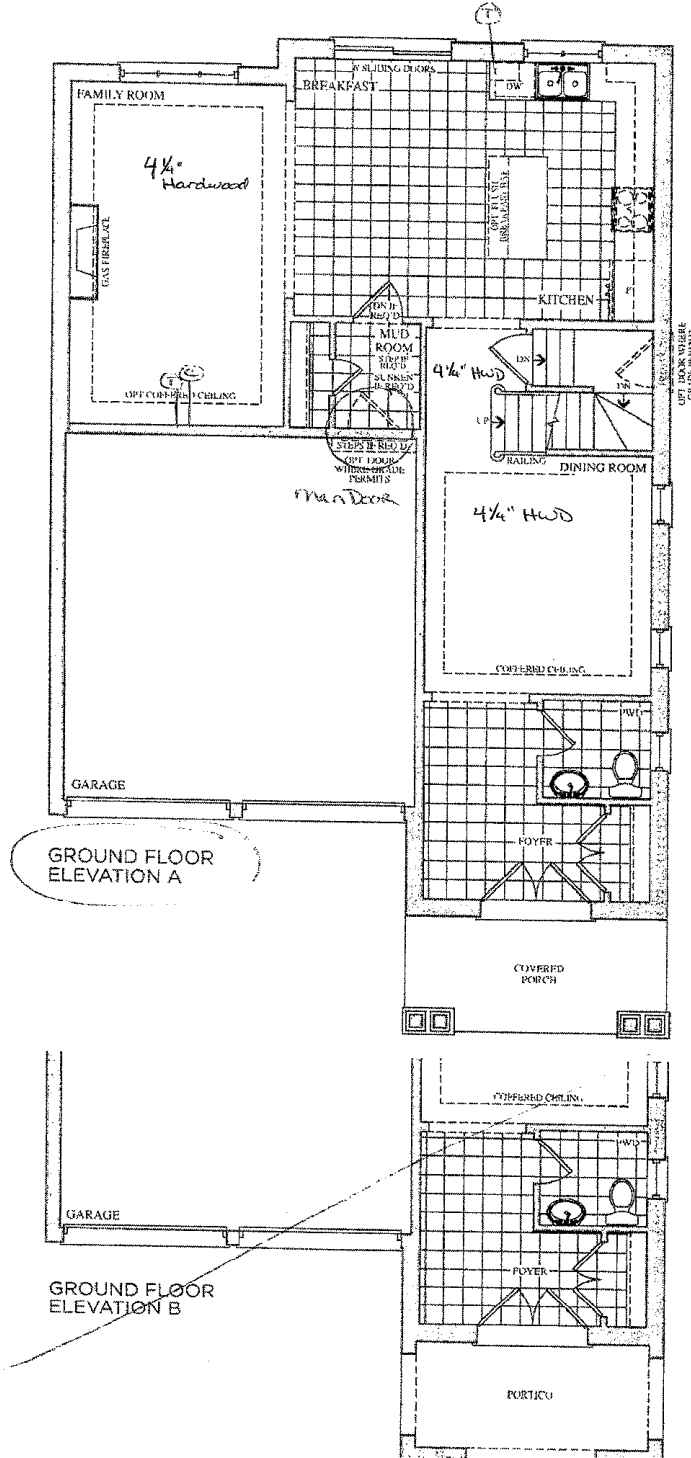

Lot 44
June 2, 16

JT NT

Lot 44
Aug. 8, 16

JT NT

Prices, figures, illustrations, sizes, features and finishes are subject to change without notice. P & O = Areas and dimensions are approximate and actual usable floor space may vary from the stated area. Layout may be reverse of the unit purchased. P & O =

GOLDPARK
HOMES

* Upgrade Underpad

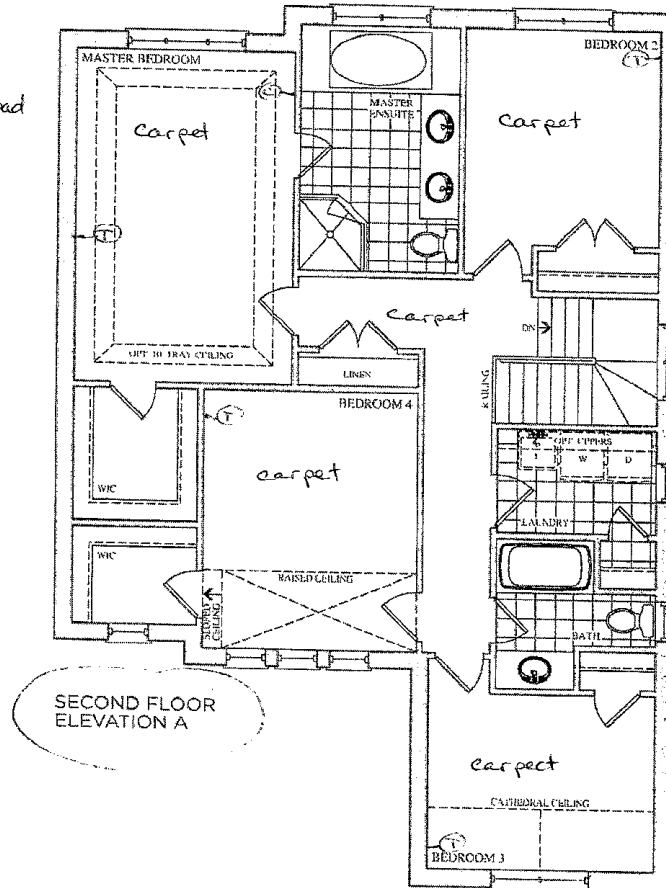

Lot 44
June 2, 16

IT NT

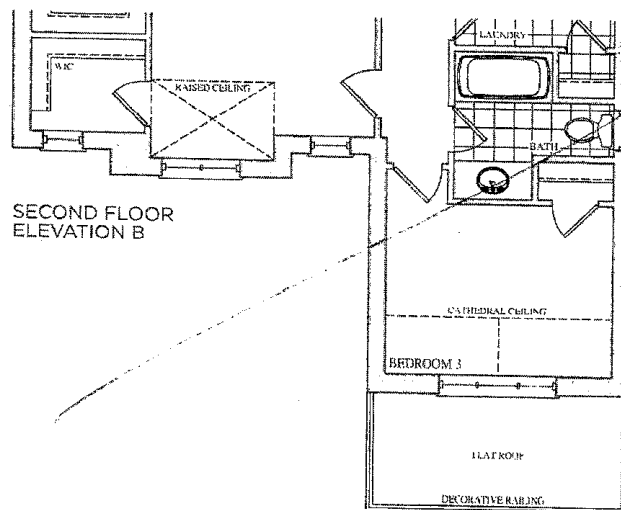

Lot 44
Aug 8, 16

IT NT

encore
BRAMPTON

The Bizet

38' SERIES

Elevation A • 2,234 sq.ft. | Elevation B • 2,222 sq.ft.

BSMNT WINDOWS

2x 30"x24"

1 x 53"x16"

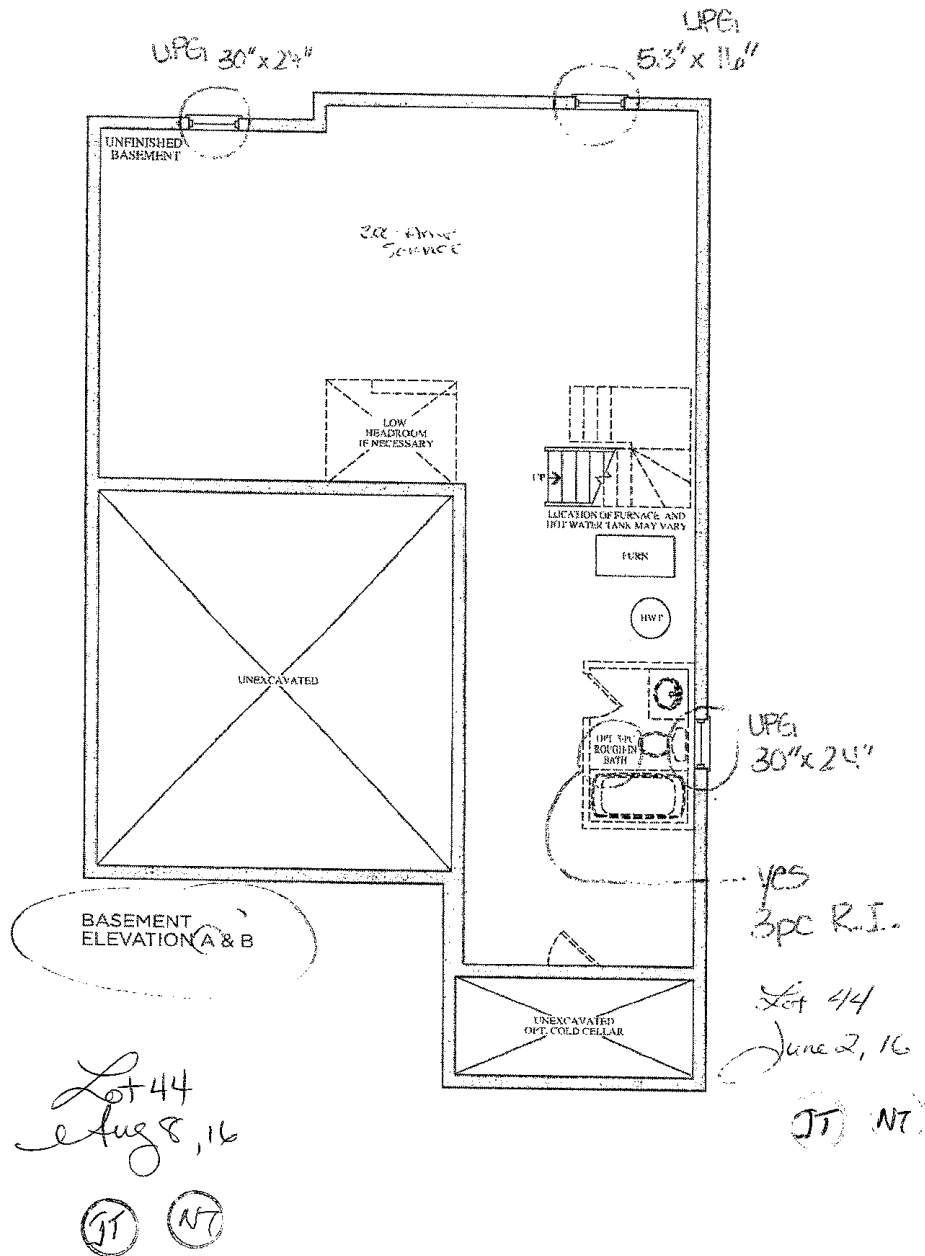

Prices, figures, illustrations, sizes, features and finishes are subject to change without notice. E & O E. Areas and dimensions are approximate and actual usable floor space may vary from the stated area. Layout may be reverse of the unit purchased. E. & O.E.

GOLDPARK
HOMES

STANDARD HARDWARE *lot 44*

STANDARD HARDWARE

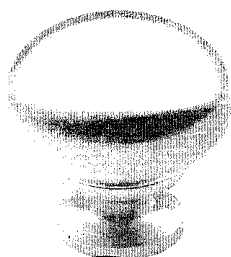

CSI-6

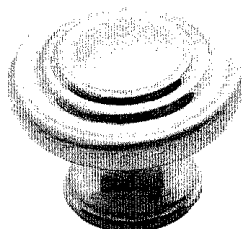
Kitchen

CSI-10

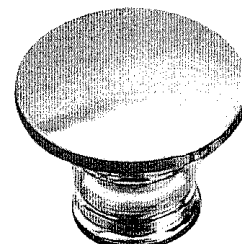

CSI-14

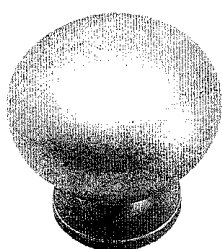

CSI-16



CSI-18

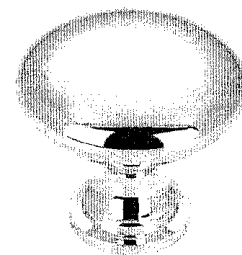

CSI-19

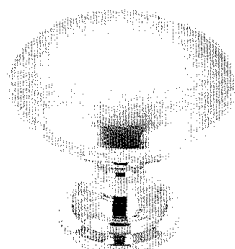

CSI-20

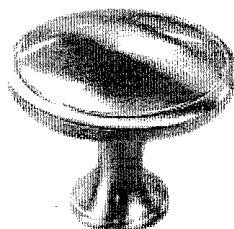
Main Bath

CSI-21

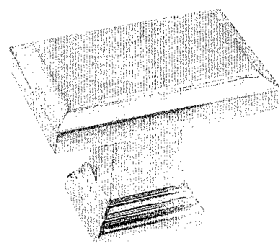

CSI-22

master Ensuite

CSI-23

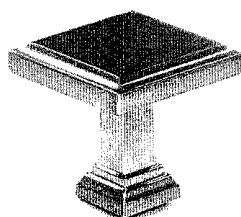

CSI-24

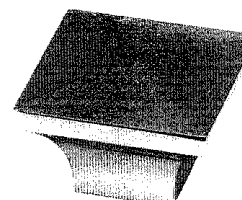

CSI-25

***NOTES:**

- IMAGES ARE FOR QUICK REFERENCE PURPOSES ONLY
- ACTUAL SIZES AND FINISHES AS PER HARDWARE
- SAMPLE BOARD PROVIDED TO DECOR CENTRE

Lot 44
Aug 8, 16
NT

CORTINA

KITCHENS INC.

70 Regina Road Woodbridge ON L4L 8L6
905-264-6464

INFORMATION - PVC DOORS

Builder... Gold Park Homes... Project... Encore... Lot #... 114...

All cabinets with PVC (Thermofoil) Doors come with melamine gables, panels and kick. The doors, crown moulding and light valance are PVC wrapped. Open shelves incorporated in design will only be available with melamine interiors. There will be variations in colour shades between the PVC parts (doors, crown and Light valance) and the melamine parts (open shelves, Gables, Panels and Kick) due to the difference in material.

Furring Panel with crown moulding to the ceiling is not available on all PVC door styles due to subtle variations in colour shades between the PVC parts (moulding) and the melamine parts (furring panel) due to the difference in material. Grain directions in wood grain pattern melamine, vary between the furring panel, crown moulding (horizontal) and the PVC doors (vertical).

Thank you for your understanding.

I am well informed of this information, and agree to the purchase of the above.

Purchaser: 

Date: 08/08/16