

Brampton Encore - 28 - 1 - 38-6 Elev.A SCARLATTI
CENTRAL VAC AND WIRING

Inv.525	1 - TELEPHONE AND CABLE ROUGH-IN LOCATION SKETCH
Line6324	Note:
30May16 / 26Sep16	
Inv.525	1 - FAMILY ROOM: INSTALL CONDUIT PIPE- FOR TELEVISION- MUST SPECIFY LOCATION AND TERMINATION POINT
Line6424	Note:
30May16 / 26Sep16	

CERAMIC

Inv.821	1 - KITCHEN: INSTALL 4TH UPGRADE FLOOR TILE IN KITCHEN
Line11434	Note:
16Sep16 / 26Sep16	
Inv.821	1 - FOYER/MAIN HALL: INSTALL 4TH UPGRADE FLOOR TILE IN FOYER AND MAIN HALL
Line11435	Note:
16Sep16 / 26Sep16	
Inv.821	1 - POWDER ROOM: INSTALL 4TH UPGRADE FLOOR TILE IN POWDER ROOM
Line11436	Note:
16Sep16 / 26Sep16	
Inv.821	1 - LAUNDRY ROOM: INSTALL 4TH UPGRADE FLOOR TILE IN LAUNDRY
Line11438	Note:
16Sep16 / 26Sep16	

ELECTRICAL

Inv.525	1 - KITCHEN: INSTALL 220V WALL RECEPTICAL ON DEDICATED CIRCUIT- FOR 4 WIRE BUILT-IN WALL OVEN - FOR FUTURE WALL OVEN/MICROWAVE UNIT. SEE SKETCH. PURCHASER IS AWARE THAT THEY MUST BUY THE APPROPRIATE CABINETRY AT THE TIME OF COLOURS
Line6327	Note:
30May16 / 26Sep16	
Inv.525	1 - KITCHEN: INSTALL 110V WALL RECEPTACLE ON DEDICATED CIRCUIT - FOR MICROWAVE - MICROWAVE NOT INCLUDED. FOR FUTURE WALL OVEN/MICROWAVE UNIT. SEE SKETCH. PURCHASER IS AWARE THAT THEY MUST BUY THE APPROPRIATE CABINETRY AT THE TIME OF COLOURS
Line6328	Note:
30May16 / 26Sep16	
Inv.525	1 - LIVING ROOM: INSTALL ADDITIONAL STANDARD FIXTURE WITH SWITCH, IN LIVING ROOM. IN ADDITION TO BUILDER'S STANDARD SWITCH CONTROLLED RECEPTICAL
Line6329	Note:
30May16 / 26Sep16	
Inv.525	1 - KITCHEN: INSTALL ROUGH - IN WALL OUTLET & SWITCH (WITH COVER PLATE) - DOES NOT INCLUDE FIXTURE - TO GO ABOVE ISLAND. SEE SKETCH
Line6339	Note:
30May16 / 26Sep16	
Inv.525	1 - KITCHEN: INSTALL ROUGH - IN CEILING OUTLET ON SAME SWITCH - DOES NOT INCLUDE FIXTURE - PUT ON SAME SWITCH AS OTHER ROUGH-IN ON KITCHEN ISLAND. SEE SKETCH
Line6340	Note:
30May16 / 26Sep16	

Brampton Encore - 28 - 1 - 38-6 Elev.A SCARLATTI

Inv.525	1 - FAMILY ROOM: INSTALL 110V WALL RECEPTACLE ON DEDICATED CIRCUIT - ABOVE FIREPLACE. SEE SKETCH
Line6419	Note:
30May16 / 26Sep16	

EXTERIOR COLOURS

Inv.525	1 - EXTERIOR COLOUR PACKAGE 6
Line11992	Note:
30May16 / 26Sep16	

FIREPLACE AND MANTLE

Inv.821	1 - FIREPLACE: FAMILY ROOM- INSTALL UPGRADE Cabinet NF100, IN LIEU OF BUILDER'S STANDARD MANTLES
Line11429	Note:
16Sep16 / 26Sep16	

FORMING

Inv.525	1 - EXTERIOR: INSTALL SIDE DOOR- HOME TO EXTERIOR- AS PER PLAN AND GRADE PERMITTING
Line6331	Note: GRADE DOES NOT PERMIT- TO BE REFUNDED TO HOMEOWNER
30May16 / 26Sep16	
Inv.821	1 - DELETE: ITEM #8 PE 525
	SIDE DOOR- HOME TO EXTERIOR- AS PER PLAN AND GRADE PERMITTING
Line11445	Note: GRADE DOES NOT PERMIT
16Sep16 / 26Sep16	

FRAMING

Inv.525	1 - GARAGE: INSTALL MANDOOR - GARAGE TO HOUSE- AS PER PLAN AND GRADE PERMITTING
Line6330	Note: GIVEN IN AGREEMENT OF PURCHASE AND SALE
30May16 / 26Sep16	
Inv.525	1 - LIVING ROOM: INSTALL OPTIONAL COFFERED CEILING - LIVING ROOM (PER ROOM AS PER PLAN). SEE SKETCH
Line6333	Note:
30May16 / 26Sep16	
Inv.525	1 - MANDOOR - GARAGE TO HOUSE- AS PER PLAN AND GRADE PERMITTING
Line11994	Note: APS BONUS PACKAGE
30May16 / 26Sep16	

GRANITE MARBLE QUARTZ

Inv.821	1 - KITCHEN: CUT-OUT FOR 36" COOKTOP IN GRANITE.
Line11419	Note:
16Sep16 / 26Sep16	
Inv.821	1 - KITCHEN: INSTALL OPTIONAL FLUSH BREAKFAST BAR
Line11420	Note:
16Sep16 / 26Sep16	
Inv.821	1 - KITCHEN: UPGRADE STANDARD GRANITE COUNTER TOP IN KITCHEN TO 4CM SURFACE EDGE (C40)
Line11421	Note:
16Sep16 / 26Sep16	

Brampton Encore - 28 - 1 - 38-6 Elev.A SCARLATTI

Inv.821	1 - KITCHEN-BREAKFAST BAR: UPGRADE STANDARD GRANITE COUNTER TOP ON FLUSH BREAKFAST BAR IN KITCHEN TO 4CM SURFACE EDGE (C40)
Line11422	Note:
16Sep16 / 26Sep16	
Inv.821	1 - KITCHEN: SINK ACCESSORY:
Line11425	INSTALL OPTIONAL ACCESSORY FOR BLANCO SINK: GRID #406454 (X1)
16Sep16 / 26Sep16	Note:

HARDWOOD

Inv.821	1 - FAMILY ROOM: INSTALL 4 1/4" PROVERCO, ASH IN KOMODO BRUSHED, IN LIEU OF BUILDER'S STANDARD HARDWOOD. IN FAMILY ROOM
Line11430	Note:
16Sep16 / 26Sep16	
Inv.821	1 - LIVING ROOM: INSTALL 4 1/4" PROVERCO, ASH IN KOMODO BRUSHED, IN LIEU OF BUILDER'S STANDARD HARDWOOD. IN LIVING ROOM
Line11431	Note:
16Sep16 / 26Sep16	
Inv.821	1 - DINING ROOM: INSTALL 4 1/4" PROVERCO, ASH IN KOMODO BRUSHED, IN LIEU OF BUILDER'S STANDARD HARDWOOD. IN DINING ROOM
Line11432	Note:
16Sep16 / 26Sep16	
Inv.821	1 - LANDINGS: INSTALL 4 1/4" PROVERCO, ASH IN KOMODO BRUSHED, IN LIEU OF BUILDER'S STANDARD HARDWOOD. ON LANDINGS
Line11433	Note:
16Sep16 / 26Sep16	
Inv.821	1 - UPPER HALL: INSTALL 4 1/4" PROVERCO, ASH IN KOMODO BRUSHED, IN LIEU OF BUILDER'S STANDARD CARPET. IN UPPER HALL
Line11443	Note:
16Sep16 / 26Sep16	

HVAC

Inv.525	1 - KITCHEN: INSTALL GAS LINE ROUGH - MAIN FLOOR - (2 STOREY MODELS) FOR STOVE
Line6335	Note:
30May16 / 26Sep16	

INTERIOR TRIM AND DOORS

Inv.525	4 - MAIN FLOOR: INSTALL FOUR (X4) STANDARD DOORS EXTENDED HEIGHT 96" (PRICE PER DOOR) MAIN FLOOR 3 STOREY MODELS - TO GO ON CLOSETS, POWDER ROOM, LAUNDRY
Line6336	Note:
30May16 / 26Sep16	

KITCHEN AND BATH CABINETRY

Inv.821	1 - KITCHEN:INSTALL Oak PVC 112 Built in wall oven and microwave and 36" cooktop with countertop by others 242cm. SEE SKETCH
Line11416	Note:
16Sep16 / 26Sep16	
Inv.821	1 - OAK PVC STD 185 Door overlay gable 100cm tall door
Line11414	Note:
16Sep16 / 26Sep16	

Brampton Encore - 28 - 1 - 38-6 Elev.A SCARLATTI

Inv.821	1 - KITCHEN: INSTALL Oak PVC 87 Pot and Pan Drawers 2 deep drawers and one shallow top drawer 60 70 80 90 cm wide TO UNDER COOKTOP. SEE SKETCH
Line11412	Note:
16Sep16 / 26Sep16	
Inv.821	1 - KITCHEN- DELETE UPPER CABINETS ABOVE STOVE. PURCHASER TO INSTALL FAN AFTER CLOSING
Line11997	Note:
16Sep16 / 26Sep16	
Inv.821	1 - KITCHEN: ADJUST KITCHEN BASE AND UPPERS TO ACCOMODATE A 36" COOKTOP. SEE SKETCH.
Line11418	Note:
16Sep16 / 26Sep16	
Inv.821	1 - KITCHEN: DELETE ALL HARDWARE FROM KITCHEN CABINETS, THROUGHOUT, WHERE APPLICABLE.
Line11423	Note: SEE ATTACHED DISCLAIMER
16Sep16 / 26Sep16	
Inv.821	1 - KITCHEN: INSTALL OAK PVC STD 179 59 cm deep Pantry per Foot In Lieu of Base and Upper 242cm, TO GO BESIDE NEW WALL OVEN UNIT, SEE SKETCH
Line11448	Note:
16Sep16 / 26Sep16	

MISC.

Inv.525	1 - BONUS PACKAGE: \$9622.00 (INCLUDING TAXES) WORTH OF UPGRADES FROM GOLD PARK HOMES DÉCOR CENTRE IS BEING APPLIED TOWARD THE STRUCTURAL APPOINTMENT. PURCHASER HAS A REMAINING AMOUNT OF \$734.00 (INCLUDING TAXES) TO BE USED TOWARD THE COLOUR APPOINTMENT
Line6344	Note:
30May16 / 26Sep16	
Inv.525	1 - Purchaser has attended a Structural appointment at the Decor Centre & has DECLINED any additional upgrades and accepts and acknowledges that there will be no further structural changes/additions/deletions to be made upon signing on May 30, 2016
Line6342	Note:
30May16 / 26Sep16	
Inv.525	1 - Purchasers are aware & accepts that ANY changes made to upgrades after signing this Purchasers Extra Form are subject to a minimum administration fee of \$500. PLUS a 10% holdback fee
Line6343	Note:
30May16 / 26Sep16	
Inv.821	1 - POWDER ROOM: DO NOT SUPPLY OR INSTALL TOILET PAPER HOLDER AND TOWEL BAR IN POWDER ROOM
Line11426	Note:
16Sep16 / 26Sep16	
Inv.821	1 - APPLIANCE SPECIFICATIONS: KITCHEN - Purchaser accepts & acknowledges that in order to either complete or install built-in appliances and accommodate for cook-top, all appliance specifications must be provided to the Décor Center within one (1) week
Line11439	Note:
16Sep16 / 26Sep16	
Inv.821	1 - DELETE HOODFAN & CABINETS ABOVE STOVE: KITCHEN - Purchasers request to NOT INSTALL builder's standard hood fan and standard cabinets above stove. DELETE. Do not supply, install, and/or credit. Purchasers are installing their own hood fan after closin
Line11440	Note: Purchasers accept and acknowledge that the exhaust fan duct hole may be off-centered with stove in kitchen due to purchasers installing their own hood fan after closing. The vendor is exempt
16Sep16 / 26Sep16	

Brampton Encore - 28 - 1 - 38-6 Elev.A SCARLATTI

Inv.821	1 - Purchaser has attended a Colour appointment at the Decor Centre & has DECLINED any additional upgrades and accepts and acknowledges that there will be no further structural changes/additions/deletions to be made upon signing on September 16, 2016
Line11441	Note:
16Sep16 / 26Sep16	
Inv.821	1 - Purchasers are aware & accepts that ANY changes made to upgrades after signing this Purchasers Extra Form are subject to a minimum administration fee of \$500. PLUS a 10% holdback fee
Line11442	Note:
16Sep16 / 26Sep16	
Inv.821	1 - BONUS PACKAGE: \$734.00 (INCLUDING TAXES) WORTH OF UPGRADES FROM GOLD PARK HOMES DÉCOR CENTRE IS BEING APPLIED TOWARD THE COLOUR APPOINTMENT
Line11446	Note:
16Sep16 / 26Sep16	

PAINTING

Inv.821	1 - STAIRCASE: Stain Staircases 3 Storey Model (Euroline Pickets Charged Separately)
Line11444	Note:
16Sep16 / 26Sep16	

PLUMBING

Inv.525	1 - KITCHEN: INSTALL ROUGH-IN - WATERLINE FOR FRIDGE
Line6338	Note:
30May16 / 26Sep16	
Inv.821	1 - KITCHEN: INSTALL BLANCO QUARTUS U2 UNDERMOUNT SINK, (#401247) IN LIEU OF BUILDER'S STANDARD SINK.
Line11424	Note:
16Sep16 / 26Sep16	

STAIRS AND RAILINGS

Inv.821	1 - HANDRAIL: INSTALL EUROLINE 2 Black (3 STORY MODEL)
Line11427	Note:
16Sep16 / 26Sep16	
Inv.821	1 - HANDRAIL: INSTALL V Groove Handrail (3 STORY MODEL)
Line11428	Note:
16Sep16 / 26Sep16	

WINDOWS - BASEMENT

Inv.525	2 - BASEMENT: INSTALL TWO (X2) BASEMENT WINDOWS - UPGRADE EXISTING BASEMENT WINDOW TO 30 INCH X 24 INCH - MAY REQUIRE INSTALLATION OF WINDOW WELL. SEE SKETCH
Line6334	Note: ONE BASEMENT WINDOW TO REMAIN STANDARD
30May16 / 26Sep16	

WINDOWS AND DOORS

Inv.525	1 - MAN DOOR GARAGE TO HOUSE - OPTIONAL - IF GRADE PERMITS
Line11993	Note: APS BONUS PACKAGE
30May16 / 26Sep16	

Scheduled Closing Date:

Purchaser: Unknown - 28 Unknown - 28

Property: 28 of Plan -

Telephone Res. / Bus: (905) 760-9595

Project: Fieldwalk Investments Inc.

Decor Advisor: Terri Parisani

Model and Elevation: Unknown

 Layout Changes: ☒ Yes ☐ No

 Sketch Attached: ☒ Yes ☐ No

Exterior Colour Scheme:

1. Cabinetry

	Style and Colour	Counter	Hardware
Kitchen / Breakfast	Toscana(pvc)ChocMapl	Grigio Sardo Granite **Upg.1 Edge C40	cs1-23
Laundry Room			
Powder Room			
Twin Bath	Varese(pvc) Mystic	7735-58 Portico Marble Laminate	cs1-24
Master Ensuite Bathroom	Toscana(pvc)AntiqWhite	6698-46 Paloma Polar Laminate	cs1-24
Second Ensuite Bathroom (If Applicable)	Siena Oak, Slate	6729-46 Paloma Bisque Laminate	cs1-24
Dishwasher Cabinet	N/A		

Comment

2. Floor Tile

	Selection	Grout	Threshold
Entrance Vestibule	*UPG.4, Volkas Series White Polished12x24		
Main Hall			
Kitchen / Breakfast	*UPG.4, Volkas Series White Polished12x24		
Laundry Room	*UPG.4, Volkas Series White Polished12x24		
Powder Room	*UPG.4, Volkas Series White Polished12x24		
Twin Bath	Serpentine Beyaz, 13 x 13		
Master Ensuite Bathroom	New Reeds Brown, 13 x 13		
Second Ensuite Bathroom (If Applicable)	Serpentine Krem, 13 x 13		
Lower Landing (If Applicable)			
SIDE ENTRANCE(Ground)	Serpentine Beyaz, 13 x 13		

Comment

*TILE IN KITCHEN DOES NOT INCLUDE BREAKFAST AREA

3. Wall Tile

	Selection	Listello/Inserts	Describe
Twin Bath	Serpentine Beyaz, 8 x 10	<input type="radio"/> Yes <input checked="" type="radio"/> No	
Master Ensuite Bathroom			
Tub Deck	New Reeds Brown, 8 x 10	<input type="radio"/> Yes <input checked="" type="radio"/> No	
Shower Stall	New Reeds Brown, 8 x 10	<input type="radio"/> Yes <input checked="" type="radio"/> No	
Bathroom Walls	New Reeds Brown, 8 x 10	<input type="radio"/> Yes <input checked="" type="radio"/> No	
Second Ensuite Bathroom (If Applicable)	Serpentine Krem, 8 x 10	<input type="radio"/> Yes <input checked="" type="radio"/> No	
		<input type="radio"/> Yes <input type="radio"/> No	
Kitchen Backsplash	<input type="radio"/> Yes <input checked="" type="radio"/> No	Backsplash Behind Fridge	None

Comment

Purchaser: Unknown - 28 Unknown - 28

Property: 28 of Plan -

Telephone Res. / Bus: (905) 760-9595

Project: Fieldwalk Investments Inc.

Decor Advisor: Terri Parisani

Model and Elevation: Unknown

4. Plumbing Fixtures

<input type="text"/>	Second Ensuite	<input type="text"/>	Powder Room	<input type="text"/>
Master Ensuite Bathroom	<input type="text"/>	Other Room - Specify	<input type="text"/>	Other Washroom
		<input type="text"/>		

Comment

 STANDARD PLUMBING THROUGHOUT
 *KITCHEN UNDER MOUNT SINK UPGRADED TO BLANCO QUATRUS U2 #401247

5. Hardwood Flooring

	Type and Stain		Type and Stain
Main Hall	*Upg.3 4 1/4" Ash, komodo brush	Upper Landing	*Upg.3 4 1/4" Ash, komodo brush
Kitchen / Breakfast	-	Upper Hall	*Upg.3 4 1/4" Ash, komodo brush
Living Room	*Upg.3 4 1/4" Ash, komodo brush	Master Bedroom	-
Dining Room	*Upg.3 4 1/4" Ash, komodo brush	Bedroom #2	-
Family Room	*Upg.3 4 1/4" Ash, komodo brush	Bedroom #3	-
Den/Library	-	Bedroom #4	-
Entrance Vestibule	-	Bedroom #5	-
Lower Landing (If Applicable)	*Upg.3 4 1/4" Ash, komodo brush	Other Room - Specify	*Upg.3 4 1/4" Ash, komodo brush
		BREAKFAST AREA	

Comment
6. Carpeting

	Upgrade	Description
Main Hall	<input type="checkbox"/>	-
Living Room	<input type="checkbox"/>	-
Dining Room	<input type="checkbox"/>	-
Family Room	<input type="checkbox"/>	-
Den/Library	<input type="checkbox"/>	-
Upper Hall	<input type="checkbox"/>	T-07
Master Bedroom	<input type="checkbox"/>	T-07
Bedroom #2	<input type="checkbox"/>	T-07
Bedroom #3	<input type="checkbox"/>	T-07
Bedroom #4	<input type="checkbox"/>	T-07
Bedroom #5	<input type="checkbox"/>	-
Ground floor Level	<input type="checkbox"/>	T-07
Upper Landing (If Applicable)	<input type="checkbox"/>	-
Lower Landing (If Applicable)	<input type="checkbox"/>	-

	Type	Area
Upgrade Underpad	STANDARD	
Carpet on Stairs	Capped	Runner - *Upgrade
	N/A	N/A

Comment

Purchaser: Unknown - 28 Unknown - 28

Property: 28 of Plan -

Telephone Res. / Bus: (905) 760-9595

Project: Fieldwalk Investments Inc.

Decor Advisor: Terri Parisani

Model and Elevation: Unknown

7. Fireplace

	Living Room			Family Room			Other Room - Specify		
	Purchased	As Per Plan	N/A	Purchased	As Per Plan	N/A	Purchased	As Per Plan	N/A
Fireplace Type	<input type="radio"/>	<input type="radio"/>	<input checked="" type="radio"/>	<input type="radio"/>	<input checked="" type="radio"/>	<input type="radio"/>	<input type="radio"/>	<input type="radio"/>	<input checked="" type="radio"/>
Mantle Type				*UPGRADE					
Colour / Stain				NF-100 CABINET					
Surround				WHITE PAINT-GRADE					
Hearth				NERO MARQUINA					
Comment									

8. Trim Carpentry

Interior Doors	Std, Extended	Front Door Glass Inserts	standard	Door Handles	standard
Interior Trim	standard				
Comment					

9. Plaster Mouldings and Medallions

Entrance Vestibule	N/A		Kitchen/Breakfast	N/A	
Main Hall	N/A		Den/Library	N/A	
Living Room	N/A		Lower Landing	N/A	
Dining Room	N/A		Other Room - Specify		
Family Room	N/A				
Comment					

10. Railings and Spindles

Railing Package	*EUROLINE 2, W/V-GROOVE HANDRAIL		
Railing Colour	*KOMODO	Spindle Colour	*KOMODO
Stringer / Riser	*KOMODO	Treads	*KOMODO
Comment	Oak Stairs	<input checked="" type="radio"/> Yes	<input type="radio"/> No

11. Wall Paint

Main & Upper Hall	WARM GREY	Master Bedroom	WARM GREY
Living Room	WARM GREY	Bedroom #2	WARM GREY
Dining Room	WARM GREY	Bedroom #3	WARM GREY
Kitchen / Breakfast	WARM GREY	Bedroom #4	WARM GREY
Family Room	WARM GREY	Bedroom #5	WARM GREY
Powder Room	WARM GREY	Master Ensuite	WARM GREY
Laundry Room	WARM GREY		
Den/Library	WARM GREY	Second Ensuite	WARM GREY
Trim Paint	WHITE		
Comment	Smooth Ceilings First Floor		

Scheduled Closing Date:

Purchaser: Unknown - 28 Unknown - 28

Property: 28 of Plan -

Telephone Res. / Bus: (905) 760-9595

Project: Fieldwalk Investments Inc.

Decor Advisor: Terri Parisani

Model and Elevation: Unknown

12. Electrical

Plugs and Switches ☒ White ☐ Ivory Above Kitchen Cabinet Light ☐ Yes ☐ No
Hood Fan ☐ White ☐ Ivory Below Kitchen Cabinet Light ☐ Yes ☐ No
Appliances Built in Cooktop Built in Oven Gas Stove Microwave
☒ Yes ☐ No ☒ Yes ☐ No ☒ Yes ☐ No ☒ Yes ☐ No

Comment

STANDARD HOOD FAN: STAINLESS STEEL

13. Heating and Air Conditioning

Air Conditioning Gas Provisions Stove
Gas Provisions Dryer Gas Provisions Barbecue

Comment

Purchased Gas Line for stove
Gas Line for BBQ standard

14. Additional Comments

15. Disclaimers and Notes

- Colours of all materials are as close as possible to builder's selection, but not necessarily identical due to variances in manufacturing.
- Any extras listed above are null and void unless accompanied by a separate invoice/amendment. Said invoice must be paid in full.
- The Purchaser acknowledges that after Interior Colour Selection form is signed and dated, no further changes will be permitted other than re-selection due to unavailability. _____ Purchaser's Initials
- The Purchaser acknowledges reading and accepting the "Gold Park Homes Decor Centre Disclaimers" form. This document contains other miscellaneous disclaimers.

This Interior Colour Selection is final and approved by:

Signature: Amar Badera Date: Sep 11/2016

36" Gas Cooktop

800 Series – Stainless Steel NGM8655UC

Not 28



BOSCH
Invented for life

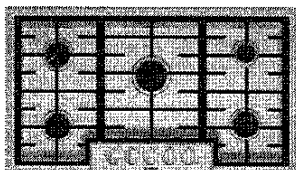

NGM8655UC

Also available in:
Black NGM8665UC

Bosch cooktops are engineered to perform, offering high heat burners for optimal cooking results.

Features & Benefits

Powerful 18,000 BTU center burner speeds cooking time.

Heavy-duty metal knobs for a premium look and feel.

Distinctive red LED light indicates burners are on.

General Properties

Knob material	Metal
Sealed burners	Yes
Grate material	Cast Iron

Element Performance

Total BTU load (NG / LP)	59,500 / 47,300
Power of front left burner (NG / LP)	12,000 / 9,100
Power of back left burner (NG / LP)	12,000 / 9,100
Power of center burner (NG / LP)	18,000 / 15,000
Power of back right burner (NG / LP)	5,500 / 5,000
Power of front right burner (NG / LP)	12,000 / 9,100

Technical Details

Watts	360 W
Circuit breaker	15 A
Volts	120 V
Frequency	60 Hz
Plug type	3 prong
Power cord length	60"
Energy source	Gas
Convertible to LP (kit required)	Yes

Dimensions & Weight

Overall appliance dimensions (HxWxD)	3 13/16" x 37" x 21 1/4"
Required cutout size (HxWxD)	3 13/16" x 34 15/16" x 19 1/8"
Minimum distance from counter front	1 7/8"
Minimum distance from rear wall	3"
Net weight	39 lbs

Accessories-Included

Included	LP conversion kit
----------	-------------------

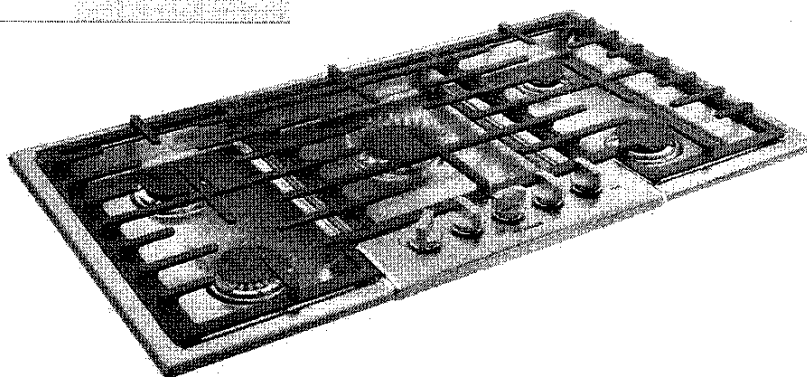

For help and assistance with Bosch accessories please call 1-800-944-2904 Mon-Fri 8am to 6pm EST

Notes: All height, width and depth dimensions are shown in inches. BSH reserves the absolute and unrestricted right to change product materials and specifications, at any time, without notice. Consult the product's installation instructions for final dimensional data and other details prior to making cutout. Applicable product warranty can be found in accompanying product literature or you may contact your account manager for further details.

Warranties: Bosch warrants that the Product is free from defects in materials and workmanship for a period of three hundred and sixty-five (365) days from the date of purchase. The foregoing timeline begins to run upon the date of purchase, and shall not be stalled, tolled, extended, or suspended, for any reason whatsoever. This Product is also warranted to be free from cosmetic defects in material and workmanship (such as scratches of stainless steel, paint/porcelain blemishes, chip, dents, or other damage) to the finish of the Product, for a period of thirty (30) days from the date of purchase or closing date for new construction. This cosmetic warranty excludes slight color variations due to inherent differences in painted and porcelain parts, as well as differences caused by kitchen lighting, product location, or other similar factors. This cosmetic warranty specifically excludes any display, floor, "As Is", or "B" stock appliances.

For more information on our entire line of products, go to www.bosch-home.ca or call 1-800-944-2904

© BSH Home Appliances Limited. All rights reserved. Bosch is a registered trademark of Robert Bosch GmbH.

09/15

36" Gas Cooktop

800 Series – Stainless Steel NGM8655UC

28



Installation Details

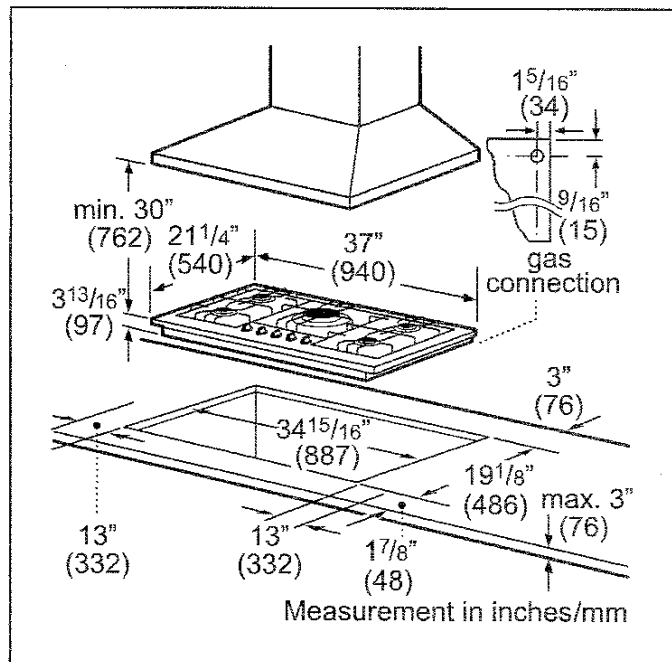

Installation above Wall Ovens

30" Built-in oven - under gas cooktop

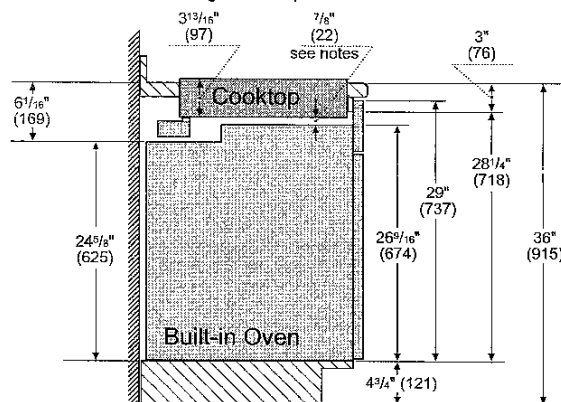

Notes:

Dimensions based on standard countertop height (36" with 4 3/4" toe kick including base plate).

The built-in oven can be installed below the gas cooktop as long as there is no contact between the bottom of the cooktop and the top of the oven.

Measurements in inches (mm)

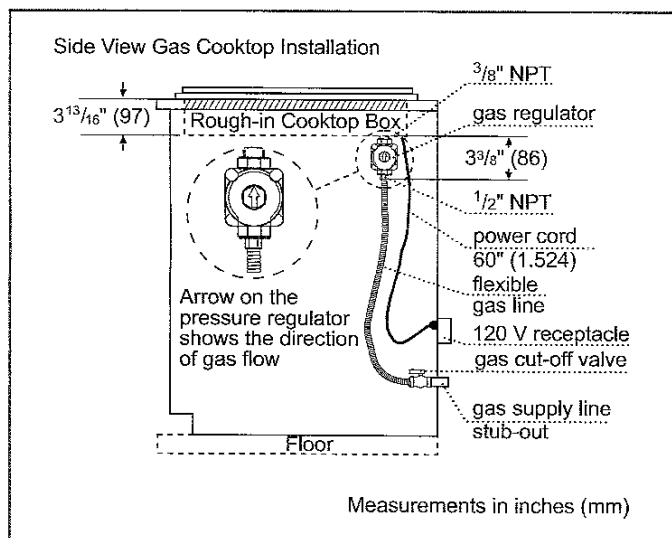

For help and assistance with Bosch accessories please call 1-800-944-2904 Mon-Fri 8am to 6pm EST

Notes: All height, width and depth dimensions are shown in inches. BSH reserves the absolute and unrestricted right to change product materials and specifications, at any time, without notice. Consult the product's installation instructions for final dimensional data and other details prior to making cutout. Applicable product warranty can be found in accompanying product literature or you may contact your account manager for further details.

Warranties: Bosch warrants that the Product is free from defects in materials and workmanship for a period of three hundred and sixty-five (365) days from the date of purchase. The foregoing timeline begins to run upon the date of purchase, and shall not be stalled, tolled, extended, or suspended, for any reason whatsoever. This Product is also warranted to be free from cosmetic defects in material and workmanship (such as scratches of stainless steel, paint/porcelain blemishes, chip, dents, or other damage) to the finish of the Product, for a period of thirty (30) days from the date of purchase or closing date for new construction. This cosmetic warranty excludes slight color variations due to inherent differences in painted and porcelain parts, as well as differences caused by kitchen lighting, product location, or other similar factors. This cosmetic warranty specifically excludes any display, floor, "As Is", or "B" stock appliances.

For more information on our entire line of products, go to www.bosch-home.ca or call 1-800-944-2904

© BSH Home Appliances Limited. All rights reserved. Bosch is a registered trademark of Robert Bosch GmbH.

09/15

Lot 28

(L)

(R)

BLANCO QUATRUS™ Undermount

BLANCO QUATRUS™ U 1 3/4

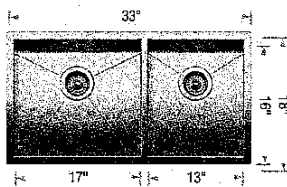

Sink Specifications

Undermount
Minimum Cabinet Size*
 36" (915 mm)
Bowl Depth
 9" (230 mm)
Cubed Weight
 56 lb. (25.4 kg)

Model N°

401244

Installed Price**

\$ 1136.20

Optional Accessories

406451	Grid (LB)	\$ 235.75
406450	Grid (SB)	\$ 211.60
406345	Ash Cutting Board	\$ 313.95
406344	Workstation	\$ 161.00
517666	CapFlow™	\$ 36.80
230694	Magnetic Caddy	\$ 112.70

BLANCO QUATRUS™ U 2

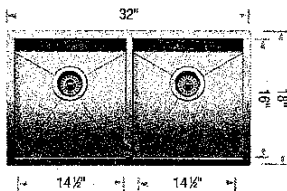

Sink Specifications

Undermount
Minimum Cabinet Size*
 36" (915 mm)
Bowl Depth
 9" (230 mm)
Cubed Weight
 55 lb. (25 kg)

Model N°

401247

Installed Price**

\$ 1021.20

Optional Accessories

406454	Grid	\$ 211.60
406345	Ash Cutting Board	\$ 313.95
406344	Workstation	\$ 161.00
517666	CapFlow™	\$ 36.80
230694	Magnetic Caddy	\$ 112.70

x1 only

BLANCO QUATRUS™ U SUPER SINGLE

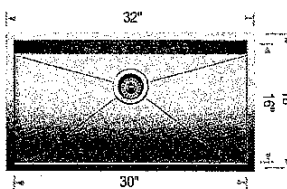

Sink Specifications

Undermount
Minimum Cabinet Size*
 36" (915 mm)
Bowl Depth
 9" (230 mm)
Cubed Weight
 55 lb. (25 kg)

Model N°

401248

Installed Price**

\$ 937.25

Optional Accessories

406347	Super Single Grid	\$ 224.25
406346	Elevated Grid	\$ 195.50
406345	Ash Cutting Board	\$ 313.95
406344	Workstation	\$ 161.00
517666	CapFlow™	\$ 36.80
230694	Magnetic Caddy	\$ 112.70

BLANCO QUATRUS™ U 1 MEDIUM

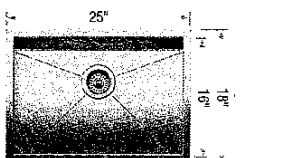

Sink Specifications

Undermount
Minimum Cabinet Size*
 27" (685 mm)
Bowl Depth
 9" (230 mm)
Cubed Weight
 43 lb. (19.5 kg)

Model N°

401246

Installed Price**

\$ 713.00

Optional Accessories

406452	Grid	\$ 259.90
406345	Ash Cutting Board	\$ 313.95
406344	Workstation	\$ 161.00
517666	CapFlow™	\$ 36.80
230694	Magnetic Caddy	\$ 112.70

CORTINA

KITCHENS INC.

70 Regina Road Woodbridge ON L4L 8L6
905-264-6464

INFORMATION - PVC DOORS

Builder: Gold Park Project: Encore Lot #: 28

All cabinets with PVC (Thermofoil) Doors come with melamine gables, panels and kick. The doors, crown moulding and light valance are PVC wrapped. Open shelves incorporated in design will only be available with melamine interiors. There will be variations in colour shades between the PVC parts (doors, crown and Light valance) and the melamine parts (open shelves, Gables, Panels and Kick) due to the difference in material.

Furring Panel with crown moulding to the ceiling is not available on all PVC door styles due to subtle variations in colour shades between the PVC parts (moulding) and the melamine parts (furring panel) due to the difference in material. Grain directions in wood grain pattern melamine, vary between the furring panel, crown moulding (horizontal) and the PVC doors (vertical).

Thank you for your understanding.

I am well informed of this information, and agree to the purchase of the above.

Purchaser: Guyana Bordin
Aman Bador

Date: SEP 16 / 2016

CORTINA

KITCHENS INC.

70 Regina Road, Woodbridge, ON L4L 8L6
Tel: (905) 264-6464 Fax: (905) 264-0664

December, 2008

POLICY MEMO FOR BUILDERS

DRILLING FOR KNOB AND HANDLE HARDWARE

Builder: Gold Park Project: Encore
Lot #: 28 Date: Sept. 16, 16

Cortina Kitchens' cabinetry doors and drawer fronts will be drilled to accept a standard knob or handle selected from Cortina's hardware boards. This drilling comes standard with the order, and is done ONLY in our shop, not on the job site.

For those not wanting Cortina's standard drilling, the following applies:

No holes to be drilled on the doors and drawer fronts should be specified in writing on the order. **If while in production, Cortina Kitchens misses this request, Cortina Kitchens and the Builder will not be held responsible to replace any or all doors and drawer fronts affected, and the customer agrees to accept the product as is.** No hardware will be supplied or credited by Cortina Kitchens. **No charge will apply for this request.**

Gagan Badera
I, Amar Badera, have read and agree to the above information.

Customer Signature:

Date:

[Signature] / Amar Badera
SEP 16/2016

CORTINA

KITCHENS INC.
70 Rugga Road, Woodbridge, Ontario L4L 8L5
Tel: 905-254-5494 Fax: 905-254-0994
www.CortinaKitchens.com

QUOTATION

Date: 06/23/16

Trade Name: Gold Park Homes

Site location: Brampton

Model: 38-B

Address:

Project: Encore

Phase:

This layout has been explained to the purchaser by Cortina Kitchens Inc. and is understood by the purchaser.

Delete
Uppers &
adjust to
36" opening

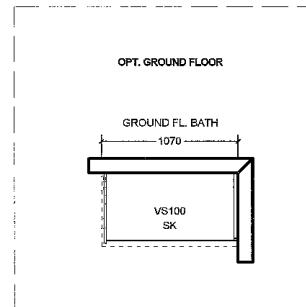
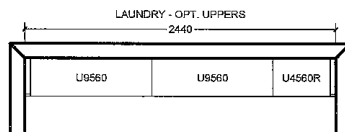
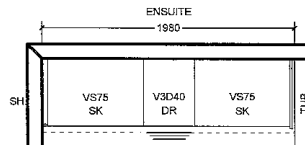
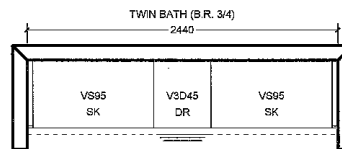
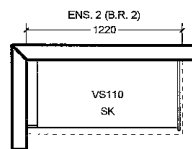
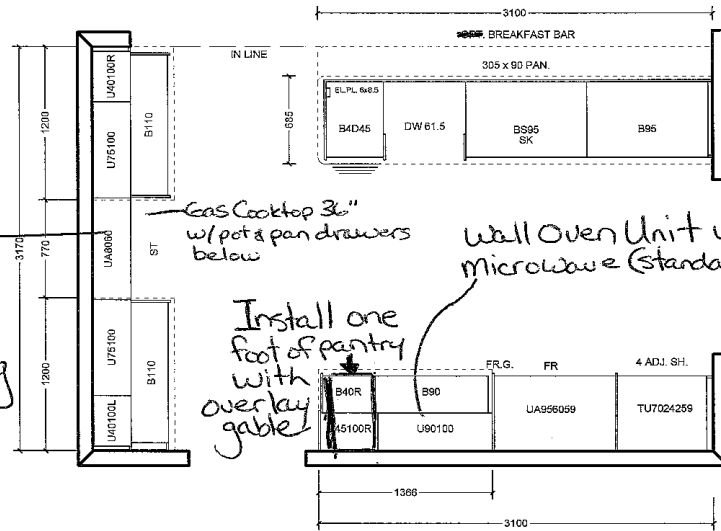

All prices subject to confirmation from head office.
This quotation is subject to the terms & conditions set out
in Cortina's Agreement of Purchase and Sale

All agreements are contingent upon strikes, accidents, and delay beyond our control.
Please provide our installer with template for sinkholes or \$150.00 will be charged for callback.

ACCEPTED DATE:

CUSTOMER SIGNATURE

SALESPERSON SIGNATURE

CORTINA HEAD OFFICE APPROVAL

ITEM A. Wood grain and colour: are characteristics of the product, we cannot guarantee that such grain and colour will always match
ITEM B. Cortina Kitchens reserves the right to alter dimensions and make technical changes without notice.

Lot 28
Sept 16, 16

AS AB

STANDARD HARDWARE *No Hardware in Kitchen,
See disclaimer

STANDARD HARDWARE

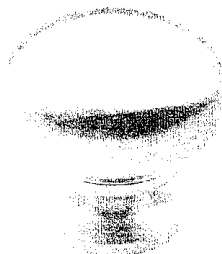

CSI-6

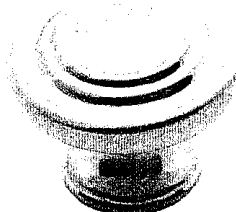

CSI-10



CSI-14



CSI-16

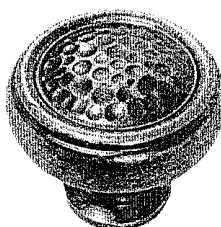

CSI-18

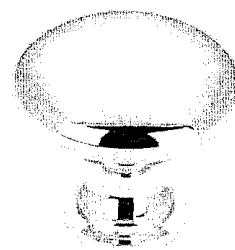

CSI-19

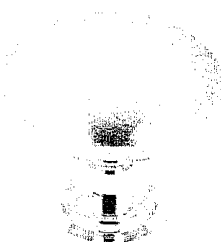

CSI-20

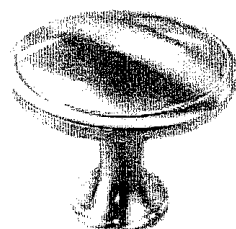

CSI-21



CSI-22

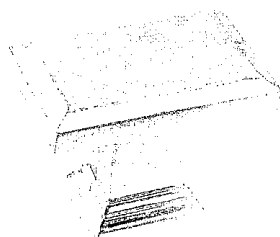

CSI-23

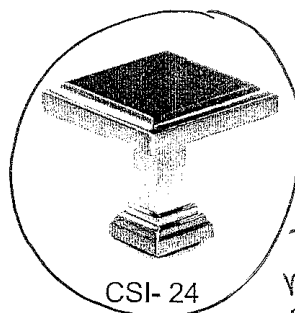

CSI-24

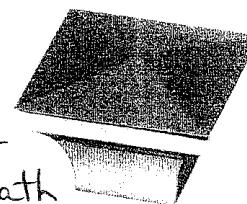

CSI-25

Powder
Twin Bath
Master Ens
Ensuite 2



***NOTES:**

- IMAGES ARE FOR QUICK REFERENCE PURPOSES ONLY
- ACTUAL SIZES AND FINISHES AS PER HARDWARE
- SAMPLE BOARD PROVIDED TO DECOR CENTRE

encore
BRAMPTON

Telephone — (T)
Cable — (C)
Electrical — (E)

**The
Scarlatti**
38' SERIES

Elevation A • 3,591 sq.ft. | Elevation B • 3,578 sq.ft.

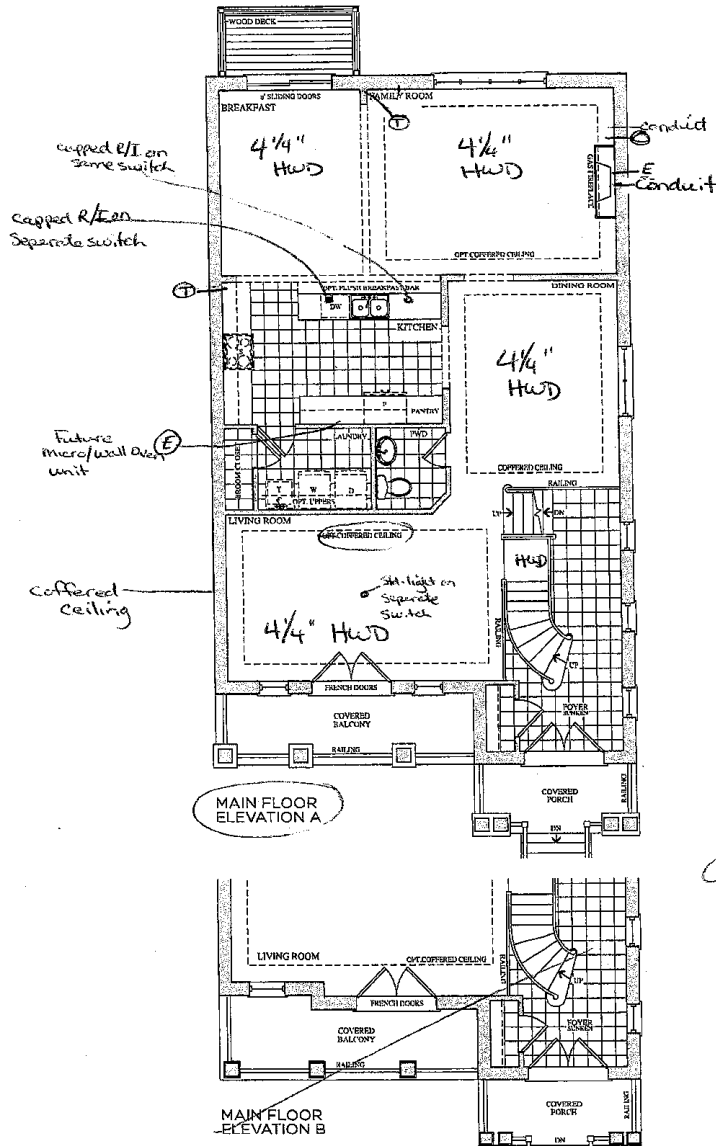

Lot 28
May 30, 16

(A) (B)

Prices, figures, illustrations, sizes, features, and finishes are subject to change without notice. E&O.E. Areas and dimensions are approximate and actual usable floor space may vary from the stated area. Layout may be reverse of the unit purchased. E. & C.E.

goldpark
HOMES

Lot 28
Sept 16, 16

(C) (A) (B)

encore
BRAMPTON

Telephone (T)
Cable (C)
Electrical (E)

**The
Scarlatti
38' SERIES**

Elevation A • 3,591 sq.ft. | Elevation B • 3,578 sq.ft.

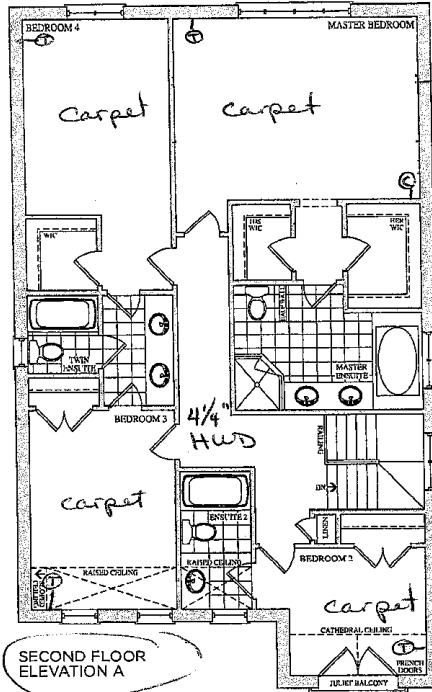

SECOND FLOOR
ELEVATION A

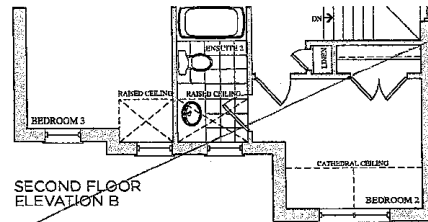

SECOND FLOOR
ELEVATION B

Lot 28
May 30, 16
(AB) (LS)

Prices, figures, illustrations, sizes, features and finishes are subject to change without notice. E&O.C. Areas and dimensions are approximate and actual usable floor space may vary from the stated area. Layout may be reverse of the unit purchased. E & O.E.

oldpark
HOME B

Lot 28
Sept 16, 16
(L1) (AB)

encore
BRAMPTON

**The
Scarlatti**
38' SERIES

Elevation A • 3,591 sq.ft. | Elevation B • 3,578 sq.ft.

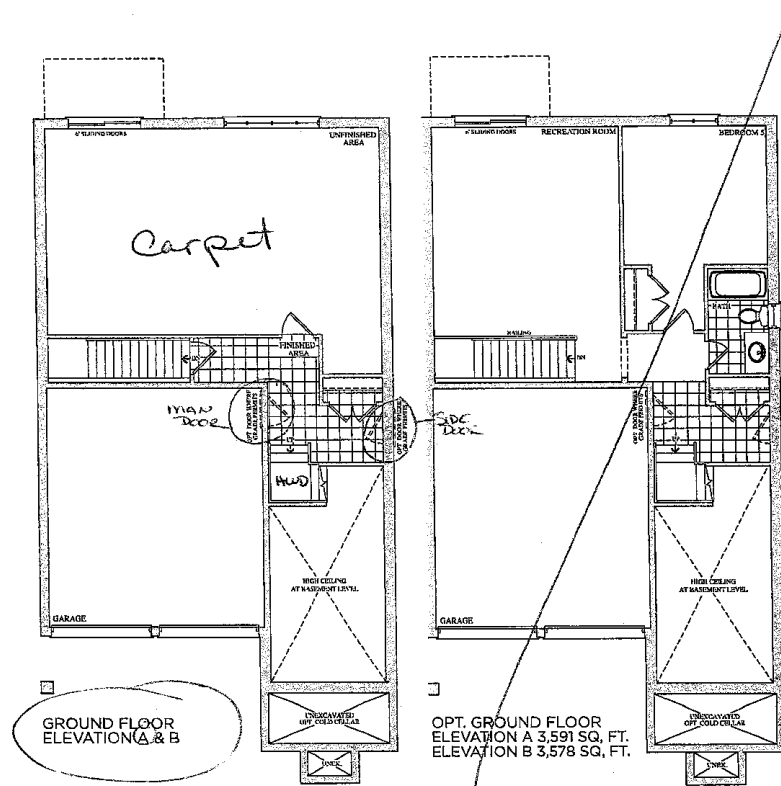

Lot 28
May 30, 116

(A) (B)

Prices, figures, illustrations, sizes, features and finishes are subject to change without notice. L&O.E. Areas and dimensions are approximate and actual usable floor space may vary from the stated area. Layout may be reverse of the one purchased. E. & O.E.

GOLDPARK
HOMES

Lot 28
Sept 16, 116

(A) (B)