

Brampton Encore - 106 - 1 - 38-5 Elev.A HANDEL
CENTRAL VAC AND WIRING

Inv.449	1 - TELEPHONE AND CABLE LOCATION SKETCH
Line5428	Note:
25Apr16 / 9Jun16	
Inv.449	1 - FAMILY ROOM: INSTALL CONDUIT PIPE- FOR TELEVISION- MUST SPECIFY LOCATION AND TERMINATION POINT. SEE SKETCH
Line5429	Note:
25Apr16 / 9Jun16	

CERAMIC

Inv.878	1 - FOYER: INSTALL Floor Upgrade 2 Foyer Vestibule Floor
Line12172	Note:
30Sep16 / 24Oct16	
Inv.878	1 - KITCHEN: INSTALL Floor Upgrade 2 Kitchen and Breakfast Floor
Line12173	Note:
30Sep16 / 24Oct16	
Inv.878	1 - POWDER ROOM: INSTALL Floor Upgrade 2 Powder Room Floor
Line12174	Note:
30Sep16 / 24Oct16	

ELECTRICAL

Inv.449	1 - FAMILY ROOM: INSTALL 110V WALL RECEPTACLE ON DEDICATED CIRCUIT - ABOVE FIREPLACE. SEE SKETCH
Line5430	Note:
25Apr16 / 9Jun16	
Inv.449	1 - KITCHEN: INSTALL 220V WALL RECEPTICAL ON DEDICATED CIRCUIT- FOR 4 WIRE BUILT-IN WALL OVEN - MUST SPECIFY LOCATION. FOR FUTURE WALL OVEN/MICROWAVE COMBO. PURCHASER IS AQWARE THAT THEY NEED TO PURCHASE APPROPRIATE CABINETRY AT TIME OF COLOUR APPOINTMENT
Line5431	Note:
25Apr16 / 9Jun16	
Inv.449	1 - KITCHEN: INSTALL 110V WALL RECEPTACLE ON DEDICATED CIRCUIT - FOR MICROWAVE - MICROWAVE NOT INCLUDED. FOR FUTURE WALL OVEN/MICROWAVE COMBO. PURCHASER IS AQWARE THAT THEY NEED TO PURCHASE APPROPRIATE CABINETRY AT TIME OF COLOUR APPOINTMENT. SEE SKETCH
Line5432	Note:
25Apr16 / 9Jun16	
Inv.449	1 - BASEMENT: INSTALL 200 AMP ELECTRICAL SERVICE IN LIEU OF STANDARD 100 AMPS
Line5433	Note:
25Apr16 / 9Jun16	
Inv.495	1 - KITCHEN: INSTALL 110V WALL RECEPTACLE ON DEDICATED CIRCUIT - FOR FUTURE WARMING DRAWER, TO GO IN A WALL OVEN/MICROWAVE/WARMING DRAWER UNIT. SEE SKETCH
Line6011	Note: PURCHASE IS AWARE THAT THEY WILL NEED TO BUY THE APROPRIATE CABINETRY AT THE TIME OF COLOURS
12May16 / 9Jun16	

EXTERIOR COLOURS

Inv.449	1 - EXTERIOR COLOUR PACKAGE 6
Line6728	Note:
25Apr16 / 9Jun16	

Brampton Encore - 106 - 1 - 38-5 Elev.A HANDEL
FORMING

Inv.449	1 - EXTERIOR: INSTALL SIDE DOOR- HOME TO EXTERIOR- AS PER PLAN AND GRADE PERMITTING
Line5434	Note:
25Apr16 / 9Jun16	
Inv.505	1 - DELETE DUE TO GRADING NOT PERMITTING:
	ITEM # 7, PE 449:
	EXTERIOR: INSTALL SIDE DOOR- HOME TO EXTERIOR- AS PER PLAN AND GRADE PERMITTING
Line8254	Note:
18May16 / 21Oct16	

FRAMING

Inv.449	1 - MANDOR - GARAGE TO HOUSE- AS PER PLAN AND GRADE PERMITTING
Line6730	Note: AS PER APS BONUS PACKAGE
25Apr16 / 9Jun16	

GRANITE MARBLE QUARTZ

Inv.878	1 - KITCHEN: INSTALL 2 CM GRP 2 Kitchen with Island
Line12175	Note:
30Sep16 / 24Oct16	
Inv.878	1 - KITCHEN: ISNTALL 2 CM GRP 2 Optional Flush BBar IN CEASARSTONE
Line12176	Note:
30Sep16 / 24Oct16	
Inv.878	1 - KITCHEN: GRANITE CUTOUT FOR COOKTOP
Line12187	Note:
30Sep16 / 24Oct16	

HARDWOOD

Inv.878	1 - DINING ROOM: INSTALL Upgrade 2 PREVERCO 4 1/4" IN ESPRESSO IN LIEU OF STANDARD NATURAL FINISH LEVEL I Dining
Line12177	Note:
30Sep16 / 24Oct16	
Inv.878	1 - FAMILY ROOM: INSTALL Upgrade 2 PREVERCO 4 1/4" IN ESPRESSO IN LIEU OF STANDARD NATURAL FINISH LEVEL I Family
Line12178	Note:
30Sep16 / 24Oct16	
Inv.878	1 - MAIN HALL: INSTALL Upgrade 2 PREVERCO 4 1/4" IN ESPRESSO IN LIEU OF STANDARD NATURAL FINISH LEVEL I Main Hall
Line12179	Note:
30Sep16 / 24Oct16	
Inv.878	1 - LANDINGS: INSTALL Upgrade 2 PREVERCO 4 1/4" IN ESPRESSO IN LIEU OF STANDARD NATURAL FINISH LEVEL I Landing
Line12180	Note:
30Sep16 / 24Oct16	

KITCHEN AND BATH CABINETRY

Brampton Encore - 106 - 1 - 38-5 Elev.A HANDEL

Inv.878	1 - KITCHEN: INSTALL Maple MDF 116 Built in wall oven and microwave warming drawer and cooktop with countertop by others 242cm
Line12184	Note:
30Sep16 / 24Oct16	
Inv.878	1 - KITCHEN: INSTALL Maple MDF 158 Overlay Gable Pantry 61x220 61x242 FOR WALL OVEN UNIT
Line12185	Note:
30Sep16 / 24Oct16	
Inv.878	2 - KITCHEN: INSTALL TWO (X2) Maple MDF 59 Upper Corner Diagonal 100cm h. SEE SKETCH
Line12186	Note:
30Sep16 / 24Oct16	
Inv.878	2 - KITCHEN: INSTALL TWO (X2) Maple MDF 56 Matching Interior Upper corner diagonal cabinet 100cm h
Line12193	Note:
30Sep16 / 24Oct16	
Inv.878	2 - KITCHEN: INSTALL TWO (X2) Maple MDF 03 Plain Clear Std White Interior 132cm h ON UPPER ANGLE CORNER. SE SKETCH
Line12194	Note:
30Sep16 / 24Oct16	
Inv.878	1 - KITCHEN: INSTALL Maple MDF 87 Pot and Pan Drawers 2 deep drawers and one shallow top drawer 60 70 80 90 cm wide UNDER COOKTOP
Line12195	Note:
30Sep16 / 24Oct16	

MISC.

Inv.449	1 - BONUS PACKAGE: \$5661.30 (INCLUDING TAXES) WORTH OF UPGRADES FROM GOLD PARK HOMES DÉCOR CENTRE IS BEING APPLIED TOWARD THE STRUCTURAL APPOINTMENT. PURCHASER HAS A REMAINING AMOUNT OF \$9338.70 (INCLUDING TAXES) TO BE USED TOWARD THE COLOUR APPOINTMENT
Line5436	Note:
25Apr16 / 9Jun16	
Inv.449	1 - Purchaser has attended a Structural appointment at the Decor Centre & has DECLINED any additional upgrades and accepts and acknowledges that there will be no further structural changes/additions/deletions to be made upon signing on April 25,2016
Line5437	Note:
25Apr16 / 9Jun16	
Inv.449	1 - Purchasers are aware & accepts that ANY changes made to upgrades after signing this Purchasers Extra Form are subject to a minimum administration fee of \$500. PLUS a 10% holdback fee.
Line5438	Note:
25Apr16 / 9Jun16	
Inv.495	1 - FEE TO RE-OPEN FILE: WAIVED AS PER HEAD OFFICE
Line6012	Note:
12May16 / 9Jun16	
Inv.495	1 - BONUS PACKAGE: \$197.75 (INCLUDING TAXES) WORTH OF UPGRADES FROM GOLD PARK HOMES DÉCOR CENTRE IS BEING APPLIED TOWARD THE STRUCTURAL APPOINTMENT. PURCHASER HAS A REMAINING AMOUNT OF \$9140.95(INCLUDING TAXES) TO BE USED TOWARD THE COLOUR APPOINTMENT
Line6013	Note:
12May16 / 9Jun16	

Brampton Encore - 106 - 1 - 38-5 Elev.A HANDEL

Inv.495	1 - Purchasers are aware & accepts that ANY changes made to upgrades after signing this Purchasers Extra Form are subject to a minimum administration fee of \$500. PLUS a 10% holdback fee
Line6014	Note:
12May16 / 9Jun16	
Inv.505	1 - Purchasers are aware & accepts that ANY changes made to upgrades after signing this Purchasers Extra Form are subject to a minimum administration fee of \$500. PLUS a 10% holdback fee
Line8255	Note:
18May16 / 21Oct16	
Inv.505	1 - BONUS PACKAGE: -\$2260.00 (INCLUDING TAXES) WORTH OF UPGRADES FROM GOLD PARK HOMES DÉCOR CENTRE IS BEING APPLIED TOWARD THE STRUCTURAL APPOINTMENT. PURCHASER HAS A REMAINING AMOUNT OF \$11400.95 (INCLUDING TAXES) TO BE USED TOWARD THE COLOUR APPOINTMENT
Line8256	Note:
18May16 / 21Oct16	
Inv.878	1 - Purchaser has attended a Colour appointment at the Decor Centre & has DECLINED any additional upgrades and accepts and acknowledges that there will be no further structural changes/additions/deletions to be made upon signing on September 30, 2016
Line12191	Note:
30Sep16 / 24Oct16	
Inv.878	1 - BONUS PACKAGE: \$11,400.95 (INCLUDING TAXES) WORTH OF UPGRADES FROM GOLD PARK HOMES DÉCOR CENTRE IS BEING APPLIED TOWARD THE COLOUR APPOINTMENT
Line12190	Note:
30Sep16 / 24Oct16	
Inv.878	1 - Purchasers are aware & accepts that ANY changes made to upgrades after signing this Purchasers Extra Form are subject to a minimum administration fee of \$500. PLUS a 10% holdback fee
Line12192	Note:
30Sep16 / 24Oct16	

PAINTING

Inv.878	1 - STAIRCASE: INSTALL choice of Stain ON Staircase 2 Storey Model (Euroline Pickets Charged Separately)
Line12181	Note:
30Sep16 / 24Oct16	

STAIRS AND RAILINGS

Inv.878	1 - RAILING: INSTALL EUROLINE 2 Black Colour Upgrade
Line12182	Note:
30Sep16 / 24Oct16	
Inv.878	1 - RAILING: INSTALL V Groove Handrail
Line12183	Note:
30Sep16 / 24Oct16	

WINDOWS - BASEMENT

Inv.449	3 - BASEMENT: INSTALL (THREE (3) BASEMENT WINDOWS - UPGRADE EXISTING BASEMENT WINDOW TO 30 INCH X 24 INCH - MAY REQUIRE INSTALLATION OF WINDOW WELL
Line5435	Note:
25Apr16 / 9Jun16	

WINDOWS AND DOORS

Inv.449	1 - MAN DOOR GARAGE TO HOUSE - OPTIONAL - IF GRADE PERMITS
Line6729	Note: AS PER APS BONUS PACKAGE
25Apr16 / 9Jun16	

Purchasers: Arpitumar Arvi Master & Deepaben Master

Property: 106 of Plan -

Telephone Res. / Bus: (905) 453-0205

Project: Fieldwalk Investments Inc.

Decor Advisor: Terri Parisani

Model and Elevation: 38-5 Elev.A HANDEL

Layout Changes: ☒ Yes ☐ No

Sketch Attached: ☒ Yes ☐ No

Exterior Colour Scheme:
1. Cabinetry

	Style and Colour	Counter	Hardware
Kitchen / Breakfast	*Upg2Romana(mpl)char	*Upg2 #6141 Caesarstone Edge: C20	cs1-24
Laundry Room			
Powder Room			
TWIN BATH	Varese (pvc) Mystic	7735-58 Portico Marble Laminate	cs1-25
Master Ensuite Bathroom	Toscana(pvc)ChocMapl	7735-58 Portico Marble Laminate	cs1-20
Second Ensuite Bathroom (If Applicable)	Varese(pvc)ChocoMapl	7735-58 Portico Marble Laminate	cs1-25
Dishwasher Cabinet	N/A		

Comment

*KITCHEN CABINETS ARE UPGRADE 2 ROMANA MAPLE WITH CHARCOAL STAIN

2. Floor Tile

	Selection	Grout	Threshold
Entrance Vestibule	*Upg.2 New Byzantine, Azzuro 12 x 24	N/A	N/A
Main Hall			
Kitchen / Breakfast	*Upg.2 New Byzantine, Azzuro 12 x 24	N/A	N/A
Laundry Room	Serpentine Beyaz, 13 x 13	N/A	N/A
Powder Room	*Upg.2 New Byzantine, Azzuro 12 x 24	N/A	N/A
TWIN BATH	Serpentine Beyaz, 13 x 13	N/A	N/A
Master Ensuite Bathroom	New Reeds Taupe, 13 x 13	N/A	N/A
Second Ensuite Bathroom (If Applicable)	Serpentine Beyaz, 13 x 13	N/A	N/A
Lower Landing (If Applicable)			

Comment
3. Wall Tile

	Selection	Listello/Inserts	Describe
TWIN BATH	Serpentine Beyaz, 8 X 10	<input type="radio"/> Yes <input checked="" type="radio"/> No	
Master Ensuite Bathroom			
Tub Deck	New Reeds Taupe, 8 x 10	<input type="radio"/> Yes <input checked="" type="radio"/> No	
Shower Stall	New Reeds Taupe, 8 x 10	<input type="radio"/> Yes <input checked="" type="radio"/> No	
Bathroom Walls	New Reeds Taupe, 8 x 10	<input type="radio"/> Yes <input checked="" type="radio"/> No	
Second Ensuite Bathroom (If Applicable)	Serpentine Beyaz, 8 X 10	<input type="radio"/> Yes <input checked="" type="radio"/> No	
		<input type="radio"/> Yes <input checked="" type="radio"/> No	
Kitchen Backsplash	<input type="radio"/> Yes <input checked="" type="radio"/> No	Backsplash Behind Fridge	No

Comment

Purchasers: Arpitumar Arvi Master & Deepaben Master

Property: 106 of Plan -

Telephone Res. / Bus: (905) 453-0205

Project: Fieldwalk Investments Inc.

Decor Advisor: Terri Parisani

Model and Elevation: 38-5 Elev.A HANDEL

4. Plumbing Fixtures

Second Ensuite **Powder Room**
Master Ensuite Bathroom **Other Room - Specify** **Other Washroom**

Comment

PLUMBING FIXTURES ARE STANDARD THROUGHOUT HOUSE

5. Hardwood Flooring

	Type and Stain		Type and Stain
Main Hall	*Upg.2 Preverco 4 1/4" Espresso	Upper Landing	*Upg.2 Preverco 4 1/4" Espresso
Kitchen / Breakfast	<input type="text"/>	Upper Hall	<input type="text"/>
Living Room	<input type="text"/>	Master Bedroom	<input type="text"/>
Dining Room	*Upg.2 Preverco 4 1/4" Espresso	Bedroom #2	<input type="text"/>
Family Room	*Upg.2 Preverco 4 1/4" Espresso	Bedroom #3	<input type="text"/>
Den/Library	<input type="text"/>	Bedroom #4	<input type="text"/>
Entrance Vestibule	<input type="text"/>	Bedroom #5	<input type="text"/>
Lower Landing (If Applicable)	<input type="text"/>	Other Room - Specify	<input type="text"/>

Comment
6. Carpeting

	Upgrade	Description
Main Hall	<input type="checkbox"/>	<input type="text"/>
Living Room	<input type="checkbox"/>	<input type="text"/>
Dining Room	<input type="checkbox"/>	<input type="text"/>
Family Room	<input type="checkbox"/>	<input type="text"/>
Den/Library	<input type="checkbox"/>	<input type="text"/>
Upper Hall	<input type="checkbox"/>	T-15
Master Bedroom	<input type="checkbox"/>	T-15
Bedroom #2	<input type="checkbox"/>	T-15
Bedroom #3	<input type="checkbox"/>	T-15
Bedroom #4	<input type="checkbox"/>	T-15
Bedroom #5	<input type="checkbox"/>	<input type="text"/>
<input type="text"/>	<input type="checkbox"/>	<input type="text"/>
Upper Landing (If Applicable)	<input type="checkbox"/>	<input type="text"/>
Lower Landing (If Applicable)	<input type="checkbox"/>	<input type="text"/>

	Type	Area
Upgrade Underpad	Standard	<input type="text"/>
	Capped	Runner - *Upgrade
Carpet on Stairs	N/A	N/a

Comment

Purchasers: Arpitumar Arvi Master & Deepaben Master

Property: 106 of Plan -

Telephone Res. / Bus: (905) 453-0205

Project: Fieldwalk Investments Inc.

Decor Advisor: Terri Parisani

Model and Elevation: 38-5 Elev.A HANDEL

7. Fireplace

	Living Room			Family Room			Other Room - Specify		
	Purchased	As Per Plan	N/A	Purchased	As Per Plan	N/A	Purchased	As Per Plan	N/A
Fireplace Type	<input type="radio"/>	<input type="radio"/>	<input checked="" type="radio"/>	<input type="radio"/>	<input checked="" type="radio"/>	<input type="radio"/>	<input type="radio"/>	<input type="radio"/>	<input checked="" type="radio"/>
Mantle Type				STANDARD					
Colour / Stain				NF-20					
Surround				WHITE PAINT-GRADE					
Hearth				BIANCO CARRARA					
				NONE					

Comment

8. Trim Carpentry

Interior Doors	STANDARD	Front Door Glass Inserts	STANDARD	Door Handles	STANDARD
Interior Trim	STANDARD				

Comment

9. Plaster Mouldings and Medallions

Entrance Vestibule	N/A		Kitchen/Breakfast	N/A	
Main Hall	N/A		Den/Library	N/A	
Living Room	N/A		Lower Landing	N/A	
Dining Room	N/A		Other Room - Specify		
Family Room	N/A				

Comment

10. Railings and Spindles

Railing Package	*EUROLINE 2 WITH V-GROOVE HANDRAIL		
Railing Colour	*ESPRESSO	Spindle Colour	
Stringer / Riser	*ESPRESSO	Treads	
		Oak Stairs	<input checked="" type="radio"/> Yes <input type="radio"/> No

Comment

11. Wall Paint

Main & Upper Hall	WARM GREY	Master Bedroom	WARM GREY
Living Room	WARM GREY	Bedroom #2	WARM GREY
Dining Room	WARM GREY	Bedroom #3	WARM GREY
Kitchen / Breakfast	WARM GREY	Bedroom #4	WARM GREY
Family Room	WARM GREY	Bedroom #5	
Powder Room	WARM GREY	Master Ensuite	WARM GREY
Laundry Room	WARM GREY	TWIN BATH	WARM GREY
Den/Library	WARM GREY	Second Ensuite	WARM GREY
Trim Paint	WHITE		

Comment

Smooth Ceilings First Floor

Purchasers: Arpitumar Arvi Master & Deepaben Master

Property: 106 of Plan -

Telephone Res. / Bus: (905) 453-0205

Project: Fieldwalk Investments Inc.

Decor Advisor: Terri Parisani

Model and Elevation: 38-5 Elev.A HANDEL

12. Electrical

Plugs and Switches ☒ White ☐ Ivory Above Kitchen Cabinet Light ☐ Yes ☒ No
Hood Fan ☐ White ☐ Ivory Below Kitchen Cabinet Light ☐ Yes ☒ No
Appliances Built in Cooktop Built in Oven Gas Stove Microwave
☒ Yes ☐ No ☒ Yes ☐ No ☐ Yes ☒ No ☒ Yes ☐ No

Comment

STANDARD HOOD FAN: STAINLESS STEEL

13. Heating and Air Conditioning

Air Conditioning Gas Provisions Stove
Gas Provisions Dryer Gas Provisions Barbecue

Comment

GAS LINE FOR BBQ IS STANDARD

14. Additional Comments

15. Disclaimers and Notes

- 1) Colours of all materials are as close as possible to builder's selection, but not necessarily identical due to variances in manufacturing.
- 2) Any extras listed above are null and void unless accompanied by a separate invoice/amendment. Said invoice must be paid in full.
- 3) The Purchaser acknowledges that after Interior Colour Selection form is signed and dated, no further changes will be permitted other than re-selection due to unavailability. Purchaser's Initials
- 4) The Purchaser acknowledges reading and accepting the "Gold Park Homes Decor Centre Disclaimers" form. This document contains other miscellaneous disclaimers.

This Interior Colour Selection is final and approved by:

Signature: Deepa Date: Sep 30 16 Signature: Arvi Date: Sep 30 16

CORTINA

KITCHENS INC.

70 Regina Road Woodbridge ON L4L 8L6
905-264-6464

CHARCOAL STAIN INFORMATION

Builder: Gold Park Homes Project: Encore Lot #: 106

Charcoal is a spray stain applied to Oak and Maple products with several characteristics that are important to be aware of when purchasing this product.

1. Shadow lines may be visible at the interior profile edges of a door or drawer front. If movement occurs shadow lines may increase or decrease, depending on the style and/or size of a door or drawer front.
2. Variation and unevenness may be visible in the finish.
3. Hairline cracks at the joints are created over time due to the nature of natural wood, caused by usage, humidity**, or dryness. They tend to be more visible to darker stains, than lighter wood stains.

** Relative humidity is recommended to be between 45% and 55%. Please refer to Cortina Kitchens "Cleaning, Care, Maintenance, & Warranty Information" guide.

Please be advised that Cortina Kitchens will not replace doors and/or parts that exhibit the above characteristics associated with this finish. These characteristics are not avoidable and are a result of the natural characteristics of wood and wood veneer, and the characteristics of darker stains on wood.

The Charcoal stain is not available on doors in Group IV, Group IVA, Group V and Group VA.

Thank you for your understanding.

I am well informed of this information, and agree to the purchase of any of the subject finishes listed above.

Purchaser: 

Date: 30th Sept, 2016

STANDARD HARDWARE

Lot 106 Sept. 30, 16

DAN
HAR

STANDARD HARDWARE

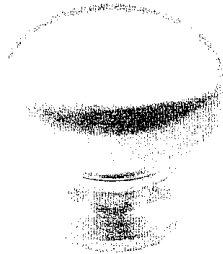

CSI-6

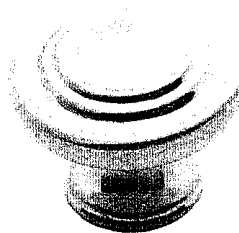

CSI-10

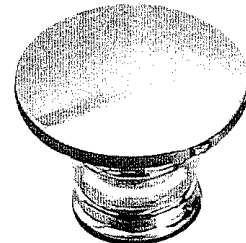

CSI-14

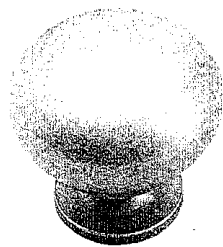

CSI-16



CSI-18

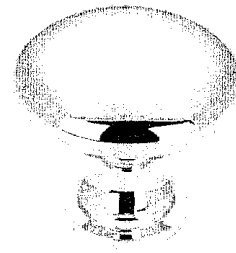

CSI-19

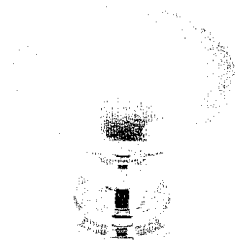

CSI-20

Master

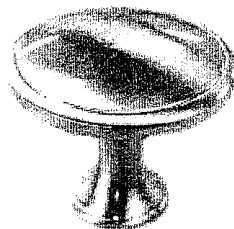

CSI-21

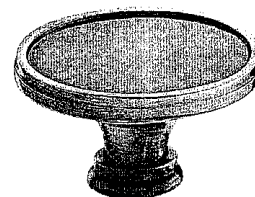

CSI-22

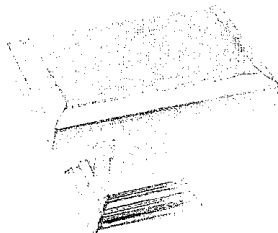

CSI-23

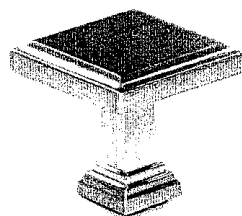

CSI-24

Kitchen

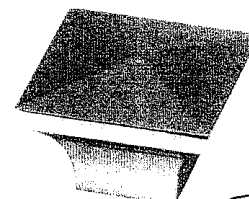

CSI-25

TWIN
ERS. 2

*NOTES:

- IMAGES ARE FOR QUICK REFERENCE PURPOSES ONLY
- ACTUAL SIZES AND FINISHES AS PER HARDWARE SAMPLE BOARD PROVIDED TO DECOR CENTRE

CORTINA KITCHENS INC.

70 Regatta Road, Woodbridge, Ontario L4L 5L8
Tel: 905-284-4484 Fax: 905-254-0984
www.CortinaKitchens.com

QUOTATION

Date: 06/23/16

Trade Name: Gold Park Homes	Site location: Brampton	Model: 38-5
Address:	Project: Encore	Phase:

This layout has been explained to the purchaser by Cortina Kitchens Inc. and is understood by the purchaser.

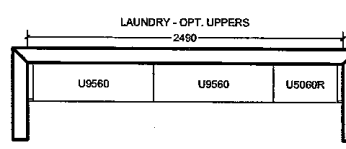
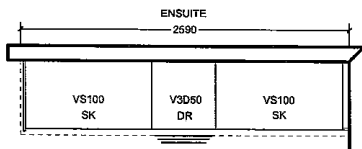
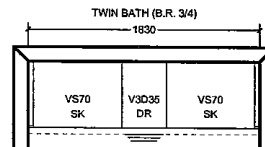
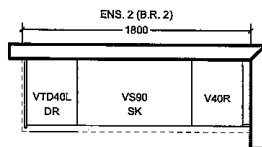
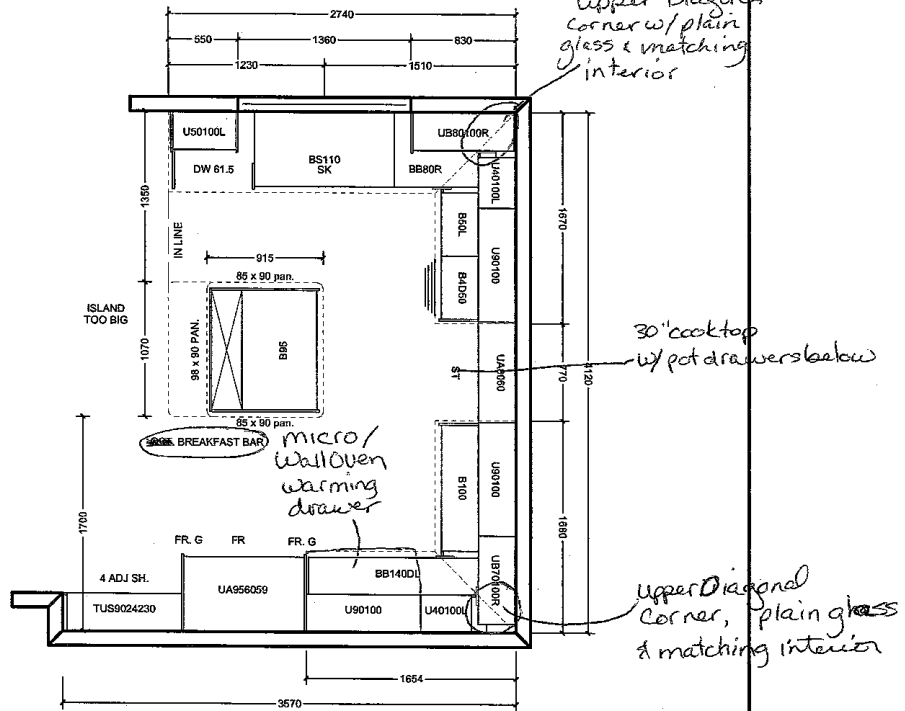

All prices subject to confirmation from head office.
This quotation is subject to the terms & conditions set out
in Cortina's Agreement of Purchase and Sale.

All agreements are contingent upon strikes, accidents, and delay beyond our control.
Please provide our installer with template for sinkholes or \$150.00 will be charged for callback.

ACCEPTED DATE: _____

CUSTOMER SIGNATURE _____

SALESPERSON SIGNATURE _____

CORTINA HEAD OFFICE APPROVAL _____

ITEM A. Wood grain and colour are characteristics of the product, we cannot guarantee that such grain and colour will always match.
ITEM B. Cortina Kitchens reserves the right to alter dimensions and make technical changes without notice.

Lot 106
Sept 30, 16

AM AM

encore
BRAMPTON

Telephone — (T)
Cable — (C)
Electrical — (E)

The Handel
38' SERIES

Elevation A - 2,603 sq.ft. | Elevation B - 2,603 sq.ft.

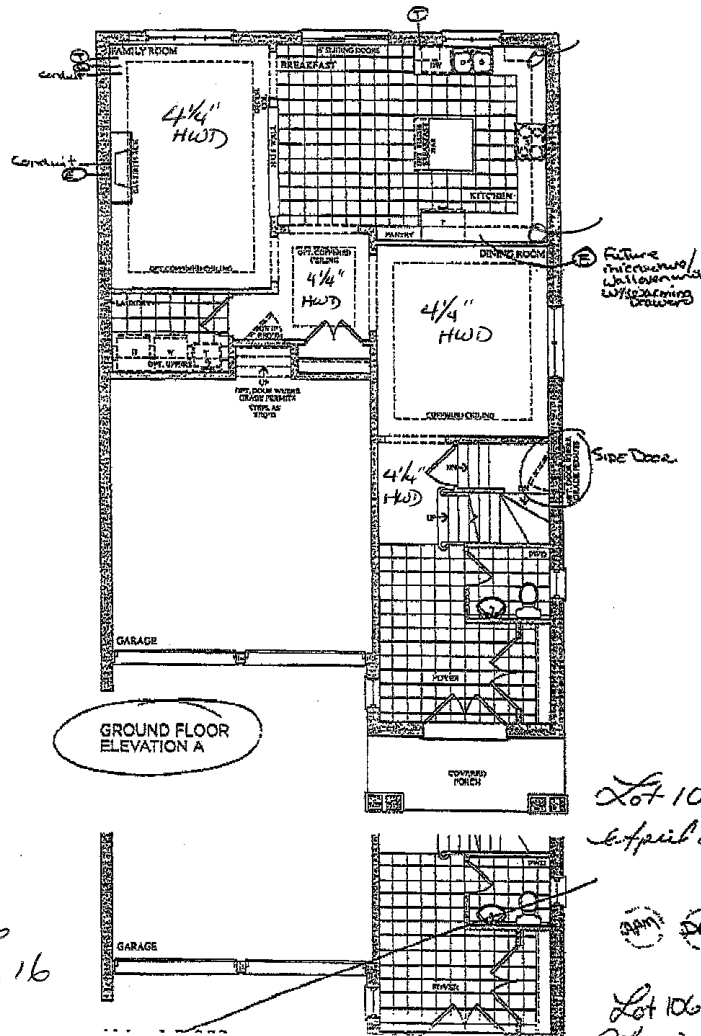

Lot 106
Sept. 30, 16

(CAM) (CAM)

Lot 106
April 25, 16

(CAM) (CAM)

Lot 106
May 12, 16

(CAM) (CAM)

encore
BRAMPTON

Telephone — (T)
Cable — (C)

The Handel 38' SERIES

Elevation A • 2,603 sq.ft. | Elevation B • 2,603 sq.ft.

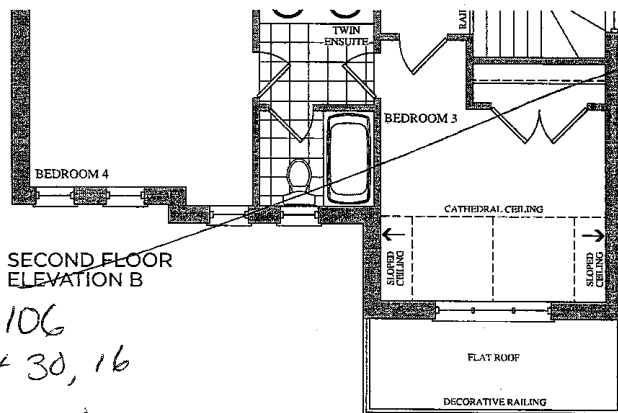
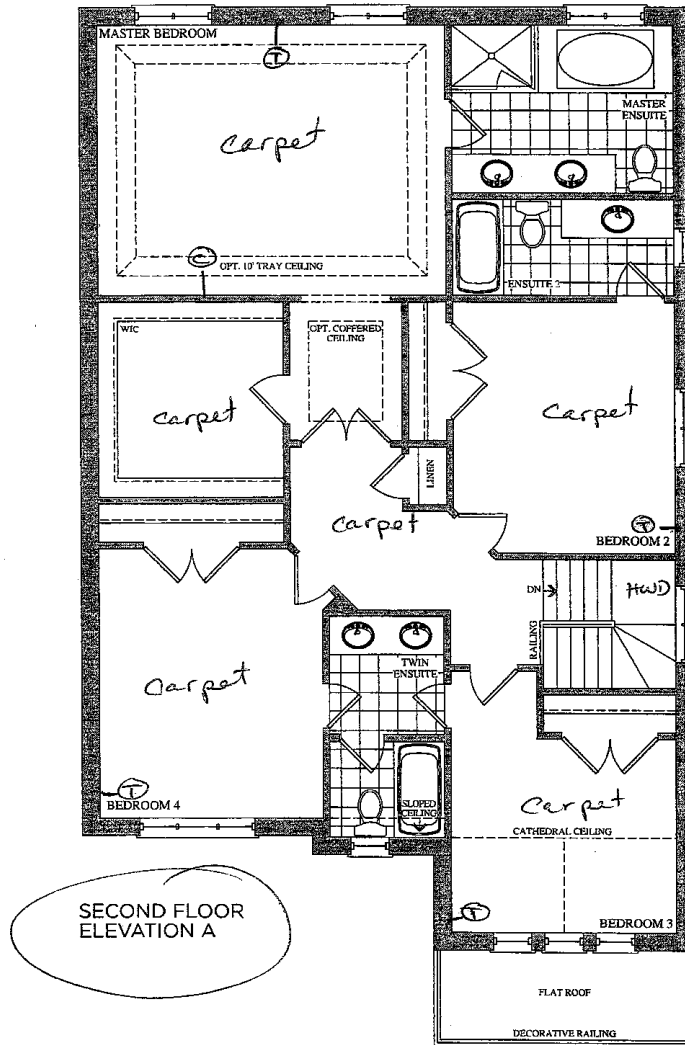

Lot 106
April 25, 16

AAM DAM

Lot 106
Sept 30, 16

AAM DAM

Prices, figures, illustrations, sizes, features and finishes are subject to change without notice. E.O.C. Areas and dimensions are approximate and actual usable floor space may vary from the stated area. Layout may be reverse of the unit purchased. E. & O.E.

GOLDPARK
HOMES

Lot 106

MICROWAVE OVEN BUILT-IN TRIM KIT INSTALLATION INSTRUCTIONS

Built-In Trim Kit Models MK2167, MK2160

UL listed for use over any electric or gas built-in electric oven, up to 30" (76.2 cm) wide

INSTRUCTIONS D'INSTALLATION GARNITURE ENCASTRÉE POUR FOUR À MICRO-ONDES

Garniture encastrée pour modèles MK2167, MK2160 - 30"

Homologations UL pour utilisation au-dessus de tous les fours encastrés électriques ou gaz, jusqu'à 30" (76,2 cm) de largeur

Table of Contents / Table des matières

MICROWAVE OVEN SAFETY	1	SÉCURITÉ DU FOUR À MICRO-ONDES	7
INSTALLATION INSTRUCTIONS	2	INSTRUCTIONS D'INSTALLATION	7
Tools and Parts	2	Outils et pièces	7
Location Requirements	2	Exigences d'emplacement	7
Required Cutout Dimensions	2	Dimensions nécessaires de l'ouverture d'encastrement	8
Trim Kit Frame Dimensions	2	Dimensions du cadre de la trousse de garniture	8
Electrical Requirements	3	Spécifications électriques	8
Prepare Microwave Oven	3	Préparation du four à micro-ondes	9
Prepare Cutout/Cabinet Opening	3	Préparation de l'ouverture d'encastrement	9
Install the Microwave Oven	4	Installation du four à micro-ondes	10
Install Trim Kit Frame	5	Installation du cadre de la trousse de garniture	11

MICROWAVE OVEN SAFETY

Your safety and the safety of others are very important.

We have provided many important safety messages in this manual and on your appliance. Always read and obey all safety messages.



This is the safety alert symbol.

This symbol alerts you to potential hazards that can kill or hurt you and others.

All safety messages will follow the safety alert symbol and either the word "DANGER" or "WARNING."

These words mean:

⚠ DANGER

You can be killed or seriously injured if you don't immediately follow instructions.

⚠ WARNING

You can be killed or seriously injured if you don't follow instructions.

All safety messages will tell you what the potential hazard is, tell you how to reduce the chance of injury, and tell you what can happen if the instructions are not followed.

** Note: Wall oven is not flush.*

○

Electrical Requirements

⚠ WARNING



Electrical Shock Hazard

Plug into a grounded 3 prong outlet.

Do not remove ground prong.

Do not use an adapter.

Do not use an extension cord.

Failure to follow these instructions can result in death, fire, or electrical shock.

Observe all governing codes and ordinances.

Required:

- A 120 volt, 60 Hz, AC only, 15- or 20-amp electrical supply with a fuse or circuit breaker.

Recommended:

- A time-delay fuse or time-delay circuit breaker.
- A separate circuit serving only this microwave oven.

GROUNDING INSTRUCTIONS

■ For all cord connected appliances:

The microwave oven must be grounded. In the event of an electrical short circuit, grounding reduces the risk of electric shock by providing an escape wire for the electric current. The microwave oven is equipped with a cord having a grounding wire with a grounding plug. The plug must be plugged into an outlet that is properly installed and grounded.

WARNING: Improper use of the grounding plug can result in a risk of electric shock. Consult a qualified electrician or serviceman if the grounding instructions are not completely understood, or if doubt exists as to whether the microwave oven is properly grounded.

Do not use an extension cord. If the power supply cord is too short, have a qualified electrician or serviceman install an outlet near the microwave oven.

SAVE THESE INSTRUCTIONS

Prepare Microwave Oven

1. Unplug microwave oven before proceeding with installation.
2. Remove any loose items inside microwave oven.
3. Gently turn microwave oven onto its top, with the door facing forward (toward installer).
4. Align the two rails on the microwave oven bottom, as shown, making sure the flanges are forward and pointing up.

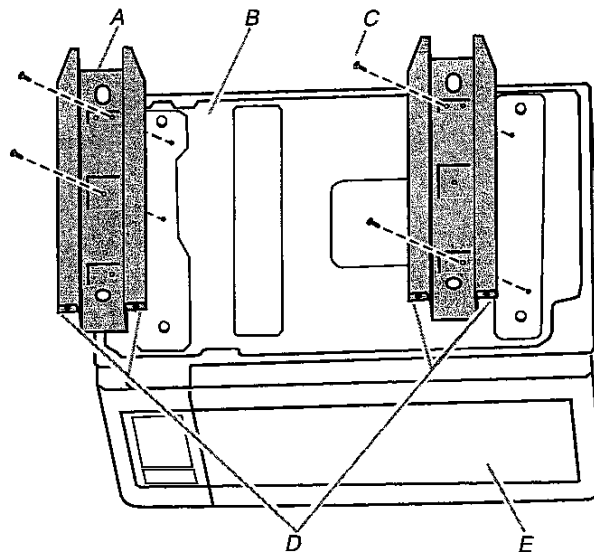

A. Rails (2)
B. Microwave oven bottom
C. Short screws (4)
D. Flanges
E. Door

5. Secure the rails to the microwave oven bottom using four short screws.

Prepare Cutout/Cabinet Opening

1. On the cutout floor, find and mark the centerline.
2. Place the bottom duct in the opening, with the flange resting against the bottom front facing of the opening.

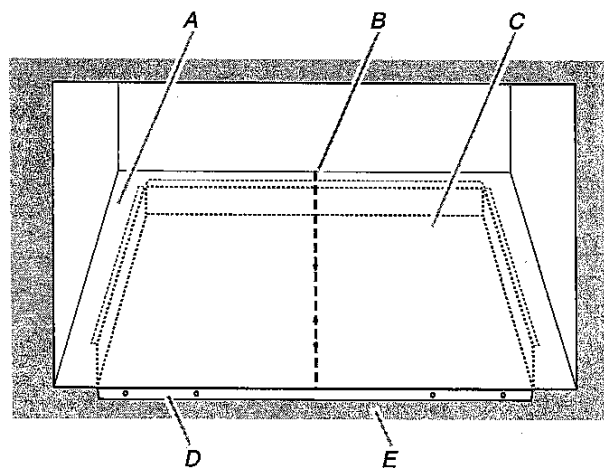

A. Cutout floor
B. Centerline
C. Bottom duct
D. Bottom duct flange
E. Front facing

5. Slide the microwave oven back and into place. The mounting holes of the rail flanges and bottom duct flange will align against the bottom front facing of the cutout/cabinet opening.
6. Secure the microwave oven to the cutout/cabinet by installing four short screws into the mounting holes.

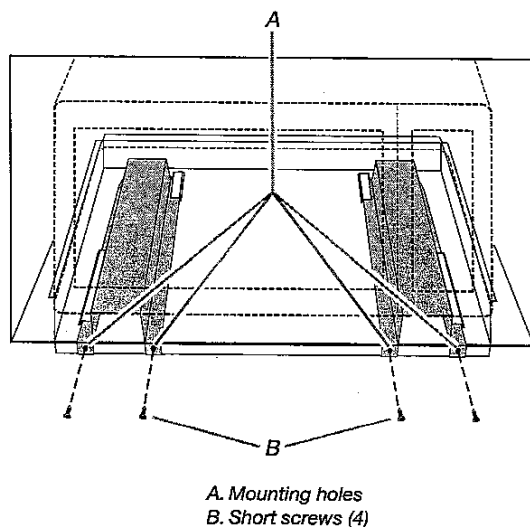

Install Trim Kit Frame

1. Position trim kit frame over the opening so that the lower tabs rest on the cutout floor, as shown.

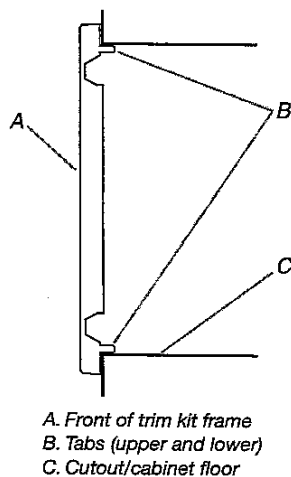

2. Holding the trim kit frame in place, use 7/64" drill to drill four pilot holes into the front facing of the cutout/cabinet through the mounting hole guides in the upper and lower corners of the trim kit frame.

NOTES:

- The holes will be drilled downward from the top, and upward from the bottom at an angle of about 45°.
- To avoid damage to the trim kit frame, do not overtighten screws.

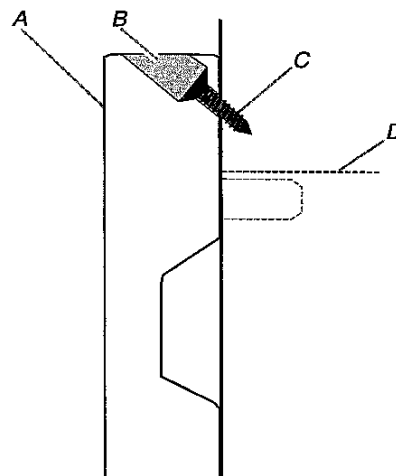

3. Secure trim kit frame to cutout/cabinet by installing four long wood screws (painted) into the pilot holes drilled in Step 2 above.

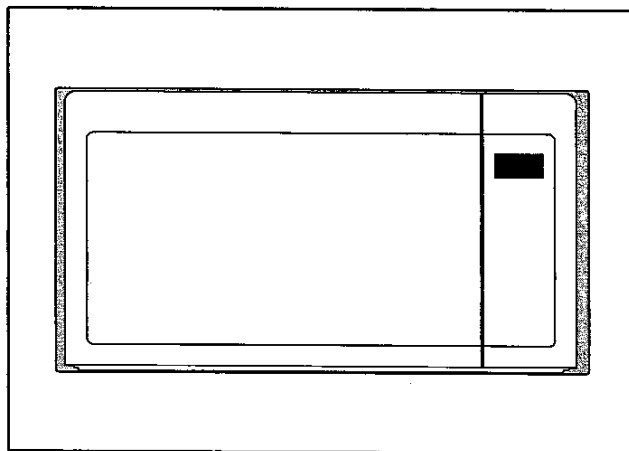

Installation is now complete. Replace any loose items that have been removed from microwave oven cavity.

Save these Installation Instructions for future reference.

SÉCURITÉ DU FOUR À MICRO-ONDES

Votre sécurité et celle des autres est très importante.

Nous donnons de nombreux messages de sécurité importants dans ce manuel et sur votre appareil ménager. Assurez-vous de toujours lire tous les messages de sécurité et de vous y conformer.



Voici le symbole d'alerte de sécurité.

Ce symbole d'alerte de sécurité vous signale les dangers potentiels de décès et de blessures graves à vous et à d'autres.

Tous les messages de sécurité suivront le symbole d'alerte de sécurité et le mot "DANGER" ou "AVERTISSEMENT". Ces mots signifient :

⚠ DANGER

Risque possible de décès ou de blessure grave si vous ne suivez pas immédiatement les instructions.

⚠ AVERTISSEMENT

Risque possible de décès ou de blessure grave si vous ne suivez pas les instructions.

Tous les messages de sécurité vous diront quel est le danger potentiel et vous disent comment réduire le risque de blessure et ce qui peut se produire en cas de non-respect des instructions.

INSTRUCTIONS D'INSTALLATION

Outils et pièces

Outillage nécessaire

Rassembler les outils et composants nécessaires avant d'entreprendre l'installation. Lire et observer les instructions fournies avec chacun des outils de la liste ci-dessous.

- Mètre ruban
- Crayon
- Tournevis Phillips
- Perceuse
- Foret de 7/64"

Pièces fournies (pas à l'échelle)

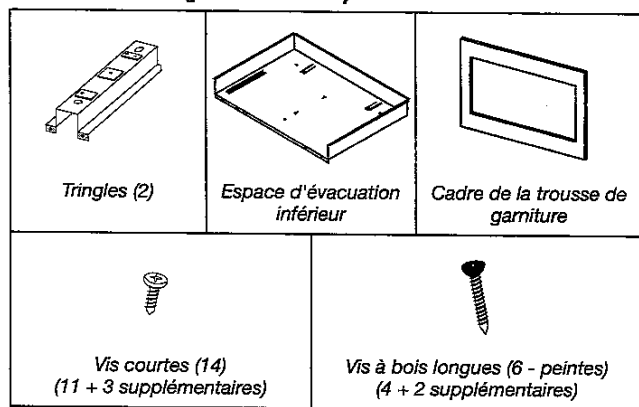

Exigences d'emplacement

Le four à micro-ondes peut être installé par dessus un four encastré. Si l'on installe le four à micro-ondes par dessus un four encastré, s'assurer qu'il existe un dégagement minimal de 3" (7,6 cm) entre le sommet de l'ouverture d'encastrement du four inférieur et le plancher de l'ouverture d'encastrement du four à micro-ondes.

Le four à micro-ondes peut aussi être installé seul dans un placard (sans four encastré en dessous). Pour faciliter l'utilisation de l'appareil, une distance minimale de 36" (91,4 cm) est recommandée entre le plancher et le plancher de l'ouverture d'encastrement.

S'assurer que les placards environnants peuvent s'ouvrir et se fermer librement. Laisser un dégagement d'au moins 1 1/16" (4 cm) sous le plancher de l'ouverture d'encastrement (3" [7,6 cm] pour une installation au-dessus d'un four encastré) et un dégagement d'au moins 2" (5,1 cm) au-dessus de l'ouverture d'encastrement.

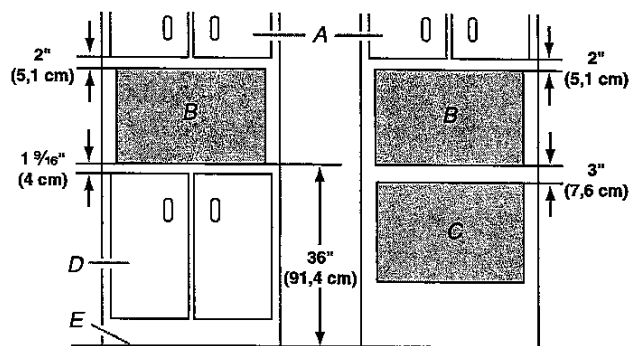

A. Placard supérieur
B. Ouverture d'encastrement du four à micro-ondes

C. Ouverture d'encastrement inférieure
D. Placards inférieurs
E. Plancher

Préparation du four à micro-ondes

1. Débrancher le four à micro-ondes avant de poursuivre l'installation.
2. Retirer les articles à l'intérieur du four à micro-ondes - le cas échéant.
3. Placer avec précaution le four à micro-ondes sur son sommet en orientant la porte vers l'avant (vers l'installateur).
4. Aligner les deux tringles sur le plancher du four à micro-ondes tel qu'illustré en s'assurant que les rebords sont orientés vers l'avant et vers le haut.

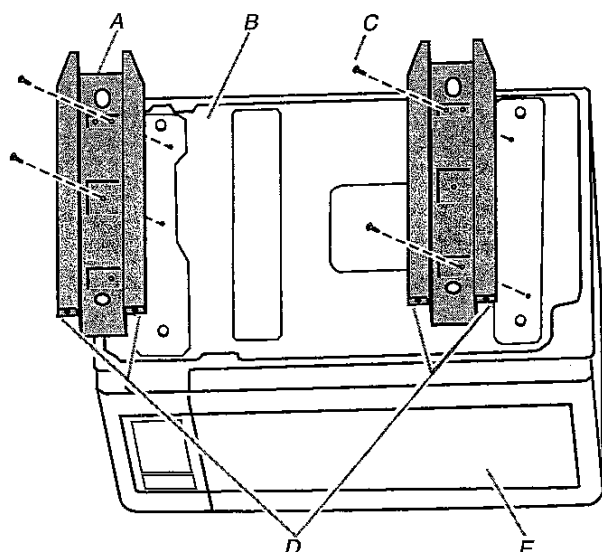

A. Tringles (2) C. Vis courtes (4)
B. Plancher du four à micro-ondes D. Rebords
E. Porte

5. Fixer les tringles au plancher du four à micro-ondes à l'aide de quatre vis courtes.

Préparation de l'ouverture d'encastrement

1. Déterminer et marquer l'axe central sur le plancher de l'ouverture d'encastrement.
2. Positionner l'espace d'évacuation inférieur dans l'ouverture en faisant reposer le rebord contre l'avant inférieur de l'ouverture.

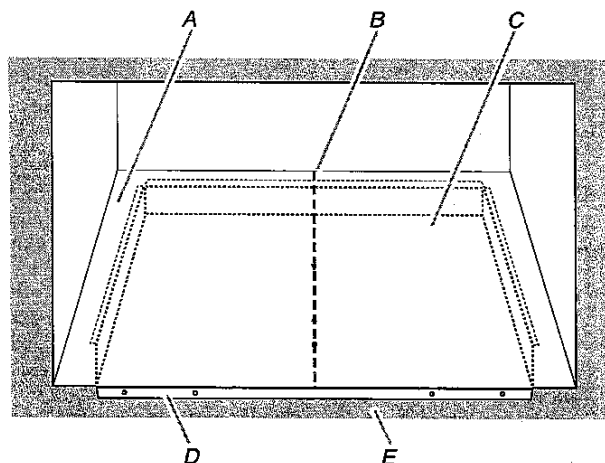

A. Plancher de l'ouverture d'encastrement D. Rebord de l'espace d'évacuation inférieur
B. Axe central E. Avant
C. Espace d'évacuation inférieur

3. Aligner les flèches centrales de l'espace d'évacuation inférieur avec l'axe central illustré à l'étape 1 ci-dessus.

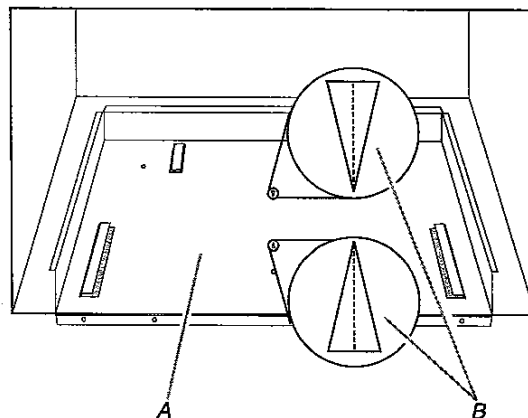

A. Espace d'évacuation inférieur
B. Flèches centrales alignées avec l'axe central

5. Réinsérer le four à micro-ondes dans la cavité pour le remettre en place. Les trous de montage des extrémités de tringles et du rebord de l'espace d'évacuation inférieur s'alignent contre la partie inférieure avant de l'ouverture d'encastrement.
6. Fixer le four à micro-ondes à l'ouverture d'encastrement en installant quatre vis courtes dans les trous de montage.

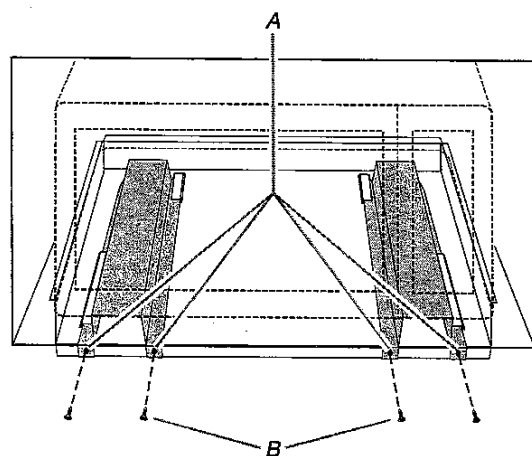

A. Trous de montage
B. Vis courtes (4)

Installation du cadre de la trousse de garniture

1. Placer le cadre de la trousse de garniture sur l'ouverture, de sorte que les languettes inférieures reposent sur le plancher de l'ouverture, tel qu'illustré.

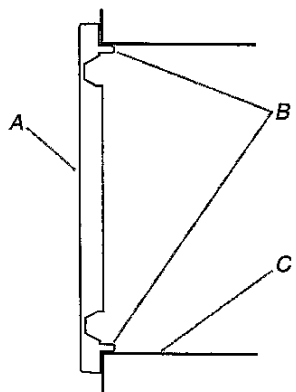

A. Avant du cadre de la trousse de garniture
B. Languettes (supérieure et inférieure)
C. Plancher de l'ouverture d'encastrement

2. Tout en maintenant le cadre de trousse de garniture en place, utiliser un foret de 7/64" pour percer quatre avant-trous dans l'avant de l'ouverture d'encastrement à travers les rails de guidage des trous de montage, dans les angles supérieurs et inférieurs du cadre de trousse de garniture.

REMARQUES :

- Les trous sont percés de haut en bas, et de bas en haut à un degré d'environ 45°.
- Pour éviter d'endommager le cadre de la trousse de garniture, ne pas trop serrer les vis.

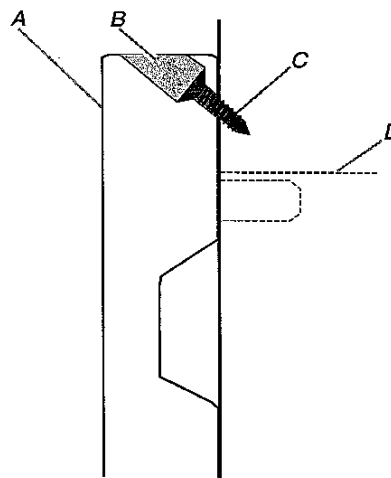

A. Cadre de la trousse de garniture
B. Rail de guidage du trou de montage
C. Vis à bois longues (4 - peintes)
D. Plafond de l'ouverture d'encastrement

3. Fixer le cadre de trousse de garniture à l'ouverture d'encastrement en installant quatre vis à bois longues (peintes) dans les avant-trous percés à l'étape 2 ci-dessus.

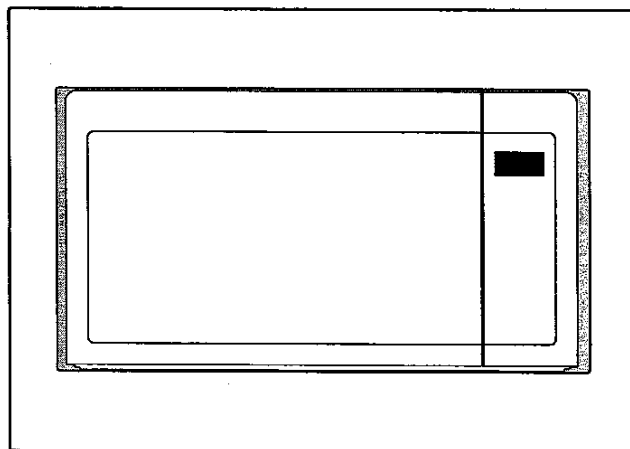

L'installation est maintenant terminée. Réinstaller tous les articles qui auraient été retirés de la cavité du four à micro-ondes. Conserver ces Instructions d'installation pour une éventuelle réutilisation ultérieure.

27" (68.6 CM) AND 30" (76.2 CM) ELECTRIC SINGLE AND DOUBLE BUILT-IN OVEN

PRODUCT MODEL SERIES

KODE300E	KODT100E	KOSE507E
KODE307E	KODT107E	KOST100E 30"
KODE500E	WOD97EC0E	KOST107E
KODE507E	KOSE500E	WOS97EC0E

Electrical:

To properly install your oven, you must determine the type of electrical connection you will be using and follow the instructions provided for it here.

- Oven must be connected to the proper electrical voltage and frequency as specified on the model/serial number rating plate. The model/serial number rating plate is located under the control panel on single ovens and under the control panel on the upper oven cavity on double ovens. See the following illustrations.

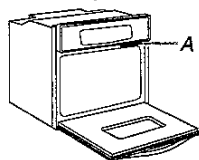

Single Oven

A. Model/serial number plate

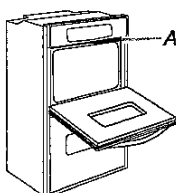

Double Oven

A. Model/serial number plate

- Models rated from 7.3 to 9.6 kW at 240 volts (5.4 to 7.4 kW at 208 volts) require a separate 40-amp circuit. Models rated at 4.8 kW and below at 240 volts (3.6 kW and below at 208 volts) require a separate 20-amp circuit.

- A circuit breaker is recommended.

- Connect directly to the circuit breaker box (or fused disconnect) through flexible, armored or nonmetallic sheathed, copper cable (with grounding wire). See "Make Electrical Connection" section.

- Flexible conduit from the oven should be connected directly to the junction box.

- Fuse both sides of the line.

- Do not cut the conduit. The length of conduit provided is for serviceability of the oven.

- A UL listed or CSA approved conduit connector must be provided.

- If the house has aluminum wiring, follow the procedure below:
 1. Connect a section of solid copper wire to the ends of the flexible conduit leads.

2. Connect the aluminum wiring to the added section of copper wire using special connectors and/or tools designed and UL listed for joining copper to aluminum.

Follow the electrical connector manufacturer's recommended procedure. Aluminum/copper connection must conform with local codes and industry accepted wiring practices.

For power requirements for models MEW7527, MEW7530, MEW7627, MEW7630, MEW9537, MEW9627, MEW9530 and MEW9630, refer to the following table.

Voltage	Single Thermal	Single Convec Thermal	Double Thermal	Double Convec Thermal	Double Convec Thermal
240 VAC	4083 W	4141 W	8163 W	8279 W	8221 W
208 VAC	3088 W	3145 W	6172 W	6288 W	6230 W
240 VAC	17.4 A	17.8 A	34.7 A	35.7 A	35.2 A
208 VAC	15.1 A	15.6 A	30.2 A	31.2 A	30.7 A

PRODUCT DIMENSIONS

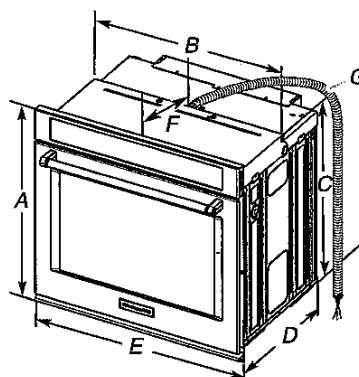

27" (68.6 cm) models

- A. 28 3/4" (72.8 cm) max. overall height
- B. 25 7/8" (64.6 cm) max. recessed width
- C. 26 3/4" (67.9 cm) recessed height
- D. 23 1/4" (59.1 cm) max. recessed depth
- E. 27" (68.6 cm) overall width
- F. 12" (30.5 cm) from back of control panel to start of strain relief
- G. 48" (121.9 cm) flexible conduit length

30" (76.2 cm) models

- A. 28 3/4" (72.8 cm) max. overall height
- B. 28 1/2" (72.4 cm) max. recessed width
- C. 26 3/4" (67.9 cm) recessed height
- D. 23 1/4" (59.1 cm) max. recessed depth
- E. 30" (76.2 cm) overall width
- F. 12" (30.5 cm) from back of control panel to start of strain relief
- G. 48" (121.9 cm) flexible conduit length

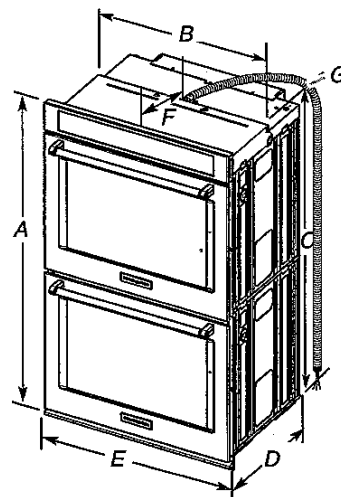

27" (68.6 cm) models

- A. 51 3/8" (130.0 cm) max. overall height
- B. 25 7/8" (64.6 cm) max. recessed width
- C. 48 1/8" (124.0 cm) recessed height
- D. 23 1/4" (59.1 cm) max. recessed depth
- E. 27" (68.6 cm) overall width
- F. 12" (30.5 cm) from back of control panel to start of strain relief
- G. 66" (167.6 cm) flexible conduit length

30" (76.2 cm) models

- A. 51 3/8" (130.0 cm) max. overall height
- B. 28 1/2" (72.4 cm) max. recessed width
- C. 48 1/8" (124.0 cm) recessed height
- D. 23 1/4" (59.1 cm) max. recessed depth
- E. 30" (76.2 cm) overall width
- F. 12" (30.5 cm) from back of control panel to start of strain relief
- G. 66" (167.6 cm) flexible conduit length



24" (61 CM), 27" (68.6 CM), AND 30" (76.2 CM) INDOOR/OUTDOOR ELECTRIC WARMING DRAWER

PRODUCT MODEL NUMBERS

KOWT100E 30" KOWT104E KOWT107E

ELECTRICAL CONNECTION

A 120 volt, 60 Hz., AC only, 15-amp fused, electrical circuit is required. A time-delay fuse or circuit breaker is also recommended. It is recommended that a separate circuit serving only this warming drawer be provided.

LOCATION REQUIREMENTS

IMPORTANT: Observe all governing codes and ordinances.

- Cutout dimensions that are shown must be used. Given dimensions provide minimum clearance with warming drawer.
- Recessed installation area must provide complete enclosure around the recessed portion of the warming drawer.
- Grounded electrical supply is required. See "Electrical Requirements" section.
- Electrical supply outlet should be located in the rear wall on the upper right-hand side of the cutout or in an adjacent cabinet. The outlet must be recessed. If the electrical outlet is located in an adjacent cabinet, a 1½" (3.5 cm) minimum diameter hole should have been drilled in the back of the cutout or support surface to pass the power supply cord through to the outlet.
- Warming drawer support surface must be solid, level and flush with bottom of cabinet cutout.
- Warming drawers with oiled bronze, black glass, and white glass panels are approved for indoor use only.

For best performance results make sure the warming drawer is leveled before completing installation. There is no way to level the warming drawer after it has been installed. If the installation is not level, the door may slide open or not seal tightly, allowing heat to escape.

PRODUCT DIMENSIONS

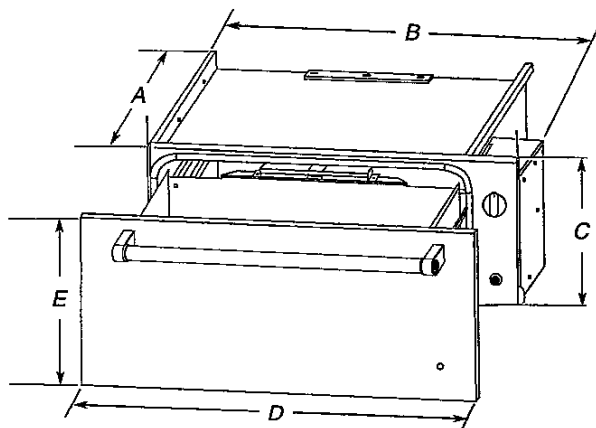

WARMING DRAWER SIZE	OVEN DEPTH (A)	RECESSED WIDTH (B)	RECESSED HEIGHT (C)	OVERALL WIDTH (D)	DRAWER FRONT HEIGHT (E)
24" (61 cm)	23½" (58.7 cm)	22¼" (56.5 cm)	9" (22.9 cm)	23¾" (60.3 cm)	10¼" (26.1 cm)
27" (68.6 cm)	23½" (58.7 cm)	25¼" (64.1 cm)	9" (22.9 cm)	26¾" (67.9 cm)	10¼" (26.1 cm)
30" (76.2 cm)	23½" (58.7 cm)	28¼" (71.8 cm)	9" (22.9 cm)	29¾" (75.6 cm)	10¼" (26.1 cm)

CABINET OPENING DIMENSIONS

Cabinet Front View

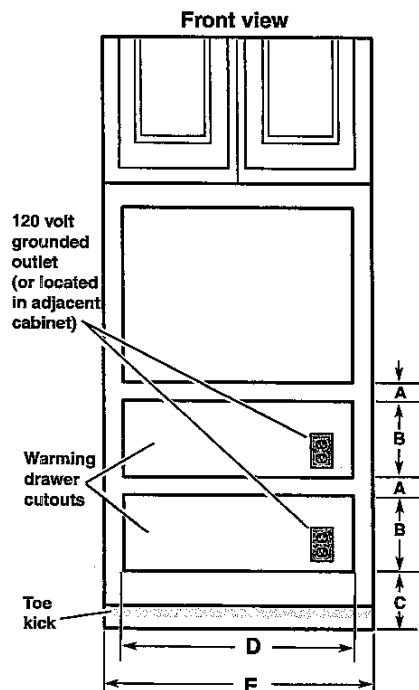

WARMING DRAWER SIZE	MINIMUM BETWEEN CUTOUTS (A)	CUTOUT HEIGHT (B)	MINIMUM/RECOMMENDED (C)	CUTOUT WIDTH (D)	MINIMUM CABINET WIDTH (E)
24" (61 cm)	2½" (6.4 cm)	9½" (23.2 cm)	1" (2.5 cm)/ 4¼" (10.8 cm)	22½" (57.1 cm)	24" (61 cm)
27" (68.6 cm)	2½" (6.4 cm)	9½" (23.2 cm)	1" (2.5 cm)/ 4¼" (10.8 cm)	25½" (64.8 cm)	27" (68.6 cm)
30" (76.2 cm)	2½" (6.4 cm)	9½" (23.2 cm)	1" (2.5 cm)/ 4¼" (10.8 cm)	28½" (72.4 cm)	30" (76.2 cm)

Warming drawer can be installed as an indoor single or double installation or installed under a single oven. Two warming drawers under a single oven are shown.

NOTE: The warming drawer cannot be leveled after being installed.

For outdoor installation follow the cutout dimensions above. Install the outdoor warming drawer in a permanent fixture.

Custom Wood Drawer Front

If you plan to install a custom wood panel to match your cabinets, we recommend consulting a qualified cabinetmaker or carpenter. The back of the wood panel must be sealed to avoid moisture damage.

30" (76.2 CM) AND 36" (91.4 CM) GAS BUILT-IN COOKTOP

PRODUCT MODEL NUMBERS

KCGS350E	KCGS950E	MGC9530D	WCG75US0D
KCGS356E	KCGS956E	MGC9536D	WCG97US0D
KCGS550E	MGC7430D	WCG51US0D	WCG97US6D
KCGS556E	MGC7536D	WCG51US6D	

GAS SUPPLY REQUIREMENTS 36"

Type of Gas

Natural Gas:

This cooktop is design-certified by CSA International for use with Natural gas or, after proper conversion, for use with LP gas.

- This cooktop is factory set for use with Natural gas. If converting to LP gas, see the "LP Gas Conversion" instructions provided in the package containing literature. The model/serial rating plate located on the underside of the cooktop base has information on the types of gas that can be used. If the types of gas listed do not include the type of gas available, check with the local gas supplier.

LP Gas Conversion:

Conversion must be done by a qualified service technician.

No attempt shall be made to convert the cooktop from the gas specified on the model/serial rating plate for use with a different gas without consulting the serving gas supplier. See the Gas Conversion instructions provided in the package containing literature.

Gas Supply Line

- Provide a gas supply line of 3/4" (1.9 cm) rigid pipe to the cooktop location. A smaller size pipe on longer runs may result in insufficient gas supply. Pipe-joint compounds that resist the action of LP gas must be used. Do not use TEFLON® tape. With LP gas, piping or tubing size should be 1/2" minimum. Usually, LP gas suppliers determine the size and materials used in the system.

Flexible metal appliance connector:

- If local codes permit, use a 1/2" or 3/4" I.D. flexible stainless steel tubing gas connector, designed by CSA to connect the cooktop to the rigid gas supply line.



- A 1/2" male pipe thread is needed for connection to the female pipe threads of the inlet to the cooktop pressure regulator.
- Do not kink or damage the flexible metal tubing when moving the cooktop.

- Must include a shutoff valve:

The supply line must be equipped with a manual shutoff valve. This valve should be located in the same room but external to the cooktop opening, such as an adjacent cabinet. It must be accessible without removing the cooktop, and it should be in a location that allows ease of opening and closing. Do not block access to shutoff valve. The valve is for turning on or shutting off gas to the cooktop.

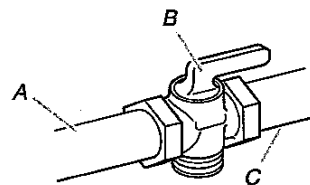

A. Gas supply line
B. Shutoff valve "open" position
C. To cooktop

®TEFLON is a registered trademark of E.I. Du Pont De Nemours and Company.

ELECTRICAL REQUIREMENTS

- A 120 volt, 60 Hz, AC only, 15-amp, fused electrical circuit is required. A time-delay fuse or circuit breaker is also recommended. It is recommended that a separate circuit serving only this cooktop be provided.
- Electronic ignition systems operate within wide voltage limits, but proper grounding and polarity are necessary. Check that the outlet provides 120-volt power and is correctly grounded.

CABINET DIMENSIONS

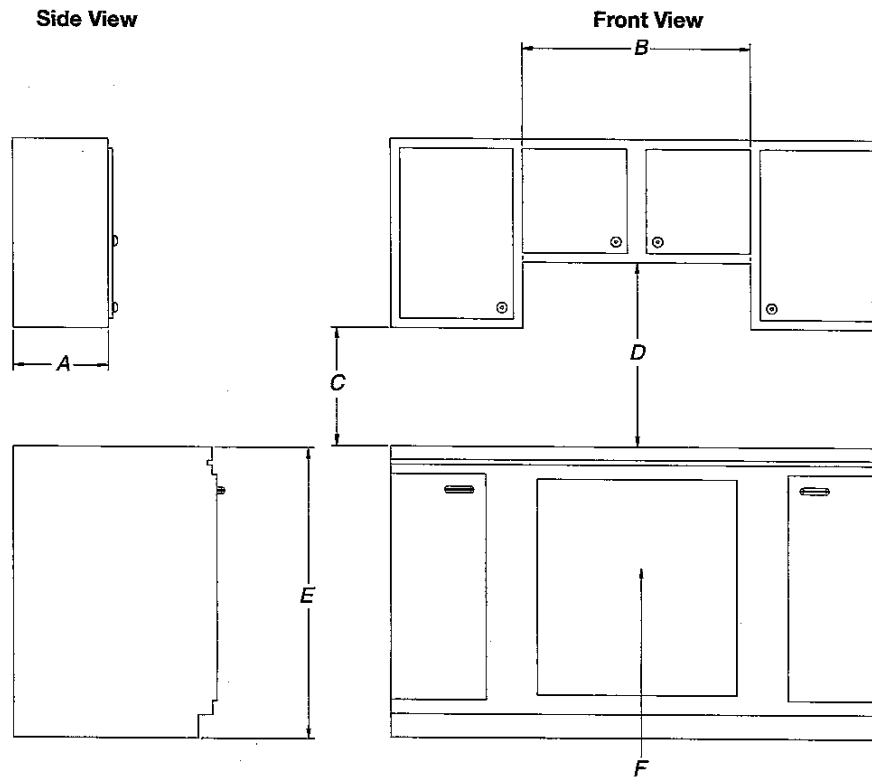

A. 13" (33.0 cm) recommended upper cabinet depth.

B. 30" (76.2 cm) for 30" models; 36" (91.4 cm) for 36" models.

C. 18" (45.7 cm) minimum clearance from upper cabinet to countertop within minimum horizontal clearances to cooktop.

D. 30" (76.2 cm) minimum clearance between top of cooktop platform and bottom of uncovered wood or metal cabinet. 24" [61 cm] minimum clearance if bottom of wood or metal cabinet is covered by not less than 1/4" [0.6 cm] flame retardant millboard covered with not less than No. 28 MSG sheet steel, 0.015" [0.04 cm] stainless steel, or 0.024" [0.06 cm] aluminum or 0.020" [0.05 cm] copper

E. 36" (91.4 cm) top of countertop to floor.

F. Gas line opening - Wall: anywhere 5" (12.7 cm) below underside of countertop. Cabinet floor: anywhere within 6" (15.2 cm) of rear wall is recommended.

KitchenAid®

FOR THE WAY IT'S MADE.®

Undercounter Dishwasher

PRODUCT MODEL NUMBERS

KDFE204E, KDTE104E, **KDTE204E**, KDTE254E, KDTM354E, KDTM384E, KDTM404E, KDTM504E, KDTM704E, KDTM804E

Electrical Requirements: 120-volt, 60 Hz, AC-only, 15- or 20-amp. fused electrical supply. Copper wire only. A time delay fuse or circuit breaker and separate circuit is recommended.

If direct wiring dishwasher: Use flexible, armored or nonmetallic, sheathed copper wire with grounding wire that meets the wiring requirements for your home and local codes and ordinances.

Use a UL Listed or CSA Approved conduit connector.

If connecting dishwasher with a power supply cord:

Use power supply cord kit (Part Number 4317824) marked for use with dishwashers. Follow the kit instructions for installing the power supply cord.

Power supply cord must plug into a grounded three-prong outlet located in the cabinet next to the dishwasher opening. Outlet must meet all local codes and ordinances.

Water Supply Requirements: A hot water line with 20 to 120 psi (138 to 862 kPa) water pressure. Water temperature must be 120°F (49°C) water at dishwasher. Use $\frac{3}{8}$ " O.D. copper tubing with compression fitting or flexible braided water supply line

Note: $\frac{1}{2}$ " minimum plastic tubing is not recommended.

Use a 90° elbow with $\frac{3}{4}$ " hose connection with rubber washer (part number W10273460). Do not solder within 6" (15.2 cm) from water inlet valve.

Drain Requirements: A new drain hose is supplied with your dishwasher. If this is not long enough, use a new drain hose with a maximum length of 12' (3.7 m) (Part No. 3385556) that meets all current AHAM/IAPMO test standards, is resistant to heat and detergent, and fits the 1" (2.5 cm) drain connector of the dishwasher.

Make sure to connect the drain hose to waste tee or disposer inlet above drain trap in house plumbing and 20" (50.8 cm) minimum above the floor. It is recommended

that the drain hose either be looped up and securely fastened to the underside of the counter, or be connected to an air gap.

Make sure to use an air gap if the drain hose is connected to house plumbing lower than 20" (50.8 cm) above subfloor or

floor.

Use $\frac{1}{2}$ " (1.3 cm) minimum I.D. drain line fittings.

If required, the air gap should be installed in accordance with the air gap installation instructions. When connecting the air gap a rubber hose (not provided) will be needed to connect to the waste tee or disposer inlet.

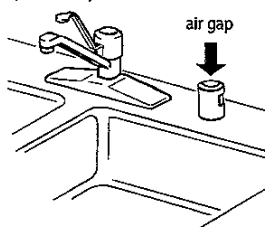

PRODUCT DIMENSIONS

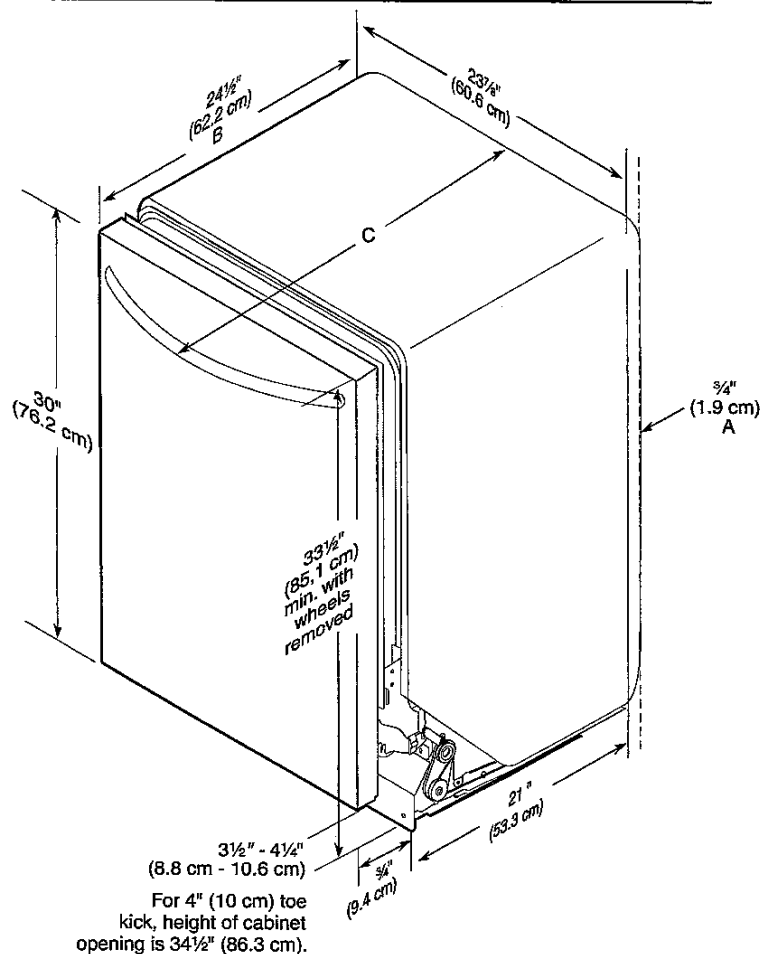

A. Insulation may be compressed (not used on all models).

B. For panel-ready models, dishwasher depth is 24" (60 cm) not including the $\frac{3}{4}$ " (1.9 cm) custom door panel.

C. Door handles may protrude forward of the face of the dishwasher; varies by model.

KitchenAid®

FOR THE WAY IT'S MADE®

PRODUCT MODEL NUMBERS

KRMF606E

KRMF706E

Electrical: A 115 volt, 60 Hz, AC only, 15- or 20-amp fused, grounded electrical supply is required. It is recommended that a separate circuit serving only your refrigerator be provided. Use an outlet that cannot be turned off by a switch. Do not use an extension cord.

Water: A cold water supply with water pressure between 35 and 120 psi (241 and 827 kPa) is required to operate the water dispenser and ice maker. If you have questions about your water pressure, call a licensed, qualified plumber.

NOTE: If the water pressure is less than what is required, the flow of water from the water dispenser could decrease or ice cubes could be hollow or irregular shaped.

Reverse Osmosis Water Supply:

IMPORTANT: The pressure of the water supply coming out of a reverse osmosis system going to the water inlet valve of the refrigerator needs to be between 35 and 120 psi (241 and 827 kPa).

If a reverse osmosis water filtration system is connected to your cold water supply, the water pressure to the reverse osmosis system needs to be a minimum of 40 to 60 psi (276 to 414 kPa).

Bottom Mount Refrigerator

PRODUCT DIMENSIONS

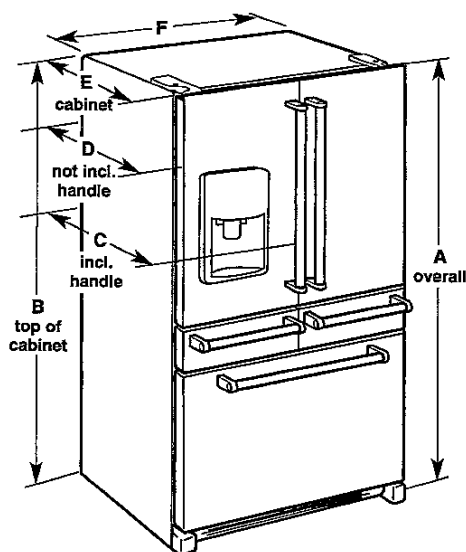

Model Size	Height - Overall "A"	Height - Top of Cabinet "B"	Depth - With Handles "C"	Depth - Without Handles "D"	Depth - Cabinet Only "E"	Width - Cabinet "F"
25.8	70 1/8" (178.1 cm)	68 3/8" (173.7 cm)	36 1/4" (92.1 cm)	34 1/2" (87.7 cm)	29" (73.7 cm)	36" (91.4 cm)

LOCATION REQUIREMENTS

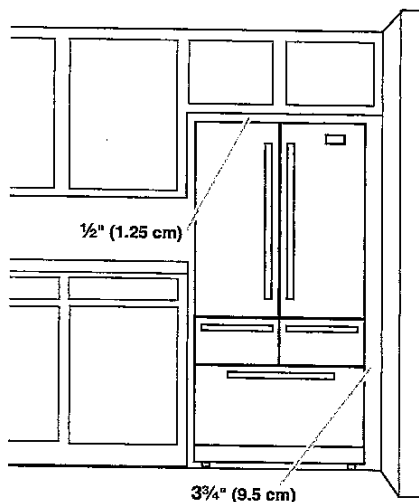

IMPORTANT: This refrigerator is designed for indoor, household use only.

To ensure proper ventilation for your refrigerator, allow for a 1/2" (1.25 cm) of space on each side and at the top. Allow for a 1" (2.54 cm) space behind the refrigerator. If your refrigerator has an ice maker, allow extra space at the back for the water line connections. When installing your refrigerator next to a fixed wall, leave a 3/4" (9.5 cm) minimum space between the refrigerator and wall to allow the door to swing open.

NOTE: This refrigerator is intended for use in a location where the temperature ranges from a minimum of 55°F (13°C) to a maximum of 110°F (43°C). The preferred room temperature range for optimum performance, which reduces electricity usage and provides superior cooling, is between 60°F (15°C) and 90°F (32°C). It is recommended that you do not install the refrigerator near a heat source, such as an oven or radiator.