

Brampton Encore - 96 - 1 - 41-5 Elev.A BRAHMS OPT - GFA1
CENTRAL VAC AND WIRING

Inv.419	1 - FAMILY ROOM: INSTALL CONDUIT PIPE- FOR TELEVISION- MUST SPECIFY LOCATION AND TERMINATION POINT. SEE FLOOR PLAN
Line4988	Note:
12Apr16 / 20Apr16	
Inv.419	1 - BEDROOM #4: RG 6 WIRING - INSTALL ROUGH-IN RG 6- IN BED #4. SEE FLOOR PLAN
Line4990	Note:
12Apr16 / 20Apr16	
Inv.419	1 - DEN: RG 6 WIRING - INSTALL ROUGH-IN RG 6- IN DEN. SEE FLOOR PLAN
Line4991	Note:
12Apr16 / 20Apr16	
Inv.419	1 - NANNY BEDROOM: RG 6 WIRING - INSTALL ROUGH-IN RG 6- IN NANNY BEDROOM. SEE FLOOR PLAN
Line4992	Note:
12Apr16 / 20Apr16	

CERAMIC

Inv.796	1 - FOYER: INSTALL Floor Upgrade 1 Foyer Vestibule Floor
Line10642	Note:
29Aug16 / 8Sep16	
Inv.796	1 - KITCHEN: INSTALL Floor Upgrade 1 Kitchen and Breakfast Floor with Servery
Line10643	Note:
29Aug16 / 8Sep16	
Inv.796	1 - POWDER ROOM: ISNTALL Floor Upgrade 1 Powder Room Floor
Line10644	Note:
29Aug16 / 8Sep16	
Inv.796	1 - GROUND FLOOR BATH (NANNY SUITE): INSTALL Floor Upgrade 1 Nanny Bath Floor
Line10645	Note:
29Aug16 / 8Sep16	
Inv.796	1 - MASTER ENSUITE: INSTALL Floor Upgrade 1 Ensuite Bath Floor
Line10646	Note:
29Aug16 / 8Sep16	

ELECTRICAL

Inv.419	1 - TELEPHONE AND CABLE ROUGH-IN LOCATIONS. SEE SKETCH
Line4987	Note:
12Apr16 / 20Apr16	
Inv.419	1 - FAMILY ROOM: INSTALL 110V WALL RECEPTACLE ON DEDICATED CIRCUIT - ABOVE FIREPLACE
Line4989	Note:
12Apr16 / 20Apr16	
Inv.419	1 - KITCHEN: INSTALL 110V WALL RECEPTACLE ON DEDICATED CIRCUIT - FOR FUTURE MICROWAVE - MICROWAVE NOT INCLUDED. CABINETRY TO BE PURCHASED AT THE TIME OF COLOURS
Line4993	Note:
12Apr16 / 20Apr16	

Brampton Encore - 96 - 1 - 41-5 Elev.A BRAHMS OPT - GFA1

Inv.419	1 - KITCHEN: INSTALL 220V WALL RECEPTICAL ON DEDICATED CIRCUIT- FOR FUTRE 4 WIRE BUILT-IN WALL OVEN - SEE SKETCH. CABINERY TO BE PURCHASED AT THE TIME OF COLOUR APPOINTMENT
Line4994	Note:
12Apr16 / 20Apr16	
Inv.419	1 - BASEMENT: INSTALL 200 AMP ELECTRICAL SERVICE
Line4995	Note:
12Apr16 / 20Apr16	
Inv.419	1 - LIVING ROOM: INSTALL ROUGH - IN CEILING OUTLET & SWITCH (WITH COVER PLATE) - DOES NOT INCLUDE FIXTURE - MUST SPECIFY LOCATION. NOTE LOCATION OF STANDARD DINING ROOM LIGHT. KEEP BUILDER'S STANDARD SWITCH CONTROLLED RECEPTICAL
Line4996	Note:
12Apr16 / 20Apr16	
Inv.419	1 - KITCHEN: INSTALL KITCHEN CABINET VALANCE LIGHTS (UNDER CABINETS) - WITH STRIP LIGHTS - DOES NOT INCLUDE (AND REQUIRES) KITCHEN UPGRADE PRICING
Line4997	Note:
12Apr16 / 20Apr16	

EXTERIOR COLOURS

Inv.450	1 - EXTERIOR COLOUR PACKAGE 4
Line5468	Note:
26Apr16 / 26Apr16	

FIREPLACE AND MANTLE

Inv.796	1 - FAMILY ROOM: INSTALL UPGRADED Flush Mount NF100Does Not Include Fireplace. IN LIEU OF BUILDER'S STANDARD MODELS
Line10650	Note:
29Aug16 / 8Sep16	

FORMING

Inv.419	1 - EXTERIOR: INSTALL SIDE DOOR- HOME TO EXTERIOR- AS PER PLAN AND GRADE PERMITTING
Line4998	Note:
12Apr16 / 20Apr16	

FRAMING

Inv.419	1 - SECOND FLOOR: SMOOTH CEILINGS - (3-Story Design) 2ND FLOOR
Line5000	Note:
12Apr16 / 20Apr16	
Inv.419	1 - BEDROOM #4: SHOWER IN LIEU OF TUB- INCLUDES FRAMED GLASS SHOWER ENCLOSURE- MUST ADD PLUMBING NOTE
Line5002	Note:
12Apr16 / 20Apr16	
Inv.419	1 - MAIN FLOOR: FIVE (5) STANDARD DOORS EXTENDED HEIGHT 96" (PRICE PER DOOR) MAIN FLOOR 3 STOREY MODELS - INCLUDE FRAMING NOTE. TO GO IN POWDER ROOM, 3 CLOSET DOORS, AND PANTRY. SEE SKETCH
Line5374	Note:
12Apr16 / 20Apr16	

Brampton Encore - 96 - 1 - 41-5 Elev.A BRAHMS OPT - GFA1

Inv.419	1 - MAIN FLOOR: TWO (2) STANDARD FRENCH DOORS EXTENDED HEIGHT 96" (PRICE PER DOOR) MAIN FLOOR 3 STOREY MODELS - INCLUDE FRAMING NOTE. TWO DOORS AT DEN. SEE SKETCH
Line5375	Note:
12Apr16 / 20Apr16	
Inv.486	1 - OPTIONAL GROUND FLOOR LAYOUT
Line5844	Note:
5May16 / 5May16	

GARAGE DOORS

Inv.419	1 - GARAGE: ONE DIGITAL ENTRY KEYPAD.
Line5006	Note:
12Apr16 / 20Apr16	
Inv.419	2 - GARAGE: TWO (2) EXTRA REMOTE CONTROLS FOR GARAGE DOORS
Line5007	Note:
12Apr16 / 20Apr16	
Inv.419	2 - GARAGE: INSTALL TWO (2) GARAGE DOOR OPENERS - WITH 1 REMOTE EACH- PRICE IS PER DOOR
Line5008	Note:
12Apr16 / 20Apr16	

GLASS AND MIRROR

Inv.419	1 - BEDROOM #4: SHOWER IN LIEU OF TUB- INCLUDES FRAMED GLASS SHOWER ENCLOSURE
Line5373	Note:
12Apr16 / 20Apr16	

GRANITE MARBLE QUARTZ

Inv.796	1 - KITCHEN: INSTALL 2 CM GRP 1 Optional Flush BBar
Line10629	Note:
29Aug16 / 8Sep16	
Inv.796	1 - TWIN BATH: INSTALL 2 CM GRP 1 Twin Bath
Line10635	Note:
29Aug16 / 8Sep16	
Inv.796	1 - MASTER ENSUITE: INSTALL 2 CM GRP 2 Master Ensuite
Line10637	Note:
29Aug16 / 8Sep16	
Inv.796	1 - KITCHEN: INSTALL 2 CM GRP 1 Kitchen with Island no BBar and Servery
Line10628	Note:
29Aug16 / 8Sep16	
Inv.796	1 - GROUND FLOOR BATH (NANNY SUITE): INSTALL 2 CM GRP 2 Optional Ground Floor Ensuite
Line10634	Note:
29Aug16 / 8Sep16	
Inv.796	1 - ENSUITE 2 (BED #4): INSTALL 2 CM GRP 1 IN Ensuite 2 (BED #4)
Line10636	Note:
29Aug16 / 8Sep16	

Brampton Encore - 96 - 1 - 41-5 Elev.A BRAHMS OPT - GFA1

Inv.796	1 - KITCHEN: CUT OUT FOR 30" COOKTOP. SEE SPECS ATTACHED
Line10652	Note:
29Aug16 / 8Sep16	

HARDWOOD

Inv.796	1 - UPPER HALL: INSTALL 4 1/4" PROVERCO HARDWOOD IN NATURAL FINISH IN Upper Hall
Line10649	Note:
29Aug16 / 8Sep16	

HVAC

Inv.419	1 - KITCHEN: GAS LINE ROUGH - MAIN FLOOR - (3 STOREY MODELS) FOR STOVE
Line5005	Note:
12Apr16 / 20Apr16	

INTERIOR TRIM AND DOORS

Inv.419	5 - MAIN FLOOR: FIVE (5) STANDARD DOORS EXTENDED HEIGHT 96" (PRICE PER DOOR) MAIN FLOOR 3 STOREY MODELS - INCLUDE FRAMING NOTE. TO GO IN POWDER ROOM, 3 CLOSET DOORS, AND PANTRY. SEE SKETCH
Line5011	Note:
12Apr16 / 20Apr16	
Inv.419	2 - MAIN FLOOR: TWO (2) STANDARD FRENCH DOORS EXTENDED HEIGHT 96" (PRICE PER DOOR) MAIN FLOOR 3 STOREY MODELS - INCLUDE FRAMING NOTE. TWO DOORS AT DEN. SEE SKETCH
Line5012	Note:
12Apr16 / 20Apr16	

KITCHEN AND BATH CABINETRY

Inv.796	1 - KITCHEN: ISNTALL Oak PVC 112 Built in wall oven and microwave oven and cooktop with countertop by others 242cm. SEE SKETCH FOR LOCATION
Line10651	Note:
29Aug16 / 8Sep16	
Inv.796	1 - KITCHEN: INSTALL UPG 1 GRP III Opt Light Valance
Line10653	Note:
29Aug16 / 8Sep16	
Inv.796	2 - KITCHEN: INSTALL Oak PVC 50 Matching Interior Single Door cabinet 100cm h. TO GO ON TWO CABINETS, ONE ON EITHER SIDE OF STOVE. SEE SKETCH ATTACHED.
Line10654	Note:
29Aug16 / 8Sep16	
Inv.796	2 - KITCHEN: INSTALL TWO Oak PVC 02 Plain Clear Std White Interior 100cm h. TO GO ON TWO CABINETS, ONE ON EITHER SIDE OF STOVE. SEE SKETCH ATTACHED
Line10655	Note:
29Aug16 / 8Sep16	

MISC.

Inv.419	1 - BONUS PACKAGE: \$10,000.00 (INCLUDING TAXES) WORTH OF UPGRADES FROM GOLD PARK HOMES DECOR CENTRE HAS BEEN USED TOWARD THIS STRUCTURAL APPOINTMENT
Line5015	Note:
12Apr16 / 20Apr16	

Brampton Encore - 96 - 1 - 41-5 Elev.A BRAHMS OPT - GFA1

Inv.419	1 - Purchaser has attended a colour chart appointment at the Decor Centre & has DECLINED any additional upgrades and accepts and acknowledges that there will be no further structural changes/additions/deletions to be made upon signing on April 12,2016
Line5016	Note:
12Apr16 / 20Apr16	
Inv.419	1 - Purchasers are aware & accepts that ANY changes made to upgrades after signing this Purchasers Extra Form are subject to a minimum administration fee of \$500. PLUS a 10% holdback fee
Line5017	Note:
12Apr16 / 20Apr16	
Inv.796	1 - Purchaser has attended a Colour appointment at the Decor Centre & has DECLINED any additional upgrades and accepts and acknowledges that there will be no further structural changes/additions/deletions to be made upon signing on August 29, 2016
Line10657	Note:
29Aug16 / 8Sep16	
Inv.796	1 - Purchasers are aware & accepts that ANY changes made to upgrades after signing this Purchasers Extra Form are subject to a minimum administration fee of \$500. PLUS a 10% holdback fee
Line10658	Note:
29Aug16 / 8Sep16	
Inv.796	1 - GRANITE WAIVER Due to the many variables that can affect the pattern, colour and/or design and "pitting" of natural products, granite installed will not be identical to the samples displayed.
Line10659	Note: Every effort is made to provide granite counter tops as close as possible but the vendor is not responsible for results which differ from the sample displayed. All countertop surfaces may have seems & product pattern & shade can change in areas containing seems.
29Aug16 / 8Sep16	

PLUMBING

Inv.419	1 - EXTERIOR: HOSE BIB - STANDARD TO UPGRADED WITH HOT AND COLD WATER VALVE. IN THE GARAGE
Line5001	Note:
12Apr16 / 20Apr16	
Inv.419	1 - KITCHEN: ROUGH-IN - WATERLINE FOR FRIDGE
Line5013	Note:
12Apr16 / 20Apr16	
Inv.419	1 - BASEMENT: INSTALL ROUGH-IN - 3PC BASEMENT ROUGH-IN. AS PER FLOOR PLAN
Line5014	Note:
12Apr16 / 20Apr16	
Inv.419	1 - BEDROOM #4: SHOWER IN LIEU OF TUB- INCLUDES FRAMED GLASS SHOWER ENCLOSURE- MUST ADD PLUMBING NOTE
Line5372	Note: see framing note
12Apr16 / 20Apr16	
Inv.796	2 - MASTER ENSUITE: INSTALL UNDERMOUNT SINK (X2) IN MASTER ENSUITE VANITY CONTRAC MODEL # CALVIN 4220CFY, 19 1/4" OVAL
Line10638	Note:
29Aug16 / 8Sep16	
Inv.796	1 - GROUND FLOOR BATH: INSTALL UNDERMOUNT SINK (X1) IN GROUND FLOOR BATH VANITY CONTRAC MODEL # CALVIN 4220CFY, 19 1/4" OVAL
Line10639	Note:
29Aug16 / 8Sep16	

Brampton Encore - 96 - 1 - 41-5 Elev.A BRAHMS OPT - GFA1

Inv.796	2 - TWIN BATH: INSTALL UNDERMOUNT SINK (X2) IN TWIN BATH VANITY
Line10640	CONTRAC MODEL # CALVIN 4220CFY, 19 1/4" OVAL Note:
29Aug16 / 8Sep16	
Inv.796	1 - ENSUITE #2 (BED #4): INSTALL UNDERMOUNT SINK (X2) IN ENSUITE #2 (BED #4) VANITY
Line10641	CONTRAC MODEL # CALVIN 4220CFY, 19 1/4" OVAL Note:
29Aug16 / 8Sep16	

STAIRS AND RAILINGS

Inv.796	1 - STAIRCASE: INSTALL UPGRADED RAILING: EUROLINE R 6 Black THROUGHOUT.
Line10662	Note: BASEMENT STAIRS ARE STANDARD
29Aug16 / 8Sep16	
Inv.796	1 - STAIRCASE: INSTALL V Groove Handrail THROUGHOUT, WHERE APPLICABLE
Line10663	Note: BASEMENT STAIRS ARE STANDARD
29Aug16 / 8Sep16	

WINDOWS - BASEMENT

Inv.419	2 - BASEMENT: INSTALL TWO (2) BASEMENT WINDOWS - UPGRADE EXISTING BASEMENT WINDOW TO 30 INCH X 16 INCH ON SIDE OF HOUSE. SEE SKETCH.MAY REQUIRE INSTALLATION OF WINDOW WELL. TO GO AT THE REAR OF THE HOUSE
Line5003	Note:
12Apr16 / 20Apr16	
Inv.419	1 - BASEMENT: INSTALL ONE (1) BASEMENT WINDOW - UPGRADE EXISTING BASEMENT WINDOW TO 30 INCH X 24 INCH - MAY REQUIRE INSTALLATION OF WINDOW WELL. TO GO AT THE REAR OF THE HOUSE
Line5004	Note:
12Apr16 / 20Apr16	

WINDOWS AND DOORS

Inv.419	1 - GARAGE: INSTALL MAN DOOR GARAGE TO HOUSE - OPTIONAL - IF GRADE PERMITS
Line4999	Note:
12Apr16 / 20Apr16	

Layout Changes: ☒ Yes ☐ No

Sketch Attached: ☒ Yes ☐ No

Exterior Colour Scheme:

1. Cabinetry

	Style and Colour	Counter	Hardware
Kitchen / Breakfast	Venice(pvc)ChocMaple	*Upg.1 New Venetian Gold Granite Edge:F20	cs1-24
Laundry Room			
Powder Room			
Twin Bath	Carrara(pvc)VanillaStix	*Upg.1 Black Pearl Granite Edge: F20	cs1-22
Master Ensuite Bathroom	Varese(pvc)ChocMaple	*Upg.2 Volakis, Marble Edge: F20	cs1-23
Second Ensuite Bathroom (If Applicable)	Toscana(pvc)AntqWhite	*Upg.1 Escarpment Dark Marble Edge: F20	cs1-25
Ground Floor Bath	Venice(pvc)ItalianWalnu	*Upg.2 Ghibli Granite Edge: F20	cs1-24
Dishwasher Cabinet	N/A		

Comment

GROUND FLOOR BAR: Cabinet: Venice(pvc)ChocMaple, Counter: 6696-46 Carrara Bianco Laminate, Edge: CS1-24

2. Floor Tile

	Selection	Grout	Threshold
Entrance Vestibule	*Upg.1 CarraraSeries White/GreyMatte13x13	N/A	N/A
Main Hall			
Kitchen / Breakfast	*Upg.1 CarraraSeries White/GreyMatte13x13	N/A	N/A
Laundry Room	Serpentine, Beyaz 13 x 13	N/A	N/A
Powder Room	*Upg.1 CarraraSeries White/GreyMatte13x13	N/A	N/A
Twin Bath	Reflex, Olive 13 x 13	N/A	N/A
Master Ensuite Bathroom	*Upg.1 CarraraSeries White/GreyMatte13x13	N/A	N/A
Second Ensuite Bathroom (If Applicable)	Reflex, Bone 13 x 13	N/A	N/A
Lower Landing (If Applicable)			
Ground Floor Bath	*Upg.1 CarraraSeries White/GreyMatte13x13	N/A	N/A

Comment

GARAGE ENTRANCE LANDING: Serpentine, Beyaz 13 x 13

3. Wall Tile

	Selection	Listello/Inserts	Describe
Twin Bath	Reflex Olive, 8 x 10	<input type="radio"/> Yes <input checked="" type="radio"/> No	
Master Ensuite Bathroom			
Tub Deck	N/A	<input type="radio"/> Yes <input checked="" type="radio"/> No	
Shower Stall	Weave White 8 x 10	<input type="radio"/> Yes <input checked="" type="radio"/> No	
Bathroom Walls	N/A	<input type="radio"/> Yes <input checked="" type="radio"/> No	
Second Ensuite Bathroom (If Applicable)	Reflex Bone 8x 10	<input type="radio"/> Yes <input checked="" type="radio"/> No	
Ground Floor Bath	Weave White 8 x 10	<input type="radio"/> Yes <input checked="" type="radio"/> No	

Kitchen Backsplash

☐ Yes ☒ No

Backsplash Behind Fridge

Comment

SECOND ENSUITE (BED #4): COORDINATING SHOWER FLOOR TILES TO BE DETERMINED BY BUILDER

Scheduled Closing Date: Tuesday, October 04, 2016

Purchasers: Manvir Singh Bajwa & Harvinderkaur Manvir

Property: 96 of Plan -

Telephone Res. / Bus: (416) 805-5357

Project: Fieldwalk Investments Inc.

Decor Advisor: Terri Parisani

Model and Elevation: 41-5 Elev.A BRAHMS OPT - GFA1

4. Plumbing Fixtures

<input type="text"/>	Second Ensuite	<input type="text"/>	Powder Room	<input type="text"/>
Master Ensuite Bathroom	<input type="text"/>	Other Room - Specify	<input type="text"/>	Other Washroom
		<input type="text"/>		

Comment

*ALL PLUMBING FIXTURES TO BE WHITE

*UNDERMOUNT SINKS TO GO IN : MASTER, TWIN BATH, ENSUITE 2, AND GROUND FLOOR BATH. SEE INVOICE FOR MODEL #

5. Hardwood Flooring

	Type and Stain		Type and Stain
Main Hall	STD. Preverco 4 1/4, Natural	Upper Landing	STD. Preverco 4 1/4, Natural
Kitchen / Breakfast	-	Upper Hall	*UPG. Preverco 4 1/4, Natural
Living Room	STD. Preverco 4 1/4, Natural	Master Bedroom	-
Dining Room	STD. Preverco 4 1/4, Natural	Bedroom #2	-
Family Room	STD. Preverco 4 1/4, Natural	Bedroom #3	-
Den/Library	STD. Preverco 4 1/4, Natural	Bedroom #4	-
Entrance Vestibule	-	Bedroom #5	-
Lower Landing (If Applicable)	STD. Preverco 4 1/4, Natural	Other Room - Specify	-
		<input type="text"/>	

Comment
6. Carpeting

	Upgrade	Description
Main Hall	<input type="checkbox"/>	-
Living Room	<input type="checkbox"/>	-
Dining Room	<input type="checkbox"/>	-
Family Room	<input type="checkbox"/>	-
Den/Library	<input type="checkbox"/>	-
Upper Hall	<input type="checkbox"/>	-
Master Bedroom	<input type="checkbox"/>	T-04
Bedroom #2	<input type="checkbox"/>	T-04
Bedroom #3	<input type="checkbox"/>	T-04
Bedroom #4	<input type="checkbox"/>	T-04
Bedroom #5	<input type="checkbox"/>	T-04 (NANNY BDRM)
GROUND FL REC RM	<input type="checkbox"/>	T-04
Upper Landing (If Applicable)	<input type="checkbox"/>	-
Lower Landing (If Applicable)	<input type="checkbox"/>	-

Upgrade Underpad	Type NONE	Area <input type="text"/>
Carpet on Stairs	Capped NONE	Runner - *Upgrade NONE

Comment

Scheduled Closing Date: Tuesday, October 04, 2016

Purchasers: Manvir Singh Bajwa & Harvinderkaur Manvir

Property: 96 of Plan -

Telephone Res. / Bus: (416) 805-5357

Project: Fieldwalk Investments Inc.

Decor Advisor: Terri Parisani

Model and Elevation: 41-5 Elev.A BRAHMS OPT - GFA1

7. Fireplace

	Living Room			Family Room			Other Room - Specify		
	Purchased	As Per Plan	N/A	Purchased	As Per Plan	N/A	Purchased	As Per Plan	N/A
Fireplace Type	<input type="radio"/>	<input type="radio"/>	<input checked="" type="radio"/>	<input type="radio"/>	<input checked="" type="radio"/>	<input type="radio"/>	<input type="radio"/>	<input type="radio"/>	<input checked="" type="radio"/>
Mantle Type				UPGRADE					
Colour / Stain				NF100					
Surround				WHITE PAINT-GRADE					
Hearth				BIANCO CARRARA					
Hearth				NONE					
Comment									

8. Trim Carpentry

Interior Doors	STD	Front Door Glass Inserts	STD	Door Handles	STD
Interior Trim	STD				
Comment	INTERIOR DOORS ARE EXTENDED ON MAIN FLOOR, STANDARD MODEL. INCLUDES TWO FRENCH DOORS				

9. Plaster Mouldings and Medallions

Entrance Vestibule	NONE		Kitchen/Breakfast	NONE	
Main Hall	NONE		Den/Library	NONE	
Living Room	NONE		Lower Landing	NONE	
Dining Room	NONE		Other Room - Specify	NONE	
Family Room	NONE				
Comment					

10. Railings and Spindles

Railing Package	*UPG. Euroline R6 Black with V-Groove Handrail		
Railing Colour	Natural	Spindle Colour	Natural
Stringer / Riser	Natural	Treads	Natural
Comment	Oak Stairs <input checked="" type="radio"/> Yes <input type="radio"/> No		
Basement stairs are paint-grade			

11. Wall Paint

Main & Upper Hall	Birch White	Master Bedroom	Birch White
Living Room	Birch White	Bedroom #2	Birch White
Dining Room	Birch White	Bedroom #3	Birch White
Kitchen / Breakfast	Birch White	Bedroom #4	Birch White
Family Room	Birch White	Bedroom #5	Birch White (nanny)
Powder Room	Birch White	Master Ensuite	Birch White
Laundry Room	Birch White		
Den/Library	Birch White	Second Ensuite	Birch White
Trim Paint	Birch White		
Comment	Smooth Ceilings First Floor		

Scheduled Closing Date: Tuesday, October 04, 2016

Purchasers: Manvir Singh Bajwa & Harvinderkaur Manvir

Property: 96 of Plan -

Telephone Res. / Bus: (416) 805-5357

Project: Fieldwalk Investments Inc.

Decor Advisor: Terri Parisani

Model and Elevation: 41-5 Elev.A BRAHMS OPT - GFA1

12. Electrical

Plugs and Switches ☒ White ☐ Ivory

Above Kitchen Cabinet Light ☐ Yes ☒ No

Hood Fan ☐ White ☐ Ivory

Below Kitchen Cabinet Light ☒ Yes ☐ No

Appliances

Built in Cooktop

Built in Oven

Gas Stove

Microwave

☒ Yes ☐ No

☒ Yes ☐ No

☒ Yes ☐ No

☒ Yes ☐ No

Comment

See specs attached

13. Heating and Air Conditioning

Air Conditioning

Gas Provisions Stove

Gas Provisions Dryer

Gas Provisions Barbecue

Comment

Upgraded to have a gas line for stove
BBQ gas line is included in offer

14. Additional Comments

15. Disclaimers and Notes

- Colours of all materials are as close as possible to builder's selection, but not necessarily identical due to variances in manufacturing.
- Any extras listed above are null and void unless accompanied by a separate invoice/amendment. Said invoice must be paid in full.
- The Purchaser acknowledges that after Interior Colour Selection form is signed and dated, no further changes will be permitted other than re-selection due to unavailability. _____ Purchaser's Initials
- The Purchaser acknowledges reading and accepting the "Gold Park Homes Decor Centre Disclaimers" form. This document contains other miscellaneous disclaimers.

This Interior Colour Selection is final and approved by:

Signature: 

Date: 8/29/2016

Signature: 

Date: 8/29/2016

Trade Name: Gold Park Homes	Site location: Brampton	Model: 41-5
Address:	Project: Encore	Phase:

This layout has been explained to the purchaser by Cortina Kitchens Inc. and is understood by the purchaser.

KITCHEN

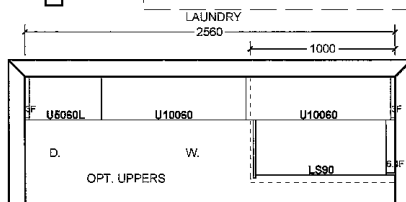
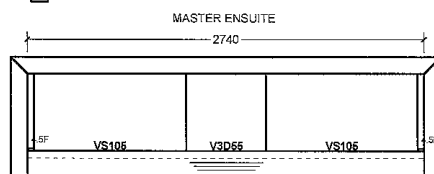
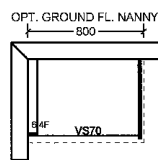
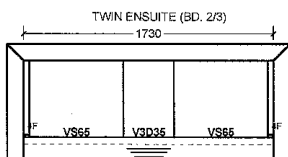
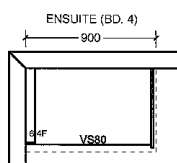
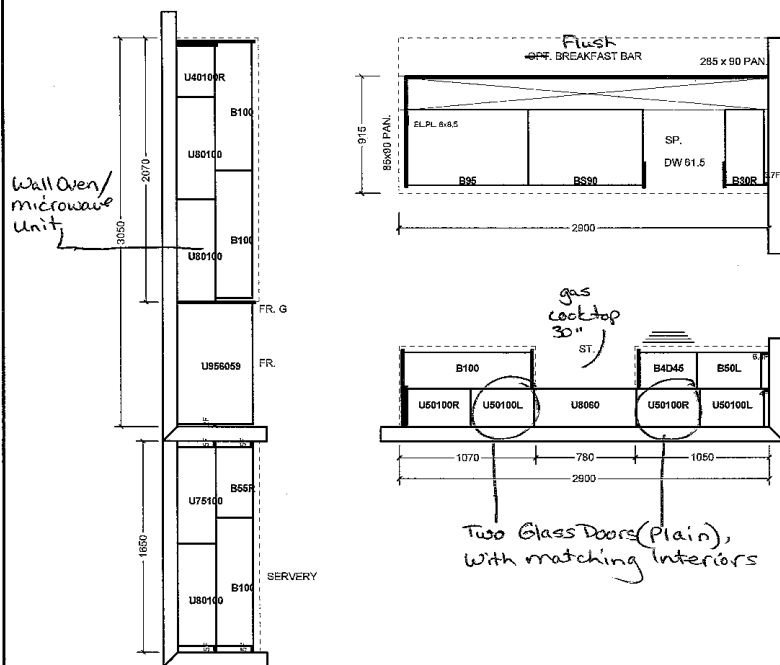

All prices subject to confirmation from head office.
This quotation is subject to the terms & conditions set out

ACCEPTED DATE: _____

All agreements are contingent upon strikes, accidents, and delays beyond our control. Please provide our installer with template for sinkholes or \$150.00 will be charged for callback.

Item A: Wood grain and colour are characteristics of the product. We cannot guarantee that such grain and colour will always match.
Item B: Corina Kitchens Inc. reserves the right to alter dimensions and make technical changes without notice.

Lot 96
Aug. 29, 16



CORTINA

KITCHENS INC.

70 Regina Road Woodbridge ON L4L 8L6
905-264-6464

INFORMATION - PVC DOORS

Builder.. Gold Park Homes .. Project. Encore Brampton .. Lot # 96 ..

All cabinets with PVC (Thermofoil) Doors come with melamine gables, panels and kick. The doors, crown moulding and light valance are PVC wrapped. Open shelves incorporated in design will only be available with melamine interiors. There will be variations in colour shades between the PVC parts (doors, crown and Light valance) and the melamine parts (open shelves, Gables , Panels and Kick) due to the difference in material.

Furring Panel with crown moulding to the ceiling is not available on all PVC door styles due to subtle variations in colour shades between the PVC parts (moulding) and the melamine parts (furring panel) due to the difference in material. Grain directions in wood grain pattern melamine , vary between the furring panel, crown moulding (horizontal) and the PVC doors (vertical).

Thank you for your understanding.

I am well informed of this information, and agree to the purchase of the above.

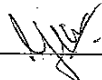
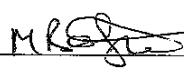
Purchaser:  MRS. 

Date: 8/29/2016

Electrical - (E)

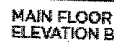

Telephone — ①
 Cable — ②

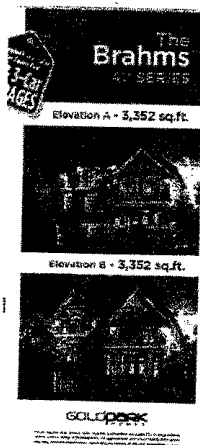
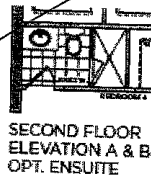
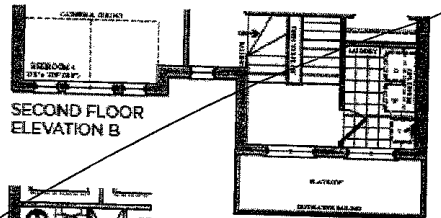
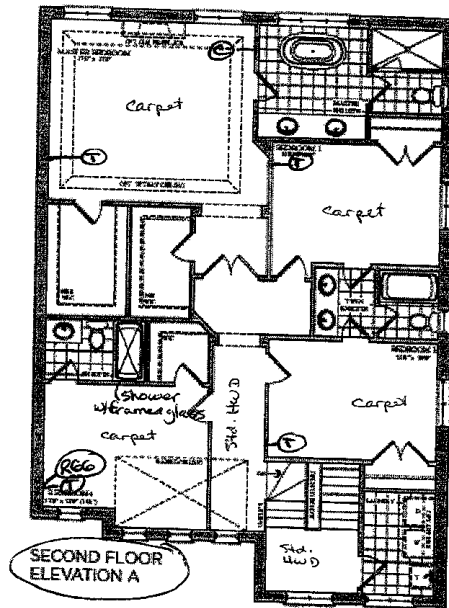

Lot 96
 Aug 29, 16
 ① ②

Lot 96
 April 12, 2016
 ① ②

Telephone — (T)
 Cable — (C)

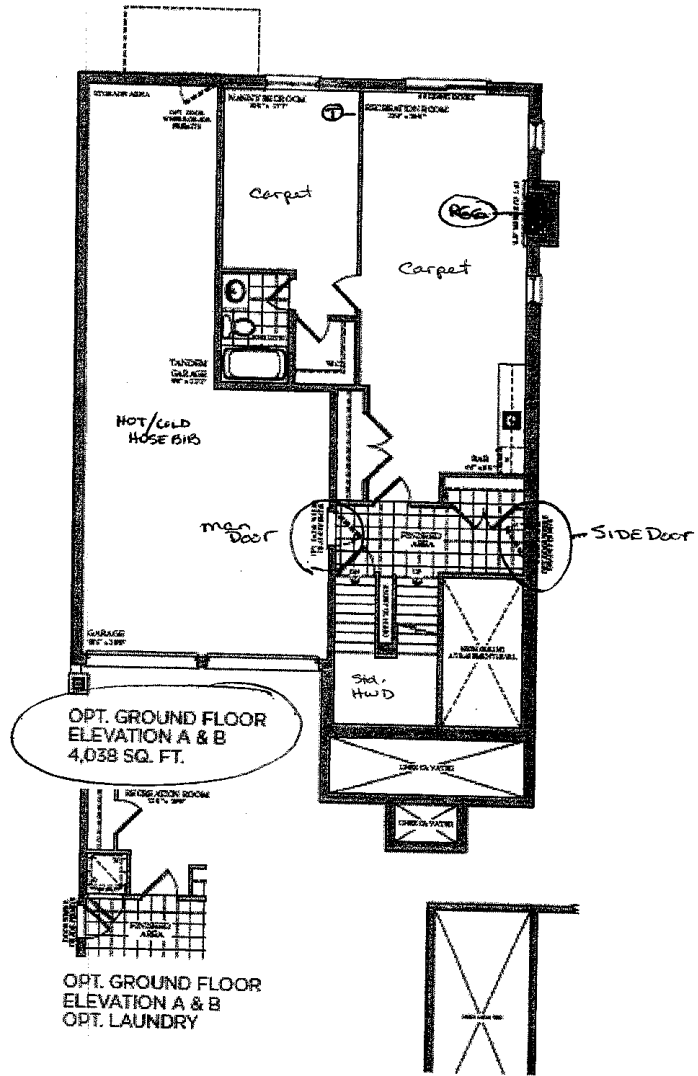
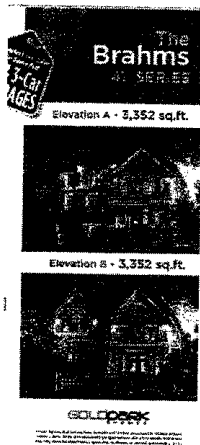

Lot 96
 Aug. 29, 16
 (Signature)

Lot 96
 April 12, 2016
 (Signature)

LSCE305ST LSCE365ST

30" & 36" Radiant Cooktops



LOT 96 BRAMPTON
SEPT 6, 2016

Premium Style & Great Features

COOKING PERFORMANCE

- Electric Cooktops with 5 Elements
- Steady Heat Elements
- Double RF 9"/6", Double LR 8"/5" (LSCE305ST)
- Triple 12"/9"/6", Double 9"/6" (LSCE365ST)

STYLE AND DESIGN

- Premium Stainless Steel Trim

CONVENIENCE

- SmoothTouch™ Glass Controls
- Bridge Element - 7" (LSCE365ST)

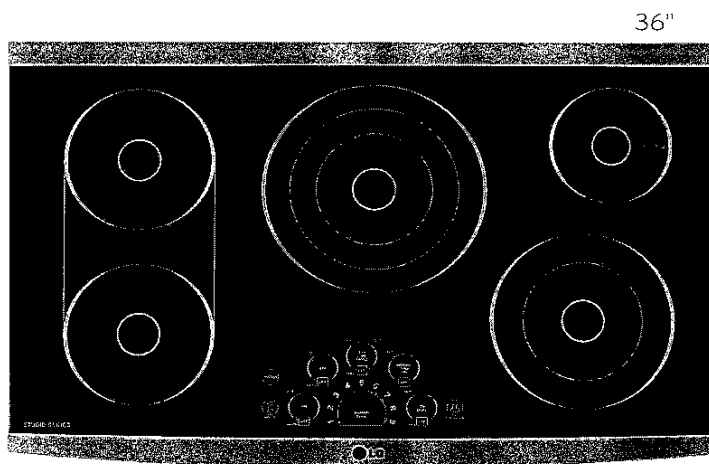
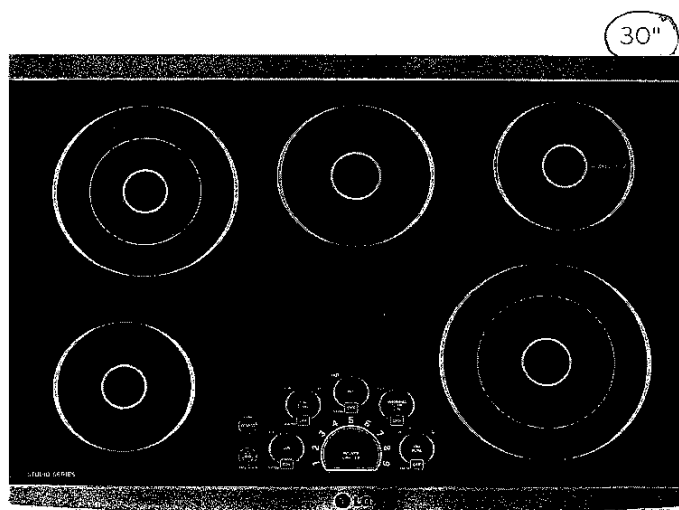

 Stainless Steel (ST)

 **LG**
Life's Good

STUDIO SERIES

LSCE305ST LSCE365ST

30" & 36" Radiant Cooktops

Steady Heat Elements

Steady Heat cooking elements deliver constant heat at any temperature for more precise heat control, and respond quickly to every power setting adjustment.

Dual & Triple Elements

LG's premium cooktops offer versatile elements that fit different sized cookware for convenience and even heating.

SmoothTouch™ Glass Controls

Intuitive SmoothTouch™ Controls are extremely easy to use with just a touch. With just a quick glance of the centralized electronic controls you can see which heating elements are activated, and the smooth surface easily wipes clean.

Bridge Element (LSCE365ST)

In addition to being used separately, the left front and the left rear elements can be joined by the bridge element to evenly heat larger pans.

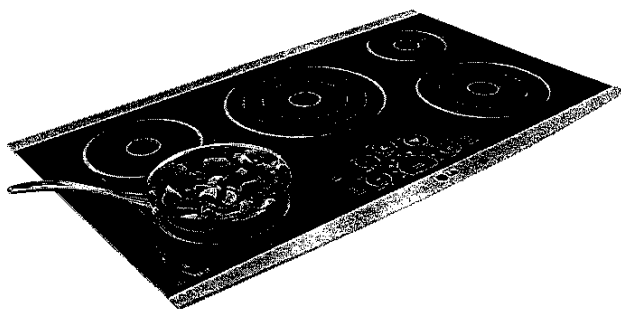

Installation Reference

(See chart at right for measurements)

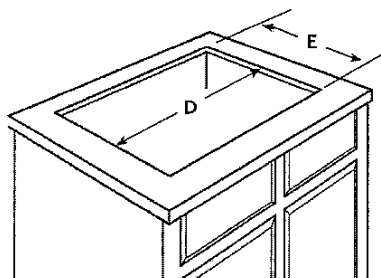
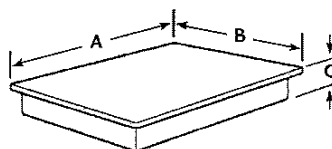

Life's Good

LOT 96 BRAMPTON
SEPT 6, 2016

TYPE	Electric
Type	30"
Size (LSCE305ST)	36"
Size (LSCE365ST)	36"
Cooking Surface	Radiant Glass Surface
Number of Elements	5 (plus bridge element - LSCE365ST)
FEATURES	
Controls Type / Location	SmoothTouch™ / Front Center
Hot Surface Indicator	
Child Lock	
Auto Shut Off	
Under Bench Oven Capable	
Warm Function	
Power Control	Steady Heat
Elements	Ceramic Glass
Surface / Frame Trim	Black / Stainless Steel
CONFIGURATION (LSCE305ST)	
Element Configuration	
Left Front	6" / 1.2kW
Left Rear	8", 5" / 1.9, 0.95kW (Dual)
Center	7" / 1.5kW
Right Front	9", 6" / 3.0, 1.4kW (Dual)
Right Rear	6" / 0.1kW (Warm)
CONFIGURATION (LSCE365ST)	
Element Configuration	
Left Front	7" / 1.8kW
Left Rear	7" / 1.8kW
Center	12", 9", 6" / 3.0, 2.2, 1.1kW (Triple)
Right Front	9", 6" / 3.0, 1.4kW (Dual)
Right Rear	6" / 0.1kW (Warm)
Bridge	7" / 0.8kW (Bridge)
DIMENSIONS (LSCE305ST)	
A: Product Width	30 27/32"
B: Product Depth	21 47/64"
C: Product Height	4"
D: Cut-Out Width	29 3/8"
E: Cut-Out Depth	20 1/4"
Net Weight	34.2 lbs.
DIMENSIONS (LSCE365ST)	
A: Product Width	36 11/16"
B: Product Depth	22 33/64"
C: Product Height	4"
D: Cut-Out Width	34 9/16"
E: Cut-Out Depth	20 3/8"
Net Weight	43 lbs.
POWER SOURCE (LSCE305ST)	
Electrical Requirements	240V/208V, 60Hz AC
Max. Amp Load	40 Amp
Power Cable Location	Right Rear
Total Connected Load	7.7kW @ 240V, 5.8kW @ 208V
POWER SOURCE (LSCE365ST)	
Electrical Requirements	240V/208V, 60Hz AC
Max. Amp Load	50 Amp
Power Cable Location	Right Rear
Total Connected Load	10.5kW @ 240V, 7.9kW @ 208V
WARRANTY	
	2 Years Parts and Labor,
	5 Years Parts on Cooktop and Coils
UPC CODES	
LSCE305ST 30" Radiant Cooktop	48231316620
LSCE365ST 36" Radiant Cooktop	48231316737

www.LG.com

LG Electronics U.S.A., Inc.
1000 Sylvan Avenue Englewood Cliffs, NJ 07632
Customer Service and Technical Support: (800) 243-0000

Dimensions and weights are approximate. Design, features and specifications subject to change without notice.

© 2010 LG Electronics USA, Inc. All rights reserved. "LG Life's Good" is a registered trademark of LG Corp. All other product and brand names are trademarks or registered trademarks of their respective companies. 07/10

RF34H9960S4

INTRODUCING THE LARGEST REFRIGERATOR IN ITS CLASS.*

Chef Inspired Features

LOT 96 BRAMPTON

SEPT 6 2016

CHEF COLLECTION

Our premium Chef Collection line is designed by Master Chefs with the sophisticated cook in mind. Every appliance in the collection has been tested and approved by Michelin Star chefs to build the best kitchen possible.

FEATURES

- Largest Capacity – 34 cu. ft.
- Triple and Metal Cooling System
- Automatic Sparkling Water Dispenser
- Fridge in Freezer with 4 Temperature Control Settings
- Star Display
- Ice Master Ice Maker in the Refrigerator
- Chef Pantry with 2 Chef Pans
- 4-Pillar High-Efficiency LED Lighting
- Arctic Blue Trim
- EZ Slide-Out Shelf in Refrigerator
- Tempered Glass Spill-Proof Shelves
- EZ Slide-Out Shelves in Freezer and Fridge in Freezer
- Gallon Door Bins
- Fingerprint Resistant Coating
- Chef Mode for Optimal Temperature
- Chef Basket
- 2 Crisper Drawers
- Full Extension Drawer/Tray
- Tilting Door Bins
- Crystal Door Bin
- Hidden Control Master

CONVENIENCE

- Cool Tight Door
- Water Filter Indicator
- Door Alarm



ENERGY STAR® rated:
855 kWh/yr

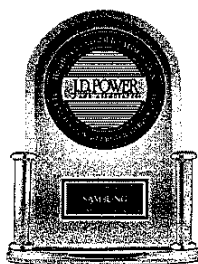

Ranked "Highest in customer satisfaction with French Door refrigerators, in a tie."**
—J.D. Power

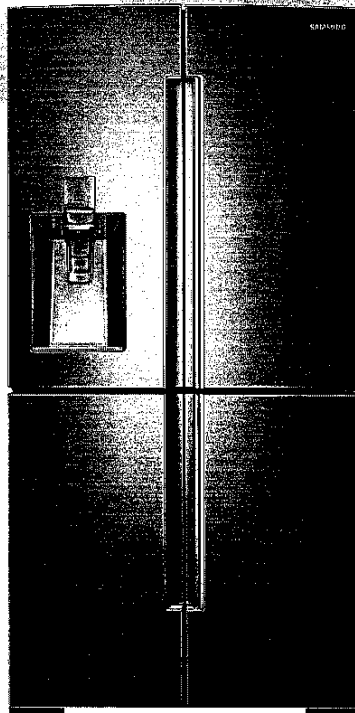

Extra Large Capacity

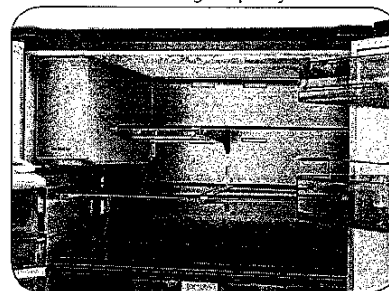

Triple and Metal Cooling System

Available Color



Stainless Steel

SIGNATURE FEATURES

LARGEST 34 CU. FT. CAPACITY

- Our 34 cu. ft. extra large capacity 4-Door French Door has enough room to fit up to 34 bags of groceries.¹

¹Among consumer-grade freestanding refrigerators

METAL COOLING

- Locks in cold, seals in freshness.
- Stainless steel paneling helps maintain consistent temperature throughout the refrigerator.

TRIPLE COOLING

- Provides precise temperature and humidity controls in all three zones.²
- Your food stays fresher longer with 2 compressors and 3 evaporators, an industry-first.²

²Among consumer-grade freestanding refrigerators.

FRIDGE IN FREEZER

- Versatile, bottom-right door can be a fridge or freezer, maximizing fresh food storage space.
- The most fresh food storage available in its class at 26.7 cu. ft., when the convertible zone is used as a refrigerator.³
- Four customizable temperature settings: Fridge at 41°F, Chilled at 30°F, Soft Freeze at 23°F and Frozen at -9° – 1°F.

³Among consumer-grade freestanding refrigerators

REFRESHING SPARKLING WATER ANYTIME

- Features convenience of built-in, chilled sparkling or still water dispenser powered by sodastream.
- Save money and space, and create less waste than when buying bottled sparkling water.
- SodaStream 60L CO₂ carbonators are available for easy exchange at 10,000 locations.

SAMSUNG

RF34H9960S4

LOT 96 BRAMPTON

SEPT. 6, 2016

INTRODUCING THE LARGEST REFRIGERATOR IN ITS CLASS.*

Chef Inspired Features

INSTALLING YOUR REFRIGERATOR

1. Measure the height, width and depth of the opening, making sure to include baseboards, molding tile, countertop overhang, etc. Check to be sure there is enough room to open the door (consider walls, islands or other obstacles when measuring).
2. Refer to illustration below to determine dimensions.
3. Allow 2" of clearance on hinge side of refrigerator when installing next to a wall where handle may make contact.
4. Allow 1" minimum clearance at rear for proper air circulation and water/electrical connections. Allow a 3/8" minimum clearance at sides and top for ease of installation.
5. Ensure each door and entry way in the home is wide enough for the refrigerator to be moved through easily.

Please note: The following dimension and cutout information is for planning purposes only. For complete installation details consult manual packed with product, or download manual on-line at samsung.com.

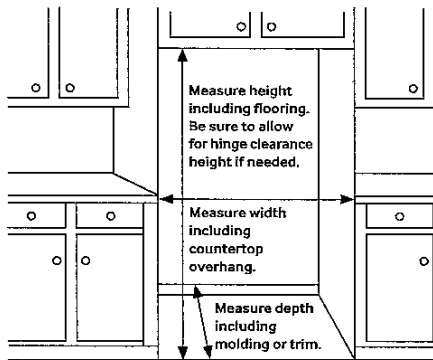

DIMENSIONS

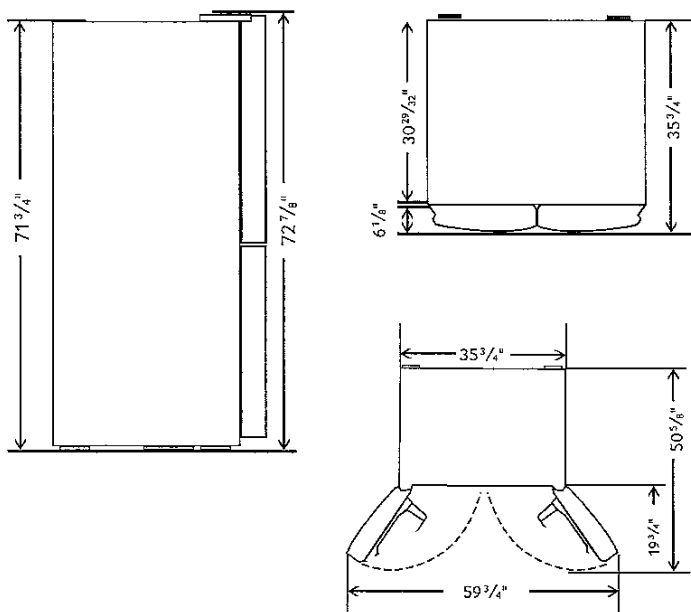

TOTAL CAPACITY: 34.3 CU. FT.

Refrigerator: 19.02 cu. ft.

- Premium External Water and Ice Dispenser
 - Still or Sparkling Water
 - Crushed or Cubed Ice
- Ice Master Ice Maker
- 4-Pillar High-Efficiency LED Lighting
- 5 Tempered Glass Spill-Proof Shelves
 - 1 EZ Slide-Out
 - 1 Flip-Up
 - 1 Foldable
 - 2 Fixed
- Crystal Door Bin
- 2 Crisper Drawers
- Chef Pan
- Chef Pantry
- Arctic Blue Trim
- Chef Basket

Fridge in Freezer: 7.64 cu. ft.

- 1 EZ Slide-Out Shelf
- 3 Freezer Drawers – Full Extension Drawer/Tray
- Tilting Door Bins
- 4 Temperature Zones:
 - 41°F
 - 30°F
 - 23°F
 - -9° – 1°F
- High-Efficiency LED Lighting

Freezer: 7.64 cu. ft.

- 1 EZ Slide-Out Shelf
- 3 Freezer Drawers – Full Extension Drawer/Tray
- High-Efficiency LED Lighting

Accessories

Water Filter: HAF-CIN/EXP

Warranty

One (1) Year Parts and Labor on Refrigerator
Five (5) Years Parts and Labor on Sealed Refrigeration System Only*
Ten (10) Years Parts and Five (5) Years Labor on Digital Inverter Compressor

*Compressor, evaporator, condenser, drier, connecting tubing

Product Dimensions & Weight

Dimensions (WxHxD with hinges, handles and doors):

35 3/4" x 72 7/8" x 35 3/4"

Dimensions (WxHxD without hinges and door):

35 3/4" x 71 3/4" x 30 29/32"

Dimensions (WxHxD with hinge and door, no handle):

35 3/4" x 72 7/8" x 35 3/4"

Weight: 535.7 lbs.

Shipping Dimensions & Weight (WxHxD)

Dimensions: 38 1/4" x 79 3/8" x 38 1/4"

Weight: 562.1 lbs.

Color	Model #	UPC Code
Stainless Steel	RF34H9960S4	887276040639

SAMSUNG

* One of the largest refrigerators in Samsung's current lineup.

** Samsung received the highest numerical score for French door refrigerators in a tie in the proprietary J.D. Power 2014 Kitchen Appliance StudySM. Study based on 15,380 total responses measuring 10 French door refrigerator brands and measures opinions of consumers about their new appliance purchased in the past 24 months. Proprietary study results are based on experiences and perceptions of consumers surveyed in January-March 2014. Your experiences may vary. Visit jdpower.com.

Actual color may vary. Design, specifications, and color availability are subject to change without notice. Non-metric weights and measurements are approximate.

30" Speed Combination Oven

LOT 96 BRAMPTON

SEP 6, 2016

500 Series – Stainless Steel HBL5751UC

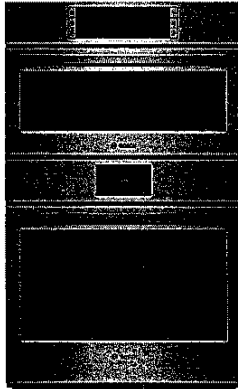

HBL5751UC
Stainless Steel

The Bosch speed combination oven features heavy metal stainless steel knobs.

Features & Benefits

Cooks faster than a traditional oven and can be used as a microwave.

Genuine European Convection for even baking results on multiple racks.

Heavy-duty metal knobs offer a premium European feel.

The wall oven is designed to be installed flush with cabinetry.



*Wall oven only

General Properties

Cooking modes – upper cavity	Microwave; 12 Auto Programs (including Auto Defrost, Melt Butter, Soften Ice Cream, Pizza), 9 Sensor Cook Programs, 9 AutoChef™ Speed Programs, Hi & Lo Broil, Convection, Keep Warm, Frozen Foods
Cooking modes – lower cavity	Bake, Variable Broil (hi & low), Roast, Warm, Sabbath, Proof Dough, Convection Bake, Convection Broil, Convection Roast, Pizza, Multi Rack Genuine European Convection, Convection Conversion

Cleaning type – lower	Self Clean
Telescopic rack	0
Illumination type	Incandescent (Upper and Lower)
Interior lights	1 Upper / 1 Lower

Oven Performance

Microwave power – upper cavity	1000 W
Bake / broil element wattages – upper cavity	600 / 1,750 W
Convection element wattages – upper cavity	1,700 W
Bake / broil element wattages – lower cavity	2,400 / 3,800 W
Convection element wattages – lower cavity	2,000 W

Technical Details

Watts (W)	9,725 W
Circuit breaker (A)	40 A
Volts (V); Frequency (Hz)	240 / 208 V; 60 Hz
Power cord length (in)	50"
Plug type	Fixed Connection, No Plug
Energy source	Electric

Dimensions & Weight

Overall appliance dimensions (HxWxD) (in)	49" x 29 3/4" x 24 1/2"
Required cutout size (HxWxD) (in)	48 5/8" x 28 1/2" x 23 1/2"
Oven cavity size – upper	1.6 cu. ft.
Overall upper oven interior dimensions (HxWxD) (in.)	9 7/8" x 16 1/2" x 16 1/2"
Turntable – Metal Max. Cookware – upper	12 3/4" dia.
Turntable – Ceramic Max. Cookware – upper	12 1/2" dia.
Rack – Rectangular Cookware Max. – upper	15" x 12"
Oven cavity size – lower	4.6 cu. ft.
Overall lower oven interior dimensions (HxWxD) (in)	17 13/16" x 24 1/8" x 18"
Usable lower oven interior dimensions (HxWxD) (in)	12 5/16" x 23 1/4" x 15 1/4"
Net weight (lbs)	259 lbs

Accessories—Included

Upper Oven: Metal Turntable, Square Rack, Ceramic Cooking Tray
Lower Oven: 2 Standard Oven Racks

Accessories—Optional

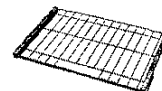

HEZTR301
30" Telescopic Rack

For help and assistance with Bosch accessories please visit: www.bosch-eshop.com/eshop/bosch/us or call 1-800-944-2904 Mon-Fri 5am to 6pm PST Sat 6am to 3pm PST

Notes: All height, width and depth dimensions are shown in inches. BSH reserves the absolute and unrestricted right to change product materials and specifications, at any time, without notice. Consult the product's installation instructions for final dimensional data and other details prior to making cutout. Applicable product warranty can be found in accompanying product literature or you may contact your account manager for further details.

Warranties: Bosch warrants that the Product is free from defects in materials and workmanship for a period of three hundred and sixty-five (365) days from the date of purchase. The foregoing timeline begins to run upon the date of purchase, and shall not be stalled, tolled, extended, or suspended, for any reason whatsoever. This Product is also warranted to be free from cosmetic defects in material and workmanship (such as scratches of stainless steel, paint/porcelain blemishes, chip, dents, or other damage) to the finish of the Product, for a period of thirty (30) days from the date of purchase or closing date for new construction. This cosmetic warranty excludes slight color variations due to inherent differences in painted and porcelain parts, as well as differences caused by kitchen lighting, product location, or other similar factors. This cosmetic warranty specifically excludes any display, floor, "As Is", or "B" stock appliances.

For more information on our entire line of products, go to www.bosch-home.com/us or call 1-800-944-2904

© BSH Home Appliances Corporation. All rights reserved. Bosch is a registered trademark of Robert Bosch GmbH.

09/15

30" Speed Combination Oven

500 Series – Stainless Steel HBL5751UC

LOT 96 BRAMPTON

SEPT 2, 2016



Installation Details

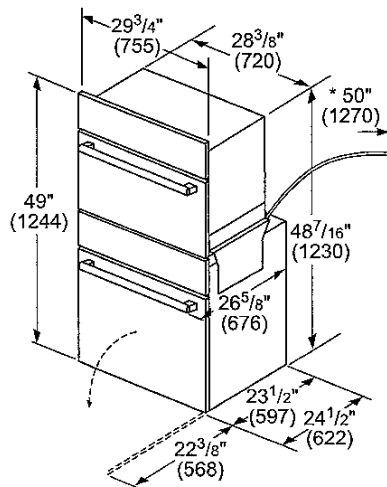

* Power conduit 50" (1270 mm) from the lower oven.

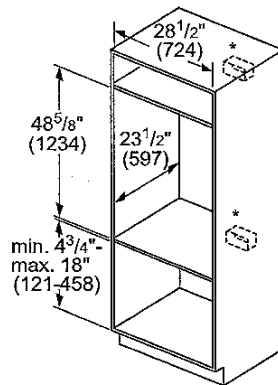

* Junction box may be installed above, below, or to the left or right of the unit within range of the power conduit.

measurements in inches (mm)

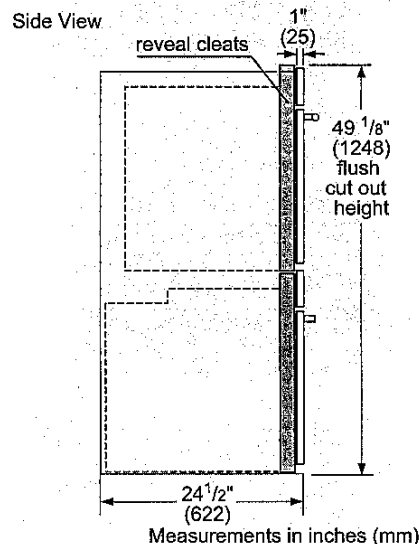
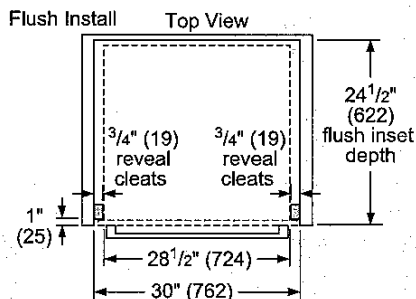

Example Flush Install

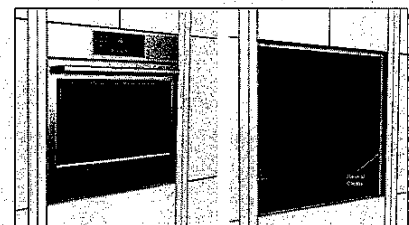

Single wall oven shown.

Measurements in inches (mm)

For help and assistance with Bosch accessories please visit: www.bosch-eshop.com/eshop/bosch/us or call 1-800-944-2904 Mon-Fri 5am to 6pm PST Sat 6am to 3pm PST

Notes: All height, width and depth dimensions are shown in inches. BSH reserves the absolute and unrestricted right to change product materials and specifications, at any time, without notice. Consult the product's installation instructions for final dimensional data and other details prior to making cutout. Applicable product warranty can be found in accompanying product literature or you may contact your account manager for further details.

Warranties: Bosch warrants that the Product is free from defects in materials and workmanship for a period of three hundred and sixty-five (365) days from the date of purchase. The foregoing timeline begins to run upon the date of purchase, and shall not be stalled, tolled, extended, or suspended, for any reason whatsoever. This Product is also warranted to be free from cosmetic defects in material and workmanship (such as scratches of stainless steel, paint/porcelain blemishes, chip, dents, or other damage) to the finish of the Product, for a period of thirty (30) days from the date of purchase or closing date for new construction. This cosmetic warranty excludes slight color variations due to inherent differences in painted and porcelain parts, as well as differences caused by kitchen lighting, product location, or other similar factors. This cosmetic warranty specifically excludes any display, floor, "As Is", or "B" stock appliances.

For more information on our entire line of products, go to www.bosch-home.com/us or call 1-800-944-2904

© BSH Home Appliances Corporation. All rights reserved. Bosch is a registered trademark of Robert Bosch GmbH.

09/15

30" Speed Combination Oven

500 Series – Stainless Steel HBL5751UC



Installation Details

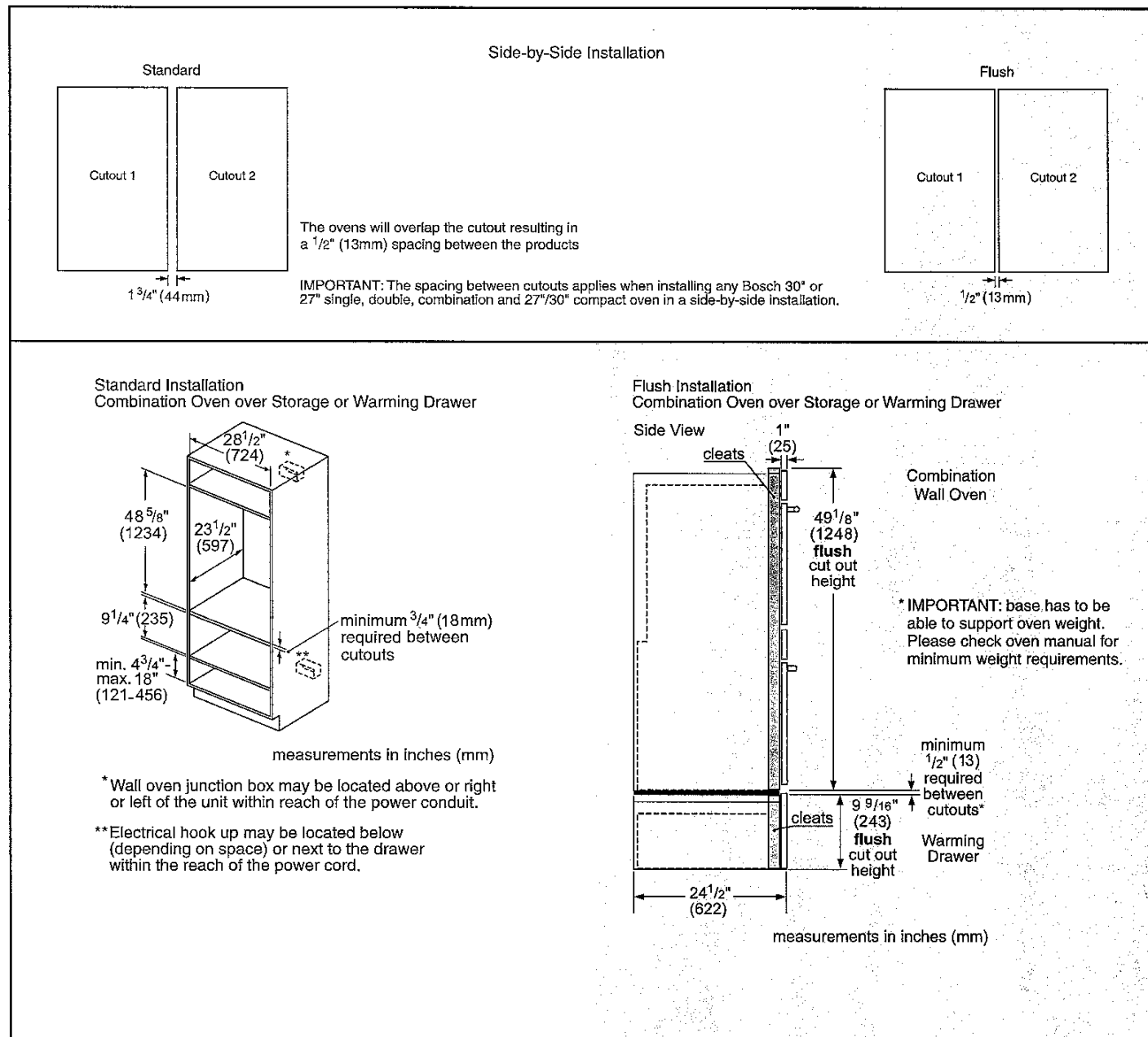

For help and assistance with Bosch accessories please visit: www.bosch-eshop.com/eshop/bosch/us or call 1-800-944-2904 Mon-Fri 5am to 6pm PST Sat 6am to 3pm PST

Notes: All height, width and depth dimensions are shown in inches. BSH reserves the absolute and unrestricted right to change product materials and specifications, at any time, without notice. Consult the product's installation instructions for final dimensional data and other details prior to making cutout. Applicable product warranty can be found in accompanying product literature or you may contact your account manager for further details.

Warranties: Bosch warrants that the Product is free from defects in materials and workmanship for a period of three hundred and sixty-five (365) days from the date of purchase. The foregoing timeline begins to run upon the date of purchase, and shall not be stalled, tolled, extended, or suspended, for any reason whatsoever. This Product is also warranted to be free from cosmetic defects in material and workmanship (such as scratches of stainless steel, paint/porcelain blemishes, chip, dents, or other damage) to the finish of the Product, for a period of thirty (30) days from the date of purchase or closing date for new construction. This cosmetic warranty excludes slight color variations due to inherent differences in painted and porcelain parts, as well as differences caused by kitchen lighting, product location, or other similar factors. This cosmetic warranty specifically excludes any display, floor, "As Is", or "B" stock appliances.

For more information on our entire line of products, go to www.bosch-home.com/us or call 1-800-944-2904

© BSH Home Appliances Corporation. All rights reserved. Bosch is a registered trademark of Robert Bosch GmbH.

09/15

Decor Centre Gold Park Homes

From: Harvinder Bajwa [bajwah2@hotmail.com]
Sent: September-04-16 7:04 PM
To: Decor Centre Gold Park Homes
Cc: Terri Parisani
Subject: Appliance spec sheets lot 96
Attachments: Cooktop.pdf; Walloven.pdf; Fridge.pdf

Hi Terry,

Here is the spec sheets for the appliances. The model number for the 30 inch cooktop is LSCE305ST.

Please confirm receipt and if everything is in order.

Thank you.