

Brampton Encore - 94 - 1 - 41-5 Elev.B BRAHMS OPT - GFA1

CENTRAL VAC AND WIRING

Inv.488	1 - FAMILY ROOM: INSTALL CONDUIT PIPE- FOR TELEVISION- MUST SPECIFY LOCATION AND TERMINATION POINT
Line5855	Note:
9May16 / 6Jun16	
Inv.488	1 - TELEPHONE AND CABLE ROUGH-IN LOCATIONS
Line5854	Note:
9May16 / 6Jun16	
Inv.488	1 - GROUND FLOOR: INSTALL CONDUIT PIPE- FOR TELEVISION- MUST SPECIFY LOCATION AND TERMINATION POINT
Line5860	Note:
9May16 / 6Jun16	
Inv.488	1 - GROUND FLOOR: INSTALL RG 6 ROUGH-IN BESIDE FIREPLACE ON GROUND FLOOR. SEE SKETCH
Line5865	Note:
9May16 / 6Jun16	
Inv.488	1 - KITCHEN - INSTALL VAC PAN UNDER KITCHEN SINK
Line5924	Note:
9May16 / 6Jun16	

ELECTRICAL

Inv.488	1 - FAMILY ROOM: INSTALL 110V WALL RECEPTACLE ON DEDICATED CIRCUIT -ABOVE FIREPLACE. SEE SKETCH
Line5856	Note:
9May16 / 6Jun16	
Inv.488	1 - GROUND FLOOR: INSTALL 110V WALL RECEPTACLE ON DEDICATED CIRCUIT - ABOVE FIREPLACE. SEE SKETCH
Line5861	Note:
9May16 / 6Jun16	
Inv.488	1 - KITCHEN: INSTALL 110V WALL RECEPTACLE ON DEDICATED CIRCUIT - FOR MICROWAVE - MICROWAVE NOT INCLUDED. PURCHASER IS AWARE THAT THEY MUST BUY THE APPROPRIATE CABINETRY AT THE TIME OF COLOURS
Line5866	Note:
9May16 / 6Jun16	
Inv.488	1 - LIVING ROOM: INSTALL ADDITIONAL STANDARD FIXTURE ON SAME SWITCH AS THE EXISTING DINING ROOM LIGHT. IN ADDITION TO THE BUILDER'S STANDARD SWITCHN CONTROLLED RECEPTAL
Line5867	Note:
9May16 / 6Jun16	
Inv.488	1 - BASEMENT: INSTALL 200 AMP ELECTRICAL SERVICE
Line5868	Note:
9May16 / 6Jun16	

EXTERIOR COLOURS

Inv.488	1 - EXTERIOR COLOUR PACKAGE 10
Line6537	Note:
9May16 / 6Jun16	

FIREPLACE

Brampton Encore - 94 - 1 - 41-5 Elev.B BRAHMS OPT - GFA1

Inv.488	1 - GROUND FLOOR: INSTALL OPTIONAL FIREPLACE ON GROUND FLOOR. STANDARD MODEL, WHITE, PAINT-GRADE MANTLE W/MARBLE SURROUND
Line5858	Note:
9May16 / 6Jun16	

FRAMING

Inv.488	1 - FAMILY ROOM: INSTALL OPTIONAL COFFERED CEILING - FAMILY ROOM (PER ROOM AS PER PLAN)
Line5869	Note:
9May16 / 6Jun16	
Inv.488	1 - OPTIONAL GROUND FLOOR
Line6535	Note:
9May16 / 6Jun16	
Inv.488	1 - MANDOOK - GARAGE TO HOUSE- AS PER PLAN AND GRADE PERMITTING
Line6541	Note: AS PER APS BONUS PACKAGE
9May16 / 6Jun16	

GRANITE MARBLE QUARTZ

Inv.825	1 - KITCHEN: INSTALL 2 CM GRP 1 Optional Flush BBar
Line11496	Note:
19Sep16 / 26Sep16	

HARDWOOD

Inv.825	1 - DEN: INSTALL 4 1/4" PROVERCO HARDWOOD Upgrade 1 IN Den
Line11487	Note:
19Sep16 / 26Sep16	
Inv.825	1 - FAMILY ROOM: INSTALL 4 1/4" PROVERCO HARDWOOD Upgrade 1 IN FAMILY ROOM
Line11488	Note:
19Sep16 / 26Sep16	
Inv.825	1 - LANDINGS: INSTALL 4 1/4" PROVERCO HARDWOOD Upgrade 1 ON LANDINGS
Line11489	Note:
19Sep16 / 26Sep16	
Inv.825	1 - LIVING ROOM: INSTALL 4 1/4" PROVERCO HARDWOOD Upgrade 1 IN LIVING ROOM
Line11490	Note:
19Sep16 / 26Sep16	
Inv.825	1 - MAIN HALL: INSTALL 4 1/4" PROVERCO HARDWOOD Upgrade 1 IN Main Hall
Line11491	Note:
19Sep16 / 26Sep16	

HVAC

Inv.488	1 - GROUND FLOOR: INSTALL GAS LINE ROUGH - FOR FIREPLACE ON GROUND FLOOR. SEE SKETCH
Line5859	Note:
9May16 / 6Jun16	
Inv.488	1 - KITCHEN: INSTALL GAS LINE ROUGH - MAIN FLOOR - (3 STOREY MODELS) FOR STOVE
Line5871	Note:
9May16 / 6Jun16	

INTERIOR TRIM AND DOORS

Brampton Encore - 94 - 1 - 41-5 Elev.B BRAHMS OPT - GFA1

Inv.488	5 - MAIN FLOOR: INSTALL FIVE (X5) STANDARD DOOR EXTENDED HEIGHT 96" (PRICE PER DOOR) MAIN FLOOR 3 STOREY MODELS - FOR CLOSETS, POWDER ROOM, AND PANTRY. SEE SKETCH
Line5872	Note:
9May16 / 6Jun16	
Inv.488	2 - DEN: INSTALL TWO (X2) STANDARD FRENCH DOORS EXTENDED HEIGHT 96" (PRICE PER DOOR) MAIN FLOOR 3 STOREY MODELS - TO GO IN DEN. SEE SKETCH
Line5873	Note:
9May16 / 6Jun16	

KITCHEN AND BATH CABINETRY

Inv.488	1 - KITCHEN - INSTALL VAC PAN UNDER KITCHEN SINK
Line6533	Note:
9May16 / 6Jun16	
Inv.825	1 - KITCHEN: INSTALL UPG 1 GRP III Kitchen CABINETS, THROUGHOUT, WHERE APPLICABLE
Line11485	Note:
19Sep16 / 26Sep16	
Inv.825	1 - KITCHEN: INSTALL Oak PVC 126 Built in microwave with trim kit with full doors above and below 220cm min 80cm wide. SEE SKETCH FOR LOCATION
Line11486	Note:
19Sep16 / 26Sep16	

MISC.

Inv.488	1 - BONUS PACKAGE: \$10,000.00 (INCLUDING TAXES) WORTH OF UPGRADES FROM GOLD PARK HOMES DÉCOR CENTRE IS BEING APPLIED TOWARD THE STRUCTURAL APPOINTMENT.
Line5877	Note:
9May16 / 6Jun16	
Inv.488	1 - Purchaser has attended a Structural appointment at the Decor Centre & has DECLINED any additional upgrades and accepts and acknowledges that there will be no further structural changes/additions/deletions to be made upon signing on May 9, 2016
Line5878	Note:
9May16 / 6Jun16	
Inv.488	1 - Purchasers are aware & accepts that ANY changes made to upgrades after signing this Purchasers Extra Form are subject to a minimum administration fee of \$500. PLUS a 10% holdback fee
Line5879	Note:
9May16 / 6Jun16	
Inv.825	1 - APPLIANCE SPECIFICATIONS: KITCHEN - Purchaser accepts & acknowledges that in order to either complete or install built-in appliances and accommodate for cook-top, all appliance specifications must be provided to the Décor Center within one (1) week
Line11497	Note:
19Sep16 / 26Sep16	
Inv.825	1 - Purchaser has attended a Colour appointment at the Decor Centre & has DECLINED any additional upgrades and accepts and acknowledges that there will be no further structural changes/additions/deletions to be made upon signing on September 19, 2016
Line11498	Note:
19Sep16 / 26Sep16	
Inv.825	1 - Purchasers are aware & accepts that ANY changes made to upgrades after signing this Purchasers Extra Form are subject to a minimum administration fee of \$500. PLUS a 10% holdback fee
Line11499	Note:
19Sep16 / 26Sep16	

Brampton Encore - 94 - 1 - 41-5 Elev.B BRAHMS OPT - GFA1

PAINTING

Inv.825	1 - STAIRCASE: Stain Staircases 3 Storey Model (Euroline Pickets Charged Separately)
Line11493	Note:
19Sep16 / 26Sep16	

PLUMBING

Inv.488	1 - KITCHEN/SERVERY: INSTAL BAR SINK - IN SERVERY
Line5875	Note:
09May16 / 06Jun16	
Inv.488	1 - KITCHEN: INSTALL ROUGH-IN - WATERLINE FOR FRIDGE
Line5876	Note:
09May16 / 06Jun16	

STAIRS AND RAILINGS

Inv.825	1 - STAIRCASE: INSTALL EUROLINE 3 OVAL Black
Line11494	Note:
19Sep16 / 26Sep16	
Inv.825	1 - STAIRCASE: INSTALL V Groove Handrail ON STAIRCASE
Line11495	Note:
19Sep16 / 26Sep16	

WINDOWS - BASEMENT

Inv.488	3 - BASEMENT: INSTALL THREE (X3) BASEMENT WINDOWS - UPGRADE EXISTING BASEMENT WINDOW TO 30 INCH X 24 INCH - MAY REQUIRE INSTALLATION OF WINDOW WELL. SEE SKETCH
Line5870	Note:
09May16 / 06Jun16	

WINDOWS AND DOORS

Inv.488	1 - MAN DOOR GARAGE TO HOUSE - OPTIONAL - IF GRADE PERMITS
Line6540	Note: AS PER APS BONUS PACKAGE
09May16 / 06Jun16	

Scheduled Closing Date: Tuesday, December 06, 2016

Purchasers: JAGDEV KULLAR & PARMINDER KULLAR

Property: 94 of Plan -

Telephone Res. / Bus: (416) 551-3522

Project: Fieldwalk Investments Inc.

Decor Advisor: Terri Parisani

Model and Elevation: 41-5 Elev.B BRAHMS OPT - GFA1

Layout Changes: ☒ Yes ☐ No

Sketch Attached: ☒ Yes ☐ No

Exterior Colour Scheme:
1. Cabinetry

	Style and Colour	Counter	Hardware
Kitchen / Breakfast	upg1, Villa(oak)Mocha	Crema Caramel, Granite Edge: C-20	cs1-22
Laundry Room			
Powder Room			
Twin Bath	Toscana(pvc)AntiqWhite	1799K- Ebony Fusion Laminate	cs1-25
Master Ensuite Bathroom	Toscana(pvc)AntiqWhite	1799K- Ebony Fusion Laminate	cs1-16
Second Ensuite Bathroom (If Applicable)	Toscana(pvc)AntiqWhite	1799K- Ebony Fusion Laminate	cs1-25
Nanny Suite	M500(melami)VanillaStix	1799K- Ebony Fusion Laminate	cs1-25
Dishwasher Cabinet	N/A		

Comment

GROUND FLOOR BAR: CABINET: Siena (Oak) Mocha HARDWARE: CS1-22 COUNTER: 7022-58 Natural Canvas Laminate

2. Floor Tile

	Selection	Grout	Threshold
Entrance Vestibule	Serpentine Krem, 13 x 13		
Main Hall			
Kitchen / Breakfast	Serpentine Krem, 13 x 13		
Laundry Room	Serpentine Taupe, 13 x 13		
Powder Room	Serpentine Krem, 13 x 13		
Twin Bath	Serpentine Taupe, 13 x 13		
Master Ensuite Bathroom	Serpentine Taupe, 13 x 13		
Second Ensuite Bathroom (If Applicable)	Serpentine Taupe, 13 x 13		
Lower Landing (If Applicable)			
Nanny Suite	Serpentine Taupe, 13 x 13		

Comment

SERVERY/PANTRY FLOOR: Serpentine Krem, 13 x 13

3. Wall Tile

	Selection	Listello/Inserts	Describe
Twin Bath	Serpentine Taupe, 8 x 10	<input type="radio"/> Yes <input checked="" type="radio"/> No	
Master Ensuite Bathroom			
Tub Deck	Serpentine Taupe, 8 x 10	<input type="radio"/> Yes <input checked="" type="radio"/> No	
Shower Stall	Serpentine Taupe, 8 x 10	<input type="radio"/> Yes <input checked="" type="radio"/> No	
Bathroom Walls	Serpentine Taupe, 8 x 10	<input type="radio"/> Yes <input checked="" type="radio"/> No	
Second Ensuite Bathroom (If Applicable)	Serpentine Taupe, 8 x 10	<input type="radio"/> Yes <input checked="" type="radio"/> No	
Nanny Suite	Serpentine Taupe, 8 x 10	<input type="radio"/> Yes <input checked="" type="radio"/> No	

Kitchen Backsplash
☐ Yes ☒ No

Backsplash Behind Fridge

N/A

Comment

Purchasers: JAGDEV KULLAR & PARMINDER KULLAR

Property: 94 of Plan -

Telephone Res. / Bus: (416) 551-3522

Project: Fieldwalk Investments Inc.

Decor Advisor: Terri Parisani

Model and Elevation: 41-5 Elev.B BRAHMS OPT - GFA1

4. Plumbing Fixtures

Twin Bath

Second Ensuite

Powder Room

Master Ensuite Bathroom

Other Room - Specify

Other Washroom

Comment

ALL FIXTURES ARE STANDARD THROUGHOUT HOME

**NOTE: PURCHASER HAS BOUGHT BAR SINK IN SERVERY

5. Hardwood Flooring

	Type and Stain		Type and Stain
Main Hall	*Proverco Oak 4 1/4" Sierra	Upper Landing	
Kitchen / Breakfast		Upper Hall	*Proverco Oak 4 1/4" Sierra
Living Room	*Proverco Oak 4 1/4" Sierra	Master Bedroom	
Dining Room	*Proverco Oak 4 1/4" Sierra	Bedroom #2	
Family Room	*Proverco Oak 4 1/4" Sierra	Bedroom #3	
Den/Library	*Proverco Oak 4 1/4" Sierra	Bedroom #4	
Entrance Vestibule		Bedroom #5	
Lower Landing (If Applicable)		Other Room - Specify	

Comment
6. Carpeting

	Upgrade	Description
Main Hall	<input type="checkbox"/>	
Living Room	<input type="checkbox"/>	
Dining Room	<input type="checkbox"/>	
Family Room	<input type="checkbox"/>	
Den/Library	<input type="checkbox"/>	
Upper Hall	<input type="checkbox"/>	T-18
Master Bedroom	<input type="checkbox"/>	T-18
Bedroom #2	<input type="checkbox"/>	T-18
Bedroom #3	<input type="checkbox"/>	T-18
Bedroom #4	<input type="checkbox"/>	T-18
Bedroom #5	<input type="checkbox"/>	
Nanny/Rec Room	<input type="checkbox"/>	T-18
Upper Landing (If Applicable)	<input type="checkbox"/>	
Lower Landing (If Applicable)	<input type="checkbox"/>	

Upgrade Underpad	Type STANDARD	Area
Carpet on Stairs	Capped N/A	Runner - *Upgrade N/A

Comment

Purchasers: JAGDEV KULLAR & PARMINDER KULLAR

Property: 94 of Plan -

Telephone Res. / Bus: (416) 551-3522

Project: Fieldwalk Investments Inc.

Decor Advisor: Terri Parisani

Model and Elevation: 41-5 Elev.B BRAHMS OPT - GFA1

7. Fireplace

	Living Room			Family Room			Other Room - Specify GROUND FL		
	Purchased	As Per Plan	N/A	Purchased	As Per Plan	N/A	Purchased	As Per Plan	N/A
Fireplace Type	<input type="radio"/>	<input type="radio"/>	<input checked="" type="radio"/>	<input type="radio"/>	<input checked="" type="radio"/>	<input type="radio"/>	<input checked="" type="radio"/>	<input type="radio"/>	<input type="radio"/>
Mantle Type				STANDARD			STANDARD		
Colour / Stain				NF-23			NF-23		
Surround				WHITE PAINT-GRADE			WHITE PAINT-GRADE		
Hearth				TRAVERTINO CLASSICO			TRAVERTINO CLASSICO		
Comment									

8. Trim Carpentry

Interior Doors	STD Extended	Front Door Glass Inserts	STD	Door Handles	STD
Interior Trim					
Comment					

9. Plaster Mouldings and Medallions

Entrance Vestibule	N/A		Kitchen/Breakfast	N/A	
Main Hall	N/A		Den/Library	N/A	
Living Room	N/A		Lower Landing	N/A	
Dining Room	N/A		Other Room - Specify	N/A	
Family Room	N/A				
Comment					

10. Railings and Spindles

Railing Package	*EUROLINE 3, V-GROOVE HANDRAIL		
Railing Colour	*SIERRA	Spindle Colour	*SIERRA
Stringer / Riser	*SIERRA	Treads	*SIERRA
Comment	Oak Stairs	<input checked="" type="radio"/> Yes	<input type="radio"/> No

11. Wall Paint

Main & Upper Hall	OYSTER	Master Bedroom	OYSTER
Living Room	OYSTER	Bedroom #2	OYSTER
Dining Room	OYSTER	Bedroom #3	OYSTER
Kitchen / Breakfast	OYSTER	Bedroom #4	OYSTER
Family Room	OYSTER	Bedroom #5	
Powder Room	OYSTER	Master Ensuite	OYSTER
Laundry Room	OYSTER	TWIN BATH	OYSTER
Den/Library	OYSTER	Second Ensuite	OYSTER
Trim Paint	WHITE	GROUND FLOOR	OYSTER
Comment	Smooth Ceilings First Floor		

Purchasers: JAGDEV KULLAR & PARMINDER KULLAR

Property: 94 of Plan -

Telephone Res. / Bus: (416) 551-3522

Project: Fieldwalk Investments Inc.

Decor Advisor: Terri Parisani

Model and Elevation: 41-5 Elev.B BRAHMS OPT - GFA1

12. Electrical

Plugs and Switches ☒ White ☐ Ivory

Hood Fan ☐ White ☐ Ivory

Appliances

Built in Cooktop

Built in Oven

Gas Stove

Microwave

☐ Yes ☒ No

☐ Yes ☒ No

☒ Yes ☐ No

☒ Yes ☐ No

Comment

STANDARD HOOD FAN: STAINLESS STEEL

13. Heating and Air Conditioning

Air Conditioning

Gas Provisions Stove

Gas Provisions Dryer

Gas Provisions Barbecue

Comment

PURCHASED GAS LINE FOR STOVE AND GROUND FLOOR FIREPLACE
GAS LINE FOR BBQ STANDARD

14. Additional Comments

15. Disclaimers and Notes

- 1) Colours of all materials are as close as possible to builder's selection, but not necessarily identical due to variances in manufacturing.
- 2) Any extras listed above are null and void unless accompanied by a separate invoice/amendment. Said invoice must be paid in full.
- 3) The Purchaser acknowledges that after Interior Colour Selection form is signed and dated, no further changes will be permitted other than re-selection due to unavailability. Purchaser's Initials
- 4) The Purchaser acknowledges reading and accepting the "Gold Park Homes Decor Centre Disclaimers" form. This document contains other miscellaneous disclaimers.

This Interior Colour Selection is final and approved by:

Signature: 

Date: 09/19/2016

Signature: 

Date: 09/19/2016

CORTINA

KITCHENS INC.

70 Regina Road Woodbridge ON L4L 8L6
905-264-6464

INFORMATION - PVC DOORS

Builder Gold Park Homes Project Encore Lot # 94

All cabinets with PVC (Thermofoil) Doors come with melamine gables, panels and kick. The doors, crown moulding and light valance are PVC wrapped. Open shelves incorporated in design will only be available with melamine interiors. There will be variations in colour shades between the PVC parts (doors, crown and Light valance) and the melamine parts (open shelves, Gables, Panels and Kick) due to the difference in material.

Furring Panel with crown moulding to the ceiling is not available on all PVC door styles due to subtle variations in colour shades between the PVC parts (moulding) and the melamine parts (furring panel) due to the difference in material. Grain directions in wood grain pattern melamine, vary between the furring panel, crown moulding (horizontal) and the PVC doors (vertical).

Thank you for your understanding.

I am well informed of this information, and agree to the purchase of the above.

Purchaser:

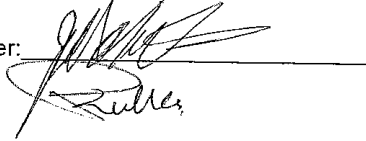

Date:

09/19/2016

encore
BRAMPTON

Telephone — (T)
Cable — (C)
Electrical — (E)

The Brahms 41' SERIES

Elevation A • 4,038 sq.ft. | Elevation B • 4,038 sq.ft.

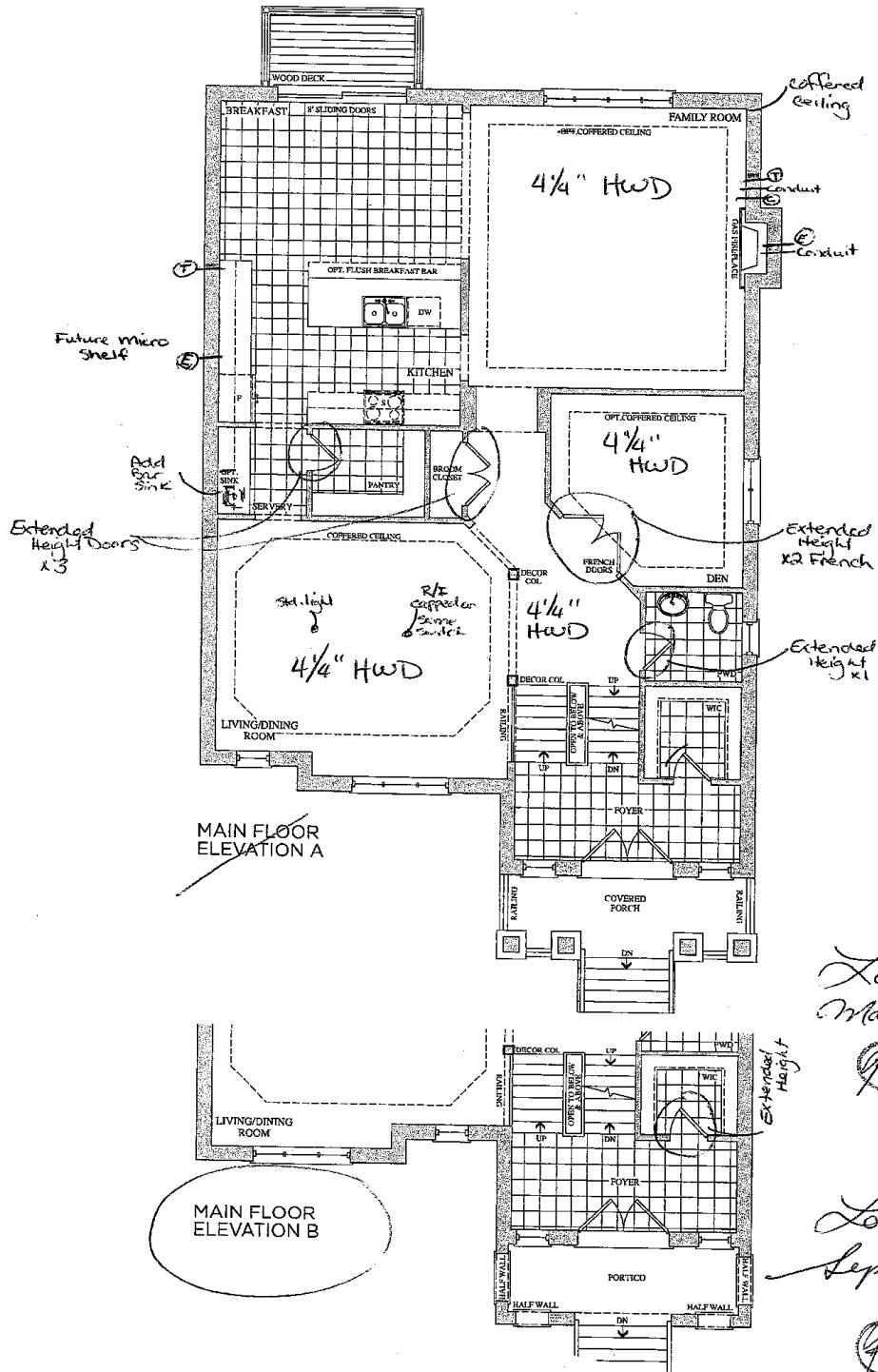

Lot 94
May 9, 2016
(P) (PK)

Lot 94
Sept 19, 16
(P) (PK)

Prices, figures, illustrations, sizes, features and finishes are subject to change without notice. E. & O.E. Areas and dimensions are approximate and actual usable floor space may vary from the stated area. Layout may be reverse of the unit purchased. E. & O.E.

GOLDPARK
HOMES

encore
BRAMPTON

Telephone — (T)
Cable — (C)
Electrical — (E)

The Brahms 41' SERIES

Elevation A • 4,038 sq.ft. | Elevation B • 4,038 sq.ft.

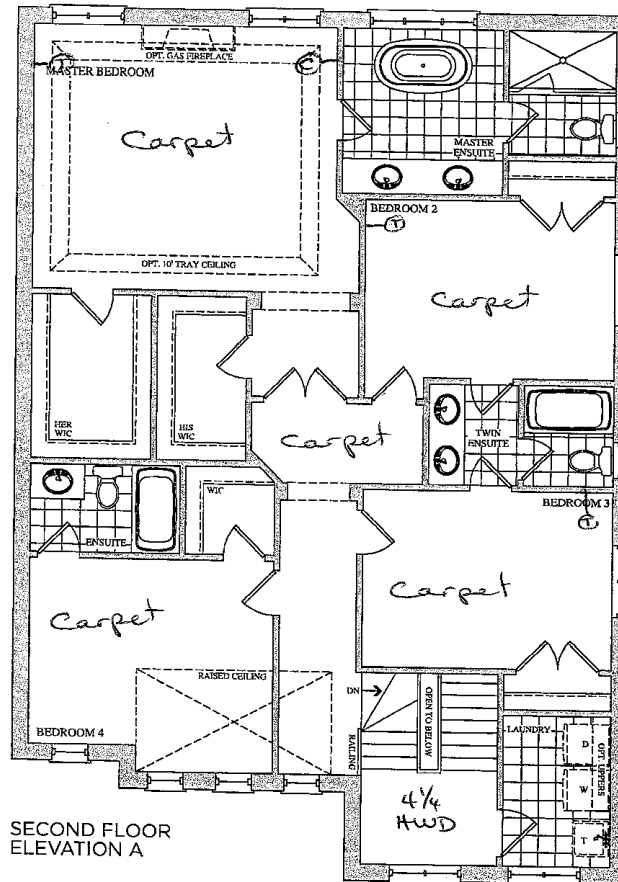

SECOND FLOOR
ELEVATION A

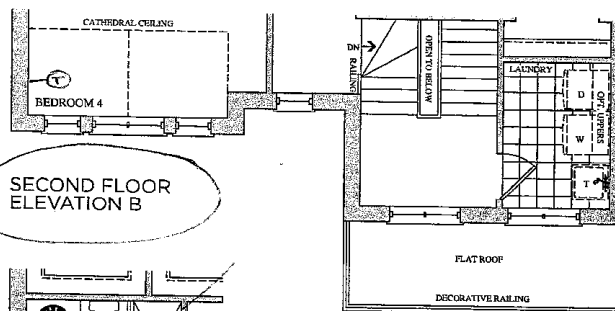

SECOND FLOOR
ELEVATION B

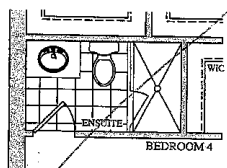

SECOND FLOOR
ELEVATION A & B
OPT. ENSUITE

Lot 94

~~PK~~ PK

Lot 94
Sept 19, 16

~~PK~~ PK

Prices, figures, illustrations, sizes, features and finishes are subject to change without notice. E.&O.E. Areas and dimensions are approximate and actual usable floor space may vary from the stated area. Layout may be reverse of the unit purchased. E. & O.E.

GOLDPARK
HOMES

encore
BRAMPTON

Telephone — (T)
Cable — (C)
Electrical — (E)

The Brahms 41' SERIES

Elevation A • 4,038 sq.ft. | Elevation B • 4,038 sq.ft.

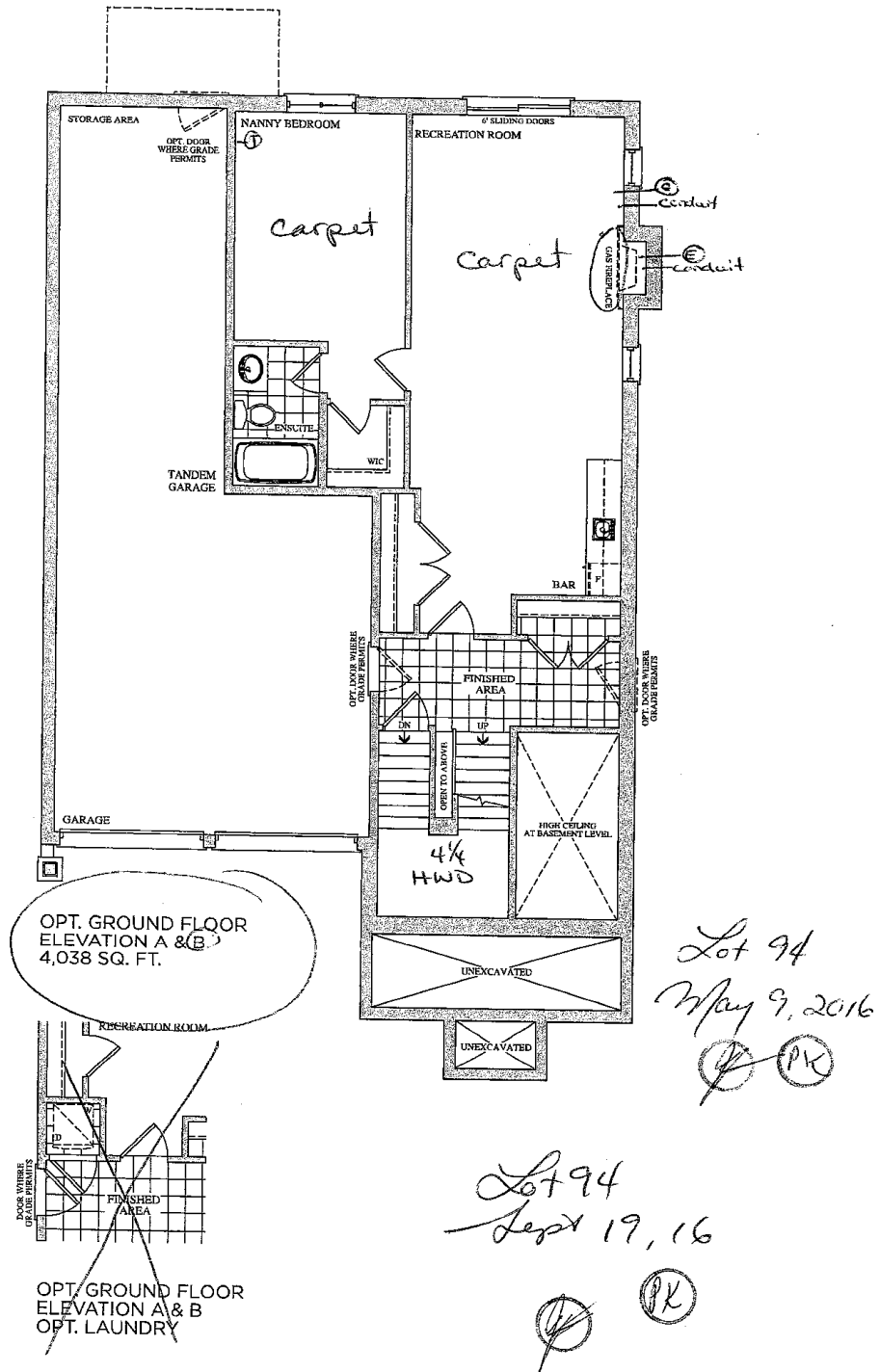

Prices, figures, illustrations, sizes, features and finishes are subject to change without notice. E.&O.E. Areas and dimensions are approximate and actual usable floor space may vary from the stated area. Layout may be reverse of the unit purchased. E. & O.E.

GOLDPARK
HOMES

Date: 23/06/16

Trade Name: Gold Park Homes

Site location: Brampton

Model: 41-5

Address:

Project: Encore

Phase:

This layout has been explained to the purchaser by Cortina Kitchens Inc. and is understood by the purchaser.

KITCHEN

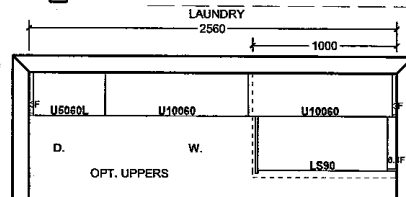
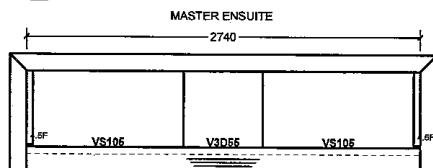
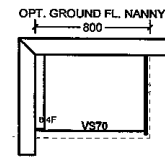
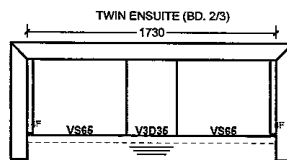
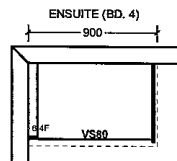
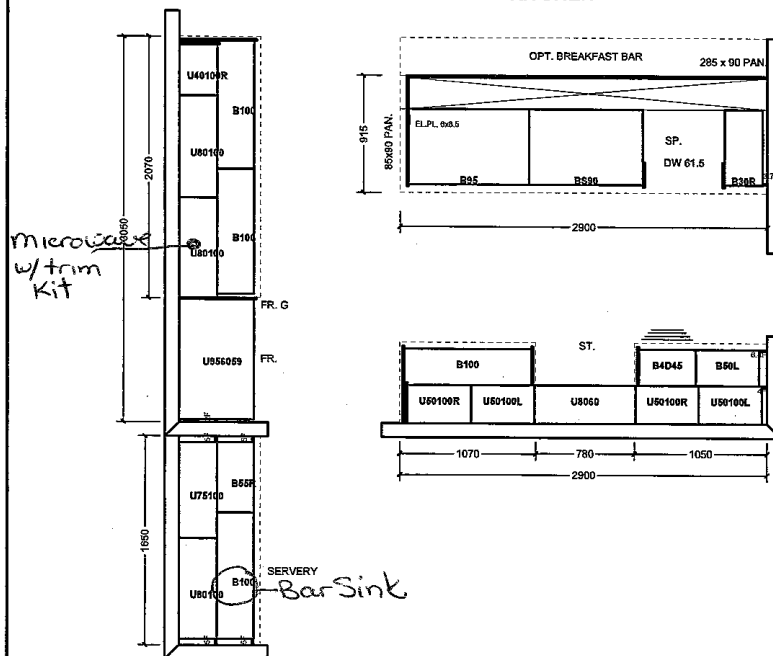

All prices subject to confirmation from head office.
This quotation is subject to the terms & conditions set out.

ACCEPTED DATE: _____

All agreements are contingent upon strikes, accidents, and delays beyond our control.
Please provide our installer with template for sinkholes or \$150.00 will be charged for callback.

Item A. Wood grain and colour are characteristics of the product. We cannot guarantee that such grain and colour will always match.
Item B. Cortina Kitchens Inc. reserves the right to alter dimensions and make technical changes without notice.

Lot 94
Sept. 19, 16
PK

STANDARD HARDWARE



STANDARD HARDWARE

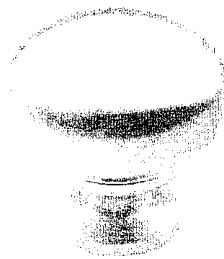

CSI-6



CSI-10

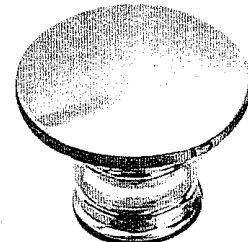

CSI-14

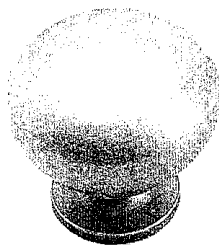

CSI-16

master Ens.



CSI-18

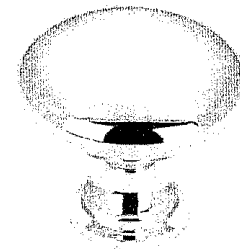

CSI-19

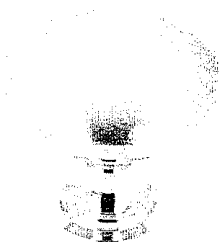

CSI-20

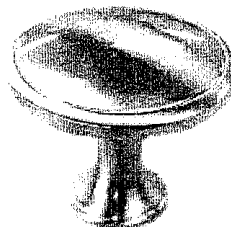

CSI-21

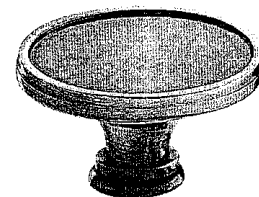

CSI-22

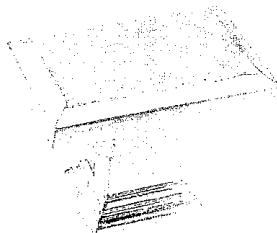
Kitchen/
Ground Floor Bar

CSI-23

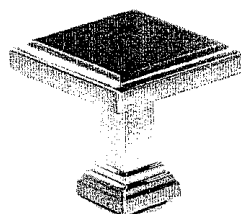

CSI-24

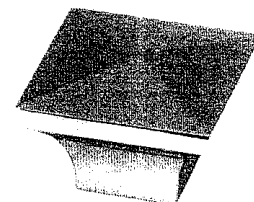

CSI-25

Twin Bath
Ens. 2
Nanny Suite

*NOTES:

- IMAGES ARE FOR QUICK REFERENCE PURPOSES ONLY
- ACTUAL SIZES AND FINISHES AS PER HARDWARE
- SAMPLE BOARD PROVIDED TO DECOR CENTRE

MCES BUILT-IN MICROWAVE WITH CONVECTION

MASTERPIECE® & PROFESSIONAL SERIES

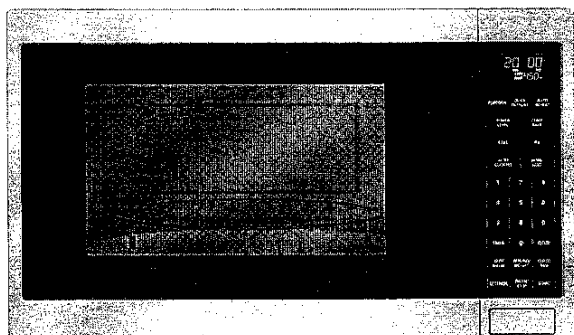

FEATURES & BENEFITS

- Automatic convection bake programs
- Innovative microwave inverter technology offers consistent cooking performance
- 1,000 watts microwave power and 10 microwave power levels
- Sensor cooking programs measure humidity and adjust cooking level and cooking time
- Built-in convection microwave is the perfect companion for any Thermador wall oven

ACCESSORIES (OPTIONAL)

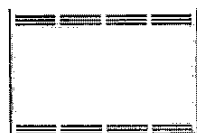

MCT27JS
27-Inch Trim Kit

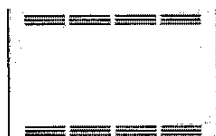

MCT30JS
30-Inch Trim Kit

GENERAL PROPERTIES

Cavity Color	Stainless Steel
Max. Microwave Power (W)	1,000 W

CAPACITY

Cavity Capacity (cu. ft.)	1.5 cu. ft.
Turntable Diameter (in.)	15"

TECHNICAL DETAILS

Watts (W)	1,500 W
Circuit Breaker (A)	20 A
Volts (V)	120 V
Frequency (Hz)	60 Hz
Plug Type	120V-3 Prong
Power Cord Length (in.)	41 5/16"

DIMENSIONS & WEIGHT

Overall Appliance Dimensions (HxWxD) (in.)	14 13/16" x 23 7/8" x 19 5/16"
27" Trim Kit Required Cutout Size (HxWxD) (in.)	19 7/8" x 25 7/16" x 21"
30" Trim Kit Required Cutout Size (HxWxD) (in.)	19 7/8" x 28 7/16" x 21"
Net Weight (Lbs)	33 lbs

ACCESSORIES (INCLUDED)

1 Oven Rack, 1 Ceramic Glass Tray, 1 Roller Ring

WARRANTY

Limited Warranty, Entire Appliance, Parts and Labor	2 Year
---	--------

LOT 94 ENCODE

MCES BUILT-IN MICROWAVE WITH CONVECTION

MASTERPIECE® & PROFESSIONAL SERIES



MICROWAVE OVEN AND CUTOUT DIMENSIONS

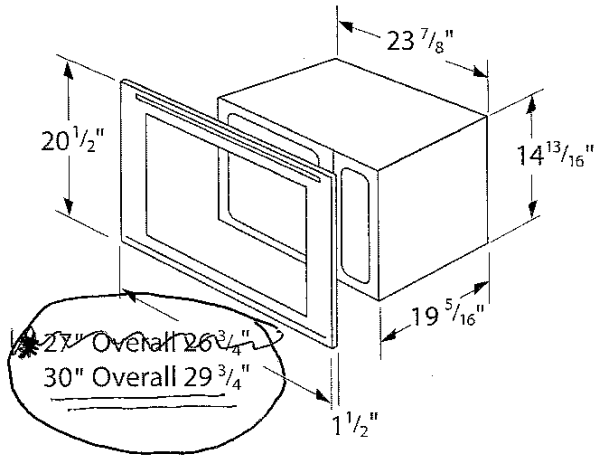

LOT 94. ENCORE

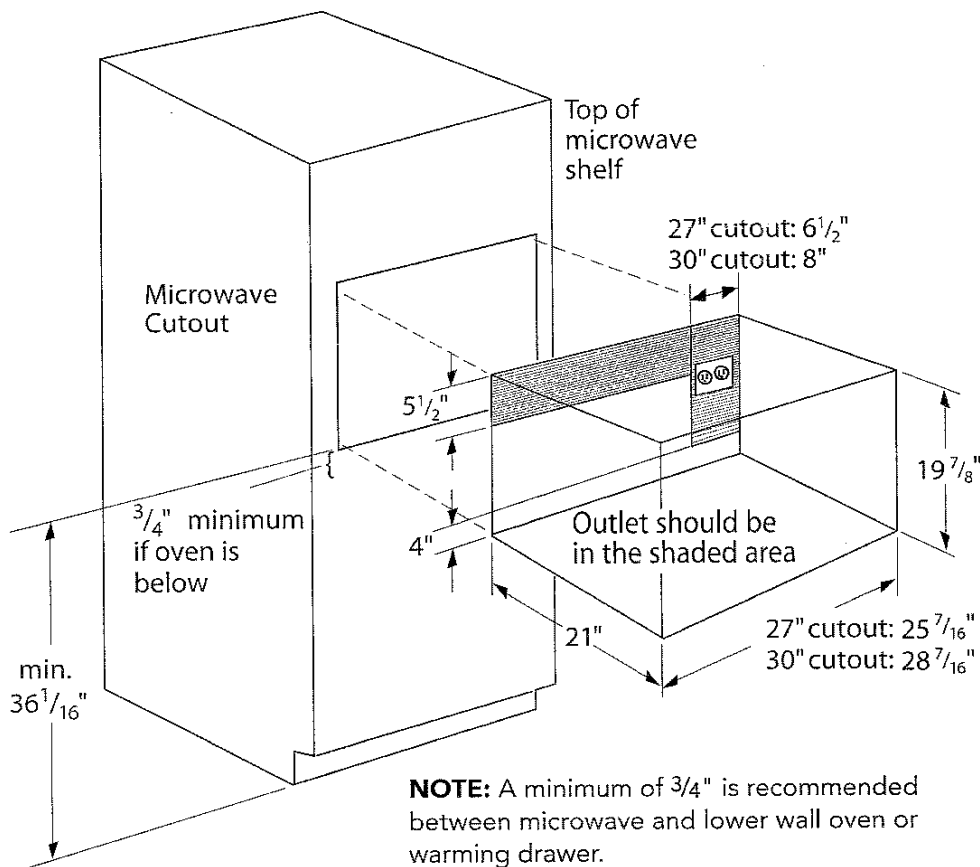

NOTE: A minimum of 3/4" is recommended between microwave and lower wall oven or warming drawer.

These warranties give you specific legal rights and you may have other rights that vary from state to state. Full warranty and limited warranty from date of installation. For complete warranty details, refer to your Use & Care manual, or ask your dealer.

Specifications are for planning purposes only. Refer to installation instructions and consult your countertop supplier prior to making counter opening. Consult with a heating and ventilation engineer for your specific ventilation requirements. For the most detailed information, refer to installation instructions accompanying product or write to Thermador indicating the model number. Specifications are correct at time of printing. Thermador reserves the right to change product specifications or design without notice. Some models are certified for use in Canada. Thermador is not responsible for products that are transported from the U.S. for use in Canada.