

30" GAS COOKTOP

JGC3530G – 30" x 4 $\frac{3}{16}$ " x 21"

C. J. T. H.
November 16, 2020

PRODUCT DIMENSIONS

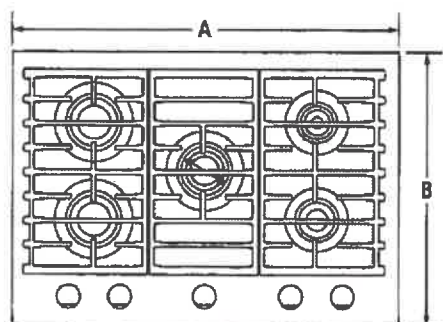

TOP VIEW

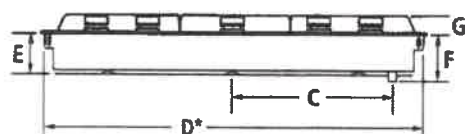

FRONT VIEW

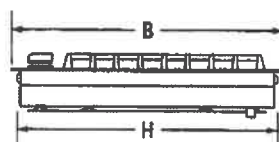

SIDE VIEW

MODEL

JGC3530G

		in	cm
A	Overall width	30	76.2
B	Overall depth	21	53.3
C	Center of cooktop to center of gas inlet	11 $\frac{3}{32}$	30.4
D*	Width of cooktop base	29 $\frac{5}{16}$	74.5
E	Height of cooktop base	3 $\frac{3}{16}$	8.1
F	Height from gas inlet to underside of cooktop	4 $\frac{3}{16}$	10.6
G	Height of cooktop with grates	1 $\frac{1}{4}$	3.1
H	Depth of cooktop base	20 $\frac{3}{16}$	51.6

*Measured from tab to tab. Tabs should not be bent during installation.

LOT 30
APPLEVIEW

1/11

IMPORTANT: Dimensional specifications are provided for planning purposes only.

Do not make any cutouts based on this information. Refer to the Installation Guide before selecting cabinetry, verifying electrical/gas connections, making cutouts or beginning installation. All Jenn-Air® appliances are appropriately UL, CUL or CSA approved.

8994dZw217

30" GAS COOKTOP

JGC3530G – 30" x 4 $\frac{3}{16}$ " x 21"

OPENING/CLEARANCE DIMENSIONS

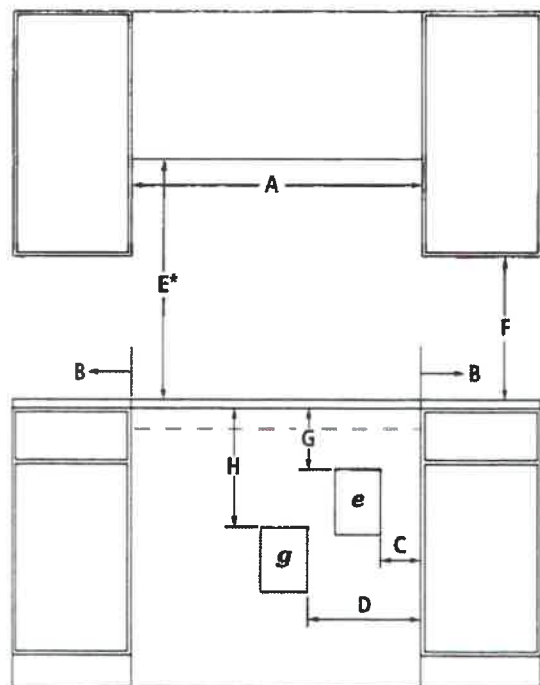

FRONT VIEW

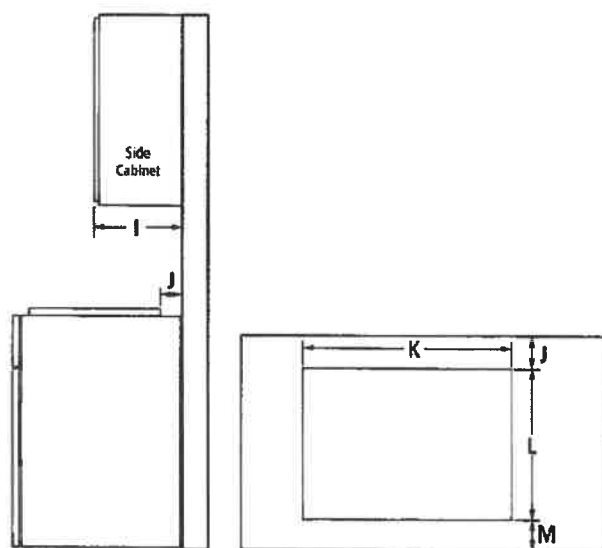

SIDE VIEW

TOP VIEW – CUTOUT

MODEL

JGC3530G

		in	cm
A	Width of combustable area above cooking surface (min.)	30	76.2
B	Width from cooktop to fixed wall or other combustable material (min.)	6	15.2
C	Width to outer edge of electrical outlet (recommended)	9	22.9
D	Width to gas supply line location (recommended)	12	30.5
E*	Height to bottom of uncovered wood or metal cabinet above cooking surface (min.)	30	76.2
F	Height to bottom of uncovered wood or metal cabinet (min.)	18	45.7
G	Height to top edge of electrical outlet (recommended)	9	22.9
H	Height to gas supply line location (recommended)	18	45.7
I	Depth of upper cabinet (recommended)	13	33.0
J	Depth from cutout to wall (min.)	2 $\frac{5}{16}$	5.9
K	Width of cutout	29 $\frac{3}{8}$	74.6
L	Depth of cutout	20 $\frac{3}{8}$	51.8
M	Depth from cutout to front of countertop	2 $\frac{5}{16}$	5.9
e	Recommended electrical access location		
g	Recommended gas supply line location		

*Dimension can be reduced by 6" (15.2 cm) when bottom of wood or metal cabinet is covered by not less than $\frac{1}{4}$ " (0.6 cm) flame retardant millboard covered with not less than No. 28 MSG sheet metal, 0.015" (0.4 mm) stainless steel, 0.024" (0.6 mm) aluminum or 0.020" (0.5 mm) copper. If installing a hood or microwave hood combination above the cooktop, follow the hood or microwave hood combination instructions for dimensional clearances above the cooking surface.

GAS REQUIREMENTS

Natural Gas

This cooktop is factory-set for use with natural gas.

LP Gas Conversion

Conversion must be done by a qualified service technician. To convert to LP gas, use an LP gas conversion kit.

ELECTRICAL REQUIREMENTS

120 volt, 60 Hz, AC only, 15-amp fused, electrical circuit is required. A time-delay fuse or dedicated circuit is recommended.

LOCATION REQUIREMENTS

- To ensure cooktop base clearance, cabinet side walls need to be wider than the cutout.
- If cabinet has a drawer, allow a 4" (10.2 cm) minimum clearance between countertop and top of drawer. Drawer depth may need to be shortened to avoid interfering with the regulator.

IMPORTANT: Dimensional specifications are provided for planning purposes only.

Do not make any cutouts based on this information. Refer to the Installation Guide before selecting cabinetry, verifying electrical/gas connections, making cutouts or beginning installation.

All Jenn-Air® appliances are appropriately UL, CUL or CSA approved.

8994dZw217

INSTALLATION INSTRUCTIONS 27" (68.6 CM) AND 30" (76.2 CM) ELECTRIC BUILT-IN MICROWAVE OVEN FLUSH INSTALLATION KIT

INSTRUCTIONS D'INSTALLATION POUR ENSEMBLE D'INSTALLATION EN AFFLEUREMENT DE FOUR À MICRO-ONDES ÉLECTRIQUE ENCASTRÉ DE 27" (68,6 CM) ET 30" (76,2 CM)

27" (68.6 cm) Flush Installation Kits Ensembles d'installation en affleurement de 27" (68,6 cm)

	Stainless Steel Acier inoxydable	Stainless Steel/ Acier inoxydable, RISE™/NOIR™
Model#/ Modèle n°	Kit PN/ Ensemble référence: W10801485	Kit PN/ Ensemble référence: W11358283
JMC2427DS	**	*
JMC2427IM, JMC2427IL	*	**

30" (76.2 cm) Flush Installation Kits Ensembles d'installation en affleurement de 30" (76,2 cm)

	Black Noir	Stainless Steel/ Acier inoxydable	Stainless Steel/ Acier inoxydable, RISE™/NOIR™
Model#/ Modèle n°	Kit PN/ Ensemble référence: W10801487	Kit PN/ Ensemble référence: W10801486	Kit PN/ Ensemble référence: W11358282
JMC2430DB	**	*	*
JMC2430DP, JMC2430DS	*	**	*
JMC2430IM, JMC2430IL	*	*	**

* Approved for use.

** Recommended color and approved for use.

* Approuvé pour l'utilisation.

** Couleur recommandée et approuvé pour l'utilisation.

Table of Contents/Table des matières

BUILT-IN MICROWAVE OVEN SAFETY.....	2	SÉCURITÉ DU FOUR À MICRO-ONDES ENCASTRÉ.....	5
INSTALLATION REQUIREMENTS.....	2	EXIGENCES D'INSTALLATION.....	5
Tools and Parts.....	2	Outils et pièces.....	5
Location Requirements.....	2	Exigences d'emplacement.....	5
INSTALLATION INSTRUCTIONS.....	4	INSTRUCTIONS D'INSTALLATION.....	7
Prepare Built-In Oven.....	4	Assemblage de la trousse d'entretoise.....	7
Install Spacer Kit.....	4	Installation de la trousse d'entretoise.....	7
Install Microwave Oven.....	4	Installation du four à micro-ondes.....	7
Complete Installation.....	4	Achever l'installation.....	7

IMPORTANT:

Save for local electrical inspector's use.

IMPORTANT:

À conserver pour consultation par l'inspecteur local des installations électriques.

W11356316A

3/4

Cabinet Dimensions - Flush Installation

A 23 1/4" (59 cm) minimum cutout depth is required. These dimensions will result in a 1/4" (6.3 mm) reveal on the top, a 1/4" (6.3 mm) reveal on the sides, and a 1/8" (3.1 mm) reveal on the bottom of the microwave oven. The front face of the cleats and platform will be visible and should be treated as a finished surface.

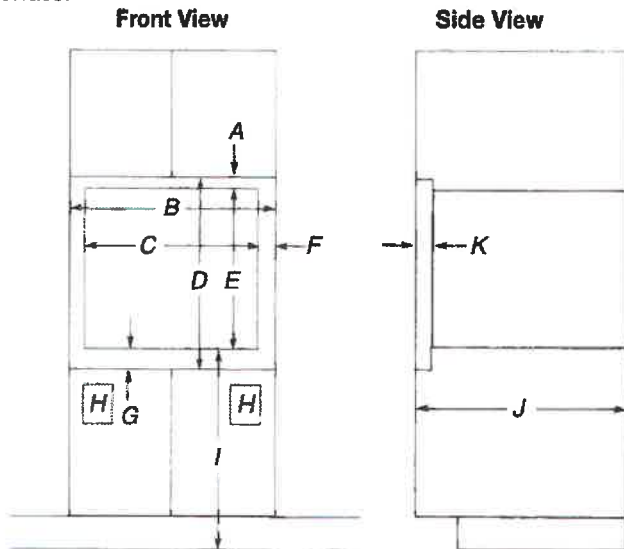

27" (68.6 cm) Models

- A. 1 3/16" (4.7 cm) top cleat*
- B. 27 1/4" (69.2 cm) minimum width of flush inset cutout
- C. 25 1/8" (65.7 cm) minimum width of opening
- D. 20 1/8" (51.3 cm) minimum height of flush inset cutout
- E. 17 7/8" (44.7 cm) recommended cutout height
- F. 1 1/16" (1.7 cm) side cleat*
- G. 3/4" (1.9 cm) bottom cleat*
- H. Recommended junction box location
- I. 40" (101.6 cm) bottom of cutout to floor (recommended)
- J. 23 1/4" (59.0 cm) minimum depth of cutout
- K. 1 3/8" (3.5 cm) recess from front of cabinet

30" (76.2 cm) Models

- A. 1 3/16" (4.7 cm) top cleat*
- B. 30 1/4" (76.8 cm) minimum width of flush inset cutout
- C. 28 7/8" (70.8 cm) minimum width of opening
- D. 20 1/8" (51.3 cm) minimum height of flush inset cutout
- E. 17 7/8" (44.7 cm) recommended cutout height
- F. 1 1/16" (1.7 cm) side cleat*
- G. 3/4" (1.9 cm) bottom cleat*
- H. Recommended junction box location
- I. 40" (101.6 cm) bottom of cutout to floor (recommended)
- J. 23 1/4" (59.0 cm) minimum depth of cutout
- K. 1 3/8" (3.5 cm) recess from front of cabinet

*Cleats must be recessed 1 3/8" (3.5 cm) from the front of the cabinet.

Minimum Installation Clearances

For proper installation, the following minimum clearances must exist below the cabinet opening.

Installation Above Single Built-In Oven

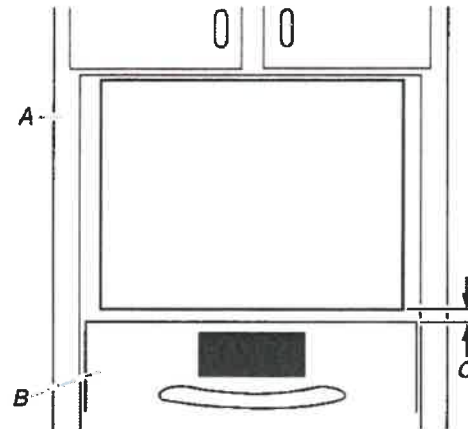

- A. Upper cabinet
- B. Lower single oven*
- C. 1" (2.5 cm) from top of oven

Checked November 16, 2020

4/11

INSTALLATION REQUIREMENTS

Tools and Parts

Gather the required tools and parts before starting installation. Read and follow the instructions provided with any tools listed here.

Tools Needed

- Phillips screwdriver
- Flat-blade screwdriver
- Measuring tape
- Level
- Drill (for wall cabinet installations)
- 1/8" (3 mm) drill bit (for wall cabinet installations)
- 1" (2.5 cm) drill bit (for wall cabinet installations)

Parts Needed

- UL listed or CSA approved conduit connector
- UL listed wire connectors

Parts Needed – Flush Installation

- W10801485 Stainless steel flush installation kit for 27" (68.6 cm) models
- W10801486 Stainless steel flush installation kit for 30" (76.2 cm) models
- W10801487 Black flush installation kit for 30" (76.2 cm) models

To order, see the "Assistance or Service" section of the Use and Care Guide.

Parts Supplied

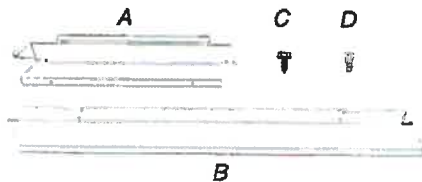

- A. Spacer bars (2)
- B. Bottom vent (1)
- C. 3/8" (9.5 mm) hex-head washer screws (4)
- D. 3/4" (1.9 cm) pan-head screws (4)

Check local codes. Check existing electrical supply. See "Electrical Requirements."

It is recommended that all electrical connections be made by a licensed, qualified electrical installer.

Location Requirements

IMPORTANT: Observe all governing codes and ordinances.

- Cabinet opening dimensions that are shown must be used. Given dimensions provide minimum clearance with microwave oven.
- Recessed installation area must provide complete enclosure around the recessed portion of the microwave oven.
- Grounded electrical supply is required. See "Electrical Requirements" section.
- Electrical supply junction box should be located 3" (7.6 cm) maximum below the support surface when the microwave oven is installed in a wall cabinet. A 1" (2.5 cm) minimum diameter hole should have been drilled in the left rear corner of the support surface to pass the appliance cable through to the junction box.

- For installation above single built-in oven, the junction box must located inside upper cabinet.
- If you are installing the junction box on rear wall behind the microwave oven, the junction box must be recessed and located in the upper or lower right or left corner of the cabinet; otherwise, the microwave oven will not fit into the cabinet opening.
- Microwave oven support surface must be solid, level, and flush with bottom of cabinet cutout. Floor must be able to support a weight of 108 lbs (49.0 kg).

IMPORTANT: To avoid damage to your cabinets, check with your builder or cabinet supplier to make sure that the materials used will not discolor, delaminate, or sustain other damage. This oven has been designed in accordance with the requirements of UL and CSA International and complies with the maximum allowable wood cabinet temperatures of 194°F (90°C).

Product Dimensions

27" (68.6 cm) and 30" (76.2 cm) Microwave Ovens

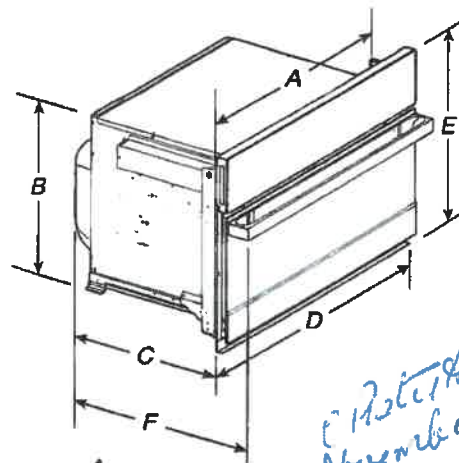

27" (68.6 cm) models

- A. 25 3/8" (64.5 cm)
- B. 17 3/8" (44.1 cm)
- C. 22 1/8" (57.1 cm)
- D. 26 3/4" (68.0 cm) overall width
- E. 19 1/8" (50.3 cm) overall height
- F. JMC2427IM: 25 3/8" (64.9 cm)
JMC2427IL: 24 3/4" (62.9 cm)

30" (76.2 cm) models

- A. 28 3/8" (72.1 cm)
- B. 17 3/8" (44.1 cm)
- C. 22 1/8" (57.7 cm)
- D. 29 3/4" (75.6 cm) overall width
- E. 19 1/8" (50.3 cm) overall height
- F. JMC2430IM: 25 3/8" (64.9 cm)
JMC2430IL: 24 3/4" (62.9 cm)

27" (68.6 cm) and 30" (76.2 cm) Microwave Oven Spacer Kit

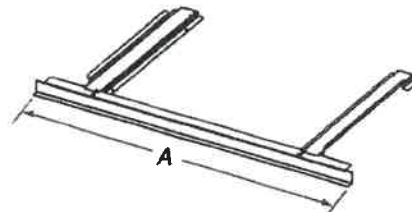

27" (68.6 cm) models

- A. 26 3/4" (67.9 cm) overall width

30" (76.2 cm) models

- A. 29 3/4" (75.6 cm) overall width

NOTE: The microwave oven spacer kit will allow the microwave oven to be installed in a 17 3/8" to 17 3/4" (44.1 to 45.1 cm) maximum cutout height.



30" SINGLE WALL OVEN WITH V2™ VERTICAL DUAL-FAN CONVECTION SYSTEM

Signature Features

JJW3430I

V2™ VERTICAL DUAL-FAN CONVECTION

Dual counter-rotating vertical fans work in tandem, helping you wield your cooking prowess with everything from mouthwatering fillets to irresistible roasts.

MY CREATIONS

My Creations allows you to seamlessly combine up to three cooking modes and save the settings for your favorite recipes.

IRRESISTIBLE INTERIOR

Captivation cloaked in black. Beyond a dark glass expanse, cinematic lighting illuminates smooth racks, flat tines, and an enticing jet black interior.

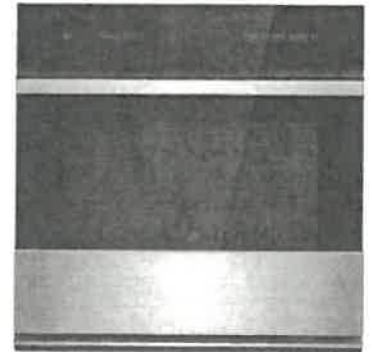

Feature Listing

DESIGN & CRAFTSMANSHIP

Irresistible Interior

7-Inch Full Color LCD Display

Cinematic Lighting

Seamless Touches

Glide Rack

Smooth Close Door

5.0 Cu. Ft. Capacity

PERFORMANCE

V2™ Vertical Dual-Fan Convection

My Creations

Closed Door Broiling

Versatile Modes

3,400-Watt Convection Element

2,800-Watt Hidden Bake Element

4,000-Watt Broil Element

8-Pass Reflective Broil Element

Connected Temperature Probe

ADDITIONAL FEATURES

Keep Warm™ Option

Auto Convection Conversion

Auto Convection Modes

Manual Convection Modes

Rapid Preheat

Proofing Option

Control Lock

Sabbath Mode

ADA Compliant

Badasses at the Ready

Serviced by a Select Few

Specifications

Shipping Weight (lbs) 184

Volts 240

Amps 20

Capacity (Cu. Ft.) 5.0

Dimensions

Overall Dimensions 30" x 29(7/8)" x 25(5/16)"

Opening / Clearance Dimensions (Traditional Installation) 28(1/2)" x 28" x 24"

Opening / Clearance Dimensions (Flush Installation) 30(1/4)" x 30(7/16)" x 25"

Do not make any cutouts based on this information

Style Options

RISE™

JJW3430IL

NOIR™

JJW3430IM

6/11



1 YEAR
WARRANTY

Bold = Top Features

JENNAIR®

SINGLE WALL OVENS

JJW24271 – 27" x 29-7/8" x 25-5/16"

JJW24301, JJW34301 – 30" x 29-7/8" x 25-5/16"

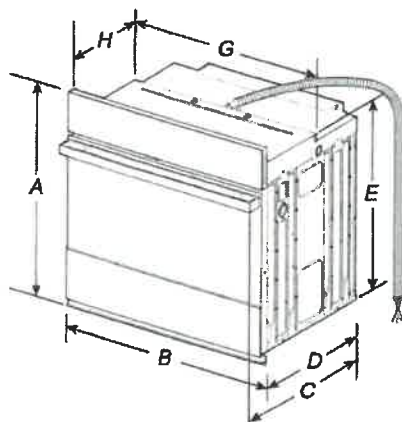

PRODUCT DIMENSIONS – SINGLE OVENS

~~27" (68.6 CM) MODELS~~

- ~~A. 29-7/8" (75.8 cm) max. overall height~~
- ~~B. 27" (68.6 cm) overall width~~
- ~~C. JJW24271M – 26-3/8" (67 cm)
JJW24271L – 27-3/16" (69 cm)~~
- ~~D. 23-1/4" (59.1 cm) max. recessed depth~~
- ~~E. 27-3/16" (69 cm) recessed height~~
- ~~F. 48" (121.9 cm) flexible conduit length~~
- ~~G. 25-7/16" (64.6 cm) max. recessed width~~
- ~~H. 12" (30.5 cm) from back of control panel to start of strain relief~~

30" (76.2 CM) MODELS

- A. 29-7/8" (75.8 cm) max. overall height
- B. 30" (76.2 cm) overall width
- C. JJW24301M – 26-3/8" (67 cm)
JJW24301L – 27-3/16" (69 cm)
JJW34301M – 26-3/8" (67 cm)
JJW34301L – 27-3/16" (69 cm)
- D. 23-1/4" (59.1 cm) max. recessed depth
- E. 27-3/16" (69 cm)
- F. 48" (121.9 cm) flexible conduit length
- G. 28-7/16" (72.2 cm) max. recessed width
- H. 12" (30.5 cm) from back of control panel to start of strain relief

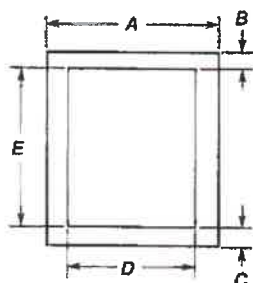

UNDERCOUNTER CABINET DIMENSIONS – SINGLE OVENS

~~27" (68.6 CM) MODELS~~

- ~~A. 27" (68.6 cm) min. cabinet width~~
- ~~B. 1-1/2" (3.8 cm) min. top of cutout to underside of countertop~~
- ~~C. 5-1/4" (13.3 cm) bottom of cutout to floor~~
- ~~D. 25-1/2" (64.8 cm) cutout width~~
- ~~E. 28" (71.2 cm) min. cutout height~~

30" (76.2 CM) MODELS

- A. 30" (76.2 cm) min. cabinet width
- B. 1-1/2" (3.8 cm) min. top of cutout to underside of countertop
- C. 5-1/4" (13.3 cm) bottom of cutout to floor
- D. 28-1/2" (72.4 cm) cutout width
- E. 28" (71.2 cm) min. cutout height

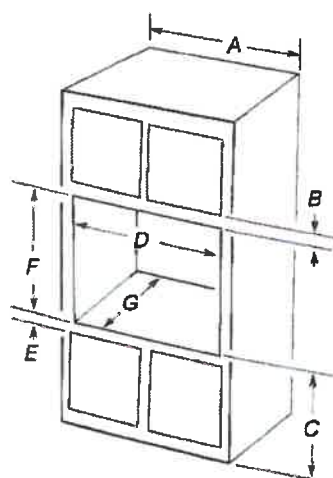

SINGLE OVENS INSTALLED IN CABINET

~~27" (68.6 CM) MODELS~~

- ~~A. 27" (68.6 cm) min. cabinet width~~
- ~~B. 2-3/16" (5.5 cm) top of cutout to bottom of upper cabinet door~~
- ~~C. 32" (81.3 cm) bottom of cutout to floor~~
- ~~D. 25-1/2" (64.8 cm) cutout width~~
- ~~E. 1-1/2" (3.8 cm) min. bottom of cutout to top of cabinet door~~
- ~~F. 28" (71.2 cm)* recommended cutout height~~
- ~~G. 24" (60.7 cm) cutout depth~~

*NOTE: The cutout height can be between 27-1/4" (69.2 cm) and 29-7/16" (74.8 cm) for 27" single ovens.

30" (76.2 CM) MODELS

- A. 30" (76.2 cm) min. cabinet width
- B. 2-3/16" (5.5 cm) top of cutout to bottom of upper cabinet door
- C. 32" (81.3 cm) bottom of cutout to floor
- D. 28-1/2" (72.4 cm) cutout width
- E. 1-1/2" (3.8 cm) min. bottom of cutout to top of cabinet door
- F. 28" (71.2 cm)* recommended cutout height
- G. 24" (60.7 cm) cutout depth

*NOTE: The cutout height can be between 27-1/4" (69.2 cm) and 29-7/16" (74.8 cm) for 30" single ovens.

IMPORTANT: Dimensional specifications are provided for planning purposes only.

Do not make any cutouts based on this information. Refer to the Installation or Use & Care Guide before selecting cabinetry, verifying electrical/gas connections, making cutouts or beginning installation. All JennAir® appliances are appropriately UL, CUL or CSA approved.

SINGLE WALL OVENS

~~JJW24271 - 27" x 29-7/8" x 25-5/16"~~

JJW2430I, JJW3430I - 30" x 29-7/8" x 25-5/16"

ELECTRICAL REQUIREMENTS

If codes permit and a separate ground wire is used, it is recommended that a qualified electrical installer determine that the ground path and the wire gauge are in accordance with local codes.

Check with a qualified electrical installer if you are not sure the oven is properly grounded.

This oven must be connected to a grounded metal, permanent wiring system.

Be sure that the electrical connection and wire size are adequate and in conformance with the National Electrical Code, ANSI/NFPA 70-latest edition or CSA Standards C22.1-94, Canadian Electrical Code, Part 1 and C22.2 No. 0-M91-latest edition, and all local codes and ordinances.

A copy of the above code standards can be obtained from:

National Fire Protection Association
1 Batterymarch Park
Quincy, MA 02169-7471

CSA International
8501 East Pleasant Valley Road
Cleveland, OH 44131-5575

ELECTRICAL CONNECTION

To properly install your oven, you must determine the type of electrical connection you will be using and follow the instructions provided for it here.

- Oven must be connected to the proper electrical voltage and frequency as specified on the model/serial/rating plate. The model/serial/rating plate is located under the control panel on single ovens. See the following illustration



A. Model/Serial/Rating Plate

- Models rated from 7.3 to 9.6 kW at 240 V (5.4 to 7.4 kW at 208 V) require a separate 40 A circuit. Models rated at 4.8 kW and below at 240 V (3.6 kW and below at 208 V) require a separate 20 A circuit.
- A circuit breaker is recommended.
- Connect directly to the circuit breaker box (or fused disconnect) through flexible, armored, or nonmetallic sheathed, copper cable (with grounding wire).
- Flexible conduit from the oven should be connected directly to the junction box.
- Fuse both sides of the line.
- Do not cut the conduit. The length of conduit provided is for serviceability of the oven.
- A UL listed or CSA approved conduit connector must be provided.
- If the house has aluminum wiring, follow the procedure below: Connect the aluminum wiring using special connectors and/or tools designed and UL listed for joining copper to aluminum. Follow the electrical connector manufacturer's recommended procedure. Aluminum/copper connection must conform with local codes and industry accepted wiring practices.

For power requirements for models JJW24271, JJW2430I and JJW3430I, refer to the following table.

Model	240 VAC	208 VAC
	kW	kW
JJW24271	4.1	3.1
JJW2430I	4.1	3.1
JJW3430I	4.5	3.4

*Photo taken
November 16, 2020*

8/11

IMPORTANT: Dimensional specifications are provided for planning purposes only.

Do not make any cutouts based on this information. Refer to the Installation or Use & Care Guide before selecting cabinetry, verifying electrical/gas connections, making cutouts or beginning installation.

All JennAir® appliances are appropriately UL, CUL or CSA approved.



72" COUNTER-DEPTH FRENCH DOOR REFRIGERATORS WITH EXTERNAL DISPENSER

JFFCC72EF – 35³/₄" x 71¹⁵/₁₆" x 31¹/₄" (with handles)

PRODUCT DIMENSIONS

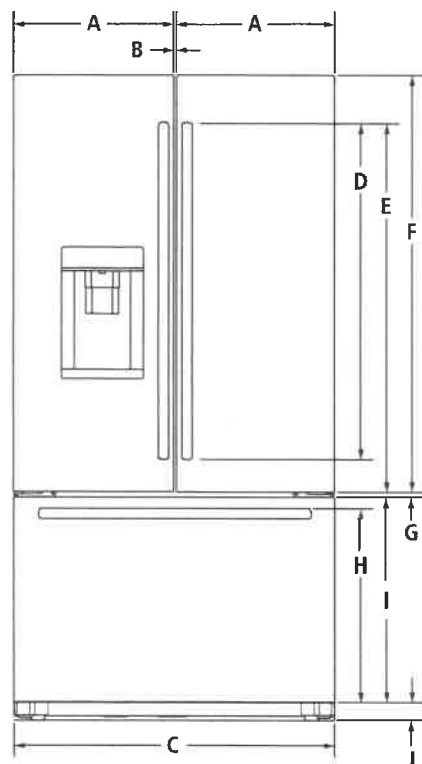

FRONT VIEW

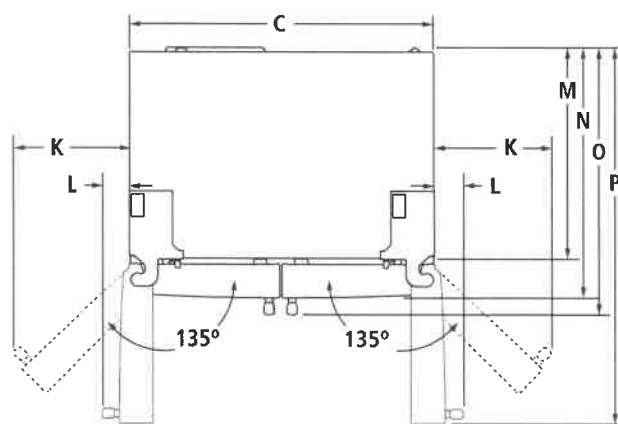

TOP VIEW

MODEL #		JFFCC72EF	
		in	cm
A	Width of each door	17 ¹ / ₁₆	45.0
B	Space between doors	³ / ₈	0.9
C	Overall width	35 ³ / ₄	90.5
D	Height of door handles		
	Pro-Style® Stainless	33 ³ / ₁₆	84.3
	Euro-Style Stainless	37 ³ / ₄	95.6
E	Height to top of door handles		
	Pro-Style® Stainless	38 ¹⁵ / ₁₆	99.0
	Euro-Style Stainless	41 ³ / ₁₆	104.6
F	Height of doors	46 ¹ / ₂	118.2
G	Space between doors and drawer	¹ / ₂	1.2
H	Height to top of drawer handle		
	Pro-Style® Stainless	21 ³ / ₄	55.3
	Euro-Style Stainless	21 ¹ / ₁₆	54.8
I	Height of drawer	23	58.4
J	Height of grille	1 ¹ / ₂	3.9
K	Width from side of refrigerator to handle – door fully open 135°		
	Pro-Style® Stainless	13 ⁷ / ₈	35.2
	Euro-Style Stainless	13 ¹ / ₂	34.3
L	Width from side of refrigerator to handle – door open 90°		
	Pro-Style® Stainless	3 ¹⁵ / ₁₆	10.0
	Euro-Style Stainless	3 ³ / ₈	8.4
M	Depth without doors	24 ⁵ / ₈	62.6
N	Depth with doors	29 ⁵ / ₁₆	74.4
O	Depth with handles		
	Pro-Style® Stainless	31 ¹⁵ / ₁₆	81.1
	Euro-Style Stainless	31 ¹ / ₄	79.4
P	Depth with doors open 90°	44	111.7

9/11

IMPORTANT: Dimensional specifications are provided for planning purposes only.

Do not make any cutouts based on this information. Refer to the Installation Guide before selecting cabinetry, verifying electrical/gas connections, making cutouts or beginning installation.

All Jenn-Air® appliances are appropriately UL, CUL or CSA approved.

72" COUNTER-DEPTH FRENCH DOOR REFRIGERATORS WITH EXTERNAL DISPENSER

JFFCC72EF – 35³/₄" x 71¹⁵/₁₆" x 31¹/₄" (with handles)

DIMENSIONS AS INSTALLED

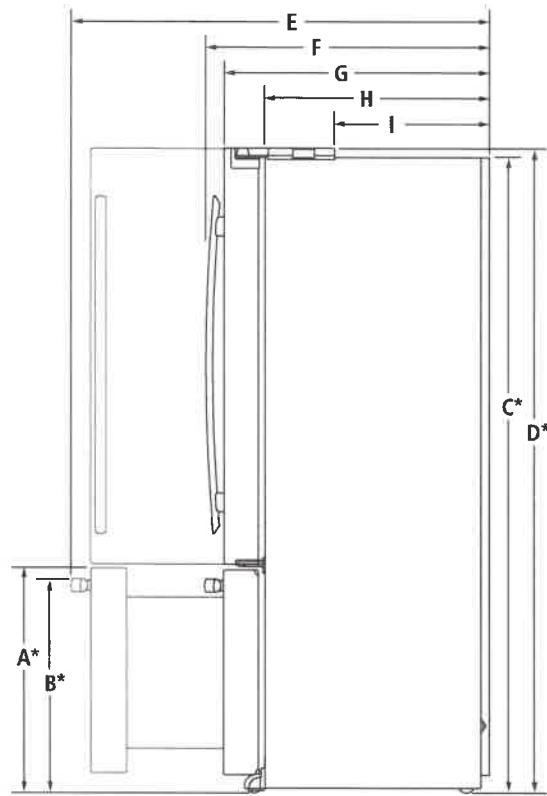

SIDE VIEW

MODEL #		JFFCC72EF	
		in	cm
A*	Height to top of drawer (min.)	24 ¹⁵ / ₁₆	63.3
B*	Height to top of drawer handle (min.)		
	Pro-Style® Stainless	23 ¹¹ / ₁₆	60.2
	Euro-Style Stainless	23 ⁹ / ₁₆	59.8
C*	Height of recessed refrigerator (min.)	70 ¹⁵ / ₁₆	180.1
D*	Height to top of hinges (min.)	71 ¹⁵ / ₁₆	182.7
E	Depth with drawer fully open including drawer handle (min.)		
	Pro-Style® Stainless	46 ⁷ / ₁₆	117.9
	Euro-Style Stainless	45 ⁵ / ₁₆	116.7
F	Depth with handles (min.)		
	Pro-Style® Stainless	31 ¹⁵ / ₁₆	81.1
	Euro-Style Stainless	31 ¹ / ₄	79.4
G	Depth with doors (min.)	29 ⁵ / ₁₆	74.4
H	Depth without doors (min.)	24 ⁵ / ₈	62.6
I	Depth to back of hinges (min.)	16 ³ / ₄	42.6

*Add ³/₄" (1.9 cm) to the height dimension when leveling legs are fully extended.

10/11

IMPORTANT: Dimensional specifications are provided for planning purposes only.

Do not make any cutouts based on this information. Refer to the Installation Guide before selecting cabinetry, verifying electrical/gas connections, making cutouts or beginning installation.

All Jenn-Air® appliances are appropriately UL, CUL or CSA approved.

JENN-AIR®

8719AdZw816

72" COUNTER-DEPTH FRENCH DOOR REFRIGERATORS WITH EXTERNAL DISPENSER

JFFCC72EF – 35³/₄" x 71¹⁵/₁₆" x 31¹/₄" (with handles)

OPENING/CLEARANCE DIMENSIONS

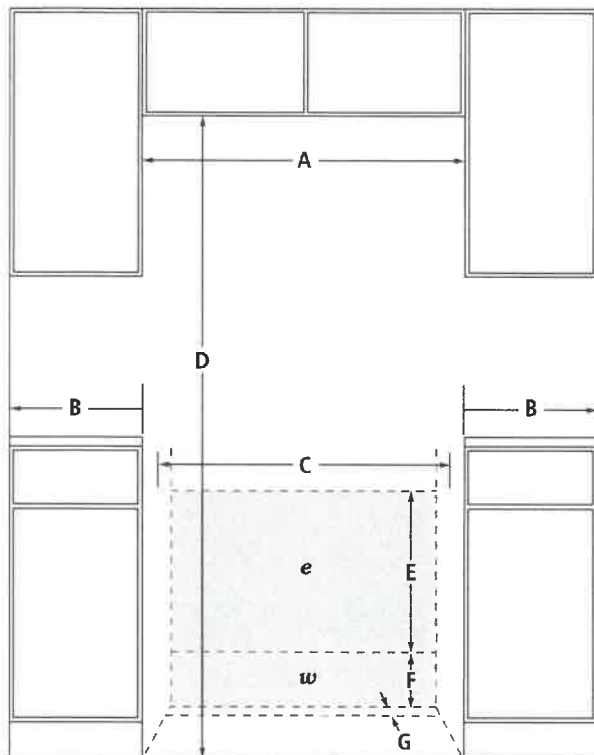

FRONT VIEW

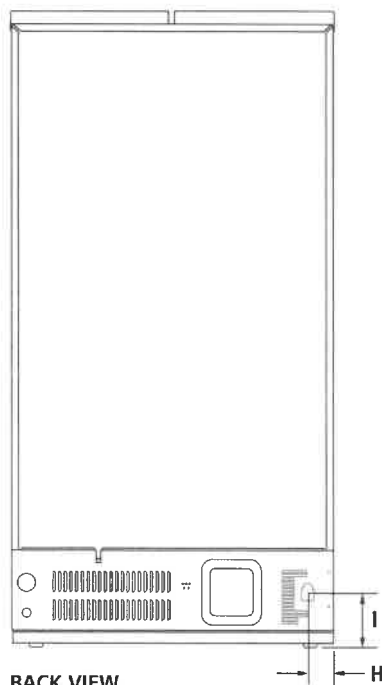

BACK VIEW

MODEL #		JFFCC72EF	
		in	cm
A	Width (min.)	36 ³ / ₄	93.3
	Minimum width from side of refrigerator to fixed wall – door open 90° (full access to remove bins)	3 ³ / ₄	9.5
B	Minimum width from side of refrigerator to fixed wall – door open approx. 135°	12	30.5
	Width of recommended electrical/water installation area	35 ¹ / ₂	90.2
C	Height (min.)	72 ¹ / ₁₆	184.0
D	Height of recommended electrical installation area (min.-max.)	24-36	61.0-91.4
E	Height of recommended water installation area	12	30.5
F	Depth of recommended water installation area	1	2.5
G	Water line location – distance from side	2 ¹ / ₂	6.4
H	Water line location – distance from bottom	7	17.8
I	Recommended electrical connection location		
e	Recommended water connection location		
w			

ELECTRICAL REQUIREMENTS

115 volt, 60 Hz, AC only, 15- or 20-amp fused, grounded circuit is required. A dedicated circuit is recommended. Use an outlet that cannot be turned off by a switch.

Minimum length of power cord is 60" (152.0 cm). Do not use an extension cord.

WATER PRESSURE REQUIREMENTS

A cold water supply with water pressure between 30 and 120 psi (207 and 827 kPa) is required to operate the water dispenser and ice maker. Call a licensed, qualified plumber with any questions about the water pressure.

Reverse Osmosis Water Supply

IMPORTANT: The pressure of the water coming out of a reverse osmosis system going to the water inlet valve of the refrigerator needs to be between 30 and 120 psi (207 and 827 kPa).

If a reverse osmosis water filtration system is connected to the cold water supply, the water pressure to the reverse osmosis system needs to be a minimum of 40 to 60 psi (276 to 414 kPa).

W/11

IMPORTANT: Dimensional specifications are provided for planning purposes only.

Do not make any cutouts based on this information. Refer to the Installation Guide before selecting cabinetry, verifying electrical/gas connections, making cutouts or beginning installation.

All Jenn-Air® appliances are appropriately UL, CUL or CSA approved.



8719AdZw816