

Trade Name: ESQUIRE HOMES	Site location: CLARINGTON	Model: 37-4 OXFORD
Address:	Project: CLARINGTON	Phase:

This layout has been explained to the purchaser by Cortina Kitchens Inc. and is understood by the purchaser.

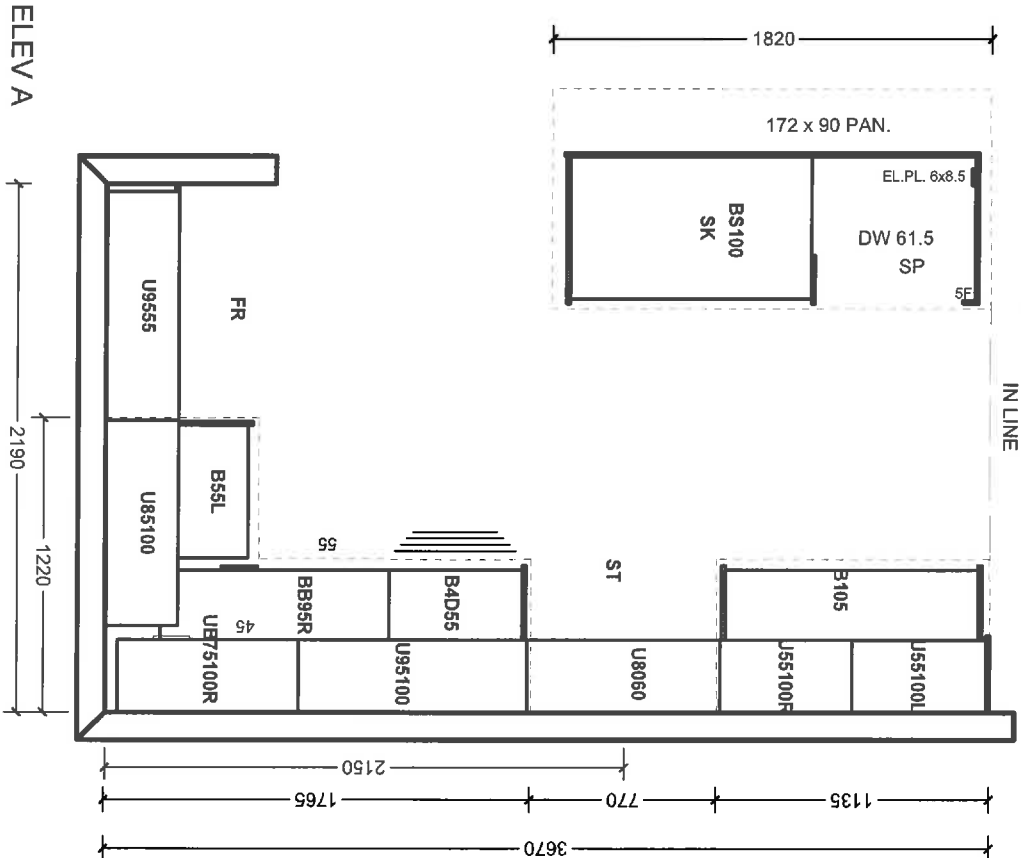

TWIN BED 2/3

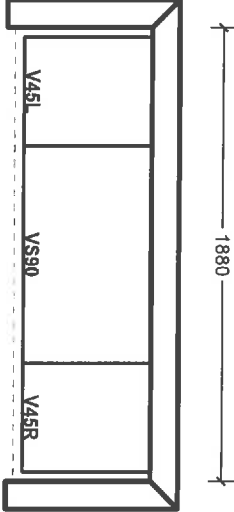

TWIN BED 2/3 OPT 2 SINKS

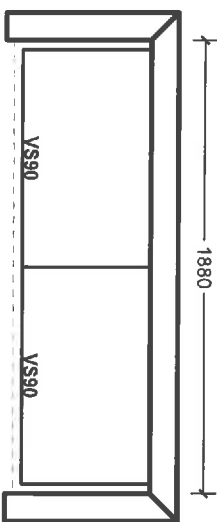

ENS 2 BED 4

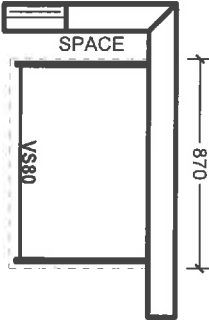

ENSUITE

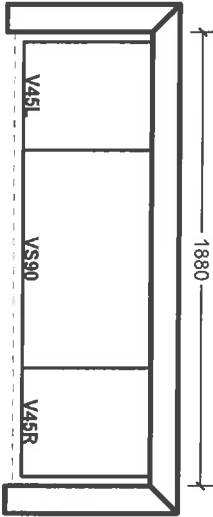

ENSUITE OPT 2 SINKS

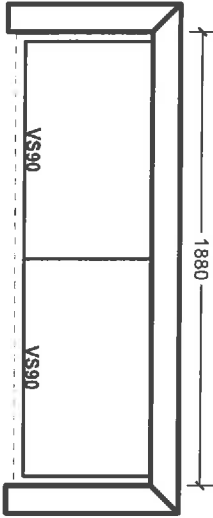

LAUNDRY

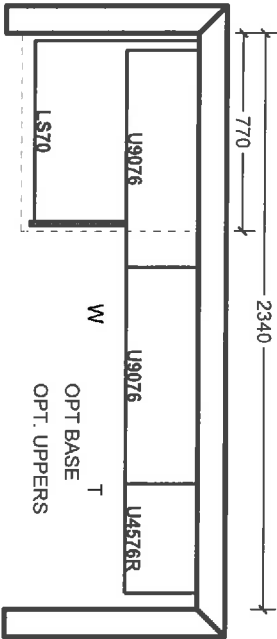

All prices subject to confirmation from head office.
This quotation is subject to the terms & conditions set out
in Cortina's Agreement of Purchase and Sale.

ACCEPTED DATE: _____

All agreements are contingent upon strikes, accidents, and delays beyond our control.
Please provide our installer with template for sinkholes or \$150.00 will be charged for callback.

Item A: Wood grain and colour are characteristics of the product. We cannot guarantee that such grain and colour will always match.
Item B: Cortina Kitchens Inc. reserves the right to alter dimensions and make technical changes without notice.

Customer Signature _____

Salesperson Signature _____

Cortina Head Office Approval _____

Trade Name: ESQUIRE HOMES	Site location: CLARINGTON	Model: 37-4 OXFORD
Address:	Project: CLARINGTON	Phase:

This layout has been explained to the purchaser by Cortina Kitchens Inc. and is understood by the purchaser.

ELEV B

TWIN BED 2/3

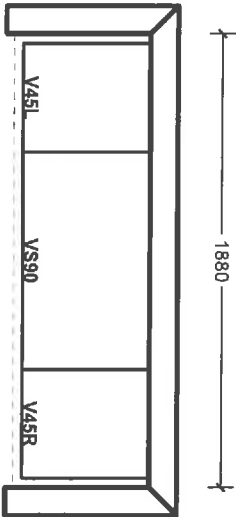

TWIN BED 2/3 OPT 2 SINKS

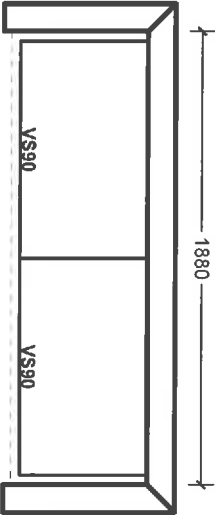

ENS BED 4

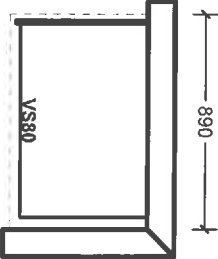

ENSUITE

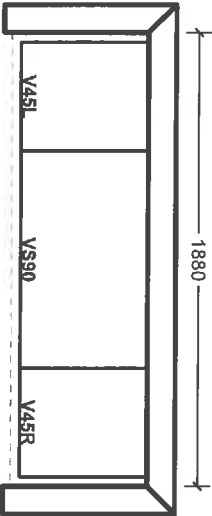

ENSUITE OPT 2 SINKS

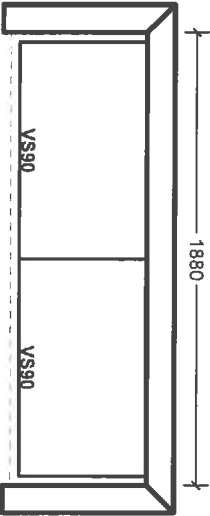

LAUNDRY

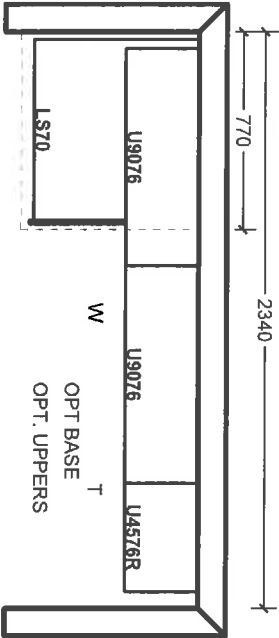

All prices subject to confirmation from head office.
This quotation is subject to the terms & conditions set out
in Cortina's Agreement of Purchase and Sale.

All agreements are contingent upon sinks, accidents, and delays beyond our control.
Please provide our installer with template for sinkholes or \$150.00 will be charged for callback.

ACCEPTED DATE: _____

Customer Signature _____

Salesperson Signature _____

Cortina Head Office Approval _____

Item A. Wood grain and colour are characteristics of the product. We cannot guarantee that such grain and colour will always match.
Item B. Cortina Kitchens Inc. reserves the right to alter dimensions and make technical changes without notice.

Customer Name: ESQUIRE HOMES	Location: CLARINGTON	Page of
Project: CLARINGTON	Model: 37-4 OXFORD	Ph: Lot#:

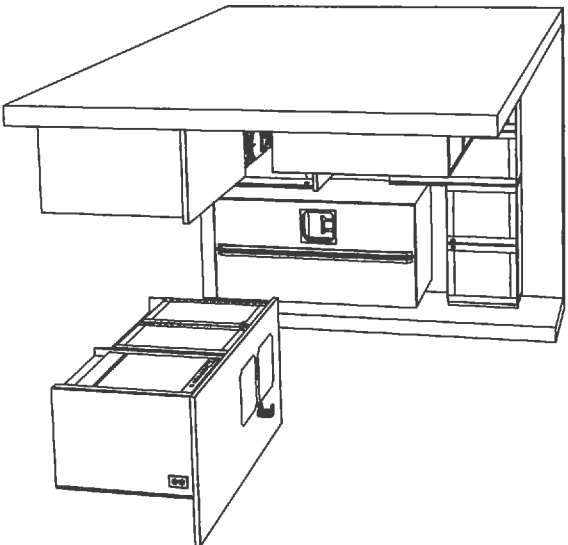
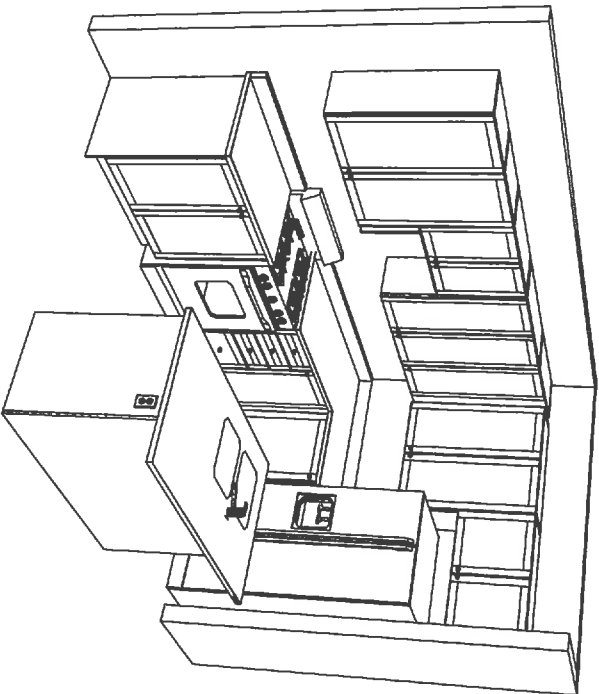

Note: This drawing is an artistic interpretation of the general appearance of the design. It is not meant to be an exact rendition. Generic doors are shown which may affect such things as hardware drilling and specific profiles.designs. .