

Trade Name: ESQUIRE HOMES	Site location: CARLINGTON	Model: 37-2 SEAGRAVE
Address:	Project: CLERINGTON	Phase:

This layout has been explained to the purchaser by Cortina Kitchens Inc. and is understood by the purchaser.

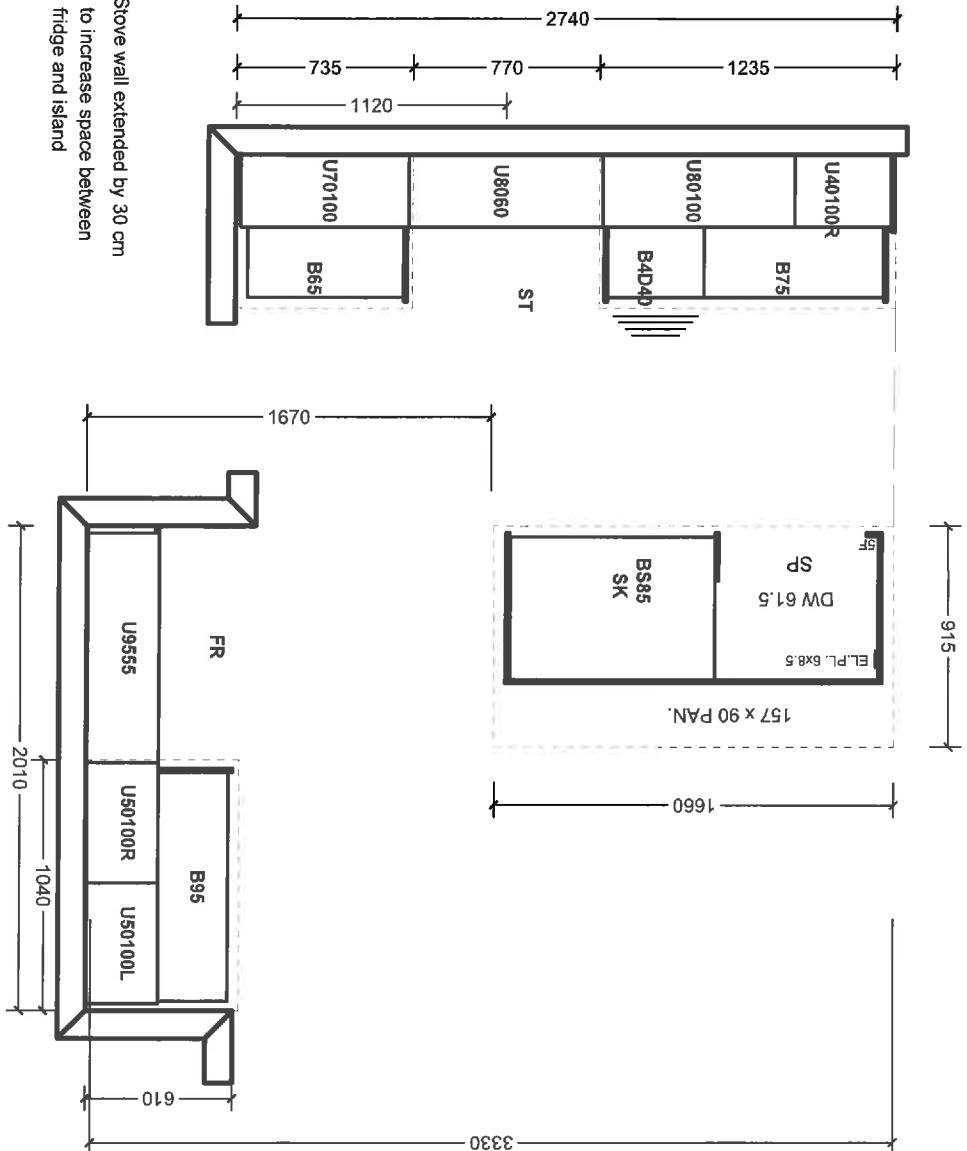

NOTE* Stove wall extended by 30 cm
to increase space between
fridge and island

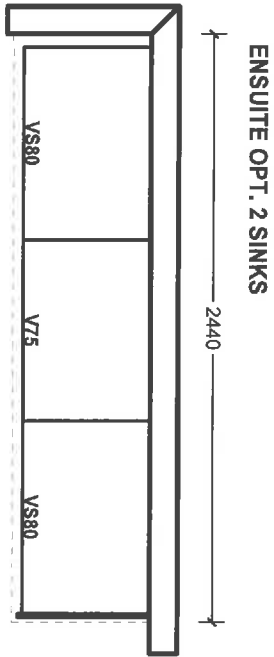
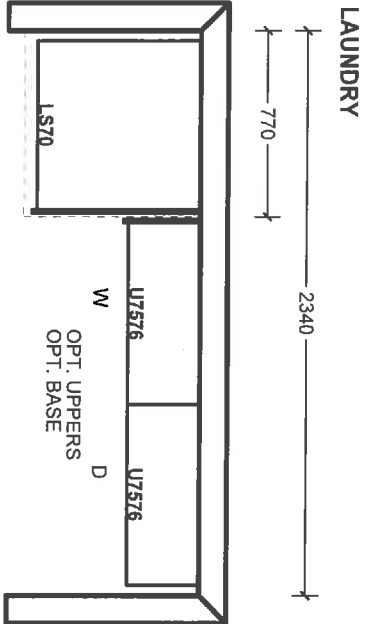
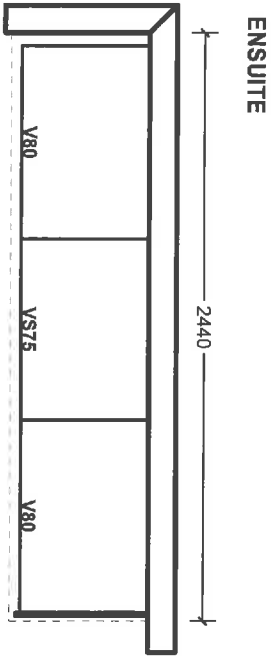
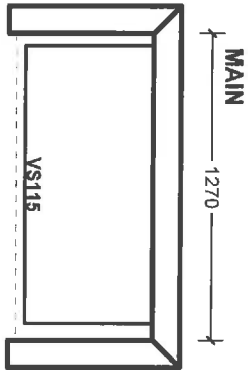

All prices subject to confirmation from head office.
This quotation is subject to the terms & conditions set out
in Cortina's Agreement of Purchase and Sale.

All agreements are contingent upon siffkes, accidents, and delays beyond our control.
Please provide our installer with template for sinkholes or \$150.00 will be charged for callback.

ACCEPTED DATE: _____

Customer Signature _____ Salesperson Signature _____ Cortina Head Office Approval _____

Trade Name: ESQUIRE HOMES	Site location: CARLINGTON	Model: 37-2 SEAGRAVE
Address:	Project: CLERINGTON	Phase:

This layout has been explained to the purchaser by Cortina Kitchens Inc. and is understood by the purchaser.

PART . SEC FLOOR B

MAIN

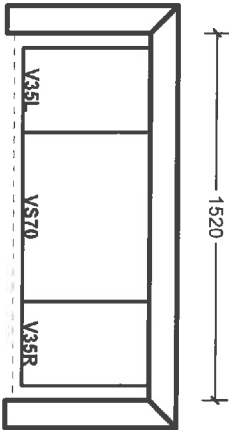

ENSUITE

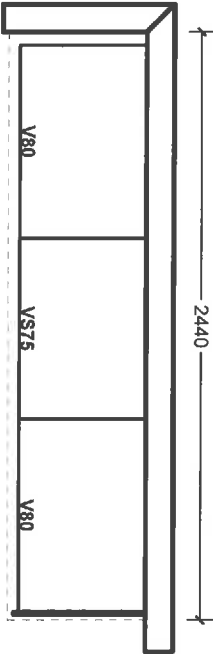

LAUNDRY

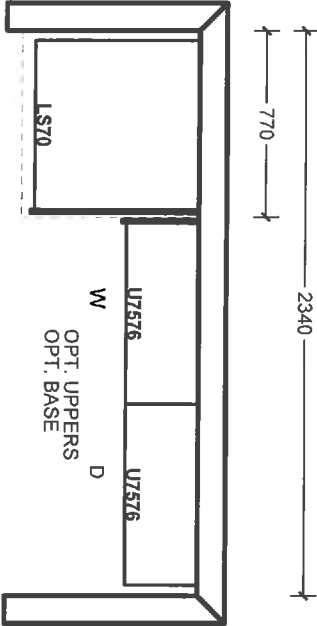

ENSUITE OPT. 2 SINKS

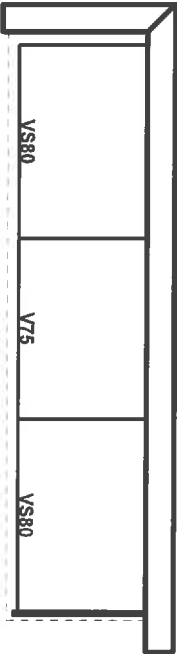

SEC FLOOR C

MAIN

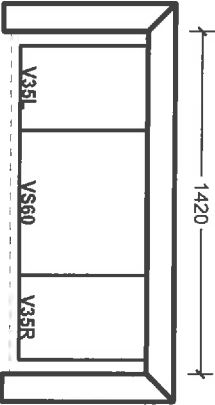

ENSUITE

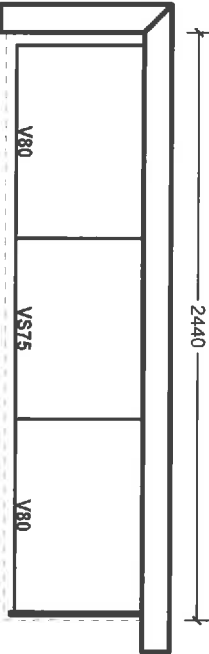

LAUNDRY

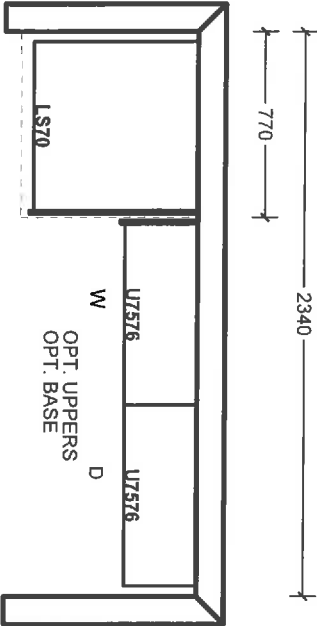

ENSUITE OPT. 2 SINKS

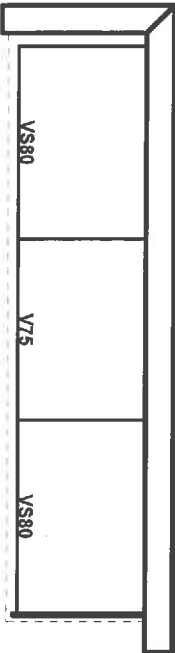

All prices subject to confirmation from head office.
This quotation is subject to the terms & conditions set out
in Cortina's Agreement of Purchase and Sale.

ACCEPTED DATE: _____

All agreements are contingent upon strikes, accidents, and delays beyond our control.
Please provide our installer with template for sinkholes or \$150.00 will be charged for callback.

Item A. Wood grain and colour are characteristics of the product. We cannot guarantee that such grain and colour will always match.
Item B. Cortina Kitchens Inc. reserves the right to alter dimensions and make technical changes without notice.

Customer Signature _____

Salesperson Signature _____

Cortina Head Office Approval _____

Customer Name: ESQUIRE HOMES	Location: CARLINGTON	Page	of
Project: CLERINGTON	Model: 37-2 SEAGRAVE	Ph:	Lot#:

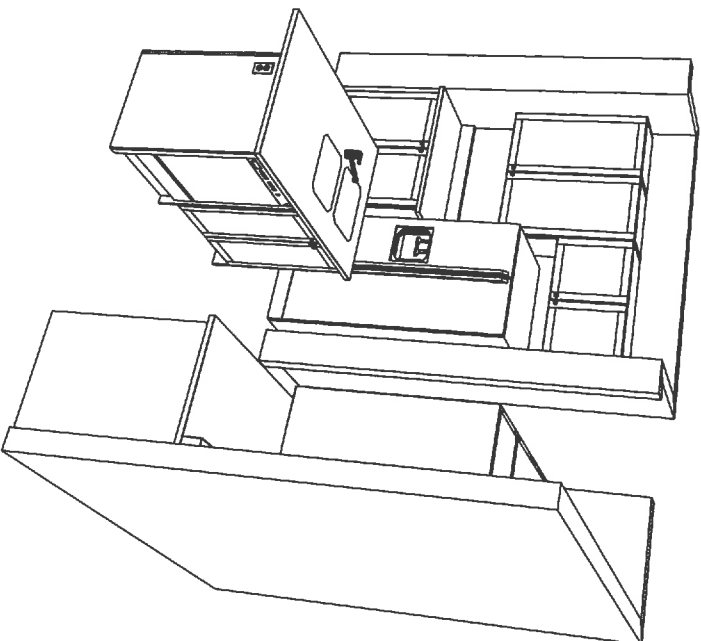
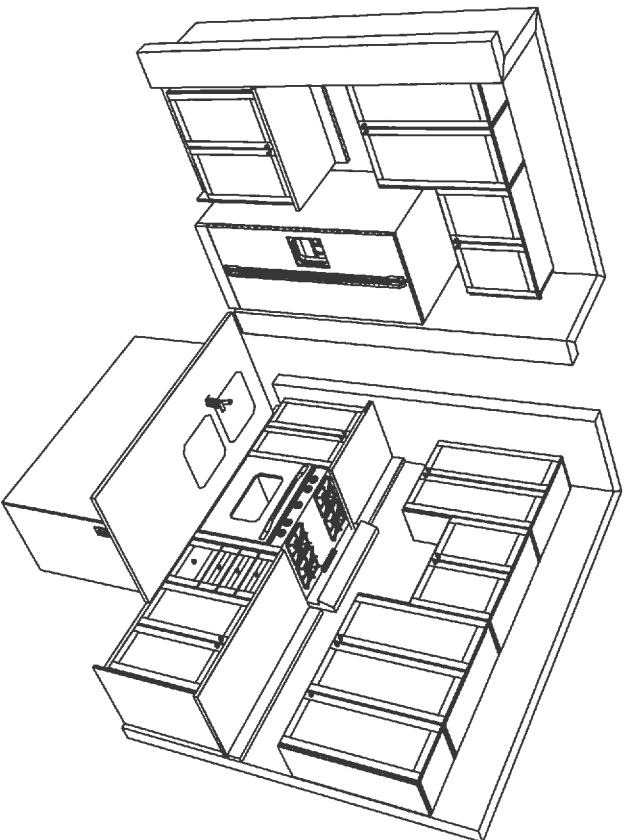

Note: This drawing is an artistic interpretation of the general appearance of the design. It is not meant to be an exact rendition. Generic doors are shown which may affect such things as hardware drilling and specific profiles.designs. .