

Name: Esquire Homes	Site location: Bowmanville	Model: 37-4 Foundry - Elev. A/B & Lot 5
Address:	Project: Northglen	Phase: CORN . UPG

This layout has been explained to the purchaser by Cortina Kitchens Inc. and is understood by the purchaser.

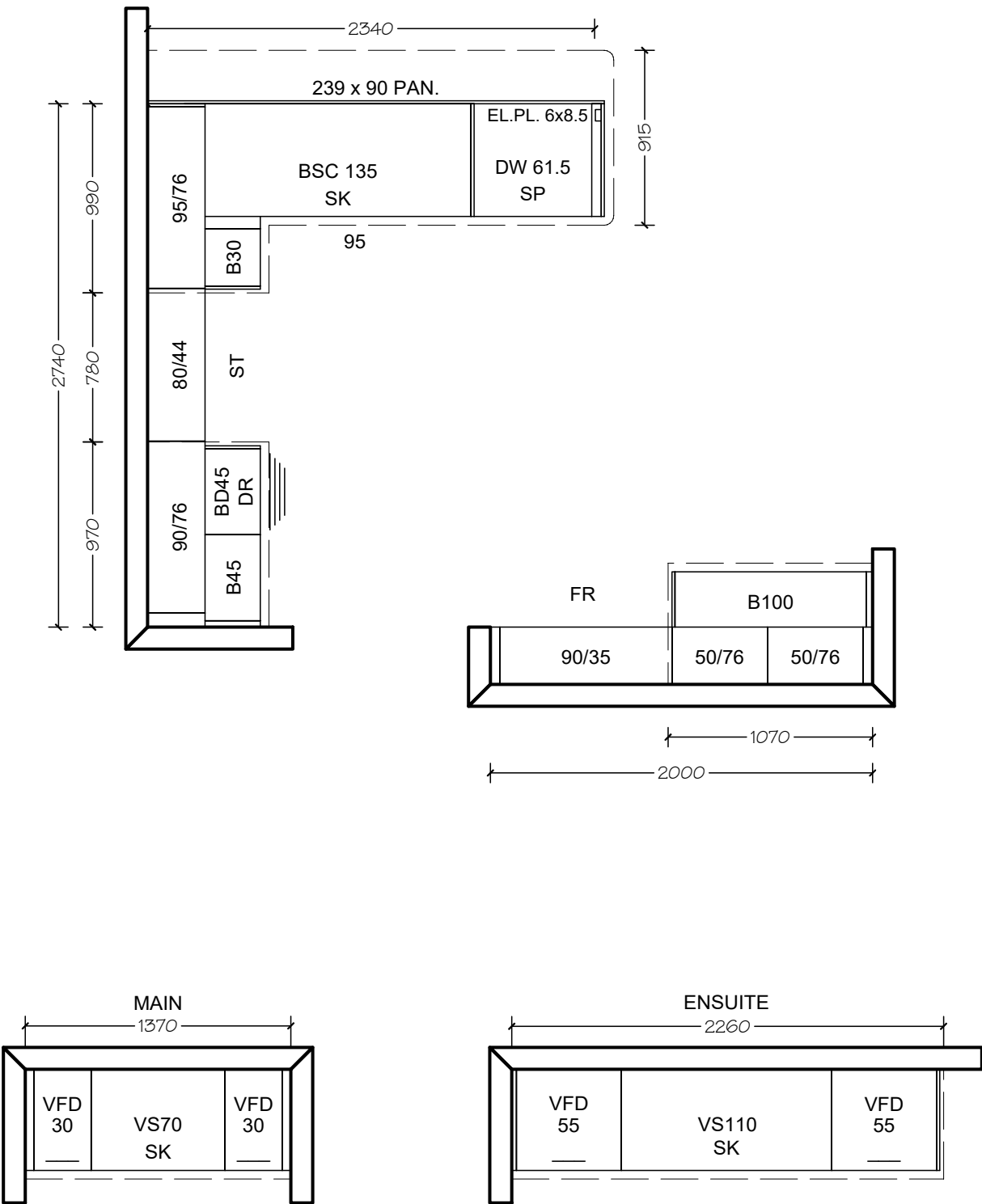

All prices subject to confirmation from head office.
This quotation is subject to the terms & conditions set out
in Cortina's Agreement of Purchase and Sale

All agreements are contingent upon strikes, accidents, and delay beyond our control.
Please provide our installer with template for sinkholes or \$150.00 will be charged for callback.

ACCEPTED DATE: _____

CUSTOMER SIGNATURE

SALESPERSON SIGNATURE

CORTINA HEAD OFFICE APPROVAL

ITEM A. Wood grain and colour are characteristics of the product, we cannot guarantee that such grain and colour will always match
ITEM B. Cortina Kitchens reserves the right to alter dimensions and make technical changes without notice.

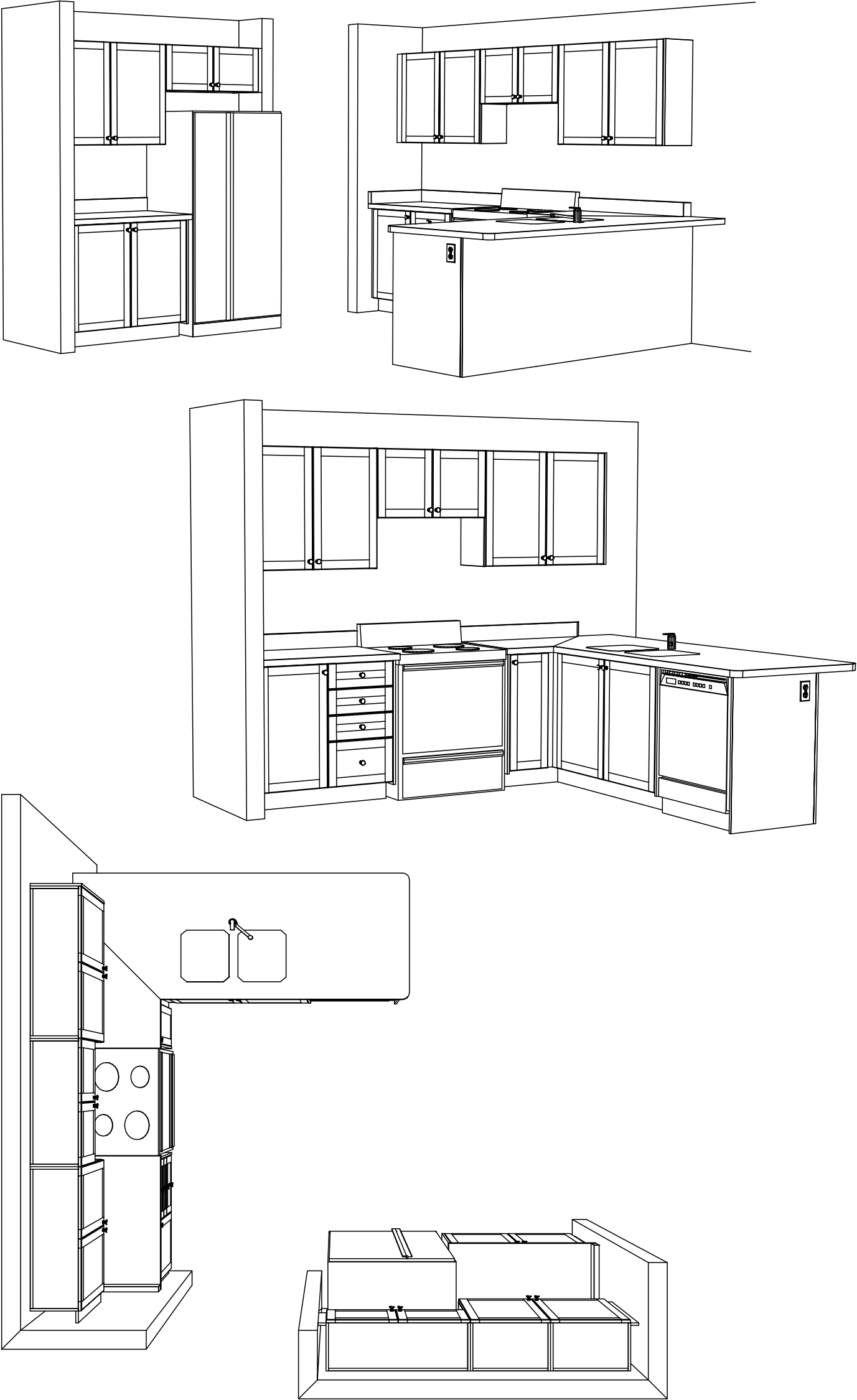

Note: This drawing is an artistic interpretation of the general appearance of the design. It is not meant to be an exact rendition. Generic doors are shown which may affect such things as hardware drilling and specific profiles.designs. .

Name: Esquire Homes	Site location: Bowmanville	Model: 37-7 Newcastle
Address:	Project: Northglen	Phase: CORN. UPG.

This layout has been explained to the purchaser by Cortina Kitchens Inc. and is understood by the purchaser.

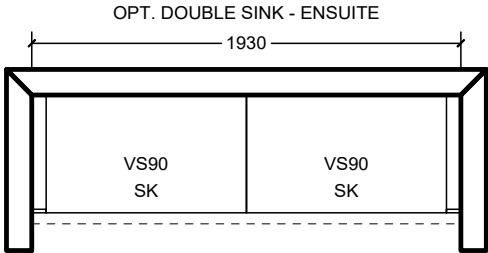
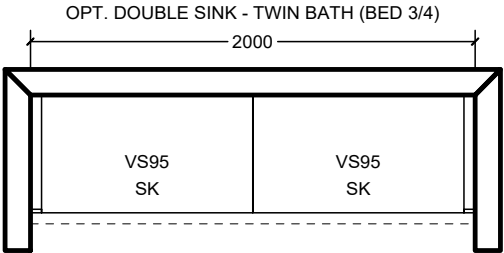
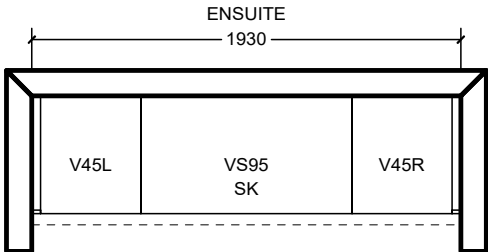
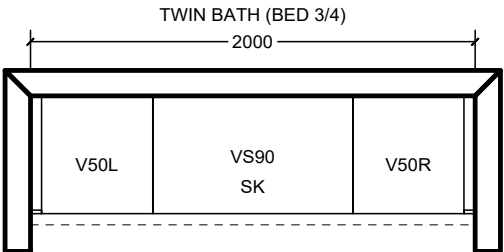
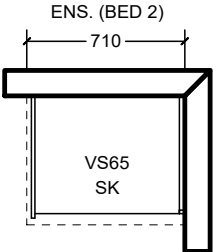
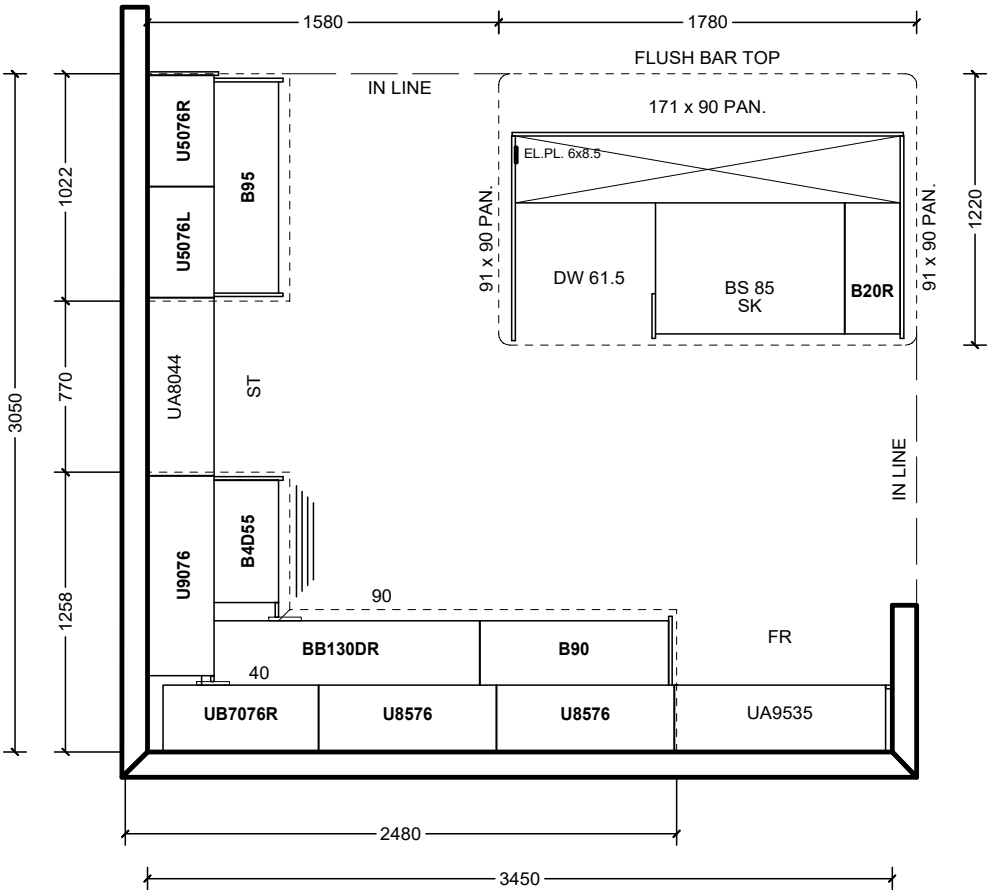

All prices subject to confirmation from head office.
This quotation is subject to the terms & conditions set out
in Cortina's Agreement of Purchase and Sale

All agreements are contingent upon strikes, accidents, and delay beyond our control.
Please provide our installer with template for sinkholes or \$150.00 will be charged for callback.

ACCEPTED DATE: _____

CUSTOMER SIGNATURE

SALESPERSON SIGNATURE

CORTINA HEAD OFFICE APPROVAL

ITEM A. Wood grain and colour are characteristics of the product, we cannot guarantee that such grain and colour will always match
ITEM B. Cortina Kitchens reserves the right to alter dimensions and make technical changes without notice.

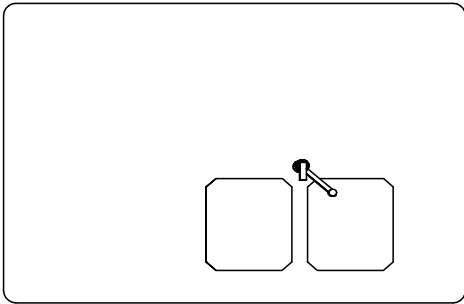
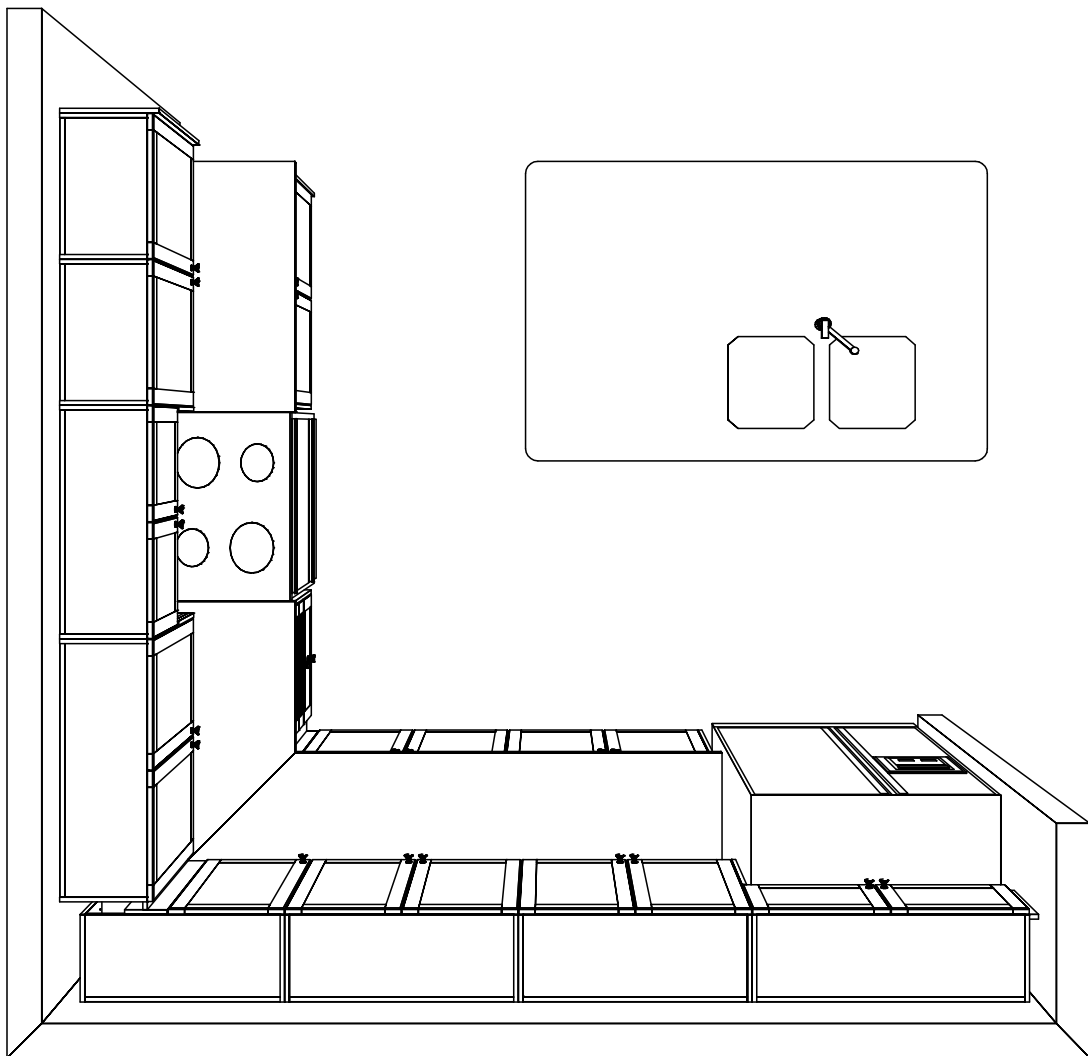
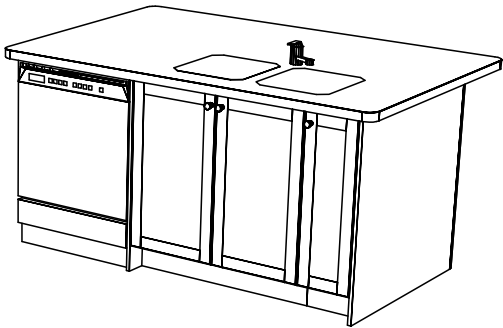
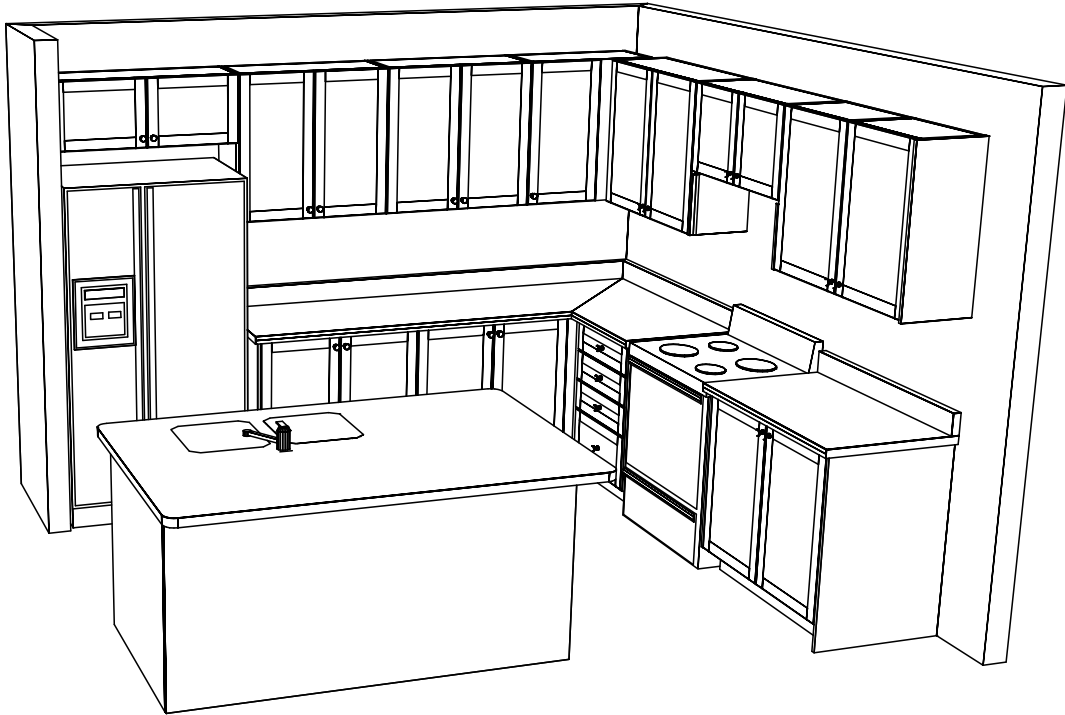

Note: This drawing is an artistic interpretation of the general appearance of the design. It is not meant to be an exact rendition. Generic doors are shown which may affect such things as hardware drilling and specific profiles.designs. .

Name: Esquire Homes	Site location: Bowmanville	Model: 37-8 Hampton
Address:	Project: Northglen	Phase: CORN. UPG.

This layout has been explained to the purchaser by Cortina Kitchens Inc. and is understood by the purchaser.

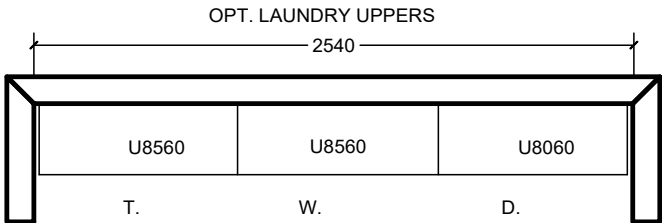
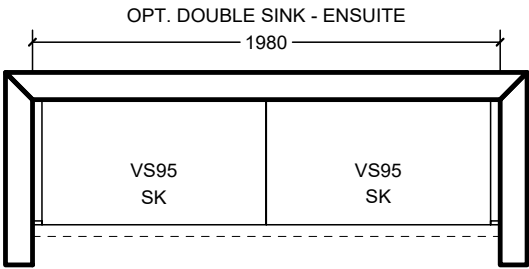
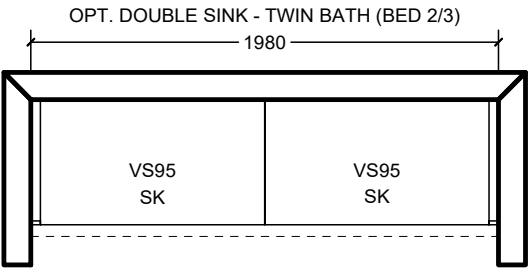
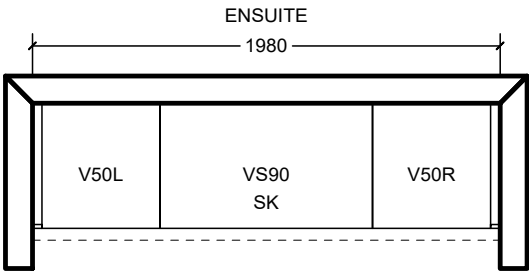
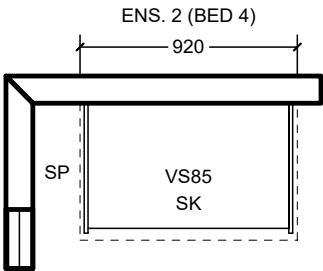
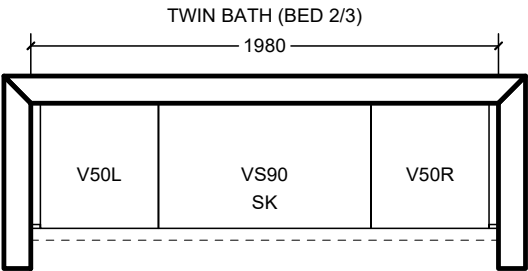
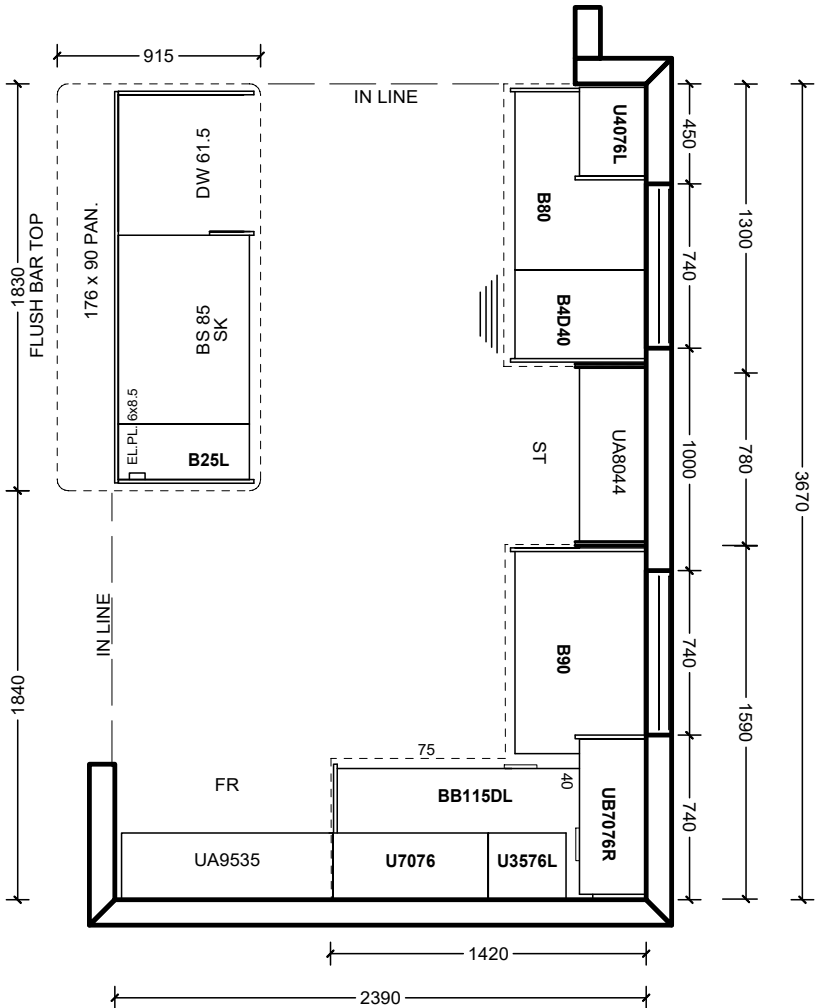

All prices subject to confirmation from head office.
This quotation is subject to the terms & conditions set out
in Cortina's Agreement of Purchase and Sale

All agreements are contingent upon strikes, accidents, and delay beyond our control.
Please provide our installer with template for sinkholes or \$150.00 will be charged for callback.

ACCEPTED DATE: _____

CUSTOMER SIGNATURE

SALESPERSON SIGNATURE

CORTINA HEAD OFFICE APPROVAL

ITEM A. Wood grain and colour are characteristics of the product, we cannot guarantee that such grain and colour will always match
ITEM B. Cortina Kitchens reserves the right to alter dimensions and make technical changes without notice.

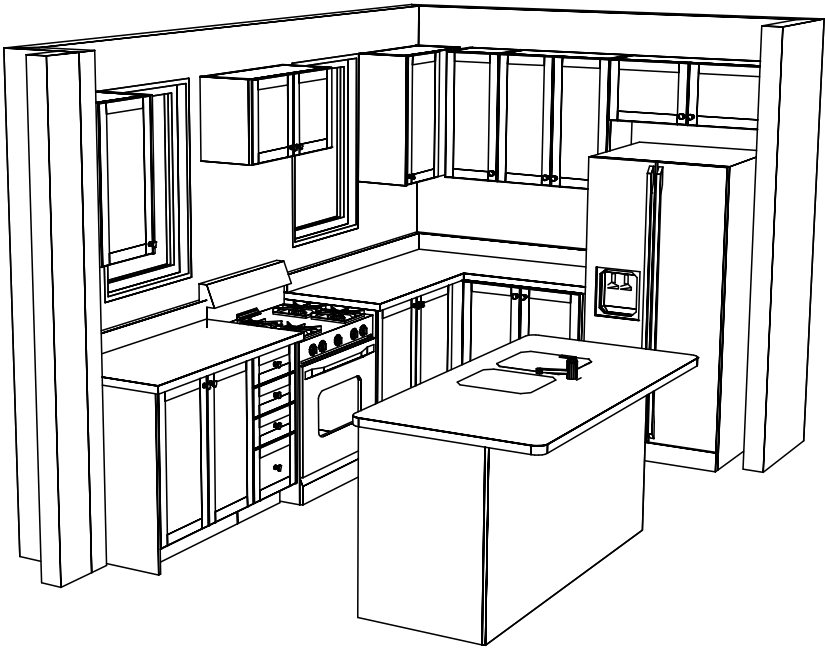
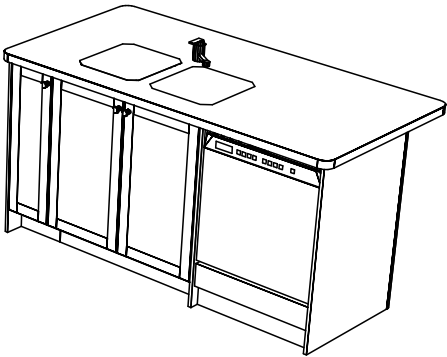
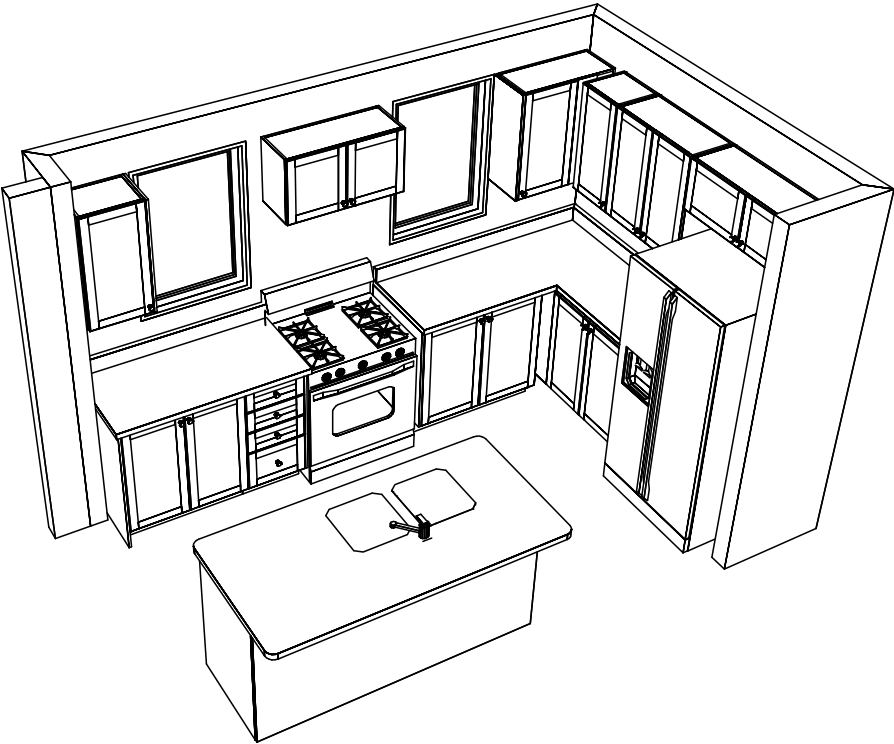

Note: This drawing is an artistic interpretation of the general appearance of the design. It is not meant to be an exact rendition. Generic doors are shown which may affect such things as hardware drilling and specific profiles.designs. .

Name: Esquire Homes	Site location: Bowmanville	Model: 40-5 George - Elev. A & B
Address:	Project: Northglen	Phase: CORN. UPG.

This layout has been explained to the purchaser by Cortina Kitchens Inc. and is understood by the purchaser.

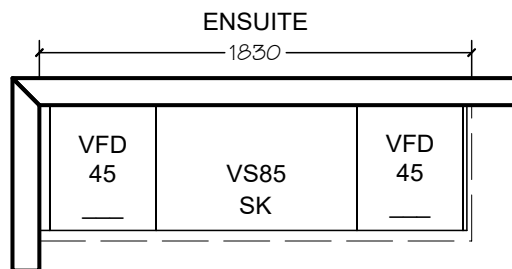
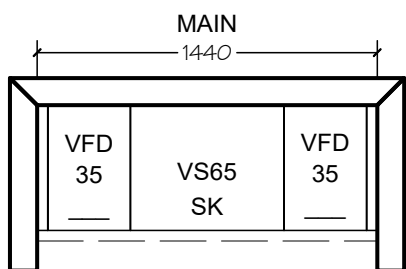
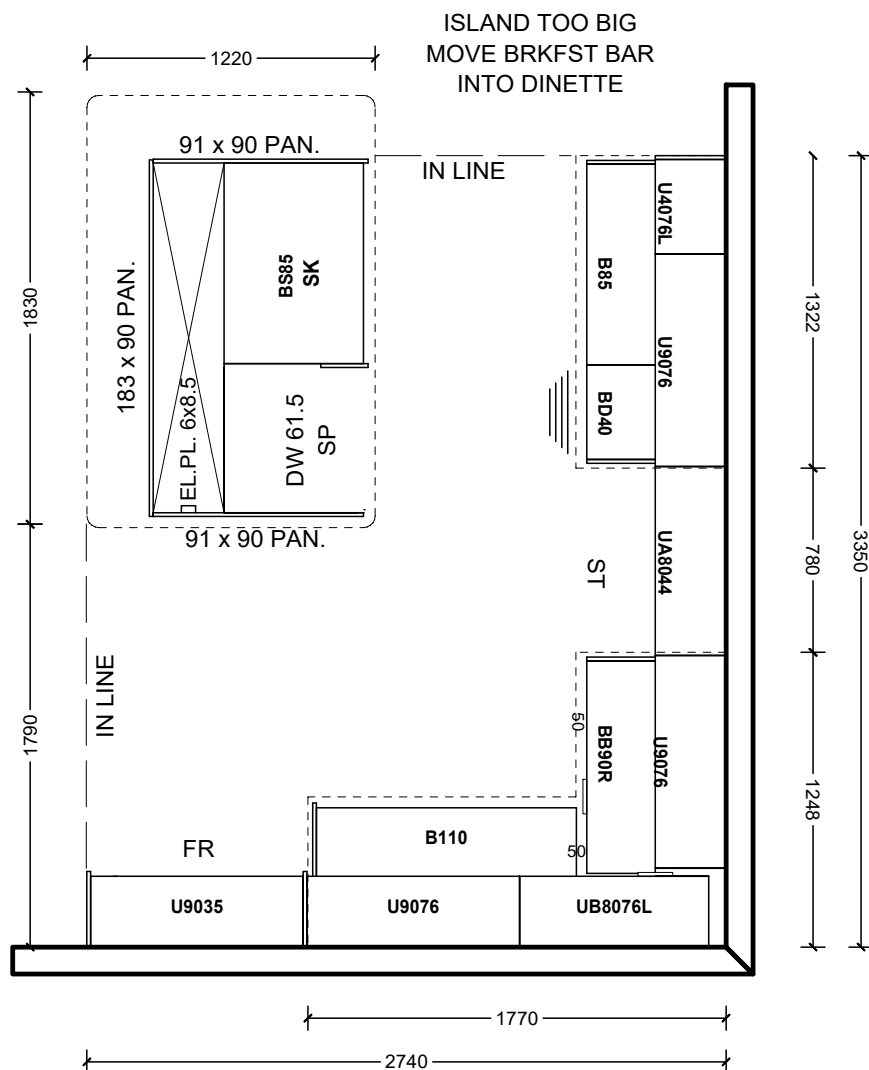

All prices subject to confirmation from head office.
This quotation is subject to the terms & conditions set out
in Cortina's Agreement of Purchase and Sale

All agreements are contingent upon strikes, accidents, and delay beyond our control. Please provide our installer with template for sinkholes or \$150.00 will be charged for callback.

ACCEPTED DATE: _____

CUSTOMER SIGNATURE

SALESPERSON SIGNATURE

CORTINA HEAD OFFICE APPROVAL

ITEM A. Wood grain and colour are characteristics of the product, we cannot guarantee that such grain and colour will always match
ITEM B. Cortina Kitchens reserves the right to alter dimensions and make technical changes without notice.

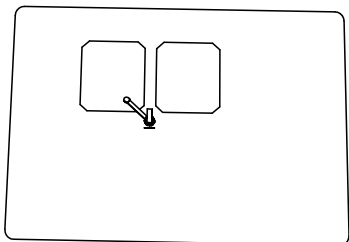
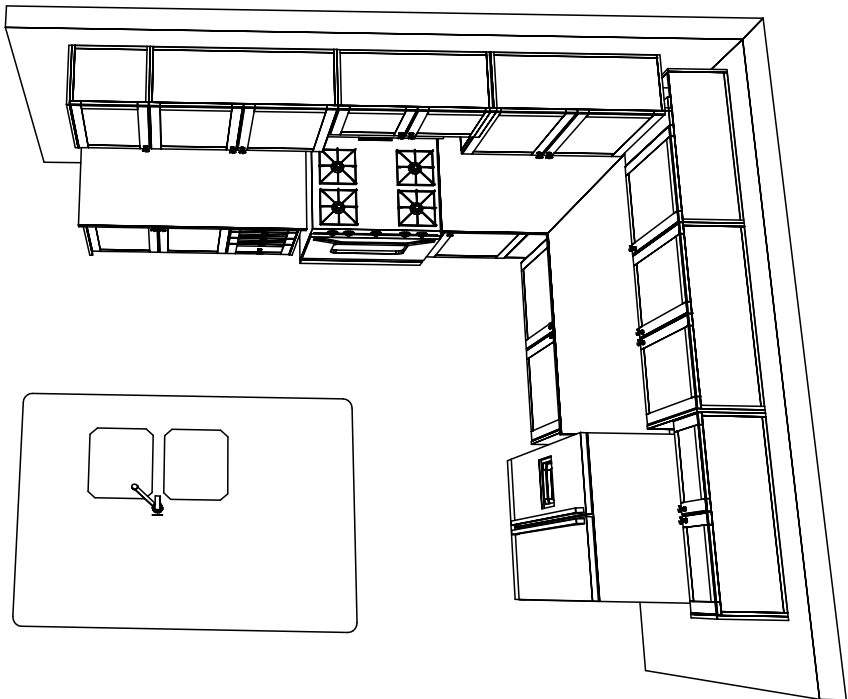
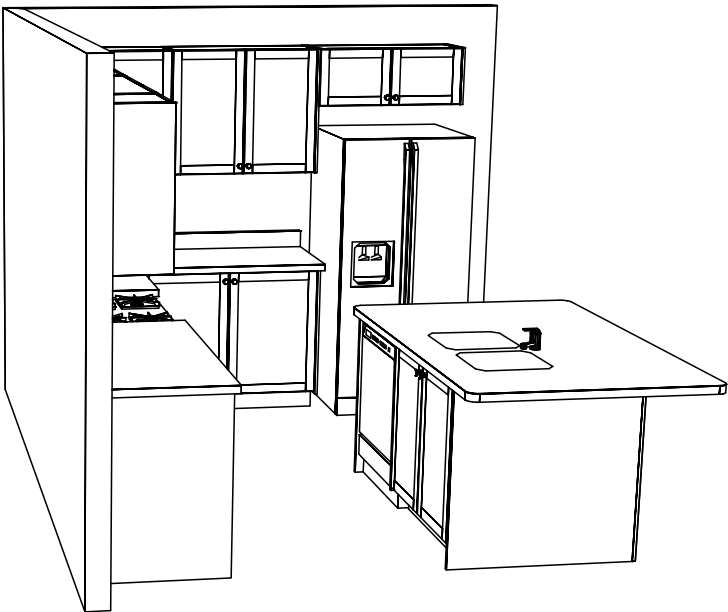
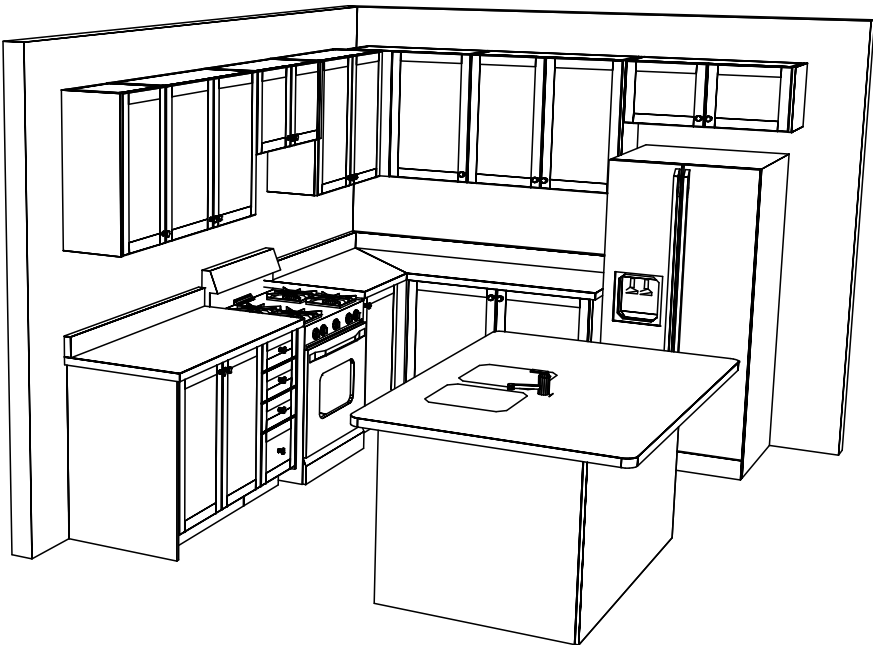

Note: This drawing is an artistic interpretation of the general appearance of the design. It is not meant to be an exact rendition. Generic doors are shown which may affect such things as hardware drilling and specific profiles.designs. .

Trade Name: Esquire Homes	Site location: Bowmanville	Model: 40-5 George elev. A-B
Address:	Project: Northglen	Phase: CORN. UPG.

This layout has been explained to the purchaser by Cortina Kitchens Inc. and is understood by the purchaser.

WET BAR IN FIN. BASEMENT

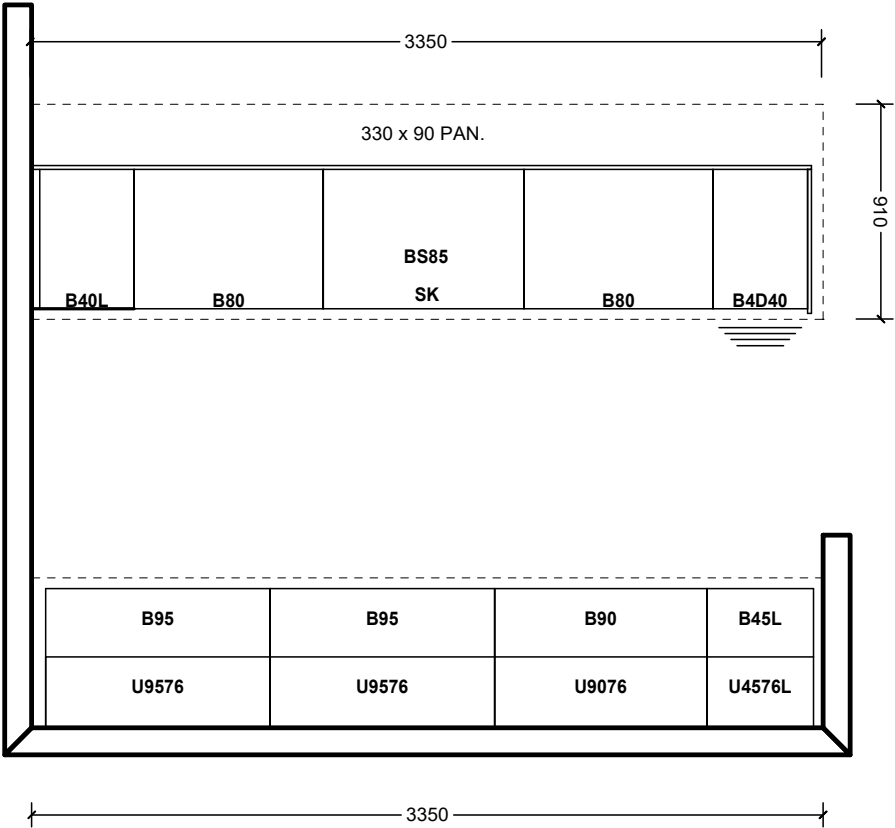

BATH . BASEMENT

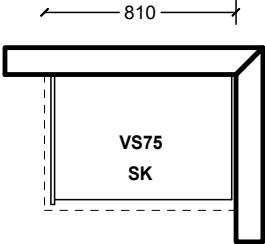

All prices subject to confirmation from head office.
This quotation is subject to the terms & conditions set out
in Cortina's Agreement of Purchase and Sale.

ACCEPTED DATE: _____

All agreements are contingent upon strikes, accidents, and delays beyond our control.
Please provide our installer with template for sinkholes or \$150.00 will be charged for callback.

Customer Signature Salesperson Signature Cortina Head Office Approval

Item A. Wood grain and colour are characteristics of the product. We cannot guarantee that such grain and colour will always match.
Item B. Cortina Kitchens Inc. reserves the right to alter dimensions and make technical changes without notice.