

Delpark Homes Design Studio

From: microsoft.com account team <estharaan@hotmail.com>
Sent: July 31, 2023 3:59 PM
To: Delpark Homes Design Studio
Subject: Re: Lot 24 Port Perry Delpark Homes

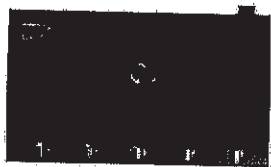

Samsung 36-inch Gas Coc

Overview

Specification

Model: NA36N7755TG

Store SKU: 1001179822

Installation requirements

Pre-installation checklist

- 1. When preparing cooktop opening, make sure the inside of the cabinet, and the cooktop do not interfere with each other.
- 2. Remove packing materials, grate boxes, regulator with literature, and literature package from the cooktop before beginning installation.

Location requirements

BEFORE YOU BEGIN to install this appliance, refer to the following information, dimensions, and clearances. These dimensions must be met for safe use of the cooktop. The location of the electrical outlet and gas piping may be adjusted to meet the following dimensions and clearances.

CAUTION

This cooktop has been designed to comply with the maximum allowable wood cabinet temperature of 194 °F (90 °C). Make sure the wall covering, countertops, and cabinets around the cooktop can withstand the heat (up to 194 °F [90 °C]) generated by the cooktop. If not, discoloration, delamination, or melting may occur.

Maintain the following minimum clearance dimensions

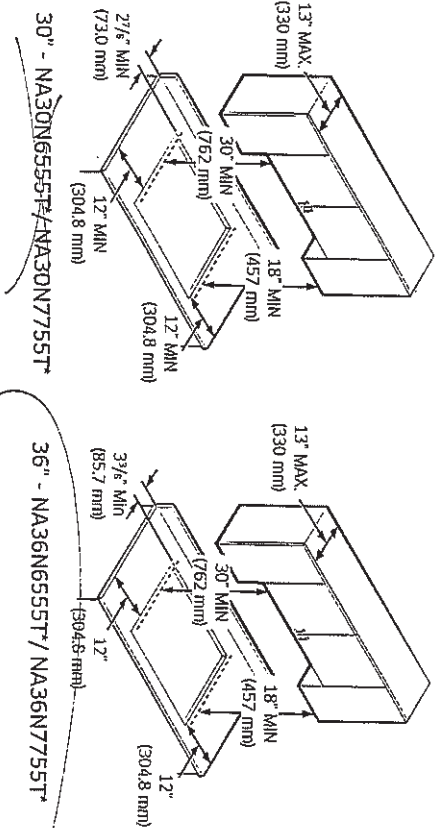

10 English

NOTE

All horizontal clearances must be maintained for a minimum of 18" (457 mm) above the cooking surface.

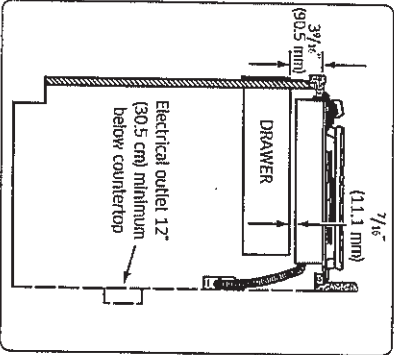

NOTE

Allow 7/16" minimum vertical clearance from the cooktop bottom (or 39/16") minimum depth from the countertop) to any combustible surfaces, including the upper edge or a drawer installed below the cooktop.

Installation over built-in oven

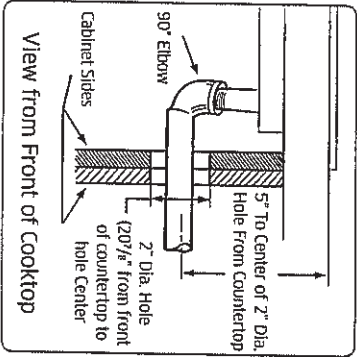

See built-in oven installation for complete installation instructions.

Port Perry
Lot 24



Overall cooktop dimensions

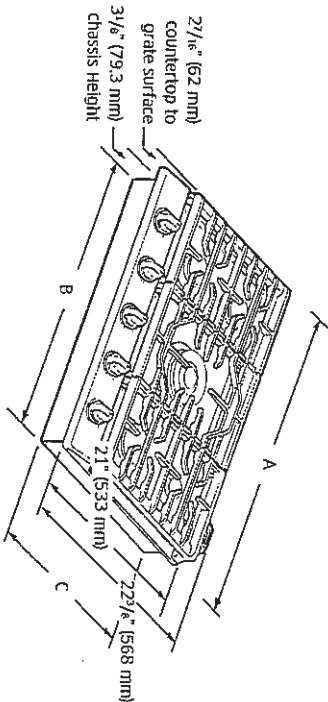

Model	A	B	C
NA30N6555T*	30"	28 1/8"	19 3/8"
NA30N7755T*	(762 mm)	(745 mm)	(492.1 mm)
NA36N6555T*	36"	33 11/16"	18 7/8"
NA36N7755T*	(914.4 mm)	(855 mm)	(479 mm)

Cutout dimensions of countertop

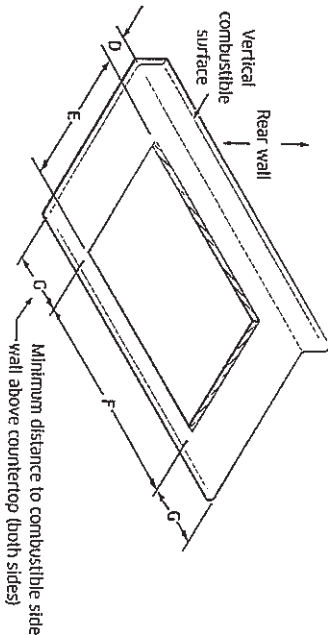

Model	(D) Min.	(E) Min.	(F) Min.	(G) Min.
NA30N6555T*	2 7/8"	1 9 7/8"	28 1/2"	1 2"
NA30N7755T*	(73 mm)	(498.5 mm)	(723.9 mm)	(304.8 mm)
NA36N6555T*	3 3/8"	1 9 1/8"	33 7/8"	1 2"
NA36N7755T*	(85.7 mm)	(485.8 mm)	(860.4 mm)	(304.8 mm)

Installation dimensions with downdraft hood

NOTE

- Make sure the clearance dimensions when you install the cooktop with downdraft hood.
 - The cooktop can be installed after detaching Smart Connect module.
- Please refer to the instruction how to detach Smart Connect module on page 15.

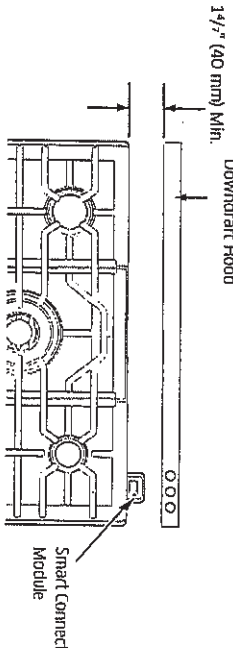
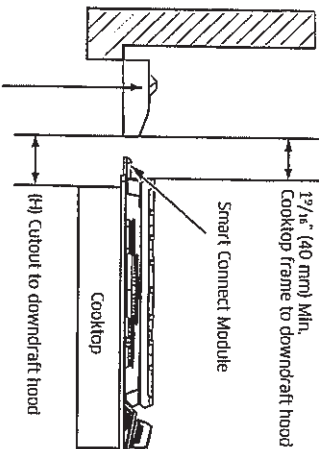

Model	(H) Min.
NA30N6555T*	27 1/8" (62 mm)
NA30N7755T*	
NA36N6555T*	3" (76 mm)
NA36N7755T*	

Port Perry
Lot 24



From: microsoft.com account team <estharan@hotmail.com>
Sent: June 15, 2023 11:04 PM
To: Delpark Homes Design Studio
Subject: Re: Lot 24 Port Perry Delpark Homes

Follow Up Flag: Follow up
Flag Status: Flagged

Home > Electric Wall Ovens

Samsung 30-inch 5.1 cu.ft |
Electric Range with Dual Co
Stainless Steel

Model # NV51K7770DS | Store SK

★★★★ (106)

Port Perry
Lot 24

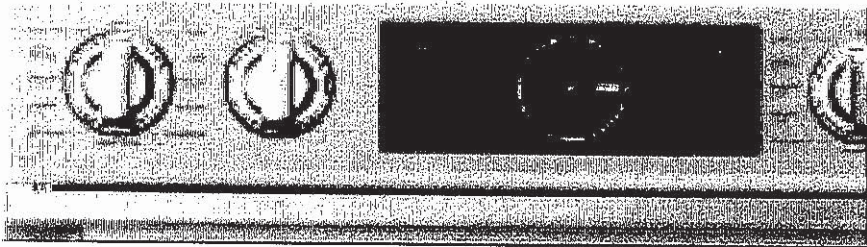

Preparation

Product dimensions - double oven (NV51*S**D*)

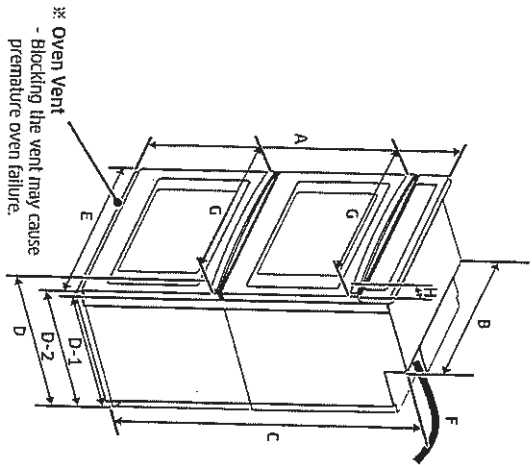

DIMENSION	
A	51 1/2" (130.7 cm)
B	28 1/2" (72.4 cm)
C	49 7/8" (126.7 cm)
D	26 5/8" (67.6 cm)
D-1	23 1/8" (58.7 cm)
D-2	24 3/8" (62.0 cm)
E	29 3/4" (75.6 cm)
F	67" (170 cm)
G	28 9/16" (72.5 cm)
H	2 1/4" (5.7 cm)

Cabinet dimensions - double ovens

Double Ovens Installed in Cabinet

- 01 Junction Box
- 02 Allow a minimum of 22" for clearance to adjacent corners, drawers, walls, etc. when door is open

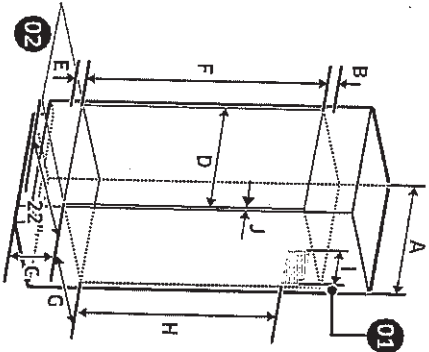

DIMENSION	
A	30" (76.2 cm)
B	Min. 1 3/16" (3.0 cm)
C	12" (30.5 cm)
D	Min. 28 1/2" / Max. 28 5/8" (Min. 72.4 cm / Max. 72.7 cm)
E	Min. 1" / Max. 1 1/4" (Min. 2.5 cm / Max. 3.2 cm)
F	50 3/4" (127.6 cm)
G	Min. 23 1/2" (Min. 59.7 cm)
H	Min 47" (Min. 119.4 cm)
I	Max. 9 1/2" (Max. 24.1 cm) – Junction Box
J	Min. 11 1/16" (1.75 cm) - Wooden cabinet thickness

Preparation

Lot 24
Port Perry

Single Oven Wall Mount

- 01 Junction Box
- 02 Allow a minimum of 22" for clearance to adjacent corners, drawers, walls, etc. when door is open

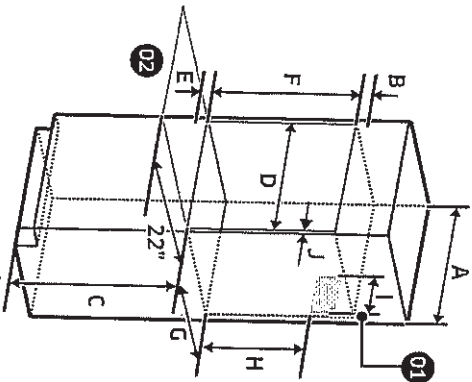

DIMENSION	
A	30" (76.2 cm)
B	Min. 1 3⁄8" (3.5 cm)
C	Min. 31" (Min 78.7 cm)
D	Min. 28 1⁄2" / Max. 28 5⁄8" (Min. 72.4 cm / Max. 72.7 cm)
E	Min. 1 1⁄4" Max. 1 1⁄4" (Min. 2.5 cm / Max. 3.2 cm)
F	Min. 27 1⁄4" / Max. 27 3⁄8" (Min. 69.2 / Max. 69.5 cm)
G	Min. 23 1⁄2" (Min. 59.7 cm)
H	Min. 22" (Min. 55.9 cm)
I	Max. 9 1⁄2" (Max. 24.1 cm) - Junction Box
J	Min. 1 1⁄16" (1.75 cm) - Wooden cabinet thickness

Product dimensions - double ovens (NV51K7770D, NV51K6650D)

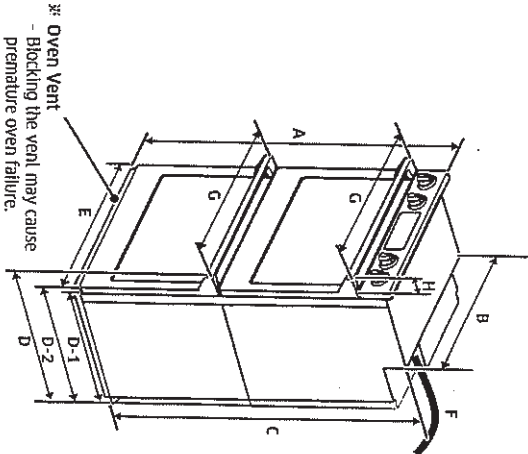

DIMENSION	
A	51 1⁄2" (130.7 cm)
B	28 1⁄2" (72.4 cm)
C	49 7⁄8" (126.7 cm)
D	26 15⁄16" (68.5 cm)
D-1	23 1⁄8" (58.7 cm)
D-2	24 3⁄8" (62.0 cm)
E	29 3⁄4" (75.6 cm)
F	67" (170 cm)
G	30" (76.0 cm)
H	29 1⁄8" (6.5 cm)

	Overall height
	Recessed width
	Recessed height
	Overall depth (with Handle)
	Recessed depth
	Overall depth
	Door width
	Conduit length
	Overall width (Handle width)
	Handle depth

Preparation

lot 24
Port Perry

RF32CG5900SR

SAMSUNG

Large Capacity 3-Door French Door 30 cu. ft. Full Depth Refrigerator with Family Hub™ and 4 types of ice



Signature Features

Family Hub™

Samsung's Family Hub™ refrigerator helps you connect to what's most important: your family and home. Family Hub™ lets you see inside your refrigerator, manage your family's calendars, stream music, see who's at the front door and much more, all right from your fridge.

Large 30 cu. ft. Capacity

Store more groceries with more room to stay organized. Large 30 cu. ft. capacity fits big and bulky items and provides easy access to everything you need.

Four Ice Types

Enjoy your favorite beverage with your choice of ice. Choose cubed ice or Ice Bites™ from the Dual Ice Maker in the freezer drawer, or opt for curved or crushed ice from the external dispenser.

Available Color



Fingerprint Resistant
Stainless Steel



Family Hub™



Large 30 cu. ft. Capacity

Design

- Family Hub™
- Premium External Filtered Water and Ice Dispenser
- Large Capacity of 30 cu. ft.
- High-Efficiency LED Lighting
- Gallon Door Bin
- Fingerprint Resistant Finish

Technology

- Wi-Fi Enabled
- Power Cool & Power Freeze
- Door Alarm
- Water Filter Indicator

Performance

- Four Ice Types: Crushed, Curved, Cubed and Ice Bites™
- SmartThings Energy*
- Metal Cooling

*Available on Android and iOS devices. A Wi-Fi connection and a Samsung account are required.



ADA Compliant

Rating



ENERGY STAR® rated:
781 kWh/yr

RF32CG5900SR

SAMSUNG

Large Capacity 3-Door French Door 30 cu. ft. Full Depth Refrigerator with Family Hub™ and 4 types of ice

Installation Specifications

1. Measure the height, width and depth of the opening, making sure to include baseboards, molding tile, countertop overhang, etc. Check to be sure there is enough room to open the door (consider walls, islands or other obstacles when measuring).
2. Refer to illustration below to determine dimensions.
3. Allow 2.5" of clearance on hinge side of refrigerator when installing next to a wall where handle may make contact.
4. Allow 1" minimum clearance at rear for proper air circulation and water/electrical connections. Allow a 3/8" minimum clearance at sides and top for ease of installation.
5. Ensure each door and entryway in the home is wide enough for the refrigerator to be moved through easily.

For optimal usage and ability to open refrigerator doors completely, do not install next to a wall.

Please note: The following dimensions and cutout information is for planning purposes only. For complete installation details, consult manual packed with product or download manual online at [samsung.com](https://www.samsung.com).

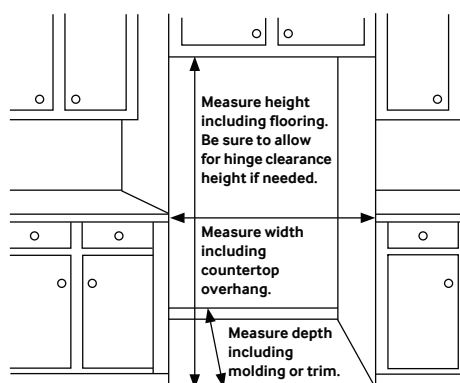

Dimensions

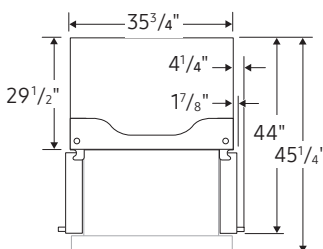
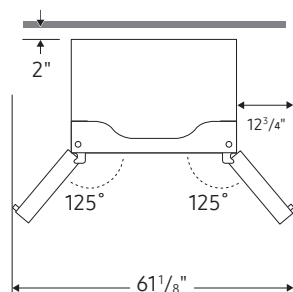
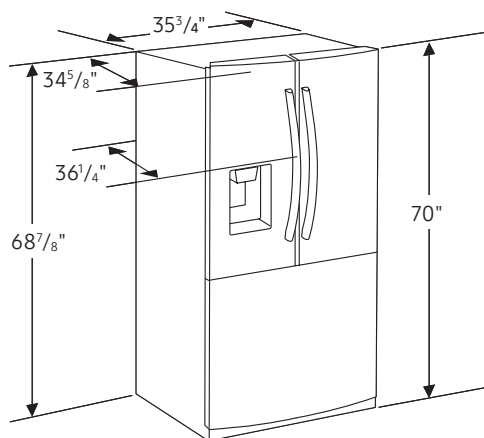

Total Capacity: 30 cu. ft.

Refrigerator: 20.8 cu. ft.

- External Filtered Water and Ice Dispenser
- 4 Tempered Glass Spill-Proof Shelves
- Full-Width Drawer
- 2 Clear Drawers
- 7 Door Bins
 - Right: 1 Gallon Bin, 3 Regular Bins
 - Left: 3 Regular Bins
- High-Efficiency LED Lighting

Freezer: 9.2 cu. ft.

- Dual Ice Maker in Freezer (Cubed Ice or Ice Bites™)
 - 2 Removable Ice Buckets and 1 Scoop
- 2 Large Opaque Bins with 1 Divider
- High-Efficiency LED Lighting

Accessories

Water Filter: HAF-QIN

Warranty

One (1) Year Parts and Labor on Refrigerator

Five (5) Years Parts and Labor on

Sealed Refrigeration System Only*

Ten (10) Years Parts and Five (5) Years

Labor on Digital Inverter Compressor

*Compressor, evaporator, condenser, drier and connecting tubing.

Product Dimensions & Weight

Dimensions (WxHxD with hinges, handles and doors):

$35\frac{3}{4}" \times 70" \times 36\frac{1}{4}"$

Dimensions (WxHxD without hinges and door):

$35\frac{3}{4}" \times 68\frac{7}{8}" \times 29\frac{1}{2}"$

Dimensions (WxHxD with hinge and door, no handle):

$35\frac{3}{4}" \times 70" \times 34\frac{5}{8}"$

Weight: 323 lbs

Shipping Dimensions & Weight (WxHxD)

Dimensions: $37\frac{3}{4}" \times 75\frac{7}{16}" \times 36"$

Weight: 333 lbs

Color

Fingerprint Resistant
Stainless Steel

Model

RF32CG5900SR

UPC Code

887276775562