

EDGE PROFILE VERIFICATION FORM

STANDARD EDGE PROFILES

2 cm

STRAIGHT POLISH

UPGRADED EDGE PROFILES

4 cm

~~1/2" BEVEL~~

~~HALF BULLNOSE~~

~~FULL BULLNOSE~~

~~Ogee~~

~~DOUBLE OGEE~~

~~straight~~

Millwood
Lot 27 Ph1

9



contrac

CALVIN

19 $\frac{1}{4}$ " OVAL UNDERMOUNT SINK

☐ 4220CFY Undermount Sink

Product Specs:

- Vitreous china
- Front overflow hole
- Template and mounting hardware supplied

Overall Dimensions (W x D x H):

(OD): 490mm(19 $\frac{1}{4}$ ") x 410mm(16 $\frac{1}{8}$ ") x 195mm(7 $\frac{7}{8}$ ")

(ID): 430mm(17") x 350mm(13 $\frac{3}{4}$ ") x 145mm(5 $\frac{3}{4}$ ")

Compliance Certifications:

Meets or exceeds the following:

- IAPMO cUPC
- ASME A112.19.2 / CSA B45.1-2008

Shipping:

Cube 1.53
GW 19 lbs

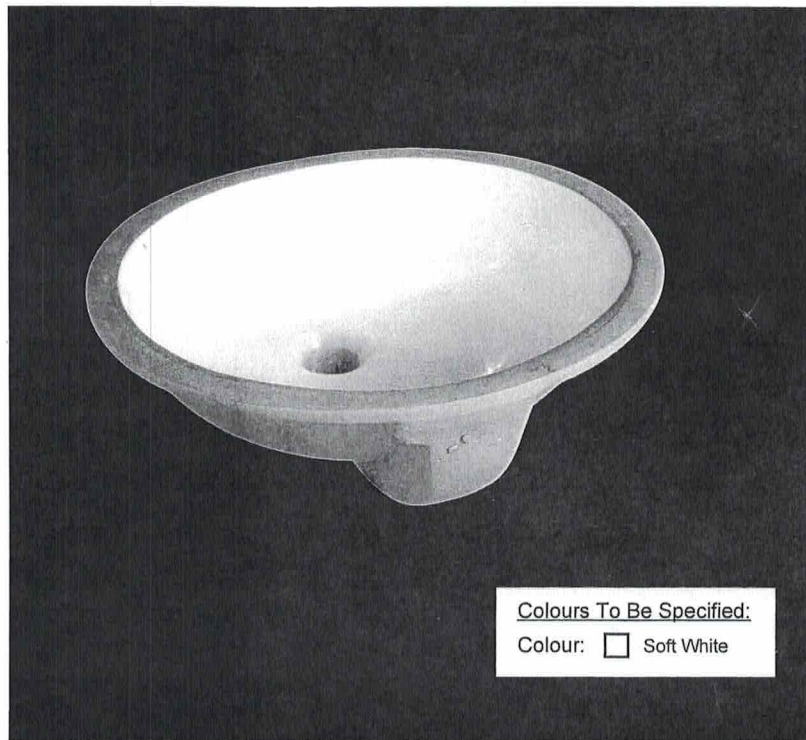

Colours To Be Specified:

Colour: ☐ Soft White

Notes:

Dimensions of fixtures are nominal and may vary within the range of tolerances established by ANSI standard A112.19.2. These measurements are subject to change or cancellation. No responsibility is assumed for use of superseded or voided pages.

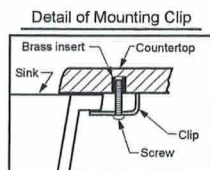

Note:

▲ Dimensions shown for location of supplies and "P" trap are suggested.

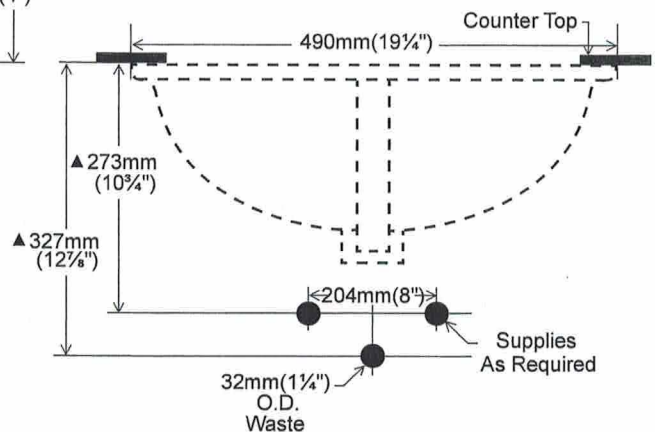
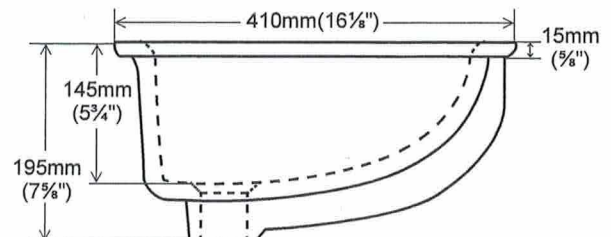
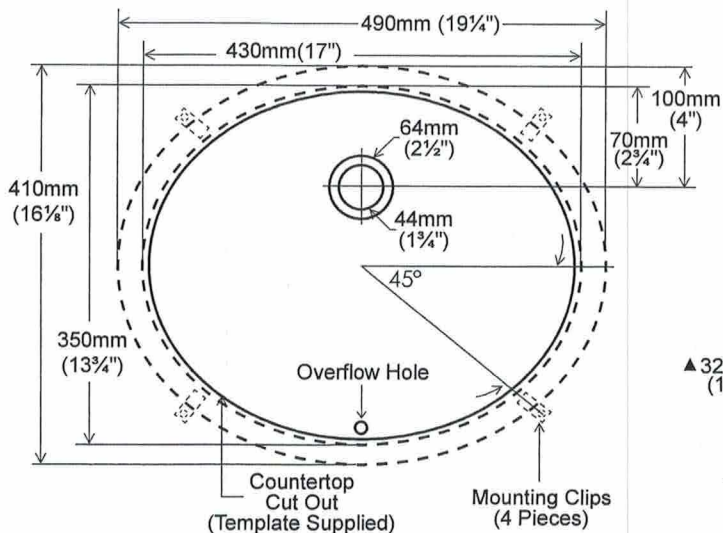

KITCHEN SINK

Stainless Steel | 122.0627.764

FAMILY : Sinks | SERIES : Cube | FINISH : Stainless Steel | STYLE : Contemporary | INSTALLATION TYPE : Undermount |
MODEL : CUX110-27-CA

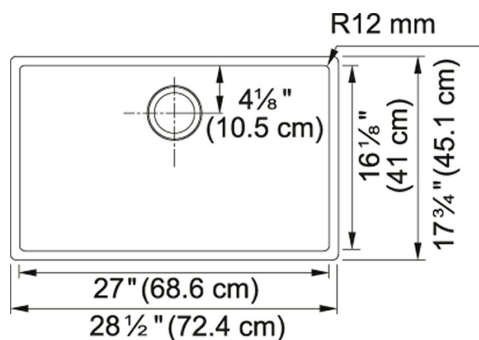

The Cube sink series boasts a minimalist, linear look with tight radius corners and is a perfect complement to a modern or transitional kitchen aesthetic.

FEATURES

- **Deep Capacity Bowl:** A large deep bowl makes it easy to clean cookware items and minimizes splashing, offering the form and function you expect from your sink.
- **Easy to Clean:** the resilient Pearl finish will stand up to heavy everyday use.
- **Efficient Drain:** The pitched bottom creates efficient draining, and the rear drain placement provides additional storage below the sink.
- **Undermount Installation:** Fitted underneath the counter, it gives an edgeless finish that is easy to clean.

TECHNICAL DATA

Cabinet Size	30"
Waste Outlet Diameter	3 1/2"
Length overall	28 1/2"
Width overall	17 3/4"
Length of large bowl	27"
Width of large bowl	16 1/8"
Depth of large bowl	9"
Number of Bowls	1
Gauge	18
Waste Kit Included	Yes
Type of Material	18 Gauge Stainless Steel
Faucet Hole	None
Cut-Out Template	Yes
Model Name	CUX110-27-CA