

Builder: Delpark Homes
 Project: Queensbury Gates
 Location: City of Oshawa, ON.
 Type: 45-4
 OVERALL HANG HEIGHT @ 96" AFF
 1' = finished end.

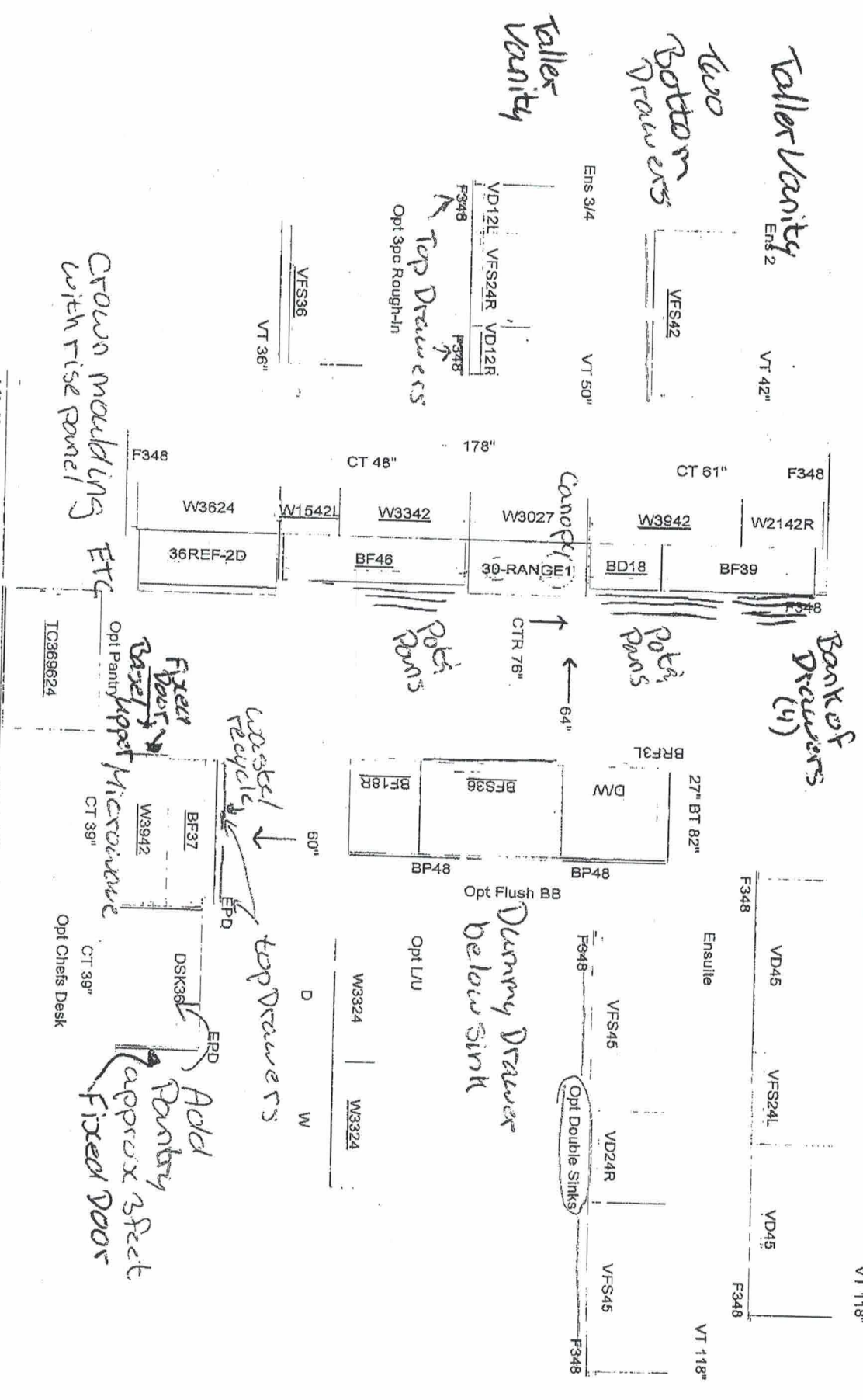

All dimensions, size designations given are subject to verification on job site and adjustment to fit job conditions.

This is an original design and must not be released or copied unless applicable fee has been paid or job order placed.

Designed: 6/30/20
 Printed: 6/30/20

45-4 kit
 All
 Drawing # 1
 No Scale.

Queensbury
 Lot 13
 Blackburn

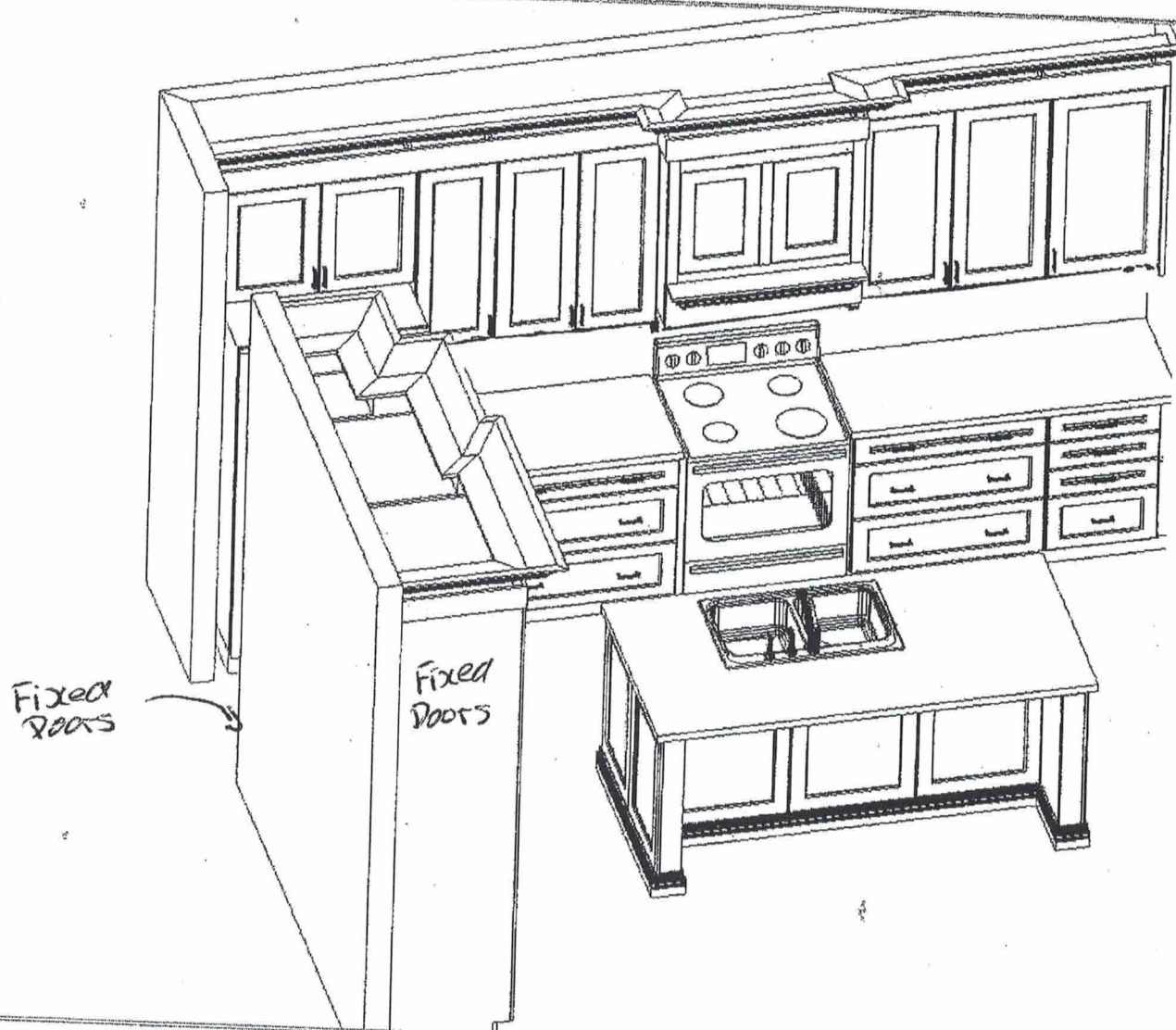

36" Canopy - Valance is STRAIGHT
 Fridge Upper w/gable
 Fixed Doors on side of Pantry
 and on the other side Upper & Lower
 2 pot & pans
 Crown Moulding ETC

Queensbury
 Lot 13



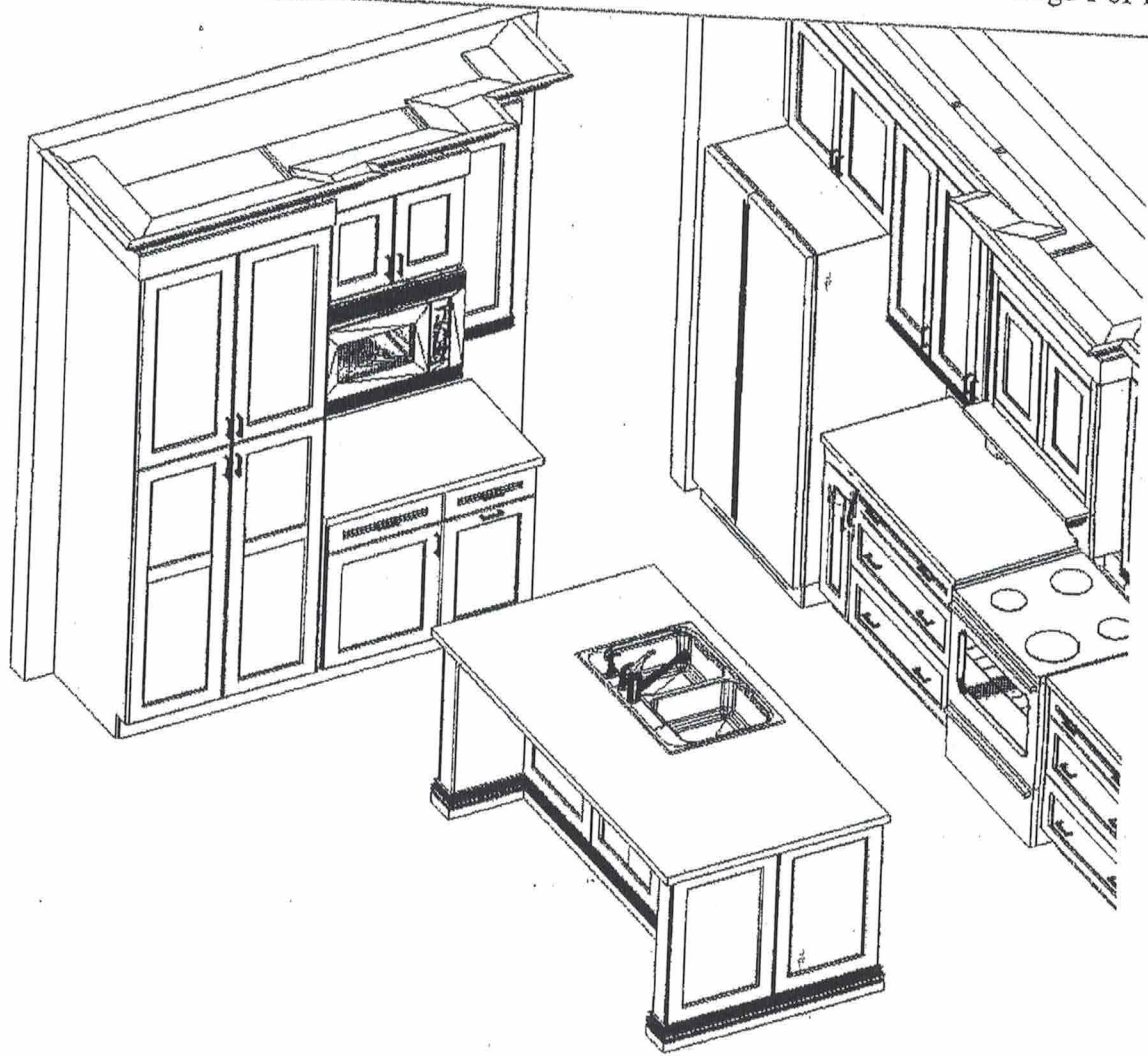

Pantry
Microwave w/ trim Kit
2 Top Drawers
Waste/recycle center
Soft Close

Queensbury
Lot 13



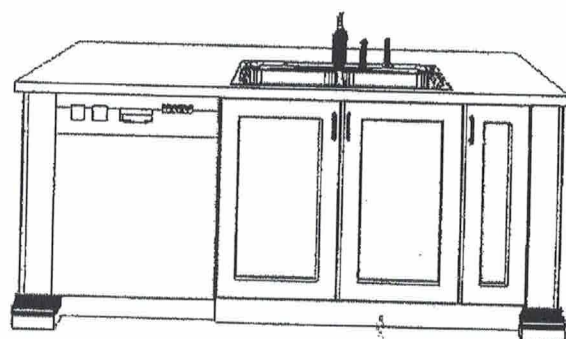

Queensbury
Lot 13



PRODUCT MODEL NUMBERS

KRFC302E

Electrical: A 115 volt, 60 Hz, AC only 15- or 20-amp fused, grounded electrical supply is required. It is recommended that a separate circuit serving only your refrigerator and approved accessories be provided. Use an outlet that cannot be turned off by a switch. Do not use an extension cord.

Water: A cold water supply with water pressure of between 35 and 120 psi (241 and 827 kPa) is required to operate the water dispenser and ice maker. If you have questions about your water pressure, call a licensed, qualified plumber.

Reverse Osmosis Water Supply:
IMPORTANT: The pressure of the water supply coming out of a reverse osmosis system going to the water inlet valve of the refrigerator needs to be between 35 and 120 psi (241 and 827 kPa).

Bottom Mount Refrigerator
PRODUCT DIMENSIONS

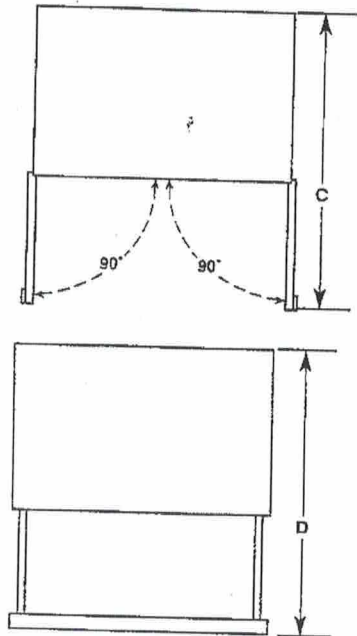
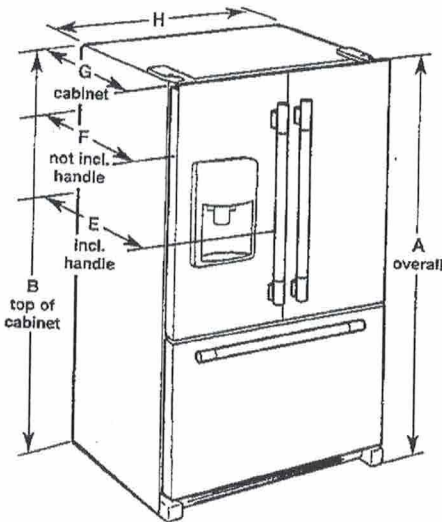

Model Size	Height - Overall "A"	Height - Top of Cabinet "B"	Depth - Doors Open 90° "C"	Depth - Drawer Open "D"	Depth - With Handles "E"	Depth - Without Handles "F"	Depth - Cabinet Only "G"	Width - Cabinet "H"
21.9	72" (182.9 cm)	71 1/4" (181.3 cm)	44 1/4" (112.1 cm)	45 1/4" (114.9 cm)	30 1/4" (76.8 cm)	27 3/4" (70.5 cm)	24 5/8" (62.5 cm)	35 3/4" (90.8 cm)

LOCATION REQUIREMENTS

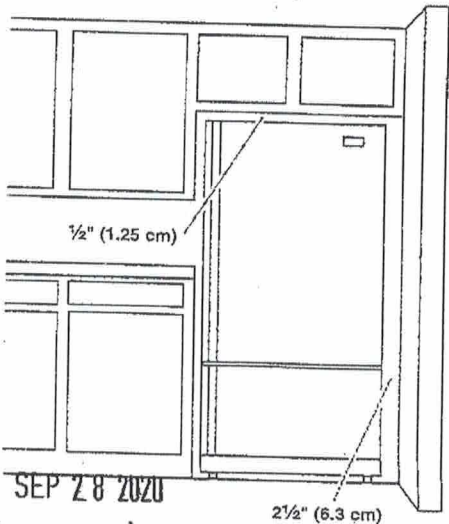

IMPORTANT: This refrigerator is designed for indoor, household use only.

To ensure proper ventilation for your refrigerator, allow for 1/2" (1.25 cm) of space on each side and at the top. Allow for 1" (2.54 cm) of space behind the refrigerator. If your refrigerator has an ice maker, allow extra space at the back for the water line connections. When installing your refrigerator next to a fixed wall, leave 2 1/2" (6.3 cm) minimum on the hinge side (some models require more) to allow for the door to swing open.

NOTE: This refrigerator is intended for use in a location where the temperature ranges from a minimum of 55°F (13°C) to a maximum of 110°F (43°C). The preferred room temperature range for optimum performance, which reduces electricity usage and provides superior cooling, is between 60°F (15°C) and 90°F (32°C). It is recommended that you do not install the refrigerator near a heat source, such as an oven or radiator.

SEP 28 2020
Queensbury
Lot 13



INSTALLATION INSTRUCTIONS

Tools and Parts

Tools Needed

Gather the required tools and parts before starting installation. Read and follow the instructions provided with any tools listed here.

- Measuring tape
- Drill
- Pencil
- 7/64" drill bit
- Phillips screwdriver

Parts Supplied (not shown to scale)

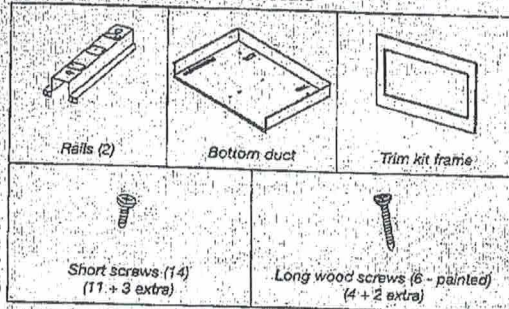

Location Requirements

The microwave oven may be installed over a built-in oven. If installing over a built-in oven, make sure there is a minimum of 3" (7.6 cm) between the top of the lower oven cutout and the microwave oven cutout floor.

The microwave oven may also be installed in a cabinet by itself (without a built-in oven below). For best usability, we recommend a minimum distance of 36" (91.4 cm) from the floor to the cutout floor.

Make sure the surrounding cabinetry has clearance to open and close freely. Allow a clearance of at least 1 1/4" (4.0 cm) below the cutout floor (3" (7.6 cm) for installation above a built-in oven), and a clearance of at least 2" (5.1 cm) above the cutout opening.

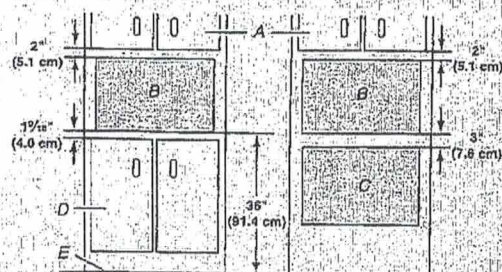

- A. Upper cabinet
- B. Microwave oven cutout
- C. Lower oven cutout
- D. Lower cabinets
- E. Floor

Required Cutout Dimensions

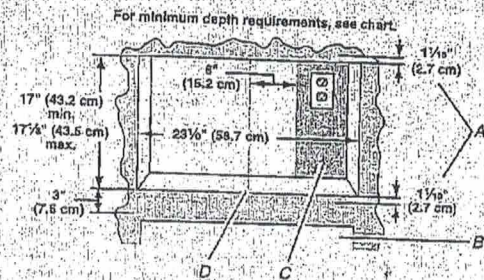

- A. Trim kit frame overhang
- B. Cutout for lower oven
- C. Recommended region for receptacle location (no less than 6" (15.2 cm) to the right of cutout centerline)
- D. Cutout centerline

Receptacle Location	Minimum Depth
Within recommended region	18" (45.7 cm) with flush receptacle 21" (53.2 cm) with non-flush receptacle
Outside recommended region	19 1/2" (49.5 cm) with flush receptacle 22 1/2" (57.2 cm) with non-flush receptacle

NOTES:

- Depth requirements depend upon receptacle and its location within or outside of recommended region. See illustration and chart above.
- Height dimension is critical: 17" (43.2 cm) minimum; 17 1/4" (43.5 cm) maximum.
- Width measurement has $\pm 1/16"$ (2 mm) tolerance.
- 3" (7.6 cm) minimum dimension is from lower oven cutout ceiling to microwave oven cutout floor.
- Trim kit frame extends 1 1/4" (2.7 cm) above and below the cutout opening.

SEP 28 2020

Queensbury
Lot 13



KitchenAid

1.5 cu. ft. Countertop Microwave

KMCC5015G

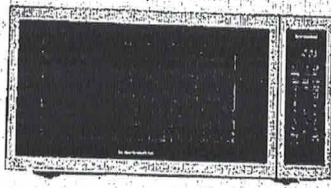

Stainless Steel
KMCC5015GSS

Capacity

Total 1.5 cu. ft.

General Features & Properties

6 Quick-Touch Cycles Including Five Sensor Cycles

13 1/2" Recessed Turntable

1.5 Cu. Ft. Capacity

Accepts 30- or 27-Inch Trim Kit

Electronic Controls with LED Display

Color-Coordinated Stainless Steel Cabinet

Electrical Details

Amps 15

Volts 120

Technical Details

Microwave Type Countertop

Lighting Type Incandescent

Dimensions

Product Dimensions (H x W x D) 12-1/2" x 21-3/4" x 20-1/2"

Reference Material

[Dimension Guide](#)

[Install Guide](#)

[Use & Care Guide](#)

[Warranty](#)

Key Features & Benefits

1400-Watt Convection Element

Circulates heat around the back of the oven to allow convection baking at temperatures up to 425°F.

Roast Function

Helps maintain the balanced heat distribution required for exceptional roasting by alternating traditional microwave cooking with convection cooking to evenly surround food with heat.

Grill Function

Delivers grilling results similar to a conventional oven. A rack that comes with the microwave heats during the grilling process to sear meats and lock in flavor.

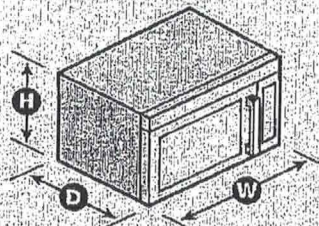

NOTE: Dimensions are for planning purposes only. For complete details, see Installation Instructions packed with product. Specifications subject to change without notice.
©/TM © 2020. All rights reserved. Printed in the U.S.A. D200104XXE KMCC5015GSpecSheetV01

SEP 28 2020

Queensbury
Lot 13



Trim Kit Frame Dimensions

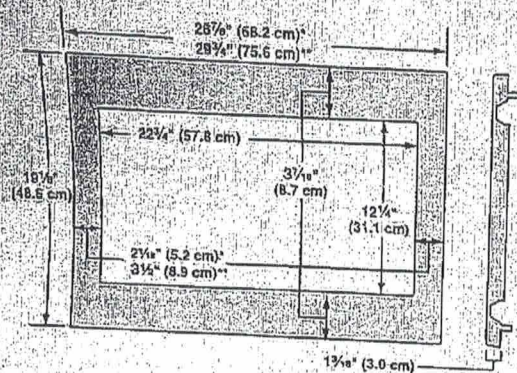

27" (68.6 cm) trim kit

30" (76.2 cm) trim kit

Electrical Requirements

⚠ WARNING



Electrical Shock Hazard

Plug into a grounded 3 prong outlet.

Do not remove ground prong.

Do not use an adapter.

Do not use an extension cord.

Failure to follow these instructions can result in death, fire, or electrical shock.

Observe all governing codes and ordinances.

Required:

- A 120 volt, 60 Hz, AC only, 15- or 20-amp electrical supply with a fuse or circuit breaker.

Recommended:

- A time-delay fuse or time-delay circuit breaker.
- A separate circuit serving only this microwave oven.

GROUNDING INSTRUCTIONS

For all cord connected appliances:

The microwave oven must be grounded. In the event of an electrical short circuit, grounding reduces the risk of electric shock by providing an escape wire for the electric current. The microwave oven is equipped with a cord having a grounding wire with a grounding plug. The plug must be plugged into an outlet that is properly installed and grounded.

WARNING: Improper use of the grounding plug can result in a risk of electric shock. Consult a qualified electrician or serviceman if the grounding instructions are not completely understood, or if doubt exists as to whether the microwave oven is properly grounded.

Do not use an extension cord. If the power supply cord is too short, have a qualified electrician or serviceman install an outlet near the microwave oven.

SAVE THESE INSTRUCTIONS

Prepare Microwave Oven

- Unplug microwave oven before proceeding with installation.
- Remove any loose items inside microwave oven.
- Gently turn microwave oven onto its top, with the door facing forward (toward installer).
- Align the two rails on the microwave oven bottom, as shown, making sure the flanges are forward and pointing up.

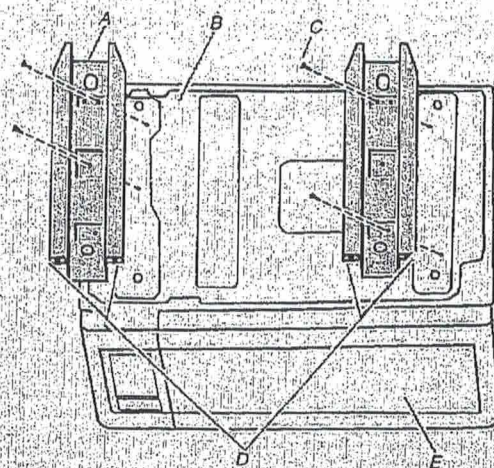

A. Rails (2)
B. Microwave oven bottom
C. Short screws (4)
D. Flanges
E. Door

- Secure the rails to the microwave oven bottom using four short screws.

SEP 28 2020

Queensbury
Lot 13

OL

WR