

Updated as of
2016 Feb 04

Page 1

Appliance and installation dimensions

Cut-outs for venting the Combi Steam Oven

required

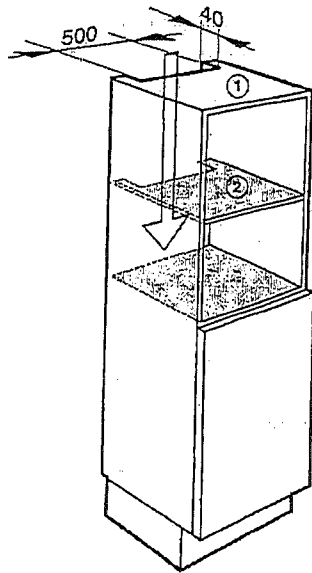

Maximum Height
is 64 inches →

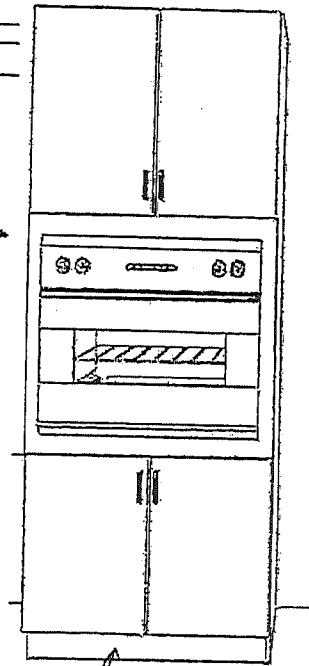

VENT HOLES

To ensure that the Combi Steam Oven has adequate ventilation, the following cut-outs measuring $19 \frac{11}{16}'' \times 1 \frac{9}{16}''$ (500 x 40 mm) must be made:

- ① in the top of the cabinet
- ② in the center shelf above the installation niche

The cabinet housing must not have a back panel fitted behind the installation niche.

ROBERT LEE

CEDAR RIDGE 5 ELEV B

LOT 16 A PHASE 1

Appliance and installation dimensions

Wall cabinet installation

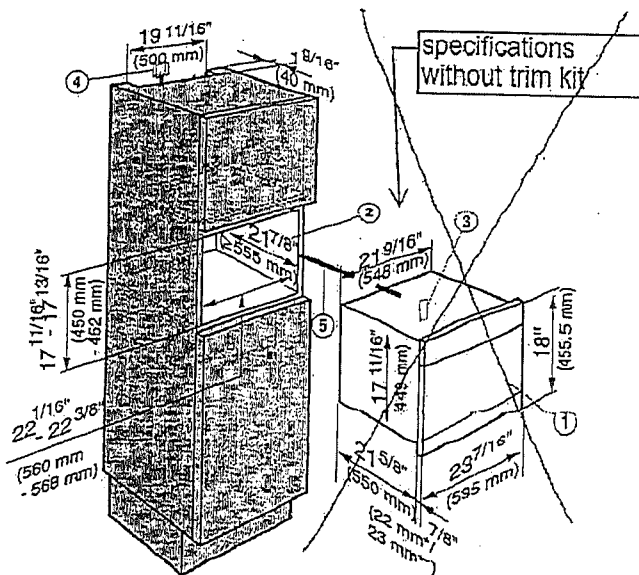

- ① Combi Steam Oven
- ② Installation niche
- ③ Power supply to the appliance
- ④ Recommended location for electrical connection
- ⑤ Power cord

* Appliances with glass front
 ** Appliances with metal front

PLEASE REFER TO
 PAGE 3 FOR
 DIMENSIONS FOR FLUSH
 AND 30" TRIM KIT.

ROBERT LEE

CEDAR RIDGE 5 ELEV B

LOT 16 A PHASE 1

30" Trim Kit
EBA 6708, EBA 6808



INSTALLATION SPECIFICATIONS

Installation in Tall Niche

ROBERT LEE

CEDAR RIDGE S ELEV B

LOT 16A

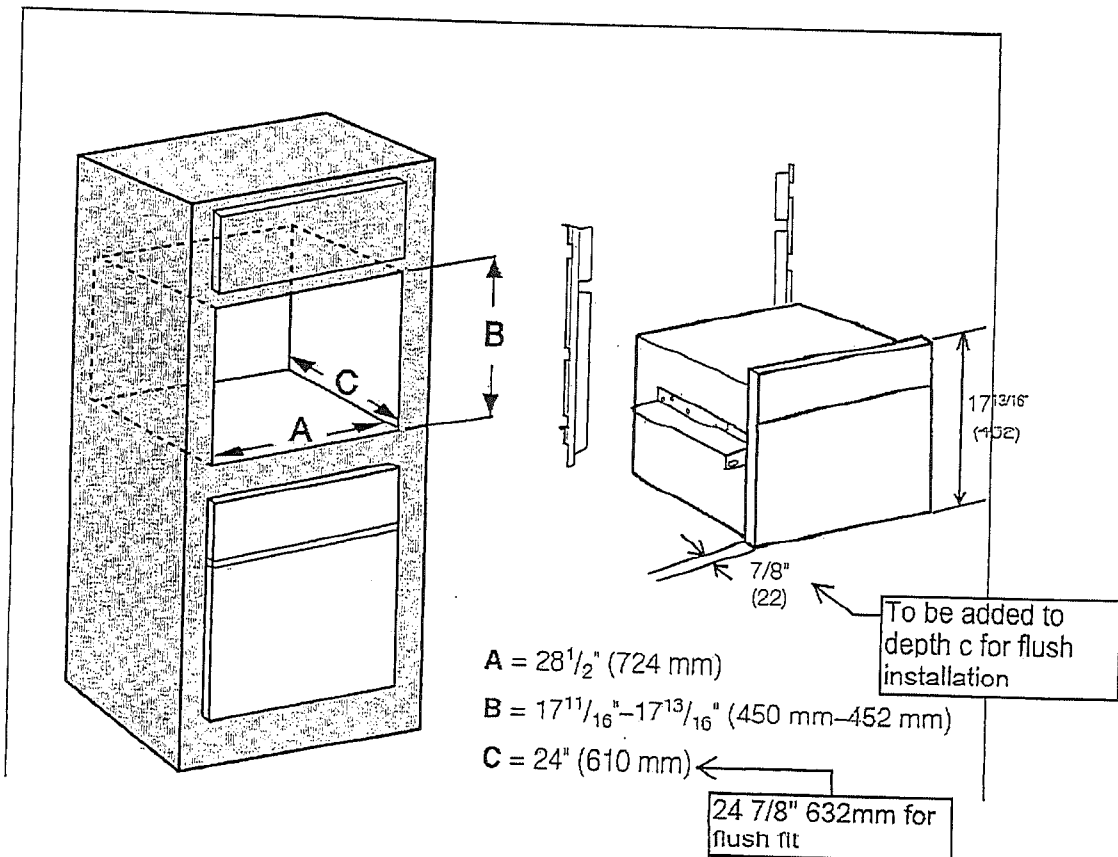

** Follow the appliance's installation directions for plumbing, electrical, and ventilation.

Electrical connection

⚠ CAUTION: Before installation or servicing, disconnect the power supply by either removing the fuse, shutting off the main power or manually "tripping" the circuit breaker.

Installation work and repairs should only be performed by a qualified technician in accordance with all applicable codes and standards. Repairs and service by unqualified persons could be dangerous.

Before connecting the appliance to the power supply, make sure that the voltage and frequency listed on the rating label correspond with the household electrical supply. This data must correspond to prevent appliance damage.

Only operate the appliance after it has been installed.

If there is any question concerning the electrical connection of this appliance to your power supply, please consult a licensed electrician or contact Miele's Technical Service Department.

Installer:
Please leave these instructions with the consumer.

Power supply

Installation, repairs and other work by unqualified persons could be dangerous.

- Be sure your electrical supply matches the data plate.

Power supply

This appliance is equipped with a 6.5 ft (1.9 m) long power cord with a three-prong grounding plug ready for connection to a 240 V, 20 A, 60 Hz power supply.

Further installation details are on the wiring diagram.

(NEMA 6-20P, 20 amp, 240 VAC, L1, L2, G)

ROBERT LEE
CEDAR RIDGE 5 ELEV B
LOT 16A PHASE 1

Item 23 Folding Door Corner Upgrade I

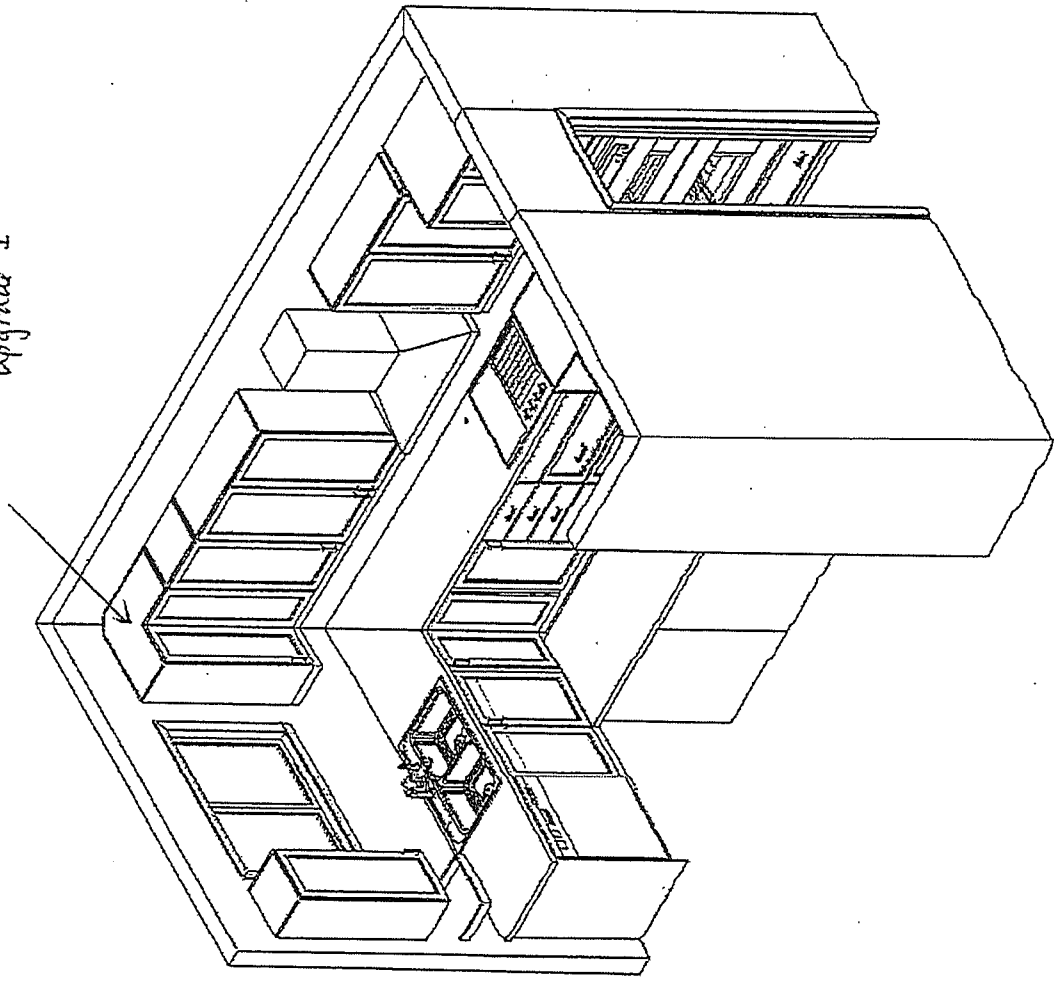

90 3 2016

ot 1624
Sutton

Item 22 Upper Cabinetry
Deep Taller Cabinet
Upgrade 1.

Page 6

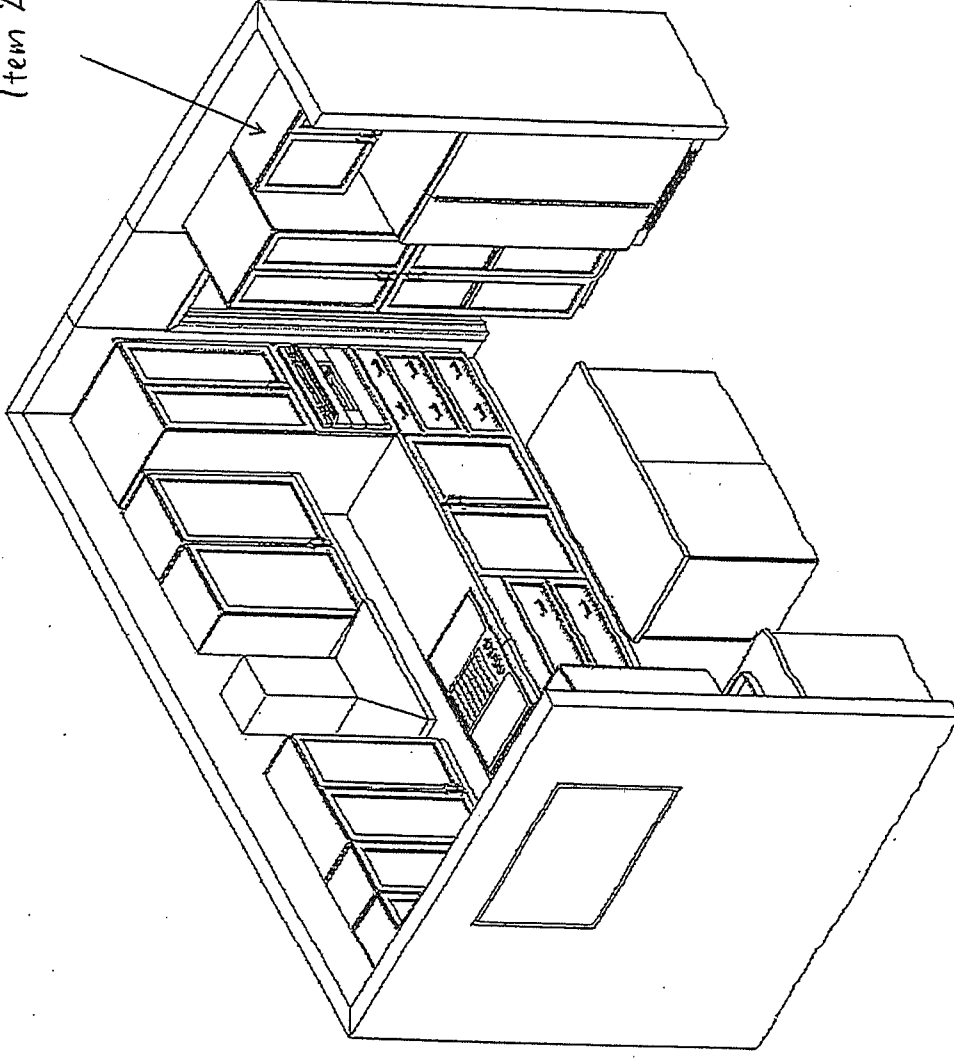

Lot 16A
Button

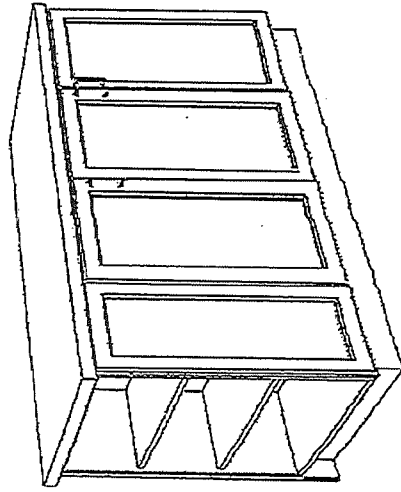

EO 3 2016

10/10/16
10/10/16



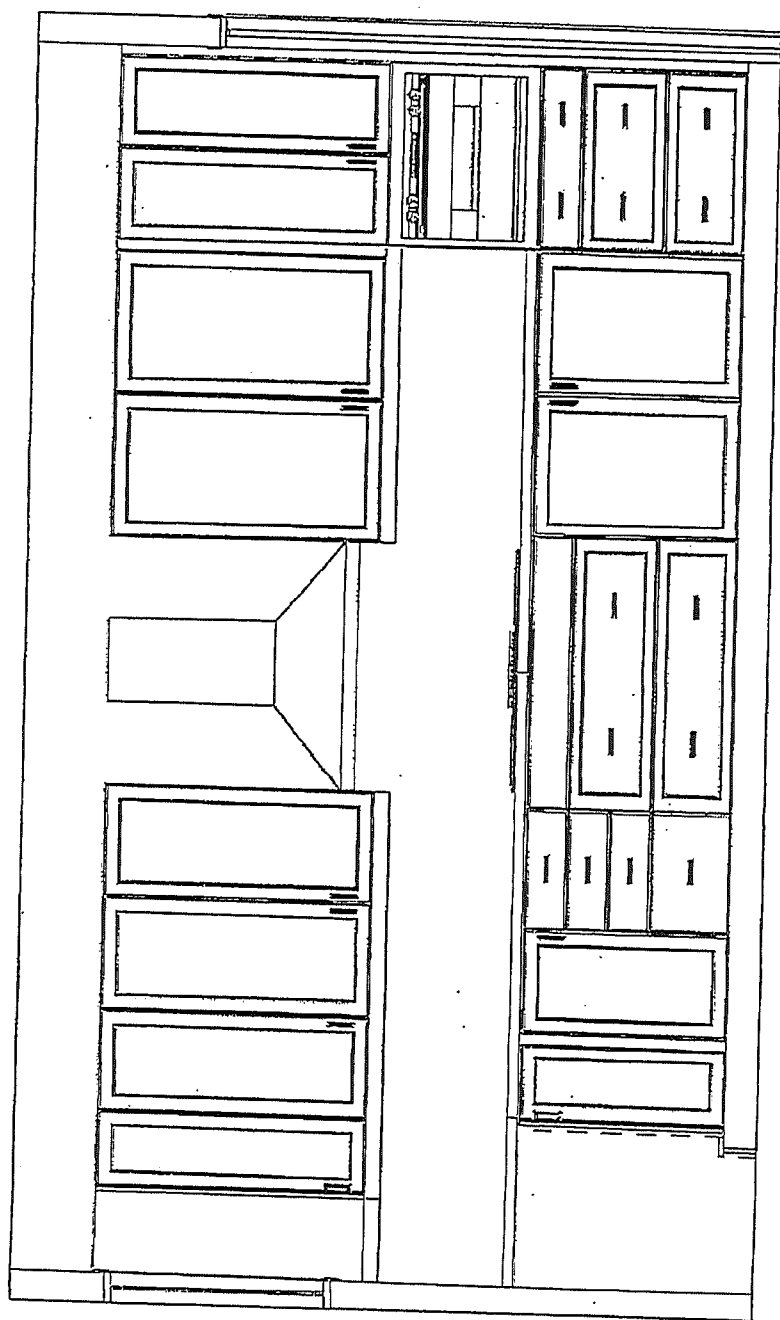

Lot 16A
Button

36" Electric Cooktop

Benchmark™ Series – Black with Stainless Steel Frame NETP666SUC

Lot 16A
Sutton

Page 3



Installation Details

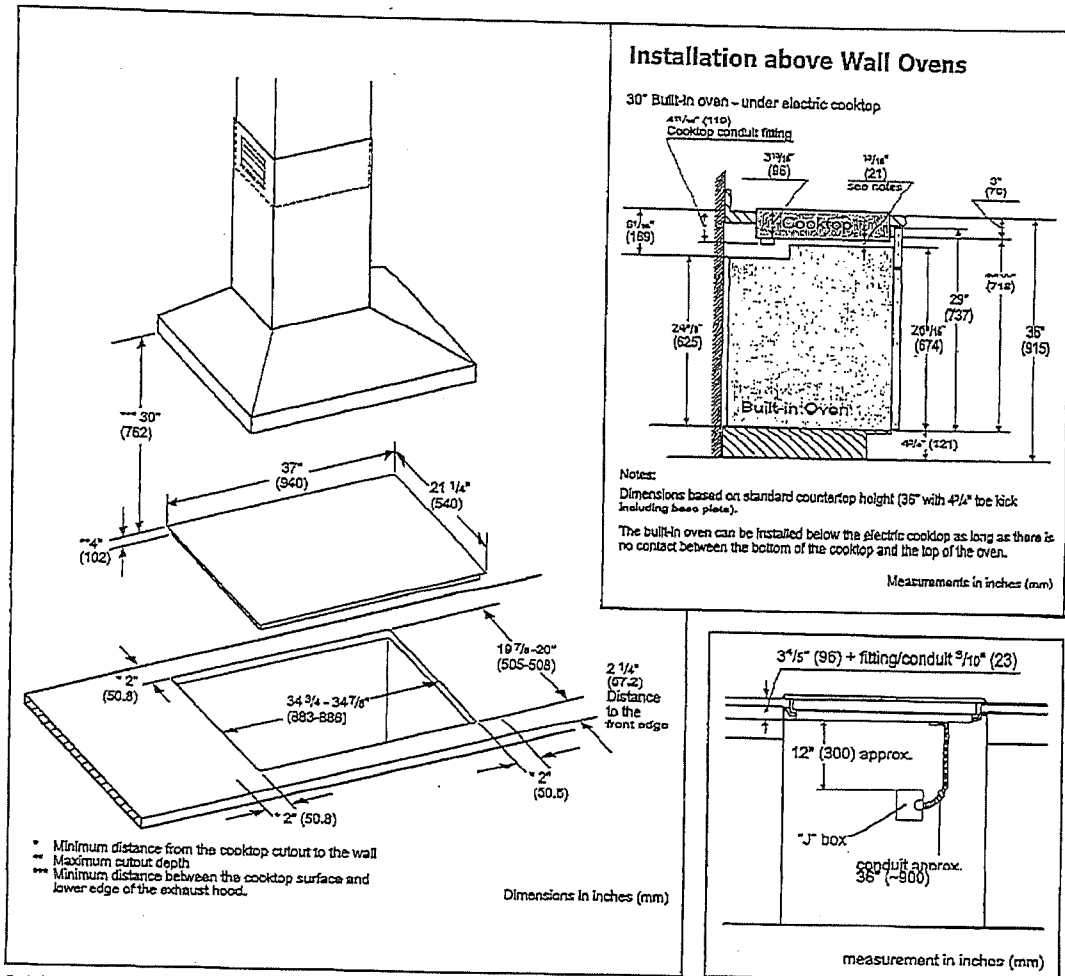

FEB 13 2016



Ref: item 26 COOK TOP IN GRANITE

Prepare Installation Space

Create the cut-out in the countertop according to the installation diagram. The angle of the cut surface to the countertop must be 90°.

The lateral cut-out edges must be flat in order to ensure that the retaining springs are well-positioned on the appliance. With multi-layered countertops, secure strips laterally in the cut-out if necessary.

After creating cut-out, remove shavings. Seal cut surfaces in a heat- and water-resistant manner.

Observe minimum distance between device underside and furniture parts of $\frac{3}{8}$ " (10 mm).

Cutout dimensions for 36" cooktops

Models: NEM5666UC, NET8666SUC, NET8666UC, NETP666SUC

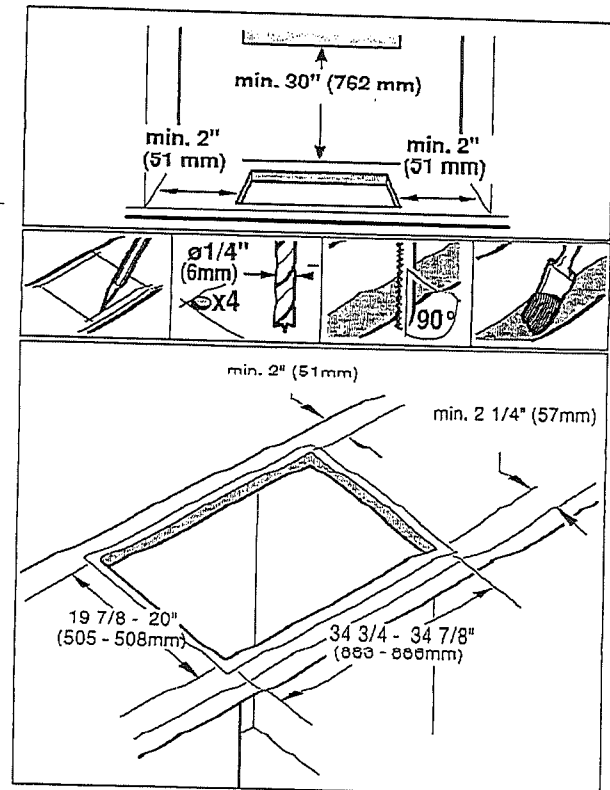

Electrical Installation

Electrical Requirements

You can find the identification plate with the electrical specifications on the underside of the appliance. The junction box must be located within 3 feet of the cooktop connection. It should be easily accessible for service purposes.

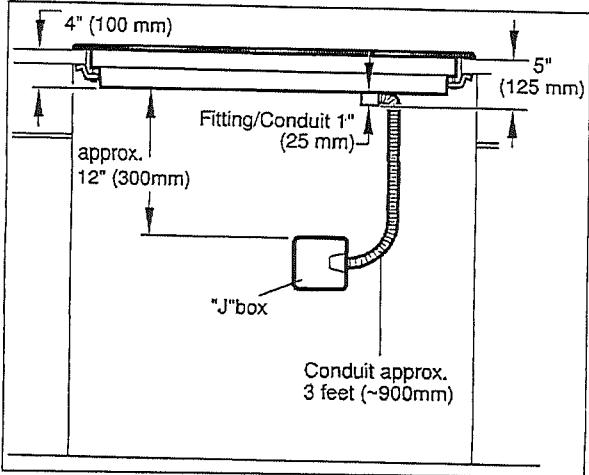

Power supply

Model	240 V AC, 60 Hz system: circuit breaker	208 V AC, 60 Hz system: circuit breaker
NETP666SUC	40 Amp	40 Amp

Connect Electrical Supply

⚠ WARNING

Before installing, turn off at the service panel. Lock service panel to prevent power from being turned on accidentally.

The electrical power supply system should be a 1-phase, 3-wire system with ground connection. Install suitable junction box (not furnished). An appropriately-sized, UL-listed conduit connector must be used to correctly attach the conduit to the junction box.

The branch-circuit breakers ampacity, the wire sizes and the connections must be conform to the requirements of the National Electrical Code or Canadian Electrical Code and all local codes and ordinances.

Attach flexible conduit to the junction box.

⚠ WARNING

To reduce the risk of electric shock and fire, do not use a flexible power supply cord.

Connect the cooktop lead wires to the junction box supply wires in proper phase:

- black (L1) to black
- red (L2) to red
- blank copper wire to ground

Check the Installation

⚠ CAUTION

Before you plug in an electrical cord or turn on power supply, make sure all controls are in the OFF position.

Remove everything from the cooktop surface including stickers. Clean cooktop surface with cooktop cleaning creme.

Switch on the circuit breaker.
Verify that elements function properly.