



CONSTRUCTION SUMMARY

Block 162 Unit 1 - 2 - The Napa 15 (THWU-15) Elev B

Extras at Time of Sale

Note:

CABINETRY - KITCHEN CABINETS

Inv:930 1 - KITCHEN CABINETRY - UPGRADE 1

Line8990 Note:

5Jun22 / 20Jun22

CABINETRY - VANITY CABINETS

Inv:930 1 - VANITY CABINETRY - MASTER ENSUITE - UPGRADE 3

Line9002 Note:

5Jun22 / 20Jun22

Inv:930 1 - VANITY CABINETRY - MAIN BATH - UPGRADE 1

Line9003 Note:

5Jun22 / 20Jun22

CEILINGS

Inv:791 1 - CEILINGS - SMOOTH CEILINGS THROUGHOUT MAIN FLOOR ONLY

Line7842 Note:

24Jan22 / 17Feb22

DO NOT INSTALL

Inv:930 1 - DO NOT INSTALL- ALL CERAMIC ACCESSORIES (TOILET PAPER HOLDER/TOWEL BAR)

Line9004 Note:

5Jun22 / 20Jun22

GLASS & MIRROR

Inv:791 1 - FULL GLASS SHOWER WITH HALF WALL AT TUB AREA - MASTER ENSUITE

Line7845 Note:

24Jan22 / 17Feb22

INTERIOR TRIM

Inv:791 1 - INTERIOR TRIM - 8 FOOT DOORS AND ARCHES - GROUND FLOOR

Line8351 Note:

24Jan22 / 17Feb22

LAMINATE FLOORING

Inv:930 1 - LAMINATE FLOORING - UPPER HALL WAY - STANDARD

Line8998 Note:

5Jun22 / 20Jun22

Inv:930 1 - LAMINATE FLOORING - STANDARD - MAIN HALL

Line8992 Note:

5Jun22 / 20Jun22

PAINT AND STAIN



CONSTRUCTION SUMMARY

Block 162 Unit 1 - 2 - The Napa 15 (THWU-15) Elev B

Inv.791	1 - PAINT AND STAIN - STANDARD STAIRCASE - STAIN STAIRCASE TO MATCH
Line7846	Note:
24Jan22 / 17Feb22	

PLUMBING

Inv.791	1 - PLUMBING - WATERLINE FOR ICE MAKER HOOK UP - INCLUDES VALVE
Line7847	Note:
24Jan22 / 17Feb22	

TILE - WALL TILE

Inv.930	1 - TILE - WALL TILE - UPGRADE 1 - TWO ROWS
Line9000	Note:
5Jun22 / 20Jun22	

Inv.930	1 - TILE - WALL TILE - UPGRADE 2 - SHOWER WALLS AND CEILING - MASTER
Line9001	Note:
5Jun22 / 20Jun22	

TILES

Inv.930	1 - TILES - UPGRADE 1 - MASTER ENSUITE
Line8999	Note:
5Jun22 / 20Jun22	

Inv.930	1 - TILES - UPGRADE 1 - ENTRY
Line8994	Note:
5Jun22 / 20Jun22	

Inv.930	1 - TILES - UPGRADE 1 - KITCHEN AND BREAKFAST
Line8995	Note:
5Jun22 / 20Jun22	

Inv.930	1 - TILES - UPGRADE 1 - POWDER ROOM
Line8996	Note:
5Jun22 / 20Jun22	

WINDOWS - BASEMENT

Inv.791	1 - BASEMENT WINDOW - 47 X 36 - EGRESS WINDOW - WITH WINDOW WELL
Line7848	Note: AS PER SKETCH
24Jan22 / 17Feb22	

Inv.791	3 - BASEMENT WINDOW - 30 X 24 - ADDITIONAL WINDOWS AS PER SKETCH
Line7850	Note:
24Jan22 / 17Feb22	



INTERIOR COLOUR SCHEME

Purchaser: NINA MOSTOVOY,

Property: Block 162 Unit 1

Telephone Res. / Bus: (416) 576-9125 /

Project: Bradford East Developments Inc.

Decor Advisor: Inna Semikolenniha

Model and Elevation: The Napa 15 (THWU-15) Elev B

Lock Date: 22-Mar-23

15-Jun-22

Plan #: 51M-1137

Layout Changes: ☐ Yes ☒ No

Sketch Attached: ☒ Yes ☐ No

Exterior Colour Scheme:

1. Kitchen and Vanities

	Style and Colour	Hardware
Kitchen / Breakfast	3/4 FLAT ONTARIO WHITE (UP1)	HC-07
Laundry Room	ROMEO CRYSTAL WHITE (STD)	HC-204
Powder Room	N/A	
Master Ensuite Bathroom	SHAKER K13 CANNES (UP3)	HC-09
BATH	3/4 FLAT ONTARIO WHITE (UP1)	HC-09

Comment

2. Counter Top

	Counter	Edge
Kitchen / Breakfast	BLACK ALICANTE 4926K-07 (STD)	
Laundry Room	CALCUTTA MARBLE 4925K-07 (STD)	
Powder Room	N/A	
Master Ensuite Bathroom	BRONZITE 4971K-52 (STD)	
BATH	BRONZITE 4971K-52 (STD)	

Comment

3. Ceramic Flooring

	Selection	Threshold
Entrance Vestibule	LUGANO PORCELAIN LIGHT GREY 12X24 MATT (UP1)	
Main Hall	LAMINATE	
Kitchen / Breakfast	LUGANO PORCELAIN LIGHT GREY 12X24 MATT (UP1)	
Laundry Room	BURLINGSTONE CERAMIC TAUPE 13x13 (STD) **correction	
Powder Room	LUGANO PORCELAIN LIGHT GREY 12X24 MATT (UP1)	
Master Ensuite Bathroom	69-072 12X24 AMELIA EARTH HD PORCELAIN (UP1)	
BATH	KEATON CARBON CERAMIC 13x13 (STD) **correction	

Comment

Initial: _____

Page 1 of 6



INTERIOR COLOUR SCHEME

Purchaser: NINA MOSTOVOY,

Property: Block 162 Unit 1

Telephone Res. / Bus: (416) 576-9125 /

Project: Bradford East Developments Inc.

Decor Advisor: Inna Semikolenniha

Model and Elevation: The Napa 15 (THWU-15) Elev B

Lock Date: 22-Mar-23

15-Jun-22

Plan #: 51M-1137

4. Ceramic Wall Tile

	Selection	Describe
Master Ensuite Bathroom		
Tub Deck Wall	69-072 12X24 AMELIA EARTH HD PORCELAIN (UP1)	
Tub Deck	69-072 12X24 AMELIA EARTH HD PORCELAIN (UP1)	
Tub Deck Skirt	69-072 12X24 AMELIA EARTH HD PORCELAIN (UP1)	
Shower Stall	PRIMA TRUE WHITE GLAZED PORCELAIN 12X24 POL (UP2)**CORRECTION	DS NM
Shower Stall Floor Tile	51-027 2X2 SOHO WARM GREY MATTE (STD)	DS NM
BATH	KAFKA CERAMIC GREY 8X10 GLOSSY (STD) **CORRECTION	
Kitchen Backsplash	N/A	

 Delete all Ceramic Accessories (Paper Holder; Towel Bar; Soap Dishes) ☒ Yes ☐ No

Comment

** Refer to Construction Summary - STANDARD GROUT THROUGHOUT UNLESS SPECIFIED **DELETE ALL CERAMIC ACCESSORIES

5. Carpeting

Main Hall	LAMINATE	
Living Room	N/A	
Dining Room	N/A	
Family Room	LAMINATE	
Den / Library / Study	N/A	
Basement Landing(If Applies)	N/A	
Lower Landing (If Applies)	LAMINATE	
Upper Landing	LAMINATE	
Upper Hall	LAMINATE	
Master Bedroom	829 TAUPE WHISPER (STD)	
Bedroom #2	829 TAUPE WHISPER (STD)	
Bedroom #3	829 TAUPE WHISPER (STD)	
Bedroom #4	829 TAUPE WHISPER (STD)	
Bedroom #5	N/A	
Underpad	Type	Area
	STD	MASTER, BDRM 2,3,4
Carpet on Stairs	Capped	Runner - *Upgrade
Comment	N/A	N/A

** Refer to Construction Summary

Initial: _____

Page 2 of 6



INTERIOR COLOUR SCHEME

Purchaser: NINA MOSTOVOY,

Property: Block 162 Unit 1

Telephone Res. / Bus: (416) 576-9125 /

Project: Bradford East Developments Inc.

Decor Advisor: Inna Semikolenniha

Model and Elevation: The Napa 15 (THWU-15) Elev B

Lock Date: 22-Mar-23

15-Jun-22

Plan #: 51M-1137

6. Hardwood

Kitchen	CERAMIC
Main Hall	EVOKE BR-PAULA PROMENADE OAK 71/2 X 5/16 APPROX. 54" (STD)
Living Room	N/A
Dining Room	N/A
Family Room	EVOKE BR-PAULA PROMENADE OAK 71/2 X 5/16 APPROX. 54" (STD)
Den / Library / Study	N/A
Basement Landing(If Applies)	N/A
Lower Landing (If Applies)	EVOKE BR-PAULA PROMENADE OAK 71/2 X 5/16 APPROX. 54" (STD)
Upper Landing	EVOKE BR-PAULA PROMENADE OAK 71/2 X 5/16 APPROX. 54" (STD)
Upper Hall	EVOKE BR-PAULA PROMENADE OAK 71/2 X 5/16 APPROX. 54" (STD)
Master Bedroom	CARPET
Bedroom #2	CARPET
Bedroom #3	CARPET
Bedroom #4	CARPET
Bedroom #5	N/A

Comment

7. Plumbing Fixtures

Powder Room	STD
Master Ensuite Bathroom	STD
BATH	STD

Waterline for Fridge ☒ Yes ☐ No

Comment

** Refer to Construction Summary

Initial: _____

Page 3 of 6



INTERIOR COLOUR SCHEME

Purchaser: NINA MOSTOVOY,

Property: Block 162 Unit 1

Telephone Res. / Bus: (416) 576-9125 /

Project: Bradford East Developments Inc.

Decor Advisor: Inna Semikolenniha

Model and Elevation: The Napa 15 (THWU-15) Elev B

Lock Date: 22-Mar-23

15-Jun-22

Plan #: 51M-1137

8. Trim Carpentry

Interior Doors

Interior Trim

Door Handles

Front Door Glass Inserts

Comment

** Refer to Construction Summary

9. Electrical

Plugs and Switches ☒ White

Hood Fan

Custom Fan Insert

Appliances

Built in Cooktop	Built in Oven	Gas Stove	Microwave
<input type="radio"/> Yes <input checked="" type="radio"/> No	<input type="radio"/> Yes <input checked="" type="radio"/> No	<input type="radio"/> Yes <input checked="" type="radio"/> No	<input type="radio"/> Yes <input type="radio"/> OTR <input checked="" type="radio"/> No

Comment

** Refer to Construction Summary

10. Railings and Pickets

Railing Type

Railing Colour

SpindleType

Spindle Colour

Stringer / Riser

Treads

Oak Stairs ☒ Yes ☐ No

Comment

** Refer to Construction Summary STAIN STAIRCASE TO MACTH EVOKE BR-PAULA PROMENADE OAK 71/2 X 5/16 APPROX. 54" (STD)

Initial: _____

Page 4 of 6



INTERIOR COLOUR SCHEME

Purchaser: NINA MOSTOVOY,

Property: Block 162 Unit 1

Telephone Res. / Bus: (416) 576-9125 /

Project: Bradford East Developments Inc.

Decor Advisor: Inna Semikolenniha

Model and Elevation: The Napa 15 (THWU-15) Elev B

Lock Date: 22-Mar-23

15-Jun-22

Plan #: 51M-1137

11. Crown Mouldings

Entrance Vestibule	NONE		Kitchen/Breakfast	NONE	
Main Hall	NONE		Den/Library	NONE	
Living Room	NONE		Lower Landing	NONE	
Dining Room	NONE				
Family Room	NONE				

Comment

** Refer to Construction Summary

12. Wall Paint

Main Floor	COOL WHITE
Second Floor	COOL WHITE

Smooth Ceilings First Floor ☒ Yes ☐ No

Comment

** Refer to Construction Summary SMOOTH CEILING ON MAIN FLOOR ONLY

13. Fireplace

	Living Room			Family Room			Other Room - Specify		
	Purchased	As Per Plan	N/A	Purchased	As Per Plan	N/A	Purchased	As Per Plan	N/A
	<input type="radio"/>	<input type="radio"/>	<input checked="" type="radio"/>	<input type="radio"/>	<input type="radio"/>	<input checked="" type="radio"/>	<input type="radio"/>	<input type="radio"/>	<input checked="" type="radio"/>
Fireplace Type	N/A								
Mantle Type	N/A								
Colour / Stain	N/A								
Surround	N/A								
Hearth	N/A								

Comment

** Refer to Construction Summary

Initial: _____

Page 5 of 6



INTERIOR COLOUR SCHEME

Purchaser: NINA MOSTOVOY,

Property: Block 162 Unit 1

Telephone Res. / Bus: (416) 576-9125 /

Project: Bradford East Developments Inc.

Decor Advisor: Inna Semikolenniha

Model and Elevation: The Napa 15 (THWU-15) Elev B

Lock Date: 22-Mar-23

15-Jun-22

Plan #: 51M-1137

14. Heating and Air Conditioning

Air Conditioning

Gas Provisions Stove

Gas Provisions Dryer

Gas Provisions Barbecue

Comment

** Refer to Construction Summary

15. General Comments

** Refer to Construction Summary

Disclaimers and Notes

Purchaser
Initials

- 1) Colours of all materials are as close as possible to builder's selection, but not necessarily identical due to variances in manufacturing.
- 2) Any extras listed above are null and void unless accompanied by a separate invoice/amendment. Said invoice must be paid in full.
- 3) The Purchaser acknowledges that after Interior Colour Selection form is signed and dated, a \$250 admin fee will be applicable for changes, deletions or alterations other than re-selection due to unavailability.
- 4) The Purchaser acknowledges reading and accepting the "Bayview Wellington Homes Decor Centre Disclaimers" form. This document contains other miscellaneous disclaimers.

This Interior Colour Selection is final and approved by:

Signature: _____ Date: _____



INTERIOR COLOUR SCHEME

Purchaser: NINA MOSTOVOY,

Property: Block 162 Unit 1

Telephone Res. / Bus: (416) 576-9125 /

Project: Bradford East Developments Inc.

Decor Advisor: Inna Semikolenniha

Model and Elevation: The Napa 15 (THWU-15) Elev B

Lock Date: 22-Mar-23

15-Jun-22

Plan #: 51M-1137

DocuSign Envelope ID: 035BA42D-4345-456D-B153-B7FC1CE2FE4D



THE
PORCH NAPA 15

DS
NM

DS
NM

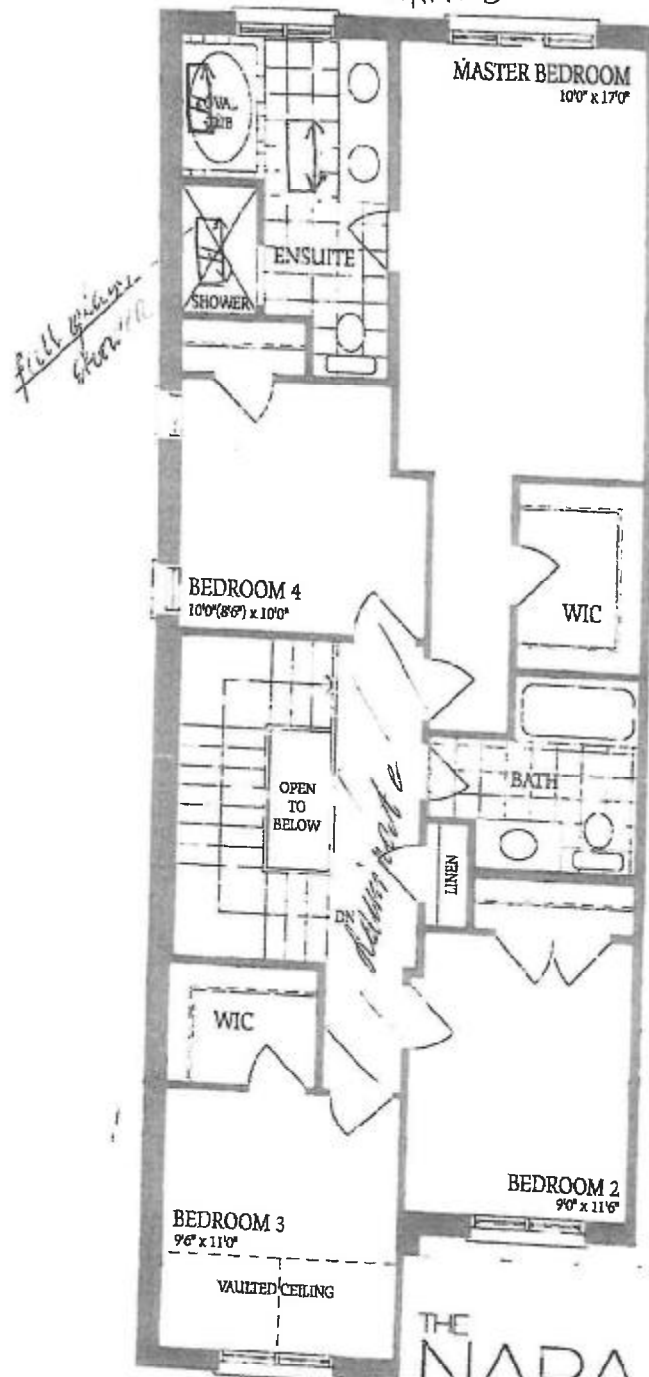

Bl 162 - 1

THE NAPA 15

DS
NM

DS
NM

DocuSign Envelope ID: 0352A42D-4345-458D-B156-B7FC1CE27E4D

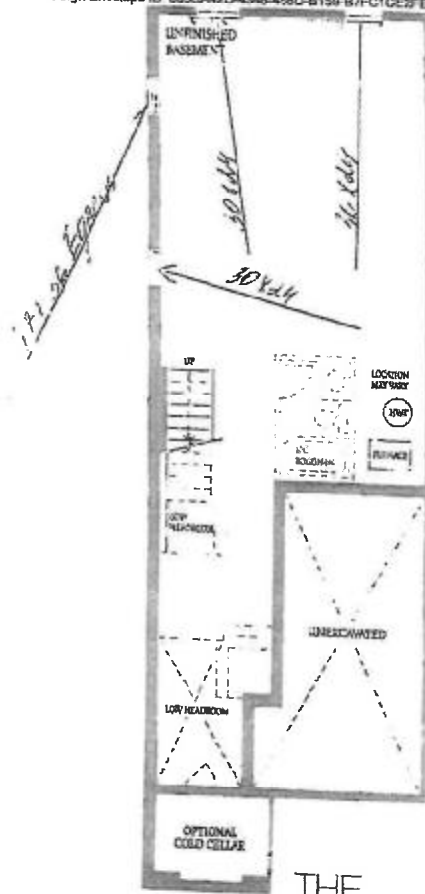

Bl 162-1

THE
NAPA 15

DS
NM

DS
NM