

GOEMANS APPLIANCES

Expect More. Get More.

APPLIANCE SPECIFICATIONS



PROJECT PARTNER:
Bill To: 6479660190

SHIP TO:
Ship To: 6479660190

PSINGH DUA, RAJINDER
129 JONKMAN BLVD LOT # 31NL
BRADFORD, ON L3Z 4K3

REMINDER:

To ensure a smooth project it is the responsibility of the homeowner / purchaser of appliances to share all the attached specifications with their cabinet provider, contractor, or any other tradesperson so they have the information required to complete their work accurately. Product specifications are for planning purposes only and are subject to change without notice. Refer to installation instructions shipped with the product before cutting cabinets, counters, panels, etc.

Goemans Appliances assumes no liability for product specifications.

Ship To: 6479660190

Bill To: 6479660190

PSINGH DUA, RAJINDER
 129 JONKMAN BLVD LOT # 31NL
 BRADFORD, ON L3Z 4K3

<i>Models</i>	<i>Pages</i>
RF23R6201SR/AA Samsung Refrigeration	3-4
NX60T8311SS/AA Samsung Range	5-6
DW80K5050US/AC Samsung Dishwasher	7-8
WF45R6100AP Samsung Washer	9-10
DVE45T6100P/AC Samsung Dryer	11-17
AVH-308CS Avant Garde Ventilation	18-19

GOEMANS
 APPLIANCES
Goemans Appliances

goemans.com

JASON NG

9052641771

Document **HB00023157-31NL-1**
 Version 1.1

Fri, Sep 17, 2021
 1:59 PM EDT

enterprise.steelcod.com/sp/goem/D7VUO7J0
Note about page numbers:

Because the original manufacturer's documents are not altered in any way, the page numbers displayed on the page may not correspond to the page number within this package.

All specifications are intended for initial planning purposes only.

Manufacturers reserve the right to change specifications at any time without notice. Always consult the installation instructions found on the manufacturer's website or included with the appliances before installation.

RF23R6201SR

SAMSUNG

23 cu. ft. Counter-Depth, 3-Door French Door Refrigerator
with CoolSelect Pantry™



Signature Features

Twin Cooling Plus®

- Independent fridge and freezer controls keep food fresher longer.

CoolSelect Pantry™

- Full-width drawer with three temperature control settings to chill or defrost food to ideal temperatures.

Ice Max

- Large capacity, stores up to 2.7 lbs of ice.

Counter Depth

- Offers a premium, built-in look.

Fingerprint Resistant Finish

- A special finish to reduce smudges and minimize cleaning.

Available Colors



CoolSelect Pantry™ with
Temperature Control



Ice Max

Convenience

- CoolSelect Pantry™ with Temperature Control and Pantry Divider
- Wi-Fi and Bixby Enabled
- Adjustable Shelves for Tall Oversized Items
- Auto Pull-Out Upper Freezer Drawer
- Water Filter Indicator

Design

- Counter Depth
- Fingerprint Resistant Finish
- Premium External Filtered Water and Ice Dispenser with Light
- High Efficiency LED Lighting
- Accessibility (ADA Compliant)
- EZ-Open Handle™ on Freezer Door
- Tempered Glass Spill-Proof Shelves
- Gallon Door Bins

Performance

- Twin Cooling Plus®
- Ice Max - Stores up to 2.7 lbs of Ice
- ENERGY STAR® Compliant
- Two Humidity-Controlled Crispers
- Power Freeze and Power Cool Options
- CoolTight Door
- Door Alarm

Rating



ENERGY STAR® rated:
699 kWh/yr

RF23R6201SR

SAMSUNG

23 cu. ft. Counter-Depth, 3-Door French Door Refrigerator with CoolSelect Pantry™

Installation Specifications

1. Measure the height, width and depth of the opening, making sure to include baseboards, molding tile, countertop overhang, etc. Check to be sure there is enough room to open the door (consider walls, islands or other obstacles when measuring).
2. Refer to illustration below to determine dimensions.
3. Allow 2.5" of clearance on hinge side of refrigerator when installing next to a wall where handle may make contact.
4. Allow 1" minimum clearance at rear for proper air circulation and water/electrical connections. Allow a 3/8" minimum clearance at sides and top for ease of installation.
5. Ensure each door and entryway in the home is wide enough for the refrigerator to be moved through easily.

For optimal usage and to be able to open refrigerator doors completely, do not install next to a wall.

Please note: The following dimension and cutout information is for planning purposes only. For complete installation details, consult manual packed with product, or download manual online at samsung.com.

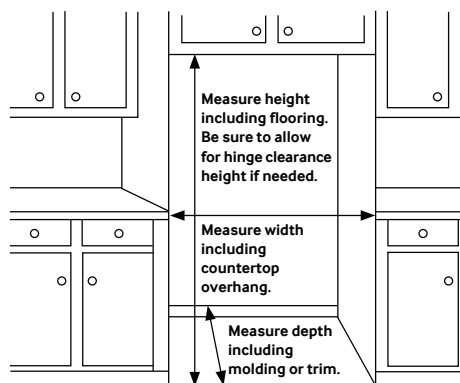

Dimensions

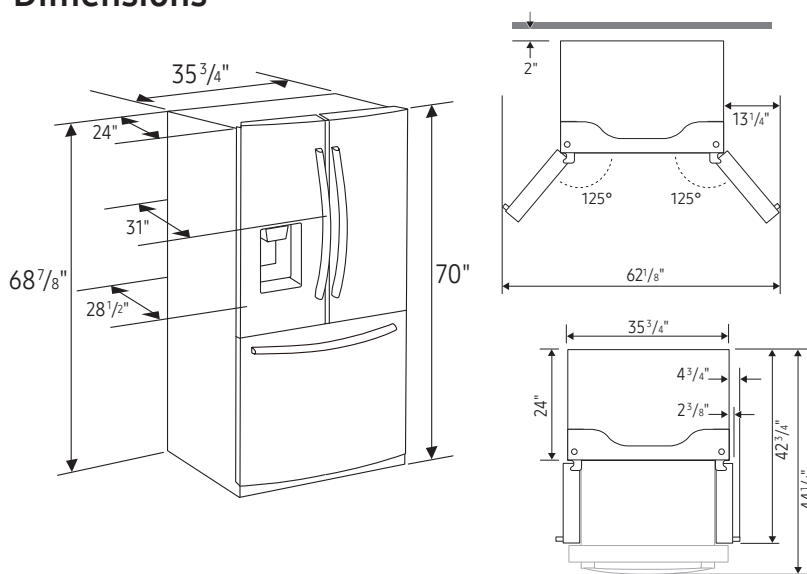

Total Capacity: 22.6 cu. ft.

Refrigerator: 15.7 cu. ft.

- Premium External Filtered Water and Ice Dispenser
 - Crushed or Cubed Ice
- Ice Max
- CoolSelect Pantry™ with Temperature Control – Deli (41°C), Fresh (38°F) and Chilled (32°F) Options
- Pantry Divider
- 2 Humidity-Controlled Crispers
- 5 Tempered Glass Spill-Proof Shelves:
 - 1 Slide-In
 - 1 Slide-Out
 - 1 Foldable Half
 - 2 Fixed
- 6 Clear Door Bins
 - Right Door: 3 Gallon Bins
 - Left Door: 3 Regular Bins
- Adjustable Shelves for Tall Oversized Items
- High Efficiency Top LED Lighting

Freezer: 6.9 cu. ft.

- EZ-Open Handle™
- 2 Drawer Dividers
- High Efficiency LED Lighting

Accessories

Water Filter: HAF-QIN

Warranty

One (1) Year Parts and Labor on Refrigerator

Five (5) Years Parts and Labor on

Sealed Refrigeration System Only*

Ten (10) Years Parts and Five (5) Years

Labor on Digital Inverter Compressor

*Compressor, evaporator, condenser, drier and connecting tubing.

Product Dimensions & Weight

Dimensions (WxHxD with hinges, handles and doors):

35 3/4" x 70" x 31"

Dimensions (WxHxD without hinges and door):

35 3/4" x 68 7/8" x 24"

Dimensions (WxHxD with hinge and door, no handle):

35 3/4" x 70" x 28 1/2"

Weight: 279 lbs

Shipping Dimensions & Weight (WxHxD)

Dimensions: 38 1/4" x 76" x 31 1/4"

Weight: 300 lbs

Color	Model #	UPC Code
Fingerprint Resistant Stainless Steel	RF23R6201SR	887276341286
Fingerprint Resistant Black Stainless Steel	RF23R6201SG	887276341279
Fingerprint Resistant Tuscan Stainless Steel	RF23R6201DT	887276341262
White	RF23R6201WW	887276341293

NX60T831SS

SAMSUNG

Samsung Front Control Slide-in Gas Range with Convection

6.0 cu. ft. Capacity



Signature Features

Convection

- Powerful convection saves you time by cooking food fast and more evenly. Perfect for baking and roasting.

Ready2Fit™ Guarantee

- If your Samsung Front Control Slide-In Range doesn't fit your 30" Freestanding Range cutout, enjoy \$100* on us to cover any countertop modification costs.

*Visit samsungpromotions.com/SlideInReady2Fit for details.

Fingerprint Resistant Finish

- Fingerprint resistant, for an everyday beautiful finish.

Available Colors



Fingerprint Resistant
Stainless Steel (shown)



Fingerprint Resistant
Black Stainless Steel



Convection



Ready2Fit™ Guarantee

Features

- Convection
- Ready2Fit™ Guarantee
- Fingerprint Resistant Finish
- 2 Power Burners
- Integrated Cast-Iron Griddle
- Large Oven Capacity – 6.0 cu. ft.
- Glass Touch Controls
- Edge-to-Edge Grates
- Storage Drawer

- Flexible Cooktop:
 - Right Front: 17K BTU
 - Left Front: 16K BTU
 - Right Rear: 5K BTU
 - Left Rear: 9.5K BTU
 - Center (Oval): 10K BTU

Convenience

- Wi-Fi Connectivity
- Voice-Enabled
- Self Clean
- Child Safety Lock
- Delay Start
- Auto Oven Light
- Kitchen Timer
- Sabbath Mode



NX60T8311SS

SAMSUNG

Samsung Front Control Slide-in Gas Range with Convection

6.0 cu. ft. Capacity

Installing Your Range

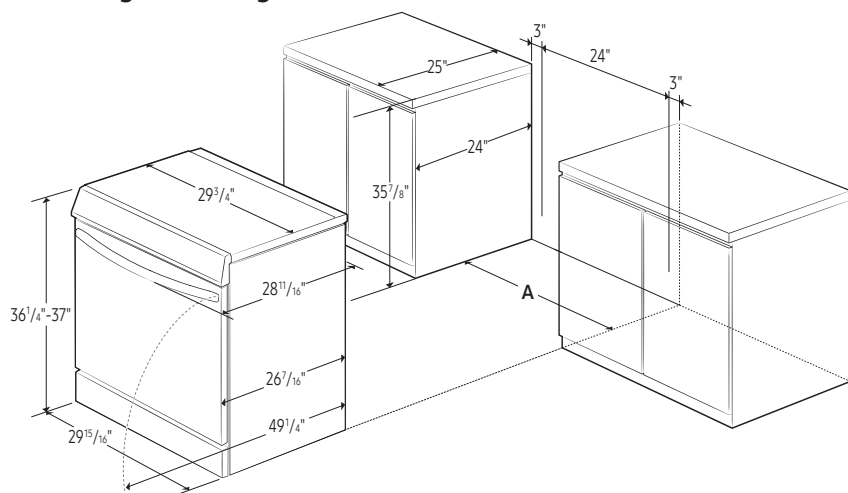

A: Cabinet opening 30"

IMPORTANT: If your cabinets are over 37" high, you must install this range on a hard, heat-resistant support that raises the surface of the range so that it is about even with the countertop.

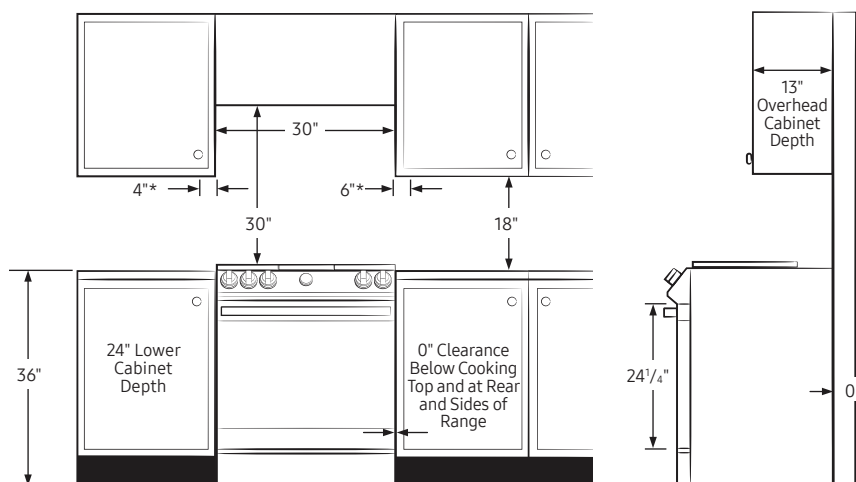

*Side clearance above cooking surface to any objects, i.e., wall.

IMPORTANT: Consult with Installation Manual for detailed instructions before installing.
All ranges must be installed with the Anti-Tip device that is included.

Recommended Locations for Gas Piping and Electrical Outlets

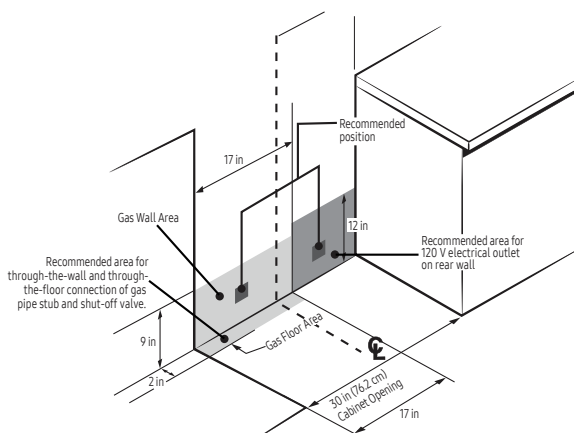

Power Source

120V/60Hz/20A

Total Power (BTU)

57,500 BTU

Black Enamel 5-Burner Cooktop

- Right Front: 17K BTU
- Left Front: 16K BTU
- Right Rear: 5K BTU
- Left Rear: 9.5K BTU
- Center (Oval): 10K BTU

Oven

- Capacity: 6.0 cu. ft.
- Convection Bake
- Convection Roast
- Bake
- Variable Broil: Low/High
- Bread Proof
- Dehydrate

Warranty

One (1) Year Parts and Labor

Product Dimensions & Weight (WxHxD)

Oven Interior Dimensions:

24¹³/₁₆" x 21⁵/₈" x 19⁵/₈"

Outside Dimensions:

29¹⁵/₁₆" x 36¹/₄-37" (Adjustable) x 28¹¹/₁₆"

Weight: 205 lbs

Shipping Dimensions & Weight (WxHxD)

Dimensions:

33¹/₁₆" x 41³/₄" x 30⁵/₁₆"

Weight: 230 lbs

Color

Fingerprint Resistant

Stainless Steel

Model

NX60T8311SS

UPC Code

887276409214

Fingerprint Resistant

Black Stainless Steel

NX60T8311SG

887276409207



Actual color may vary. Design, specifications, and color availability are subject to change without notice. Non-metric weights and measurements are approximate.

©2020 Samsung Electronics America, Inc. 85 Challenger Road, Ridgefield Park, NJ 07660. Tel: 800-SAMSUNG. samsung.com. Samsung is a registered trademark of Samsung Electronics Co. Ltd.

DW80K5050US/AC



Dishwasher with StormWash

www.samsung.com/ca



Color Stainless Steel

Dimensions

Width	23.9"
Height	33.9"
Depth	24.8"

Control Type Hidden touch
Display Light Color Ice blue
Washing Type Rotary
Capacity (Place Setting) 15 P/S
Energy Star
Dry System Auto Door Open Dry
Water Consumption Per Cycle (gallons) 3.5
Noise level (dBA) 48
Cycle time (min) 170 - 103
Normal | Auto | Delicate
Rinse Only | Heavy | Express 60'
Storm Wash | Delay Start | Half Load
Sanitize | Hi-Temp Wash | Control Lock
Auto Door Open
Adjustable Height
Adjustable Tines
Max Dish loading 13.5"
Cutlery Basket
Tub Material Stainless
Leakage Sensor
Number of Wash Arm Upper / Mid / Low
Food Disposer

Product dimension, cutout and installation specifications are provided for planning purposes only. Before installing any product, be sure to verify cutout dimensions and electrical/gas connections with the installation

®Registered trademark/TM Trademark of Samsung Electronics Canada Inc. © Samsung Electronics Canada Inc. All Rights Reserved.

All other trademarks are owned by their respective companies.

Because Samsung Electronics Canada Inc. policy includes a continuous commitment to improve our products, we reserve the right to change materials and specifications without notice. We also reserve the right to discontinue or transition products without notice.

preparing the dishwasher enclosure

PRODUCT DIMENSIONS

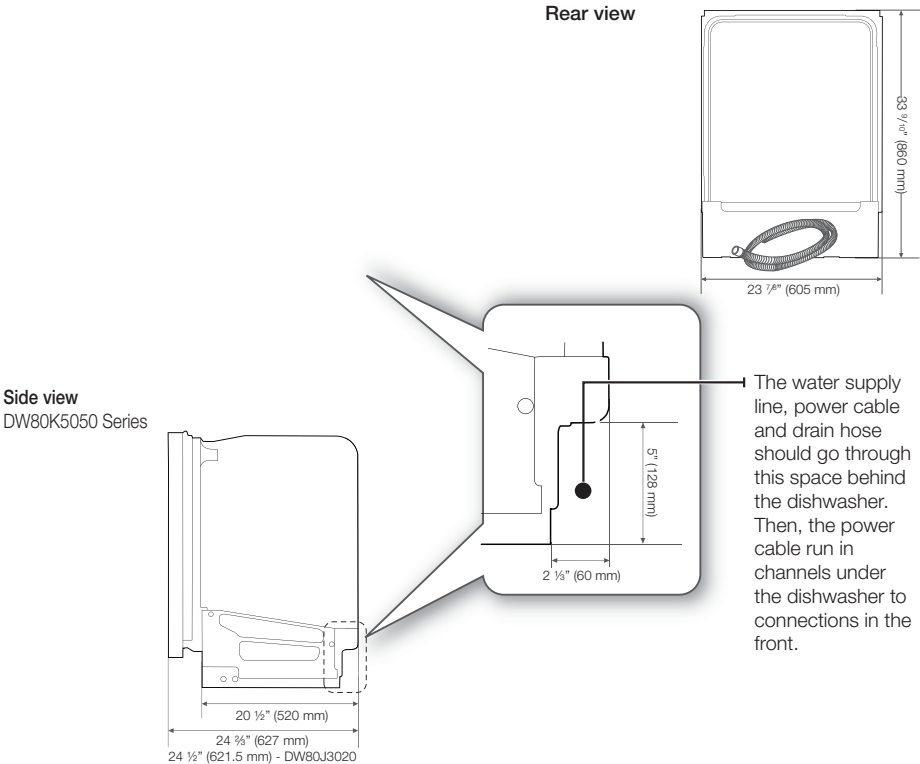

ENCLOSURE DIMENSIONS

 This dishwasher is designed to be enclosed on the top and on both sides by a standard residential kitchen cabinet unit.

The installation enclosure must be clean and free of any obstructions.

The enclosure must be at least 24 inches wide, 24 inches deep, and 34 1/8 inches high.

For the front door of the dishwasher to be flush with the leading edge of the counter top, the counter top must be at least 25 inches deep.

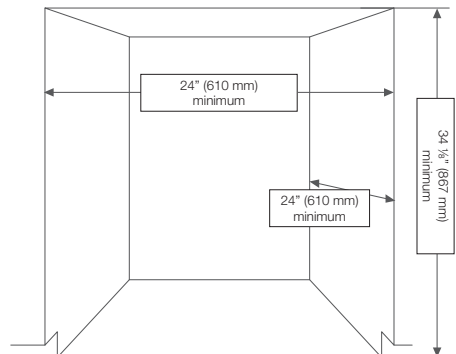

WF45R6100AC

SAMSUNG

Samsung Front Load Washer with Steam

5.2 cu. ft. Capacity IEC



Signature Features

Steam

- Powerful stain removal without pretreatment while still gentle on your clothing.

Self Clean+

- Keeps your washer drum fresh and clean by eliminating 99% of bacteria¹. Will also send a reminder to clean the drum every forty wash cycles.

Closet-Depth Fit²

- This washer fits within your existing laundry space without sacrificing any capacity thanks to our new, wider drum.
- A new control panel design provides better visibility so it is easy to use even when stacked.

Available Colours



Champagne (shown)



Platinum



Steam



Self Clean+

Features

- Steam
- Self Clean+
- Smart Care
- VRT Plus™ Technology
- Swirl+ Drum Design
- Closet-Depth Fit²
- Stackability
- Internal Water Heater
- 1200 RPM Maximum Spin Speed
- Direct Drive Motor
- 10 Preset Washing Cycles
- 7 Additional Washing Options
- 5 Temperature Levels
- LED Display: Ice Blue
- 24-Hour Delay End

Convenience

- Child Lock
- Delay End
- Dispenser Trays: Main Wash, Softener, Bleach

Rating



ENERGY STAR®-rated
CEE Tier 2
IMEF = 2.92
IWF = 2.9

¹Based on testing by Intertek of the Self Clean+ cycle on the WF6000R.

²Designed to fit a 40" installation depth.

WF45R6100AC

SAMSUNG

Samsung Front Load Washer with Steam

5.2 cu. ft. Capacity IEC

Installation Specifications

If the washer and dryer are installed together or the dryer alone, the closet front must have two unobstructed air openings for a combined minimum total area of 72-inch² (see stacked build below). Your washer alone does not require a specific air opening.

*Required spacing (External exhaust elbow may require additional space.)

1. Alcove or closet installation

Minimum Clearance for Closet and Alcove Installations:

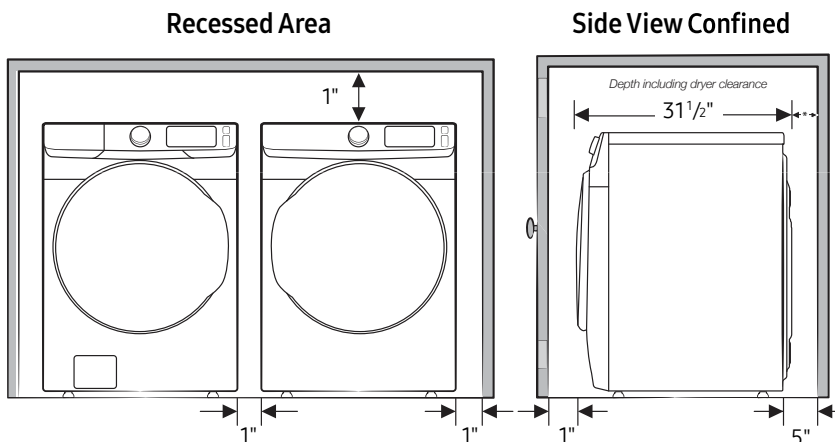

2. With stacked washer and dryer

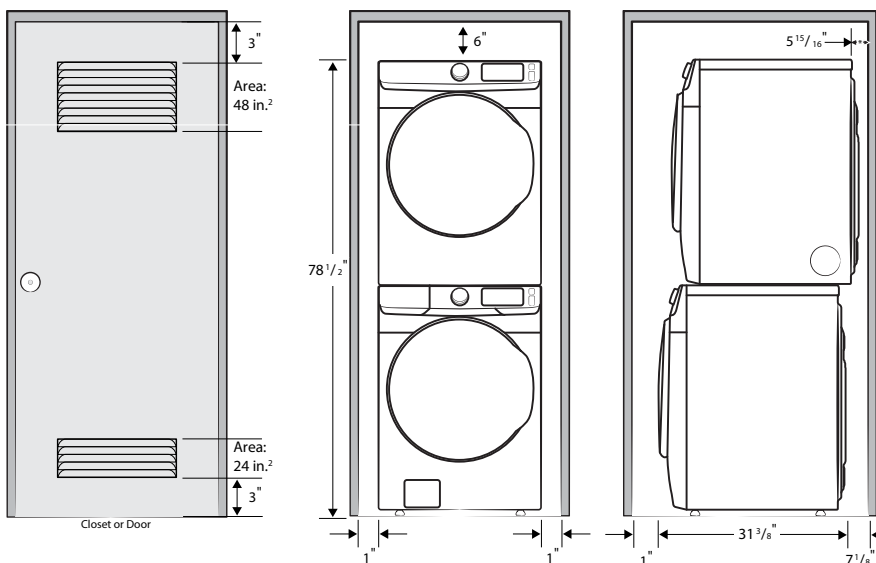

Dimensions

Required Dimensions for Installation with Pedestal:

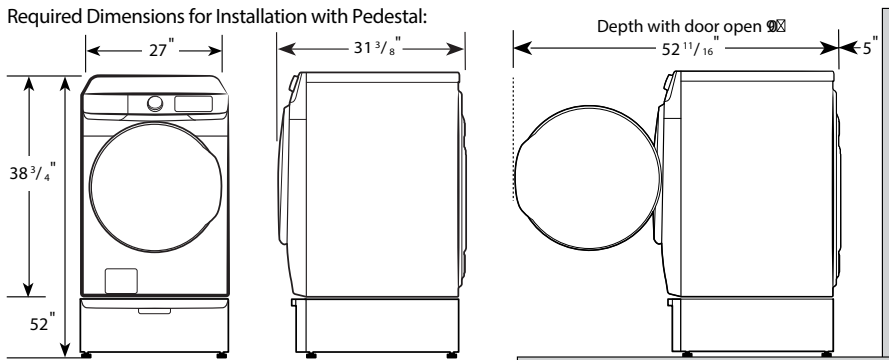

10 Preset Washing Cycles:

Normal, Heavy Duty, Bedding, Quick Wash, Permanent Press, Delicates, Whites, Sanitize, Rinse and Spin, Self Clean+

7 Additional Washing Options:

Presoak, Steam, Delay End, Alarm Off, Child Lock, Smart Care, Spin Only

5 Temperature Levels:

Hot, Warmer, Warm, Cool, Cold

5 Spin Speeds:

High, Medium High, Medium, Low, No Spin

Warranty

One (1) Year Parts and Labor

Ten (10) Years Direct Drive Motor (Part Only)

Product Dimensions & Weight (WxHxD)

Dimensions: 27" x 38³/₄" x 31³/₈"

Weight: 201 lbs

Shipping Dimensions & Weight (WxHxD)

Dimensions: 29³/₈" x 42³/₈" x 34¹/₈"

Weight: 205 lbs

Color	Model #	UPC Code
Champagne	WF45R6100AC	887276305295
Platinum	WF45R6100AP	887276299464

Matching Dryer (Electric/Gas)

Champagne	DVE45T6100C	887276390352
Platinum	DVE45T6100P	887276390369
Platinum	DVG45T6100P	887276390390

Pedestal

Champagne	WE402NC	887276310121
Platinum	WE402NP	887276390390

Accessories

Stacking Kit	SKK-8K	887276344034
--------------	--------	--------------

DVE45T6100P/AC



7.5 Cu.Ft. Electric Dryer with Steam Sanitize

www.samsung.com/ca



- Interior Drum Light
- Smart Care
- Reversible Door
- Child Lock
- Dual Heater
- Filter Check Indicator
- Mixed Load Bell
- Progress Indicator
- Steam
- Vent Exhaust (Electric/Gas) 4 ways
- Wrinkle Prevent
- Number of Drying Level 5 EA
- Number of Temp. Level 5 EA
- Number of Time Level 5 EA
- Normal | Heavy Duty
- Time Dry | Air Fluff
- Perm Press | Quick Dry
- Refresh | Delicates
- Bedding | Steam Sanitize+
- Wrinkle Prevent | Eco Dry | Damp Alert
- Drum Light (Long Key) | Alarm Off (Long Key)
- Child Lock (Dual Long Key) | Smart Care (Long Key)
- Adjust Time (Up) | Adjust Time (Down)

Color Platinum

Dimensions

Width	27"
Height	31.5"
Depth	38.7"

Product dimension, cutout and installation specifications are provided for planning purposes only. Before installing any product, be sure to verify cutout dimensions and electrical/gas connections with the installation

®Registered trademark/TM Trademark of Samsung Electronics Canada Inc. © Samsung Electronics Canada Inc. All Rights Reserved.
All other trademarks are owned by their respective companies.
Because Samsung Electronics Canada Inc. policy includes a continuous commitment to improve our products, we reserve the right to change materials and specifications without notice. We also reserve the right to discontinue or transition products without notice.

Dimensions

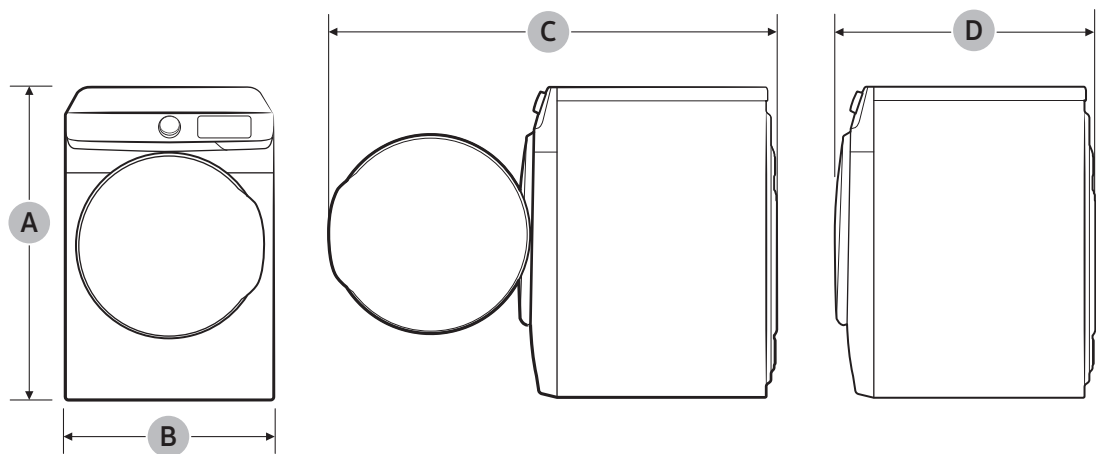

Type		Front loading dryer
Dimensions (in. (mm))	A. Overall height	38.7 (984)
	B. Width	27.0 (686)
	C. Depth with door open	52.6 (1335)
	D. Depth	31.5 (800)

Installation requirements

Clearance requirement

This clearance requirement is applicable for dryers only.

NOTE

- For washer's clearance requirement, see the washer's user manual.
- If the washer and dryer have different clearance requirements, use the one with the larger value.

Alcove or closet installations

WARNING

- The dryer must be exhausted to the outside to reduce the risk of fire when installed in an alcove or closet.
- No other fuel-burning appliance should be installed in the same closet as the dryer.
- Place the dryer at least 18 in. (460 mm) above the floor for garage installation.

Minimum clearance for stable operation:

Sides	Top	Rear	Front
1 in. (25 mm)	1 in. (25 mm)	5.9 in. (150 mm)	1 in. (25 mm)

If both the washer and a dryer are installed in the same location, the front of the alcove or closet must have two unobstructed air openings for a combined minimum total area of 72 in.² (465 cm²).

Undercounter installation

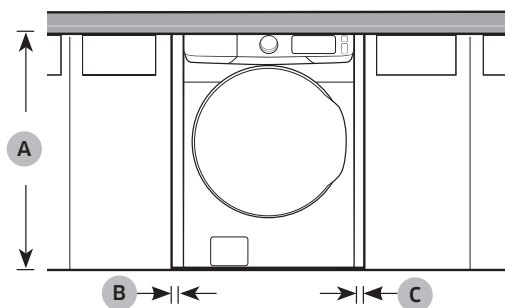

A	39.6 in. (1006 mm)
B	1 in. (25 mm)
C	1 in. (25 mm)

Pedestal installation

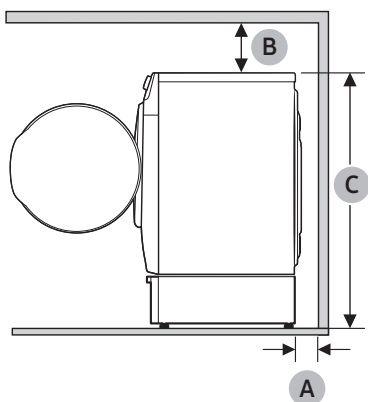

A	5.9 in. (150 mm)
B	6 in. (152 mm)
C	52.0 in. (1320 mm)

Installation requirements

This clearance requirement is applicable for washer and dryer pair installation.

Side by side installation

Stacked installation (Model: SKK-8K)

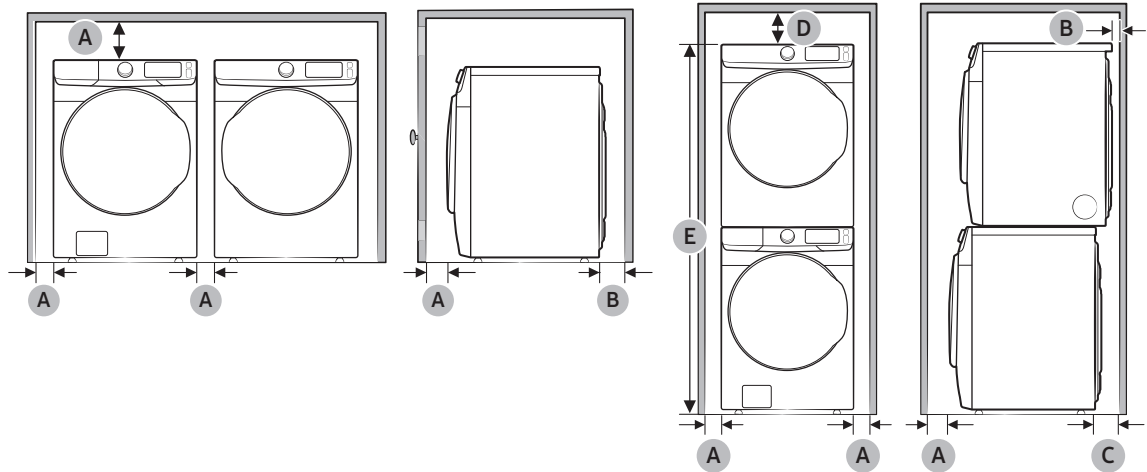

A	1 in. (25 mm)
B	5.9 in. (150 mm)
C	7.1 in. (180 mm)
D	6 in. (152 mm)
E	78.5 in. (1994 mm)

NOTE

Stacking (MODEL NO: SKK-8K)

Many of Samsung's washers and dryers can be stacked to maximize usable space. You can purchase an optional stacking kit from your Samsung retailer. For details about stacking and compatible models, refer to the user manual included in the stacking kit you purchase.

Ducting requirements

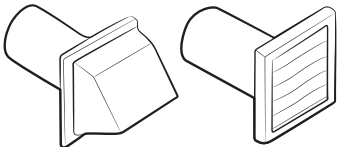
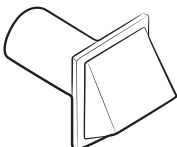
Weather hood type	Recommended	Use only for short-run installation
	 4" (10.2 cm)	 2.5" (6.4 cm)
No. of 90° elbows	Rigid	Rigid
0	80 ft. (24.4 m)	74 ft. (22.6 m)
1	68 ft. (20.7 m)	62 ft. (18.9 m)
2	57 ft. (17.4 m)	51 ft. (15.5 m)
3	47 ft. (14.3 m)	41 ft. (12.5 m)

NOTE

* Use a 4-inch (10.2 cm) diameter rigid aluminum or galvanized steel duct.

If you integrate the dryer's vent system with an existing exhaust system:

- Make sure the exhaust system meets all applicable local, state, and national regulations.
- Verify you are not using flexible plastic duct.
- Make sure to check for and remove all lint buildup from inside the existing ducts.
- Confirm the duct is not kinked or crushed.
- Make sure the exhaust hood damper opens and closes freely.

Manometer measurements

The static pressure in any exhaust system must not exceed 0.83 inches of water column or be less than 0. Note that these values are measured with the dryer running with a manometer presented to the exhaust duct that connects to the dryer. The dryer tumbler must be empty and lint filter clean.

Installation requirements

Exhausting requirements

The dryer must not be exhausted into a chimney, a wall, a ceiling, an attic, a crawl space, or a concealed space of a building. Exhausting the dryer to the outside will prevent large amounts of lint and moisture from being blown into the room.

In the United States and Canada

- All dryers must be exhausted to the outside.
- The required exhaust duct is 4 inches (10.2 cm) in diameter.
- See “**Ducting requirements**” in the “**Installation**” section for the maximum duct length and number of bends that can be used.
- The total length of flexible metal duct must not exceed 7' 10 1/2" (2.4 m).
- Do not assemble the duct with screws or other fasteners that extend into the duct and catch lint.
- **For the United States only:** Use only those foil-type flexible ducts, if any, specifically identified for use with the appliance by the manufacturer and that comply with the Outline for Clothes Dryer Transition Duct. Use Subject 2158A.

Outside the United States and Canada

- Refer to the local codes.

WARNING

- You must exhaust the dryer to the outside to reduce the risk of fire when you install the dryer in an alcove or closet.
- Do not use a plastic or non-metal flexible duct.
- If your existing ductwork is plastic, non-metal, or combustible, replace it with metal.
- Use only a metal exhaust duct that is non-flammable to ensure containment of exhaust air, heat, and lint.

30" Wall mounted hood AVH-308CS

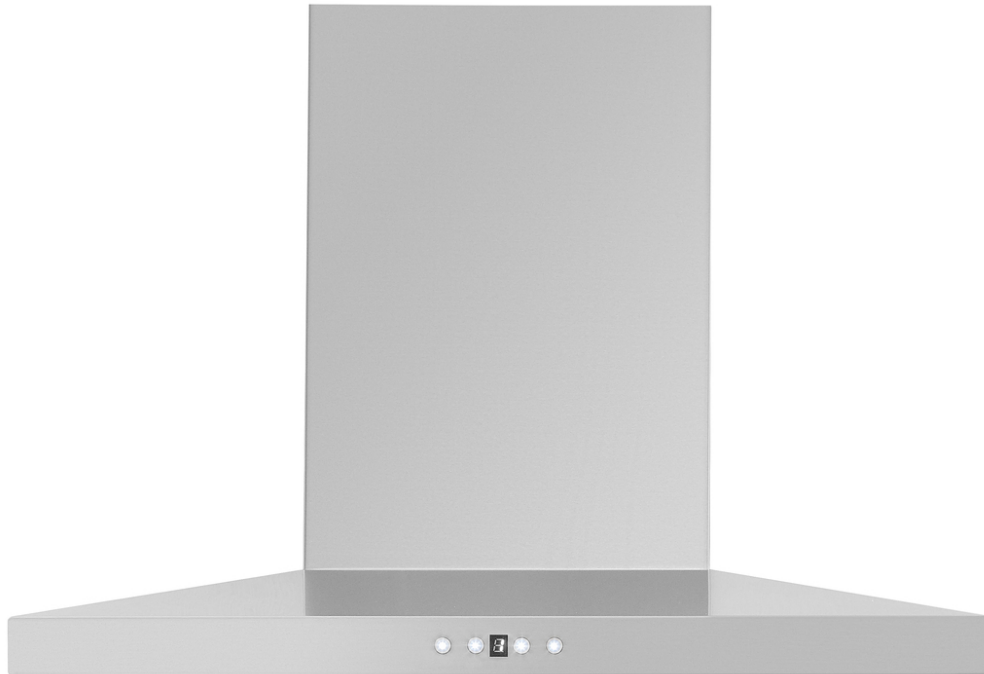

Model	AVH-308CS
Features	
Control	Soft touch with LED display
Lighting	2 bulbs, 3W LED (bulbs included)
Blower type	860 CFM, 6-Speed
Blower performance	Speed 1, 2.4 sones Speed 6, 6.2 sones
Filter type	2 aluminium micro hole filters (included) 2 Stainless steel baffle filters (included)
Duct transition	6" Round (Top)
Ducting	Ducted
Chimney (ducted out)	For ceiling heights up to 9'0"
Exterior Appearance	
Stainless steel grade	201
Electrical Requirements	
Electrical requirements	120V / 60Hz / 2.7 Amps
Dimensions	
Dimensions	29 1/2" (W) x 19 3/4" (D) x 3 1/4" (H)
Warranty	
1-year Warranty	Parts and labour, in-home service

2. INSTALLATION INSTRUCTIONS (continued)

PREPARING THE INSTALLATION

- **For indoor use only.**
- **For household use only. This hood is not to be used to exhaust explosive or dangerous fumes or materials.**
- For your safety and for optimum performance, refer to the 'Installation Drawings' below for the distance required between the cooktop and the range hood taking into consideration the height of the ceiling. If the instructions for installation of the gas hob specify a greater distance, this has to be taken into account as well.
- The exhaust air must not be discharged into a chimney that is used for exhausting fumes from other appliances that burn gas or other fuels.
- Determine the exact location of the vent hood. Mark the location. Find the centerline of the cooktop. Use a level to draw a vertical straight pencil line on the wall.
- Plan the route for venting exhaust to the outdoors. Use the shortest and straightest duct route possible. Make sure the first duct runs is at least 12" before redirecting. Long duct runs, elbows and transitions will reduce the performance of the hood. Use as few of them as possible. Larger ducting may be required for longer duct runs.
- Install a wall cap with damper or roof cap at the exterior opening / wall. Join the wall cap or roof cap to the ductwork.
- Connect round metal ductwork to cap and work back towards the hood location. Use a 2" metal foil duct tape to seal the joints.

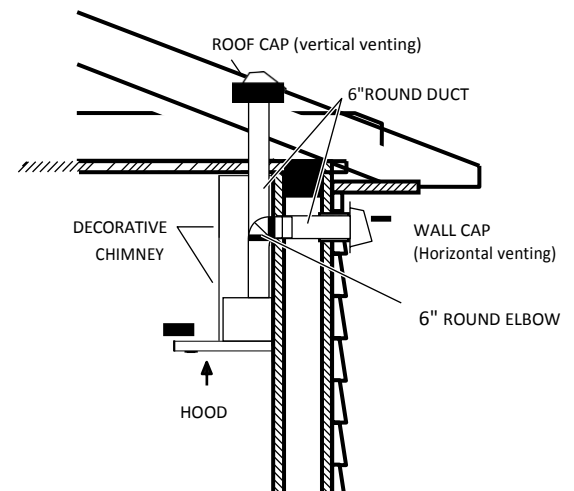

INSTALLATION DRAWINGS

It is important to install the hood at the proper mounting height. Hoods mounted too low could result in heat damage and fire hazard; while hoods mounted too high will be hard to reach and will lose its performance and efficiency.

- For ceilings of 8', the hood distance above an electric cooking surface must not be less than **28"**.

The hood distance above a gas cooking surface must not be less than **30"**.
- For ceilings of 9' or more, the minimum hood distance must be no less than **30"** for any type of cooktop.

