



CONSTRUCTION SUMMARY

184 - 5 - The Castello 1 (S50-1) Elev A Lot 184

Extras at Time of Sale

Upgrade 1 granite countertops in kitchen and all bathroom with undermount sinks (AS PER BONUS) <i>Worksheet</i> <i>Note:</i>
Stainless steel stove, fridge, dishwasher, white washer & dryer (AS PER BONUS) <i>Worksheet</i> <i>Note:</i>
Upgrade 1 wrought iron pickets main to second floor only (AS PER BONUS) <i>Worksheet</i> <i>Note:</i>
Upgraded 3 1/4 hardwood on upper hallway and master bedroom (AS PER BONUS) <i>Worksheet</i> <i>Note:</i>
Smooth ceiling on main floor (AS PER BONUS) <i>Worksheet</i> <i>Note:</i>
Upgrade 1 tile on main and second floor (AS PER BONUS) <i>Worksheet</i> <i>Note:</i>
*** EXTRA *** <i>Worksheet</i> <i>Note:</i>
Smooth ceiling on second floor <i>Worksheet</i> <i>Note:</i>
Coffered ceiling in living/dining room as per plan <i>Worksheet</i> <i>Note:</i>
8 ft interior doors throughout main floor only <i>Worksheet</i> <i>Note:</i>
24X24 ceramic flooring in all tiled areas on main and second floor as per plan <i>Worksheet</i> <i>Note:</i>
Kitchen Island sink as per plan <i>Worksheet</i> <i>Note:</i>

CABINETRY

Inv.5	1 - CABINETRY-KITCHEN-UPGRADE 1 - BUILT IN CABINET-TO ACCOMMODATE-MICRO/OVEN COMBO (BESIDE FRIDGE)(THIS INCLUDES 2 DOOR CABINET ABOVE MICROWAVE CUT OUT, MICROWAVE CUT OUT, OVEN CUT OUT, DRAWER BELOW)
Line52	<i>Note:</i>
9Oct20 / 26Oct20	
Inv.5	1 - DESIGNER FRIDGE - BUILT IN FRIDGE CABINET
Line53	<i>Note:</i>
9Oct20 / 26Oct20	
Inv.10	1 - CABINETRY- UPGRADE 1- BUILT IN DESIGNER FRIDGE CABINET-HEIGHTS-83 3/8--WIDTH- 42 1/4- DEPTH - 27 3/4- SPECS FOR FRIDGE PROVIDED
Line72	<i>Note:</i> AS PER SKETCH
30Oct20 / 4Nov20	

CABINETRY - ACCESSORIES

Inv.5	1 - LIGHT VALANCE
Line55	<i>Note:</i>
9Oct20 / 26Oct20	

CABINETRY - KITCHEN CABINETS

Inv.5	1 - CABINETRY - KITCHEN CABINETS - UPGRADE 1 - KITCHEN
Line28	<i>Note:</i>
9Oct20 / 26Oct20	



CONSTRUCTION SUMMARY

184 - 5 - The Castello 1 (S50-1) Elev A Lot 184

Inv.5	1 - CABINETRY - KITCHEN CABINETS - DEEP FRIDGE UPPER
Line29	Note:
9Oct20 / 26Oct20	
Inv.5	1 - CABINETRY - KITCHEN CABINETS - UPGRADE 2 - MASTER ENSUITE
Line30	Note:
9Oct20 / 26Oct20	
Inv.5	1 - CABINETRY - KITCHEN CABINETS - DELETE UPPER CABINET OVER STOVE TO ACCOMODATE CHIMNEY HOODFAN
Line51	Note:
9Oct20 / 26Oct20	
Inv.10	1 - CABINETRY - KITCHEN CABINETS - UPGRADE 1 - POTS AND PANS DRAWER - 60CM X 80CM
Line73	Note: IN THE ISLAND AS PER SKETCH
30Oct20 / 4Nov20	
Inv.10	1 - CABINETRY - KITCHEN CABINETS - GAS SLIDE IN STOVE CABINET
Line74	Note:
30Oct20 / 4Nov20	
Inv.11	1 - CABINETRY - KITCHEN CABINETS - KITCHEN BANK OF DRAWERS
Line98	Note:
8Nov20 / 11Nov20	

CARPET

Inv.5	1 - CARPET - CARPET UNDER PAD - UPGRADE 1 - MEDIA LOFT , BEDROOMS - 2,3,4,5.
Line47	Note:
9Oct20 / 26Oct20	

CEILINGS

Inv.2	1 - SMOOTH CEILINGS THROUGH OUT MAIN FLOOR (AS PER BONUS)
Line1	Note:
6Oct20 / 26Oct20	

CONSTRUCTION

Inv.2	1 - LEAVE 36" OPENING FOR STOVE
Line20	Note:
6Oct20 / 26Oct20	
Inv.2	1 - MOVE STOVE OPENING -1 FT TOWARDS EXTERIOR WALL
Line21	Note:
6Oct20 / 26Oct20	

COUNTER TOP - GRANITE

Inv.5	1 - UPGRADE 1 - GRANITE - KITCHEN - AND 1/4" BEVEL EDGE (AS PER BONUS)
Line31	Note:
9Oct20 / 26Oct20	
Inv.5	1 - UPGRADE 1 - GRANITE - ISLAND-AND 1/4" BEVEL EDGE (AS PER BONUS)
Line32	Note:
9Oct20 / 26Oct20	



CONSTRUCTION SUMMARY

184 - 5 - The Castello 1 (S50-1) Elev A Lot 184

Inv.5	1 - UPGRADE 1 - GRANITE - ENSUITE - AND 1/4" BEVEL EDGE (AS PER BONUS)
Line33	Note:
9Oct20 / 26Oct20	
Inv.5	1 - UPGRADE 1 - GRANITE - ENSUITE 2 - AND 1/4" BEVEL EDGE (AS PER BONUS)
Line34	Note:
9Oct20 / 26Oct20	
Inv.5	1 - UPGRADE 1 - GRANITE - SHARED ENSUITE 3 - AND 1/4" BEVEL EDGE (AS PER BONUS)
Line35	Note:
9Oct20 / 26Oct20	
Inv.5	1 - UPGRADE 1 - GRANITE - ENSUITE 4 -AND 1/4" BEVEL EDGE (AS PER BONUS)
Line36	Note:
9Oct20 / 26Oct20	

DO NOT INSTALL

Inv.5	1 - DELETE ALL CERAMIC ACCESSORIES (PAPER HOLDER , TOWEL BAR, SOAP DISHES)
Line58	Note:
9Oct20 / 26Oct20	
Inv.5	1 - DO NOT INSTALL MIRROR IN POWDFER ROOM.
Line57	Note:
9Oct20 / 26Oct20	

ELECTRICAL

Inv.2	1 - MOVE AND CENTER EXISTING CEILING LIGHT FIXTURE - ABOVE ISLAND IN THE KITCHEN-AS PER SKETCH
Line8	Note:
6Oct20 / 26Oct20	
Inv.2	1 - DOUBLE WALL OVEN-MICROWAVE PLUG ON SEPARATE CIRCUIT - TO ACCOMODATE BUILT IN COMBO - AS PER SKETCH
Line9	Note:
6Oct20 / 26Oct20	

HARDWOOD FLOORING

Inv.5	1 - HARDWOOD- UPGRADE 1 -MERCIER RED OAK 3 1/4 INCH X 3/4 INCH - MASTER BEDROOM (SA PER BONUS)
Line48	Note:
9Oct20 / 26Oct20	
Inv.5	1 - HARDWOOD- UPGRADE 1 -MERCIER RED OAK 3 1/4 INCH X 3/4 INCH - UPPER HALL (SA PER BONUS)
Line49	Note:
9Oct20 / 26Oct20	

HEATING AND AIR CONDITIONING

Inv.5	1 - HEATING AND AIR CONDITIONING - INCREASE KITCHEN EXHAUST TO 8 INCH
Line56	Note:
9Oct20 / 26Oct20	

MISCELLANEOUS



CONSTRUCTION SUMMARY

184 - 5 - The Castello 1 (S50-1) Elev A Lot 184

Inv.2	1 - GAS LINE - ROUGH IN GAS LINE - STOVE
Line7	Note:
6Oct20 / 26Oct20	
Inv.4	1 - APPLIANCES - STAINLESS STEEL -STOVE-FRIDGE-DISHWASHER-WHITE WASHER -DRYER AS PER BONUS
Line27	Note:
9Oct20 / 26Oct20	
Inv.5	1 - SINK - LONDON - UNDERMOUNT (UP1)
Line37	Note:
9Oct20 / 26Oct20	
Inv.5	6 - SINK - OVAL UNDERMOUNT PORCELAIN - VANITY - 6X OVAL , FOR ALL VANITIES ON SECON FLOOR.
Line38	Note:
9Oct20 / 26Oct20	

PAINT AND STAIN

Inv.5	1 - PAINT AND STAIN - STAIN TO STAIRS, RAILINGS, PICKETS AND STRINGER - MAIN TO SECOND FLOOR
Line50	Note:
9Oct20 / 26Oct20	

PLUMBING

Inv.2	1 - PLUMBING - POT TOP ROUGH IN ONLY-KITCHEN ABOVE STOVE
Line4	Note:
6Oct20 / 26Oct20	
Inv.2	1 - PLUMBING - KEEP EXISTING SHOWER HEAD ON WALL AND ADD - RAIN SHOWER HEAD - MOUNTED AND CENTERED ON TO SHOWER CEILING - IN MASTER BEDROOM AS PER FLOORPLAN. THIS INCLUDES FOLLOWING :1) S1003 FIXTURE (MOEN), 2) 116651 3) AT2199, 4)3372, 5)T4171
Line6	Note:
6Oct20 / 26Oct20	
Inv.5	1 - PLUMBING - WATERLINE FOR FRIDGE
Line59	Note:
9Oct20 / 26Oct20	

STAIRS AND RAILING

Inv.2	1 - INTERIOR RAIL - UPGRADE 1 IRON -MAIN TO SECOND FLOOR ONLY (AS PER BONUS)
Line2	Note:
6Oct20 / 26Oct20	

TILE

Inv.5	1 - TILE - UPGRADE 4 - ENTRY - (AS PER BONUS UP1-PRICE DIFFERENCE)
Line39	Note:
9Oct20 / 26Oct20	
Inv.5	1 - TILE - UPGRADE 4 - MAIN HALL - (AS PER BONUS UP1-PRICE DIFFERENCE)
Line40	Note:
9Oct20 / 26Oct20	



CONSTRUCTION SUMMARY

184 - 5 - The Castello 1 (S50-1) Elev A Lot 184

Inv.5	1 - TILE - UPGRADE 4 - SIDE ENTRY, MUDROOM, LAUNDRY- (AS PER BONUS UP1-PRICE DIFFERENCE)
Line41	Note:
9Oct20 / 26Oct20	
Inv.5	1 - TILE - UPGRADE 4 - POWDER ROOM - (AS PER BONUS UP1-PRICE DIFFERENCE)
Line42	Note:
9Oct20 / 26Oct20	
Inv.5	1 - TILE - UPGRADE 4 - KITCHEN AND BREAKFAST-(AS PER BONUS UP1-PRICE DIFFERENCE)
Line43	Note:
9Oct20 / 26Oct20	
Inv.5	1 - TILE - UPGRADE 2 - MASTER ENSUITE
Line44	Note:
9Oct20 / 26Oct20	

TILE - TUB AND SHOWER

Inv.5	1 - WALL TILE - UPGRADE 2 - MASTER ENSUITE - SHOWER WALLS AND CEILING
Line45	Note:
9Oct20 / 26Oct20	

TRIM CARPENTRY

Inv.2	1 - 8' TALL INTERIOR DOORS/DOOR OPENINGS THROUGHOUT MAIN FLOOR (AS PER SCHEDULE A-2)
Line3	Note:
6Oct20 / 26Oct20	



INTERIOR COLOUR SCHEME

Purchasers:

FURQAN ABBASSI & ALAA ABBASSI

Property: 184

Telephone Res. / Bus:

/

Project: Bradford Capital Holdings Inc.

Decor Advisor:

Inna Semikolenniha

Model and Elevation: The Castello 1 (S50-1) Elev A Lot 184

Lock Date:

10-Nov-20

30-Oct-20

Plan #:

51M-1063

Layout Changes: ☐ Yes ☒ No

Sketch Attached: ☒ Yes ☐ No

Exterior Colour Scheme: # 1

1. Kitchen and Vanities

	Style and Colour	Hardware
Kitchen / Breakfast	ROMEO MSC - ONTARIO WHITE (UP1)	HC-07
Laundry Room	ROMEO CRYSTAL - WHITE (STD)	HC-09
Powder Room	N/A	N/A
Master Ensuite Bathroom	SHAKER OAK-SLATE GREY (UP2)	HC-09
ENSUITE 2	ROMEO CRYSTAL - WHITE (STD)	HC-09
SHARED ENSUITE 3	ROMEO CRYSTAL - WHITE (STD)	HC-09
ENSUITE 4	ROMEO CRYSTAL - WHITE (STD)	HC-09
KITCHEN ISELAND	ROMEO MSC - ONTARIO WHITE (UP1)	HC-07

Comment

**OPEN STOVE OPENING TO 36"
** DELETE CABINET ABOVE STOVE TO ACCOMODATE CHIMNEY HOOD FAN
** KITCHEN-BUILT IN MICRO/OVEN COMBO CABINET - BESIDE FRIDGE
** MOVE 36" STOVE OPENING 1FT TOWARDS EXTERIOR WALL
**BUILT IN DESIGNER FRIDGE CABINET-HEIGHTS-83 3/8-- WIDTH- 42 1/4- DEPTH - 27 3/4- SPECS FOR FRIDGE PROVIDED **POTS AND PANS DRAWER - 60CM X 80CM **GAS SLIDE IN STOVE CABINET ** EXTRA BANK OF DRAWERS-KITCHEN - OPOSITE SIDE OF STOVE

2. Counter Top

	Counter	Edge
Kitchen / Breakfast	SPARKLY WHITE (UP1-AS PER BONUS)	1/4" BEVEL EDGE (STD)
Laundry Room	CALCUTTA MARBLE-4925K-07 (STD)	N/A
Powder Room	N/A	
Master Ensuite Bathroom	FUSION WHITE (UP1-AS PER BONUS)	1/4" BEVEL EDGE (STD)
ENSUITE 2	FUSION WHITE (UP1-AS PER BONUS)	1/4" BEVEL EDGE (STD)
SHARED ENSUITE 3	FUSION WHITE (UP1-AS PER BONUS)	1/4" BEVEL EDGE (STD)
ENSUITE 4	FUSION WHITE (UP1-AS PER BONUS)	1/4" BEVEL EDGE (STD)
KITCHEN ISELAND	SPARKLY WHITE (UP1-AS PER BONUS)	1/4" BEVEL EDGE (STD)

Comment

***LONDON- UNDERMOUNT SINK (UP1)
*** 6X OVAL UNDERMOUNT SINKS -FOR ALL BATHROOMS ON SECOND FLOOR(AS PER BONUS)

3. Ceramic Flooring

	Selection	Threshold
Entrance Vestibule	GLAMOUR PORCELAIN-CALACATTA-24X24 (UP4)	
Main Hall	GLAMOUR PORCELAIN-CALACATTA-24X24 (UP4)	
Kitchen / Breakfast	GLAMOUR PORCELAIN-CALACATTA-24X24 (UP4)	
Laundry Room	PIETRA MODA PORCELAIN- SILVER MATT 12X24 (UP1-AS PER BON)	
Powder Room	GLAMOUR PORCELAIN-CALACATTA-24X24 (UP4)	
Master Ensuite Bathroom	MAYIFAIR SUAVE BIANCO-16X32 - POLISHED	
Master Ensuite Shower Floor	2X2 SOHO WARM GREY - 51-027	
ENSUITE 2	AMELIA - MIST - MATTE - NON-RECTIFIED 69-069 - 12x24 (UP1)	AS PER BONUS
SHARED ENSUITE 3	AMELIA - MIST - MATTE - NON-RECTIFIED 69-069 - 12x24 (UP1)	AS PER BONUS
ENSUITE 3 SHOWER FLOO	2X2 SOHO WARM GREY - 51-027 (STD)	
ENSUITE 4	AMELIA - MIST - MATTE - NON-RECTIFIED 69-069 - 12x24 (UP1)	AS PER BONUS

Comment



INTERIOR COLOUR SCHEME

Purchasers:

FURQAN ABBASSI & ALAA ABBASSI

Property: 184

Telephone Res. / Bus:

/

Project: Bradford Capital Holdings Inc.

Decor Advisor:

Inna Semikolenniha

Model and Elevation: The Castello 1 (S50-1) Elev A Lot 184

Lock Date:

10-Nov-20

30-Oct-20

Plan #: 51M-1063

4. Ceramic Wall Tile

Master Ensuite Bathroom

Tub Deck Wall

Tub Deck

Tub Deck Skirt

Shower Stall

N/A

N/A

N/A

MAYIFAIR SUAVE BIANCO-16X32 POLISHED

MASTER ENSUITE

N/A

ENSUITE 2

AMELIA-MIST-MATTE-NONE RECTIFIED 69-0912X24(UP1

AS PER BONUS

ENSUITE 3 SHOWER STAL

AMELIA-MIST-MATTE-NONE RECTIFIED 69-0912X24(UP1

AS PER BONUS

ENSUITE 4

AMELIA-MIST-MATTE-NONE RECTIFIED 69-0912X24(UP1

AS PER BONUS

Kitchen Backsplash

N/A

Delete all Ceramic Accessories (Paper Holder;Towel Bar; Soap Dishes)

Yes

No

Comment

** Refer to Construction Summary - STANDARD GROUT THROUGHOUT UNLESS SPECIFIED

*** DELETE ALL CERAMIC ACCESSORIES***

DO NOT INSTALL MIRROR IN POWDER ROOM

5. Carpeting

Main Hall

TILE

Living Room

HARDWOOD

Dining Room

HARDWOOD

Family Room

HARDWOOD

Den / Library / Study

HARDWOOD

Basement Landing(If Applies)

N/A

Lower Landing (If Applies)

N/A

Upper Landing

N/A

Upper Hall

HARDWOOD

Master Bedroom

HARDWOOD

Bedroom #2

MOHAWK - 829 TAUPE WHISPER (STD)

Bedroom #3

MOHAWK - 829 TAUPE WHISPER (STD)

Bedroom #4

MOHAWK - 829 TAUPE WHISPER (STD)

Bedroom #5

MOHAWK - 829 TAUPE WHISPER (STD)

MEDIA LOFT

MOHAWK - 829 TAUPE WHISPER (STD)

Underpad

Type

Area

SUPREME ELITE (UPGRADE 1)

MEDIA LOFT & ALL BEDROOMS EXEPT MASTER

Carpet on Stairs

Capped

Runner - *Upgrade

N/A

N/A

Comment

** Refer to Construction Summary

***(SUPREME ELITE (UPGRADE 1) -CARPET UNDER PAD - MEDIA LOFT,BEDROOM 2,3,4,5.

Initials:_____

Page 2 of 6

Printed 11/11/2020 11:43:16

PDF created with pdfFactory trial version www.pdffactory.com



INTERIOR COLOUR SCHEME

Purchasers:

FURQAN ABBASSI & ALAA ABBASSI

Property: 184

Telephone Res. / Bus:

/

Project: Bradford Capital Holdings Inc.

Decor Advisor:

Inna Semikolenniha

Model and Elevation: The Castello 1 (S50-1) Elev A Lot 184

Lock Date:

10-Nov-20

30-Oct-20

Plan #:

51M-1063

6. Hardwood

Kitchen	TILE
Main Hall	TILE
Living Room	MERCIER-RED OAK-3 1/4" PRO (83) - CONCRETE GREY (STD)
Dining Room	MERCIER-RED OAK-3 1/4" PRO (83) - CONCRETE GREY (STD)
Family Room	MERCIER-RED OAK-3 1/4" PRO (83) - CONCRETE GREY (STD)
Den / Library / Study	MERCIER-RED OAK-3 1/4" PRO (83) - CONCRETE GREY (STD)
Basement Landing(If Applies)	N/A
Lower Landing (If Applies)	N/A
Upper Landing	N/A
Upper Hall	MERCIER-RED OAK-3 1/4" PRO (83) - CONCRETE GREY (AS PER BONUS)
Master Bedroom	MERCIER-RED OAK-3 1/4" PRO (83) - CONCRETE GREY (AS PER BONUS)
Bedroom #2	CARPET
Bedroom #3	CARPET
Bedroom #4	CARPET
Bedroom #5	CARPET
MEDIA LOFT	CARPET

Comment

7. Plumbing Fixtures

	Sink / Other	Faucet
Kitchen	SINK - KITCHEN - LONDON DOUBLE BOWL	STD
Powder Room	SINK - BATHROOM - OVAL UNDERMOUNT - BATHF	STD
Master Ensuite Bathroom	SINK - BATHROOM - OVAL UNDERMOUNT - BATHF	STD
ENSUITE 2	SINK - BATHROOM - OVAL UNDERMOUNT - BATHF	STD
SHARED ENSUITE 3	SINK - BATHROOM - OVAL UNDERMOUNT - BATHF	STD
ENSUITE 4	SINK - BATHROOM - OVAL UNDERMOUNT - BATHF	STD
LAINDRY	STD	STD

Waterline for Fridge ☒ Yes ☐ No

Comment

** Refer to Construction Summary

*** POT FILLER - ROUGH IN (CENTERED)

***SINK - KITCHEN - LONDON DOUBLE BOWL- KITCHEN

***SINK - BATHROOM - OVAL UNDERMOUNT - BATHROOMS (6XTOTAL)

***FAUCET - UP1-STO-72308 - KITCHEN

***RAIN SHOWER HEAD - S1003 fixture (Moen), 116651, At2199, 3372, T4171- MASTER ENSUITE SHOWER

***WATERLINE FOR FRIDGE



INTERIOR COLOUR SCHEME

Purchasers:

FURQAN ABBASSI & ALAA ABBASSI

Property: 184

Telephone Res. / Bus:

/

Project: Bradford Capital Holdings Inc.

Decor Advisor:

Inna Semikolenniha

Model and Elevation: The Castello 1 (S50-1) Elev A Lot 184

Lock Date:

10-Nov-20

30-Oct-20

Plan #:

51M-1063

8. Trim Carpentry

Interior Doors

STD

Front Door Glass Inserts

STD

Door Handles

STD

Interior Trim

STD

Comment

** Refer to Construction Summary

9. Electrical

Plugs and Switches

☒ White

STANDARD WHITE DECOR

Hood Fan

CHIMNEY HOOD FAN

Custom Fan Insert

Appliances

Built in Cooktop

Built in Oven

Gas Stove

Microwave

☐ Yes ☒ No

☒ Yes ☐ No

☒ Yes ☐ No

☒ Yes ☐ OTR ☐ No

Comment

** Refer to Construction Summary
***CHIMNEY HOOD FAN
***INCREASE KITCHEN EXHAUST TO 8 INCH

10. Railings and Pickets

Railing Type

UPGRADE 1 - WROUGHT IRON

Colour

STAIN COLOUR TO MATCH HARDWOOD

SpindleType

IRON

Colour

BLACK

Stringer / Riser

STAIN COLOUR TO MATCH HARDWOOD

Treads

STAIN COLOUR TO MATCH HARDWOOD

Comment

Oak Stairs

☒ Yes ☐ No

** Refer to Construction Summary
***STAIN STAIRCASE TO MATCH HARDWOOD- CONCRETE GREY



INTERIOR COLOUR SCHEME

Purchasers:

FURQAN ABBASSI & ALAA ABBASSI

Property: 184

Telephone Res. / Bus:

/

Project: Bradford Capital Holdings Inc.

Decor Advisor:

Inna Semikolenniha

Model and Elevation: The Castello 1 (S50-1) Elev A Lot 184

Lock Date:

10-Nov-20

30-Oct-20

Plan #: 51M-1063

11. Crown Mouldings

Entrance Vestibule	N/A		Kitchen/Breakfast	N/A	
Main Hall	N/A		Den/Library	N/A	
Living Room	N/A		Lower Landing	N/A	
Dining Room	N/A				
Family Room	N/A				

Comment

** Refer to Construction Summary

12. Wall Paint

Main Floor	COOL WHITE
Second Floor	COOL WHITE

Smooth Ceilings First Floor ☒ Yes ☐ No

Comment

** Refer to Construction Summary
***SMOOTH CEILINGS THROUGH OUT MAIN FLOOR

13. Fireplace

	Living Room			Family Room			Other Room - Specify		
	Purchased	As Per Plan	N/A	Purchased	As Per Plan	N/A	Purchased	As Per Plan	N/A
	<input type="radio"/>	<input type="radio"/>	<input checked="" type="radio"/>	<input type="radio"/>	<input checked="" type="radio"/>	<input type="radio"/>	<input type="radio"/>	<input type="radio"/>	<input checked="" type="radio"/>
Fireplace Type				STD					
Mantle Type				M2					
Colour / Stain				PAINTED WHITE					
Surround				BIANCO					
Hearth				NONE					

Comment

** Refer to Construction Summary

Initials:_____



INTERIOR COLOUR SCHEME

Purchasers:

FURQAN ABBASSI & ALAA ABBASSI

Property: 184

Telephone Res. / Bus: /

Project: Bradford Capital Holdings Inc.

Decor Advisor: Inna Semikolenniha

Model and Elevation: The Castello 1 (S50-1) Elev A Lot 184

Lock Date: 10-Nov-20

30-Oct-20

Plan #: 51M-1063

14. Heating and Air Conditioning

Air Conditioning	Gas Provisions Stove
Gas Provisions Dryer	Gas Provisions Barbecue
Comment	
<div><div>** Refer to Construction Summary</div><div>***INCREASE KITCHEN EXHAUST TO 8 INCH</div></div>	

15. General Comments

** Refer to Construction Summary

Disclaimers and Notes

Purchaser

Initials

1) Colours of all materials are as close as possible to builder's selection, but not necessarily identical due to variances in manufacturing.

2) Any extras listed above are null and void unless accompanied by a separate invoice/amendment. Said invoice must be paid in full.

3) The Purchaser acknowledges that after Interior Colour Selection form is signed and dated, a \$250 admin fee will be applicable for changes, deletions or alterations other than re-selection due to unavailability.

4) The Purchaser acknowledges reading and accepting the "Bayview Wellington Homes Decor Centre Disclaimers" form. This document contains other miscellaneous disclaimers.

This Interior Colour Selection is final and approved by:

Signature:_____

Date: _____

Signature:_____

Date: _____



INTERIOR COLOUR SCHEME

Purchasers:	FURQAN ABBASSI & ALAA ABBASSI	Property:	184
Telephone Res. / Bus:	/	Project:	Bradford Capital Holdings Inc.
Decor Advisor:	Inna Semikolenniha	Model and Elevation:	The Castello 1 (S50-1) Elev A Lot 184
Lock Date:	10-Nov-20	30-Oct-20	Plan #: 51M-1063

LOT 184
CASTELLO 1 (S50-1) ELEV - A

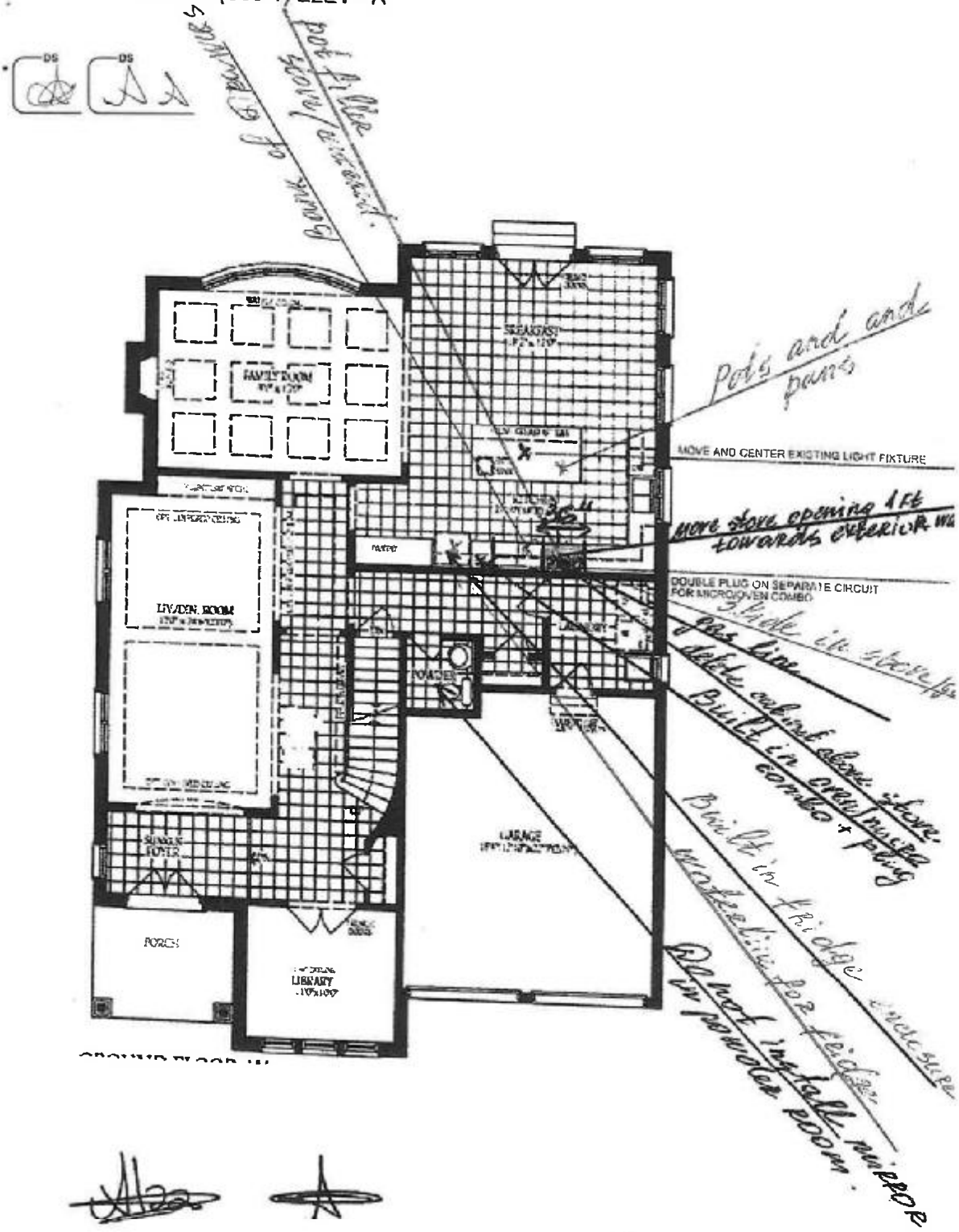

[Handwritten signatures and marks]

LOT 184
CASTELLO 1 (S50-1) ELEV - A



[Handwritten signature]