



PLANNING DEPARTMENT

COMPLIES WITH ZONING BY-LAW:

DATE REVIEWED:

REVIEWED BY: *Sarah O'Brien*

ENGINEERING REVIEW

ACCEPTED

ACCEPTED AS NOTED

REQUIRES RE-SUBMISSION

THIS PLAN HAS BEEN REVIEWED WITH RESPECT TO GENERAL CONFORMANCE WITH THE OVERALL LOT GRADING PLAN AND OUR APPROVAL OF THIS PLAN FOR NO OTHER REASON. WE ACCEPT NO RESPONSIBILITY FOR THE ACCURACY OF THE ELEVATIONS AND DIMENSIONS PROVIDED BY OTHERS.

September 3, 2020

DATE

REVIEWED BY

(TOWN OF BRADFORD WEST GWILLIMBURY USE ONLY)

BLOCK 159			
LOT NO.	LOT FRONTAGE (M)	LOT AREA (SM)	BUILDING HT (M)
1	9.98	328.52	8.28
2	6.00	200.92	8.57
3	6.00	200.61	8.66
4	6.00	200.31	8.66
5	6.00	200.00	8.58
6	6.00	199.67	8.45
7	6.00	198.91	8.45
8	14.22	360.81	8.35

TOWN OF BRADFORD WEST GWILLIMBURY - BUILDING DEPARTMENT

**REVIEWED**

INSPECTOR:

PERMIT NO.: PRBD202001073

DATE: Sept. 10, 2020

ALL CONSTRUCTION SHALL COMPLY WITH THE ONTARIO BUILDING CODE AND ALL OTHER APPLICABLE STATUTORY REGULATIONS. THE REVIEWED DOCUMENTS MUST BE KEPT ON SITE AT ALL TIMES.

INSPECTION REQUEST EMAIL: BUILDINGINSPECTIONS@TOWNOFBWG.COM  
INSPECTION REQUEST FAX: (905) 778-2035  
INSPECTION REQUEST TELEPHONE: (905) 778-2055 EXT. 1500

1hr FRR



It is the builder's complete responsibility to ensure that all plans submitted for approval fully comply with the Architectural Guidelines and all applicable regulations and requirements including zoning provisions and any provisions in the subdivision agreement. The Control Architect is not responsible in any way for examining or approving site (lotting) plans or working drawings with respect to any zoning or building code or permit matter or that any house can be properly built or located on its lot.

This is to certify that these plans comply with the applicable Architectural Design Guidelines approved by the Town of BRADFORD / WEST GWILLIMBURY.

JOHN G. WILLIAMS LTD., ARCHITECT  
ARCHITECTURAL CONTROL REVIEW  
AND APPROVAL

APPROVED BY:

DATE: Jun. 18, 2018

This stamp certifies compliance with the applicable Design Guidelines only and bears no further professional responsibility.

MUNICIPAL ADDRESS

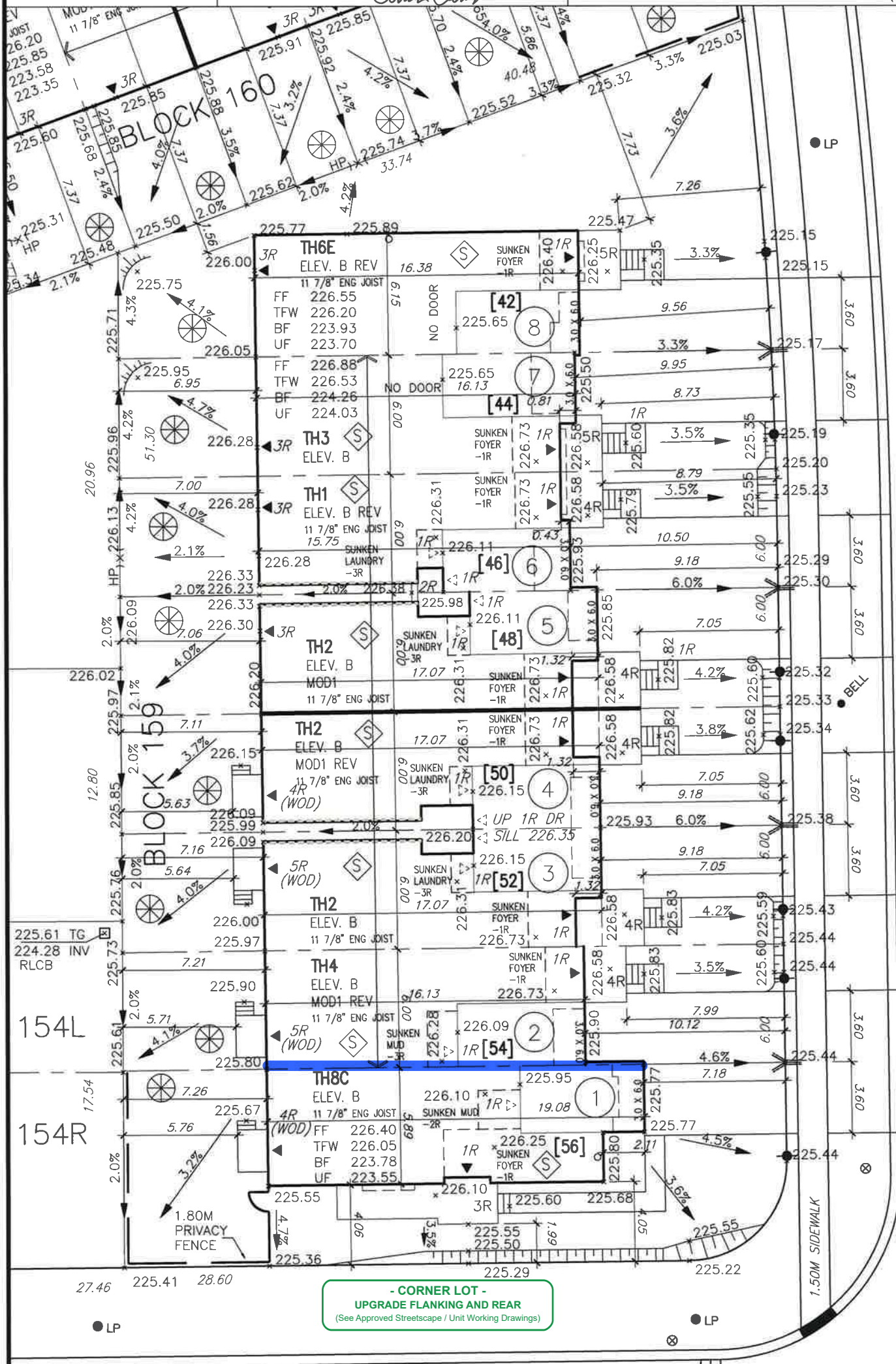

**- CORNER LOT -  
UPGRADE FLANKING AND REAR**  
(See Approved Streetscape / Unit Working Drawings)

## WESTLAKE CRESCENT

RICHARD - H:\ARCHIVE\WORKING\2016\16023.BW\Site plan\16023-SP.dwg - Wed - Jun 27 2018 - 1:31 PM file name project no. 13045

<ul style="list-style-type: none"> <li>PROPOSED VALVE</li> <li>LIGHT POLE</li> <li>WATER SERVICE</li> <li>DOUBLE STM./SAN. CONNECTION</li> <li>SINGLE STM./SAN. CONNECTION</li> <li>CATCH BASIN</li> <li>CABLE TELEVISION PEDESTAL</li> <li>BELL PEDESTAL</li> </ul>	<ul style="list-style-type: none"> <li>HYDRANT</li> <li>TRANSFORMER</li> </ul>	<ul style="list-style-type: none"> <li>STREET SIGN</li> <li>MAIL BOX</li> <li>RETAINING WALL</li> <li>CHAIN LINK FENCE (SEE LANDSCAPE PLAN)</li> <li>ACOUSTICAL FENCE (SEE LANDSCAPE PLAN)</li> <li>WOOD SCREEN FENCE (SEE LANDSCAPE PLAN)</li> <li>HYDRO SERVICE LATERAL</li> <li>HYDRO METER</li> <li>GAS METER</li> <li>EMBANKMENT</li> </ul>	<ul style="list-style-type: none"> <li>[XXXX] MUNICIPAL ADDRESS</li> <li>PROVIDE 3/4" DIA. CLEAR STONE IN THIS AREA</li> <li>THIS LOT CONTAINS ENGINEERED FILL</li> <li>AIR CONDITIONER REQUIRED</li> <li>RAIN WATER DOWNSPOUT LOCATION (DISCHARGE ONTO SPLASHPAD)</li> <li>SIDE WINDOW LOCATION</li> <li>OPT. DOOR LOCATION</li> <li>EXTERIOR DOOR LOCATION</li> <li>REDUCE SIDE YARD</li> </ul>
--	--	--	---

The undersigned has reviewed and takes responsibility for this design and has the qualifications and meets the requirements set out in the Ontario Building Code to be a Designer.

qualification information  
**Wellington Jno-Baptista** 25591  
name  
registration information  
**VA3 Design Inc.** 42658  
signature

Builder to verify location of all hydrants, street lights, transformers and other services. If minimum dimensions are not maintained, builder is to relocate at his own expense.  
Builder to verify service connection elevations prior to constructing foundations.

255 Consumers Rd Suite 120  
Toronto ON M2J 1R4  
t 416.630.2255 f 416.630.4782  
va3design.com

URBAN ECOSYSTEMS LTD. HAS REVIEWED THE PROPOSED GRADES AS SHOWN ON THIS PLAN AND HAS FOUND THEM TO BE IN GENERAL CONFORMANCE WITH THE APPROVED PLANS

LOT NO. **Block 159A**  
DATE **June 28, 2018**

DEVELOPER:  
**ARG GROUP**

BUILDER:  
**BAYVIEW WELLINGTON**

CONSULTANT:  
**URBAN ECO SYSTEMS- CIVIL ENG  
VA3 DESIGN- ARCHITECTURE**

MAX BUILDING HEIGHT: 13.0m	LOT AREA: VARIES m2	SAN INVERT: - m
BUILDING HEIGHT: -m	LOT FRONTAGE: - m	STM INVERT: - m
AVERAGE GRADE: 225.91m	LOT COVERAGE: N/A %	DESIGNED: - -
4		DRAWN: RC
3		SCALE: 1:250
2	ISSUED FOR PERMIT	JUNE 13-2018
1	ISSUED FOR REVIEW	NOV 06-2017
No.	Revision	Date
PLAN:		LOT NO: <b>159A</b>