

# GOEMANS APPLIANCES

## Appliance Specification Confirmation Sheet

Appliance specifications for:

Sales Rep: Judith

Store Location: Vaughan

Email:

Date: 7 July 2017

Pages including cover: 23 pages

ABDUL QATHAR &  
NAFISA QATHERI

Invoice:

HB00016294

Please find attached the most current specifications for the appliances purchased by our mutual customer.

We have included a copy of the customers packing slip with full model numbers. Please take a moment to check against the specification sheets to insure you have all the information you may require.

While we have provided the most current information available from the manufacture, the dimensions and information attached are for planning purposes only. As per the manufacturer specifications are subject to change without notice.

Please do not hesitate to call or e-mail the sales rep if you require further information not enclosed. We are always pleased to help.

We have advised the customer that it is their responsibility to communicate any changes to this order to their kitchen designer/builder as soon as possible to avoid errors in design or rough in.

Please sign below confirming both receipt of this package and that you have reviewed the information enclosed to ensure specifications match the attached packing slip.

Signature

Print

Date



# GOEMANS APPLIANCES

1-877-463-6267

HST # 105167993 WWW.GOEMANS.COM  
Find us on Facebook at www.facebook.com/GoemansAppliances

## PACKING SLIP

# HB00016394

Salesperson: JUDITH ORETA  
Purchase Date: 7/06/17  
Invoice Finished Date:  
Delivery/Pickup Date: Nov 03, 2017  
Invoice Type: VBL  
Date Printed: Jul 06, 2017  
Page: 1



### ONLINE BANKING ACCOUNT

**BILL TO:** 4169101904

ABDUL QAHAR &, NAFISA QAHERI  
95 WOODRIVER ST  
RICHMOND HILL, ON L4S 1J8

**SHIP TO:** 4169101904

ABDUL QAHAR &, NAFISA QAHERI  
95 WOODRIVER ST  
RICHMOND HILL, ON L4S 1J8

TEL# (416) 910-1904 BUS# (905) 737-5069

TEL# (416) 910-1904 BUS# (905) 737-5069

Directions: SDSSD

QTY	LOC	MODEL #	SERIAL #	COLOUR	BRAND - DESCRIPTION
1	①	JS48PPDUDE		PRO STAIN	JEN, RESB: REFRIGERATOR, SIDE-BY-SIDE, BU 48, ADVANCED INTEGRATED LCD ICE & WATER DISPENSER
		This special order product requires a 50% deposit & is considered FINAL SALE. x PLEASE ALLOW UP TO 4-12 WEEKS FOR DELIVERY OF THIS PIECE.			
-1		P-CJEN-1707-15PER			
1		P-CJEN-1707-750			
1	②	JGC3536GS		STAINLES	JEN, CTGD: COOKTOP, GAS, DROP-IN 36W, 5 BRASS BNRS (SEALED), 20K, UNDER-LITE PWR DLS
-1		P-CJEN-1707-15PER			
1	③	JMW3430DP		PROSTAIN	JEN, OVC: OVEN, COMBO 30, 5.0 CONVECT OVEN, 1.4 CONVECT MICRO, WIFI
-1		P-CJEN-1707-15PER			
1		P-CJEN-1707-500			
1	④	JDB9000CWP		PROSTYLE	JEN, DISIC: DISHWASHER, INTEGRATED, COLOUR STAINLESS STEEL TUB, FULLY INTEGRATED WITH PROSTYL
-1		P-CJEN-1707-15PER			
1	⑤	JXW8936DS		STAINLES	JEN, HOWC: HOOD, WALL MOUNT 36W, 600CFM, FLOATING GLASS, 3SPD+BOOST, PERIMETRIC
		This special order product requires a 50% deposit & is considered FINAL SALE. x PLEASE ALLOW UP TO 4-12 WEEKS FOR DELIVERY OF THIS PIECE.			
-1		P-CJEN-1707-15PER			
1	⑥	WM3770HVA		Graphite	LGE, WAFL: WASHER, FRONT LOAD, LARGE CAPA 5.2 CUFT, STEAM, HTR, 1200RPM, 12 WASH/10 OPT

- All products remain the property of Goemans until paid in full.
- Removal of old appliances at owner's risk and must be disconnected.
- Please refer to delivery/installation brochures for important details.
- All authorized returned products will be subject to a restocking charge.
- Interest of 18% per annum will be charged on overdue accounts.
- Upon delivery customer agrees to accept service in accordance with manufacturer's warranty.
- This sales invoice is based on delivery within 12 months from date of purchase. After 12 months (or if market conditions adversely change) Goemans reserves the right to review pricing/delivery on this order and offer our customers options to accommodate these changes. Any & all date sensitive supplier promotions are exempt from the 12 month price guarantee and must be taken by the promotional delivery deadline.

WHITE CUSTOMER COPY

PINK GOEMANS COPY



# GOEMANS APPLIANCES

1-877-463-6267

HST # 105167993 WWW.GOEMANS.COM  
Find us on Facebook at www.facebook.com/GoemansAppliances

## PACKING SLIP

# HB00016394

Salesperson: JUDITH ORETA  
Purchase Date: 7/06/17  
Invoice Finished Date:  
Delivery/Pickup Date: Nov 03, 2017  
Invoice Type: VBL  
Date Printed: Jul 06, 2017  
Page: 2



### ONLINE BANKING ACCOUNT

**BILL TO:** 4169101904

ABDUL QAHAR &, NAFISA QAHERI  
95 WOODRIVER ST  
RICHMOND HILL, ON L4S 1J8

**SHIP TO:** 4169101904

ABDUL QAHAR &, NAFISA QAHERI  
95 WOODRIVER ST  
RICHMOND HILL, ON L4S 1J8

TEL# (416) 910-1904 BUS# (905) 737-5069

TEL# (416) 910-1904 BUS# (905) 737-5069

Directions: SDSSD

QTY	LOC	MODEL #	SERIAL #	COLOUR	BRAND - DESCRIPTION
1		DRIVER BASIC LDry H/U DECLINED MUST PURCHASE OPTIONAL HOSES			
1	7	DLEX3570V		GRAPHITE	LGE, DREFL: DRYER, ELECTRIC - TO MATCH LAR 27W,7.3CUFT,STEAM,LED DISPLAY
1		DRIVER BASIC LDry H/U DECLINED			
1	8	WDP4V		GRAPHITE	LGE, ALAU: ACCESSORY, LAUNDRY 13.6 PEDESTAL,27W,POCKET HANDLE,FOR 3875 PAIR
1		DRIVER BASIC LDry H/U DECLINED			
		This special order or clearance product requires a 50% deposit & is considered FINAL SALE.			
1	9	x WDP4V		GRAPHITE	LGE, ALAU: ACCESSORY, LAUNDRY 13.6 PEDESTAL,27W,POCKET HANDLE,FOR 3875 PAIR
1		DRIVER BASIC LDry H/U DECLINED			
		This special order or clearance product requires a 50% deposit & is considered FINAL SALE.			
1		x P-DELIVERY \$20,000-29,999			
-1		SALES DELIVERY ALLOWANCE			
1		P-OOT DELIVERY FOR ZONE A			
-1		SALES DELIVERY ALLOWANCE			
		CUSTOMER DECLINED EXTENDED SERVICE PLAN X			
		+++++++OFFERED INSTALLATION+++++++			

- All products remain the property of Goemans until paid in full.
- Removal of old appliances at owner's risk and must be disconnected.
- Please refer to delivery/installation brochures for important details.
- All authorized returned products will be subject to a restocking charge.
- Interest of 18% per annum will be charged on overdue accounts.
- Upon delivery customer agrees to accept service in accordance with manufacturer's warranty.
- This sales invoice is based on delivery within 12 months from date of purchase. After 12 months (or if market conditions adversely change) Goemans reserves the right to review pricing/delivery on this order and offer our customers options to accommodate these changes. Any & all date sensitive supplier promotions are exempt from the 12 month price guarantee and must be taken by the promotional delivery deadline.

WHITE CUSTOMER COPY

PINK GOEMANS COPY

## 48" SIDE-BY-SIDE REFRIGERATORS WITH ICE &amp; WATER DISPENSER

JS48PPDUDE – 48 $\frac{3}{8}$ " x 83 $\frac{3}{8}$ " x 27 $\frac{3}{4}$ " (with handles)JS48SSDUDE – 48 $\frac{3}{8}$ " x 83 $\frac{3}{8}$ " x 27 $\frac{1}{8}$ " (with handles)

## PRODUCT DIMENSIONS

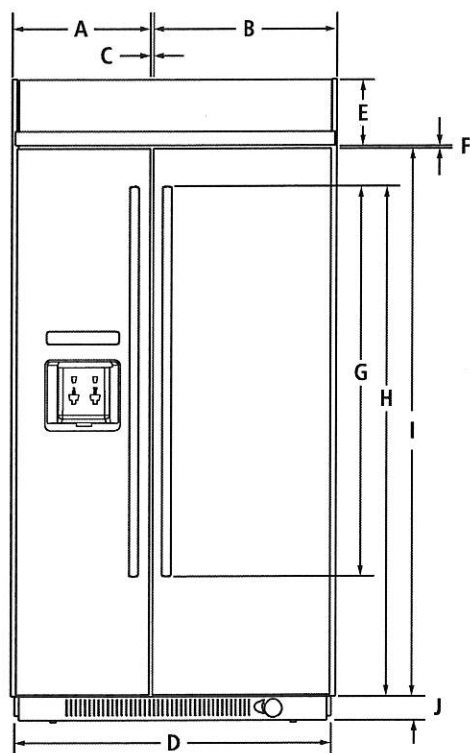

FRONT VIEW

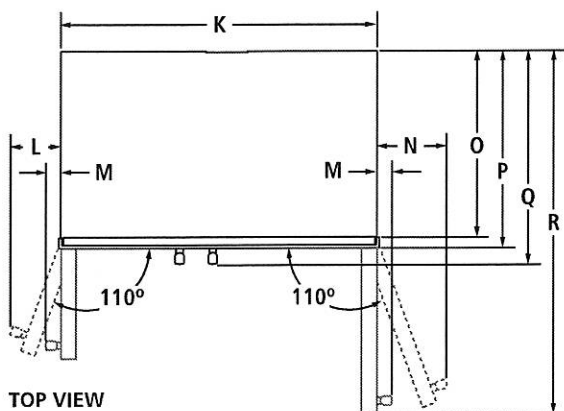

TOP VIEW

MODEL #		JS48PPDUDE JS48SSDUDE	
		in	cm
A	Width of freezer door (including hinge side offset)	20	50.8
B	Width of refrigerator door (including hinge side offset)	27	68.6
C	Space between doors	$\frac{3}{8}$	1.0
D	Overall width (Including side trim)	48 $\frac{3}{8}$	122.9
E	Height of top grille	8 $\frac{5}{8}$	21.7
F	Space between doors and top grille	$\frac{3}{8}$	1.0
G	Height of handles		
	Pro-Style® Stainless	45 $\frac{9}{16}$	115.7
	Euro Style Stainless	50	127.1
H	Height to top of handles		
	Pro-Style® Stainless	63 $\frac{11}{16}$	163.5
	Euro Style Stainless	65 $\frac{3}{4}$	167.0
I	Height of doors	71	180.2
J	Height of bottom grille	3	7.6
K	Width of recessed refrigerator	47	119.4
L	Width from side of refrigerator to freezer handle – door fully open 110°		
	Pro-Style® Stainless	8 $\frac{3}{8}$	21.3
	Euro Style Stainless	8	20.3
M	Width from side of refrigerator to handle – door open 90°		
	Pro-Style® Stainless	2 $\frac{5}{8}$	6.7
	Euro Style Stainless	2	5.1
N	Width from side of refrigerator to refrigerator handle – door fully open 110°		
	Pro-Style® Stainless	10 $\frac{7}{8}$	27.6
	Euro Style Stainless	10 $\frac{1}{4}$	26.1
O	Depth without doors	22 $\frac{1}{8}$	56.2
P	Depth with doors	25 $\frac{1}{8}$	63.8
Q	Depth with handles		
	Pro-Style® Stainless	27 $\frac{3}{4}$	70.5
	Euro Style Stainless	27 $\frac{1}{8}$	68.8
R	Depth with refrigerator door open 90°	50 $\frac{13}{16}$	129.0

**IMPORTANT:** Dimensional specifications are provided for planning purposes only.**Do not make any cutouts based on this information.** Refer to the Installation or Use & Care Guide before selecting cabinetry, verifying electrical/gas connections, making cutouts or beginning installation.

All Jenn-Air® appliances are appropriately UL, CUL or CSA approved.

①

## 48" SIDE-BY-SIDE REFRIGERATORS WITH ICE &amp; WATER DISPENSER

JS48PPDUDE – 48 $\frac{3}{8}$ " x 83 $\frac{3}{8}$ " x 27 $\frac{3}{4}$ " (with handles)JS48SSDUDE – 48 $\frac{3}{8}$ " x 83 $\frac{3}{8}$ " x 27 $\frac{1}{8}$ " (with handles)

## DIMENSIONS AS INSTALLED

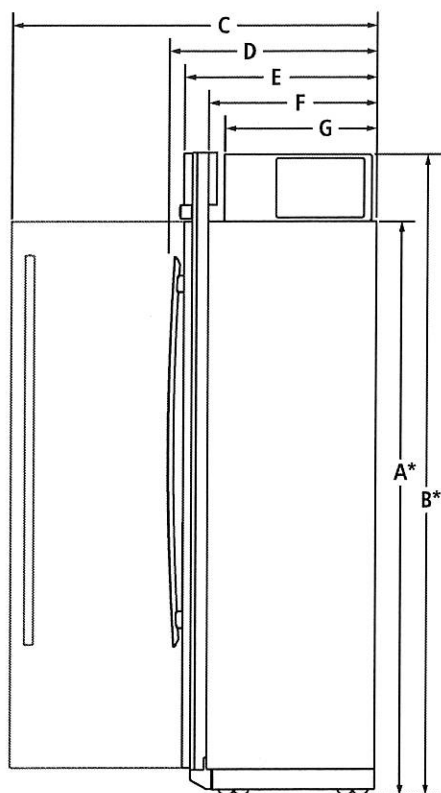

SIDE VIEW

MODEL #	JS48PPDUDE JS48SSDUDE	
	in	cm
A*	Height without compressor (min.)	74 $\frac{3}{8}$ 188.9
B*	Height of recessed refrigerator (min.)	83 $\frac{3}{8}$ 211.8
C	Depth with refrigerator door open 90° (min.)	51 $\frac{1}{8}$ 129.7
D	Depth with handles (min.)	
	Pro-Style® Stainless	27 $\frac{3}{4}$ 70.5
	Euro Style Stainless	27 $\frac{1}{8}$ 68.8
E	Depth with doors (min.)	25 $\frac{1}{8}$ 63.8
F	Depth without doors (min.)	22 $\frac{1}{8}$ 56.2
G	Depth of compressor (min.)	19 $\frac{5}{8}$ 49.8

\*Add 1 $\frac{1}{4}$ " (3.2 cm) to the height dimension when leveling legs are fully extended.**IMPORTANT:** Dimensional specifications are provided for planning purposes only.

Do not make any cutouts based on this information. Refer to the Installation or Use &amp; Care Guide before selecting cabinetry, verifying electrical/gas connections, making cutouts or beginning installation.

All Jenn-Air® appliances are appropriately UL, CUL or CSA approved.



8116AdZw915

## 48" SIDE-BY-SIDE REFRIGERATORS WITH ICE &amp; WATER DISPENSER

JS48PPDUDE – 48 $\frac{3}{8}$ " x 83 $\frac{3}{8}$ " x 27 $\frac{3}{4}$ " (with handles)JS48SSDUDE – 48 $\frac{3}{8}$ " x 83 $\frac{3}{8}$ " x 27 $\frac{1}{8}$ " (with handles)

## OPENING/CLEARANCE DIMENSIONS

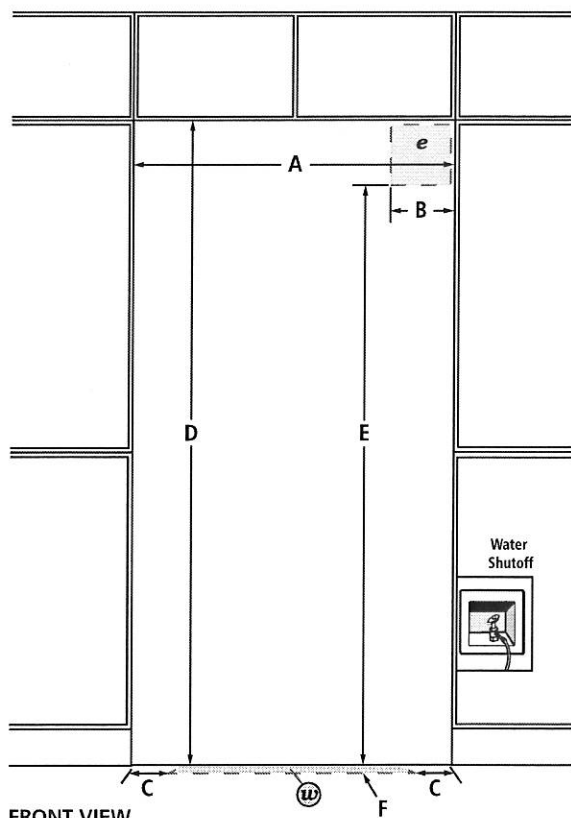

FRONT VIEW

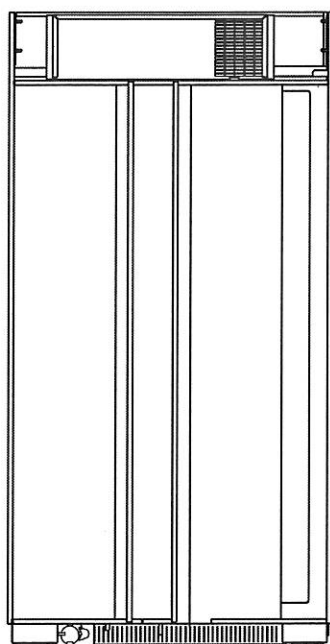

BACK VIEW

MODEL #	JS48PPDUDE JS48SSDUDE	
	in	cm
<b>A</b> Width (min.)	47 $\frac{1}{2}$	120.7
<b>B</b> Width of recommended electrical location	13 $\frac{1}{2}$	34.3
<b>C</b> Distance from side of cabinet to recommended water connection location	6	15.2
<b>D</b> Height (min.)	84	213.4
<b>E</b> Height to recommended electrical location	77	195.6
<b>F</b> Depth of recommended water connection location (max.)	1	2.5
<b>e</b> Recommended electrical connection location		
<b>w</b> Recommended water connection location		

## ELECTRICAL REQUIREMENTS

115 volt, 60 Hz, AC only, 15- or 20-amp fused, grounded circuit is required. A dedicated circuit is recommended. Use an outlet that cannot be turned off by a switch.

Minimum length of power cord is 84" (213.4 cm). Do not use an extension cord.

## WATER PRESSURE REQUIREMENTS

A cold water supply with water pressure between 30 and 120 psi (207 and 827 kPa) is required to operate the water dispenser and ice maker. Call a licensed, qualified plumber with any questions about the water pressure.

## Reverse Osmosis Water Supply

**IMPORTANT:** The pressure of the water coming out of a reverse osmosis system going to the water inlet valve of the refrigerator needs to be between 30 and 120 psi (207 and 827 kPa).

If a reverse osmosis water filtration system is connected to the cold water supply, the water pressure to the reverse osmosis system needs to be a minimum of 40 to 60 psi (276 to 414 kPa).

## LOCATION REQUIREMENTS

Floor must be able to support refrigerator (more than 600 lb [272 kg]) and contents of the refrigerator and must be at the same level as flooring in the room.

**IMPORTANT:** Dimensional specifications are provided for planning purposes only.

**Do not make any cutouts based on this information.** Refer to the Installation or Use & Care Guide before selecting cabinetry, verifying electrical/gas connections, making cutouts or beginning installation.

All Jenn-Air® appliances are appropriately UL, CUL or CSA approved.

# JENN-AIR® DETAILED PLANNING DIMENSIONS

1 of 2

2

## 36" GAS COOKTOP

JGC3536G – 36" x 4<sup>3</sup>/<sub>16</sub>" x 21"

### PRODUCT DIMENSIONS

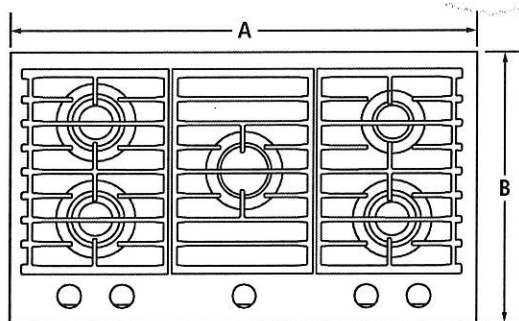

TOP VIEW

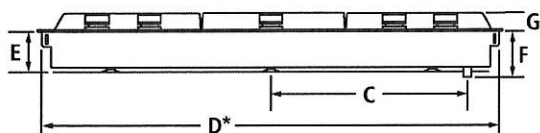

FRONT VIEW

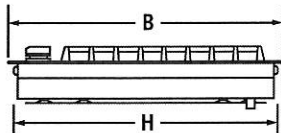

SIDE VIEW

MODEL #		JGC3536G	
		in	cm
A	Overall width	36	91.4
B	Overall depth	21	53.3
C	Center of cooktop to center of gas inlet	14 <sup>13</sup> / <sub>32</sub>	36.6
D*	Width of cooktop base	35 <sup>5</sup> / <sub>16</sub>	74.5
E	Height of cooktop base	3 <sup>3</sup> / <sub>16</sub>	8.1
F	Height from gas inlet to underside of cooktop	4 <sup>3</sup> / <sub>16</sub>	10.6
G	Height of cooktop with grates	1 <sup>1</sup> / <sub>4</sub>	3.1
H	Depth of cooktop base	20 <sup>5</sup> / <sub>16</sub>	51.6

\*Measured from tab to tab. Tabs should not be bent during installation.

**IMPORTANT:** Dimensional specifications are provided for planning purposes only.

**Do not make any cutouts based on this information.** Refer to the Installation Guide *before* selecting cabinetry, verifying electrical/gas connections, making cutouts or beginning installation.

All Jenn-Air® appliances are appropriately UL, CUL or CSA approved.

**JENN-AIR®**

8993dZw217



2

## 36" GAS COOKTOP

JGC3536G – 36" x 4 $\frac{3}{16}$ " x 21"

## OPENING/CLEARANCE DIMENSIONS

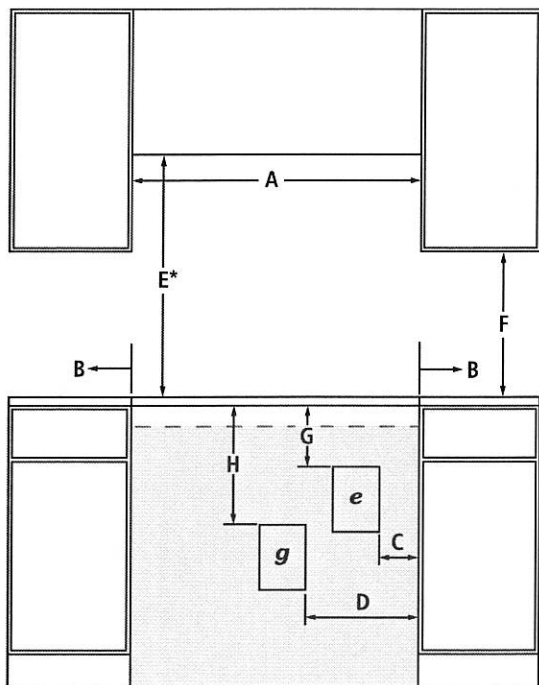

FRONT VIEW

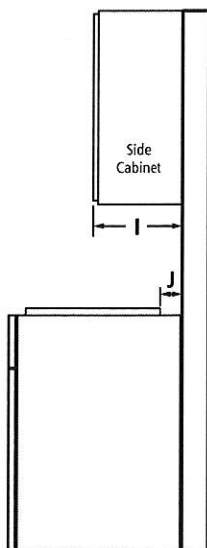

SIDE VIEW

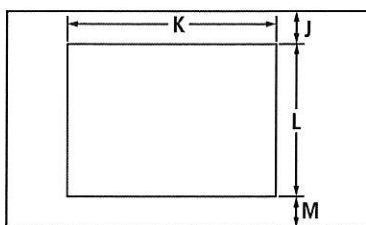

TOP VIEW – CUTOUT

MODEL #		JGC3536G	
		in	cm
A	Width of combustable area above cooking surface (min.)	36	91.4
B	Width from cooktop to fixed wall or other combustable material (min.)	6	15.2
C	Width to outer edge of electrical outlet (recommended)	9	22.9
D	Width to gas supply line location (recommended)	12	30.5
E*	Height to bottom of uncovered wood or metal cabinet above cooking surface (min.)	30	76.2
F	Height to bottom of uncovered wood or metal cabinet (min.)	18	45.7
G	Height to top edge of electrical outlet (recommended)	9	22.9
H	Height to gas supply line location (recommended)	18	45.7
I	Depth of upper cabinet (recommended)	13	33.0
J	Depth from cutout to wall (min.)	2 $\frac{5}{16}$	5.9
K	Width of cutout	35 $\frac{3}{8}$	89.9
L	Depth of cutout	20 $\frac{3}{8}$	51.8
M	Depth from cutout to front of countertop	2 $\frac{5}{16}$	5.9
e	Recommended electrical access location		
g	Recommended gas supply line location		

\*Dimension can be reduced by 6" (15.2 cm) when bottom of wood or metal cabinet is covered by not less than  $\frac{1}{4}$ " (0.6 cm) flame retardant millboard covered with not less than No. 28 MSG sheet metal, 0.015" (0.4 mm) stainless steel, 0.024" (0.6 mm) aluminum or 0.020" (0.5 mm) copper. If installing a hood or microwave hood combination above the cooktop, follow the hood or microwave hood combination instructions for dimensional clearances above the cooking surface.

## GAS REQUIREMENTS

## Natural Gas

This cooktop is factory-set for use with natural gas.

## LP Gas Conversion

Conversion must be done by a qualified service technician. To convert to LP gas, use an LP gas conversion kit.

## ELECTRICAL REQUIREMENTS

120 volt, 60 Hz, AC only, 15-amp fused, electrical circuit is required. A time-delay fuse or dedicated circuit is recommended.

## LOCATION REQUIREMENTS

- To ensure cooktop base clearance, cabinet side walls need to be wider than the cutout.
- If cabinet has a drawer, allow a 4" (10.2 cm) minimum clearance between countertop and top of drawer. Drawer depth may need to be shortened to avoid interfering with the regulator.

**IMPORTANT:** Dimensional specifications are provided for planning purposes only.

**Do not make any cutouts based on this information.** Refer to the Installation Guide *before* selecting cabinetry, verifying electrical/gas connections, making cutouts or beginning installation.

All Jenn-Air® appliances are appropriately UL, CUL or CSA approved.

**JENN-AIR®**

8993dZw217



## 30" COMBINATION MICROWAVE/WALL OVENS

JMW3430D, JMW2430D – 30" x 43¾" x 25⅝"

## PRODUCT DIMENSIONS

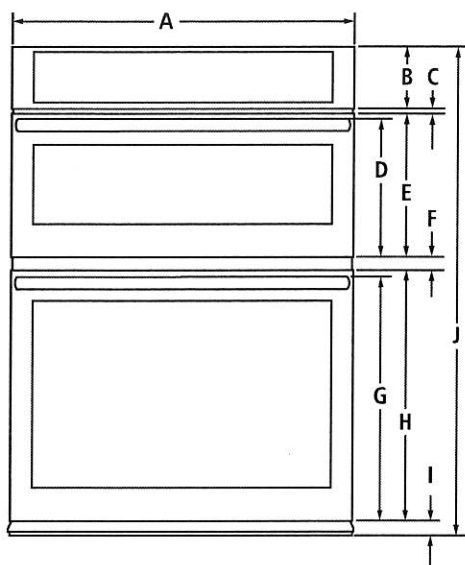

FRONT VIEW

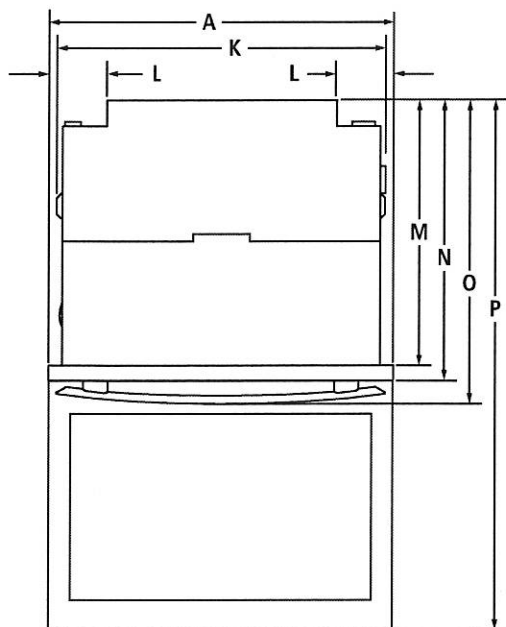

TOP VIEW

MODEL #		JMW3430D JMW2430D	
		in	cm
A	Overall width		
	Pro-Style® Stainless or Euro-Style Stainless	30	76.2
	Floating Glass	29⅛	76.1
B	Height of control panel	5½	14
C	Space between control panel and door	½	1.2
D	Height to top of microwave oven handle		
	Pro-Style® Stainless	12¾	31.0
	Euro-Style (color-coordinating)	12¾	31.0
E	Height of microwave oven door	12⅞	32.3
F	Space between doors	1⅞	2.9
G	Height to top of oven handle		
	Pro-Style® Stainless	21⅝	55.0
	Euro-Style (color-coordinating)	21⅞	54.4
H	Height of oven door	22⅞	56.2
I	Height of trim	1⅞	4.3
J	Overall height	43¾	111.1
K	Width of recessed oven	28⅞	72.2
L	Width of conduit channel	4⅝	12.5
M	Depth of recessed oven	23¼	59.0
N	Depth with doors	24⅝	61.9
O	Depth with handles		
	Pro-Style® Stainless	26⅝	67.0
	Euro-Style (color-coordinating)	25⅞	64.3
P	Depth with door fully open	45⅝	115.3

**IMPORTANT:** Dimensional specifications are provided for planning purposes only.**Do not make any cutouts based on this information.** Refer to the Installation Guide *before* selecting cabinetry, verifying electrical/gas connections, making cutouts or beginning installation.

All Jenn-Air® appliances are appropriately UL, CUL or CSA approved.

## 30" COMBINATION MICROWAVE/WALL OVENS

JMW3430D, JMW2430D – 30" x 43<sup>3</sup>/<sub>4</sub>" x 25<sup>5</sup>/<sub>16</sub>"

## DIMENSIONS AS INSTALLED

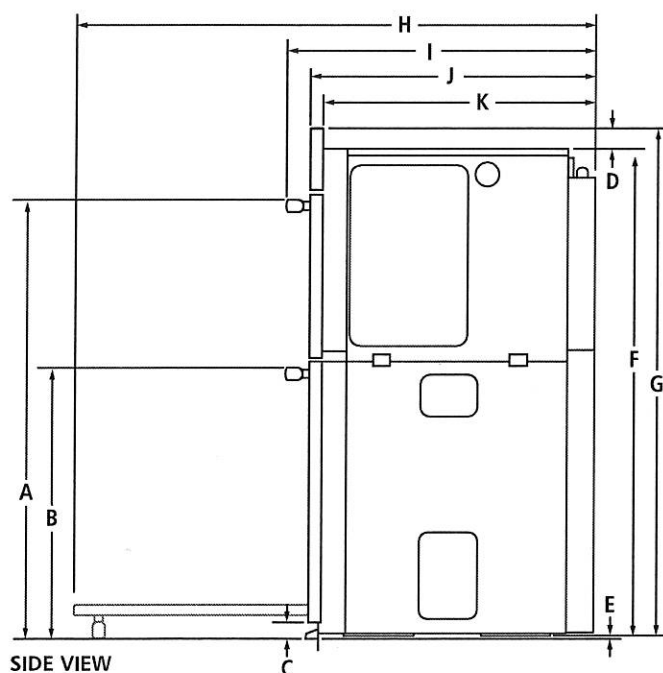

MODEL #		JMW3430D JMW2430D	
		in	cm
A	Height to top of upper handle Pro-Style® Stainless	36 <sup>1</sup> / <sub>2</sub>	92.7
	Euro-Style (color-coordinating)	36 <sup>1</sup> / <sub>2</sub>	92.7
B	Height to top of lower handle Pro-Style® Stainless	23 <sup>3</sup> / <sub>8</sub>	59.3
	Euro-Style (color-coordinating)	23 <sup>3</sup> / <sub>8</sub>	58.7
C	Height of trim extending below cutout	1 <sup>1</sup> / <sub>16</sub>	4.3
D	Height from top of recessed oven to top of control panel JMW3430D	2 <sup>1</sup> / <sub>2</sub>	6.3
	JMW2430D	2 <sup>15</sup> / <sub>16</sub>	7.4
E	Height from bottom of recessed oven foot to bottom of oven vent	<sup>3</sup> / <sub>16</sub>	0.5
F	Height of recessed oven	41	104.2
G	Height to top of control panel	43 <sup>3</sup> / <sub>4</sub>	111.1
H	Depth with door fully open	45 <sup>3</sup> / <sub>8</sub>	115.3
I	Depth with handles Pro-Style® Stainless	26 <sup>3</sup> / <sub>8</sub>	67.0
	Euro-Style (color-coordinating)	25 <sup>5</sup> / <sub>16</sub>	64.3
J	Depth with doors	24 <sup>3</sup> / <sub>8</sub>	61.9
K	Depth of recessed oven	23 <sup>1</sup> / <sub>4</sub>	59.0

**IMPORTANT:** Dimensional specifications are provided for planning purposes only.  
**Do not make any cutouts based on this information.** Refer to the Installation Guide *before*  
 selecting cabinetry, verifying electrical/gas connections, making cutouts or beginning installation.  
 All Jenn-Air® appliances are appropriately UL, CUL or CSA approved.

3

## 30" COMBINATION MICROWAVE/WALL OVENS

JMW3430D, JMW2430D – 30" x 43 $\frac{3}{4}$ " x 25 $\frac{5}{16}$ "

## OPENING/CLEARANCE DIMENSIONS

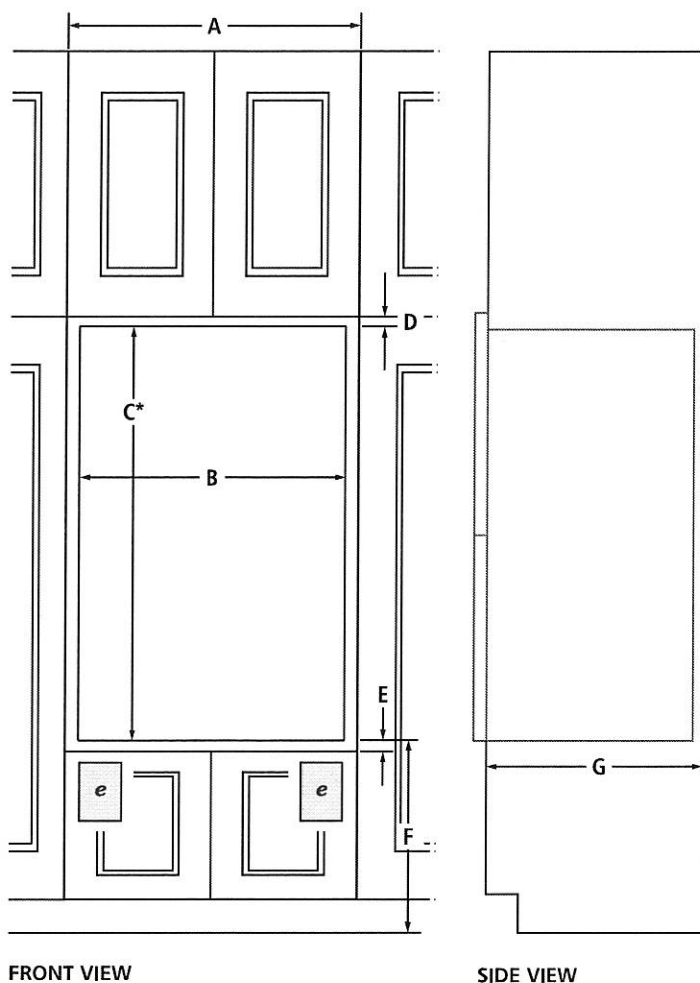

FRONT VIEW

SIDE VIEW

MODEL #	JMW3430D JMW2430D	
	in	cm
<b>A</b>	Width of cabinet (min.)	30 76.2
<b>B</b>	Width of cutout	28 $\frac{1}{2}$ 72.4
<b>C*</b>	Height of cutout (recommended)	41 $\frac{5}{16}$ 104.9
<b>D</b>	Top of cutout to bottom of upper cabinet door (min.)	2 $\frac{1}{4}$ 5.7
<b>E</b>	Bottom of cutout to top of lower cabinet door (min.)	1 $\frac{1}{2}$ 3.8
<b>F</b>	Bottom of cutout to floor	4-19 $\frac{1}{4}$ 10.2-48.9
<b>G</b>	Depth of cutout (min.)	24 61.0
<b>e</b>	Recommended junction box location	

\* Will fit cutout height from 41" (104.1 cm) to 41 $\frac{1}{2}$ " (105.4 cm).

## ELECTRICAL REQUIREMENTS

240 volt, 40-amp fused, grounded circuit is required. A dedicated circuit is required.

The length of conduit provided is for serviceability. Do not cut the conduit. The junction box should be located 3" (7.6 cm) maximum below the support surface. Drill a 1" (2.5 cm) minimum diameter hole in the right rear or left rear corner of the support surface for access to the junction box.

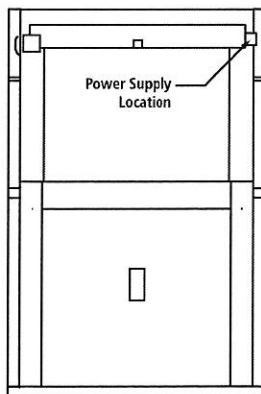

BACK VIEW

**IMPORTANT:** Dimensional specifications are provided for planning purposes only.

**Do not make any cutouts based on this information.** Refer to the Installation Guide *before* selecting cabinetry, verifying electrical/gas connections, making cutouts or beginning installation.

All Jenn-Air® appliances are appropriately UL, CUL or CSA approved.

**JENN-AIR®**

8610AdZw915



## 30" COMBINATION MICROWAVE/WALL OVENS – FLUSH INSTALLATION

JMW3430D, JMW2430D – 30" x 43¾" x 24¾" (depth without handles)

## OPENING/CLEARANCE DIMENSIONS

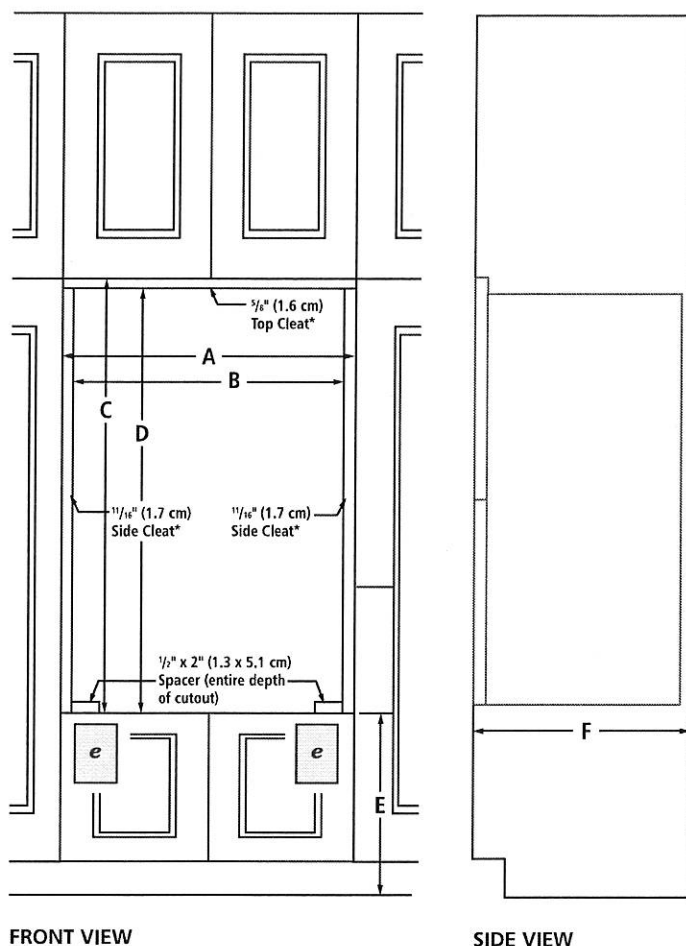

FRONT VIEW

SIDE VIEW

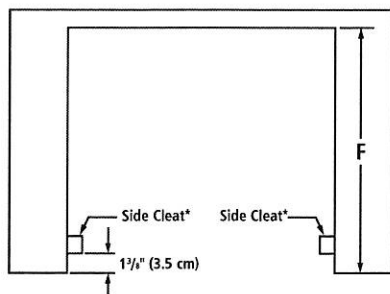

TOP VIEW

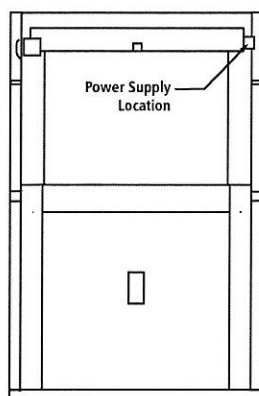

BACK VIEW

\* Cleats and spacers must be recessed 1 3/8" (3.5 cm) from the front of the cabinet.

MODEL #		JMW3430D JMW2430D	
		in	cm
A	Width of flush inset cutout (min.)	30 1/4	76.8
B	Width of opening (min.)	28 7/8	73.3
C	Height of flush inset cutout (min.)	44 5/16	112.5
D	Height of opening (min.)	43 11/16	110.9
E	Bottom of cutout to floor	4 5/8- 19 1/4	11.7- 48.9
F	Depth of cutout (min.)	25	63.5
e	Recommended junction box location		

## ELECTRICAL REQUIREMENTS

240 volt, 40-amp fused, grounded circuit is required. A dedicated circuit is required.

The length of conduit provided is for serviceability. Do not cut the conduit. The junction box should be located 3" (7.6 cm) maximum below the support surface. Drill a 1" (2.5 cm) minimum diameter hole in the right rear or left rear corner of the support surface for access to the junction box.

## FLUSH INSTALLATION REQUIREMENTS

A 25" (63.5 cm) minimum cutout depth is required.

These dimensions will result in a 1/4" (0.6 cm) reveal on the top, a 1/4" (0.6 cm) reveal on the sides and a 1/8" (0.3 cm) reveal on the bottom of the wall oven.

The front face of the cleats and spacers will be visible and should be treated as a finished surface.

**IMPORTANT:** Dimensional specifications are provided for planning purposes only. Do not make any cutouts based on this information. Refer to the Installation Guide before selecting cabinetry, verifying electrical/gas connections, making cutouts or beginning installation. All Jenn-Air® appliances are appropriately UL, CUL or CSA approved.

## DISHWASHERS

JDB9800CW, JDB9200CW, JDB9000CW – 23¾" x 33⅞" x 26⅞" (including handle)

## PRODUCT DIMENSIONS

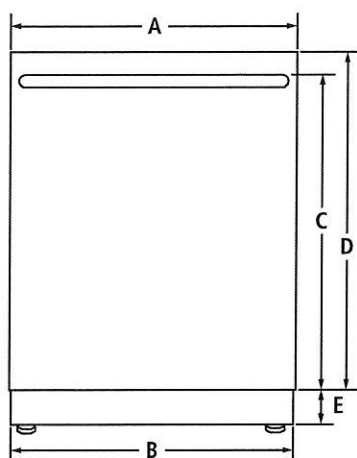

FRONT VIEW

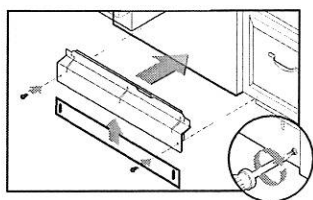

ADJUSTABLE TOE KICK

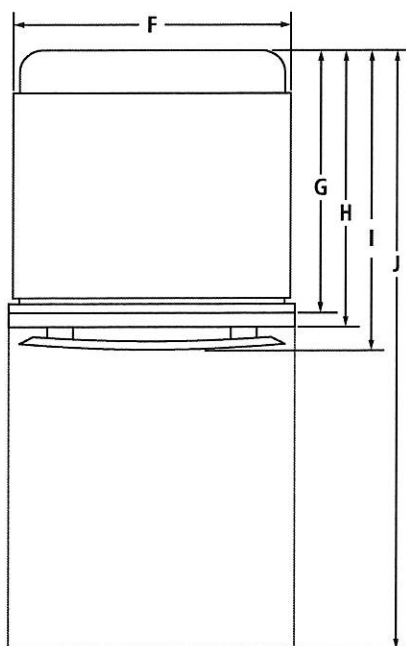

TOP VIEW

MODEL #		JDB9800CW JDB9200CW JDB9000CW	
		in	cm
<b>A</b>	Width of door	23½	59.7
<b>B</b>	Width of toe kick	23½	59.7
<b>C</b>	Height to top of handle Pro-Style® Stainless	27⅞	70.8
	Euro-Style (color-coordinating)	27⅞	70.8
	Floating Glass	27⅞	70.8
<b>D</b>	Height of door Pro-Style® Stainless	30	76.3
	Euro-Style (color-coordinating)	30	76.3
	Floating Glass	30	76.3
<b>E</b>	Height of adjustable toe kick (min.-max.)	3½- 4⅞	8.9- 10.5
<b>F</b>	Width of recessed dishwasher	23¾	60.4
<b>G</b>	Depth with tub flange	22⅝	57.4
<b>H</b>	Depth with door Pro-Style® Stainless	24⅝	62.6
	Euro-Style (color-coordinating)	24⅝	62.6
	Floating Glass	25	63.5
<b>I</b>	Depth with handle Pro-Style® Stainless	27⅞	70.8
	Euro-Style (color-coordinating)	26⅞	68.3
	Floating Glass	27⅞	70.8
<b>J</b>	Depth with door fully open	49¾	126.3

**IMPORTANT:** Dimensional specifications are provided for planning purposes only.**Do not make any cutouts based on this information.** Refer to the Installation or Use & Care Guide before selecting cabinetry, verifying electrical/gas connections, making cutouts or beginning installation.

All Jenn-Air® appliances are appropriately UL, CUL or CSA approved.

## DISHWASHERS

JDB9800CW, JDB9200CW, JDB9000CW – 23¾" x 33⅞" x 26⅞" (including handle)

## DIMENSIONS AS INSTALLED

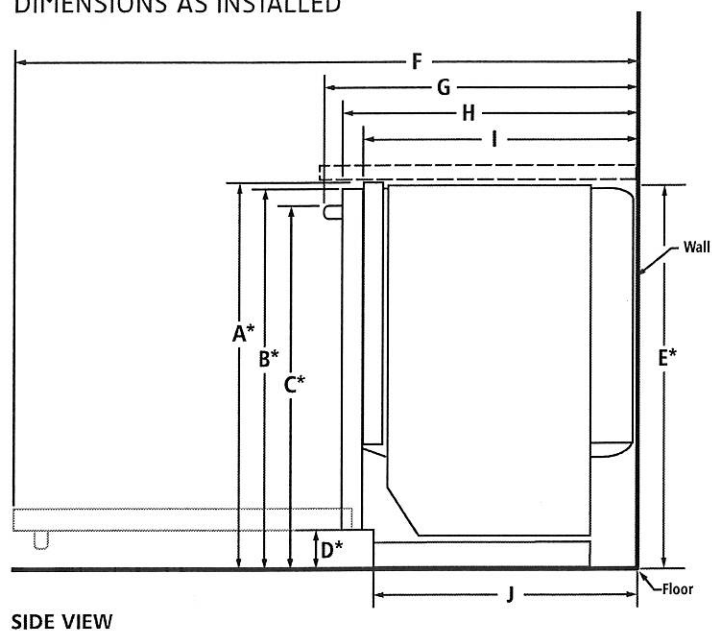

MODEL #		JDB9800CW JDB9200CW JDB9000CW	
		in	cm
<b>A*</b>	Height to top of tub flange (min.)	33⅞	86.0
<b>B*</b>	Height to top of door (min.)	33¾	85.7
<b>C*</b>	Height to top of handle (min.) Pro-Style® Stainless	31½	80.1
	Euro-Style (color-coordinating)	31½	80.1
	Floating Glass	31½	80.1
<b>D*</b>	Height to bottom of door	3⅝	9.4
<b>E*</b>	Height of recessed dishwasher (min.)	33⅝	85.5
<b>F</b>	Depth with door fully open (min.)	49¾	126.3
	Depth with handle (min.) Pro-Style® Stainless	27⅞	70.8
	Euro-Style (color-coordinating)	26⅞	68.3
<b>G</b>	Floating Glass	27⅞	70.8
<b>H</b>	Depth with door (min.)	24⅝	62.6
<b>I</b>	Depth with tub flange (min.)	22⅝	57.4
<b>J</b>	Depth with toe kick (min.)	20⅞	52.9

\*With wheels removed. Add up to ⅝" (1.6 cm) to height with wheels and leg levelers fully extended.

**IMPORTANT:** Dimensional specifications are provided for planning purposes only.

**Do not make any cutouts based on this information.** Refer to the Installation or Use & Care Guide before selecting cabinetry, verifying electrical/gas connections, making cutouts or beginning installation.

All Jenn-Air® appliances are appropriately UL, CUL or CSA approved.



## DISHWASHERS

JDB9800CW, JDB9200CW, JDB9000CW – 23 $\frac{3}{4}$ " x 33 $\frac{7}{8}$ " x 26 $\frac{7}{8}$ " (including handle)

## OPENING/CLEARANCE DIMENSIONS

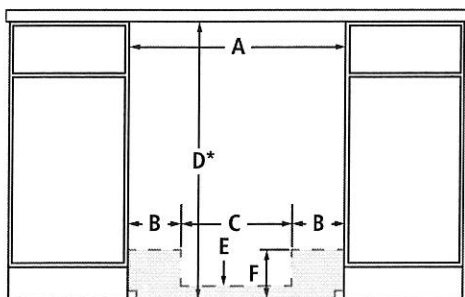

FRONT VIEW

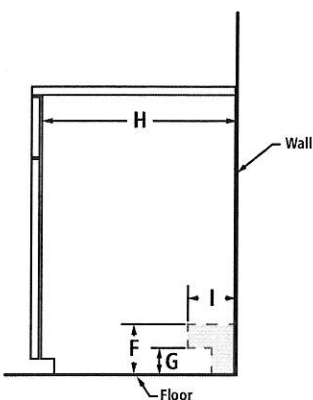

SIDE VIEW

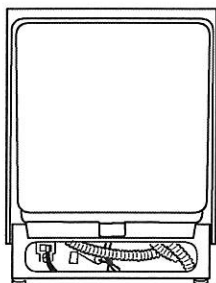

BACK VIEW

MODEL #		JDB9800CW JDB9200CW JDB9000CW	
		in	cm
A	Width (min.)	24	61.0
B	Width of possible utility installation area (back wall)	6 $\frac{3}{4}$	17.2
C	Width of clear area (back wall)	10 $\frac{1}{2}$	26.7
D*	Height with wheels removed (min.)	33 $\frac{7}{8}$	86.0
E	Height of possible utility installation area (back wall)	2 $\frac{1}{2}$	6.4
F	Height of possible utility installation area (back/side wall)	6 $\frac{1}{4}$	15.9
G	Height of clear area (side wall)	3	7.6
H	Depth (min.)	24	61.0
I	Depth of utility location (side wall)	4	10.2

**Electrical, water and drain connections may be installed in shaded areas**

Recommended drain connection location – closest to sink	1 $\frac{1}{2}$ dia. 3.8 dia.
Recommended electrical connection location – right-hand side or back wall	1 $\frac{1}{2}$ dia. 3.8 dia.
Recommended water connection location – left-hand side or back wall	$\frac{1}{2}$ dia. 1.3 dia.

\*Measured from the lowest point on the underside of countertop.

**ELECTRICAL REQUIREMENTS**

120 volt, 60 Hz, AC only, 15- or 20-amp fused, grounded circuit is required. A dedicated circuit is recommended. Use an outlet that cannot be turned off by a switch. Do not use an extension cord.

**WATER SUPPLY REQUIREMENTS**

120°F (49°C) hot water supply with water pressure between 20 and 120 psi (138 and 862 kPa) is required. If you have questions about your water pressure, call a licensed, qualified plumber.

**DRAIN REQUIREMENTS**

Connect drain hose to waste tee or disposer inlet above drain trap. Maximum drain hose length 12' (3.7 m).

**LOCATION REQUIREMENTS**

Corner locations require a 2" (5.1 cm) minimum clearance between the side of the dishwasher door and the wall or cabinet.

**IMPORTANT:** Dimensional specifications are provided for planning purposes only.

**Do not make any cutouts based on this information.** Refer to the Installation or Use & Care Guide before selecting cabinetry, verifying electrical/gas connections, making cutouts or beginning installation.

All Jenn-Air® appliances are appropriately UL, CUL or CSA approved.



## 36" LOW PROFILE WALL-MOUNT PERIMETRIC CANOPY HOOD

JXW8936DS – 36" x 33 $\frac{1}{8}$ "-54 $\frac{3}{4}$ " x 21 $\frac{1}{16}$ "

## PRODUCT DIMENSIONS

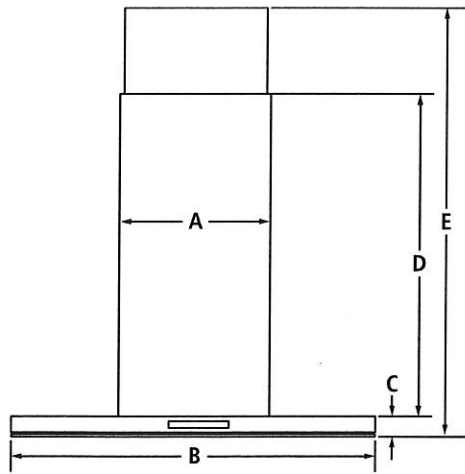

FRONT VIEW

MODEL #		JXW8936DS	
		in	cm
A	Width of chimney	13 $\frac{1}{8}$	33.4
B	Width of hood	36	91.4
C	Height of hood	1 $\frac{5}{8}$	4.2
D	Height of chimney	25 $\frac{1}{2}$	64.8
E	Overall height with vented installation (min.-max.)	33 $\frac{1}{8}$ -54 $\frac{3}{4}$	84.1-139.1
F	Depth of chimney	12 $\frac{3}{8}$	31.4
G	Depth of hood	21 $\frac{1}{16}$	54.8
H	Vent collar diameter	6	15.2
I	Width from chimney to edge of hood	12 $\frac{3}{8}$	31.4

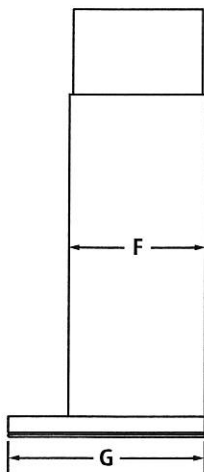

SIDE VIEW

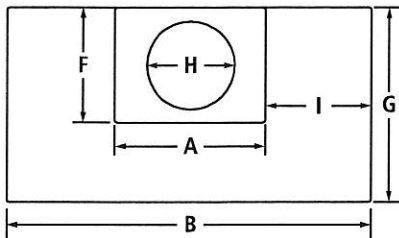

TOP VIEW

**IMPORTANT:** Dimensional specifications are provided for planning purposes only.

**Do not make any cutouts based on this information.** Refer to the Installation or Use & Care Guide before selecting cabinetry, verifying electrical/gas connections, making cutouts or beginning installation. All Jenn-Air® appliances are appropriately UL, CUL or CSA approved.

## 36" LOW PROFILE WALL-MOUNT PERIMETRIC CANOPY HOOD

JXW8936DS – 36" x 33 $\frac{1}{8}$ "-54 $\frac{3}{4}$ " x 21 $\frac{1}{16}$ "

## OPENING/CLEARANCE DIMENSIONS

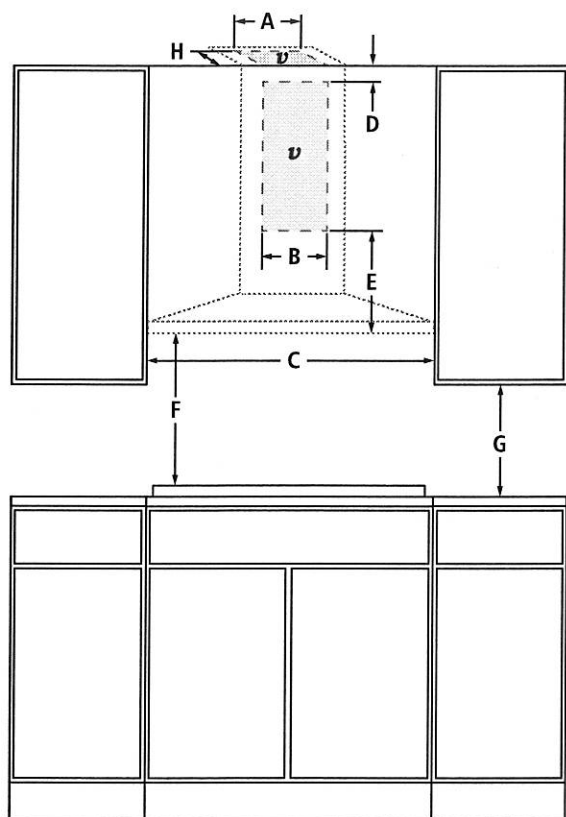

FRONT VIEW

MODEL #		JXW8936DS	
		in	cm
A	Width of entry location for vent and power supply – ceiling option (min.-max.)	10-13	25.4-33.0
B	Width of entry location for vent and power supply – wall option (min.-max.)	10-13	25.4-33.0
C	Width of cabinet opening (min.)	36	91.4
D	Minimum height from entry location to ceiling for vent and power supply – wall option (vented installation)	2	5.1
	Minimum height from entry location to ceiling for vent and power supply – wall option (non-vented installation)	9	22.9
E	Height from hood to entry location for vent and power supply – wall option (min.)	17	43.2
F	Suggested distance from hood to electric cooking surface (min.-max.)	24-36	61.0-91.4
	Suggested distance from hood to gas cooking surface (min.-max.)	30-36	76.2-91.4
G	Height from upper cabinet to countertop (min.)	18	45.7
H	Depth of entry location for vent and power supply – ceiling option	9½	24.1
v	Recommended vent and power supply entry location		

## ELECTRICAL REQUIREMENTS

120 volt, 60 Hz, AC only, 15-amp fused, electrical circuit is required.

## VENTING REQUIREMENTS

The hood is factory set for venting through the roof or wall. For non-vented (recirculating) installation, refer to recirculation kit instructions for further information.

## LOCATION REQUIREMENTS

Ceiling structure must be able to support 80 lb (36.6 kg).

For vented installation, the chimney can be adjusted for ceilings between 7' 10" (2.39 m) and 10' 4" (3.15 m).

For non-vented (recirculating) installation, the chimney can be adjusted for ceilings between 7' 10" (2.39 m) and 10' 4" (3.15 m).

**IMPORTANT:** Dimensional specifications are provided for planning purposes only.

**Do not make any cutouts based on this information.** Refer to the Installation or Use & Care Guide before selecting cabinetry, verifying electrical/gas connections, making cutouts or beginning installation.

All Jenn-Air® appliances are appropriately UL, CUL or CSA approved.



8796BdZw616



# FRONT LOAD WASHERS

## WM3770HVA

### Performance

- 5.2 cu.ft. Ultra Large Capacity with NeveRust™ Stainless Steel Drum (IEC)
- DirectDrive™ Motor for the Ultimate in Durability and Reliability with 10 Year Warranty
- 10° TiLTub™ for Easy Reach into the Rear of the Drum
- 1300 RPM Powerful Spin for Efficient Water Extraction

### Intelligent Fabric Care

- TurboWash™ Technology
- Steam Technology
- ASC Certified Allergiene™ Cycle
- NSF Certified Sanitary Cycle
- ColdWash™ Technology
- 6Motion™ Technology
- NFC Tag On
- SmartDiagnosis™
- TrueBalance™ Anti-Vibration System
- Magnet Ventilation
- SenseClean™ System for Intelligent Fabric Care
- 12 Washing Programs and 5 Temperature Settings
- Delay Wash up to 19 hours for Washing Convenience

### Style and Design

- Upfront Electronic Control Panel with Dual LED Display and Dial-A-Cycle™
- Large Chrome Rimmed Glass Door with Dark Blue Tinted Cover

### Technology Benefits

- LoDecibel™ Quiet Operation
- Highly Energy and Water Efficient



Graphite Steel

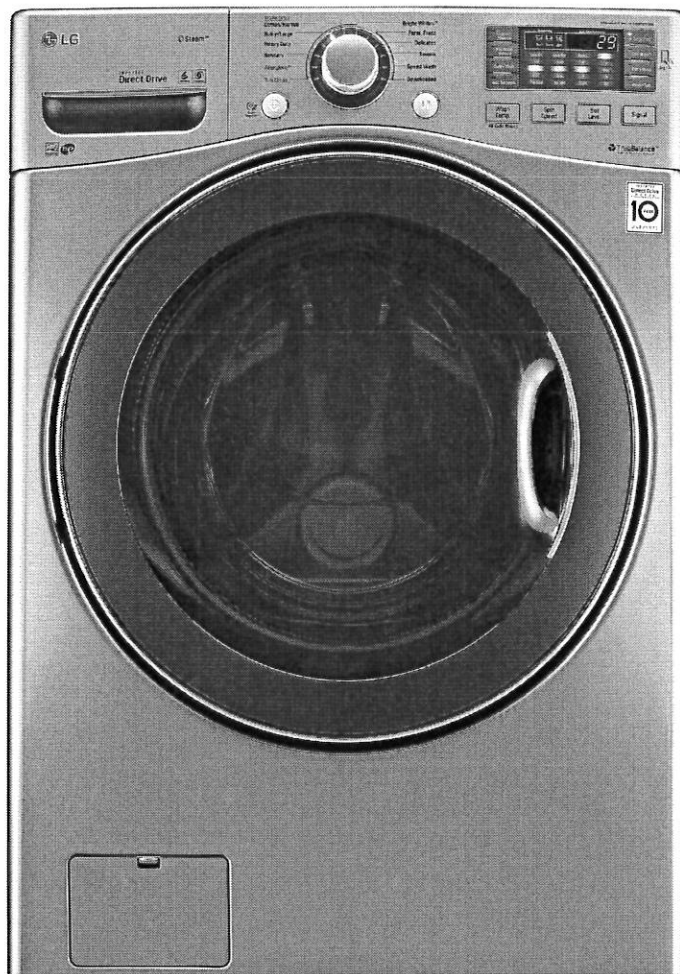

### Fast Forward your Laundry

Tired of spending hours on end finishing your family's laundry? Now, those days are gone. LG's revolutionary TurboWash™ Technology allows you to save 20 minutes on larger loads, with outstanding cleaning performance! It's like pressing the fast forward button on your laundry.

### Deep Clean with Steam

LG Steam Technology penetrate fabric to remove soil and enhance cleaning results, it also removes common household allergens. The Allergiene™ cycle gently removes over 95% of common household allergens, like dust mites and pet dander from even the most delicate fabrics. It's so effective it's certified by the Asthma Society of Canada (ASC).

### More Free Time

Towers of towels, piles of sweatshirts, and a mountain of jeans? Go for it. The ultra large capacity (5.2 cu.ft.) washer lets you do more laundry in fewer loads. That's time well saved.

### Count On It

When you buy a washer, you don't want to worry that it won't last. Because the DirectDrive™ Motor uses fewer moving parts and operates more efficiently, LG confidently backs the motor with a 10-year warranty.

### NFC Tag On

Easily change and customize cycles with a simple tap of a smart phone app. Can't find a cycle you need? There's an app for that. Your laundry just got a little bit smarter.

### Call, Connect, Resolve

SmartDiagnosis™ uses self-diagnosing technology that can communicate 24/7 with LG customer service over the telephone providing you with comfort and reliability.

### All the Right Moves

With 6Motion™ Technology, each wash cycle combines up to 6 different wash motions to provide a revolutionary cleaning experience and ultimate fabric care.

## PRODUCT FEATURES

TYPE		
Front Loader	•	
Design Lock	Front Control	
Intelligent Electronic Controls with Dual LED Display	•	
Dial-A-Cycle™	•	
Capacity	IEC 5.2 cu.ft.	
TYPE		
Energy Star	•	
WASH PROGRAMS		
12 Programs	Cotton/Normal, Bulky/Large, Perm. Press, Delicates, Download, Speed Wash, Tub Clean, Sanitary, Allergiene™, Heavy Duty, Towels, Bright Whites™	
10 Options	Prewash, Rinse+Spin, TurboWash™, Extra Rinse, Child Lock, ColdWash™, Steam, FreshCare™, Delay Wash (up to 19 hours), Add Garment	
5 Wash/Rinse Temperatures	Extra Hot, Hot, Warm, Cold, Tap Cold (All Cold Rinses)	
5 Spin Speeds	Extra High (1300 max), High, Medium, Low, No Spin	
No. of Water Levels	Automatically adjusts to the size of load	
No. of Soil Levels	5	
FABRIC CARE FEATURES		
TurboWash™	•	
Steam	•	
Allergiene™ Cycle	•	
ColdWash™	•	
6Motion™	•	
SenseClean™ System		
CONVENIENCE FEATURES		
4 Tray Dispenser	Prewash, Main Wash (with liquid detergent cup), Bleach, Fabric Softener	
TrueBalance™ Anti-Vibration System	•	
NFC Tag On	•	
SmartDiagnosis™	•	
Load Sense	•	
Status Indicator(s)	•	
End of Cycle Signal	•	
Child Lock	•	
Auto Suds Removal	•	
Forced Drain System	•	
Internal Water Heater	•	
Easy Loading Tilt™	•	
Leveling Legs	4 Adjustable Legs	
LoDecibel™ Quiet Operation	•	
MOTOR AND AGITATOR		
Motor Type / Motor Speed / Axis	Direct Drive / Variable / Horizontal	
MATERIALS AND FINISHES		
NeveRust™ Stainless Steel Drum	•	
Cabinet	Painted Steel	
Control Panel	Plastic	
Top Plate	Painted	
Transparent Glass Door	•	
Door Rim	Large Chrome Rimmed Glass Door with Dark Blue Tinted Cover	
Available Colours	Graphite Steel (V)	
POWER SOURCE		
Ratings / Electrical Requirements / Type	UL Listed / 120V, 10 Amps / Electric	
OPTIONS		
Pedestal	WDP4V	
Pedestal (WxHxD)	27" x 13 3/5" x 25 2/5"	
Stacking Kit	KSTK1	
DIMENSIONS		
Product (WxHxD)	27" x 38 11/16" x 29 3/4" (51" D with door open)	
Carton (WxHxD)	29 1/2" x 43 5/16" x 31 5/16"	
Weight (Product/Carton)	202.8 lbs/224.8 lbs	
UPC CODES		
WM3770HVA (Washer)	772454 067594	
WDP4V (Pedestal)	772454 052866	
KSTK1 (Stacking Kit)	772454 059896	
WARRANTY		
	1 Year Parts and Labour	
	5 Years Part on Drum	
	10 Years Part on DirectDrive™ Motor	



LG ELECTRONICS CANADA INC.

20 Norelco Drive, North York, Ontario M9L 2X6

Tel: 647-253-6300 | LG.com

Customer Service & Parts

1-888-542-2623

Design, features and specifications are subject to change without notice.

Non-metric weights and measurements are approximate.

All trademarks are property of their respective owners.

Printed in August 2016



## ELECTRIC DRYERS

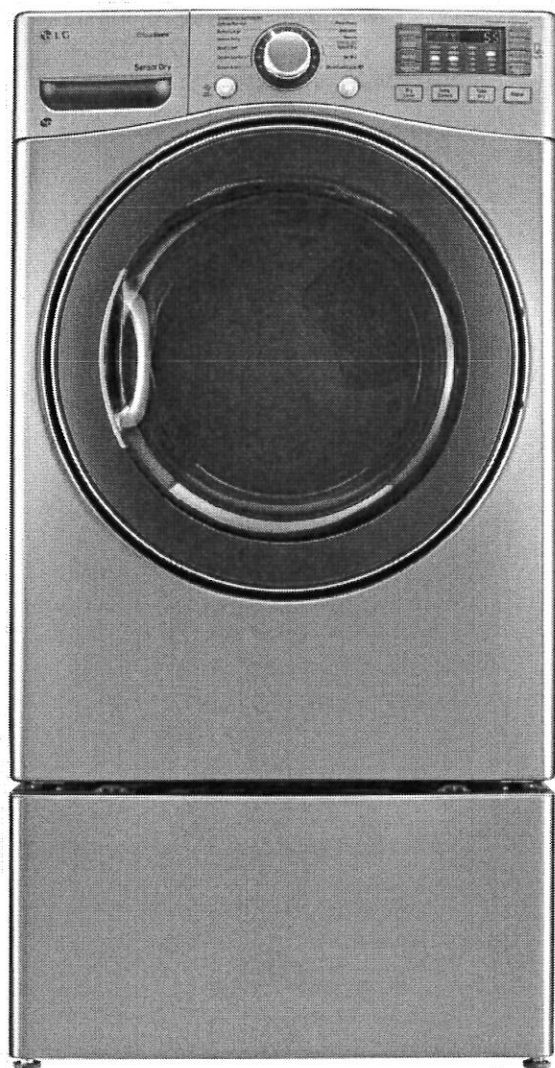

## DLEX3570V

**Performance**

- 7.4 cu.ft. Ultra Large Capacity with Aluminized Alloy Steel Drum (Alcosta)

**Intelligent Fabric Care**

- TrueSteam™ Technology
- SteamFresh™ Cycle
- SteamSanitary™ Cycle
- ReduceStatic™ Option
- EasyIron™ Option
- Sensor Dry System for Intelligent Fabric Care and Energy Efficiency
- Precise Temperature Control with Variable Heat Source
- NFC Tag On
- SmartDiagnosis™
- 12 Drying Programs
- 5 Temperature Settings
- 3 Minute Installation Check
- FlowSense™ Duct Clogging Indicator
- Drying Rack
- Wrinkle Care Option
- Anti-Bacterial Cycle
- Custom Program
- Damp Dry Signal

**Style and Design**

- Upfront Electronic Control Panel with Dual LED Display and Dial-A-Cycle™
- Large Chrome Rimmed Glass Door with Dark Blue Tinted Cover

**Technology Benefits**

- LoDecibel™ Quiet Operation

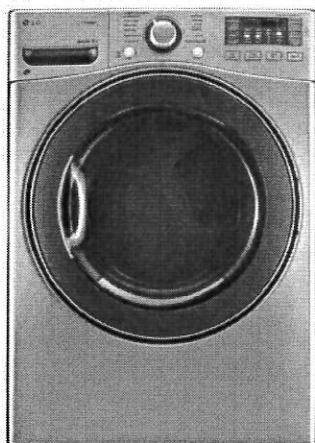
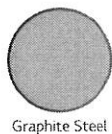



7

# ELECTRIC DRYERS

## Harness the Power of Steam

LG's **TrueSteam™ Technology** uses a steam generator to produce real steam right into the dryer giving you unique cycle options that remove wrinkles, odours, static and allergens.

## The Quick Fix

Late for the party and no time to iron your favourite outfit? The **SteamFresh™ Cycle** refreshes and reduces wrinkles in up to five garments at a time with one 20-minute dryer cycle.

## Refresh and Sanitize

**SteamSanitary™ Cycle** refreshes and sanitizes dry items in the steam dryer. The SteamSanitary™ Cycle kills bacteria on your clothes and is great for decorative pillows and other non-washable items.

## Dry Big Loads

Accurately dry big and bulky loads with **7.4 cu.ft. ultra large capacity**. Less time in laundry room, more time for life.

## NFC Tag On

Easily change and customize cycles with a **simple tap of a smart phone app**. Can't find a cycle you need? There's an app for that. Your laundry just got a little bit smarter.

## Call, Connect, Resolve

**SmartDiagnosis™** uses self-diagnosing technology that can communicate 24/7 with LG customer service over the telephone providing you with comfort and reliability.

## Accurate Drying

LG's **Sensor Dry System** measures the moisture levels during the cycle and automatically adjusts the drying time, assuring you get dry laundry every time.

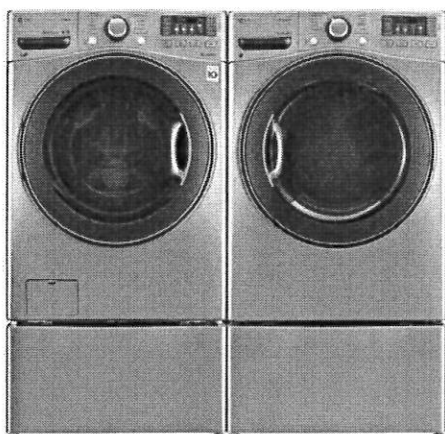

LG ELECTRONICS CANADA INC.  
20 Norelco Drive, North York, Ontario, M9L 2X6  
Tel: 647.253.6300 | LG.com  
Customer Service & Parts  
1-888-542-2623

DLEX3570V	
<b>TYPE</b>	
Front Loader	•
Design Lock	Front Control
Intelligent Electronic Controls with Dual LED Display	•
Dial-A-Cycle™	•
Capacity	7.4 cu.ft.
Dry Linen Capacity	> 10.2 kg
<b>DRYING PROGRAMS</b>	
12 Programs	Sensor Dry, SteamFresh™, SteamSanitary™, Towels, Perm Press, Cotton/Normal, Heavy Duty, Delicates, Small load, Bulky/Large, Anti-Bacterial Manual Dry, Speed Dry, Air Dry
10 Options	More Time, Less Time, ReduceStatic™, EasyIron™, Custom Program, Wrinkle Care, Rack Dry, Child Lock, Damp Dry Signal, Signal ON/OFF
5 Temperature Settings	High, Medium High, Medium, Low, Ultra Low
5 Drying Levels	Very Dry, More Dry, Normal Dry, Less Dry, Damp Dry
Dry Times	60 min., 50 min., 40 min., 30 min., 20 min., More Time/Less Time
<b>FABRIC CARE FEATURES</b>	
SteamFresh™ Cycle	•
SteamSanitary™ Cycle	•
ReduceStatic™ Option	•
EasyIron™ Option	•
Sensor Dry	•
Precise Temperature Control and Variable Heater	•
<b>CONVENIENCE FEATURES</b>	
NFC Tag On	•
SmartDiagnosis™	•
FlowSense™ Duct Clogging Indicator	•
Wrinkle Care Option	•
Remaining Time Display/Status Indicator(s)	•
End of Cycle Signal	•
Child Lock	•
Drying Rack	•
Drum Light	•
Reversible Door	•
Leveling Legs	4 Adjustable Legs
Venting Option	4 Way Venting
3 Minute Installation Check	•
LoDecibel™ Quiet Operation	•
<b>MATERIALS AND FINISHES</b>	
Aluminized Alloy Steel Drum (Alcosta)	•
Cabinet	Painted Steel
Control Panel	Plastic
Top Plate	Painted
Transparent Glass Door	•
Door Rim	Large Chrome Rimmed Glass Door with Dark Blue Tinted Cover
Available Colours	Graphite Steel (V)
<b>POWER SOURCE</b>	
Ratings	UL Listed
Electrical Requirements	240V, 30 Amps
Type	Electric
<b>OPTIONS</b>	
Pedestal	WDP4V
Pedestal (WxHxD)	27" x 13 3/5" x 28 2/5"
Stacking Kit	KSTK1
<b>DIMENSIONS</b>	
Product (WxHxD)	27" x 38 11/16" x 29 3/4" (51" D with door open)
Carton (WxHxD)	29 1/2" x 42 1/4" x 31 1/4"
Weight (Product/Carton)	134.1 lbs/144 lbs
<b>UPC CODES</b>	
DLEX3570V	772454 063268
WDP4V	772454 052866
KSTK1	772454 059896
<b>WARRANTY</b>	
1 year parts and labour	

Design, features and specifications are subject to change without notice.  
Non-metric weights and measurements are approximate.  
All trademarks are property of their respective owners.

9/1

## Pedestals Laundry Accessories

LG

Model: WDP4V / SKU #: WDP4V

Price

\$349

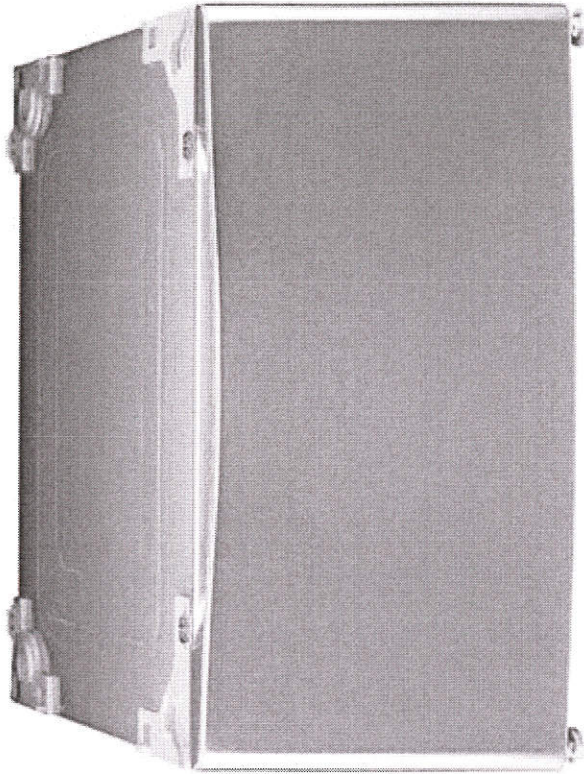

Description

### Description

This LG pedestal doubles as a great place to store laundry products and provides easy access to front loading doors to minimizes bending and stooping at doors.

Specifications

Q/A

**General**

Color

Graphite Steel

**Specification**

Information

Provides easy access to front loading doors.

**Warranty**

Warranty

1 year(s)

UPC

UPC#

048231011198

**Dimensions**

**Dimensions**

Width

27 inch(es) / 68.58 cm

Height

13.6 inch(es) / 34.54 cm

Depth

28.4 inch(es) / 72.14 cm

*\*While we place great care into preparing product descriptions and prices, sometimes technical and typographical errors or omissions may occur. Goemans Appliances cannot be held responsible for such errors and we apologize for any inconvenience this may cause.*

© Goemans Appliances 2017 | All rights reserved.

