

Cristina Marques

From: Jason Ng [Jason.Ng@goemans.com]
Sent: June-15-17 3:50 PM
To: 'Green Valley Bayview Wellington Homes'; Cristina Marques
Cc: 'realtorelango@gmail.com'
Subject: Invoice HB00016257 From Goemans Vaughan
Attachments: HB16257 - SPECS.pdf

Hi BW,

Please see attached for upgraded appliances:

EESWARAP, ELANGO & THAMARA
TBA LEWIS AVE
LOT# 234
BRADFORD, ON, TBA
(416) 721-8493, (416) 837-9610
realtorelango@gmail.com

**** please note**

- The fridge will require a 73" tall opening
- 36" cooktop
- 36" chimney hood fan
- The oven is a combination microwave and oven in 1 piece

The customer i believe purchased a microwave plug, please rectify that if its not needed.
If you have any question please don't hesitate to ask.

Jay

JASON NG

Sales | Goemans Appliances
167 Chrislea road, Vaughan, L4L 8N6, ON
Phone 905-264-1771 Ext. 1782 Cell 416-721-3812
Jason.ng@goemans.com

Tues 12-6, Wed 12-9, Thurs-Sat 10-6
Sun-Mon: OFF

Our Mission :

Character Matters. All of our actions are driven by our unwavering commitment to our core principles of **knowledge, integrity, and respect.**

The information in this email and subsequent attachments may contain confidential information that is intended solely for the attention of the named addressee(s). This message or any part thereof must not be disclosed, copied, distributed or retained by any person without authorization from the Company.

GOEMANS APPLIANCES

1-877-463-6267

HST # 105167993 WWW.GOEMANS.COM
Find us on Facebook at www.facebook.com/GoemansAppliances

PACKING SLIP

HB00016257

Salesperson: JASON NG
Purchase Date: 6/15/17
Invoice Finished Date:
Delivery/Pickup Date: Aug 18, 2017
Invoice Type: VBL
Date Printed: Jun 15, 2017
Page: 1

ONLINE BANKING ACCOUNT

BILL TO: 4167218493

EESWARAP, ELANGO & THAMARA

TBA LEWIS AVE

LOT # 234

BRADFORD, ON TBA

TEL# (416) 721-8493 BUS# (416) 837-9610

Directions: 6TH LINE & SIMCOE ROAD

SHIP TO: 4167218493

EESWARAP, ELANGO & THAMARA

TBA LEWIS AVE

LOT # 234

BRADFORD, ON TBA

TEL# (416) 721-8493 BUS# (416) 837-9610

QTY	LOC	MODEL #	SERIAL #	COLOUR	BRAND - DESCRIPTION
1		JFFCC72EFS		EURO STY	JEN, REBC3: REFRIGERATOR, FRENCH 3-DOOR, C 36W, 72H, 24 CUFT, LUXURY EXT. I/W, OBSIDIAN INT, WIFI
-1		P-CJEN-1704-20PER			
1		JMW3430DS		EURO STA	JEN, OVC: OVEN, COMBO 30, 5.0 CONVECT OVEN, 1.4 CONVECT MICRO, WIFI
-1		P-CJEN-1704-20PER			
1		W10837591			JEN, AOV: ACCESSORY, OVEN FLUSH INSTALLATION KIT, SS 30 OVENS (SNGL/DBL)
1		JGC7636BP		STAINLES	JEN, CTGD: COOKTOP, GAS, DROP-IN 36W, 6B, 18K BTU, LOW PROFILE FLSH SS, PRO KNOBS
-1		P-CJEN-1704-20PER			
1		JDB9800CWS		EURO STY	JEN, DISIC: DISHWASHER, INTEGRATED, COLOUR STAINLESS STEEL TUB, FULLY INTEGRATED WITH EURO HA
-1		P-CJEN-1704-20PER			
1		JXW8536DS		STAINLES	JEN, HOWC: HOOD, WALL MOUNT 36 WALL MOUNT, 600CFM, 6.9 SNS, PRMTRC
-1		P-CJEN-1704-20PER			
		This special order product requires a 50% deposit & is considered FINAL SALE. x			
		PLEASE ALLOW UP TO 4-12 WEEKS FOR DELIVERY OF THIS PIECE.			
1		KC2TS10ST			KITC, COUN: COUNTER-TOP APPLIANCES 10 PIECE SET (8, 10, 1.5, 3.0, 3.5, 8.0)
1		P-CJEN BUY 4+PC=FREE KC2TS10ST			

- All products remain the property of Goemans until paid in full.
- Removal of old appliances at owner's risk and must be disconnected.
- Please refer to delivery/installation brochures for important details.
- All authorized returned products will be subject to a restocking charge.
- Interest of 18% per annum will be charged on overdue accounts.
- Upon delivery customer agrees to accept service in accordance with manufacturer's warranty.
- This sales invoice is based on delivery within 12 months from date of purchase. After 12 months (or if market conditions adversely change) Goemans reserves the right to review pricing/delivery on this order and offer our customers options to accommodate these changes. Any & all date sensitive supplier promotions are exempt from the 12 month price guarantee and must be taken by the promotional delivery deadline.

WHITE CUSTOMER COPY

PINK GOEMANS COPY

GOEMANS APPLIANCES

1-877-463-6267

HST # 105167993

WWW.GOEMANS.COM

Find us on Facebook at www.facebook.com/GoemansAppliances

PACKING SLIP

HB00016257

Salesperson: JASON NG
Purchase Date: 6/15/17
Invoice Finished Date:
Delivery/Pickup Date: Aug 18, 2017
Invoice Type: VBL
Date Printed: Jun 15, 2017
Page: 2

ONLINE BANKING ACCOUNT

BILL TO: 4167218493

EESWARAP, ELANGO & THAMARA

TBA LEWIS AVE

LOT # 234

BRADFORD, ON TBA

TEL# (416) 721-8493 BUS# (416) 837-9610

SHIP TO: 4167218493

EESWARAP, ELANGO & THAMARA

TBA LEWIS AVE

LOT # 234

BRADFORD, ON TBA

TEL# (416) 721-8493 BUS# (416) 837-9610

Directions: 6TH LINE & SIMCOE ROAD

QTY	LOC	MODEL #	SERIAL #	COLOUR	BRAND - DESCRIPTION
1		MHW5500FC		METALIC S	MAY, WAFL: WASHER, FRONT LOAD, LARGE CAPA MAXIMA®, 5.2 CU FT IEC, 11 CYCLES, 1200 RPM, STAIN
1		MUST ADD WASHER HOSES YMED5500FC		METALIC S	MAY, DREFL: DRYER, ELECTRIC - TO MATCH LAR MAXIMA®, 7.4 CU FT., 9 CYCLES, ADVANCED MOISTURE S
1		HOSE KIT WS5SS-ST			REL, ALAU: ACCESSORY, LAUNDRY
1		HOSE LNDRY 6FT 48			HOSE-KIT,FOR STEAM DRYER,ALSO INCLUDES 1 WSHR HOSE REL, AWA: ACCESSORY WASHER
1		P-DELIVERY \$10,000-19,999			1X 6 FT WASH HOSE, 3/4,STAINLESS STEEL BRAID
-1		SALES DELIVERY ALLOWANCE			
		BAYVIEW WELLING CUSTOMER, HOOD FAN TO BE DELIVERED AND INSTALLED 1 WEEK PRIOR TO CLOSING. FOR PDI INSPECTION. IN			
1		VHOOD2CHMY	UNASSIGNED INSTALLER		Chimney style hood install up to 36" model
1		Mounting of hood to wall, and vent connection up to 4ft in length. No hole cutting. OVENCMB	UNASSIGNED INSTALLER		Combination units. Microwave oven combo
		Lifting and securing unit into cabinetry. Electrical must be properly located on dedicated circuit. BREAKER NOT INCLUDED			
1		DISHN	UNASSIGNED INSTALLER		New home dishwasher install

- All products remain the property of Goemans until paid in full.
- Removal of old appliances at owner's risk and must be disconnected.
- Please refer to delivery/installation brochures for important details.
- All authorized returned products will be subject to a restocking charge.
- Interest of 18% per annum will be charged on overdue accounts.
- Upon delivery customer agrees to accept service in accordance with manufacturer's warranty.
- This sales invoice is based on delivery within 12 months from date of purchase. After 12 months (or if market conditions adversely change) Goemans reserves the right to review pricing/delivery on this order and offer our customers options to accommodate these changes. Any & all date sensitive supplier promotions are exempt from the 12 month price guarantee and must be taken by the promotional delivery deadline.

WHITE CUSTOMER COPY

PINK GOEMANS COPY

GOEMANS APPLIANCES

1-877-463-6267

HST # 105167993 WWW.GOEMANS.COM
Find us on Facebook at www.facebook.com/GoemansAppliances

PACKING SLIP

HB00016257

Salesperson: JASON NG
Purchase Date: 6/15/17
Invoice Finished Date:
Delivery/Pickup Date: Aug 18, 2017
Invoice Type: VBL
Date Printed: Jun 15, 2017
Page: 3

ONLINE BANKING ACCOUNT

BILL TO: 4167218493

EESWARAP, ELANGO & THAMARA
TBA LEWIS AVE
LOT # 234
BRADFORD, ON TBA

TEL# (416) 721-8493 BUS# (416) 837-9610

SHIP TO: 4167218493

EESWARAP, ELANGO & THAMARA
TBA LEWIS AVE
LOT # 234
BRADFORD, ON TBA

TEL# (416) 721-8493 BUS# (416) 837-9610

Directions: 6TH LINE & SIMCOE ROAD

QTY	LOC	MODEL #	SERIAL #	COLOUR	BRAND - DESCRIPTION
1		Hook-up of waterline, drain and power connection. Drain and water supply must be present and ready or subject to additional cost. BREAKER NOT INCLUDED G-G2G	UNASSIGNED INSTALLER		Gas short connection (already existing)
1		Includes set up of appliance, 4ft gas flex hose and shut off valve. Anti tip and levelling, Gas must be present and in proper location. Drop In Cooktops only (Use GPROR1 or 2 for Pro Cooktops) *** INCLUDES DISCONNECT OF EXISTING COOKTOP IF VIA CODE IS A DDED ONLY***	UNASSIGNED INSTALLER		10% 4-5 UNITS INSTALL PCKG DISCOUNT
1		INSTALL DISCOUNT	UNASSIGNED INSTALLER		SALES INSTALLATION ALLOWANCE
CUSTOMER AGREED TO PAY FINAL BALANCE BY CASH OR CHEQUE, 2 WEEKS PRIOR TO DELIVERY. IF CHANGING FROM CASH TO CREDIT CARD ANY CASH DISCOUNTS WILL BE FORFEITED AND APPLIED TO THE INVOICE ACCORDINGLY. YOUR DELIVERY DATE IS TENTATIVE UNTIL BALANCE OF INVOICE IS PAID IN FULL. 10k MAX ON CREDIT CARD 10K ON CHEQUE/CASH HOOD TO BE DELIVERED AND INSTALLED 1 WEEK PRIOR TO CLOSING. BAYVIEW WELLINGTON CUSTOMER. SITE SUPER ANDY WILL SIGN FOR IT. JN Payment VISA					

- All products remain the property of Goemans until paid in full.
- Removal of old appliances at owner's risk and must be disconnected.
- Please refer to delivery/installation brochures for important details.
- All authorized returned products will be subject to a restocking charge.
- Interest of 18% per annum will be charged on overdue accounts.
- Upon delivery customer agrees to accept service in accordance with manufacturer's warranty.
- This sales invoice is based on delivery within 12 months from date of purchase. After 12 months (or if market conditions adversely change) Goemans reserves the right to review pricing/delivery on this order and offer our customers options to accommodate these changes. Any & all date sensitive supplier promotions are exempt from the 12 month price guarantee and must be taken by the promotional delivery deadline.

WHITE CUSTOMER COPY

PINK GOEMANS COPY

wt 234

JENN-AIR® DETAILED PLANNING DIMENSIONS

1 of 3

72" COUNTER-DEPTH FRENCH DOOR REFRIGERATORS WITH EXTERNAL DISPENSER

JFFCC72EF – 35³/₄" x 71¹/₁₆" x 31¹/₄" (with handles)

PRODUCT DIMENSIONS

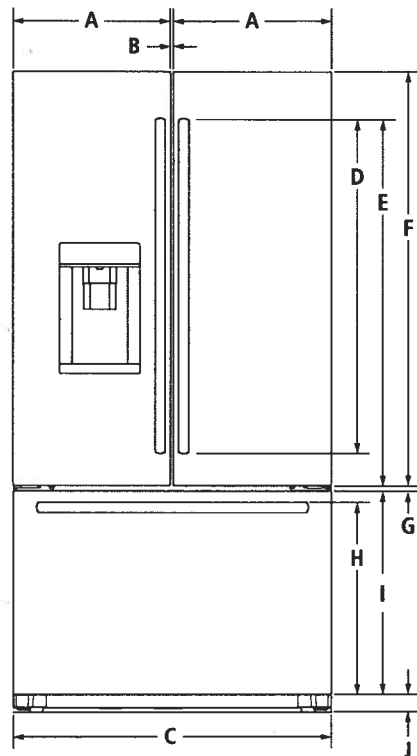

FRONT VIEW

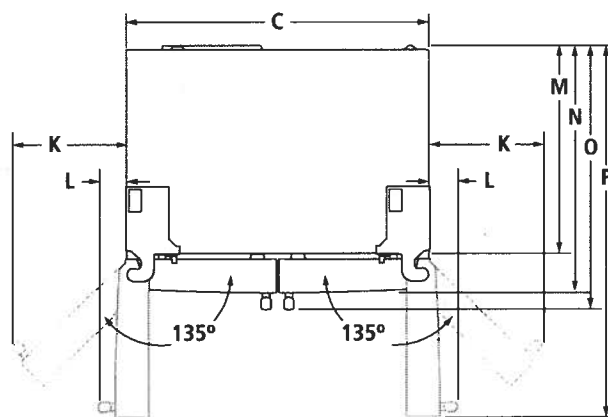

TOP VIEW

MODEL #		JFFCC72EF	
		in	cm
A	Width of each door	17 ¹ / ₁₆	45.0
B	Space between doors	³ / ₈	0.9
C	Overall width	35 ³ / ₄	90.5
D	Height of door handles		
	Pro-Style® Stainless	33 ³ / ₁₆	84.3
	Euro-Style Stainless	37 ³ / ₄	95.6
E	Height to top of door handles		
	Pro-Style® Stainless	38 ⁷ / ₁₆	99.0
	Euro-Style Stainless	41 ¹ / ₁₆	104.6
F	Height of doors	46 ¹ / ₂	118.2
G	Space between doors and drawer	¹ / ₂	1.2
H	Height to top of drawer handle		
	Pro-Style® Stainless	21 ³ / ₄	55.3
	Euro-Style Stainless	21 ¹ / ₁₆	54.8
I	Height of drawer	23	58.4
J	Height of grille	1 ¹ / ₂	3.9
K	Width from side of refrigerator to handle – door fully open 135°		
	Pro-Style® Stainless	13 ⁷ / ₈	35.2
	Euro-Style Stainless	13 ¹ / ₂	34.3
L	Width from side of refrigerator to handle – door open 90°		
	Pro-Style® Stainless	3 ¹⁵ / ₁₆	10.0
	Euro-Style Stainless	3 ³ / ₈	8.4
M	Depth without doors	24 ³ / ₈	62.6
N	Depth with doors	29 ⁹ / ₁₆	74.4
O	Depth with handles		
	Pro-Style® Stainless	31 ¹⁵ / ₁₆	81.1
	Euro-Style Stainless	31 ¹ / ₄	79.4
P	Depth with doors open 90°	44	111.7

IMPORTANT: Dimensional specifications are provided for planning purposes only.

Do not make any cutouts based on this information. Refer to the Installation Guide *before* selecting cabinetry, verifying electrical/gas connections, making cutouts or beginning installation.

All Jenn-Air® appliances are appropriately UL, CUL or CSA approved.



8719AdZw816

JENN-AIR® DETAILED PLANNING DIMENSIONS

2 of 3

72" COUNTER-DEPTH FRENCH DOOR REFRIGERATORS WITH EXTERNAL DISPENSER

JFFCC72EF – 35³/₄" x 71⁵/₁₆" x 31¹/₄" (with handles)

DIMENSIONS AS INSTALLED

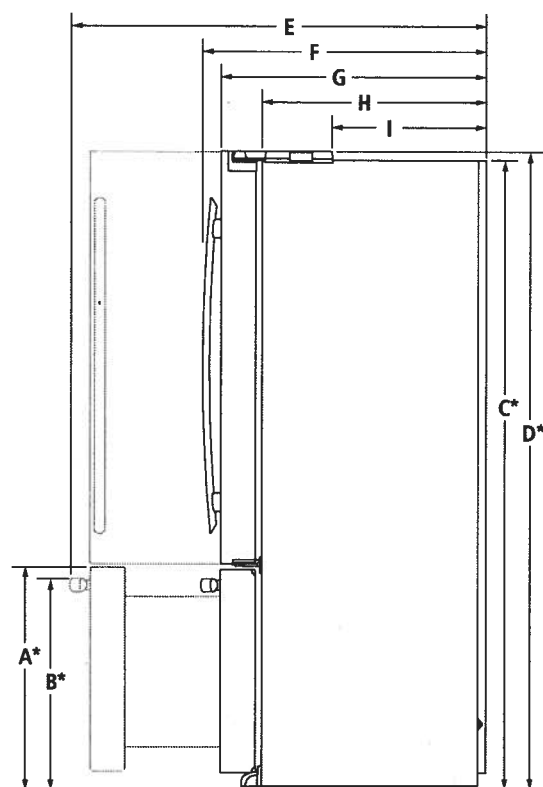

SIDE VIEW

MODEL #		JFFCC72EF	
		in	cm
A*	Height to top of drawer (min.)	24 ¹ / ₁₆	63.3
B*	Height to top of drawer handle (min.)		
	Pro-Style® Stainless	23 ¹ / ₁₆	60.2
	Euro-Style Stainless	23 ³ / ₁₆	59.8
C*	Height of recessed refrigerator (min.)	70 ⁵ / ₁₆	180.1
D*	Height to top of hinges (min.)	71 ⁵ / ₁₆	182.7
E	Depth with drawer fully open including drawer handle (min.)		
	Pro-Style® Stainless	46 ⁷ / ₁₆	117.9
	Euro-Style Stainless	45 ⁵ / ₁₆	116.7
F	Depth with handles (min.)		
	Pro-Style® Stainless	31 ⁵ / ₁₆	81.1
	Euro-Style Stainless	31 ¹ / ₄	79.4
G	Depth with doors (min.)	29 ⁹ / ₁₆	74.4
H	Depth without doors (min.)	24 ⁷ / ₈	62.6
I	Depth to back of hinges (min.)	16 ³ / ₄	42.6

*Add ³/₄" (1.9 cm) to the height dimension when leveling legs are fully extended.

IMPORTANT: Dimensional specifications are provided for planning purposes only.
Do not make any cutouts based on this information. Refer to the Installation Guide *before* selecting cabinetry, verifying electrical/gas connections, making cutouts or beginning installation.
 All Jenn-Air® appliances are appropriately UL, CUL or CSA approved.



8719AdZw816

72" COUNTER-DEPTH FRENCH DOOR REFRIGERATORS WITH EXTERNAL DISPENSER

JFFCC72EF – 35³/₄" x 71⁵/₁₆" x 31¹/₄" (with handles)

OPENING/CLEARANCE DIMENSIONS

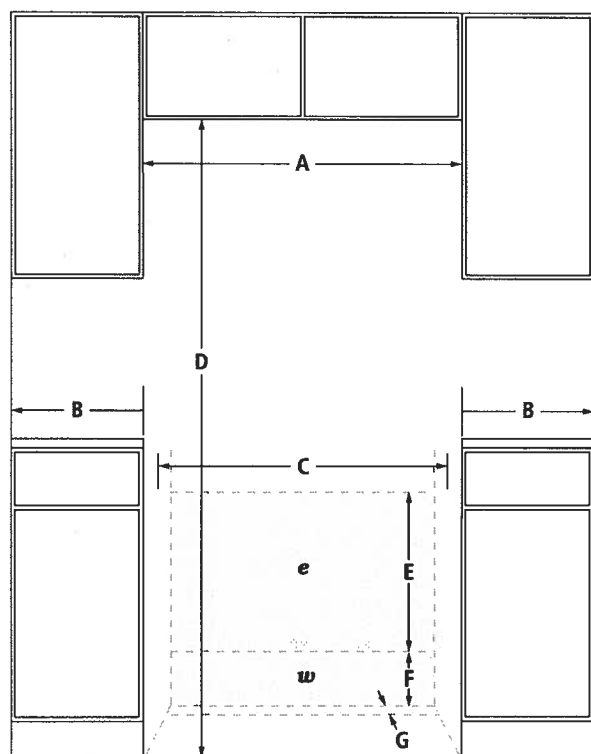

FRONT VIEW

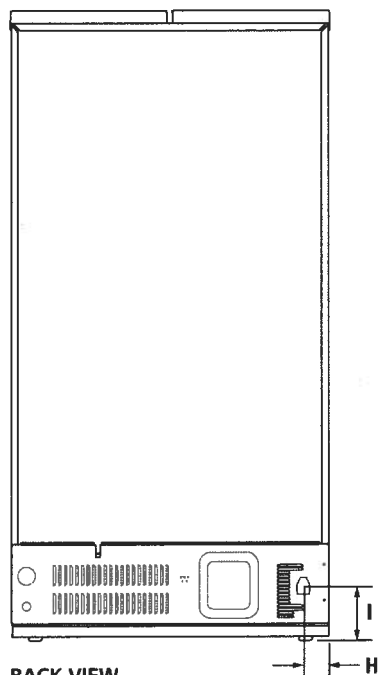

BACK VIEW

MODEL #		JFFCC72EF	
		in	cm
A	Width (min.)	36 ³ / ₄	93.3
	Minimum width from side of refrigerator to fixed wall – door open 90° (full access to remove bins)	3 ³ / ₄	9.5
B	Minimum width from side of refrigerator to fixed wall – door open approx. 135°	12	30.5
C	Width of recommended electrical/water installation area	35 ¹ / ₂	90.2
D	Height (min.)	72 ⁵ / ₁₆	184.0
E	Height of recommended electrical installation area (min.-max.)	24-36	61.0-91.4
F	Height of recommended water installation area	12	30.5
G	Depth of recommended water installation area	1	2.5
H	Water line location – distance from side	2 ¹ / ₂	6.4
I	Water line location – distance from bottom	7	17.8
e	Recommended electrical connection location		
w	Recommended water connection location		

ELECTRICAL REQUIREMENTS

115 volt, 60 Hz, AC only, 15- or 20-amp fused, grounded circuit is required. A dedicated circuit is recommended. Use an outlet that cannot be turned off by a switch.

Minimum length of power cord is 60" (152.0 cm). Do not use an extension cord.

WATER PRESSURE REQUIREMENTS

A cold water supply with water pressure between 30 and 120 psi (207 and 827 kPa) is required to operate the water dispenser and ice maker. Call a licensed, qualified plumber with any questions about the water pressure.

Reverse Osmosis Water Supply

IMPORTANT: The pressure of the water coming out of a reverse osmosis system going to the water inlet valve of the refrigerator needs to be between 30 and 120 psi (207 and 827 kPa).

If a reverse osmosis water filtration system is connected to the cold water supply, the water pressure to the reverse osmosis system needs to be a minimum of 40 to 60 psi (276 to 414 kPa).

IMPORTANT: Dimensional specifications are provided for planning purposes only.

Do not make any cutouts based on this information. Refer to the Installation Guide before selecting cabinetry, verifying electrical/gas connections, making cutouts or beginning installation.

All Jenn-Air® appliances are appropriately UL, CUL or CSA approved.



8719AdZw816

JENN-AIR® DETAILED PLANNING DIMENSIONS

1 of 4

30" COMBINATION MICROWAVE/WALL OVENS

JMW3430D, JMW2430D – 30" x 43¾" x 25⅝"

PRODUCT DIMENSIONS

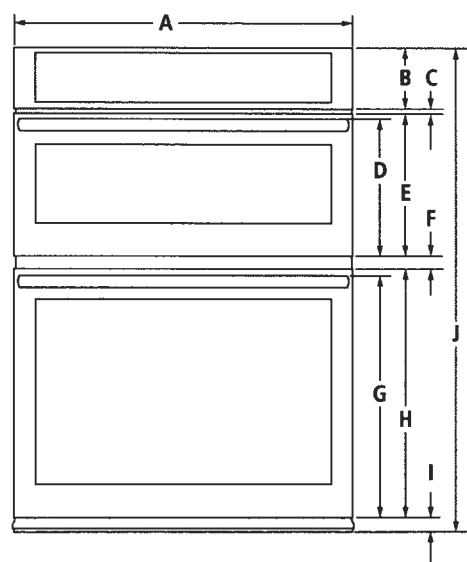

FRONT VIEW

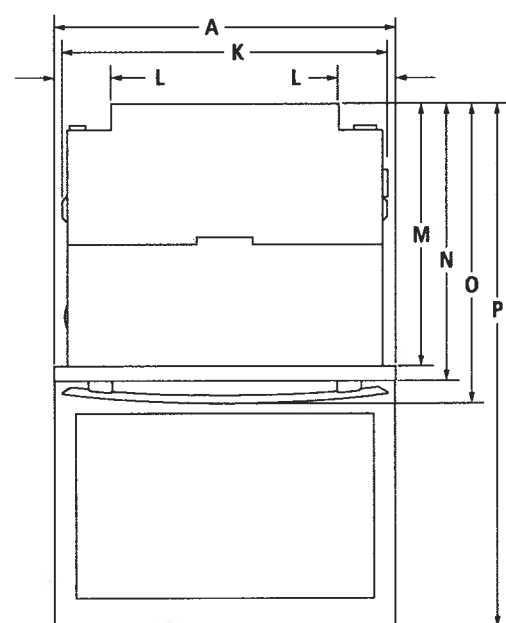

TOP VIEW

MODEL #		JMW3430D JMW2430D	
		in	cm
A	Overall width		
	Pro-Style® Stainless or Euro-Style Stainless	30	76.2
	Floating Glass	29⅛	76.1
B	Height of control panel	5½	14
C	Space between control panel and door	½	1.2
D	Height to top of microwave oven handle		
	Pro-Style® Stainless	12⅞	31.0
	Euro-Style (color-coordinating)	12⅞	31.0
E	Height of microwave oven door	12⅞	32.3
F	Space between doors	1⅛	2.9
G	Height to top of oven handle		
	Pro-Style® Stainless	21⅞	55.0
	Euro-Style (color-coordinating)	21⅞	54.4
H	Height of oven door	22⅞	56.2
I	Height of trim	1⅞	4.3
J	Overall height	43¾	111.1
K	Width of recessed oven	28⅞	72.2
L	Width of conduit channel	4⅞	12.5
M	Depth of recessed oven	23¼	59.0
N	Depth with doors	24⅞	61.9
O	Depth with handles		
	Pro-Style® Stainless	26⅞	67.0
	Euro-Style (color-coordinating)	25⅞	64.3
P	Depth with door fully open	45⅞	115.3

IMPORTANT: Dimensional specifications are provided for planning purposes only.
Do not make any cutouts based on this information. Refer to the Installation Guide *before* selecting cabinetry, verifying electrical/gas connections, making cutouts or beginning installation.
 All Jenn-Air® appliances are appropriately UL, CUL or CSA approved.



8610AdZw915

JENN-AIR® DETAILED PLANNING DIMENSIONS

2 of 4

30" COMBINATION MICROWAVE/WALL OVENS

JMW3430D, JMW2430D – 30" x 43³/₄" x 25⁵/₁₆"

DIMENSIONS AS INSTALLED

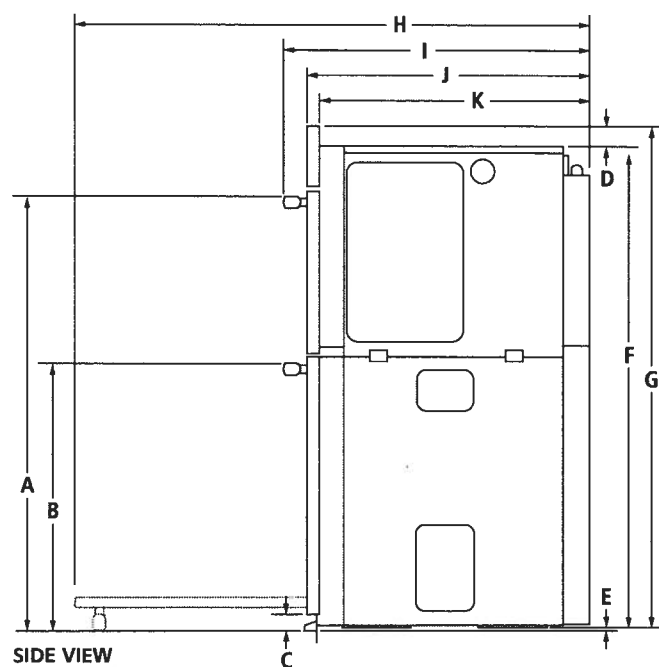

MODEL #	JMW3430D JMW2430D	
	in	cm
A	Height to top of upper handle Pro-Style® Stainless	36½ 92.7
	Euro-Style (color-coordinating)	36½ 92.7
B	Height to top of lower handle Pro-Style® Stainless	23⅜ 59.3
	Euro-Style (color-coordinating)	23⅜ 58.7
C	Height of trim extending below cutout	1⅞ 4.3
D	Height from top of recessed oven to top of control panel JMW3430D	2½ 6.3
	JMW2430D	2⅝ 7.4
E	Height from bottom of recessed oven foot to bottom of oven vent	¾ 0.5
F	Height of recessed oven	41 104.2
G	Height to top of control panel	43¾ 111.1
H	Depth with door fully open	45⅝ 115.3
I	Depth with handles Pro-Style® Stainless	26⅝ 67.0
	Euro-Style (color-coordinating)	25⅝ 64.3
J	Depth with doors	24⅜ 61.9
K	Depth of recessed oven	23¼ 59.0

IMPORTANT: Dimensional specifications are provided for planning purposes only.
Do not make any cutouts based on this information. Refer to the Installation Guide before
 selecting cabinetry, verifying electrical/gas connections, making cutouts or beginning installation.
 All Jenn-Air® appliances are appropriately UL, CUL or CSA approved.



8610AdZw915

30" COMBINATION MICROWAVE/WALL OVENS

JMW3430D, JMW2430D – 30" x 43³/₄" x 25⁵/₁₆"

DO NOT USE THIS
SPEC PAGE, ITS
ONLY FOR
PROUD
INSTALLATION.
JAY

OPENING/CLEARANCE DIMENSIONS

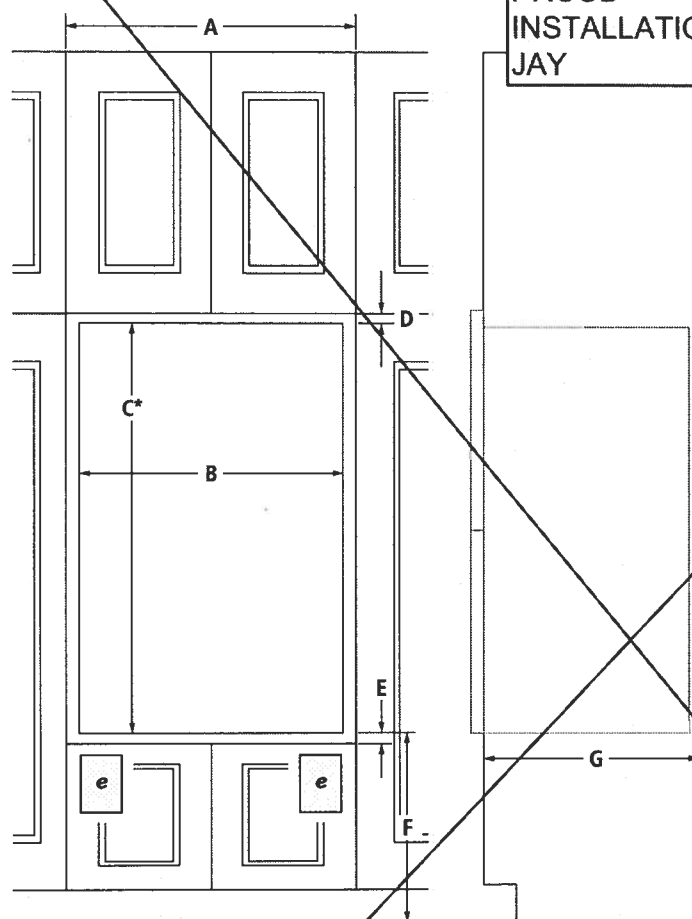

FRONT VIEW

SIDE VIEW

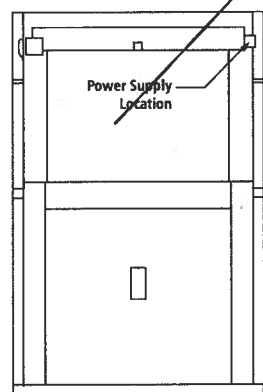

BACK VIEW

MODEL #

JMW3430D
JMW2430D

		in	cm
A	Width of cabinet (min.)	30	76.2
B	Width of cutout	28 ¹ / ₂	72.4
C*	Height of cutout (recommended)	41 ⁵ / ₁₆	104.9
D	Top of cutout to bottom of upper cabinet door (min.)	2 ¹ / ₄	5.7
E	Bottom of cutout to top of lower cabinet door (min.)	1 ¹ / ₂	3.8
F	Bottom of cutout to floor	4-19 ¹ / ₄	10.2-48.9
G	Depth of cutout (min.)	24	61.0
e	Recommended junction box location		

* Will fit cutout height from 41" (104.1 cm) to 41¹/₂" (105.4 cm).

ELECTRICAL REQUIREMENTS

240 volt, 40-amp fused, grounded circuit is required. A dedicated circuit is required.

The length of conduit provided is for serviceability. Do not cut the conduit. The junction box should be located 3" (7.6 cm) maximum below the support surface. Drill a 1" (2.5 cm) minimum diameter hole in the right rear or left rear corner of the support surface for access to the junction box.

IMPORTANT: Dimensional specifications are provided for planning purposes only.

Do not make any cutouts based on this information. Refer to the Installation Guide *before* selecting cabinetry, verifying electrical/gas connections, making cutouts or beginning installation.

All Jenn-Air® appliances are appropriately UL, CUL or CSA approved.

JENN-AIR®

8610AdZw915

30" COMBINATION MICROWAVE/WALL OVENS – FLUSH INSTALLATION

JMW3430D, JMW2430D – 30" x 43³/₄" x 24³/₈" (depth without handles)

OPENING/CLEARANCE DIMENSIONS

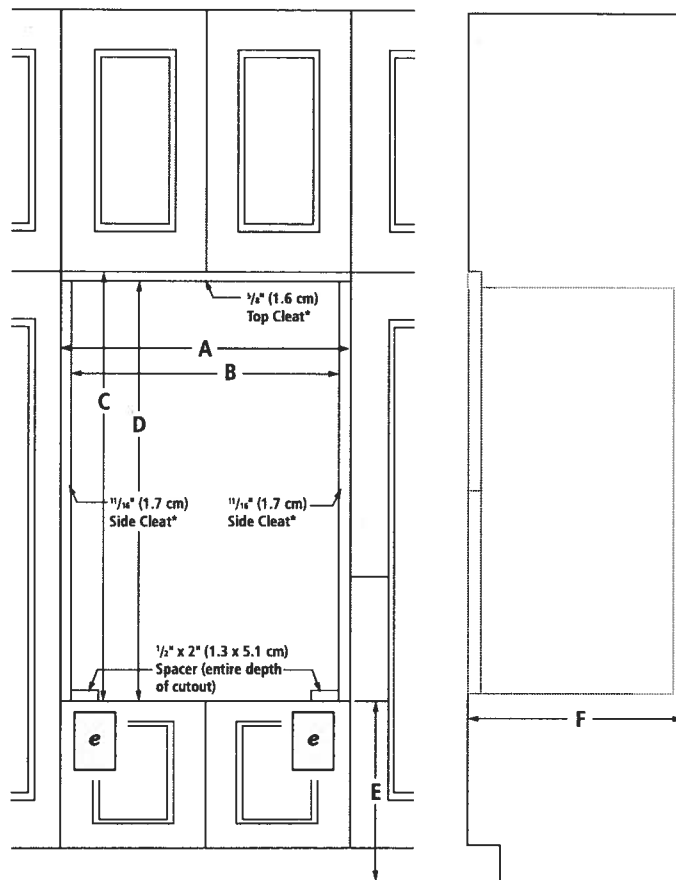

FRONT VIEW

SIDE VIEW

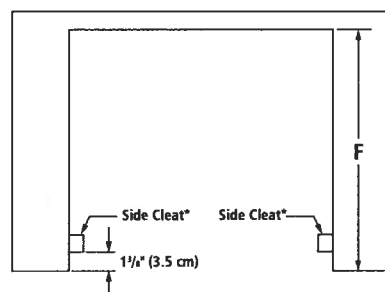

TOP VIEW

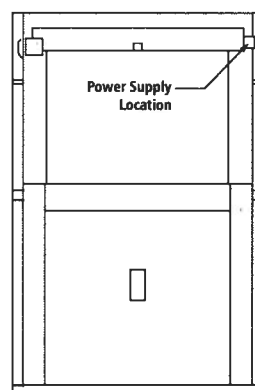

BACK VIEW

MODEL #	JMW3430D JMW2430D	
	in	cm
A	Width of flush inset cutout (min.)	30 ¹ / ₄ 76.8
B	Width of opening (min.)	28 ⁷ / ₈ 73.3
C	Height of flush inset cutout (min.)	44 ³ / ₁₆ 112.5
D	Height of opening (min.)	43 ¹¹ / ₁₆ 110.9
E	Bottom of cutout to floor	4 ⁵ / ₈ – 11.7– 19 ¹ / ₄ 48.9
F	Depth of cutout (min.)	25 63.5
e	Recommended junction box location	

ELECTRICAL REQUIREMENTS

240 volt, 40-amp fused, grounded circuit is required. A dedicated circuit is required.

The length of conduit provided is for serviceability. Do not cut the conduit. The junction box should be located 3" (7.6 cm) maximum below the support surface. Drill a 1" (2.5 cm) minimum diameter hole in the right rear or left rear corner of the support surface for access to the junction box.

FLUSH INSTALLATION REQUIREMENTS

A 25" (63.5 cm) minimum cutout depth is required.

These dimensions will result in a 1/4" (0.6 cm) reveal on the top, a 1/4" (0.6 cm) reveal on the sides and a 1/8" (0.3 cm) reveal on the bottom of the wall oven.

The front face of the cleats and spacers will be visible and should be treated as a finished surface.

CUSTOMER
WANTS FLUSH
INSTALLATION.
JAY

* Cleats and spacers must be recessed 1³/₈" (3.5 cm) from the front of the cabinet.

IMPORTANT: Dimensional specifications are provided for planning purposes only. Do not make any cutouts based on this information. Refer to the Installation Guide before selecting cabinetry, verifying electrical/gas connections, making cutouts or beginning installation. All Jenn-Air® appliances are appropriately UL, CUL or CSA approved.

JENN-AIR® DETAILED PLANNING DIMENSIONS

1 of 2

36" GAS COOKTOP

JGC7636B – 36" x 5¼" x 21"

PRODUCT DIMENSIONS

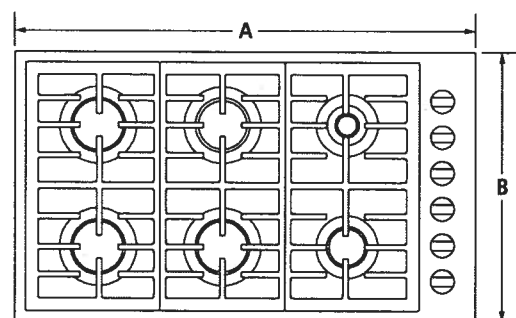

TOP VIEW

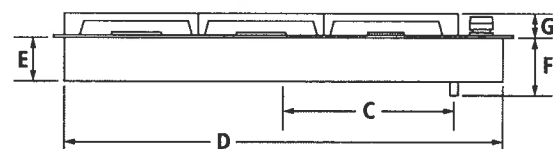

FRONT VIEW

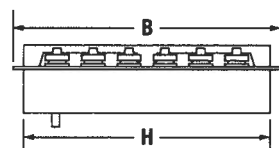

SIDE VIEW

MODEL #		JGC7636B	
		in	cm
A	Overall width	36	91.4
B	Depth of cooktop	21	53.3
C	Center of cooktop to center of gas inlet	13½	34.3
D	Width of recessed cooktop	35¼	89.5
E	Height of recessed cooktop	3¼	8.3
F	Height from gas inlet to countertop	5¼	13.3
G	Height with grates	1¼	3.2
H	Depth of recessed cooktop	20¼	51.4

IMPORTANT: Dimensional specifications are provided for planning purposes only.
Do not make any cutouts based on this information. Refer to the Installation Guide *before* selecting cabinetry, verifying electrical/gas connections, making cutouts or beginning installation.
 All Jenn-Air® appliances are appropriately UL, CUL or CSA approved.



8658AdZw1015

36" GAS COOKTOP

JGC7636B – 36" x 5¼" x 21"

OPENING/CLEARANCE DIMENSIONS

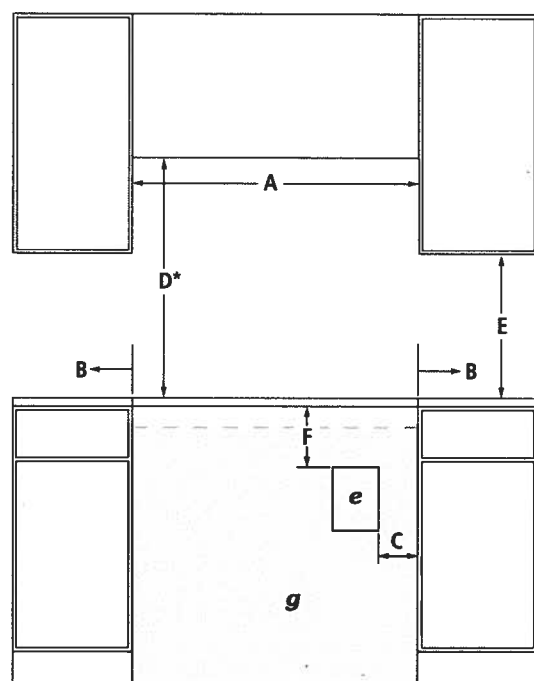

FRONT VIEW

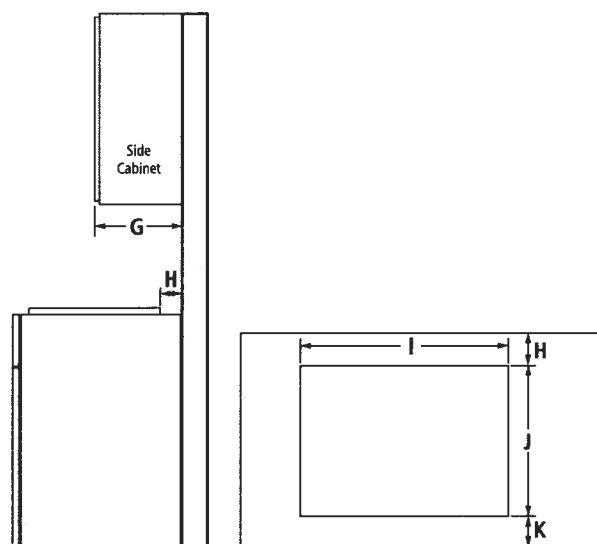

SIDE VIEW

TOP VIEW – CUTOUT

MODEL #		JGC7636B	
		in	cm
A	Width of combustable area above cooking surface (min.)	36	91.4
B	Width from cooktop to fixed wall or other combustable material (min.)	6	15.2
C	Width to outer edge of outlet (max.)	24	61.0
D*	Height to bottom of uncovered wood or metal cabinet above cooking surface (min.)	30	76.2
E	Height to bottom of uncovered wood or metal cabinet (min.)	18	45.7
F	Height to top edge of outlet (min.)	5½	14.0
G	Depth of upper cabinet (recommended)	13	33.0
H	Depth from cutout to wall (min.)	2⅝	5.9
I	Width of cutout	35⅞	89.9
J	Depth of cutout	20⅞	51.8
K	Depth from cutout to front of countertop	2⅝	5.9
e	Recommended electrical access location		
g	Recommended gas supply line location		

*Dimension can be reduced by 6" (15.2 cm) when bottom of wood or metal cabinet is covered by not less than ¼" (0.6 cm) flame retardant millboard covered with not less than No. 28 MSG sheet metal, 0.015" (0.4 mm) stainless steel, 0.024" (0.6 mm) aluminum or 0.020" (0.5 mm) copper. If installing a hood or microwave hood combination above the cooktop, follow the hood or microwave hood combination instructions for dimensional clearances above the cooking surface.

GAS REQUIREMENTS

Natural Gas

This cooktop is factory-set for use with natural gas.

LP Gas Conversion

Conversion must be done by a qualified service technician. To convert to LP gas, use an LP gas conversion kit.

ELECTRICAL REQUIREMENTS

120 volt, 60 Hz, AC only, 15-amp fused, electrical circuit is required. A time-delay fuse or dedicated circuit is recommended.

LOCATION REQUIREMENTS

- To ensure cooktop base clearance, cabinet side walls need to be wider than the cutout.
- If cabinet has a drawer, allow a 4" (10.2 cm) minimum clearance between countertop and top of drawer. Drawer depth may need to be shortened to avoid interfering with the regulator.

IMPORTANT: Dimensional specifications are provided for planning purposes only.

Do not make any cutouts based on this information. Refer to the Installation Guide *before* selecting cabinetry, verifying electrical/gas connections, making cutouts or beginning installation.

All Jenn-Air® appliances are appropriately UL, CUL or CSA approved.



8658AdZw1015

DISHWASHERS

JDB9800CW, JDB9200CW, JDB9000CW – 23¾" x 33⅞" x 26⅞" (including handle)

PRODUCT DIMENSIONS

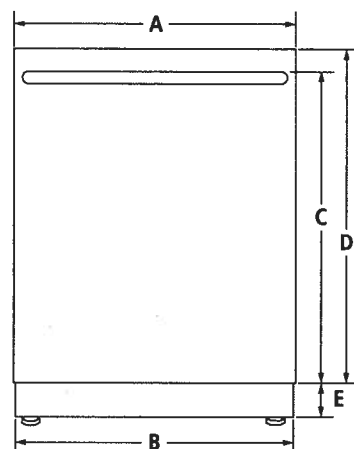

FRONT VIEW

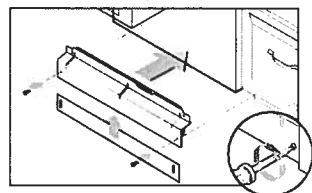

ADJUSTABLE TOE KICK

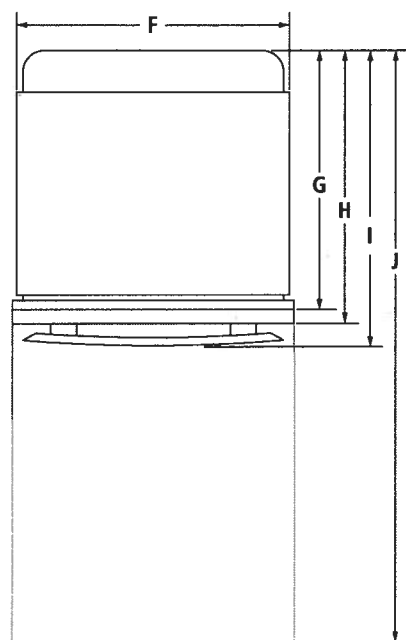

TOP VIEW

MODEL #		JDB9800CW JDB9200CW JDB9000CW	
		in	cm
A	Width of door	23½	59.7
B	Width of toe kick	23½	59.7
C	Height to top of handle Pro-Style® Stainless	27⅞	70.8
	Euro-Style (color-coordinating)	27⅞	70.8
	Floating Glass	27⅞	70.8
D	Height of door Pro-Style® Stainless	30	76.3
	Euro-Style (color-coordinating)	30	76.3
	Floating Glass	30	76.3
E	Height of adjustable toe kick (min.-max.)	3½- 4⅞	8.9- 10.5
F	Width of recessed dishwasher	23¾	60.4
G	Depth with tub flange	22⅞	57.4
H	Depth with door Pro-Style® Stainless	24⅞	62.6
	Euro-Style (color-coordinating)	24⅞	62.6
	Floating Glass	25	63.5
I	Depth with handle Pro-Style® Stainless	27⅞	70.8
	Euro-Style (color-coordinating)	26⅞	68.3
	Floating Glass	27⅞	70.8
J	Depth with door fully open	49¾	126.3

IMPORTANT: Dimensional specifications are provided for planning purposes only.

Do not make any cutouts based on this information. Refer to the Installation or Use & Care Guide before selecting cabinetry, verifying electrical/gas connections, making cutouts or beginning installation.

All Jenn-Air® appliances are appropriately UL, CUL or CSA approved.

DISHWASHERS

JDB9800CW, JDB9200CW, JDB9000CW – 23¾" x 33⅞" x 26⅞" (including handle)

DIMENSIONS AS INSTALLED

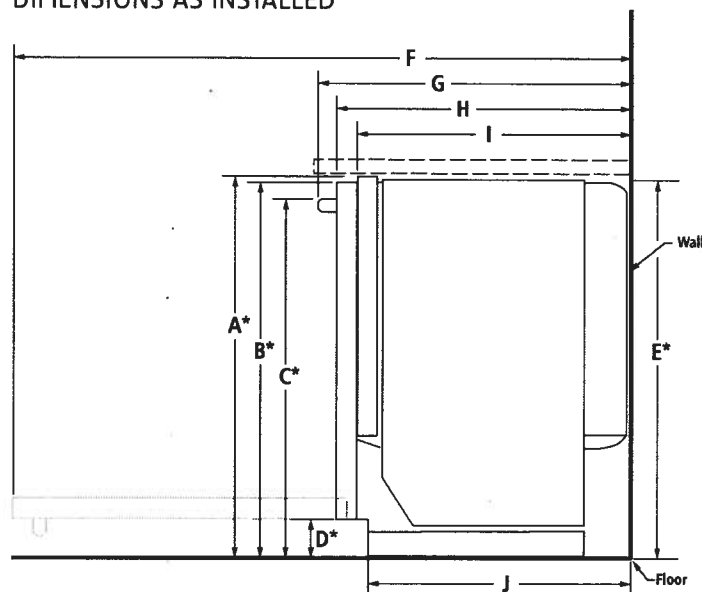

SIDE VIEW

MODEL #		JDB9800CW JDB9200CW JDB9000CW	
		in	cm
A*	Height to top of tub flange (min.)	33⅞	86.0
B*	Height to top of door (min.)	33¾	85.7
C*	Height to top of handle (min.)		
	Pro-Style® Stainless	31½	80.1
	Euro-Style (color-coordinating)	31½	80.1
	Floating Glass	31½	80.1
D*	Height to bottom of door	3⅞	9.4
E*	Height of recessed dishwasher (min.)	33⅞	85.5
F	Depth with door fully open (min.)	49¾	126.3
G	Depth with handle (min.)		
	Pro-Style® Stainless	27⅞	70.8
	Euro-Style (color-coordinating)	26⅞	68.3
	Floating Glass	27⅞	70.8
H	Depth with door (min.)	24⅞	62.6
I	Depth with tub flange (min.)	22⅞	57.4
J	Depth with toe kick (min.)	20⅞	52.9

*With wheels removed. Add up to ⅞" (1.6 cm) to height with wheels and leg levelers fully extended.

IMPORTANT: Dimensional specifications are provided for planning purposes only.

Do not make any cutouts based on this information. Refer to the Installation or Use & Care Guide before selecting cabinetry, verifying electrical/gas connections, making cutouts or beginning installation.

All Jenn-Air® appliances are appropriately UL, CUL or CSA approved.



8768CdZw416

DISHWASHERS

JDB9800CW, JDB9200CW, JDB9000CW – 23¾" x 33⅞" x 26⅞" (including handle)

OPENING/CLEARANCE DIMENSIONS

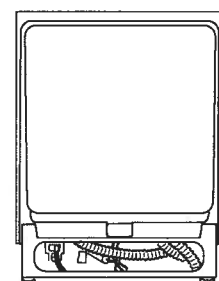
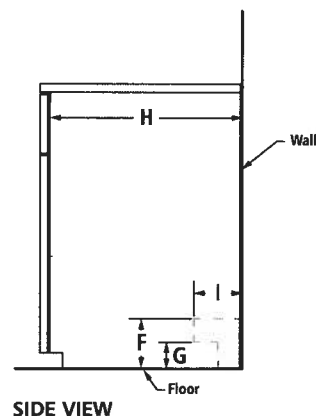
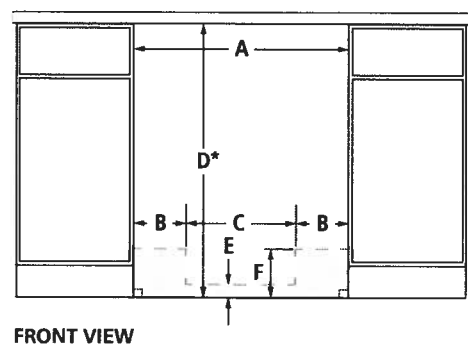

MODEL #		JDB9800CW JDB9200CW JDB9000CW	
		in	cm
A	Width (min.)	24	61.0
B	Width of possible utility installation area (back wall)	6¾	17.2
C	Width of clear area (back wall)	10½	26.7
D*	Height with wheels removed (min.)	33⅞	86.0
E	Height of possible utility installation area (back wall)	2½	6.4
F	Height of possible utility installation area (back/side wall)	6¾	15.9
G	Height of clear area (side wall)	3	7.6
H	Depth (min.)	24	61.0
I	Depth of utility location (side wall)	4	10.2

Electrical, water and drain connections may be installed in shaded areas

Recommended drain connection location – closest to sink	1½ dia. 3.8 dia.
Recommended electrical connection location – right-hand side or back wall	1½ dia. 3.8 dia.
Recommended water connection location – left-hand side or back wall	½ dia. 1.3 dia.

*Measured from the lowest point on the underside of countertop.

ELECTRICAL REQUIREMENTS

120 volt, 60 Hz, AC only, 15- or 20-amp fused, grounded circuit is required. A dedicated circuit is recommended. Use an outlet that cannot be turned off by a switch. Do not use an extension cord.

WATER SUPPLY REQUIREMENTS

120°F (49°C) hot water supply with water pressure between 20 and 120 psi (138 and 862 kPa) is required. If you have questions about your water pressure, call a licensed, qualified plumber.

DRAIN REQUIREMENTS

Connect drain hose to waste tee or disposer inlet above drain trap. Maximum drain hose length 12' (3.7 m).

LOCATION REQUIREMENTS

Corner locations require a 2" (5.1 cm) minimum clearance between the side of the dishwasher door and the wall or cabinet.

IMPORTANT: Dimensional specifications are provided for planning purposes only.

Do not make any cutouts based on this information. Refer to the Installation or Use & Care Guide before selecting cabinetry, verifying electrical/gas connections, making cutouts or beginning installation.

All Jenn-Air® appliances are appropriately UL, CUL or CSA approved.



8768CdZw416

JENN-AIR® DETAILED PLANNING DIMENSIONS

1 of 2

36"/30" PYRAMID-STYLE WALL-MOUNT CANOPY HOODS

JXW8536DS – 36" x 24⁵/₈"-42⁵/₈" x 19¹/₁₆"

JXW8530DS – 30" x 24⁵/₈"-42⁵/₈" x 19¹/₁₆"

PRODUCT DIMENSIONS

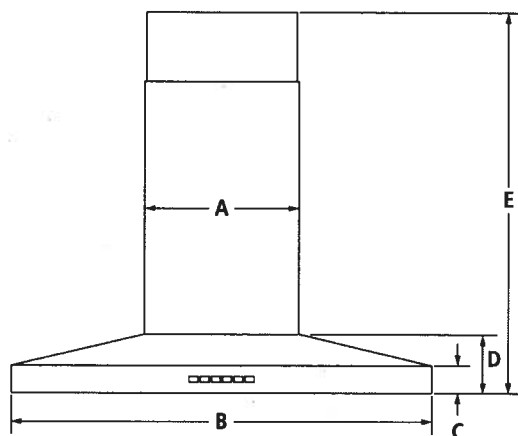

FRONT VIEW

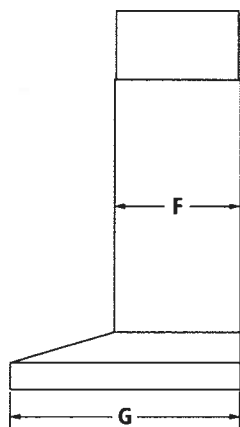

SIDE VIEW

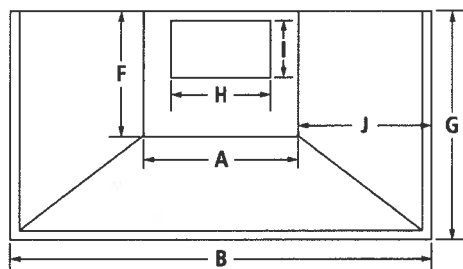

TOP VIEW

MODEL #		JXW8536DS		JXW8530DS	
		in	cm	in	cm
A	Width of chimney	13 ³ / ₁₆	33.5	13 ³ / ₁₆	33.5
B	Width of canopy	36	91.4	30	76.2
C	Height of trim	2 ³ / ₈	6.1	2 ³ / ₈	6.1
D	Height of canopy	5	12.7	5	12.7
E	Overall height with vented installation (min.-max.)	24 ⁵ / ₈ -38 ³ / ₄	62.5-98.4	24 ⁵ / ₈ -38 ³ / ₄	62.5-98.4
	Overall height with non-vented (recirculating) installation (min.-max.)	28 ⁵ / ₁₆ -42 ⁵ / ₈	71.9-108.3	28 ⁵ / ₁₆ -42 ⁵ / ₈	71.9-108.3
F	Depth of chimney	10 ³ / ₄	27.3	10 ³ / ₄	27.3
G	Depth of canopy	19 ¹ / ₁₆	50.0	19 ¹ / ₁₆	50.0
H	Width of vent collar	6 ¹ / ₄	15.8	6 ¹ / ₄	15.8
I	Depth of vent collar	3 ³ / ₄	9.5	3 ³ / ₄	9.5
J	Width from chimney to edge of canopy	11 ¹ / ₁₆	29.0	8 ⁷ / ₁₆	21.4

IMPORTANT: Dimensional specifications are provided for planning purposes only.

Do not make any cutouts based on this information. Refer to the Installation or Use & Care Guide before selecting cabinetry, verifying electrical/gas connections, making cutouts or beginning installation.

All Jenn-Air® appliances are appropriately UL, CUL or CSA approved.



8316AdZw1114

JENN-AIR® DETAILED PLANNING DIMENSIONS

2 of 2

36"/30" PYRAMID-STYLE WALL-MOUNT CANOPY HOODS

JXW8536DS – 36" x 24⁵/₈"-42⁵/₈" x 19¹/₁₆"

JXW8530DS – 30" x 24⁵/₈"-42⁵/₈" x 19¹/₁₆"

OPENING/CLEARANCE DIMENSIONS

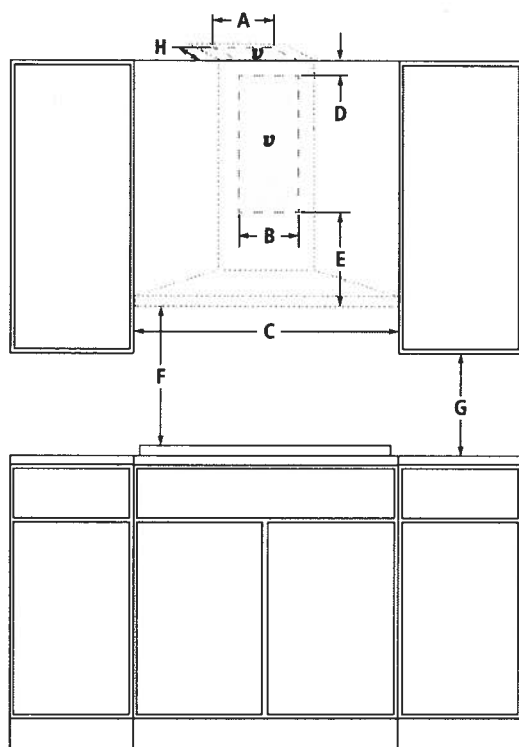

FRONT VIEW

MODEL #		JXW8736DS		JXW8530DS	
		in	cm	in	cm
A	Width of entry location for vent and power supply – ceiling option (min.-max.)	10-13	25.4-33.0	10-13	25.4-33.0
B	Width of entry location for vent and power supply – wall option (min.-max.)	10-13	25.4-33.0	10-13	25.4-33.0
C	Width of cabinet opening (min.)	36	91.4	30	76.2
D	Minimum height from entry location to ceiling for vent and power supply – wall option (vented installation)	2	5.1	2	5.1
E	Minimum height from entry location to ceiling for vent and power supply – wall option (non-vented installation)	9	22.9	9	22.9
F	Height from hood to entry location for vent and power supply – wall option (min.)	17	43.2	17	43.2
G	Suggested distance from hood to electric cooking surface (min.-max.)	24-36	61.0-91.4	24-36	61.0-91.4
H	Suggested distance from hood to gas cooking surface (min.-max.)	27-36	68.6-91.4	27-36	68.6-91.4
v	Height from upper cabinet to countertop (min.)	18	45.7	18	45.7
H	Depth of entry location for vent and power supply – ceiling option	9½	24.1	9½	24.1
v	Recommended vent and power supply entry location				

ELECTRICAL REQUIREMENTS

120 volt, 60 Hz, AC only, 15-amp fused, electrical circuit is required.

VENTING REQUIREMENTS

The hood is factory set for venting through the roof or wall. For non-vented (recirculating) installation, refer to recirculation kit instructions for further information.

LOCATION REQUIREMENTS

Mounting structure must be able to support 60 lb (27.2 kg).

For vented installation, the chimney can be adjusted for ceilings between 7' 1" (2.16 m) and 9' 2" (2.79 m).

For non-vented (recirculating) installation, the chimney can be adjusted for ceilings between 7' 1" (2.16 m) and 9' 6" (2.90 m).

IMPORTANT: Dimensional specifications are provided for planning purposes only.

Do not make any cutouts based on this information. Refer to the Installation or Use & Care Guide before selecting cabinetry, verifying electrical/gas connections, making cutouts or beginning installation.

All Jenn-Air® appliances are appropriately UL, CUL or CSA approved.



8316AdZw1114



Front-Loading Washer

PRODUCT MODEL NUMBERS

MHW3000B, MHW3500B, MHW4000B, MHW4200B, MHW6000A, MHW7000A, MHW8000A, MHW3100D, MHW4100D, MHW4300D, MHW4400D, MHW5100D, MHW5400D, MHW7100D, MHW8100D, MHW3505F, MHW3500F, MHW5500F, MHW8200F, MHW8150E

Washer Dimensions:

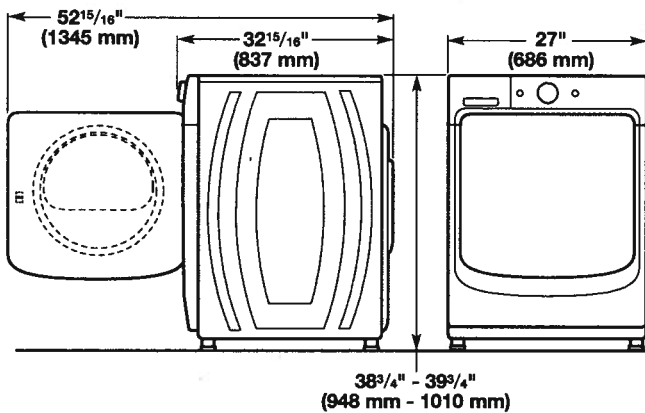

Undercounter installation - washer only:

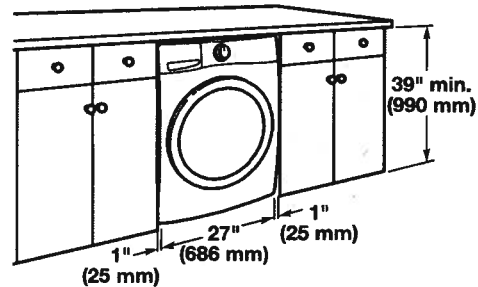

Recessed or closet installation - stacked washer and dryer

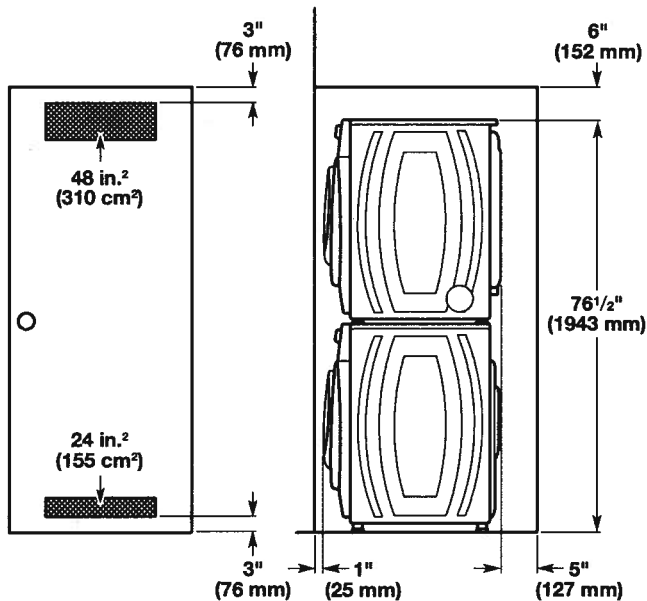

*Add spacing of 1" (25 mm) on all sides of washer/dryer.

Recessed area or closet installation (washer only):

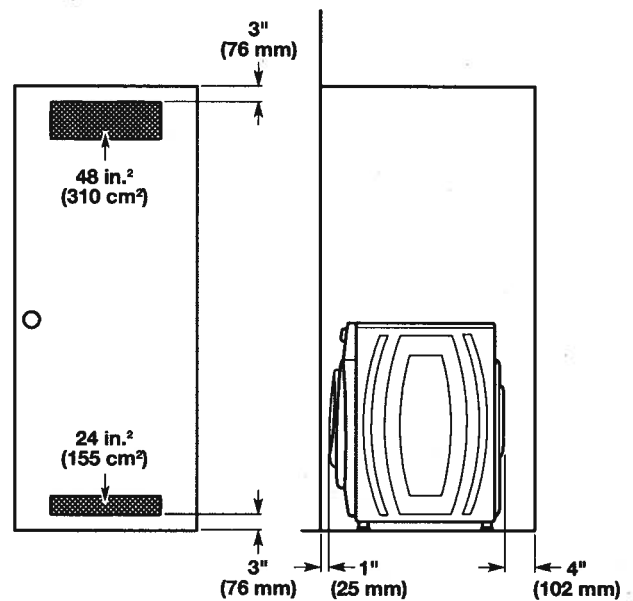

*Add spacing of 1" (25 mm) on all sides of washer.

Custom cabinet installation (washer only):

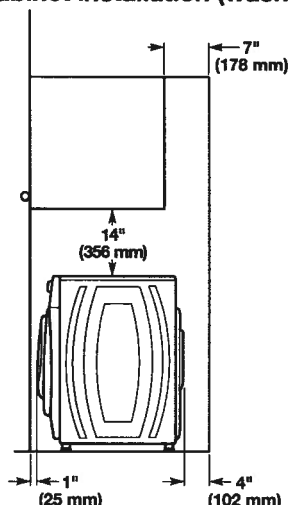

**Recommended 4" (102 mm), minimum 1.5" (38 mm)

All dimensions show recommended spacing allowed, except for closet door ventilation openings, which are the minimum required.

For each arrangement, consider allowing more space for ease of installation and servicing, spacing for companion appliances, and clearances for walls, doors, and floor moldings.

Space must be large enough to allow door to fully open.

Add spacing of 1" (25 mm) on all sides of washer to reduce noise transfer. If a closet door or louvered door is installed, top and bottom air openings in door are required.

ELECTRICAL REQUIREMENTS

A 120-volt, 60-Hz., AC only, 15- or 20-amp fused electrical supply is required. A time-delay fuse or circuit breaker is recommended. It is recommended that a separate circuit serving only this appliance be provided.

DRAIN SYSTEM

Drain system can be installed using a floor drain, wall standpipe, floor standpipe, or laundry tub. Select method you need.

IMPORTANT: To avoid siphoning, only 4.5" (114 mm) of drain hose should be inside standpipe. Always secure drain hose with a cable tie.

Floor standpipe drain system

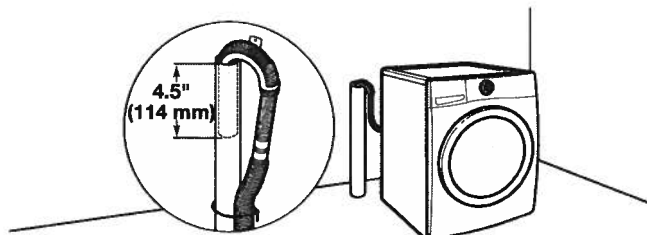

Minimum diameter for a standpipe drain: 2" (51 mm). Minimum carry-away capacity: 17 gal. (64 L) per minute. A 1/4" (6 mm) diameter to 1" (25 mm) diameter Standpipe Adapter Kit is available (Part Number 3363920). Top of standpipe must be at least 30" (762 mm) high; install no higher than 96" (2.44 m) from bottom of washer. If you have an overhead sewer and need to pump higher than 96" (2.44 m), a sump pump and associated hardware are needed. See "Alternate Parts".

Wall standpipe drain system

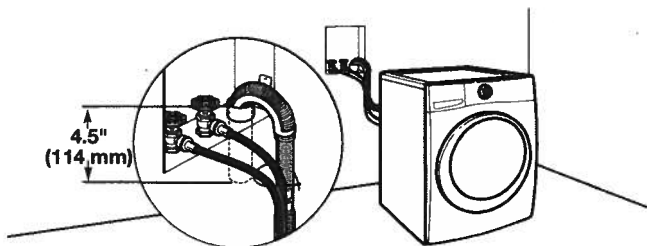

See requirements for floor standpipe drain system.

Laundry tub drain system

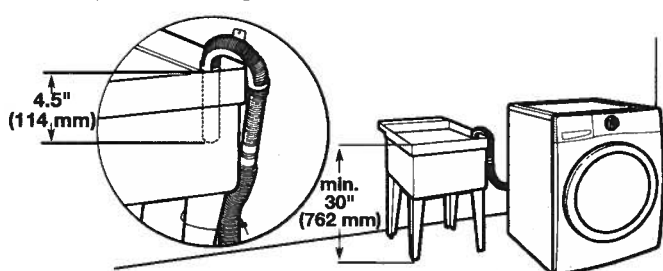

Minimum capacity: 20 gal. (76 L). Top of laundry tub must be at least 30" (762 mm) above floor; install no higher than 96" (2.44 m) from bottom of washer.

Floor drain system

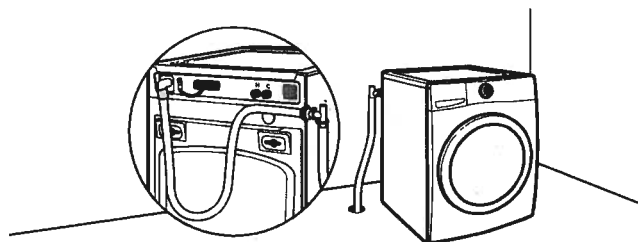

Floor drain system requires a Siphon Break Kit (Part Number 285834), 2 Connector Kits (Part Number 285835), and an Extension Drain Hose (Part Number 285863) that may be purchased separately. See "Alternate Parts". Minimum siphon break height: 28" (710 mm) from bottom of washer. Additional hoses may be needed.

Because Whirlpool Corporation policy includes a continuous commitment to improve our products, we reserve the right to change materials and specifications without notice.

Dimensions are for planning purposes only. For complete details, see Installation Instructions packed with product. Specifications subject to change without notice.



ELECTRIC DRYER

PRODUCT MODEL NUMBERS

MED3500F, MED5500F, MED8200F

Front view

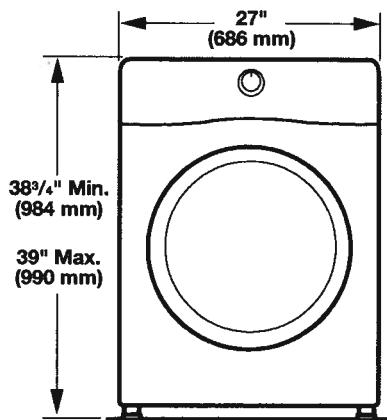

Side view

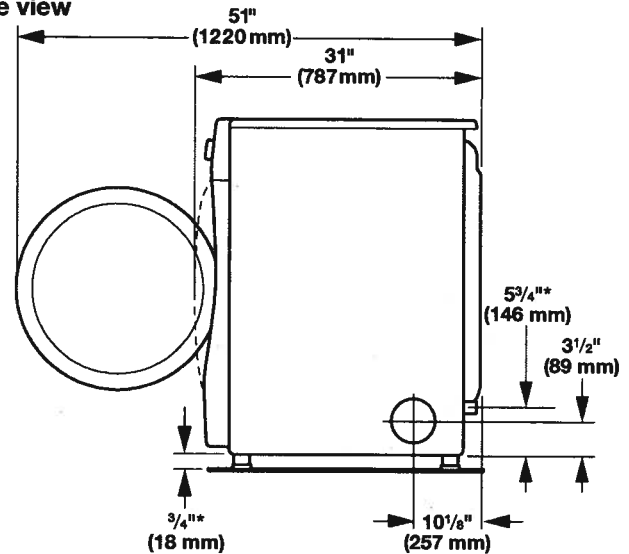

Back view

NOTE: Most installations require a minimum of 5" (127 mm) clearance behind dryer for exhaust vent with elbow. See "Venting Requirements."

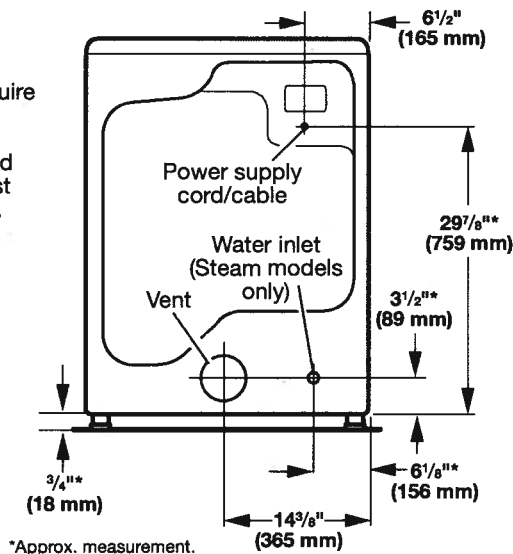

*Approx. measurement.

Recommended installation clearances

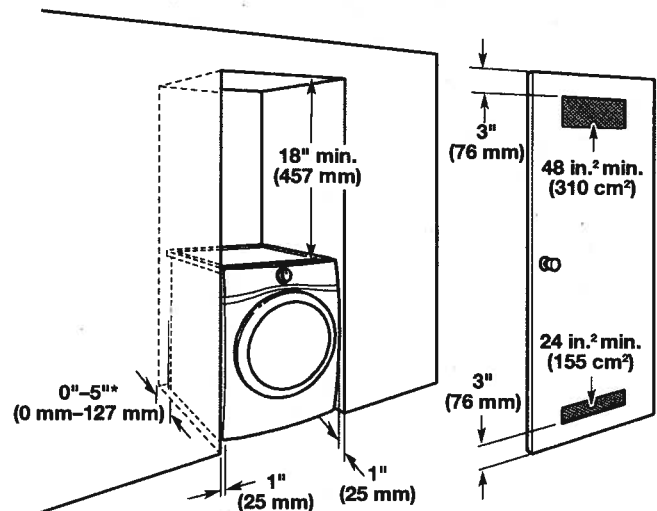

*0" (0 mm) spacing is allowed for straight-back venting only. For steam models only, inlet hose must not be kinked.

Spacing for recessed area or closet installation

All dimensions show recommended and minimum spacing allowed.

- Additional spacing should be considered for ease of installation and servicing.
- Additional clearances might be required for wall, door, and floor moldings.
- Additional spacing should be considered on all sides of the dryer to reduce noise transfer.
- For closet installation with a door, minimum ventilation openings in the top and bottom of the door are required. Louvered doors with equivalent ventilation openings are acceptable.
- Companion appliance spacing should also be considered.

INSTALLATION REQUIREMENTS

ELECTRICAL REQUIREMENTS

To supply the required 3- or 4-wire, single phase, 120/240 volt, 60 Hz, AC only electrical supply (or 3- or 4-wire, 120/208 volt electrical supply, if specified on the serial/rating plate) on a separate 30-amp circuit, fused on both sides of the line. Connect to an individual branch circuit. Do not have a fuse in the neutral or grounding circuit.

WATER (STEAM MODELS ONLY) REQUIREMENTS

The dryer must be connected to the cold water faucet using new inlet hoses (not supplied). Do not use old hoses. Do not overtighten. Damage to the coupling can result.

VENTING REQUIREMENTS

Exhaust venting: Exhaust your dryer to the outside. 4" (102 mm) diameter vent is required. Rigid or flexible metal exhaust vent must be used. Do not use plastic or metal foil vet. Exhaust hood must be at least 12" (305 mm) from the ground or any object that may be in the path of the exhaust.

Exhaust hoods:

Recommended styles:

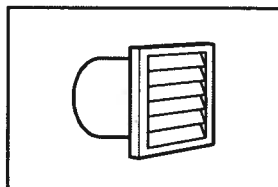

Louvered Hood

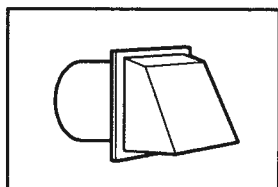

Box Hood

Acceptable style:

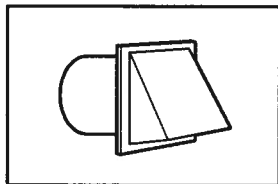

Angled Hood

Determine vent path:

- Select route that will provide straightest and most direct path outdoors.
- Plan installation to use fewest number of elbows and turns.
- When using elbows or making turns, allow as much room as possible.
- Bend vent gradually to avoid kinking.
- Use as few 90° turns as possible.

Determine vent length and elbows needed for best drying performance:

- Use the following "Vent System Charts" to determine type of vent material and hood combinations acceptable to use.
NOTE: Do not use vent runs longer than those specified in "Vent System Charts."
- Shorten life of dryer.
- Reduce performance, resulting in longer drying times and increased energy usage.

The "Vent System Charts" provide venting requirements that will help achieve best drying performance.

Standard Vent System Chart

Number of 90° elbows	Type of vent	Angled hoods
0	Rigid metal	64 ft. (20 m)
1	Rigid metal	54 ft. (16.5 m)
2	Rigid metal	44 ft. (13.4 m)
3	Rigid metal	35 ft. (10.7 m)
4	Rigid metal	27 ft. (8.2 m)

Long Vent System Chart

Number of 90° elbows	Type of vent	Angled hoods
0	Rigid metal	160 ft. (48.8 m)
1	Rigid metal	150 ft. (45.7 m)
2	Rigid metal	140 ft. (42.7 m)
3	Rigid metal	130 ft. (39.6 m)
4	Rigid metal	120 ft. (36.6 m)

To determine if your model has a long vent system, refer to the type code located on the serial number plate in the inner door well. Example: An electric model would be **DALV** (Long Vent) – ELE – XXXXXXX-XXX.

NOTE: For long vent systems, use of box/louvered hoods will improve venting, regardless of length.