



CONSTRUCTION SUMMARY

75 - 1 - PRESTON 8 (30-1C) ELEV A
CABINETRY - BASE CABINETS

Inv.764	1 - BANK OF DRAWERS- 55 CM (SUBJECT TO FLOOR PLAN) NEXT TO SINK (IF POSSILE) SEE SKETCH "A"
Line9287	Note:
11May16 / 15Jul16	

CONSTRUCTION

Inv.764	1 - INCREASE SIZE OF SLIDING DOOR (8FT) SEE SKETCH
Line8927	Note:
11May16 / 15Jul16	

Inv.764	1 - MOVE WALL 3FT(INCREASING SIZE OF KITCHEN) RELOCATE WASHER/DRYER AREA WASHER/DRYER, TUB AND VENT TO BASEMENT SEE SKETCH"A"
Line8928	Note:
11May16 / 15Jul16	

Inv.764	1 - DELETE CLOSET AND WALL IN HALLWAY NEAR ENTRANCE TO THE GARAGE. SEE SKETCH "A"
Line8929	Note:
11May16 / 15Jul16	

Inv.764	1 - CLOSE OFF SMALLER AREA(LESS 3FT) OF PREVIOUS LAUNDRY ROOM(CREATING A SMALL CLOSET WITH A DOOR) SEE SKETCH "A"
Line9271	Note:
11May16 / 15Jul16	

Inv.958	1 - FAMILY ROOM/OPT BED 4-ADD TOP OF WALL TO THE HALF WALL, AND PUT IN A DOUBLE DOOR CLOSET. SEE SKETCH "A"
Line9306	Note:
9Jul16 / 15Jul16	

Inv.958	1 - MASTER ENSUITE: RELOCATE TUB AND SHOWER (SEE SKETCH "A") , MOVE VANITY WALL BACK INTO BEDROOM 3(AS FAR,AS UP TO THE BEDROOM 3CLOSET DOOR IF POSSIBLE) TURN TUB FROM CORNER TO SIDE WALL.
Line9308	Note: NOTE: PURCHASER TO KNOW THAT NO CREDITS ARE GIVEN FOR MAJOR UPGRADES AND ARE BEING CHARGED TO CHANGE A CORNER DEEPER SOAKER TUB FOR A STANDAR 5 FOOT TUB
9Jul16 / 15Jul16	

Inv.958	1 - BEDROOM 2-DELETE WALL AND CLOSET-MOVE WALL OF WALK IN CLOSET GOING INTO FAMILY ROOM UP TO LEVEL WITH BEDROOM WALL. SEE SKETCH "A" SECOND FLOOR
Line9305	Note:
9Jul16 / 15Jul16	

Inv.958	1 - BEDROOM 3-DELETE DOUBLE DOOR CLOSETS MOVING WALL IN TO BE ABLE TO MOVE SUITE WALL OUT. SEE SKETCH "A" SUPPLY AND INSTALL DOUBLE DOOR CLOSET ON WALL NEXT TO DOORWAY
Line9307	Note:
9Jul16 / 15Jul16	

ELECTRICAL

Inv.764	1 - SUPPLY AND INSTAL 210 OUTLET IN GARAGE. SEE SKETCH "A"
Line8930	Note:
11May16 / 15Jul16	

MISCELLANEOUS



CONSTRUCTION SUMMARY

75 - 1 - PRESTON 8 (30-1C) ELEV A

Inv.764	1 - DELETE ISLAND AND , RELOCATE SINK NEXT TO DISHWASHER , (HAVE SINK , DISHWASHER, STOVE ALL AND EXISTING CABINETRY STANDARD ON ONE SIDE OF KITCHEN) . (SEE SKETCH "A")
Line9272	Note: PLUMBING NEEDS TO BE MOVED.
11May16 / 15Jul16	

PLUMBING

Inv.764	1 - LEAVE ROUGH IN FOR SINK AND RELOCATE TUB IN BASMENT
Line9288	Note: NO CHARGE
11May16 / 15Jul16	

STAIRS AND RAILING

Inv.958	1 - STAIRS - UPGRADE - OAK
Line9309	Note:
9Jul16 / 15Jul16	
Inv.958	1 - IRON PICKETS ON STAIRCASE
Line9311	Note:
9Jul16 / 15Jul16	

Lot 75-PRESTON 8-MAIN FLOOR



35 ft. SERIES

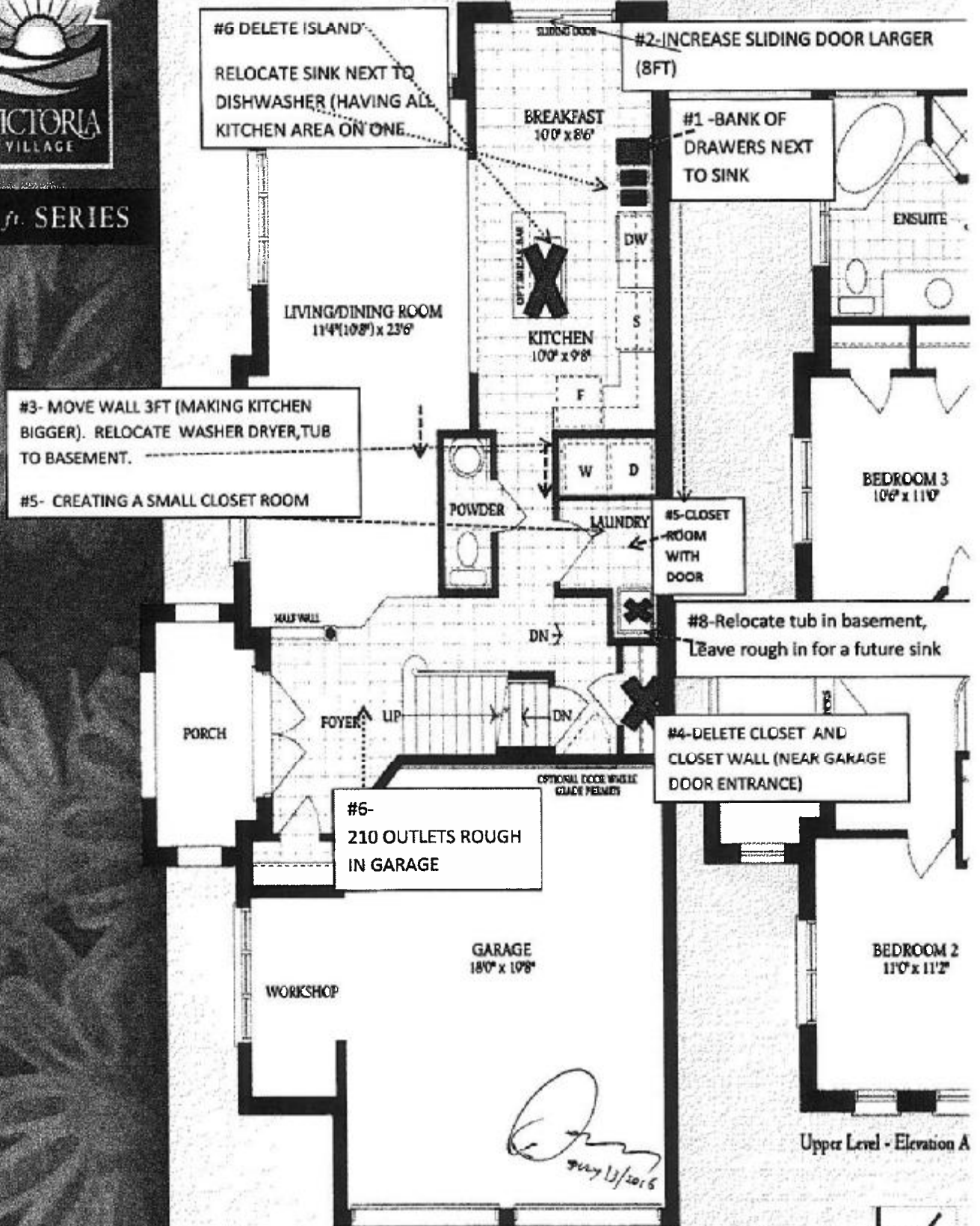

Main Level - Elevation A

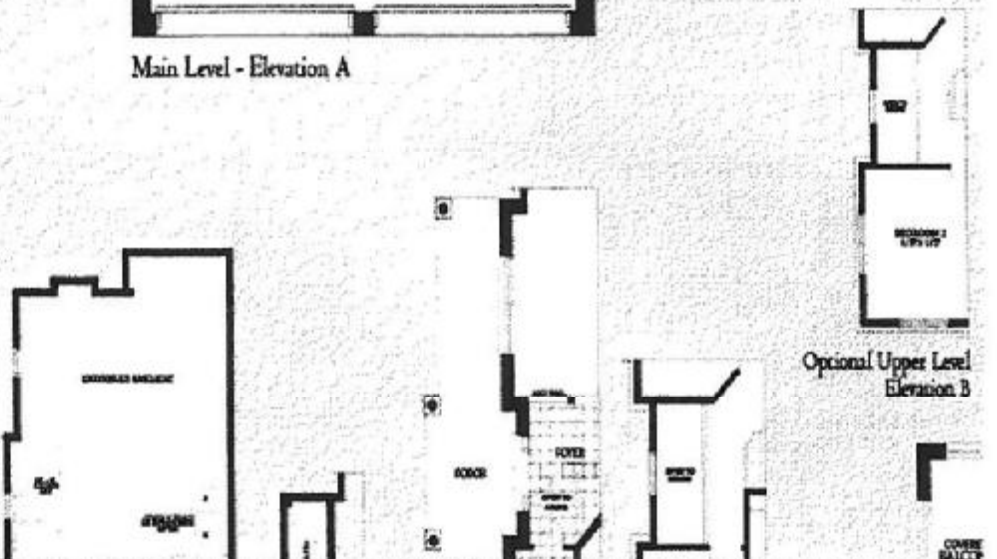

Preston 8-second floor

Sketch "A"

#1-(BEDROOM 2) DELETE WALL & CLOSET-

MOVE WALL OF WALK IN CLOSET GOING INTO FAMILY ROOM UP TO LEVEL WITH BEDROOM WALL

#3-(BEDROOM 3)-DELETE DOUBLE DOOR CLOSETS MOVING WALL IN, TO BE ABLE TO MOVE ENSUITE WALL OUT.
~SUPPLY AND INSTALL DOUBLE DOOR CLOSET ON WALL NEXT TO DOORWAY

Upper Level - Elevation A

BEDROOM 2
11'0" x 11'2"

BEDROOM 3
10'6" x 11'0"

ENSUITE

OPTIONAL
D.V.G. FIREPLACE

FAMILY ROOM /
OPT. BED. 4
11'8" x 12'0"

BATH

WALK-IN
CLOSET

BEDROOM
x 15'0"

#4-ENSUITE-MOVE ENSUITE WALL BACK (INTO BEDROOM 3 TO END OF CLOSET OR AS FAR AS POSSIBLE),
~RELOCATE SHOWER NEXT TO VANITY, AND TOILET NEXT TO TUB. TURN TUB FROM CORNER TO SIDE WALL

#2-(2ND FLOOR FAMILY ROOM/OPT BEDR 4)-ADD TOP OF THE WALL TO THE HALF WALL, AND PUT INSERT A DOUBLE DOOR CLOSET.

July 9/2016