



CONSTRUCTION SUMMARY

TH 1 Block 11 - 1 - Bedford 7 Elev A

Extras at Time of Sale

GRANITE KITCHEN COUNTER TOP AND UNDERMOUNT SINK

Worksheet Note:

VENDOR TO SUPPLY AND INSTALL A 5 FT. BY 7 FT. DECK WITH STAIRS TO GRADE

Worksheet Note:

ELECTRICAL

Inv.579	4 - POT LIGHT - LED - 1ST FLOOR NON INSULATED CEILING - PRICE IS PER POT LIGHT X4 IN KITCHEN - AS PER SKETCH -
Line5583	Note:
25Jan16 / 31May16	
Inv.579	1 - MOVE EXISTING KITCHEN CEILING OUTLET - CENETERED ABOVE BREAKFAST BAR - AS PER SKETCH
Line5588	Note:
25Jan16 / 31May16	
Inv.579	1 - SWITCH - 2 WAY SWITCH FOR CEILING OUTLET MOVED FROM KITCHEN TO CENTERED ABOVE BREAKFAST BAR -
Line5884	Note:
25Jan16 / 31May16	

HARDWOOD FLOORING

Inv.579	1 - HARDWOOD FLOORING - STANDARD SERIES - 2 1/4 MERCIER SOLID OAK - LANDINGS
Line5744	Note:
25Jan16 / 31May16	

PLUMBING

Inv.579	1 - ICE MAKER ROUGH IN - WATERLINE TO FRIDGE FOR ICEMAKER
Line5587	Note:
25Jan16 / 31May16	

STAIRS AND RAILING

Inv.579	1 - UPGRADE RAILING - UPGRADE 2 - LEVEL 1 - WROUGHT IRON - BLACK
Line5586	Note:
25Jan16 / 31May16	

TH 1
BLK 11

PATIO DOOR

GREAT ROOM
17'6"x12'6"

move existing
light fixture
↓ on new
switch

BREAKFAST
9'0"x11'2"

FLUSH

DW

pot
lights

KITCHEN
8'6"x11'2"

S

F

UP

DN

PWD

DOOR & STEPS
WHERE GRADE
PERMITS

DN

SUNKEN
FOYER

GARAGE
10'0"x21'0"

PORCH

GROUND FLOOR
ELEV. A

MASTER BEDROOM
11'0"x15'6"

THI
BUC II
No changes
made.

ENSUITE

LINEN

WIC

LAUNDRY

BATH

BEDROOM 3
8'6"x12'0"

VAULTED CEILING

BEDROOM 2
8'8"x13'2"(11'0")

SECOND FLOOR
ELEV. A

BEDROOM 3
01/21/11

BEDROOM 2

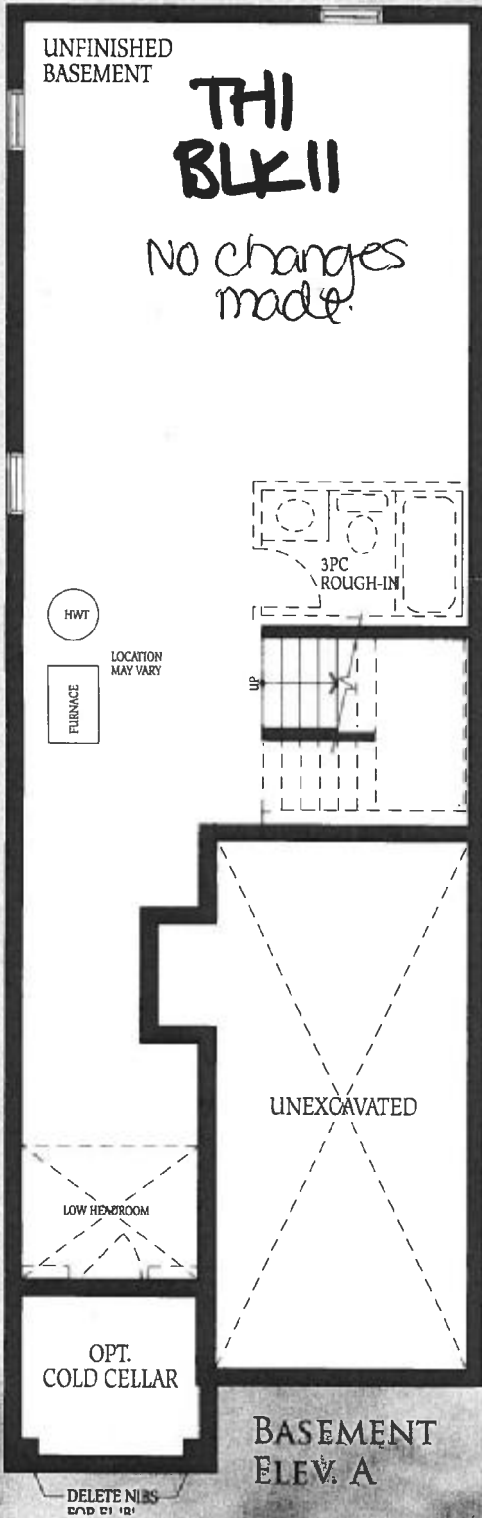

BASEMENT
ELEV. A

The floor plans and elevations are subject to change without notice and are not to be used for construction purposes. The floor plans and elevations are for informational purposes only. Actual usable floor area may vary.