



CONSTRUCTION SUMMARY

15 - 1 - The Rideau 5 (42-5) Elev B
CABINETRY

Inv.372	1 - CABINETRY - KITCHEN - GROUP 7 CLASSIC PAINT
Line3390	Note:
10Oct15 / 9Nov15	
Inv.372	1 - VANITY - BATH - GROUP 7 CLASSIC PAINT
Line3396	Note:
10Oct15 / 9Nov15	
Inv.372	1 - VANITY - SHARED BATHROOM - GROUP 3 VIKING 3
Line3395	Note:
10Oct15 / 9Nov15	
Inv.372	1 - VANITY - MASTER ENSUITE BATHROOM - GROUP 4 - 6 CLASSIC VIKING PAINT
Line3397	Note:
10Oct15 / 9Nov15	
Inv.372	1 - FRIDGE OPENING NEEDS TO BE 48" WIDE, PLEASE ENSURE SIZE OF PANTRY DOES NOT DECREASE. JUST SLIDE OVER CABINETRY TO MAKE ROOM.
Line3506	Note:
10Oct15 / 9Nov15	

CABINETRY - ACCESSORIES

Inv.372	1 - (J10)ACCOMODATE "BUILT IN DESIGNER REFRIDGERATOR "
Line3404	Note:
10Oct15 / 9Nov15	
Inv.372	1 - (B18)POTS & PANS DRAWER (MIN 60CM/MAX 90CM , (SIZE SUBJECT TO FLOORPLAN)
Line3405	Note:
10Oct15 / 9Nov15	
Inv.386	1 - OPTIONAL LIGHT VALANCE - UPPERS
Line3713	Note:
20Oct15 / 30Oct15	

CABINETRY - BASE CABINETS

Inv.372	1 - (B06) BASE PIE CUT CORNER WITH LAZY SUSAN
Line3403	Note:
10Oct15 / 9Nov15	

CABINETRY - UPPER CABINETS

Inv.372	1 - (A02) UPPER ANGLE CORNER
Line3402	Note:
10Oct15 / 9Nov15	

CABINETRY - VANITY CABINETS

Inv.372	2 - (D12)- VANITY TOP DRAWER PRICE PER DRAWER (INCLUDES FALSE DRAWER - BATH
Line3393	Note:
10Oct15 / 9Nov15	
Inv.372	1 - VANITY CABINETS - CLASSIC - VANITY BANK OF DRAWERS - 55CM MAX- MASTER ENSUITE
Line3398	Note:
10Oct15 / 9Nov15	



CONSTRUCTION SUMMARY

15 - 1 - The Rideau 5 (42-5) Elev B
CEILINGS

Inv.37	1 - SMOOTH CEILINGS - 2ND FLOOR
Line576	Note:
30May15 / 9Sep15	
Inv.37	1 - SMOOTH CEILINGS - MAIN FLOOR
Line575	Note:
30May15 / 9Sep15	
Inv.37	1 - OPTIONAL TRAY CEILINGS - MASTER BEDROOM
Line577	Note:
30May15 / 9Sep15	

CONSTRUCTION

Inv.37	1 - ADD STONE AND PRECAST TO FRONT OF HOME AS PER SKETCH.
Line1713	Note: ARCHITECTURAL APPROVAL IS NEEDED
30May15 / 9Sep15	
Inv.37	1 - DELETE WALLS SURROUNDING TOILET IN MASTER ENSUITE. RELOCATE TOILET. as per sketch
Line590	Note:
30May15 / 9Sep15	
Inv.37	1 - RECONFIGURE LAUNDRY ROOM AS PER SKETCH
Line591	Note:
30May15 / 9Sep15	
Inv.37	1 - FRAMELESS 3' X 5' GLASS SHOWER IN LIEU OF 5 FT TUB. INCUDE STANDARD TILES, GLASS PANELS, AND POTLIGHT.
Line592	Note: Change shower size if necessary to make this bathroom work with the bidet.
30May15 / 9Sep15	
Inv.37	1 - CLOSE PASSTHROUGH FROM KITCHEN TO LIV/DINING ROOM. MOVE CABINTRY DOWN TO FILL SPACE OF THE PASS THROUGH (AS PER SKETCH)
Line593	Note:
30May15 / 9Sep15	
Inv.37	1 - DELETE NIB WALLS IN MAIN HALLWAY AND KITCHEN AS PER SKETCH
Line595	Note:
30May15 / 9Sep15	
Inv.37	1 - IN ORDER FOR BIDET TO FIT IN BATH FOR BEDROOM 4, THE WALL BETWEEN THE MEDIA/LOFT BATHROOM WILL HAVE TO BE MOVED 1 FOOT INTO LOFT.
Line1711	Note:
30May15 / 9Sep15	
Inv.37	1 - DELETE DOOR IN BEDROOM 4 BATH SEPERATING TOILETS AND SINK AS PER SKETCH. PRICE INCLUDED IN #19
Line1717	Note:
30May15 / 9Sep15	
Inv.386	1 - 10" HOOD FAN VENT
Line3714	Note:
20Oct15 / 30Oct15	

DO NOT INSTALL



CONSTRUCTION SUMMARY

15 - 1 - The Rideau 5 (42-5) Elev B

Inv.372	4 - TOILET PAPER HOLDER, SOAP HOLDER, TOWEL RACK - DO NOT INSTALL- ALL BATHROOMS
Line3399	Note:
10Oct15 / 9Nov15	

ELECTRICAL

Inv.37	1 - CENTER LIGHT FIXTURE IN LIVING/DINING ROOM
Line588	Note:
30May15 / 9Sep15	
Inv.37	1 - POWDER ROOM LIGHT - CEILING MOUNT WITH A FIXTURE
Line589	Note:
30May15 / 9Sep15	
Inv.37	1 - CENTER STAIRWAY LIGHT AS PER SKETCH
Line1712	Note:
30May15 / 9Sep15	

HARDWOOD FLOORING

Inv.372	1 - HARDWOOD FLOORING - UPGRADE 7 - 5 INCH VINTAGE OAK ENGINEERED SCRAPED - FAMILY
Line3386	Note:
10Oct15 / 9Nov15	
Inv.372	1 - HARDWOOD FLOORING - UPGRADE 7 - 5 INCH VINTAGE OAK ENGINEERED SCRAPED - LANDING- INCLUDES BASEMENT LANDING
Line3387	Note: PRICE DIFFERENCE PAID IN PE 37
10Oct15 / 9Nov15	
Inv.372	1 - HARDWOOD FLOORING - UPGRADE 7 - 5 INCH VINTAGE OAK ENGINEERED SCRAPED - LIVING AND DINING
Line3388	Note:
10Oct15 / 9Nov15	
Inv.372	1 - HARDWOOD FLOORING - UPGRADE 7 - 5 INCH VINTAGE OAK ENGINEERED SCRAPED - STUDY
Line3389	Note:
10Oct15 / 9Nov15	
Inv.372	1 - HARDWOOD FLOORING - UPGRADE 7 - 5 INCH VINTAGE OAK ENGINEERED SCRAPED - UPPER HALL
Line3400	Note: PRICE DIFFERENCE PAID IN PE 37
10Oct15 / 9Nov15	
Inv.37	1 - HARDWOOD - STANDARD - 2¼ MERCIER SOLID OAK - STANDARD COLOURS - UPPER HALL
Line1374	Note: MEDIA LOFT TO REMAIN BERBER CARPET
30May15 / 9Sep15	
Inv.37	1 - HARDWOOD - STANDARD - 2¼ MERCIER SOLID OAK - STANDARD COLOURS - LANDING, INCLUDES BASEMENT STAIRS LANDING
Line1373	Note:
30May15 / 9Sep15	

HEATING & VENTILATION

Inv.37	1 - GAS LINE - ROUGH IN GAS LINE -STOVE
Line581	Note:
30May15 / 9Sep15	



CONSTRUCTION SUMMARY

15 - 1 - The Rideau 5 (42-5) Elev B
PAINT AND STAIN

Inv.372	1 - STAIN OAK RAILINGS AND STAIRS - RAILINGS - PICKETS - NEWEL POST - NOSING - STRINGERS - TREADS AND RISERS - WROUGHT IRON PICKETS - COMPLETE- STAIN OAK - PRICE IS PER SET
Line3406	Note:
10Oct15 / 9Nov15	

PLUMBING

Inv.37	1 - BIDET - ROUGH - IN BIDET -MASTER ENSUITE AS PER SKETCH
Line582	Note:
30May15 / 9Sep15	
Inv.37	1 - BIDET - ROUGH - IN BIDET - BEDROOM 4 ENSUITE AS PER SKETCH
Line583	Note:
30May15 / 9Sep15	
Inv.37	1 - BAR SINK ROUGH - IN BAR SINK - INCLUDES ABS WASTE AND VENT ONLY - IN BASEMENT AS PER SKETCH
Line584	Note:
30May15 / 9Sep15	
Inv.384	1 - ICE MAKER ROUGH IN - WATERLINE TO FRIDGE FOR ICEMAKER
Line3712	Note:
20Oct15 / 30Oct15	

STAIRS AND RAILINGS / NOSINGS

Inv.37	1 - STAIRS TO BASEMENT - OAK - NATURAL STAIN
Line586	Note:
30May15 / 9Sep15	
Inv.37	1 - UPGRADE RAILING - UPGRADE 2 - LEVEL 2 - WROUGHT IRON - BLACK
Line587	Note:
30May15 / 9Sep15	

TRIM CARPENTRY

Inv.372	1 - INTERIOR TRIM - UPGRADE 2 - 3INCH BACKBAND CASING - 7 1/4 MDF BASEBOARD
Line3401	Note:
10Oct15 / 9Nov15	



INTERIOR COLOUR SCHEME

** Document is NOT locked **

Purchasers: FILOMENA PALMIERI & LANFRANCO PALMIERProperty: 15

Telephone Res. / Bus: (905) 303-5896 / (905) 760-7840Project: Bradford Capital Holdings Inc.

Decor Advisor: Jessica BoardmanModel and Elevation: The Rideau 5 (42-5) Elev B

Lock Date: 10-Oct-15Plan #: 51M-1063

Layout Changes: ☒ Yes ☐ No

Sketch Attached: ☒ Yes ☐ No

Exterior Colour Scheme: #6

1. Kitchen and Vanities

	Style and Colour	Hardware
Kitchen / Breakfast	BOSTON PAINT - MACADEMIA -UPGRADE 3	9677
Laundry Room	RIDEAU-ONTARIO WHITE	9677
Powder Room	N/A	
Master Ensuite Bathroom	BOSTON MAPLE- SOAPSTONE - UPGRADE 2	9677
SHARED BATH	CAMDEN MAPLE - SOAPSTONE - UPGRADE 1	9677
BATH	MANCHESTER- WINTER WHITE UPGRADE 2	9677

Comment

(D12)- VANITY TOP DRAWER PRICE PER DRAWER (INCLUDES FALSE DRAWER) - BATH
VANITY CABINETS - CLASSIC - VANITY BANK OF DRAWERS - 55CM MAX- MASTER ENSUITE
(B06) BASE PIE CUT CORNER WITH LAZY SUSAN
(A02) UPPER ANGLE CORNER
(J09)66CM "COUNTER DEPTH"FRIDGE CABINET (1 GABLE & CABINET 59CM DEEP)
(B18)POTS & PANS DRAWER (MIN 60CM/MAX 90CM , (SIZE SUBJECT TO FLOORPLAN)

2. Counter Top

	Counter	Edge
Kitchen / Breakfast	WHITE CARRARA 4924-38	
Laundry Room	FROSTY WHITE 1573-60	
Powder Room	N/A	
Master Ensuite Bathroom	WHITE CARRARA 4924-38	
SHARED BATH	WHITE CARRARA 4924-38	
BATH	INUKSHUK GREY P-344 LM	

Comment

3. Ceramic Flooring

	Selection	Threshold
Entrance Vestibule	DO NOT INSTALL	
Main Hall	DO NOT INSTALL	
Kitchen / Breakfast	DO NOT INSTALL	
Laundry Room	DO NOT INSTALL	
Powder Room	DO NOT INSTALL	
Master Ensuite Bathroom	DO NOT INSTALL	
SHARED BATH	DO NOT INSTALL	
BATH	DO NOT INSTALL	

Comment

*****PURCHASER TO SUPPLY OWN TILES IN ALL TILED AREAS DO NOT INSTALL *****



INTERIOR COLOUR SCHEME

** Document is NOT locked **

Purchasers:

FILOMENA PALMIERI & LANFRANCO PALMIER

Property: 15

Telephone Res. / Bus:

(905) 303-5896 / (905) 760-7840

Project: Bradford Capital Holdings Inc.

Decor Advisor:

Jessica Boardman

Model and Elevation: The Rideau 5 (42-5) Elev B

Lock Date:

10-Oct-15

Plan #: 51M-1063

4. Ceramic Wall Tile

Master Ensuite Bathroom

Tub Deck Wall

DO NOT INSTALL

Tub Deck

DO NOT INSTALL

Tub Deck Skirt

DO NOT INSTALL

Shower Stall

DO NOT INSTALL

SHARED BATH SHOWER

DO NOT INSTALL

BATH SHOWER

DO NOT INSTALL

Kitchen Backsplash

Delete all Ceramic Accessories (Paper Holder;Towel Bar; Soap Dishes)

☒ Yes

☐ No

Comment

*****PURCHASER TO SUPPLY OWN TILES IN ALL TILED AREAS DO NOT INSTALL *****

*****DELETE ALL CERAMIC ACCESSORIES IN ALL BATHROOMS*****

** Refer to Construction Summary - STANDARD GROUT THROUGHOUT UNLESS SPECIFIED

5. Carpeting

Main Hall

SEE TILE DETAILS

Living Room

SEE HARDWOOD DETAILS

Dining Room

SEE HARDWOOD DETAILS

Family Room

SEE HARDWOOD DETAILS

Den / Library / Study

SEE HARDWOOD DETAILS

Basement Landing(If Applies)

SEE HARDWOOD DETAILS

Lower Landing (If Applies)

SEE HARDWOOD DETAILS

Upper Landing

SEE HARDWOOD DETAILS

Upper Hall

SEE HARDWOOD DETAILS

Master Bedroom

2369 SUN RIVER- 713 SILVER MAPLE

Bedroom #2

2369 SUN RIVER- 713 SILVER MAPLE

Bedroom #3

2369 SUN RIVER- 713 SILVER MAPLE

Bedroom #4

2369 SUN RIVER- 713 SILVER MAPLE

Bedroom #5

N/A

MEDIA LOFT

2369 SUN RIVER- 713 SILVER MAPLE

Underpad

Type

10MM STANDARD

Area

ALL BEDROOMS

Carpet on Stairs

Capped

Runner - *Upgrade

Comment

NO

** Refer to Construction Summary



INTERIOR COLOUR SCHEME

** Document is NOT locked **

Purchasers:

FILOMENA PALMIERI & LANFRANCO PALMIER

Property: 15

Telephone Res. / Bus:

(905) 303-5896 / (905) 760-7840

Project: Bradford Capital Holdings Inc.

Decor Advisor:

Jessica Boardman

Model and Elevation: The Rideau 5 (42-5) Elev B

Lock Date:

10-Oct-15

Plan #: 51M-1063

6. Hardwood

Kitchen	SEE TILE DETAILS
Main Hall	SEE TILE DETAILS
Living Room	WHITE OAK COTHAM HANDSCRAPPED CHARACTER PEARL 5"
Dining Room	WHITE OAK COTHAM HANDSCRAPPED CHARACTER PEARL 5"
Family Room	WHITE OAK COTHAM HANDSCRAPPED CHARACTER PEARL 5"
Den / Library / Study	WHITE OAK COTHAM HANDSCRAPPED CHARACTER PEARL 5"
Basement Landing(If Applies)	WHITE OAK COTHAM HANDSCRAPPED CHARACTER PEARL 5"
Lower Landing (If Applies)	WHITE OAK COTHAM HANDSCRAPPED CHARACTER PEARL 5"
Upper Landing	WHITE OAK COTHAM HANDSCRAPPED CHARACTER PEARL 5"
Upper Hall	WHITE OAK COTHAM HANDSCRAPPED CHARACTER PEARL 5"
Master Bedroom	SEE CARPET DETAILS
Bedroom #2	SEE CARPET DETAILS
Bedroom #3	SEE CARPET DETAILS
Bedroom #4	SEE CARPET DETAILS
Bedroom #5	N/A
MEDIA LOFT	SEE CARPET DETAILS
Comment	

7. Plumbing Fixtures

Powder Room	BATH. SINK STANDARD-L4621
Master Ensuite Bathroom	BATH. SINK STANDARD-L4621
ENSUITE TUB DECK	MASTER TUB DECK STANDARD- 4796/T
ENSUITE SHOWER	SHOWER STANDARD- 62320/TL183
SHARED BATH	SHOWER STANDARD- 62320/TL183
BATH	SHOWER STANDARD- 62320/TL183
KITCHEN	KITCHEN STANDARD- 7545C
Waterline for Fridge	<input type="radio"/> Yes <input checked="" type="radio"/> No
Comment	***** ALL PLUMBING FIXTURES STANDARD***** ** Refer to Construction Summary



INTERIOR COLOUR SCHEME

** Document is NOT locked **

Purchasers:	FILOMENA PALMIERI & LANFRANCO PALMIER	Property:	15
Telephone Res. / Bus:	(905) 303-5896 / (905) 760-7840	Project:	Bradford Capital Holdings Inc.
Decor Advisor:	Jessica Boardman	Model and Elevation:	The Rideau 5 (42-5) Elev B
Lock Date:	10-Oct-15	Plan #:	51M-1063

8. Trim Carpentry

Interior Doors	STD	Front Door Glass Inserts	N/A	Door Handles	3820 STANDARD
Interior Trim	3INCH BACKBAND CASING - 7 1/4 MDF BASEBOARD UPGRD2				

Comment

** Refer to Construction Summary

9. Electrical

Plugs and Switches	<input checked="" type="radio"/> White			
Hood Fan	WHITE			
Custom Fan Insert				
Appliances	Built in Cooktop	Built in Oven	Gas Stove	Microwave
Comment	<input type="radio"/> Yes <input checked="" type="radio"/> No	<input type="radio"/> Yes <input checked="" type="radio"/> No	<input checked="" type="radio"/> Yes <input type="radio"/> No	<input type="radio"/> Yes <input type="radio"/> OTR <input checked="" type="radio"/> No

** Refer to Construction Summary

10. Railings and Pickets

Railing Type	UPGRADE 2 LEVEL 2	Colour	STAIN TO MATCH HARDWOOD
SpindleType	WROUGHT IRON	Colour	BLACK
Stringer / Riser	STAIN TO MATCH HARDWOOD	Treads	STAIN TO MATCH HARDWOOD
Comment	Oak Stairs <input checked="" type="radio"/> Yes <input type="radio"/> No		

WHITE OAK COTHAM HANDSCRAPPED CHARACTER PEARL 5"

** Refer to Construction Summary



INTERIOR COLOUR SCHEME

** Document is NOT locked **

Purchasers:

FILOMENA PALMIERI & LANFRANCO PALMIER

Property: 15

Telephone Res. / Bus:

(905) 303-5896 / (905) 760-7840

Project: Bradford Capital Holdings Inc.

Decor Advisor:

Jessica Boardman

Model and Elevation: The Rideau 5 (42-5) Elev B

Lock Date:

10-Oct-15

Plan #: 51M-1063

11. Crown Mouldings

Entrance Vestibule	NONE		Kitchen/Breakfast	NONE	
Main Hall	NONE		Den/Library	NONE	
Living Room	NONE		Lower Landing	NONE	
Dining Room	NONE				
Family Room	NONE				

Comment

** Refer to Construction Summary

12. Wall Paint

Main Floor	GREENPARK WARM GREY
Second Floor	GREENPARK WARM GREY
	7701

Smooth Ceilings First Floor ☒ Yes ☐ No

Comment

** Refer to Construction Summary

13. Fireplace

	Living Room	Family Room	Other Room - Specify
	PurchasedAs Per Plan N/A	PurchasedAs Per Plan N/A	PurchasedAs Per Plan N/A
	<input type="radio"/> <input type="radio"/> <input checked="" type="radio"/>	<input type="radio"/> <input checked="" type="radio"/> <input type="radio"/>	<input type="radio"/> <input type="radio"/> <input checked="" type="radio"/>
Fireplace Type		D.V GAS	
Mantle Type		M1 STANDARD	
Colour / Stain		WHITE	
Surround		BIANCO- MARBLE	
Hearth			

Comment

** Refer to Construction Summary



INTERIOR COLOUR SCHEME

**** Document is NOT locked ****

Purchasers:	FILOMENA PALMIERI & LANFRANCO PALMIER	Property:	15
Telephone Res. / Bus:	(905) 303-5896 / (905) 760-7840	Project:	Bradford Capital Holdings Inc.
Decor Advisor:	Jessica Boardman	Model and Elevation:	The Rideau 5 (42-5) Elev B
Lock Date:	10-Oct-15	Plan #:	51M-1063

14. Heating and Air Conditioning

Air Conditioning	Gas Provisions Stove
Gas Provisions Dryer	Gas Provisions Barbecue
Comment	
** Refer to Construction Summary	

15. General Comments

** Refer to Construction Summary

Disclaimers and Notes

Purchaser Initials	
	1) Colours of all materials are as close as possible to builder's selection, but not necessarily identical due to variances in manufacturing.
	2) Any extras listed above are null and void unless accompanied by a separate invoice/amendment. Said invoice must be paid in full.
	3) The Purchaser acknowledges that after Interior Colour Selection form is signed and dated, a \$250 admin fee will be applicable for changes, deletions or alterations other than re-selection due to unavailability.
	4) The Purchaser acknowledges reading and accepting the "Bayview Wellington Homes Decor Centre Disclaimers" form. This document contains other miscellaneous disclaimers.
<i>This Interior Colour Selection is final and approved by:</i>	
Signature:_____	Date: _____
Signature:_____	Date: _____



INTERIOR COLOUR SCHEME
**** Document is NOT locked ****

Purchasers:	FILOMENA PALMIERI & LANFRANCO PALMIER	Property:	15
Telephone Res. / Bus:	(905) 303-5896 / (905) 760-7840	Project:	Bradford Capital Holdings Inc.
Decor Advisor:	Jessica Boardman	Model and Elevation:	The Rideau 5 (42-5) Elev B
Lock Date:	10-Oct-15	Plan #:	51M-1063



INTERIOR COLOUR SCHEME

** Document is NOT locked **

Purchasers:

FILOMENA PALMIERI & LANFRANCO PALMIER

Property: 15

Telephone Res. / Bus:

(905) 303-5896 / (905) 760-7840

Project: Bradford Capital Holdings Inc.

Decor Advisor:

Jessica Boardman

Model and Elevation: The Rideau 5 (42-5) Elev B

Lock Date:

10-Oct-15

Plan #: 51M-1063

Layout Changes: ☒ Yes ☐ No

Sketch Attached: ☒ Yes ☐ No

Exterior Colour Scheme: #6

1. Kitchen and Vanities

	Style and Colour	Hardware
Kitchen / Breakfast	BOSTON PAINT - MACADEMIA -UPGRADE 3	9677
Laundry Room	RIDEAU-ONTARIO WHITE	9677
Powder Room	N/A	
Master Ensuite Bathroom	BOSTON MAPLE- SOAPSTONE - UPGRADE 2	9677
SHARED BATH	CAMDEN MAPLE - SOAPSTONE - UPGRADE 1	9677
BATH	MANCHESTER- WINTER WHITE UPGRADE 2	9677

Comment

(D12)- VANITY TOP DRAWER PRICE PER DRAWER (INCLUDES FALSE DRAWER) - BATH
VANITY CABINETS - CLASSIC - VANITY BANK OF DRAWERS - 55CM MAX- MASTER ENSUITE
(B06) BASE PIE CUT CORNER WITH LAZY SUSAN
(A02) UPPER ANGLE CORNER
(J09)66CM "COUNTER DEPTH"FRIDGE CABINET (1 GABLE & CABINET 59CM DEEP)
(B18)POTS & PANS DRAWER (MIN 60CM/MAX 90CM , (SIZE SUBJECT TO FLOORPLAN)

2. Counter Top

	Counter	Edge
Kitchen / Breakfast	WHITE CARRARA 4924-38	
Laundry Room	FROSTY WHITE 1573-60	
Powder Room	N/A	
Master Ensuite Bathroom	WHITE CARRARA 4924-38	
SHARED BATH	WHITE CARRARA 4924-38	
BATH	INUKSHUK GREY P-344 LM	

Comment

3. Ceramic Flooring

	Selection	Threshold
Entrance Vestibule	DO NOT INSTALL	
Main Hall	DO NOT INSTALL	
Kitchen / Breakfast	DO NOT INSTALL	
Laundry Room	DO NOT INSTALL	
Powder Room	DO NOT INSTALL	
Master Ensuite Bathroom	DO NOT INSTALL	
SHARED BATH	DO NOT INSTALL	
BATH	DO NOT INSTALL	

Comment

*****PURCHASER TO SUPPLY OWN TILES IN ALL TILED AREAS DO NOT INSTALL *****



INTERIOR COLOUR SCHEME

** Document is NOT locked **

Purchasers:

FILOMENA PALMIERI & LANFRANCO PALMIER

Property: 15

Telephone Res. / Bus:

(905) 303-5896 / (905) 760-7840

Project: Bradford Capital Holdings Inc.

Decor Advisor:

Jessica Boardman

Model and Elevation: The Rideau 5 (42-5) Elev B

Lock Date:

10-Oct-15

Plan #: 51M-1063

4. Ceramic Wall Tile

Master Ensuite Bathroom		Selection	Describe
Tub Deck Wall		DO NOT INSTALL	
Tub Deck		DO NOT INSTALL	
Tub Deck Skirt		DO NOT INSTALL	
Shower Stall		DO NOT INSTALL	
SHARED BATH SHOWER		DO NOT INSTALL	
BATH SHOWER		DO NOT INSTALL	
Kitchen Backsplash			

Delete all Ceramic Accessories (Paper Holder;Towel Bar; Soap Dishes) ☒ Yes ☐ No

Comment

*****PURCHASER TO SUPPLY OWN TILES IN ALL TILED AREAS DO NOT INSTALL *****

*****DELETE ALL CERAMIC ACCESSORIES IN ALL BATHROOMS*****

** Refer to Construction Summary - STANDARD GROUT THROUGHOUT UNLESS SPECIFIED

5. Carpeting

Main Hall	SEE TILE DETAILS
Living Room	SEE HARDWOOD DETAILS
Dining Room	SEE HARDWOOD DETAILS
Family Room	SEE HARDWOOD DETAILS
Den / Library / Study	SEE HARDWOOD DETAILS
Basement Landing(If Applies)	SEE HARDWOOD DETAILS
Lower Landing (If Applies)	SEE HARDWOOD DETAILS
Upper Landing	SEE HARDWOOD DETAILS
Upper Hall	SEE HARDWOOD DETAILS
Master Bedroom	2369 SUN RIVER- 713 SILVER MAPLE
Bedroom #2	2369 SUN RIVER- 713 SILVER MAPLE
Bedroom #3	2369 SUN RIVER- 713 SILVER MAPLE
Bedroom #4	2369 SUN RIVER- 713 SILVER MAPLE
Bedroom #5	N/A
MEDIA LOFT	2369 SUN RIVER- 713 SILVER MAPLE

Underpad	Type	Area
	10MM STANDARD	ALL BEDROOMS
Carpet on Stairs	Capped	Runner - *Upgrade
		NO

Comment

** Refer to Construction Summary

Initials:_____



INTERIOR COLOUR SCHEME

** Document is NOT locked **

Purchasers:

FILOMENA PALMIERI & LANFRANCO PALMIER

Property: 15

Telephone Res. / Bus:

(905) 303-5896 / (905) 760-7840

Project: Bradford Capital Holdings Inc.

Decor Advisor:

Jessica Boardman

Model and Elevation: The Rideau 5 (42-5) Elev B

Lock Date:

10-Oct-15

Plan #: 51M-1063

6. Hardwood

Kitchen	SEE TILE DETAILS
Main Hall	SEE TILE DETAILS
Living Room	WHITE OAK COTHAM HANDSCRAPPED CHARACTER PEARL 5"
Dining Room	WHITE OAK COTHAM HANDSCRAPPED CHARACTER PEARL 5"
Family Room	WHITE OAK COTHAM HANDSCRAPPED CHARACTER PEARL 5"
Den / Library / Study	WHITE OAK COTHAM HANDSCRAPPED CHARACTER PEARL 5"
Basement Landing(If Applies)	WHITE OAK COTHAM HANDSCRAPPED CHARACTER PEARL 5"
Lower Landing (If Applies)	WHITE OAK COTHAM HANDSCRAPPED CHARACTER PEARL 5"
Upper Landing	WHITE OAK COTHAM HANDSCRAPPED CHARACTER PEARL 5"
Upper Hall	WHITE OAK COTHAM HANDSCRAPPED CHARACTER PEARL 5"
Master Bedroom	SEE CARPET DETAILS
Bedroom #2	SEE CARPET DETAILS
Bedroom #3	SEE CARPET DETAILS
Bedroom #4	SEE CARPET DETAILS
Bedroom #5	N/A
MEDIA LOFT	SEE CARPET DETAILS
Comment	

7. Plumbing Fixtures

Powder Room	BATH. SINK STANDARD-L4621
Master Ensuite Bathroom	BATH. SINK STANDARD-L4621
ENSUITE TUB DECK	MASTER TUB DECK STANDARD- 4796/T
ENSUITE SHOWER	SHOWER STANDARD- 62320/TL183
SHARED BATH	SHOWER STANDARD- 62320/TL183
BATH	SHOWER STANDARD- 62320/TL183
KITCHEN	KITCHEN STANDARD- 7545C
Waterline for Fridge	<input type="radio"/> Yes <input checked="" type="radio"/> No
Comment	***** ALL PLUMBING FIXTURES STANDARD***** ** Refer to Construction Summary



INTERIOR COLOUR SCHEME

** Document is NOT locked **

Purchasers:

FILOMENA PALMIERI & LANFRANCO PALMIER

Property: 15

Telephone Res. / Bus:

(905) 303-5896 / (905) 760-7840

Project: Bradford Capital Holdings Inc.

Decor Advisor:

Jessica Boardman

Model and Elevation: The Rideau 5 (42-5) Elev B

Lock Date:

10-Oct-15

Plan #: 51M-1063

8. Trim Carpentry

Interior Doors

STD

Front Door Glass Inserts

N/A

Door Handles

3820 STANDARD

Interior Trim

3INCH BACKBAND CASING - 7 1/4 MDF BASEBOARD UPGRD2

Comment

** Refer to Construction Summary

9. Electrical

Plugs and Switches

☒ White

Hood Fan

WHITE

Custom Fan Insert

Appliances

Built in Cooktop

Built in Oven

Gas Stove

Microwave

☐ Yes ☒ No

☐ Yes ☒ No

☒ Yes ☐ No

☐ Yes ☐ OTR ☒ No

Comment

** Refer to Construction Summary

10. Railings and Pickets

Railing Type

UPGRADE 2 LEVEL 2

Colour

STAIN TO MATCH HARDWOOD

SpindleType

WROUGHT IRON

Colour

BLACK

Stringer / Riser

STAIN TO MATCH HARDWOOD

Treads

STAIN TO MATCH HARDWOOD

Comment

Oak Stairs

☒ Yes ☐ No

WHITE OAK COTHAM HANDSCRAPPED CHARACTER PEARL 5"

** Refer to Construction Summary



INTERIOR COLOUR SCHEME

** Document is NOT locked **

Purchasers:

FILOMENA PALMIERI & LANFRANCO PALMIER

Property: 15

Telephone Res. / Bus:

(905) 303-5896 / (905) 760-7840

Project: Bradford Capital Holdings Inc.

Decor Advisor:

Jessica Boardman

Model and Elevation: The Rideau 5 (42-5) Elev B

Lock Date:

10-Oct-15

Plan #: 51M-1063

11. Crown Mouldings

Entrance Vestibule	NONE		Kitchen/Breakfast	NONE	
Main Hall	NONE		Den/Library	NONE	
Living Room	NONE		Lower Landing	NONE	
Dining Room	NONE				
Family Room	NONE				

Comment

** Refer to Construction Summary

12. Wall Paint

Main Floor	GREENPARK WARM GREY
Second Floor	GREENPARK WARM GREY
	7701

Smooth Ceilings First Floor

☒ Yes

☐ No

Comment

** Refer to Construction Summary

13. Fireplace

	<div>Living Room</div> <div>PurchasedAs Per Plan N/A</div> <div><input type="radio"/><input type="radio"/><input checked="" type="radio"/></div>	<div>Family Room</div> <div>PurchasedAs Per Plan N/A</div> <div><input type="radio"/><input checked="" type="radio"/><input type="radio"/></div>	<div>Other Room - Specify</div> <div>PurchasedAs Per Plan N/A</div> <div><input type="radio"/><input type="radio"/><input checked="" type="radio"/></div>
--	--	--	---

Fireplace Type		D.V GAS	
Mantle Type		M1 STANDARD	
Colour / Stain		WHITE	
Surround		BIANCO- MARBLE	
Hearth			

Comment

** Refer to Construction Summary



INTERIOR COLOUR SCHEME

**** Document is NOT locked ****

Purchasers:	FILOMENA PALMIERI & LANFRANCO PALMIER	Property:	15
Telephone Res. / Bus:	(905) 303-5896 / (905) 760-7840	Project:	Bradford Capital Holdings Inc.
Decor Advisor:	Jessica Boardman	Model and Elevation:	The Rideau 5 (42-5) Elev B
Lock Date:	10-Oct-15	Plan #:	51M-1063

14. Heating and Air Conditioning

Air Conditioning	Gas Provisions Stove
Gas Provisions Dryer	Gas Provisions Barbecue
Comment	
** Refer to Construction Summary	

15. General Comments

** Refer to Construction Summary

Disclaimers and Notes

Purchaser Initials	
	1) Colours of all materials are as close as possible to builder's selection, but not necessarily identical due to variances in manufacturing.
	2) Any extras listed above are null and void unless accompanied by a separate invoice/amendment. Said invoice must be paid in full.
	3) The Purchaser acknowledges that after Interior Colour Selection form is signed and dated, a \$250 admin fee will be applicable for changes, deletions or alterations other than re-selection due to unavailability.
	4) The Purchaser acknowledges reading and accepting the "Bayview Wellington Homes Decor Centre Disclaimers" form. This document contains other miscellaneous disclaimers.
<i>This Interior Colour Selection is final and approved by:</i>	
Signature:_____	Date: _____
Signature:_____	Date: _____



INTERIOR COLOUR SCHEME
**** Document is NOT locked ****

Purchasers:	FILOMENA PALMIERI & LANFRANCO PALMIER	Property:	15
Telephone Res. / Bus:	(905) 303-5896 / (905) 760-7840	Project:	Bradford Capital Holdings Inc.
Decor Advisor:	Jessica Boardman	Model and Elevation:	The Rideau 5 (42-5) Elev B
Lock Date:	10-Oct-15	Plan #:	51M-1063

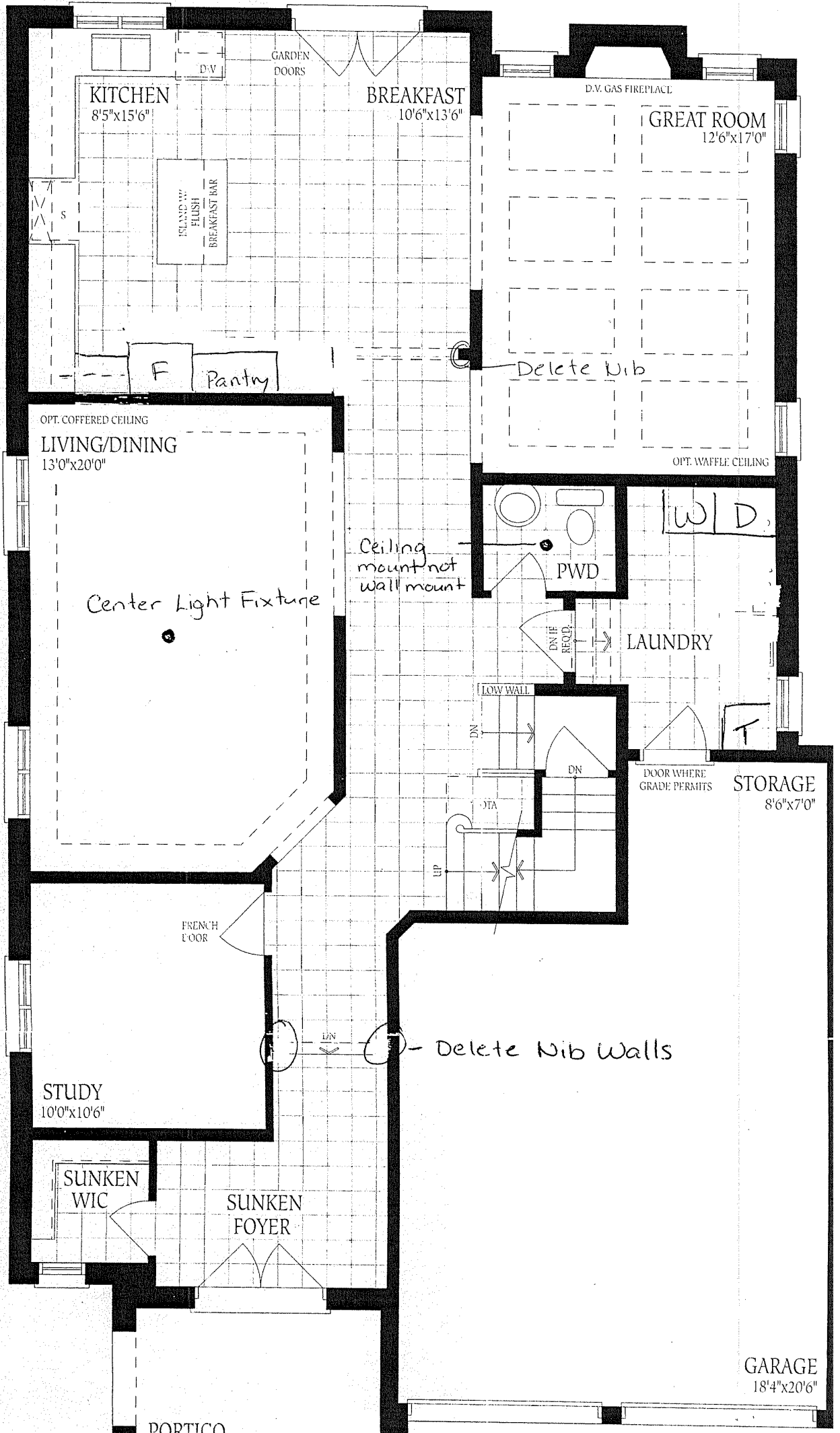

July 5th

Lot #15

RI
↓
Bidet

Handwritten signature/initials

Delete wc
around toi

RAISED TRAY CEILING
MASTER BEDROOM
18'11"x13'0"

ENSUITE

GLASS
SHOWER

BEDROOM 2
12'6"x11'6"

WIC

COFFERED CEILING

MEDIA LOFT
12'4"x12'0"

LINEN

WIC

Toilet
↓
R/I
↓
Bidet
↑
move 1 ft
wall

Delete
wall

WIC

SHARED
BATH

Center Light fixture

WIC

BEDROOM 4
14'0"x11'6"(10'6")

VAULTED CEILING

BEDROOM 3
14'6"(13'0")x14'2"(11'0")

VAULTED CEILING

Second Floor
Elevation A



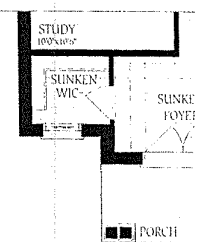
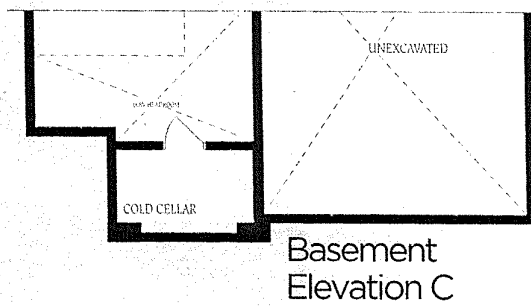
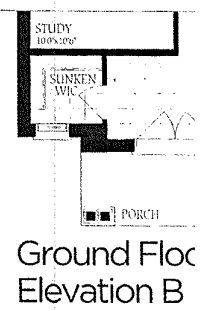
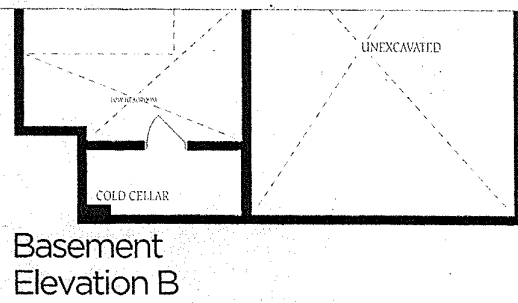
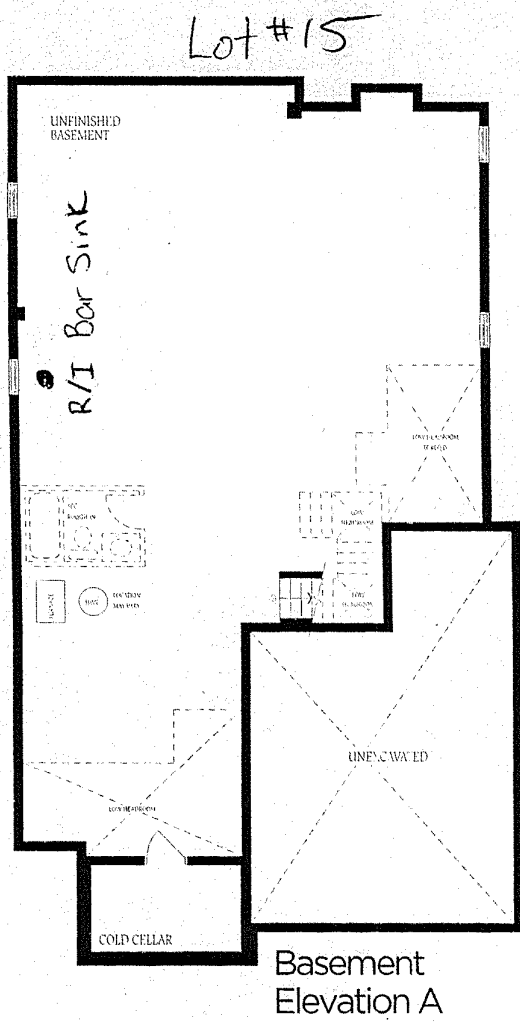
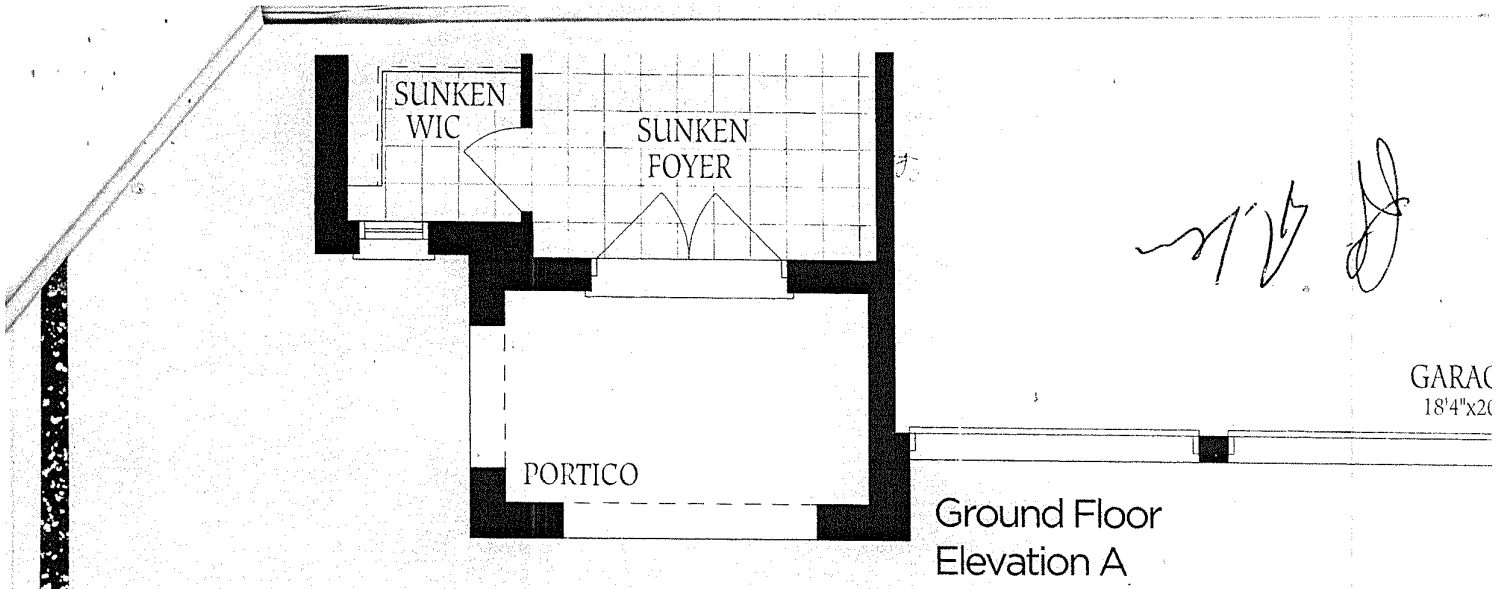

48" PRO-STYLE® SIDE-BY-SIDE REFRIGERATOR WITH DISPENSER

JS48PPDUB – 48 1/8" x 83" x 27 3/4"

PRODUCT DIMENSIONS

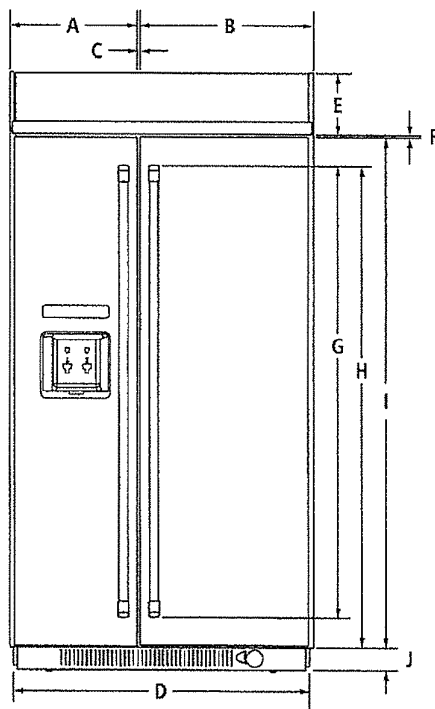

FRONT VIEW

MODEL #		JS48PPDUB	
		in	cm
A	Width of freezer door	19 5/8	50.0
B	Width of refrigerator door	28 1/8	71.2
C	Space between doors	3/8	1.0
D	Overall width	48 1/8	122.2
E	Height of top grille	8 5/8	21.7
F	Space between doors and top grille	3/8	1.0
G	Height of handles	63	160.0
H	Height to top of handles	67	170.3
I	Height of doors	71	180.2
J	Height of bottom grille	3 1/2	8.9
K	Width of recessed refrigerator	47 5/8	121.0
L	Width from side of refrigerator to freezer handle – door fully open 110°	8 3/8	21.3
M	Width from side of refrigerator to handle – door open 90°	2 5/8	6.7
N	Width from side of refrigerator to refrigerator handle – door fully open 110°	10 7/8	27.6
O	Depth without doors	22 1/8	56.2
P	Depth with doors	25 1/8	63.8
Q	Depth with handles	27 3/4	70.5
R	Depth with refrigerator door open 90°	51 1/8	129.7

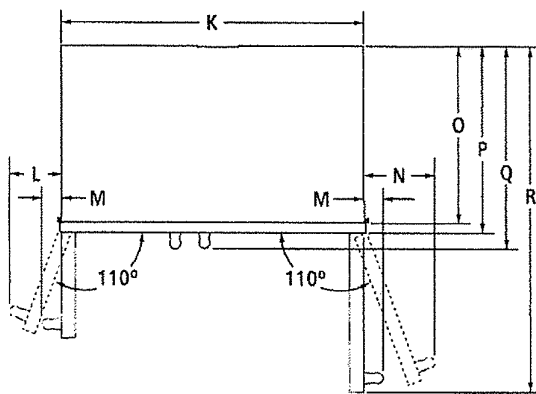

TOP VIEW

48" PRO-STYLE® SIDE-BY-SIDE REFRIGERATOR WITH DISPENSER

JS48PPDUB – 48⅛" x 83" x 27¾"

DIMENSIONS AS INSTALLED

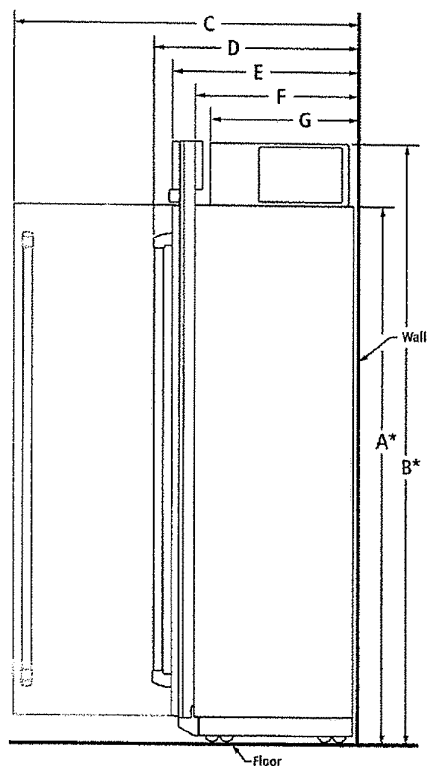

SIDE VIEW

MODEL

JS48PPDUB

		in	cm
A*	Height without compressor (min.)	74⅞	188.9
B*	Height of recessed refrigerator (min.)	83	210.8
C	Depth with refrigerator door open 90° (min.)	51⅞	129.7
D	Depth with handles (min.)	27¾	70.5
E	Depth with doors (min.)	25⅞	63.8
F	Depth without doors (min.)	22⅞	56.2
G	Depth of compressor (min.)	19⅞	49.8

*Add 1⅞" (2.9 cm) to the height dimension when leveling legs are fully extended.

48" PRO-STYLE® SIDE-BY-SIDE REFRIGERATOR WITH DISPENSER

JS48PPDUB – 48 1/8" x 83" x 27 3/4"

OPENING/CLEARANCE DIMENSIONS

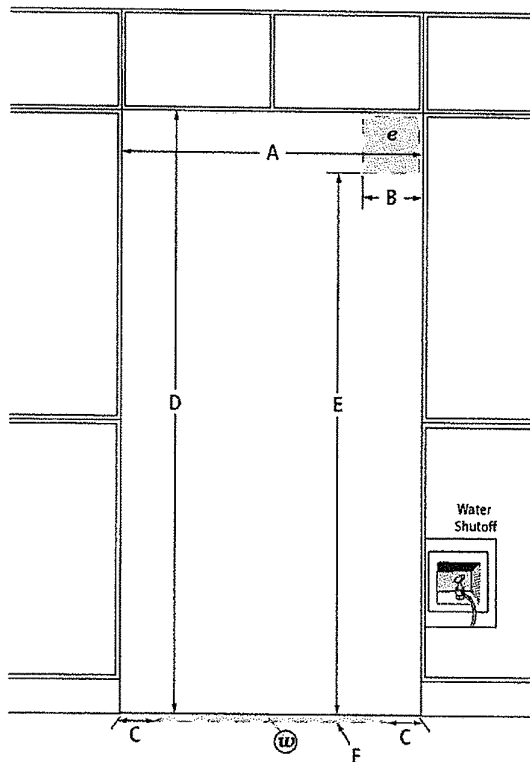

FRONT VIEW

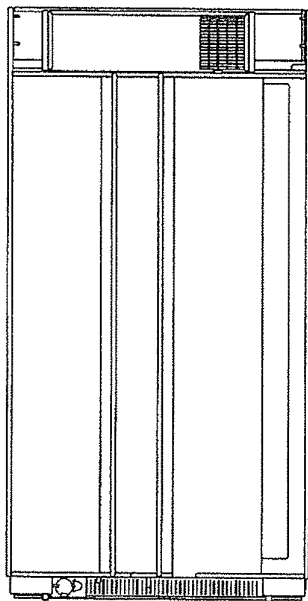

BACK VIEW

MODEL #		JS48PPDUB	
		in	cm
A	Width (min.)	47 1/2	120.7
B	Width of recommended electrical location	4	10.2
C	Distance from side of cabinet to recommended water connection location	6	15.2
D	Height (min.)	83 1/2	212.1
E	Height to recommended electrical location	77	195.6
F	Depth of recommended water connection location (max.)	1	2.5
e	Recommended electrical connection location		
w	Recommended water connection location		

ELECTRICAL REQUIREMENTS

115 volt, 60 Hz, AC only, 15- or 20-amp fused, grounded circuit is required. A dedicated circuit is recommended. Use an outlet that cannot be turned off by a switch.

Minimum length of power cord is 84" (213.4 cm). Do not use an extension cord.

WATER PRESSURE REQUIREMENTS

A cold water supply with water pressure between 30 and 120 psi (207 and 827 kPa) is required to operate the water dispenser and ice maker. Call a licensed, qualified plumber with any questions about the water pressure.

Reverse Osmosis Water Supply

IMPORTANT: The pressure of the water coming out of a reverse osmosis system going to the water inlet valve of the refrigerator needs to be between 30 and 120 psi (207 and 827 kPa).

If a reverse osmosis water filtration system is connected to the cold water supply, the water pressure to the reverse osmosis system needs to be a minimum of 40 to 60 psi (276 to 414 kPa).

LOCATION REQUIREMENTS

Floor must be able to support refrigerator (more than 600 lb [272 kg]) and contents of the refrigerator and must be at the same level as flooring in the room.

Product dimension, cutout and installation specifications are provided for planning purposes only. Before installing any product, be sure to verify cutout dimensions and electrical/gas connections as actual product dimensions may vary.

JENN-AIR®

JRC120078 03/2012

JENN-AIR® DETAILED PLANNING DIMENSIONS

1 of 4

36" PRO-STYLE® DUAL-FUEL RANGES

JDRP536WP, JDRP436WP – 35⁷/₈" x 36³/₄" x 29¹/₄"

PRODUCT DIMENSIONS

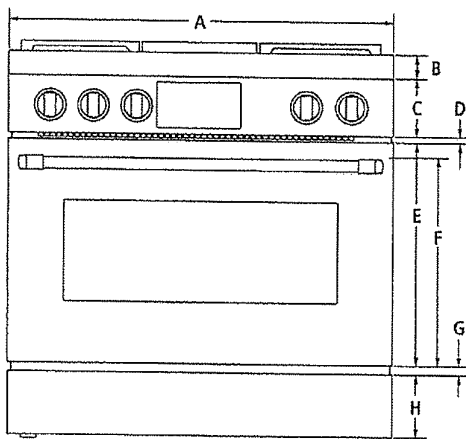

FRONT VIEW

MODEL #	JDRP536WP JDRP436WP	
	in	cm
A Overall width	35 ⁷ / ₈	91.1
B Height of bullnose	2 ¹ / ₄	5.5
C Height of control panel	5 ³ / ₈	13.5
D Space between door and control panel	7 ⁷ / ₈	2.0
E Height of door	20 ³ / ₄	52.5
F Height to top of handle	19 ³ / ₈	49.0
G Space between door and lower panel	1	2.5
H Height of lower panel	5 ¹ / ₂	14.0
I Depth with control panel overhang	27 ³ / ₈	69.5
J Depth with handle	29 ¹ / ₄	74.2
K Depth with door fully open	45 ³ / ₄	116.2

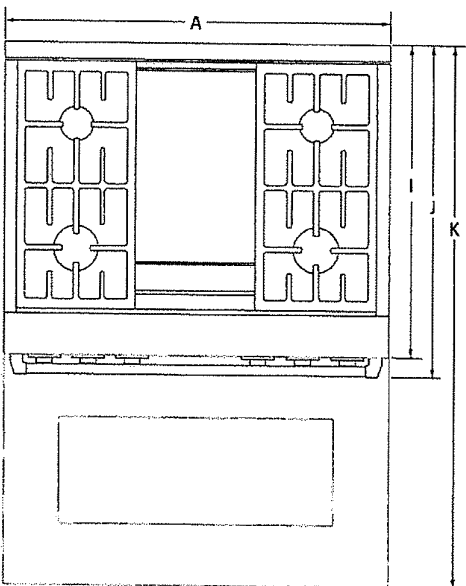

TOP VIEW

Product dimension, cutout and installation specifications are provided for planning purposes only. Before installing any product, be sure to verify cutout dimensions and electrical/gas connections as actual product dimensions may vary.

JENN-AIR®

JRC120044A 07/2012

JENN-AIR® DETAILED PLANNING DIMENSIONS

2 of 4

36" PRO-STYLE® DUAL-FUEL RANGES

JDRP536WP, JDRP436WP – 35⁷/₈" x 36³/₄" x 29¹/₄"

DIMENSIONS AS INSTALLED

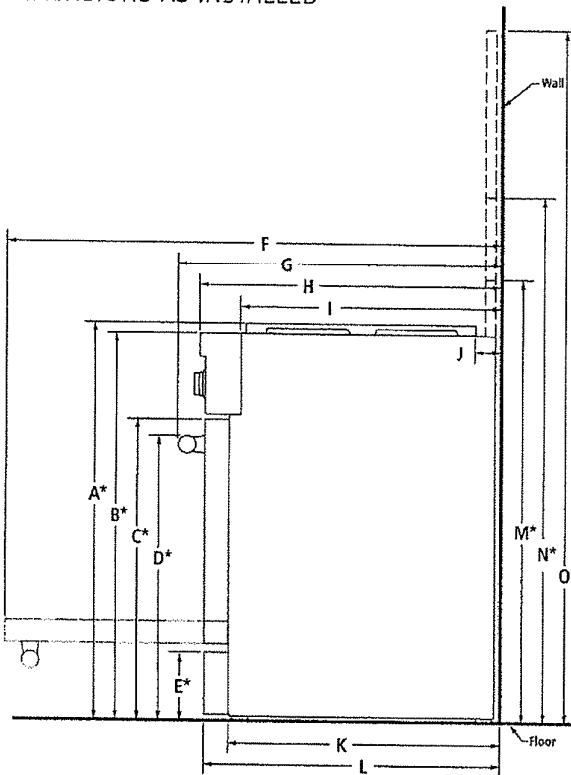

SIDE VIEW

MODEL #	JDRP536WP JDRP436WP	
	in	cm
A* Height to top of grates (min.)	36 ³ / ₄	93.3
B* Height to top of cooking surface (min.)	35 ³ / ₄	90.8
C* Height to top of door (min.)	27 ³ / ₈	69.5
D* Height to top of handle (min.)	25 ⁷ / ₈	65.7
E* Height to top of lower panel (min.)	5 ⁷ / ₈	14.9
F Depth with door fully open	45 ³ / ₄	116.2
G Depth with handle	29 ¹ / ₄	74.2
H Depth with control panel overhang	27 ³ / ₈	69.5
I Depth without control panel	23 ¹ / ₂	59.5
J Depth between grates and wall	1 ³ / ₄	4.5
K Depth without door	24 ³ / ₈	62.5
L Depth with door	26 ³ / ₄	68.0

OPTIONAL ACCESSORIES

M* Height to top of 9" stainless steel backsplash (min.)	44 ³ / ₄	113.7
N* Height to top of adjustable stainless steel backsplash (min.)	55 ¹ / ₂	141.0
O* Height to top of adjustable stainless steel backsplash (max.)	74 ³ / ₄	189.9

*Add 1³/₄" (4.4 cm) to the height dimension when leveling legs are fully extended.

Product dimension, cutout and installation specifications are provided for planning purposes only. Before installing any product, be sure to verify cutout dimensions and electrical/gas connections as actual product dimensions may vary.

JENN-AIR®

JRC120044A 07/2012

JENN-AIR® DETAILED PLANNING DIMENSIONS

3 of 4

36" PRO-STYLE® DUAL-FUEL RANGES

JDRP536WP, JDRP436WP – 35⁷/₈" x 36³/₄" x 29¹/₄"

OPENING/CLEARANCE DIMENSIONS

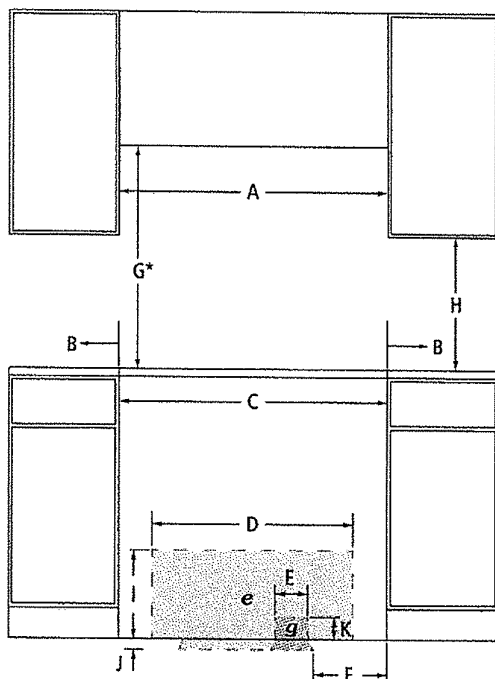

FRONT VIEW

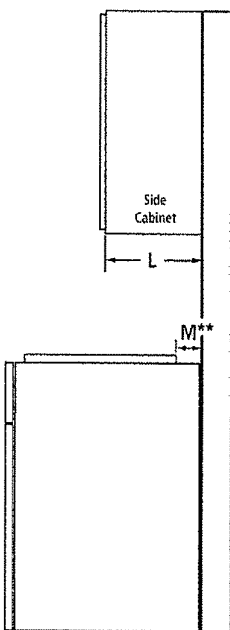

SIDE VIEW

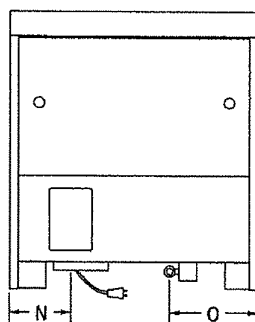

BACK VIEW

MODEL #		JDRP536WP JDRP436WP	
		in	cm
A	Width of combustable area above cooking surface (min.)	36	91.4
B	Width from range to fixed wall or other combustable material (min.)	6	15.2
C	Width of opening (min.)	36 ³ / ₄	92.1
D	Width of electrical installation area	28	71.1
E	Width of gas installation area	14	35.5
F	Width from side cabinet to gas installation area	6	15.2
G*	Height to bottom of uncovered wood or metal cabinet above cooking surface (min.)	42	106.7
H	Height to bottom of uncovered wood or metal cabinet (min.)	18	45.7
I	Height of electrical installation area	15	38.1
J	Depth of electrical and gas installation area	5	12.7
K	Height of gas installation area	3	7.6
L	Depth of upper cabinet (max.)	13	33.0
M**	Depth to wall (min.)	6	15.2
N	Width to electrical conduit	9 ¹ / ₈	23.0
O	Width to gas inlet	14 ³ / ₈	36.5
e	Recommended electrical access location		
g	Recommended gas supply line location		

*Dimension can be reduced by 6" (15.2 cm) when bottom of wood or metal cabinet is covered by not less than 1/4" (0.6 cm) flame retardant millboard covered with not less than No. 28 MSG sheet metal, 0.015" (0.4 mm) stainless steel, 0.024" (0.6 mm) aluminum or 0.020" (0.5 mm) copper.

If installing a hood or hood liner above the range, follow the hood or hood liner instructions for dimensional clearances above the cooking surface.

**If back wall is constructed of a combustable material and a backsplash is not installed, a 6" (15.2 cm) minimum clearance is required.

ELECTRICAL REQUIREMENTS

240 volt, 60 Hz, AC only, 40-amp fused, grounded circuit is required. A dedicated circuit is recommended. A UL listed 40-amp power supply cord kit.

JENN-AIR® DETAILED PLANNING DIMENSIONS

VENTILATION SELECTION CHART – RANGETOPS AND RANGES

4 of 4

MODEL #	PRO-STYLE™ HOODS	EURO-STYLE ISLAND-MOUNT HOODS	EURO-STYLE WALL-MOUNT HOODS	GLASS COLLECTION ISLAND-MOUNT HOOD	GLASS COLLECTION WALL-MOUNT HOODS	PERIMETRIC HOOD	OILED BRONZE WALL-MOUNT HOODS	EURO-STYLE TELESCOPING DOWNDRAFT SYSTEMS	CUSTOM HOOD LINERS	OVER-THE-RANGE MICROWAVE OVENS
	JXW9048WP JXW9036WP JXW9030WP JXW90136WP JXW90130WP	JXB042WS JXB036WS JXB030WS	JXW8036WS JXW8030WS	JX5036WS	JXW5036WS JXW5030WS	JXP5032WS	JXW6036WR JXW6030WR	JXD7036YS JXD7030YS	UXL6048PSS UXL6036PSS	JNV9186W JNV8208W
PRO-STYLE™ RANGETOPS										
48-INCH (more than 60,000 BTU total)										
JGCP548WP – 6 Burners & Griddle	★	—	—	—	—	—	—	—	★	—
36-INCH (less than 60,000 BTU total)										
JGCP536WP – 4 Burners & Griddle	★	—	—	—	—	—	—	—	★	—
36-INCH (more than 60,000 BTU total)										
JGCP436WP – 6 Burners	★	—	—	—	—	—	—	—	★	—
30-INCH (less than 60,000 BTU total)										
JGCP430WP – 4 Burners	★	—	—	—	—	—	—	—	★	—
48-INCH (less than 60,000 BTU total)										
JGDB348COP – 4 Burners & Grill Assembly	—	—	—	—	—	—	—	—	★	—
PRO-STYLE™ DUAL-FUEL AND GAS RANGES										
48-INCH (more than 60,000 BTU total)										
JDRP548WP – 6 Burners & Griddle	★	—	—	—	—	—	—	—	★	—
36-INCH (less than 60,000 BTU total)										
JDRP536WP – 4 Burners & Griddle	★	—	—	—	—	—	—	—	★	—
36-INCH (more than 60,000 BTU total)										
JDRP436WP – 6 Burners	★	—	—	—	—	—	—	—	★	—
30-INCH (less than 60,000 BTU total)										
JDRP430WP – 4 Burners	—	—	—	—	—	—	—	—	—	—
SLIDE-IN RANGES										
Dual-Fuel and Gas Conventional (less than 60,000 BTU total)										
JDS8860BP – 4 Burners	■	■	■	■	■	■	■	■	■	■
JDS8850CD – 4 Burners	■	■	■	■	■	■	■	■	■	■
JGS8860BP – 4 Burners	■	■	■	■	■	■	■	■	■	■
JGS8850CD – 4 Burners	■	■	■	■	■	■	■	■	■	■
ELECTRIC CONVENTIONAL										
JES8850CA – 5 Elements	■	■	■	■	■	■	■	■	■	■

A. Custom hood liners can be used with any of the following blower motors: UXB1200DYS, UXB6600DYS, UXN1200DYS or UXN6600DYS.
 B. Blower motor UXB6600DYS is rated for up to 65,000 BTUs and can be used with the rangetops and ranges indicated.

KEY	Stylis and Performance Pair	Performance Pair	Not Recommended
★	Stylis and Performance Pair	Performance Pair	Not Recommended
■	Stylis and Performance Pair	Performance Pair	Not Recommended
—	Stylis and Performance Pair	Performance Pair	Not Recommended

Product dimension, cutout and installation specifications are provided for planning purposes only. Before installing any product, be sure to verify cutout dimensions and electrical/gas connections as actual product dimensions may vary.

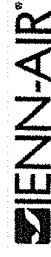

JRC120044A 07/2012

JENN-AIR® DETAILED PLANNING DIMENSIONS

1 of 3

DISHWASHERS

JDB9800CW, JDB9200CW, JDB9000CW – 23¾" x 33⅞" x 26⅞" (including handle)

PRODUCT DIMENSIONS

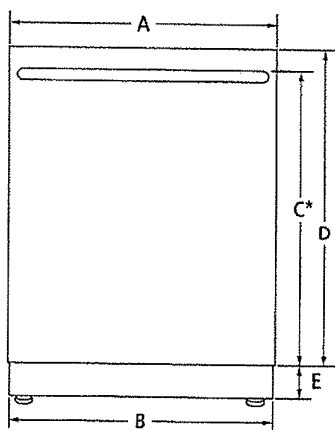

FRONT VIEW

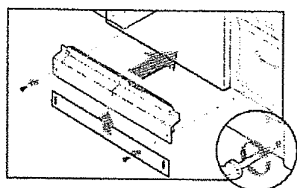

ADJUSTABLE TOE KICK

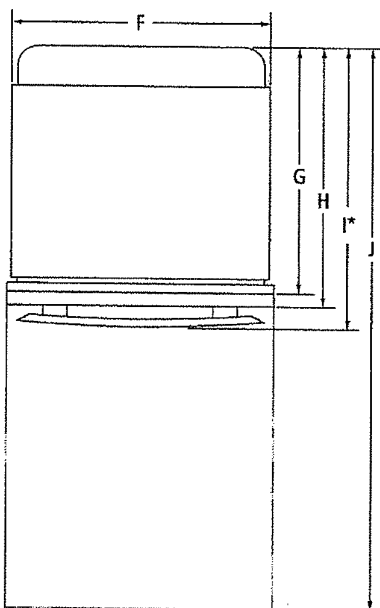

TOP VIEW

IMPORTANT: Dimensional specifications are provided for planning purposes only. Do not make any cutouts based on this information. Refer to the Installation or Use & Care Guide before selecting cabinetry, verifying electrical/gas connections, making cutouts or beginning installation. All Jenn-Air® appliances are appropriately UL, CUL or CSA approved.

MODEL #		JDB9800CW JDB9200CW JDB9000CW	
		in	cm
A	Width of door	23½	59.7
B	Width of toe kick	23½	59.7
C*	Height to top of handle Pro-Style® Stainless	27⅞	70.8
	Euro-Style (color-coordinating)	27⅞	70.8
	Floating Glass	27⅞	70.8
	Custom panel (¾"/1.9 cm)	*	*
D	Height of door Pro-Style® Stainless	30	76.3
	Euro-Style (color-coordinating)	30	76.3
	Floating Glass	30	76.3
	Custom panel (¾"/1.9 cm)	27⅞	69.5
E	Height of adjustable toe kick (min.-max.)	3½- 4⅞	8.9- 10.5
F	Width of recessed dishwasher	23¾	60.4
G	Depth with tub flange	22⅞	57.4
H	Depth with door Pro-Style® Stainless	24⅞	62.6
	Euro-Style (color-coordinating)	24⅞	62.6
	Floating Glass	25	63.5
	Custom panel (¾"/1.9 cm)	24¾	63.0
I*	Depth with handle Pro-Style® Stainless	27⅞	70.8
	Euro-Style (color-coordinating)	26⅞	68.3
	Floating Glass	27⅞	70.8
	Custom panel (¾"/1.9 cm)	*	*
J	Depth with door fully open	49¾	126.3

*For custom panel models, this depends on handle chosen.

JENN-AIR®

8160AdZw1114

JENN-AIR® DETAILED PLANNING DIMENSIONS

2 of 3

DISHWASHERS

JDB9800CW, JDB9200CW, JDB9000CW – 23³/₄" x 33⁷/₈" x 26⁷/₈" (including handle)

DIMENSIONS AS INSTALLED

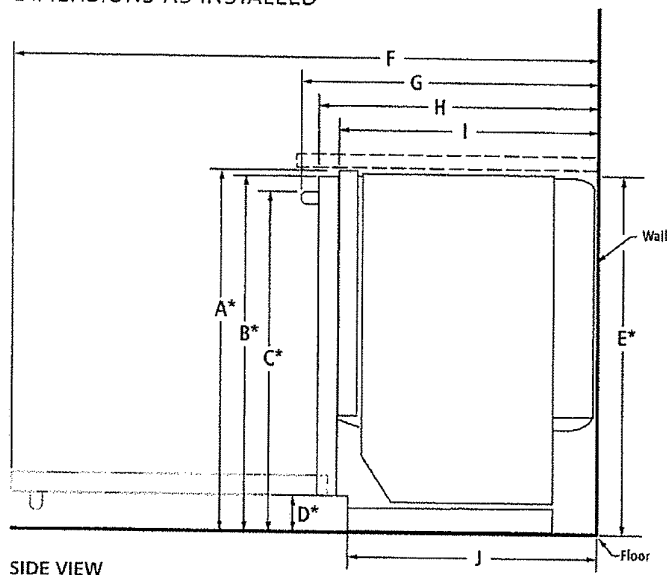

SIDE VIEW

MODEL #		JDB9800CW JDB9200CW JDB9000CW	
		in	cm
A*	Height to top of tub flange (min.)	33 ⁷ / ₈	86.0
B*	Height to top of door (min.)	33 ³ / ₄	85.7
C*	Height to top of handle (min.)		
	Pro-Style® Stainless	31 ¹ / ₂	80.1
	Euro-Style (color-coordinating)	31 ¹ / ₂	80.1
	Floating Glass	31 ¹ / ₂	80.1
	Custom panel (¾"/1.9 cm)	†	†
D*	Height to bottom of door	3 ³ / ₈	9.4
E*	Height of recessed dishwasher (min.)	33 ³ / ₄	85.5
F	Depth with door fully open (min.)	49 ³ / ₄	126.3
G	Depth with handle (min.)		
	Pro-Style® Stainless	27 ⁷ / ₈	70.8
	Euro-Style (color-coordinating)	26 ⁷ / ₈	68.3
	Floating Glass	27 ⁷ / ₈	70.8
	Custom panel (¾"/1.9 cm)	†	†
H	Depth with door (min.)	24 ⁵ / ₈	62.6
I	Depth with tub flange (min.)	22 ³ / ₈	57.4
J	Depth with toe kick (min.)	20 ⁷ / ₈	52.9

*With wheels removed. Add up to ¾" (1.6 cm) to height with wheels and leg levelers fully extended.

†For custom panel models, this depends on handle chosen.

IMPORTANT: Dimensional specifications are provided for planning purposes only. Do not make any cutouts based on this information. Refer to the Installation or Use & Care Guide before selecting cabinetry, verifying electrical/gas connections, making cutouts or beginning installation. All Jenn-Air® appliances are appropriately UL, CUL or CSA approved.

JENN-AIR®

8160AdZw1114

JENN-AIR® DETAILED PLANNING DIMENSIONS

3 of 3

DISHWASHERS

JDB9800CW, JDB9200CW, JDB9000CW – 23¾" x 33⅞" x 26⅞" (including handle)

OPENING/CLEARANCE DIMENSIONS

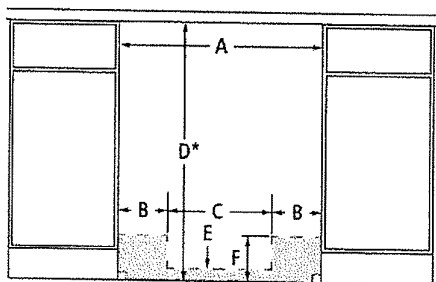

FRONT VIEW

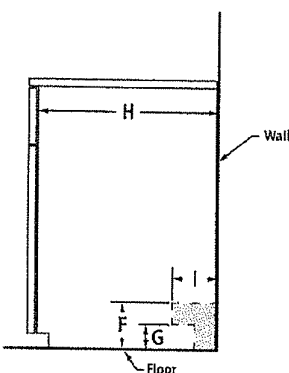

SIDE VIEW

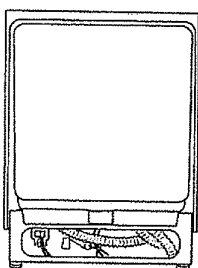

BACK VIEW

MODEL #	JDB9800CW JDB9200CW JDB9000CW	
	in	cm
A Width (min.)	24	61.0
B Width of possible utility installation area (back wall)	6¾	17.2
C Width of clear area (back wall)	10½	26.7
D* Height with wheels removed (min.)	33⅞	86.0
E Height of possible utility installation area (back wall)	2½	6.4
F Height of possible utility installation area (back/side wall)	6¾	15.9
G Height of clear area (side wall)	3	7.6
H Depth (min.)	24	61.0
I Depth of utility location (side wall)	4	10.2

Electrical, water and drain connections may be installed in shaded areas

Recommended drain connection location – closest to sink	1½ dia. 3.8 dia.
Recommended electrical connection location – right-hand side or back wall	1½ dia. 3.8 dia.
Recommended water connection location – left-hand side or back wall	½ dia. 1.3 dia.

*Measured from the lowest point on the underside of countertop.

ELECTRICAL REQUIREMENTS

120 volt, 60 Hz, AC only, 15- or 20-amp fused, grounded circuit is required. A dedicated circuit is recommended. Use an outlet that cannot be turned off by a switch. Do not use an extension cord.

WATER SUPPLY REQUIREMENTS

120°F (49°C) hot water supply with water pressure between 20 and 120 psi (138 and 862 kPa) is required. If you have questions about your water pressure, call a licensed, qualified plumber.

DRAIN REQUIREMENTS

Connect drain hose to waste tee or disposer inlet above drain trap. Maximum drain hose length 12' (3.7 m).

LOCATION REQUIREMENTS

Corner locations require a 2" (5.1 cm) minimum clearance between the side of the dishwasher door and the wall or cabinet.

IMPORTANT: Dimensional specifications are provided for planning purposes only. Do not make any cutouts based on this information. Refer to the Installation or Use & Care Guide before selecting cabinetry, verifying electrical/gas connections, making cutouts or beginning installation. All Jenn-Air® appliances are appropriately UL, CUL or CSA approved.

JENN-AIR®

8160AdZw1114

JENN-AIR® DETAILED PLANNING DIMENSIONS

1 of 4

48"/36"/30" PRO-STYLE™ WALL-MOUNT HOODS

JXW9048WP – 48" x 19³/₈" x 25"

JXW9036WP – 36" x 19³/₈" x 25"

JXW9030WP – 30" x 19³/₈" x 25"

PRODUCT DIMENSIONS

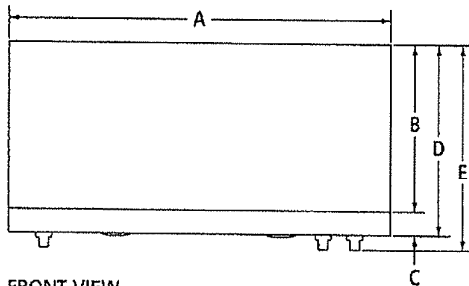

FRONT VIEW

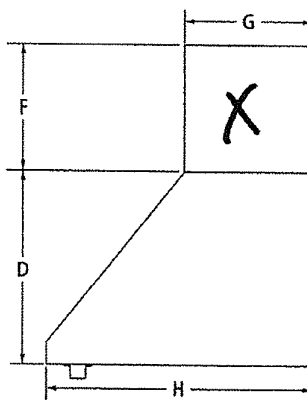

SIDE VIEW
(shown with optional duct cover)

**NO
Duct cover**

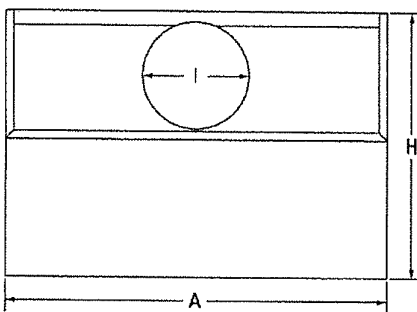

TOP VIEW

MODEL #	JXW9048WP		JXW9036WP		JXW9030WP	
	in	cm	in	cm	in	cm
A Overall width	48	121.9	36	91.4	30	76.2
B Height without trim	15 ³ / ₄	40.0	15 ³ / ₄	40.0	15 ³ / ₄	40.0
C Height of trim	2 ¹ / ₄	5.7	2 ¹ / ₄	5.7	2 ¹ / ₄	5.7
D Height without controls	18	45.7	18	45.7	18	45.7
E Height with controls	19 ³ / ₈	49.1	19 ³ / ₈	49.1	19 ³ / ₈	49.1
F Height of optional duct cover	12	30.5	12	30.5	12	30.5
G Depth of optional duct cover	12	30.5	12	30.5	12	30.5
H Depth of hood	25	63.5	25	63.5	25	63.5
I Vent collar diameter	9 ⁷ / ₈	25.1	9 ⁷ / ₈	25.1	9 ⁷ / ₈	25.1

Product dimension, cutout and installation specifications are provided for planning purposes only. Before installing any product, be sure to verify cutout dimensions and electrical/gas connections as actual product dimensions may vary.

JENN-AIR®

JRC120062A 07/2012

JENN-AIR® DETAILED PLANNING DIMENSIONS

2 of 4

48"/36"/30" PRO-STYLE™ WALL-MOUNT HOODS

JXW9048WP – 48" x 19³/₈" x 25"

JXW9036WP – 36" x 19³/₈" x 25"

JXW9030WP – 30" x 19³/₈" x 25"

OPENING/CLEARANCE DIMENSIONS

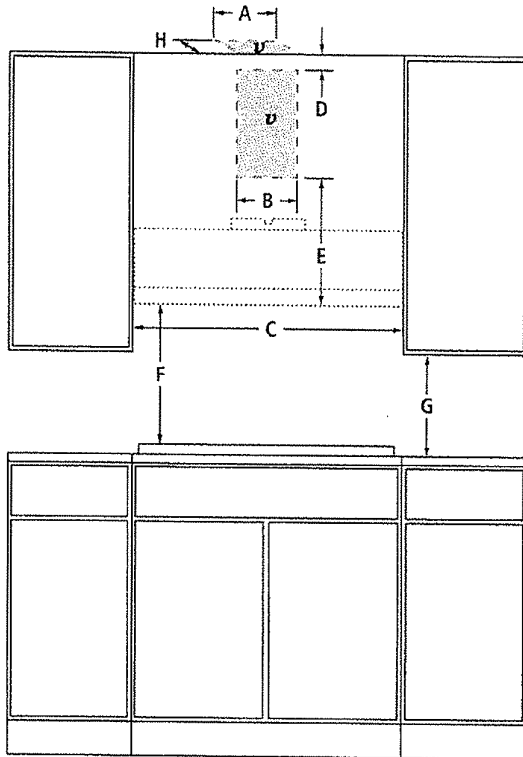

FRONT VIEW

ELECTRICAL REQUIREMENTS

120 volt, 60 Hz, AC only, 15-amp fused, electrical circuit is required. The knockout into the back of the terminal box is located on the right side.

VENTING REQUIREMENTS

The hood is factory set for venting through the roof or wall. Do not terminate the vent in an attic or other enclosed area.

LOCATION REQUIREMENTS

The minimum height from the floor to the top of the vent hood is 7' (2.1 m). The minimum height from the floor to the top of the optional duct cover is 8' (2.4 m).

MODEL #		JXW9048WP		JXW9036WP		JXW9030WP	
		in	cm	in	cm	in	cm
A	Width of vent entry location – ceiling option	12	30.5	12	30.5	12	30.5
B	Width of vent entry location – wall option	12	30.5	12	30.5	12	30.5
C	Width of cabinet opening (min.)	48	121.9	36	91.4	30	76.2
D	Height from vent entry location to ceiling – wall option (min.)	2	5.1	2	5.1	2	5.1
E	Height from hood to vent entry location – wall option (min.)	24	61.0	24	61.0	24	61.0
F	Height from hood to cooking surface (min.-max.)	30-36	76.2-91.4	30-36	76.2-91.4	30-36	76.2-91.4
G	Height from upper cabinet to countertop (min.)	18	45.7	18	45.7	18	45.7
H	Depth of vent entry location – ceiling option	12	30.5	12	30.5	12	30.5
v	Recommended vent entry location						

Product dimension, cutout and installation specifications are provided for planning purposes only. Before installing any product, be sure to verify cutout dimensions and electrical/gas connections as actual product dimensions may vary.

JENN-AIR®

JRC120062A 07/2012

JENN-AIR® DETAILED PLANNING DIMENSIONS

VENTILATION SELECTION CHART – COOKTOPS

3 of 4

MODEL #	PRO-STYLE™ HOODS			EURO-STYLE ISLAND-MOUNT HOODS		EURO-STYLE WALL-MOUNT HOODS		GLASS COLLECTION ISLAND-MOUNT HOOD	GLASS COLLECTION WALL-MOUNT HOODS	PERIMETRIC HOOD	OILED BRONZE WALL-MOUNT HOODS	EURO-STYLE TELESCOPING DOWNDRAFT SYSTEMS	CUSTOM HOOD LINERS	OVER-THE-RANGE MICROWAVE OVENS
	JXW9048WP	JXW9036WP	JXU9150WP	JX18042WS	JX18036WS	JXW8036WS	JXW8030WS							
INDUCTION COOKTOPS														
36-INCH														
JIC4530X – 5 Elements	■	■	—	★	★	—	★	★	★	★	■	—	★	■
30-INCH														
JIC4430X – 4 Elements	■	■	■	■	★	—	★	★	★	★	■	★	★	■
CONVENTIONAL GAS COOKTOPS														
36-INCH (less than 60,000 BTU total)														
JGC9536BD – 5 Burners	■	■	—	★	★	—	★	★	★	★	★	★	★	■
JGC1536AD – 5 Burners	■	■	—	★	★	—	★	★	★	★	■	★	★	■
JGC8536BD – 5 Burners	■	■	—	★	★	—	★	★	★	★	■	★	★	■
30-INCH (less than 60,000 BTU total)														
JGC9430BD – 4 Burners	■	■	■	■	★	—	★	★	★	★	★	★	★	■
JGC1430AD – 4 Burners	■	■	■	■	★	—	★	★	★	★	■	★	★	■
JGC8430CD – 4 Burners	■	■	■	■	★	—	★	★	★	★	■	★	★	■
CONVENTIONAL ELECTRIC COOKTOPS														
36-INCH														
JEC4530Y – 5 Elements	■	■	—	★	★	—	★	★	★	★	■	★	★	■
JEC9536BD – 5 Elements	■	■	—	★	★	—	★	★	★	★	■	★	★	■
JEC8536BD – 5 Elements	■	■	—	★	★	—	★	★	★	★	■	★	★	■
30-INCH														
JEC4530Y – 5 Elements	■	■	■	■	★	—	★	★	★	★	■	★	★	■
JEC9530BD – 5 Elements	■	■	■	■	★	—	★	★	★	★	■	★	★	■
JEC8430BD – 4 Elements	■	■	■	■	★	—	★	★	★	★	■	★	★	■

A. Custom hood liners can be used with any of the following blower motors: UX31200DYS, UX80600DYS, UX1203DYS or UX16000DYS.

KEY	
★	Style and Performance Pair
■	Performance Pair
—	Not Recommended

Product dimension, cutout and installation specifications are provided for planning purposes only. Before installing any product, be sure to verify actual dimensions and electrical/gas connections as actual product dimensions may vary.

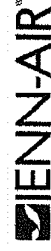

JRC120062A 07/2012

JENN-AIR® DETAILED PLANNING DIMENSIONS

VENTILATION SELECTION CHART – RANGETOPS AND RANGES

4 of 4

MODEL #	PRO-STYLE™ HOODS	EURO-STYLE ISLAND-MOUNT HOODS	EURO-STYLE WALL-MOUNT HOODS	GLASS COLLECTION ISLAND-MOUNT HOOD	GLASS COLLECTION WALL-MOUNT HOODS	PERIMETRIC HOOD	OILED BRONZE WALL-MOUNT HOODS	EURO-STYLE TELESCOPING DOWNDRAFT SYSTEMS	CUSTOM HOOD LINERS	OVER-THE-RANGE MICROWAVE OVENS
	JXW9048WP JXW9036WP JXW9128WP JXW9130WP	JXB042WS JXB036WS	JXW8036WS JXW8036WS		JXW5036WS	JXP5032WS	JXW6030WR	JXD7036YS JXD7030YS	UXL6048YSS UXL6036YSS 1200 or 600 CFM	JMW9186W JMW8208W
PRO-STYLE RANGETOPS										
48-INCH (more than 60,000 BTU total)	★	—	—	—	—	—	—	—	★	—
JGP548WP – 6 Burners & Griddle										
36-INCH (less than 60,000 BTU total)	★	—	—	—	—	—	—	—	★	—
JGP536WP – 4 Burners & Griddle										
36-INCH (more than 60,000 BTU total)	★	—	—	—	—	—	—	—	★	—
JGP436WP – 6 Burners										
30-INCH (less than 60,000 BTU total)	★	—	—	—	—	—	—	—	★	—
JGP430WP – 4 Burners										
48-INCH (less than 60,000 BTU total)	★	—	—	—	—	—	—	—	★	—
JGD8348CDP – 4 Burners & Grill Assembly										
PRO-STYLE DUAL-FUEL AND GAS RANGES										
48-INCH (more than 60,000 BTU total)	★	—	—	—	—	—	—	—	★	—
JDRP548WP – 6 Burners & Griddle										
36-INCH (less than 60,000 BTU total)	★	—	—	—	—	—	—	—	★	—
JDRP536WP – 4 Burners & Griddle										
36-INCH (more than 60,000 BTU total)	★	—	—	—	—	—	—	—	★	—
JDRP436WP – 6 Burners										
30-INCH (less than 60,000 BTU total)	★	—	—	—	—	—	—	—	★	—
JDRP430WP – 4 Burners										
48-INCH (more than 60,000 BTU total)	★	—	—	—	—	—	—	—	★	—
JDRP430WP – 4 Burners										
DUAL-FUEL AND GAS CONVENTIONAL (less than 60,000 BTU total)										
JDS8860BDP – 4 Burners	★	—	—	—	—	—	—	—	★	—
JDS8850CD – 4 Burners										
JGS8860BDP – 4 Burners	★	—	—	—	—	—	—	—	★	—
JGS8850CD – 4 Burners										
ELECTRIC CONVENTIONAL										
JES8850CA – 5 Elements	★	—	—	—	—	—	—	—	★	—

A. Custom hood liners can be used with any of the following blower motors: UXB1200DYS, UXB0600DYS, UX1200DYS or UX1060DYS
 B. Blower motor UXB0600DYS is rated for up to 65,000 BTUs and can be used with the rangetops and ranges indicated.

KEY	Style and Performance Pair
★	Performance Pair
—	Not Recommended

Product dimension, cutout and installation specifications are provided for planning purposes only. Before installing any product, be sure to verify cutout dimensions and electrical requirements as actual product dimensions may vary.