



CONSTRUCTION SUMMARY

Block 411 Unit 2 - 1 - The Napa 1 (TH-1) Elev A

CONSTRUCTION

Inv.222	1 - REDUCE KITCHEN BY ONE FOOT - AS PER SKETCH, THIS INCLUDES MOVING BACK BREAKFAST BAR AND SINK COUNTER, FLOOR TILE, AND STANDARD KITCHEN SMOOTH CEILINGS BY ONE FOOT
Line1846	Note:
26Jul15 / 9Sep15	

ELECTRICAL

Inv.222	1 - CEILING OUTLET - ON NEW SWITCH - EXTRA INTERIOR CEILING OUTLET ROUGH IN NO FIXTURE ON NEW SWITCH - CENTERED ABOVE BREAKFAST BAR - AS PER SKETCH
Line1969	Note:
26Jul15 / 9Sep15	

HARDWOOD FLOORING

Inv.222	1 - HARDWOOD - STANDARD - 2¼ MERCIER SOLID OAK - STANDARD COLOURS - LANDING
Line1841	Note:
26Jul15 / 9Sep15	
Inv.222	1 - HARDWOOD - STANDARD - 2¼ MERCIER SOLID OAK - STANDARD COLOURS - UPPER HALL
Line1842	Note:
26Jul15 / 9Sep15	

PATIO DOOR
GREAT ROOM-
17'2"x12'0"

OPT. COFFERED CEILING

BLK 411 unit 2
Napali A.

move back b. bar
in kitchen tile 1ft
smooth ceiling in kitchen

4x4 MS
new up
ceiling
(12'11'2")

FLUSH BREAKFAST BAR

9'0"x9'0"

DW

SINK

KITCHEN

8'2"x12'10"

L.W.

UP

F

MUD

DN IF REQD.

DOORS WHERE
GRADE PERMITS

OTA

DN

PWD

DN

SUNKEN
FOYER

GARAGE
10'0"x19'8"

PORCH

Ground Floor
Elevation A

E
9

BLK 411 unit 0
Napal A.

UNFINISHED
BASEMENT

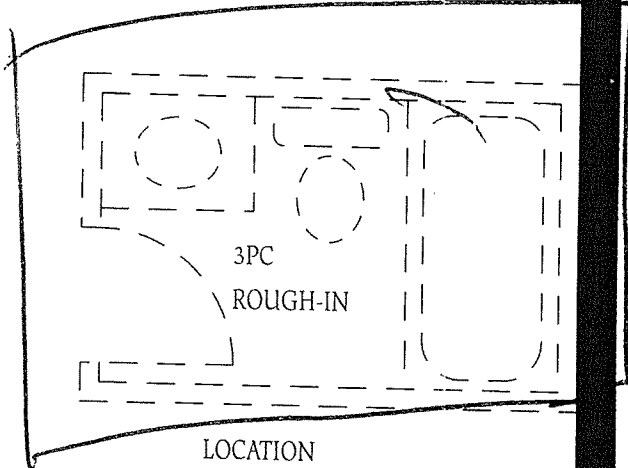

move
rough in

LOCATION
MAY VARY

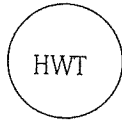

UP

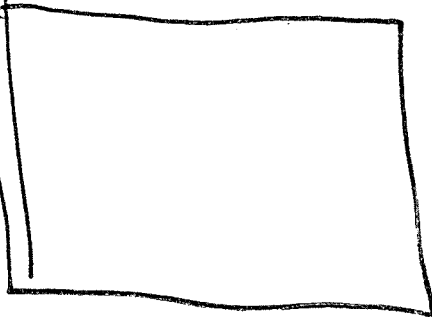
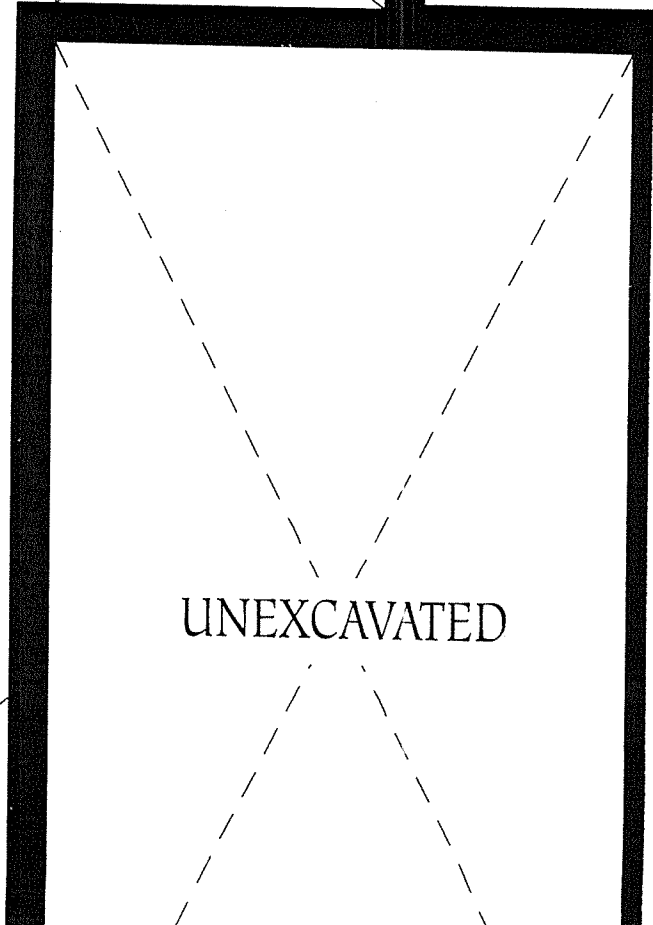
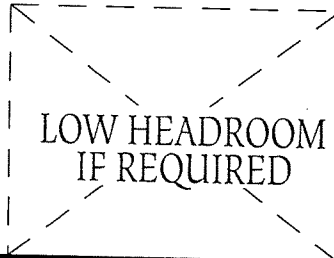
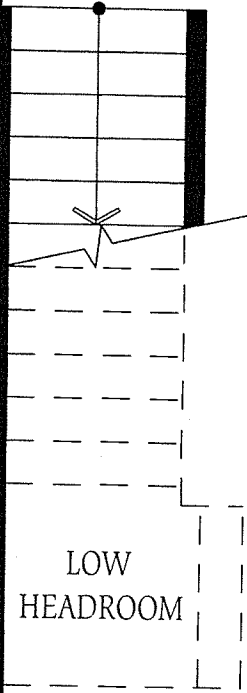

LOW HEADROOM