

# Construction Scheme

## Suite: 705, Level: 7 - Rush

### STANDARD SUITE FINISHES (SEE UPGRADE SUMMARY FOR EXTRAS)

#### CERAMICS

		UPGRADE
Floor Tile (Main Bath)	MOD (Concrete. Col: Ash Grey. Matte Finish. 12" x 24")	
Wall Field Tile (Main Bath)	MOD (Colours & Dimensions. Arctic White. Matte Finish. 4" x 16")	
Accent Tile (Main Bath)	MOD (Colours & Dimensions. Sterling Grey. Matte Finish. 4" x 16")	

#### CABINETRY

		UPGRADE
METRO. AL UNOVA. WHITE. HI-GLOSS (Kitchen Only)		
Cabinets (Kitchen)	Cabinet UPGRADE #3 (METRO. AL UNOVA. WHITE. HI-GLOSS)	
Vanity Cabinet (Main Bath)	MOD (Como. Grigio. Flat Panel)	







#### COUNTERTOPS AND BACKSPLASH

		UPGRADE
Backsplash (Kitchen)	FAB (Cristallo Glass Mosaic. Grey. 1"x2")	
Kitchen Countertop (Kitchen)	FAB (Blizzard. Quartz)	
Countertop (Main Bath)	MOD (Bianco Carrara. Marble. Polished Finish)	

#### FLOORING (HARDWOOD AND CARPET)

		UPGRADE
Hardwood Flooring - Standard - Den		
Entry (Flooring)	FAB (Solo-3 Layer Engineered Wood Floor. White Oak. Graphite. 1/2X4X1/4")	
Kitchen (Flooring)	FAB (Solo-3 Layer Engineered Wood Floor. White Oak. Graphite. 1/2X4X1/4")	
Living Room/Dining Room (Flooring)	FAB (Solo-3 Layer Engineered Wood Floor. White Oak. Graphite. 1/2X4X1/4")	
Den (Flooring)	FAB (Solo-3 Layer Engineered Wood Floor. White Oak. Graphite. 1/2X4X1/4")	
Master Bedroom (Flooring)	FAB (Tender Ivory. Palilio 17057)	

EXTRAS

		UPGRADE
Smooth Ceiling - Throughout		
24" Deep Upper Cabinet Above Fridge with a 5/8" Fridge Gable		
Valence Lighting		
Front Loader Washer and Dryer - Whirlpool Duet 2014 (In Lieu of Standard)		
Option 1 - Open Roll Roller Shades		
Option 1 - Open Roll Roller Shades - Master Bedroom - Canvas		
Option 1 - Open Roll Roller Shades - Dining/Living - Pearl		

Suite: 705, Level: 7 - Rush

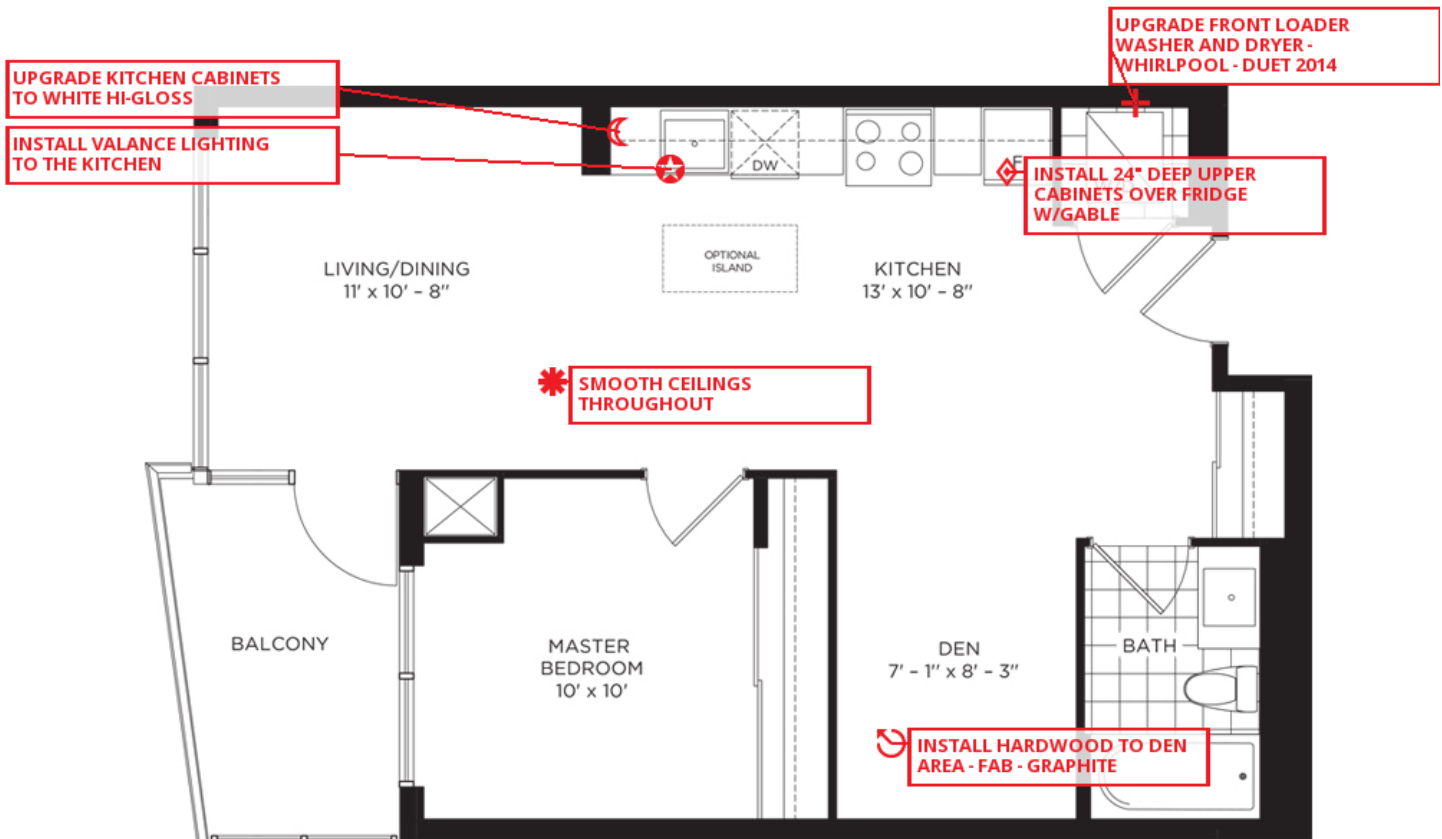

MAIN LEVEL