

Construction Scheme

Suite: 1801, Level: 18 - Lush

STANDARD SUITE FINISHES (SEE UPGRADE SUMMARY FOR EXTRAS)

CERAMICS

		UPGRADE
Floor Tile (Main Bath)	NEO (Concrete. Col: Light Taupe. Matte Finish. 12" x 24")	
Wall Field Tile (Main Bath)	NEO (Colours & Dimensions. Arctic White. Matte Finish. 4" x 16")	
Accent Tile (Main Bath)	NEO (Colours & Dimensions. Sand Beige. Sand Beige. 4" x 16")	



CABINETRY

		UPGRADE
Cabinets (Kitchen)	NEO (Como. Nero. Flat Panel)	
Vanity Cabinet (Main Bath)	NEO (Como. Nero. Flat Panel)	

COUNTERTOPS AND BACKSPLASH

		UPGRADE
Backsplash (Kitchen)	NEO (Cristallo Glass Mosaic. Ivory. 1"x2")	
Kitchen Countertop (Kitchen)	NEO (Beige Marfil. Quartz)	
Countertop (Main Bath)	NEO (Boticino Fiorito. Marble. Polished Finish)	

FLOORING (HARDWOOD AND CARPET)

		UPGRADE
Hardwood Flooring - Option C - Foyer + Closet / Kit		
Hardwood Flooring - Option C - Living / Dining		
Entry (Flooring)	UPGRADE OPTION B-Hardwood Floor (W- Tabaek Walnut Natural 4" Width)	
Kitchen (Flooring)	UPGRADE OPTION C-Hardwood Floor (W- Tabaek Walnut Natural 4" Width)	
Living Room/Dining Room (Flooring)	UPGRADE OPTION C-Hardwood Floor (W- Tabaek Walnut Natural 4" Width)	
Den (Flooring)	MOD (Cameo.Papilio 17185)	
Master Bedroom (Flooring)	MOD (Cameo.Papilio 17185)	



EXTRAS

		UPGRADE
Interior Door 2 Panel - Option 1	Quantity: 4	
Closet Doors - Master Bedroom - Mirror Sliders - Medium Sized Closet		
Den Enclosures - Bottom Rolling Slider - 3 Sliders - 3 Meter Straight Opening - Frosted Glass		
Custom Closet - Master Bedroom Closet - Without Drawers - WHITE		
Electric Fireplace without Mantel - Option 1: Napoleon EF39HD		
24" Deep Upper Cabinet Above Fridge with a 5/8" Fridge Gable		
Main Bath - Medicine Cabinet		
Front Loader Washer and Dryer - Whirlpool Duet 2014 (In Lieu of Standard)		
Option 1 - Open Roll Roller Shades		
Option 1 - Open Roll Roller Shades - Master Bedroom - Canvas		
Option 1 - Open Roll Roller Shades - Dining/Living - Pearl		

Suite: 1801, Level: 18 - Lush

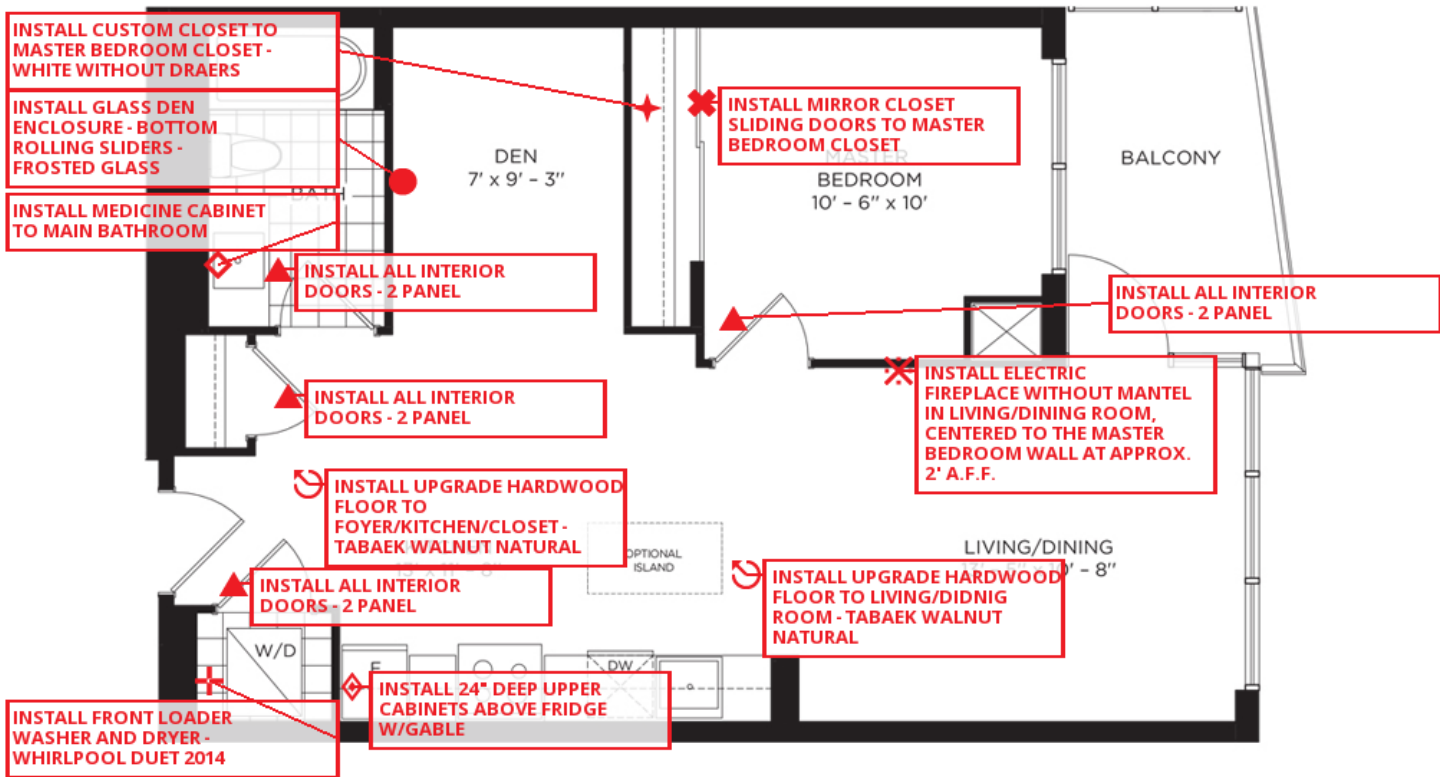

MAIN LEVEL