

Elle Construction Colour Scheme
3525 Kariya Drive
Suite 2003, Level 17, Unit 3

CABINETRY AND COUNTERTOPS

KITCHEN CABINET	Cartier 318 Maple Wenge
<input type="checkbox"/> 42" Upper Cabinets	<input type="checkbox"/> White Cabinet Only <input type="checkbox"/> Valence Lighting
MAIN BATH CABINET	White Shaker
ENSUITE CABINET	
KITCHEN COUNTERTOP	New Caledonia 3/4" Granite Slab Single Square Profile Edge
<input type="checkbox"/> 1 1/4" Granite Counter Top	<input checked="" type="checkbox"/> Under-Mount Kitchen Sink
MAIN BATH COUNTERTOP	Formica 7814-58 Chalk Solid
<input type="checkbox"/> Stone Vanity Counter Top	<input type="checkbox"/> Shower Stall <input type="checkbox"/> Jetted Tub <input type="checkbox"/> Undermount Sink
ENSUITE COUNTERTOP	
<input type="checkbox"/> Stone Vanity Counter Top	<input type="checkbox"/> Shower Stall <input type="checkbox"/> Jetted Tub <input type="checkbox"/> Undermount Sink
APPLIANCES	Black

TILES

ENTRY FLOOR TILE	Olympia Fabric Gold 12" x 12"
KITCHEN FLOOR TILE	Olympia Fabric Gold 12" x 12"
KITCHEN BACKSPLASH	Olympia Yukon Matte Taupe Y13 3" x 6"
BATHROOM FLOOR TILE	Centura DX2260 12" x 12"
BATHROOM WALL TILE	Ciot Fusion Brown 10" x 18"
BATHROOM WALL ACCENT TILE	
ENSUITE FLOOR TILE	
ENSUITE WALL TILE	
ENSUITE WALL ACCENT TILE	

HARDWOOD

	Kultur Clique Smoke Maple Lounge 4" Width
<input checked="" type="checkbox"/> Living Room/Dining Room/Hallway	<input type="checkbox"/> Den <input type="checkbox"/> Entry <input type="checkbox"/> Kitchen
<input type="checkbox"/> Master Bedroom	<input type="checkbox"/> 2nd Bedroom <input type="checkbox"/> 3rd Bedroom

CARPET

	Peerless Excel Lt. Cashmere 6383
--	----------------------------------

ELECTRICAL

<input type="checkbox"/> Valence Lighting	<input type="checkbox"/> Electrical Outlets	<input type="checkbox"/> TV/Cable Outlets	<input type="checkbox"/> Phone Outlets	<input type="checkbox"/> Light Fixture
---	---	---	--	--

VENETIAN BLINDS

<input checked="" type="checkbox"/> No
--

NOTES

Elle Colour Selection

3525 Kariya Drive, Mississauga, ON. Suite # 2003 Unit # 3 Level 17
Purchaser(s). RYAN GLASSFORD

floorplan 3:

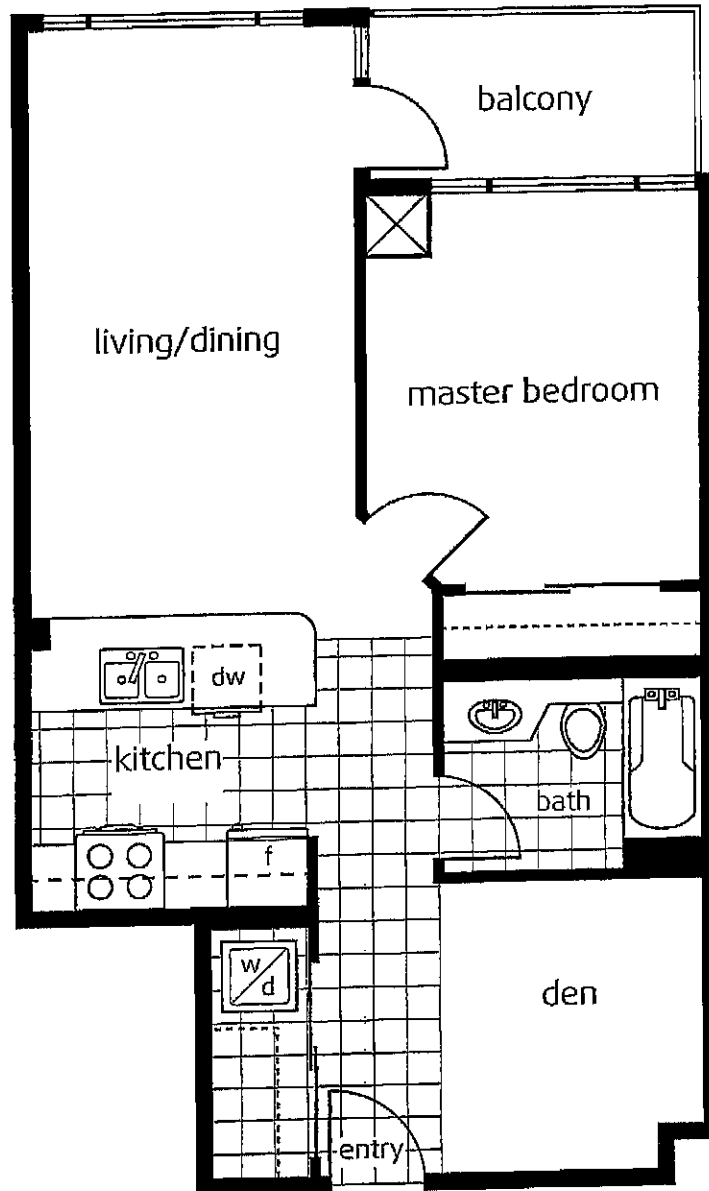

The floor plan shown above is for reference purposes only. This plan is not to scale and is subject to architectural review and revision, including, without limitation, the Unit being constructed with a layout that is the reverse of that set out above. All details and dimensions, if any, are approximate, and subject to change without notice in order to comply with building site conditions, municipal, structural, Vendor and/or architectural requirements. Balconies and Terraces are exclusive use common elements, shown for display purposes only and location and size vary according to applicable floor plan design layout. Materials, specifications, floor plans and dimensions are subject to change without notice. Window size and type may vary. E & O.E.